

HAGGERTY SCHOOL PLAYGROUND - DESIGN CONCEPT #1

CITY OF CAMBRIDGE

COMMUNITY DEVELOPMENT DEPARTMENT

2014

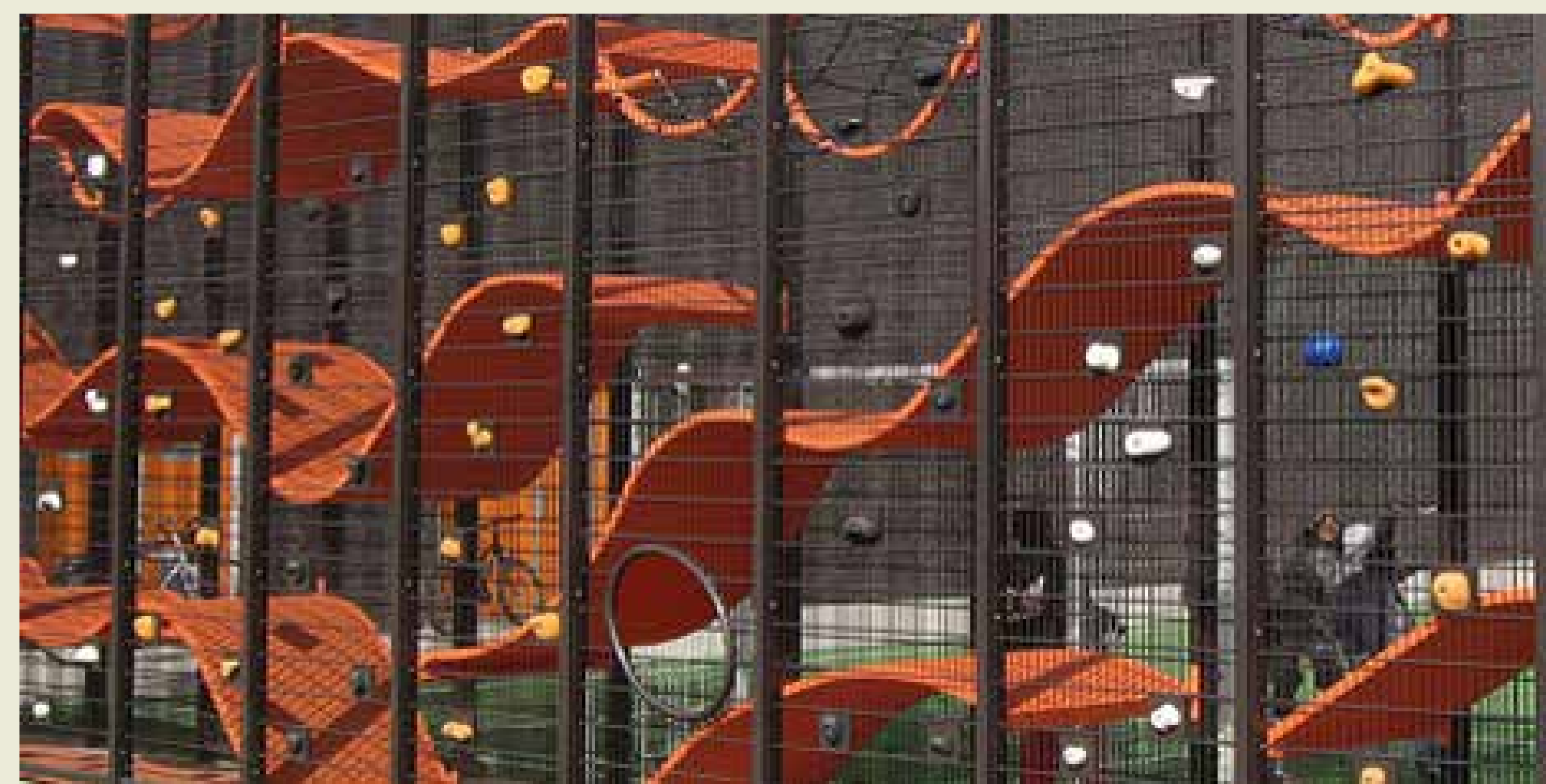

▲ PLAY "CIRCUIT" (BALANCE & UPPER BODY)



▲ OPEN SPACE GAINED BY USING VERTICAL PLAY EQUIPMENT AGAINST BACK WALLS

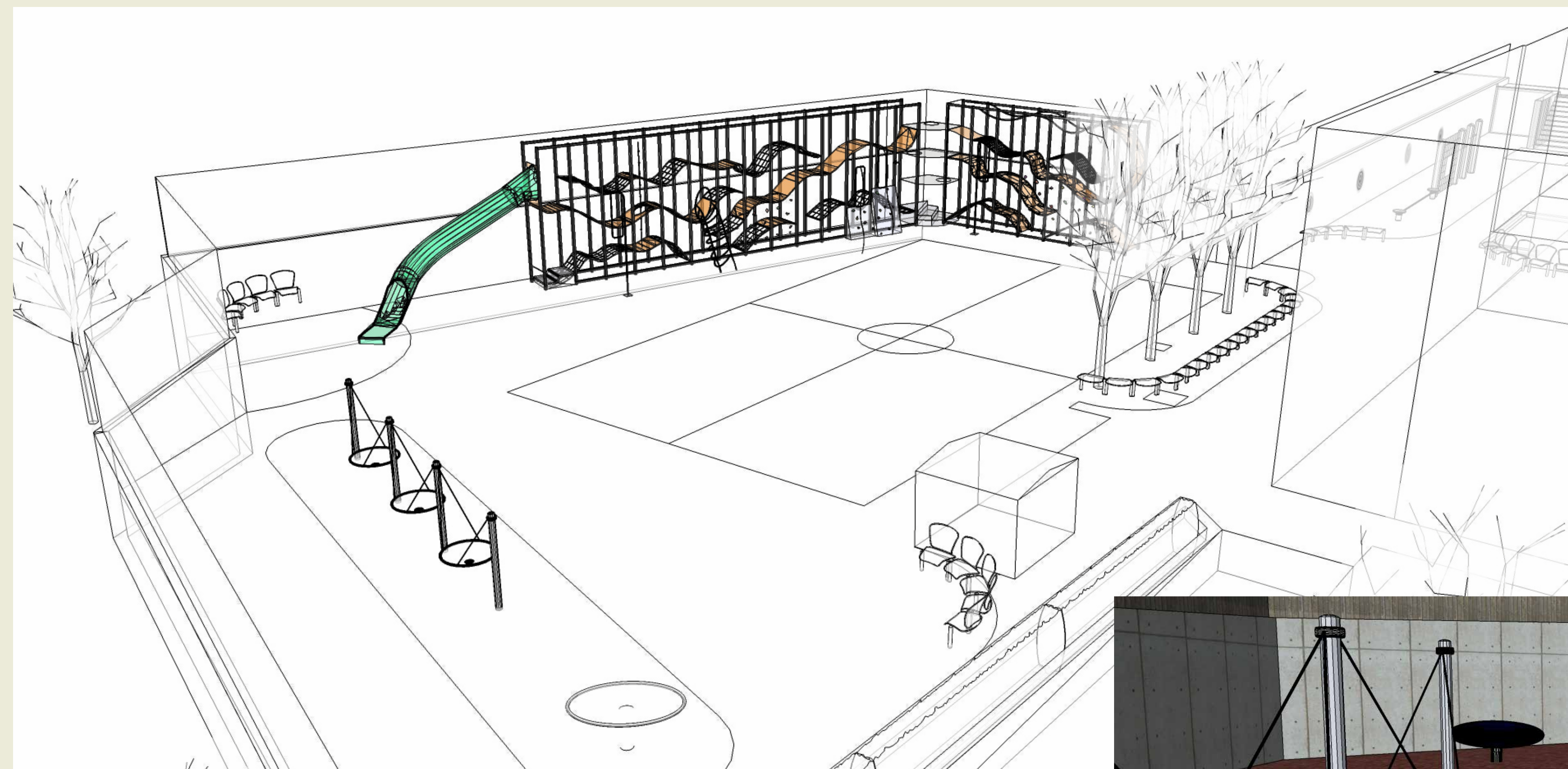

▲ OPEN MULTI USE ARTIFICIAL GRASS AREA

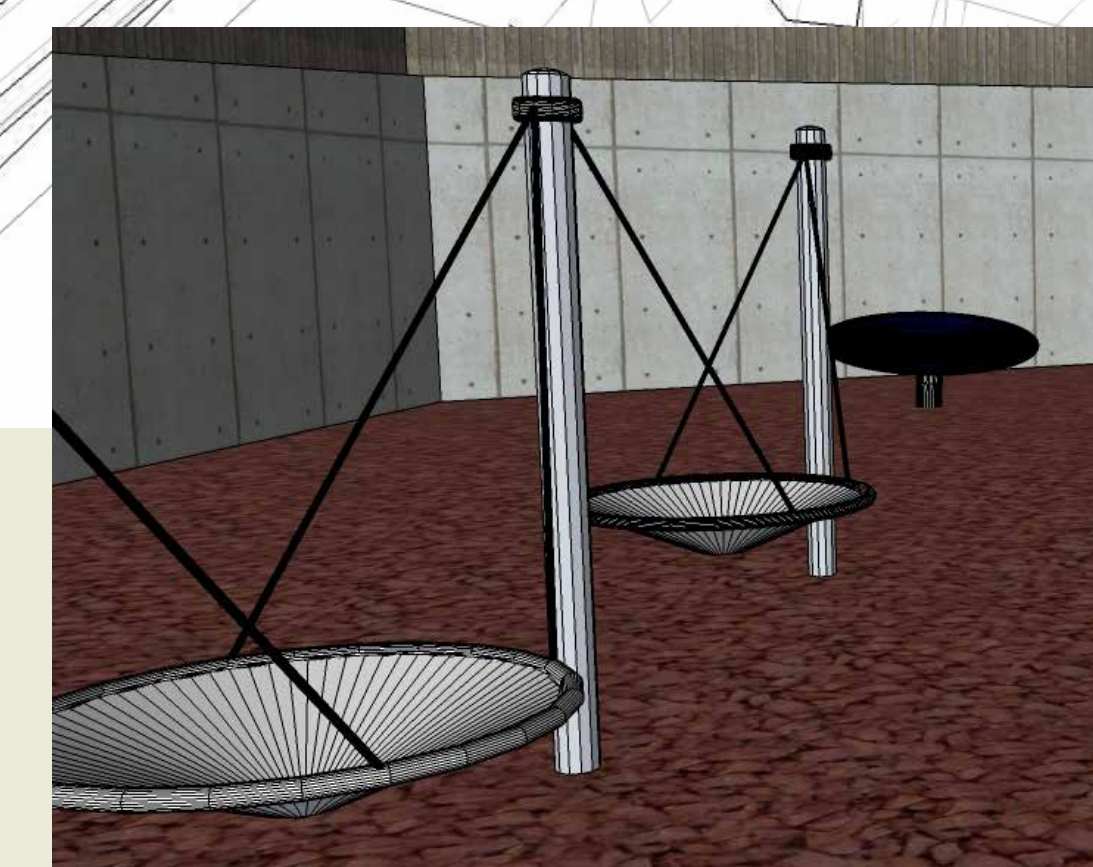

▲ GROUP SWINGS

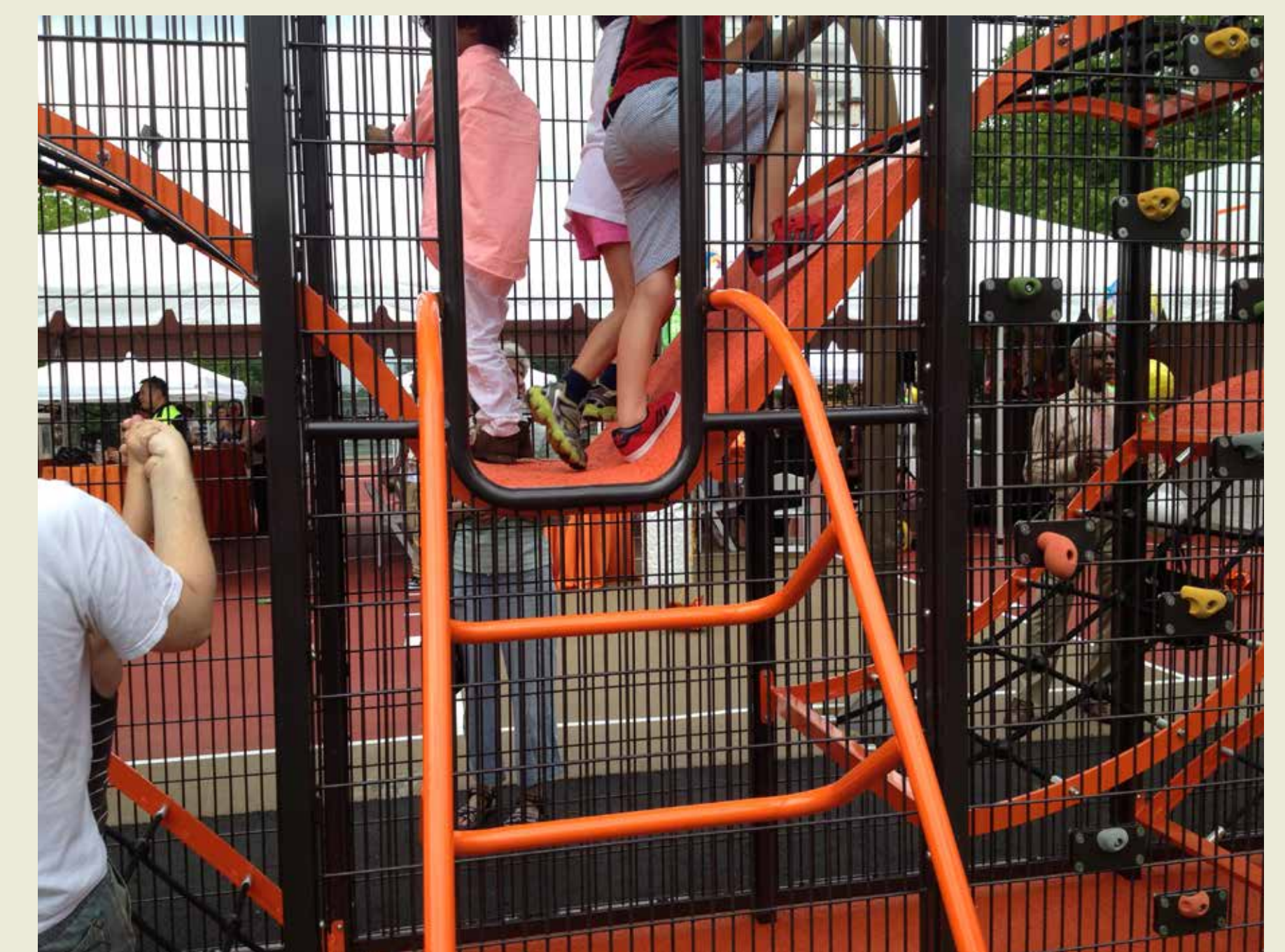

▲ MOVEMENT CAROUSEL/SPINNER



▲ ARTIFICIAL GRASS FIELD & PLAYGROUND SURFACING



▲ SEATING FOR SMALL & LARGE GROUPS

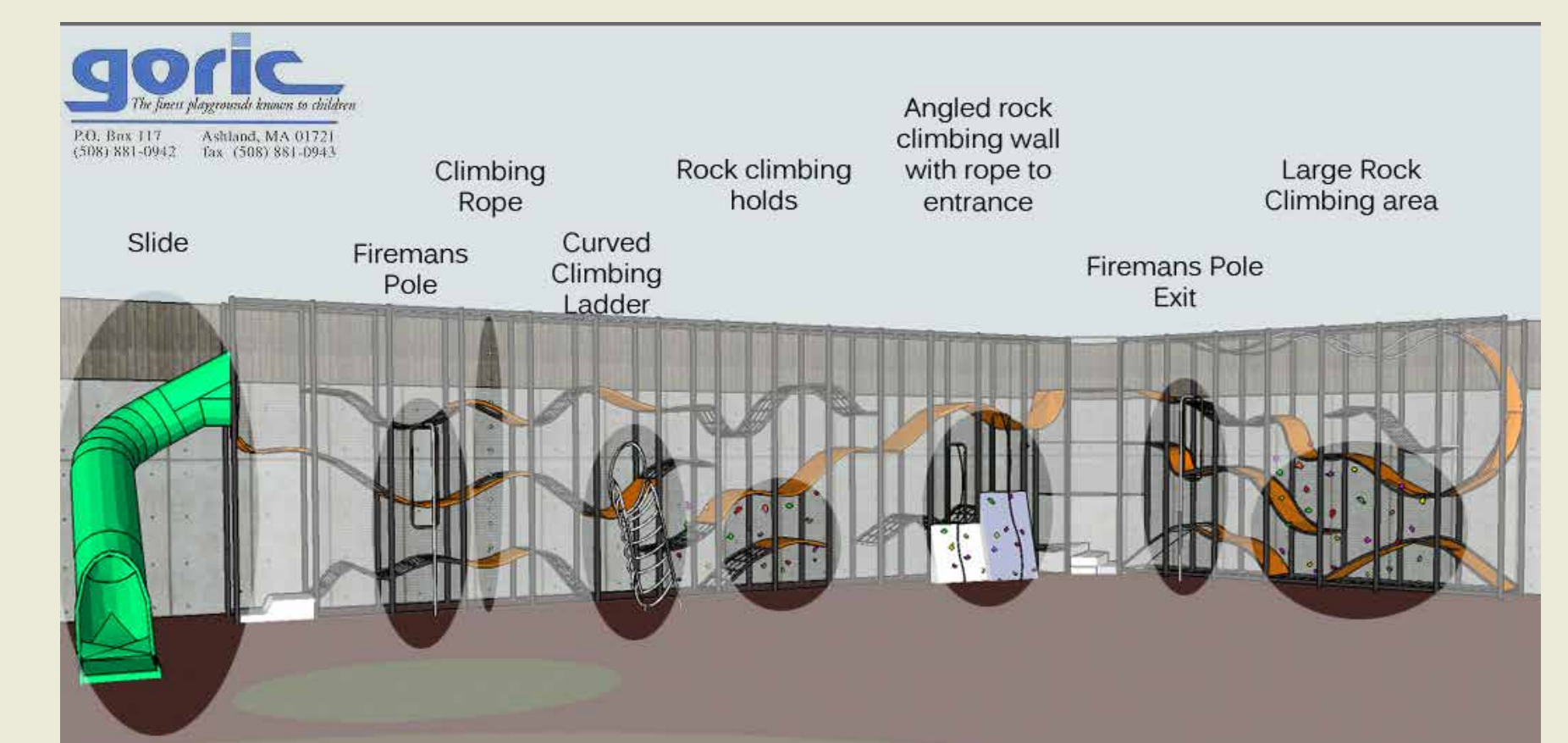

HAGGERTY SCHOOL PLAYGROUND - PRE-SCHOOL PLAYSPACE (Lawn St. Side)

CITY OF CAMBRIDGE

COMMUNITY DEVELOPMENT DEPARTMENT

2014



▲ RUBBERIZED MOUNDS/SLOPED/HILLS FOR PLAY



▲ MOVEMENT/CAROUSEL



▲ STORAGE SHEDS FOR LOOSE PARTS



▲ PLAY HOUSE

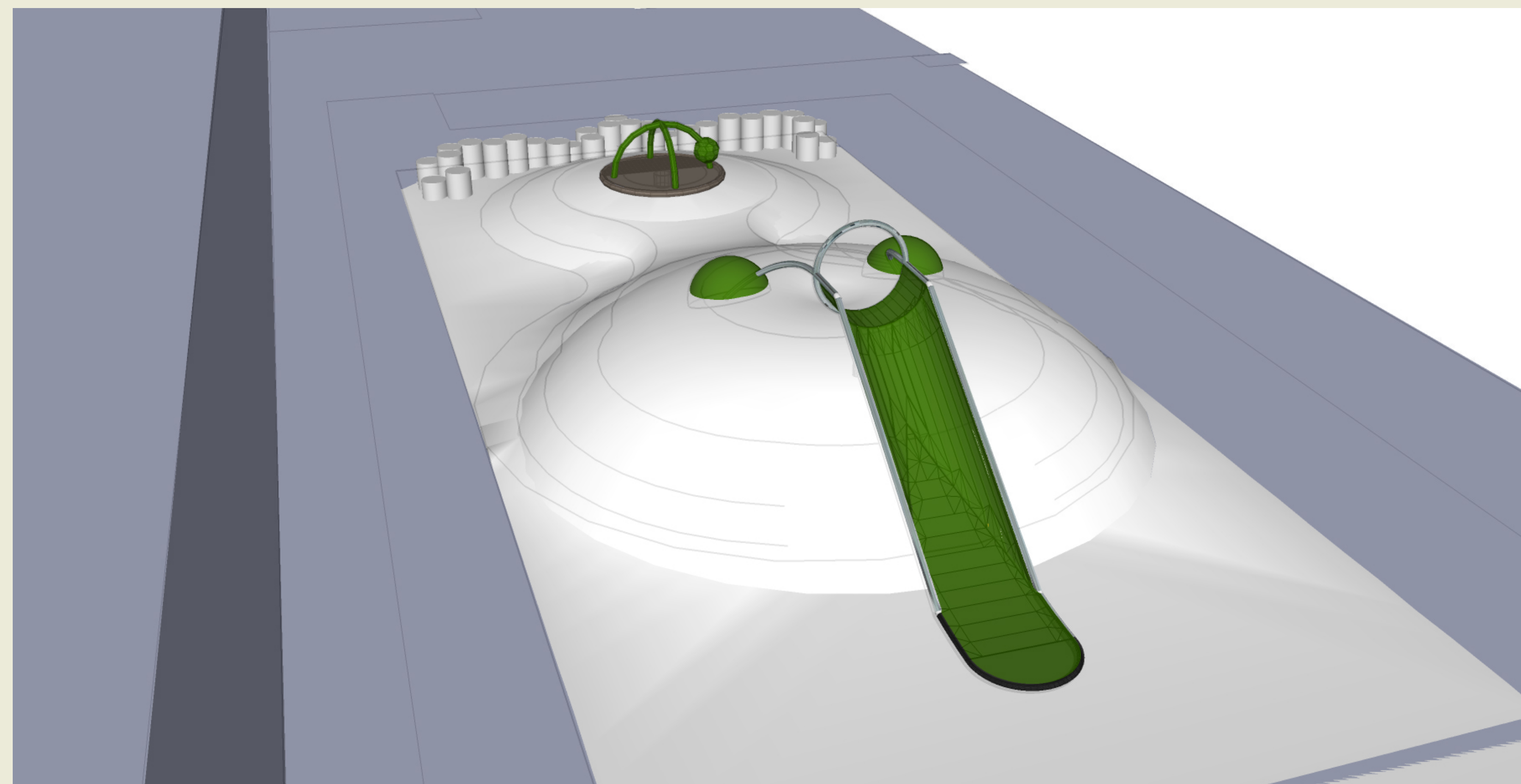

▲ LOOSE PARTS

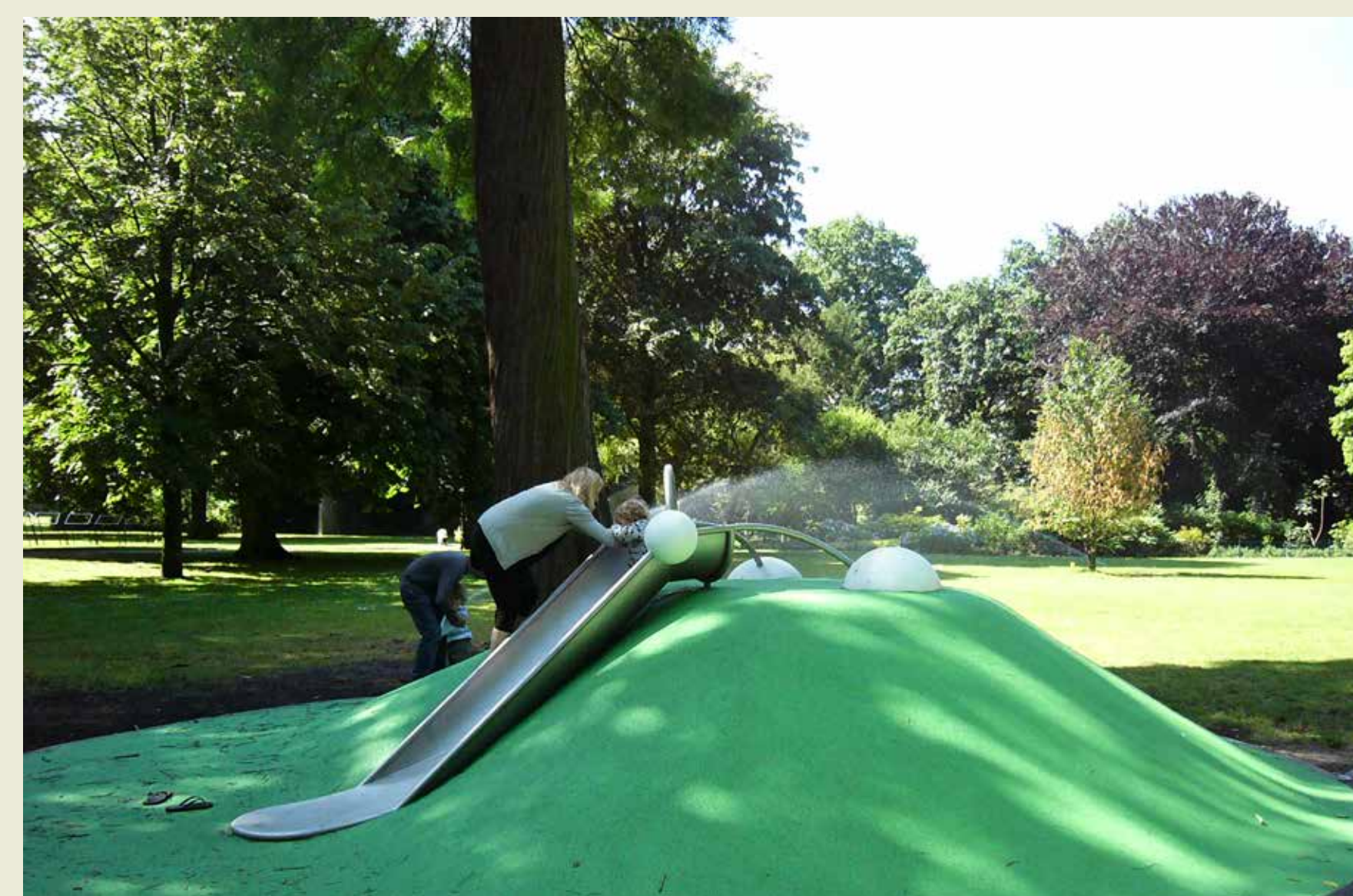

▲ SLIDE INTERGRATED INTO HILL

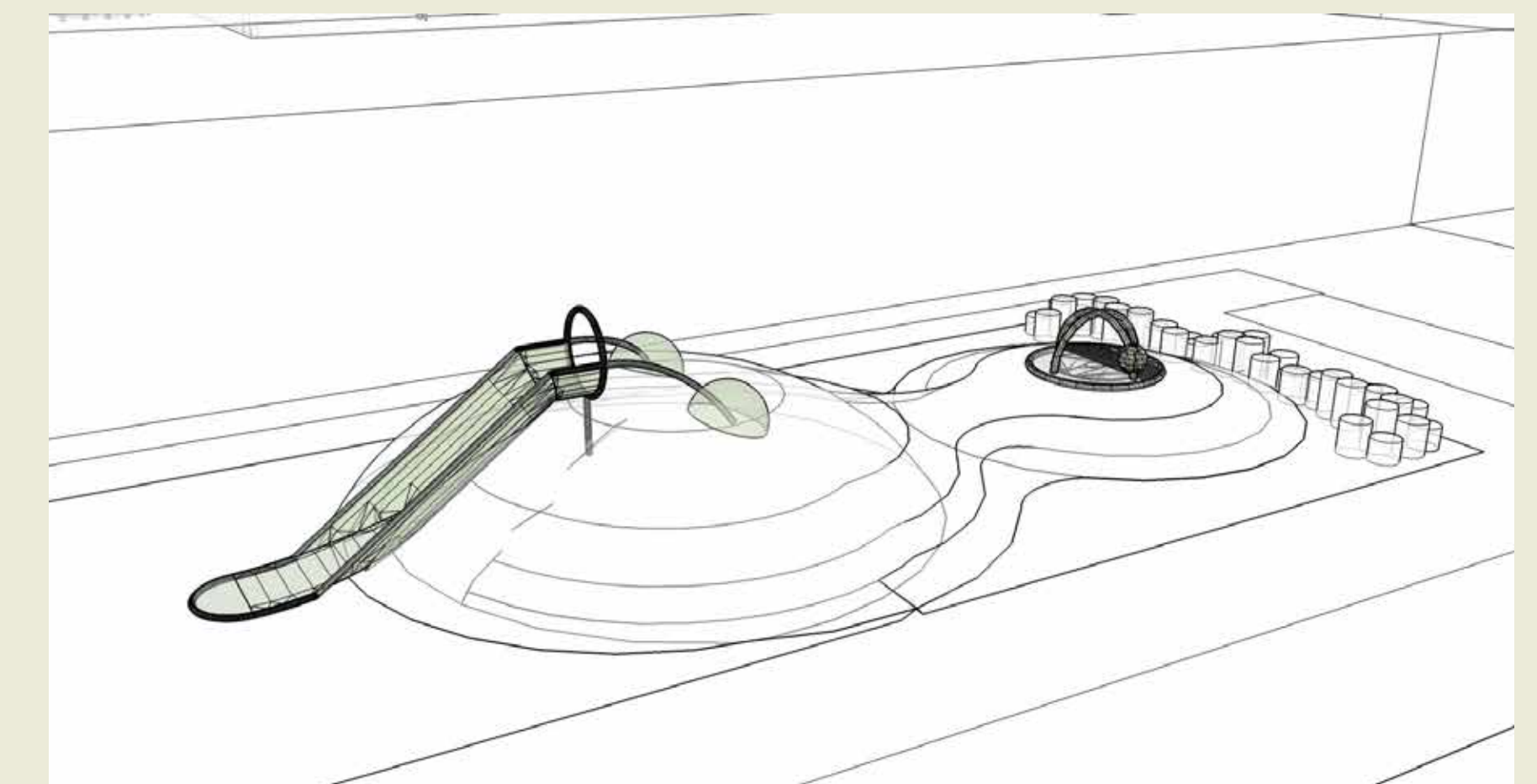
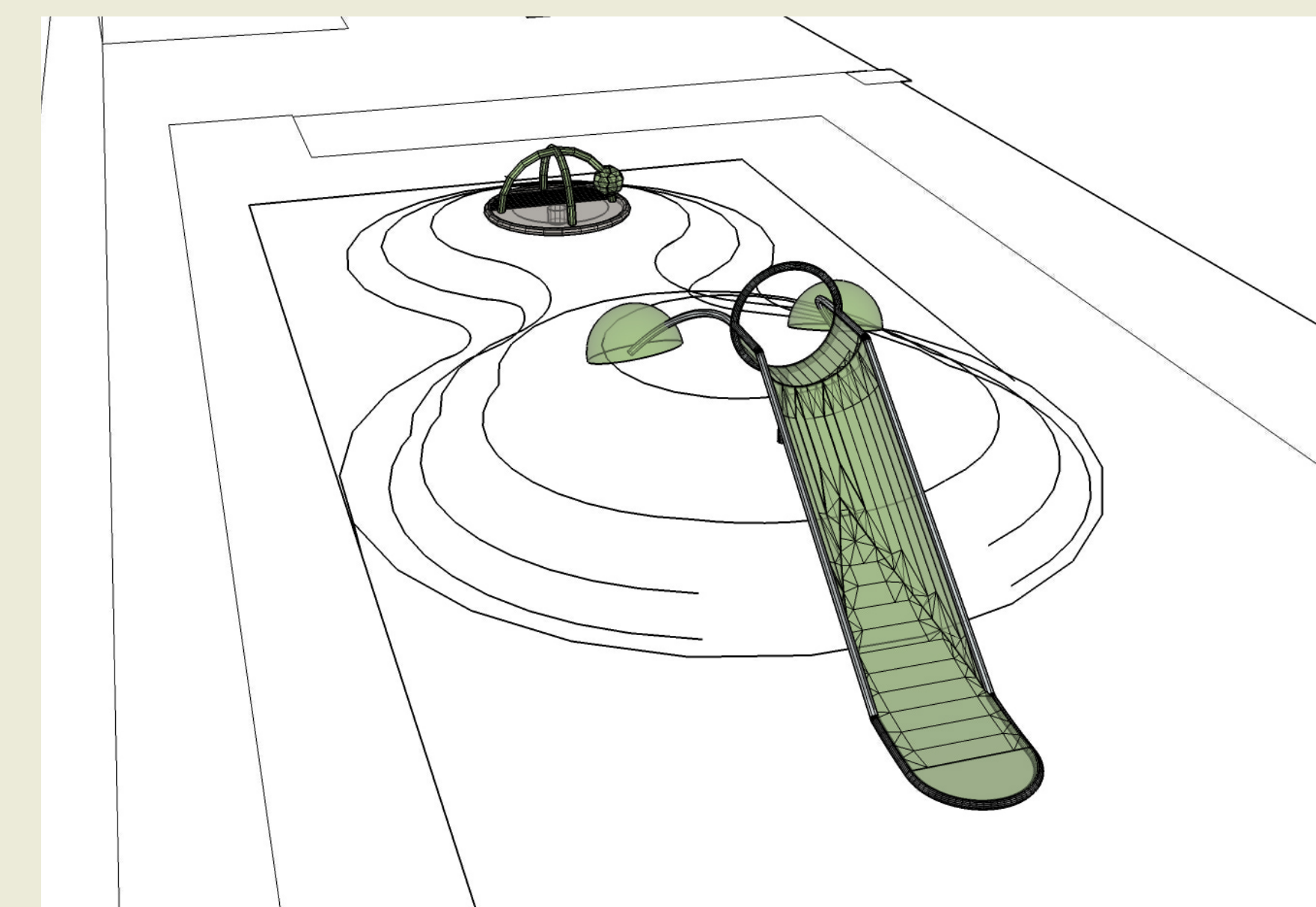

▲ CLIMBING LOGS (RUBBER)/HILLS

HAGGERTY SCHOOL PLAYGROUND - STORAGE PLAY POD

CITY OF CAMBRIDGE

COMMUNITY DEVELOPMENT DEPARTMENT

2014



▲ STORAGE PLAY POD WITH LOOSE PARTS

