

# Virtual Meeting Instructions

- Working group members may speak and show webcam video
  - Use "Raise Hand" button during discussion
  - Click on "Reactions" or "Participants" then "Raise hand"
- Members of the public are muted and cannot show webcam video
- Public can write questions or ask for assistance in Q&A Window
  - Questions may be submitted at any time and project staff will address, as time allows, during discussion/comment periods
- Participants will be removed for inappropriate behavior
- **Technical support** – Andy Reker / areker@cambridgema.gov

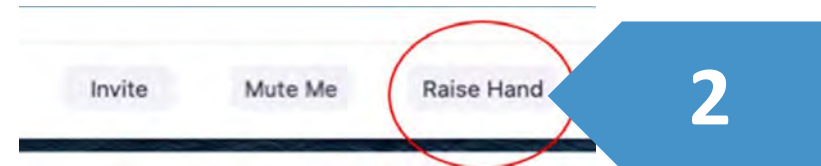

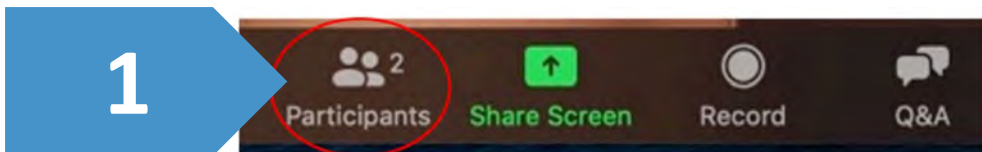



CITY OF CAMBRIDGE  
**GRAND JUNCTION MULTI-USE PATH DESIGN PROJECT**  
**WORKING GROUP #6 – MARCH 2, 2021**





# MEETING AGENDA

## Welcome!

- Introductions and Welcome
- Virtual Meeting Instructions
- Project Updates
- Overview of StoryMap Feedback
- Design Themes
- Pocket Parks
- Working Group Discussion
- Public Comment
- Next Steps

## Virtual Meeting Instructions

- Working group members may speak and show webcam video
  - Use "Raise Hand" button during discussion
- Members of the public are muted and cannot show webcam video
- Public can write in questions or ask for assistance in Q&A Window
  - Questions may be submitted at any time and will be addressed, as time allows, during discussion/comment periods
- Participants will be removed for inappropriate behavior
- Technical support / Andy Reker (areker@cambridgema.gov)

Bottom  
Panel of  
Zoom Screen

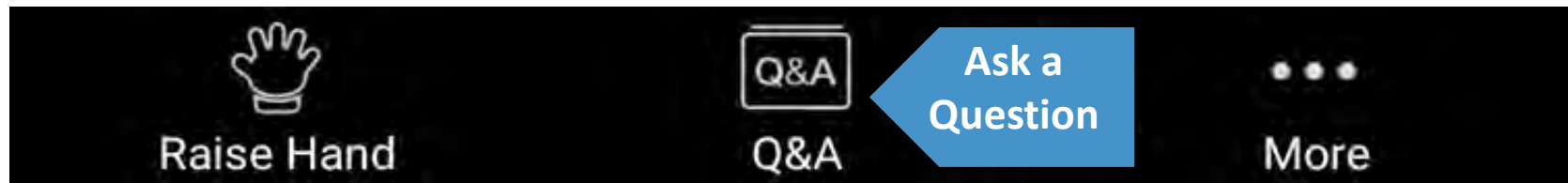



# PROJECT UPDATES

# Current Status and Next Steps

- Project team has evaluated 25% Open House feedback
- Reviewing design direction with GJ Advisory Committee (Tonight!)
- Initial review by MassDOT and MBTA was positive with more detailed comments to come
- MIT providing initial comments
- Additional coordination with Alexandria Real Estate and other entities as needed
- Design is moving toward 75% design

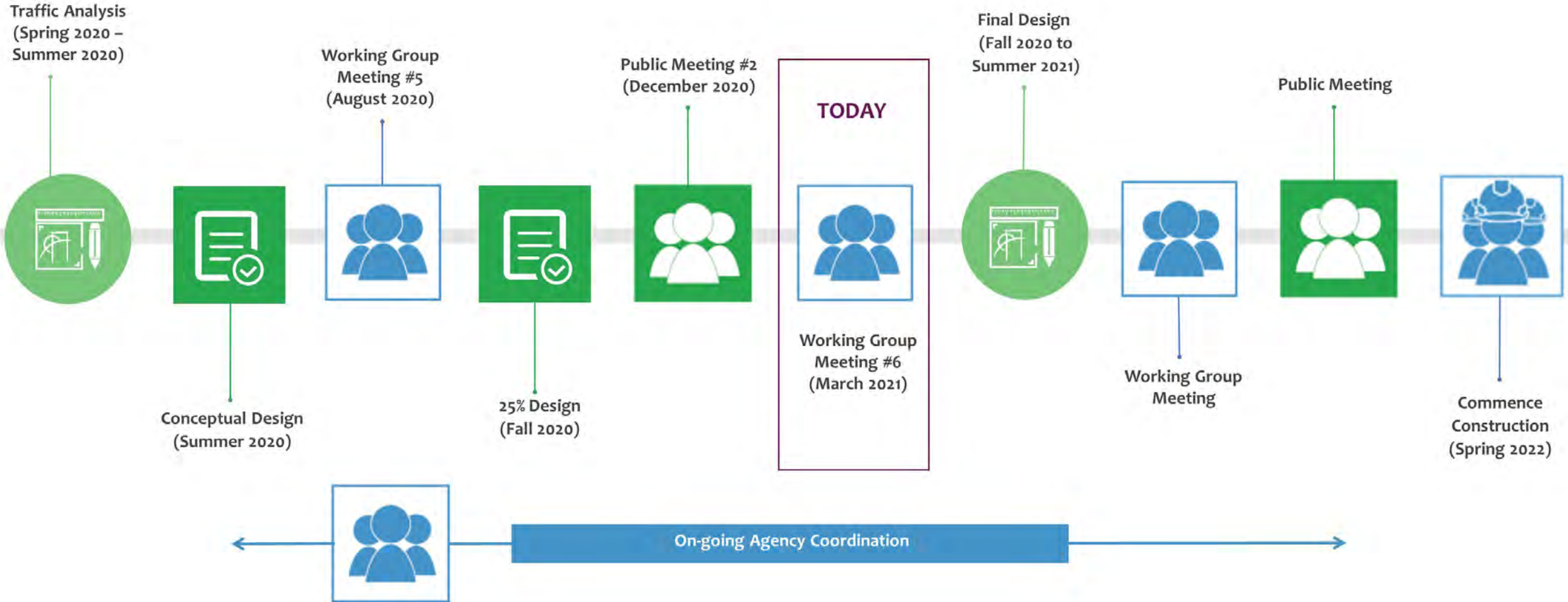





# OVERVIEW OF STORYMAP FEEDBACK

# STORYMAP ENGAGEMENT

## StoryMap/Open House Overview

Open for One Month

December 2020

Sunday	Monday	Tuesday	Wednesday	Thursday	Friday	Saturday
		1	2	3	4	5
6	7	8	9	10	11	12
13	14	15	16	17	18	19
20	21	22	23	24	25	26
27	28	29	30	31		

January 2021

Sunday	Monday	Tuesday	Wednesday	Thursday	Friday	Saturday
					1	2
3	4	5	6	7	8	9
10	11	12	13	14	15	16
17	18	19	20	21	22	23
24 31	25	26	27	28	29	30



## POSITIVE FEEDBACK

Can't wait for this to be in place...  
...an amazing plan.

...would be tremendously excited if this project came to fruition.

I appreciate this so so so much.

... extremely excited to see this. ... so thrilled to see the work proposed.

Makes me happy and proud to live in Cambridgeport.

...appreciate all the time and research and effort that has gone into making this a terrific multi-use path.

This will be a tremendous improvement, thank you.

Thank you for all your hard work in making this project a reality!

...so impressive. ...looking forward to using this path...

...more youth will ride bikes!!!



# DESIGN THEMES



## KEY THEMES

- People would like street crossings with the path to be intuitive and incorporate elements to improve comfort and visibility
- People would like to see more separation between people biking and people walking
- People would like the path to tie into other regional walking and biking facilities
- In general people want good neighborhood connections but mixed opinions on where and how
- People desire path amenities (lighting, art, landscaping)

# INTUITIVE AND ENHANCED CROSSINGS

People would like street crossings to be intuitive with elements to improve comfort and visibility





## Massachusetts Ave. Design Considerations

Consider relocation of northbound bus stop to north of Albany Street

Construct sidewalk level bicycle facilities on Mass Ave. that tie into planned protected intersections at Albany and Vassar Streets

Coordinate with MIT

Signalized path crossing coordinated with intersections

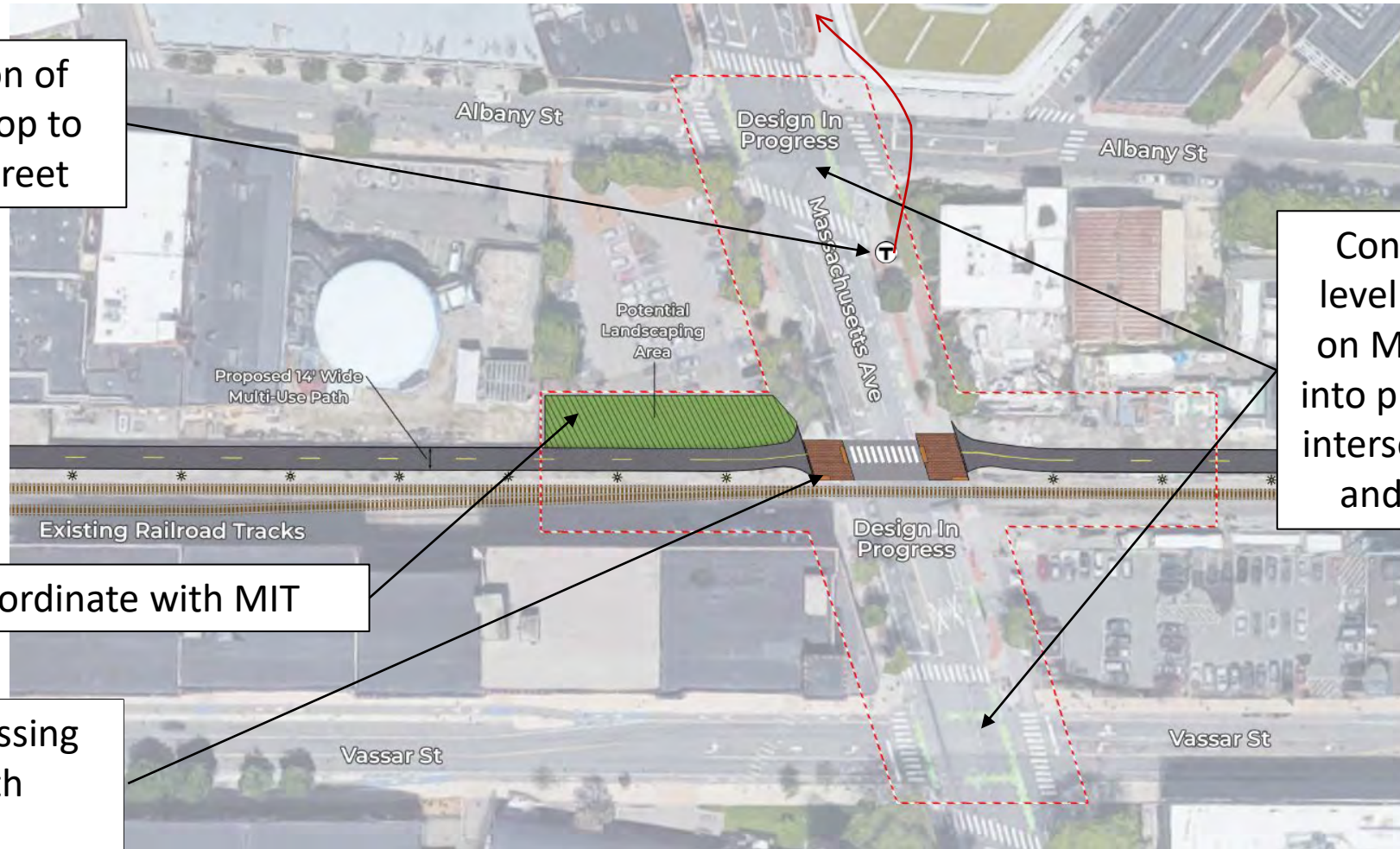

## Main Street Design Considerations

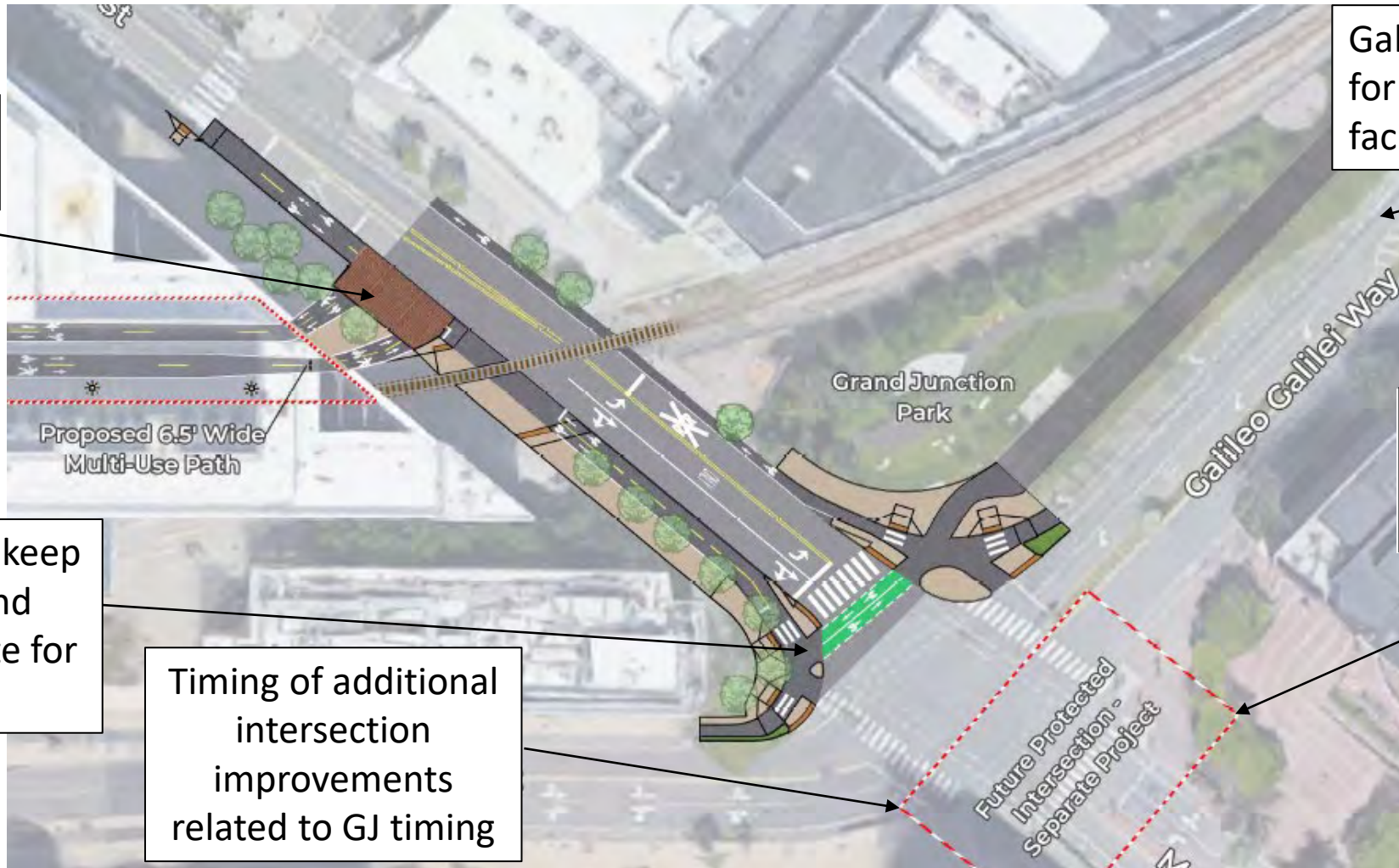

Mixing zone in northwest corner

Galileo Galilei Way plans for separated bicycle facility

Consideration to keep pedestrians and bicyclists separate for crossing

Timing of additional intersection improvements related to GJ timing

Project will tie into improvements made by others on east side



## Main Street Design Considerations

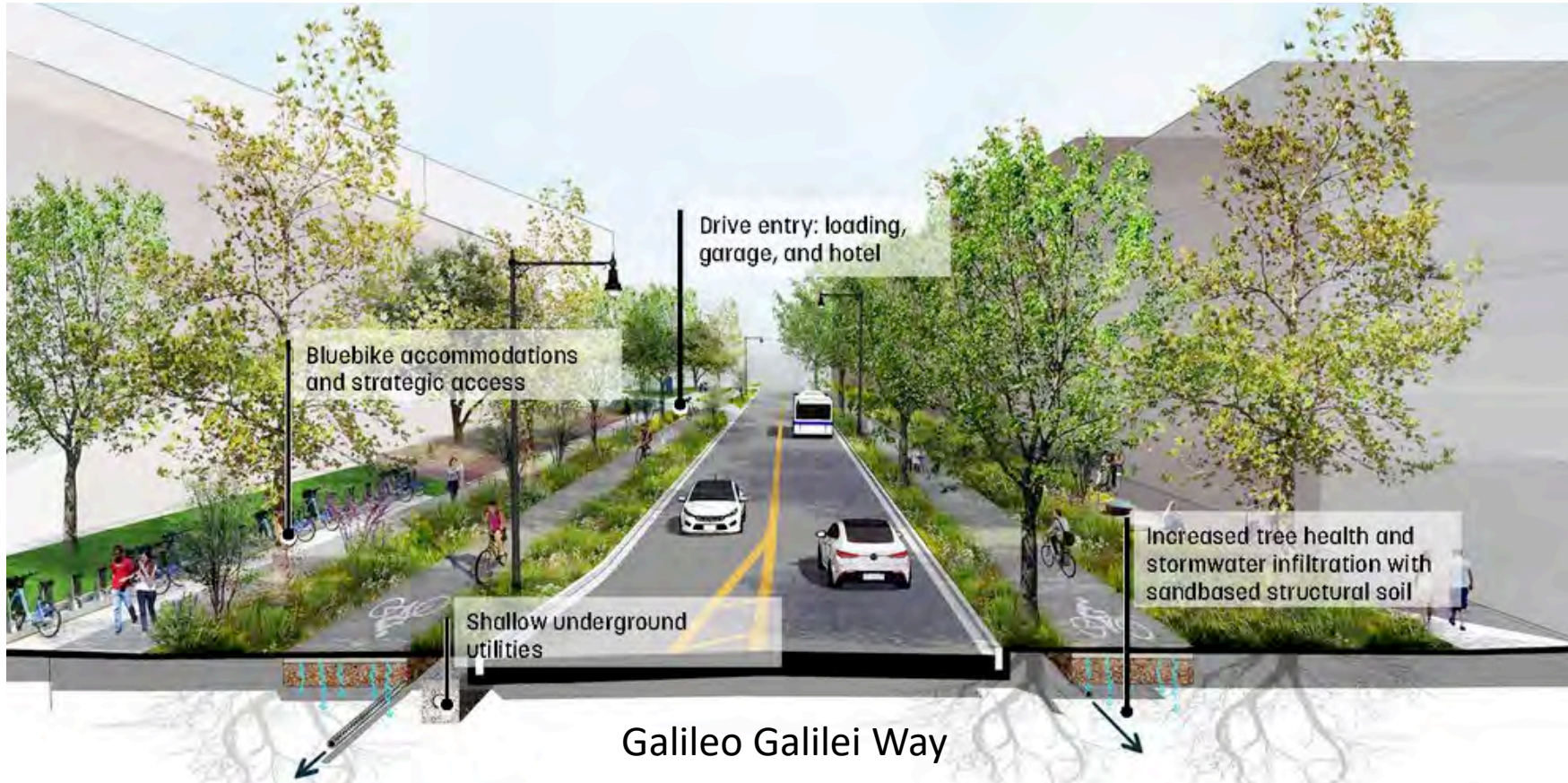

<https://www.cambridgeredevelopment.org/kendall-transportation>

## Binney Street Design Considerations

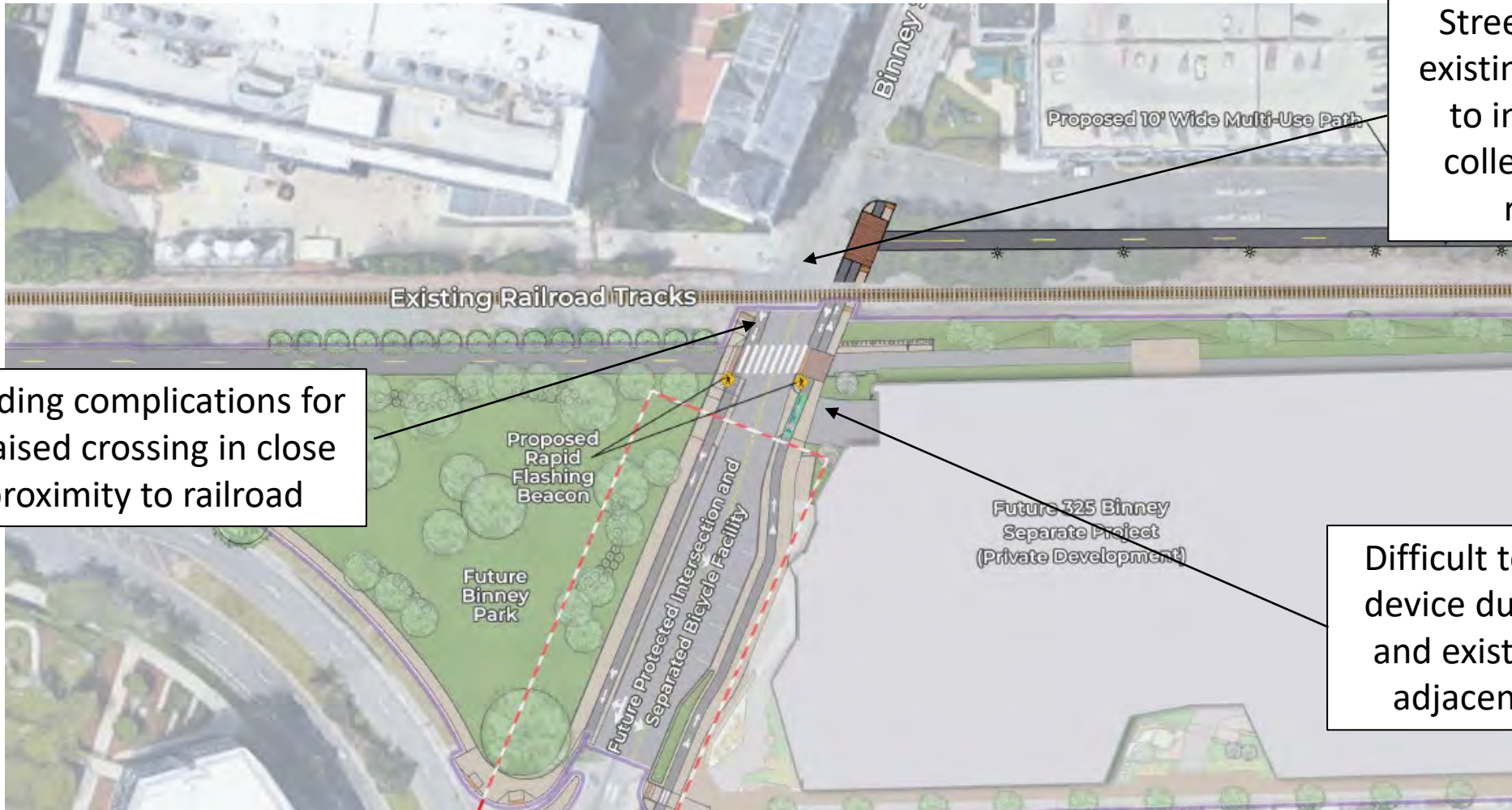

Street congested with existing utilities; difficult to install drainage to collect stormwater at raised device

Grading complications for a raised crossing in close proximity to railroad

Difficult to install raised device due to proposed and existing driveways adjacent to crossing



## Cambridge Street Design Considerations

- Pocket park design
- Free wall
- Circulation around tree
- Review northbound to westbound Cambridge Street access

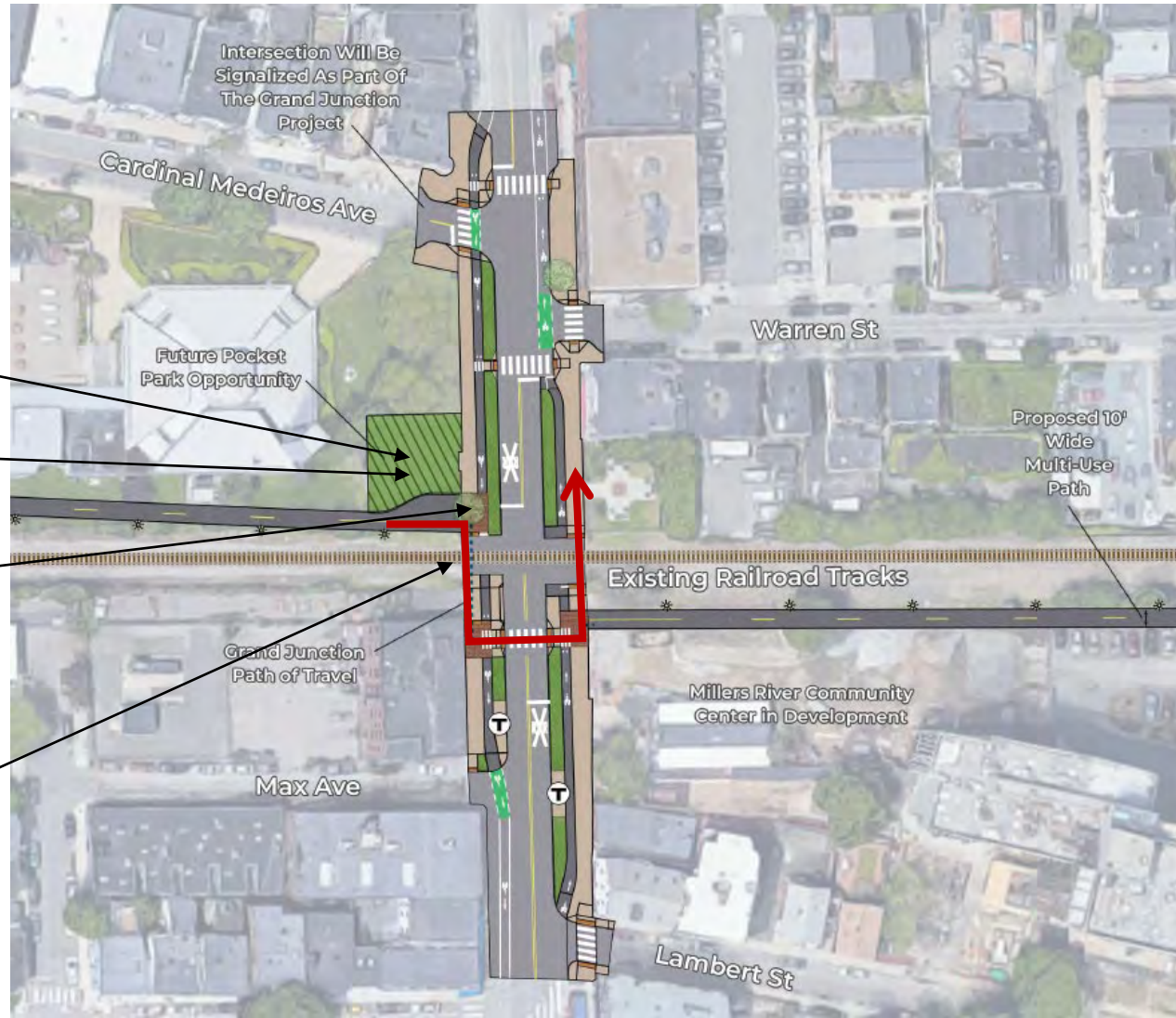

## Cambridge Street Crossing

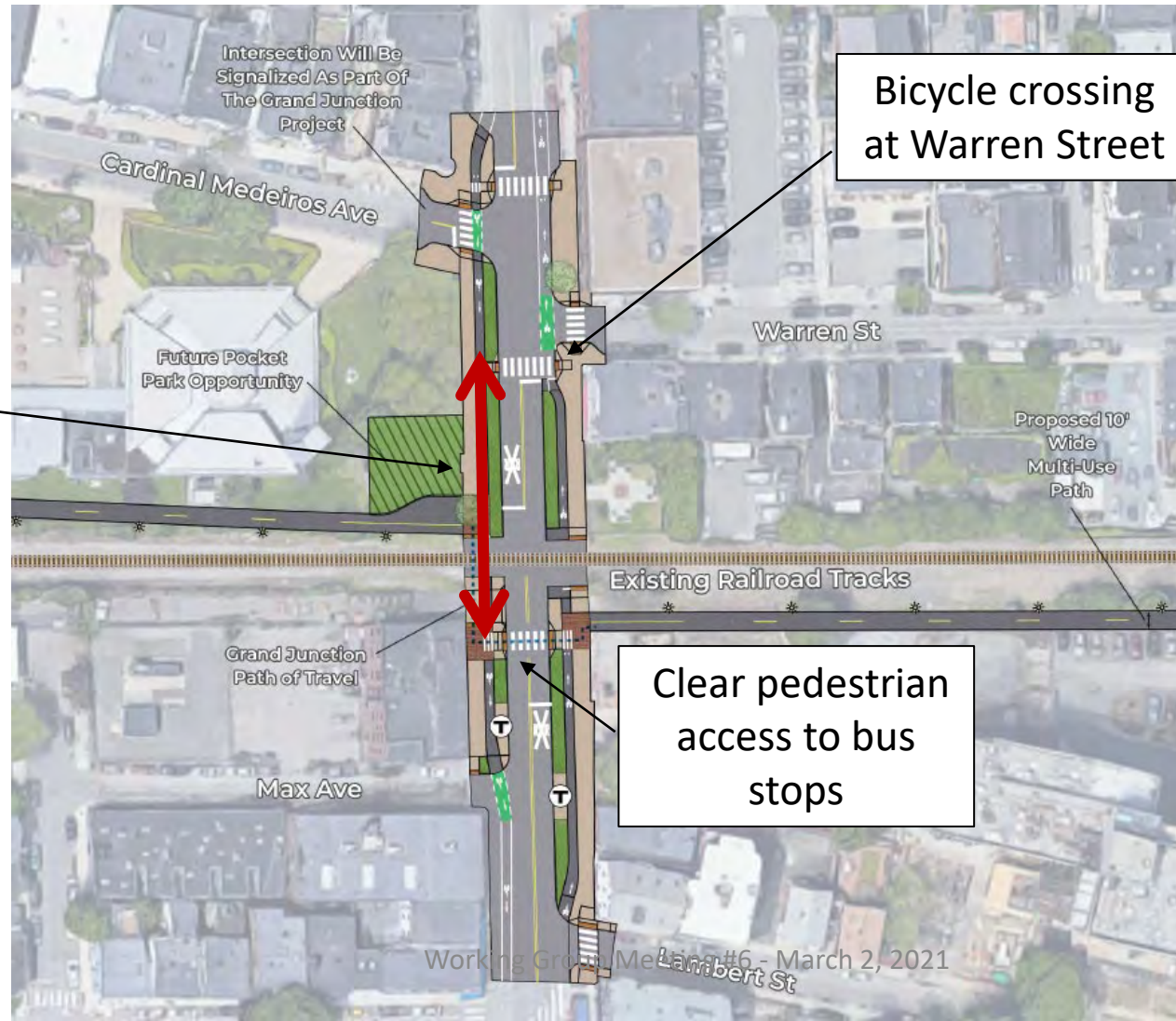

Two-way bicycle facility between multi-use path and Warren Street

Bicycle crossing at Warren Street

Clear pedestrian access to bus stops



# SEPARATION OF BICYCLES AND PEDESTRIANS

People would like to see separation when feasible between people biking and people walking



People would like the path to tie into other regional walking and biking facilities

**Legend**



<https://trailmap.mapc.org/>

**Southern Regional Connections**



**Northern Regional Connections**

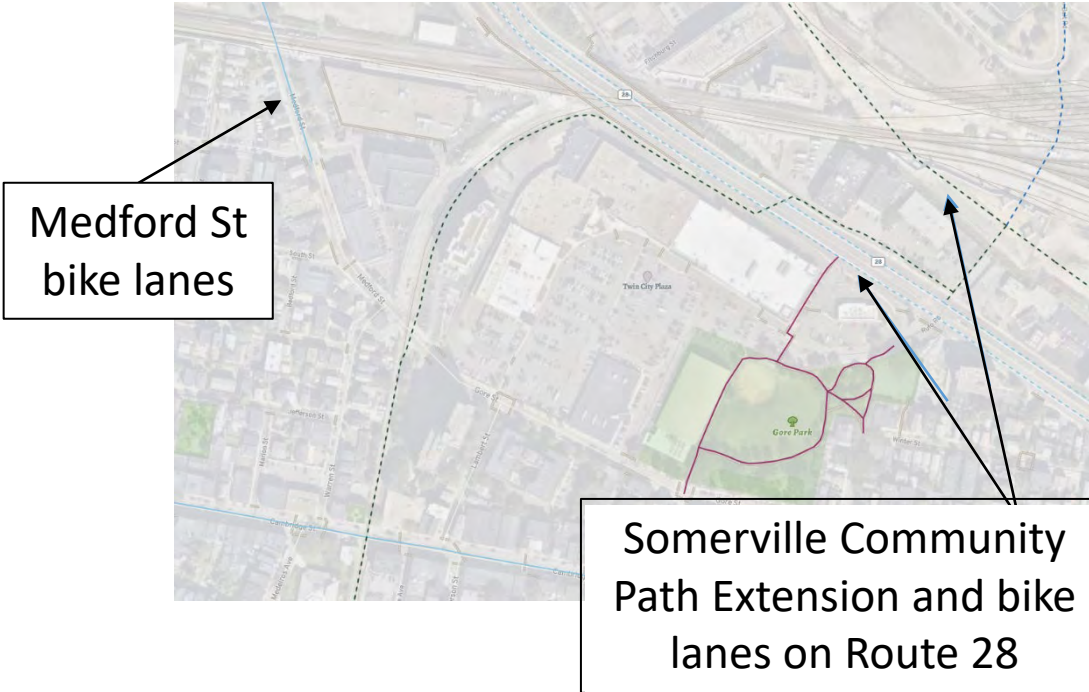



## Southern Path End at Waverly Street

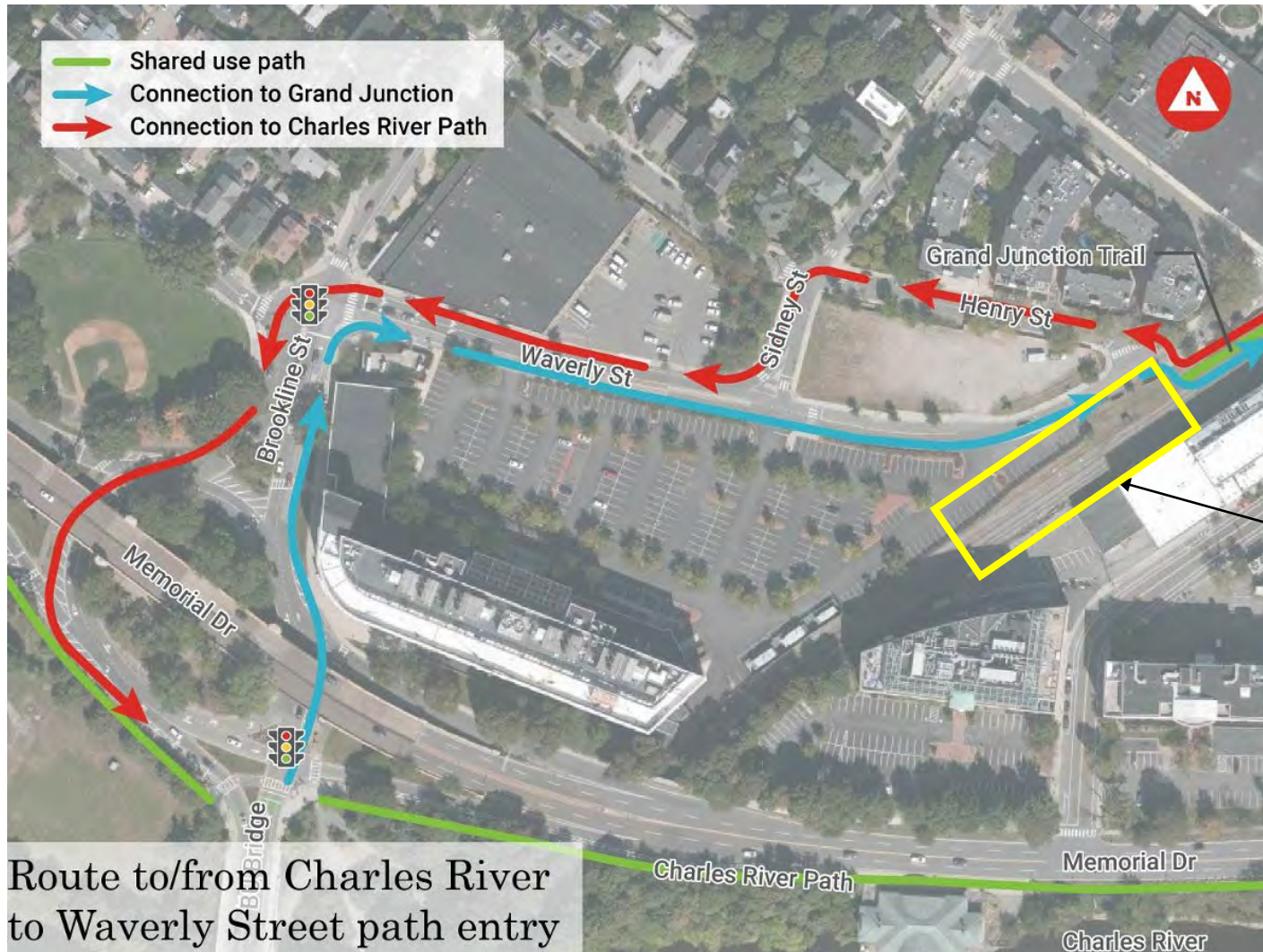

Shorter, protected connection to Charles River desired.

Continuing path directly to the River has challenges which will take additional time and funding to overcome.

Route to/from Charles River to Waverly Street path entry



## Connection to Charles River via Amesbury Street

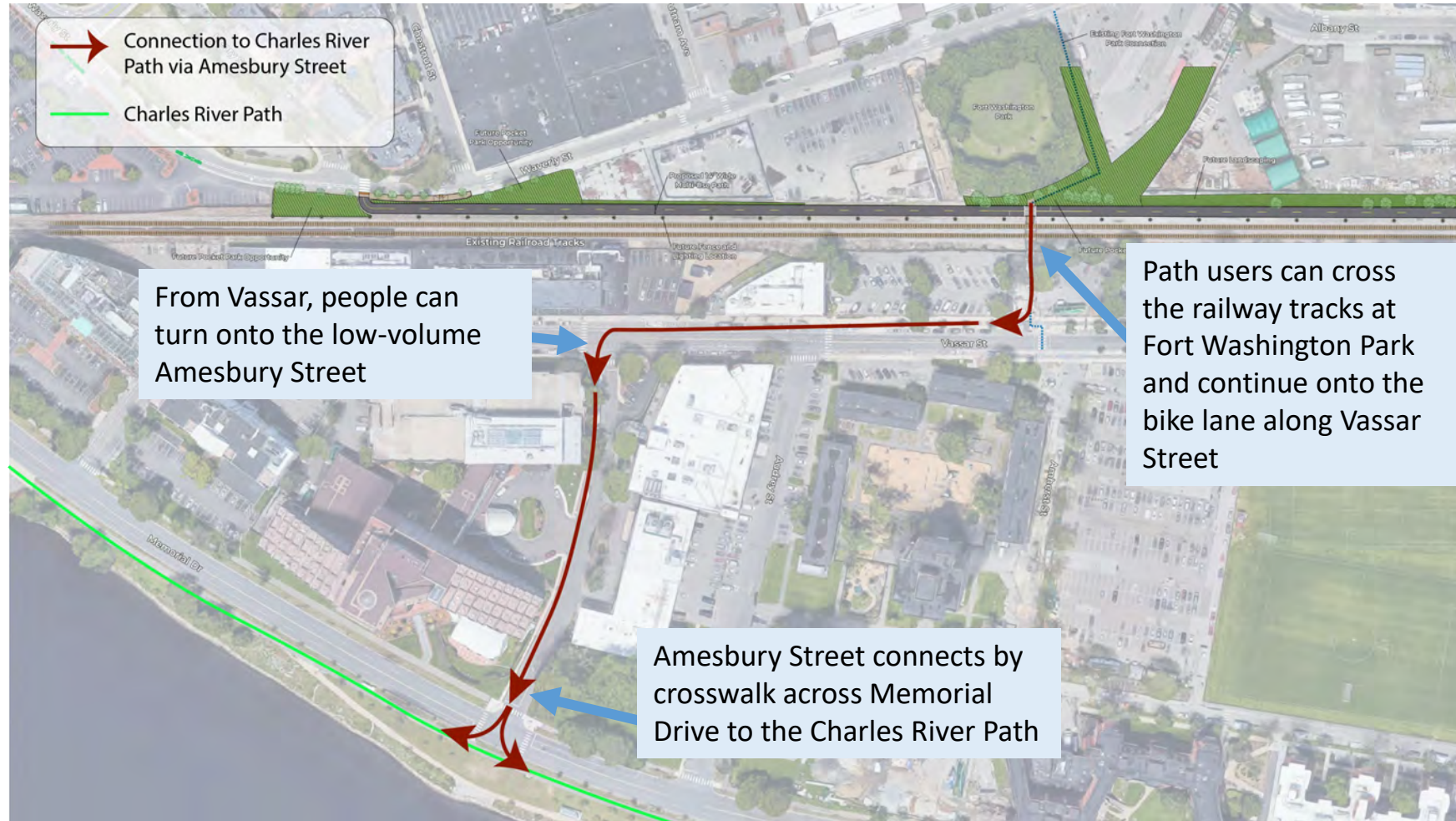



# Northern Path End at Gore Street

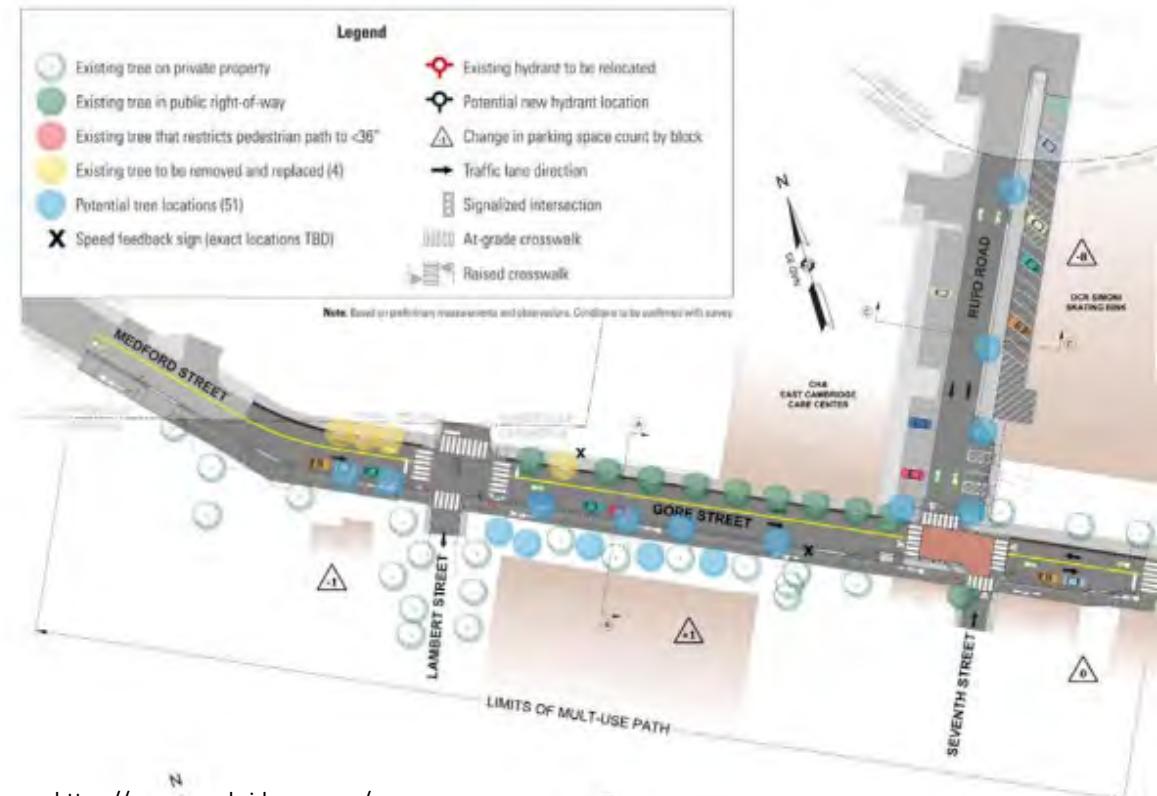
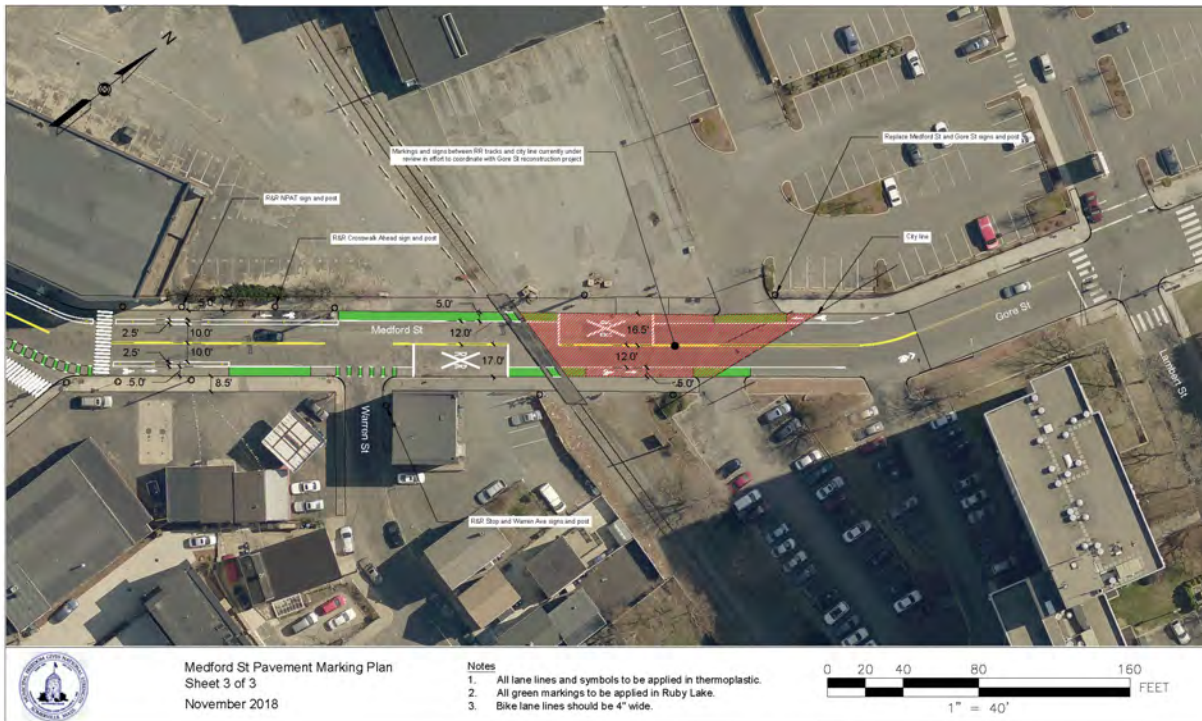



In general people want good neighborhood connections but mixed opinions on where and how





# NEIGHBORHOOD CONNECTIONS

## Existing and Proposed Connections and Crossings

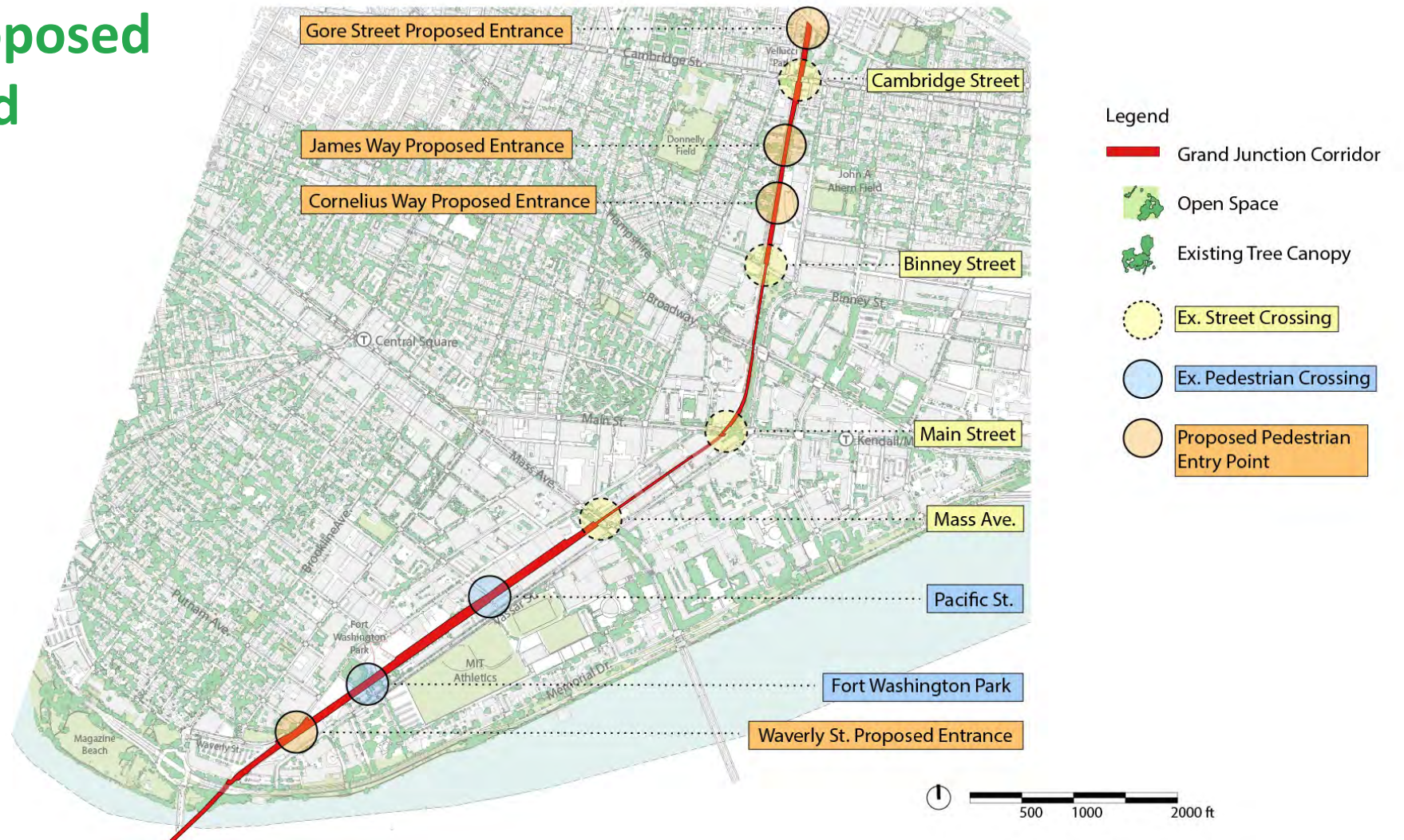







## Linden Park Neighborhood Design Considerations

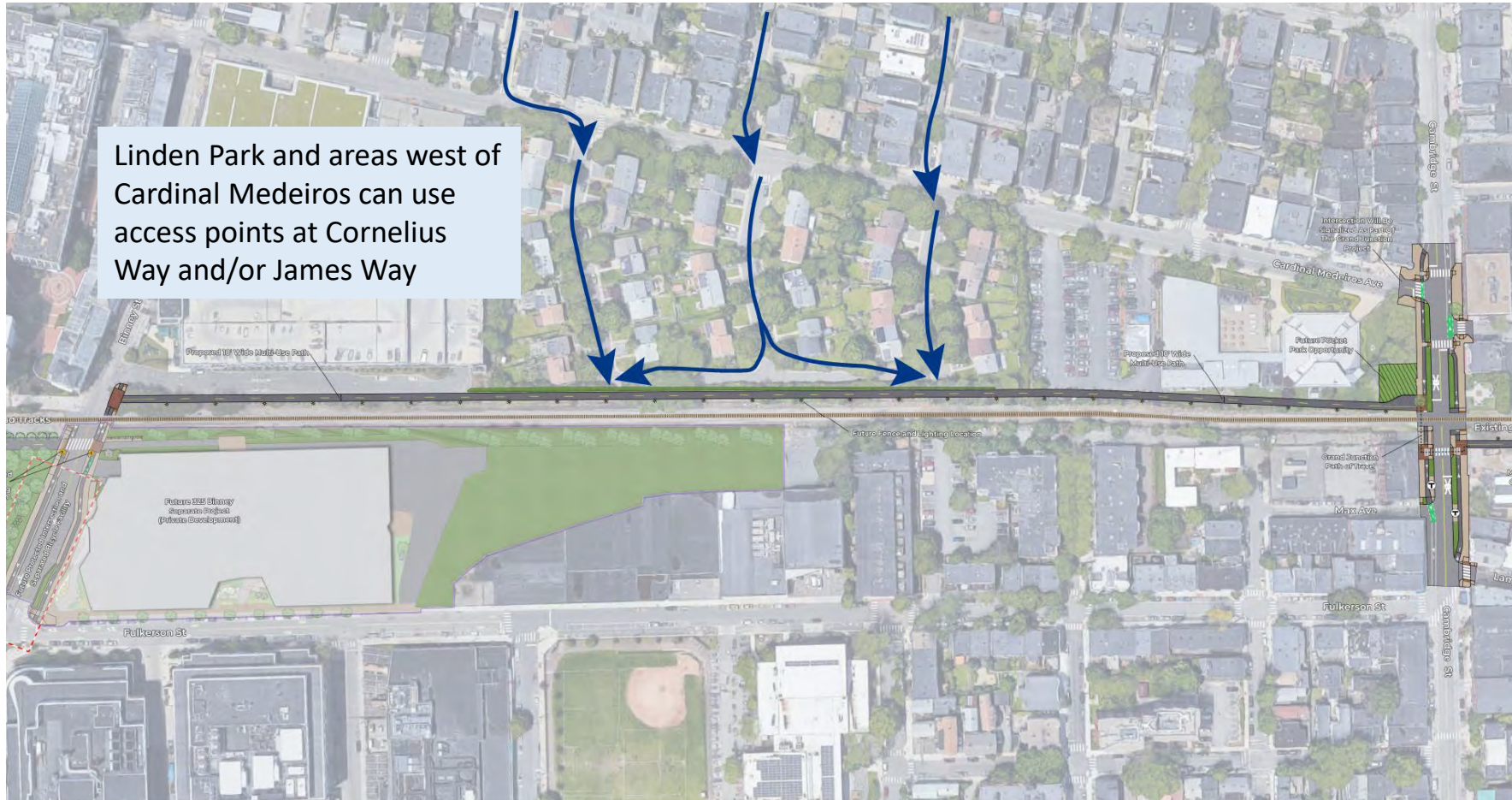







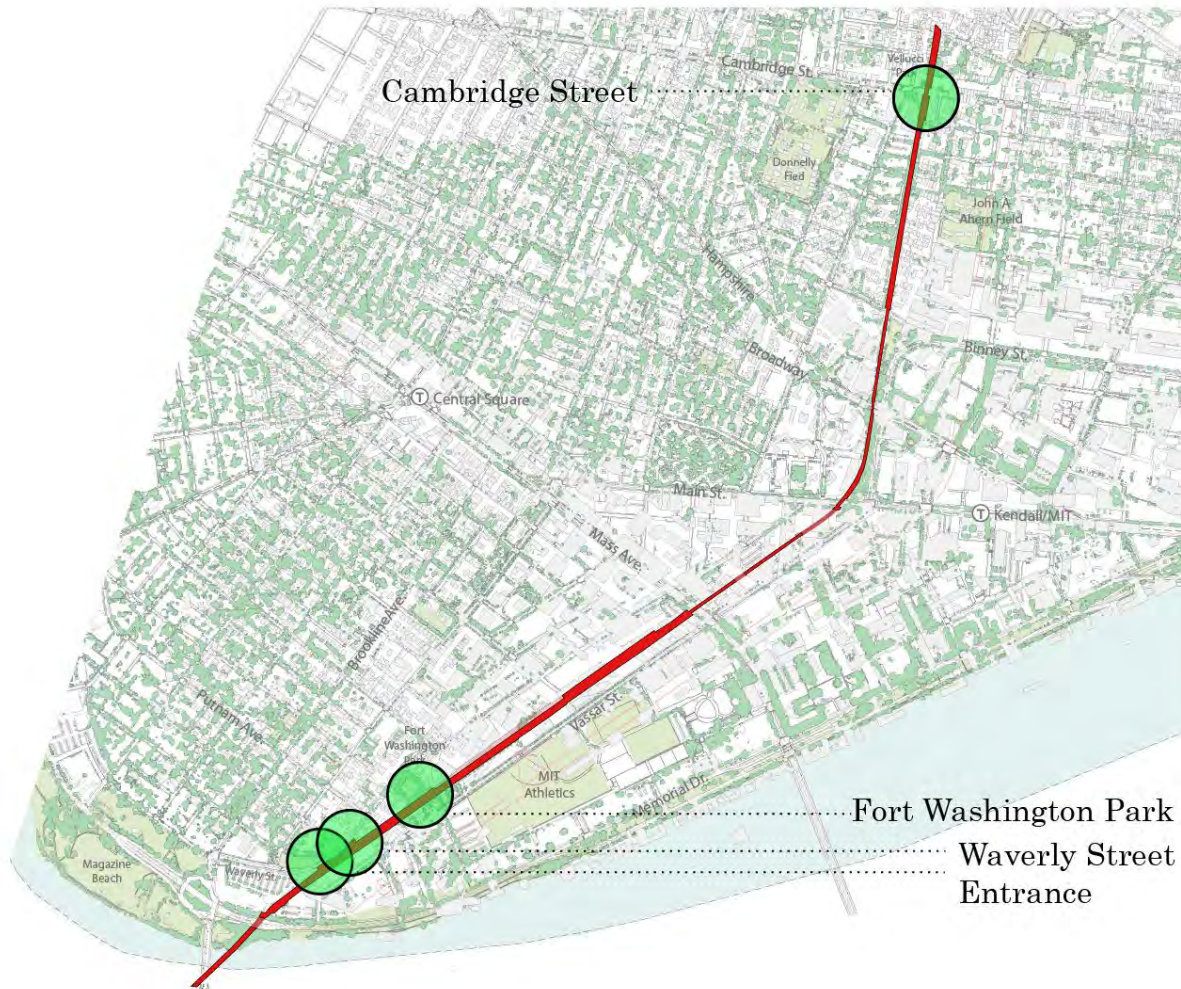

# POCKET PARKS

# POCKET PARK LOCATIONS



## Pocket Park Opportunities Along Grand Junction Multi-Use Path

### Legend

-  Grand Junction Corridor
-  Open Space
-  Existing Tree Canopy
-  Pocket Park Opportunity

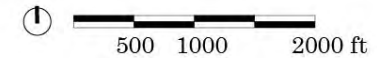



# SOUTHERN PATH END AT WAVERLY STREET

## Pocket Park Opportunity #1: Waverly Street

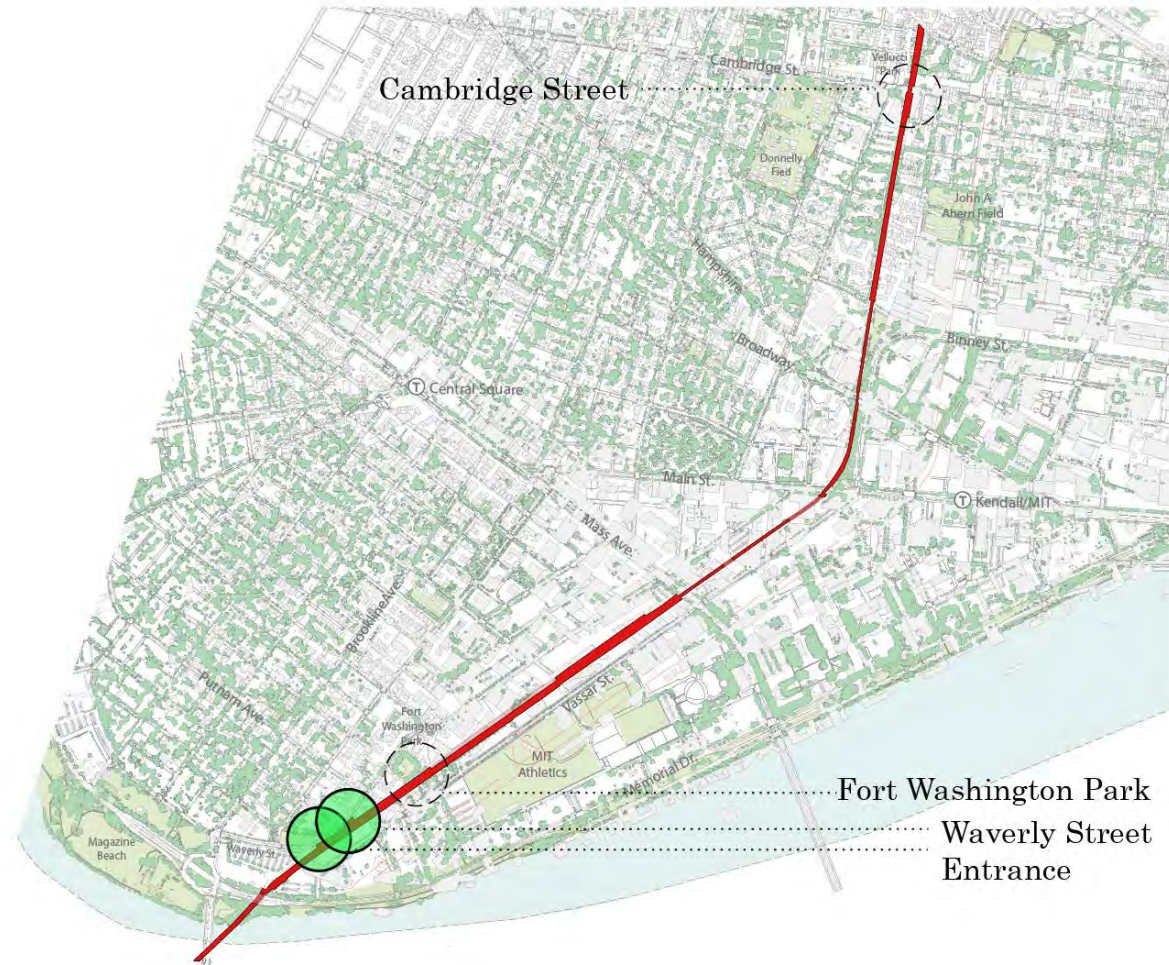



## Precedent Images: Landform and Microclimate



Introduced Landforms and Pathways



Introduced Landform



Planted Slope



Long Communal Bench



Bioswale Plantings



Bioswale Tree Plantings



# SOUTHERN PATH END AT WAVERLY STREET

## Pocket Park Design: Plan View

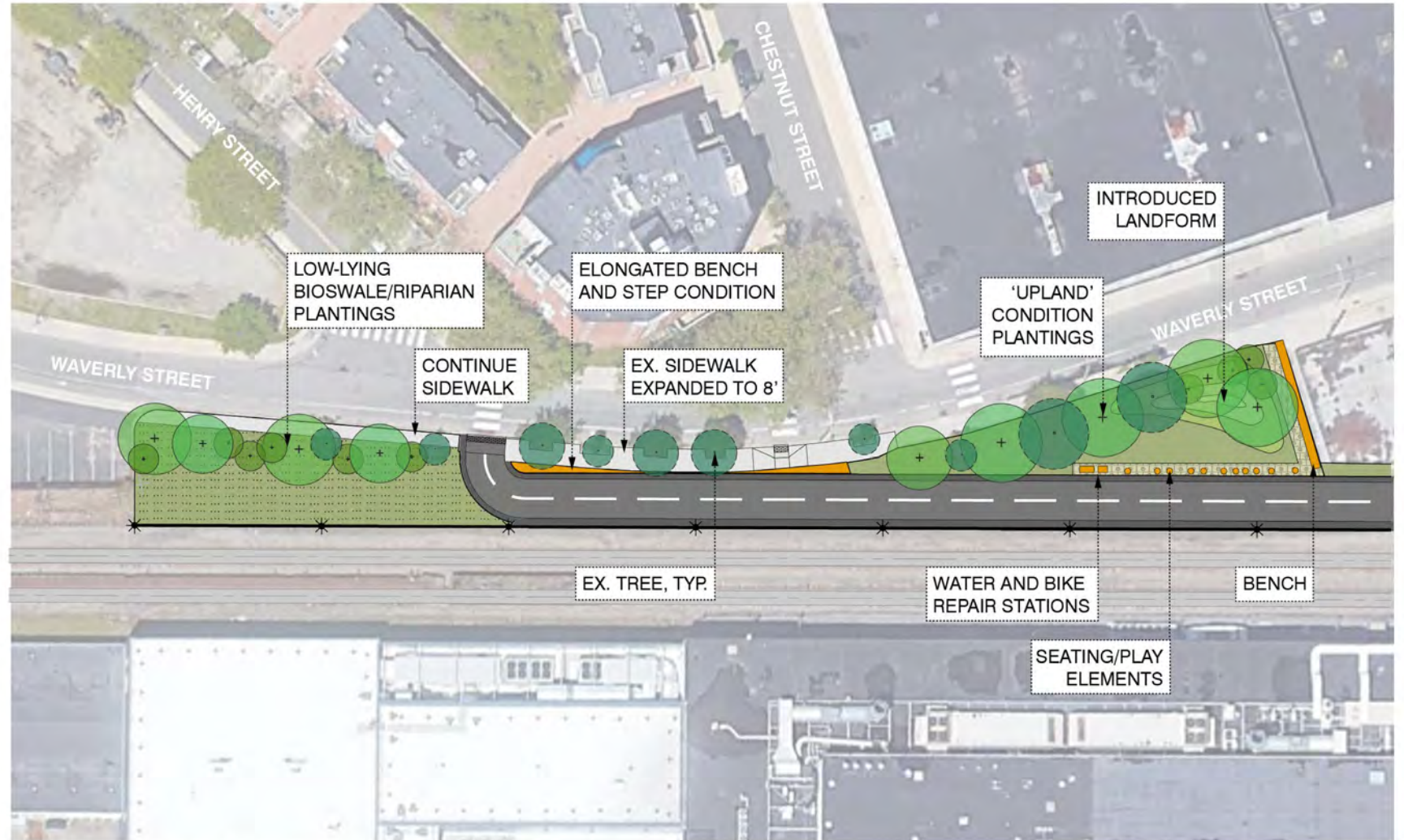

# SOUTHERN PATH END AT WAVERLY STREET

## Pocket Park Design: Plan View

- Room for Future Path Extension

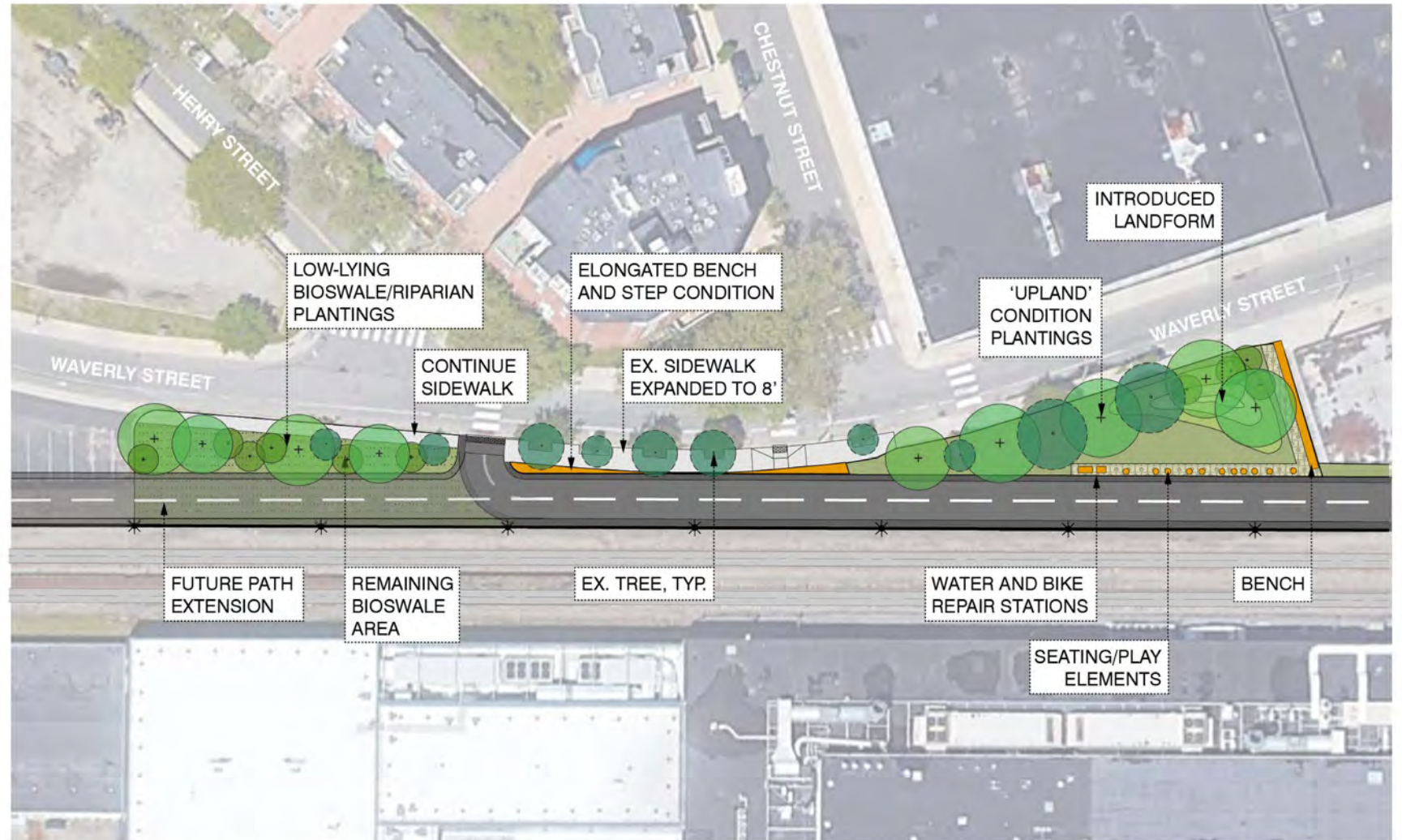



# SOUTHERN PATH END AT WAVERLY STREET

## Pocket Park Design: Cross Sections

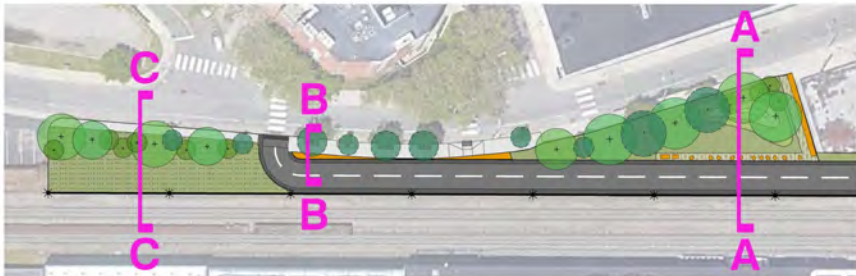
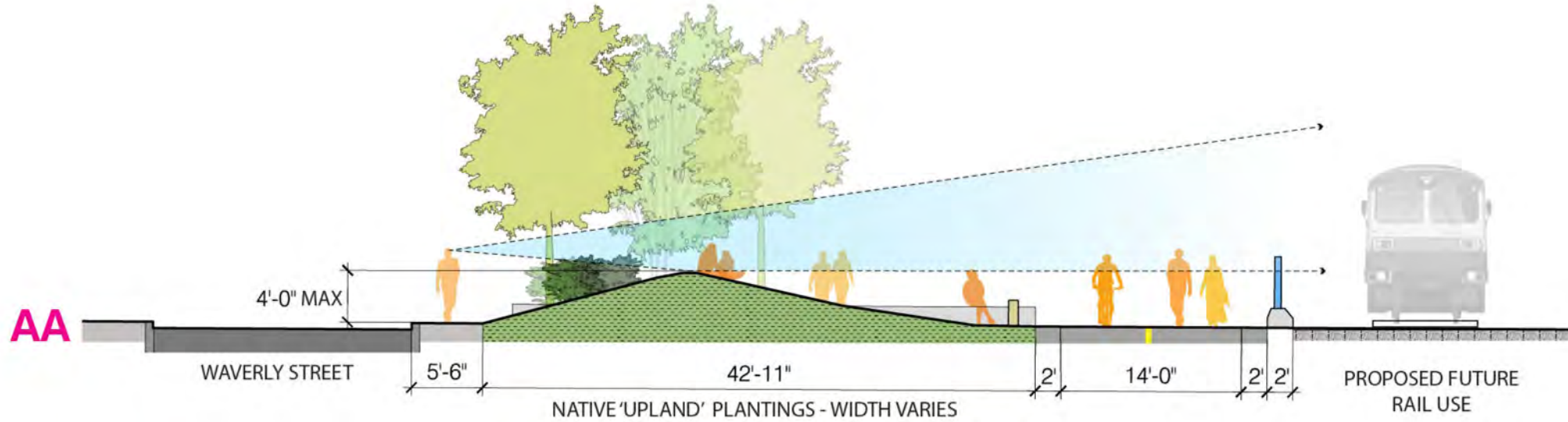

# SOUTHERN PATH END AT WAVERLY STREET

## Pocket Park Design: Cross Sections

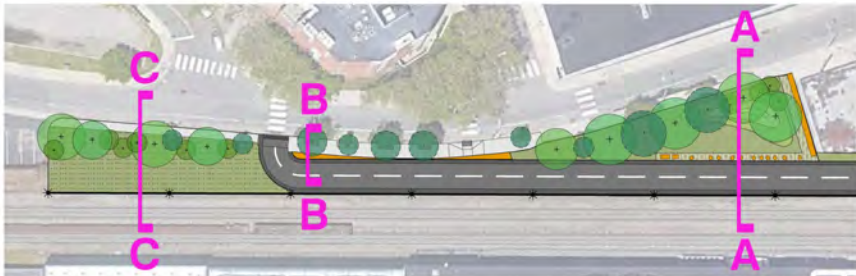
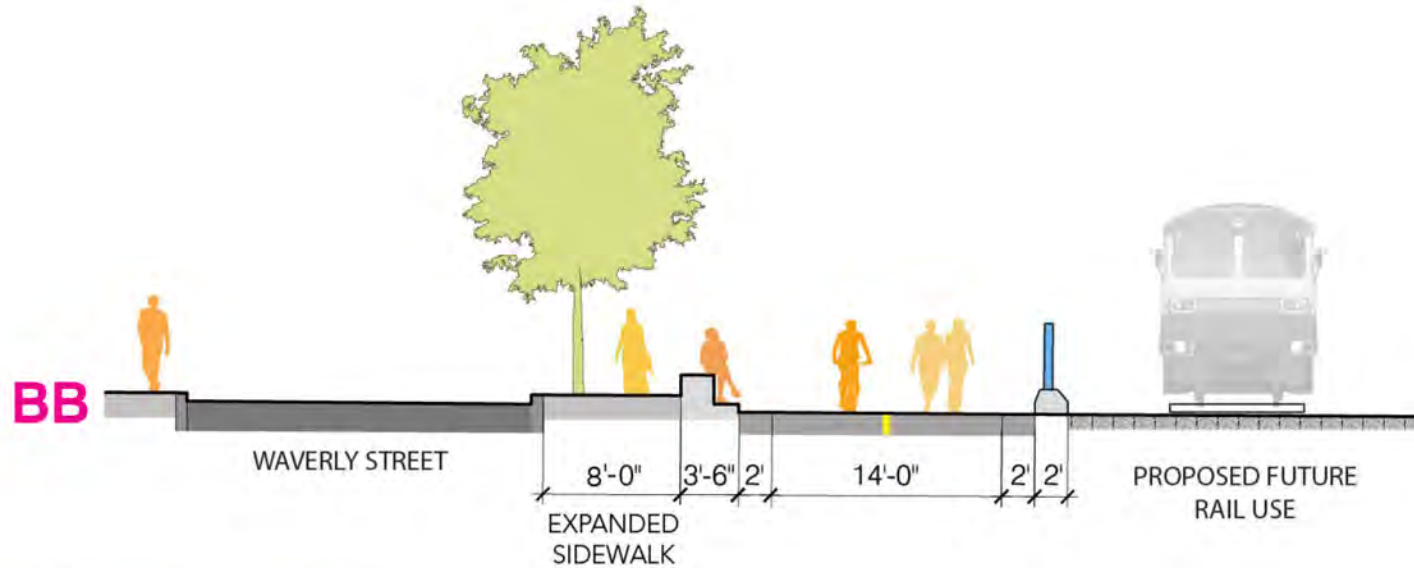

# SOUTHERN PATH END AT WAVERLY STREET

## Pocket Park Design: Cross Sections

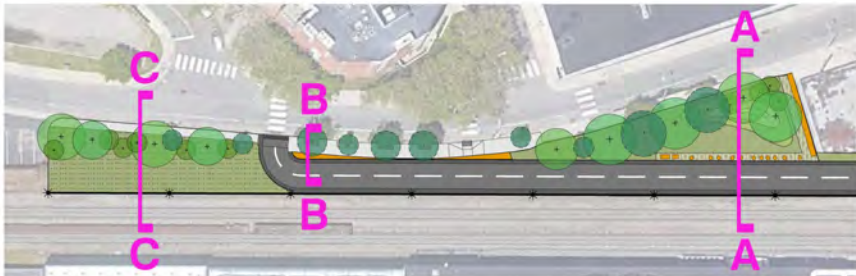
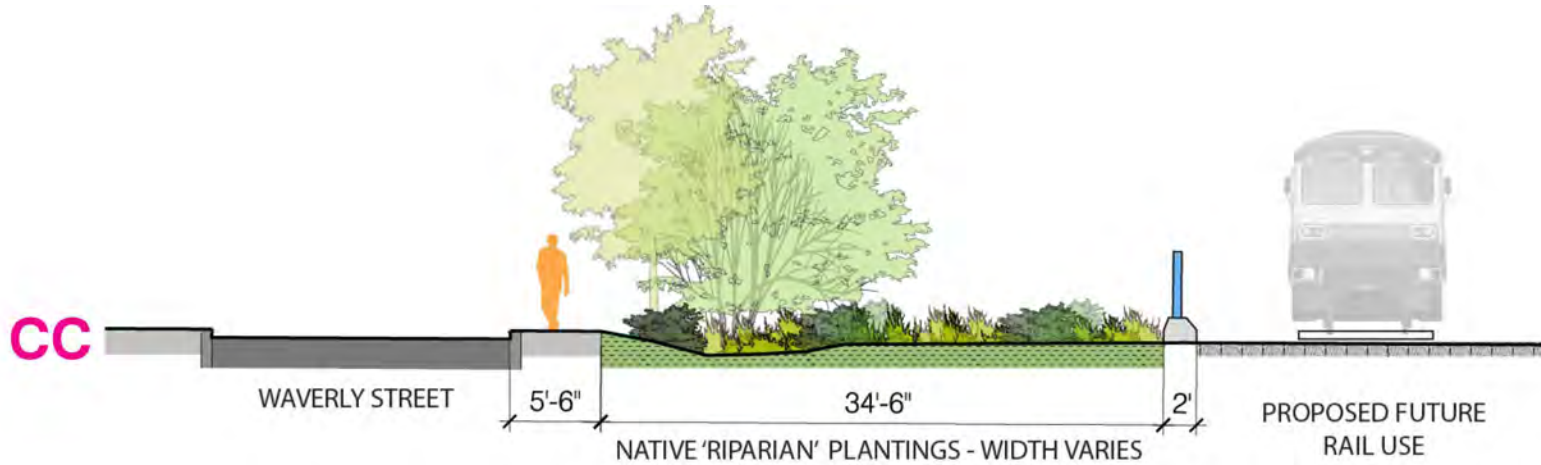



# CONNECTION AT FORT WASHINGTON PARK

## Pocket Park Opportunity #2: Fort Washington Park

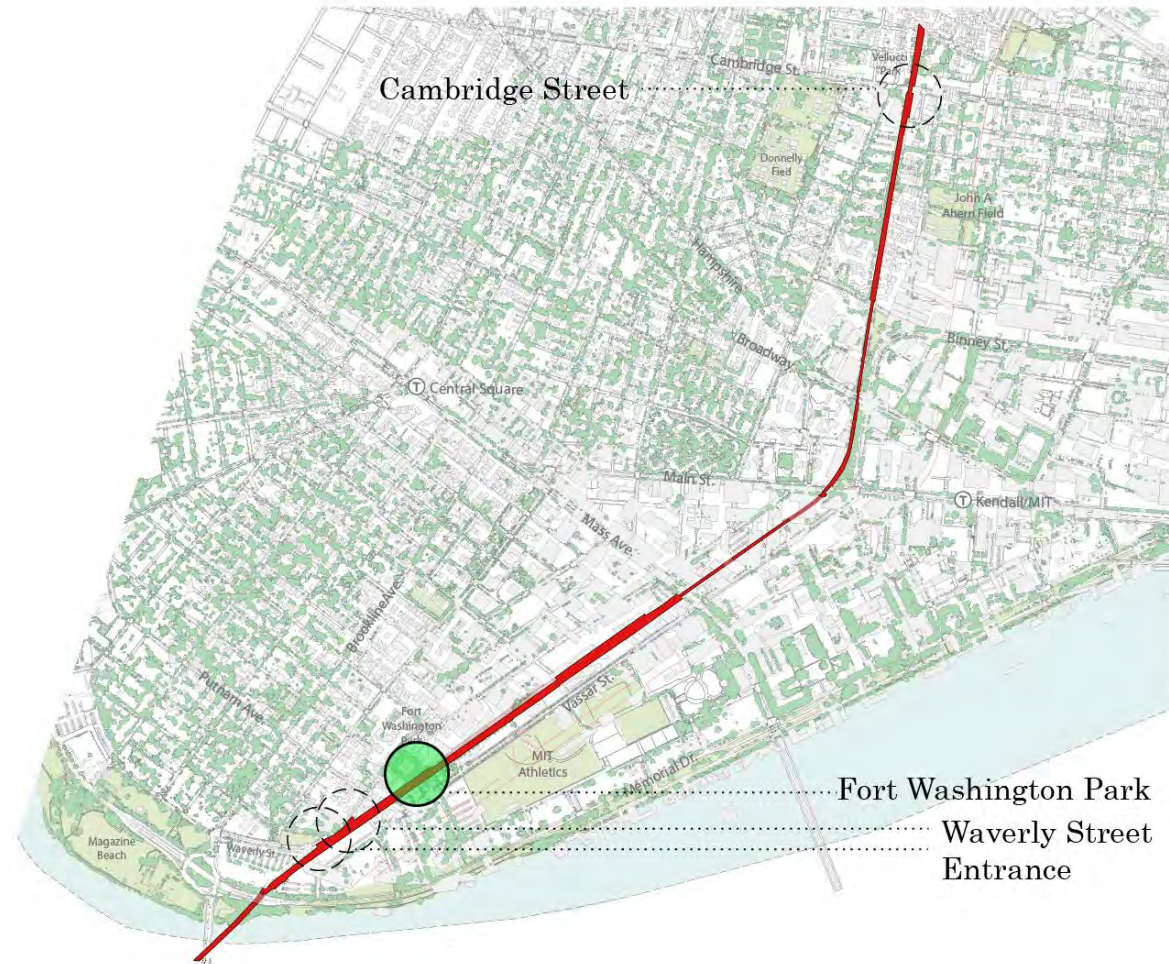



## Precedent Images: Historical Context and Connectivity



Existing Brick at Fort Washington Park



Paved Pedestrian Allee



Brick-Paved Pedestrian Path



Movable Tables and Chairs



Multi-Use Path Divided With Plantings



Multi-Use Path with Edge Plantings



# CONNECTION AT FORT WASHINGTON PARK

## Pocket Park Design Option 1: Path-side Plaza



SCALE: 1" = 40'-0"



# CONNECTION AT FORT WASHINGTON PARK

## Pocket Park Design Option 2: Mass Plantings



SCALE: 1" = 40'-0"



# CAMBRIDGE STREET POCKET PARK DESIGN

## Pocket Park Opportunity #3: Cambridge Street





# CAMBRIDGE STREET POCKET PARK DESIGN

## Precedent Images: Arts and Gathering



Graffiti Alley - Central Square



Free Wall



Perforated Masonry Wall



Urban Grove



Communal Bench and Permeable Paving



Low Stone Wall of Neighboring Property



# CAMBRIDGE STREET POCKET PARK DESIGN

## Pocket Park Design Option 1: Art Gallery Scheme with Bluebike Station

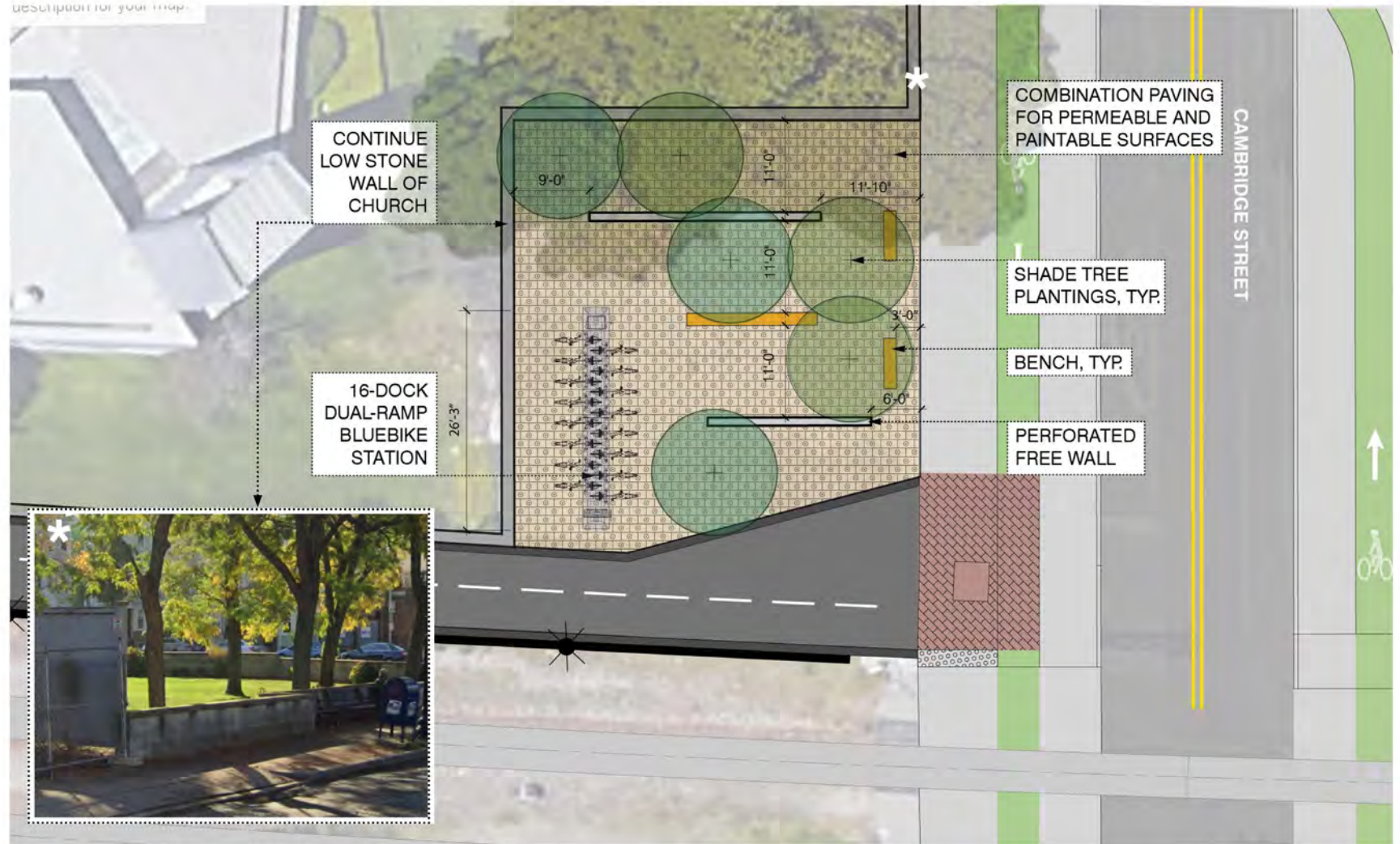

# CAMBRIDGE STREET POCKET PARK DESIGN

## Pocket Park Design Option 1: Art Gallery Scheme Cross Sections

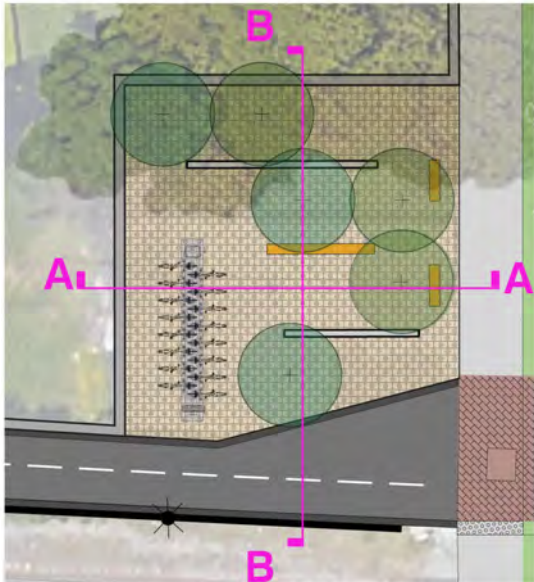

**AA**

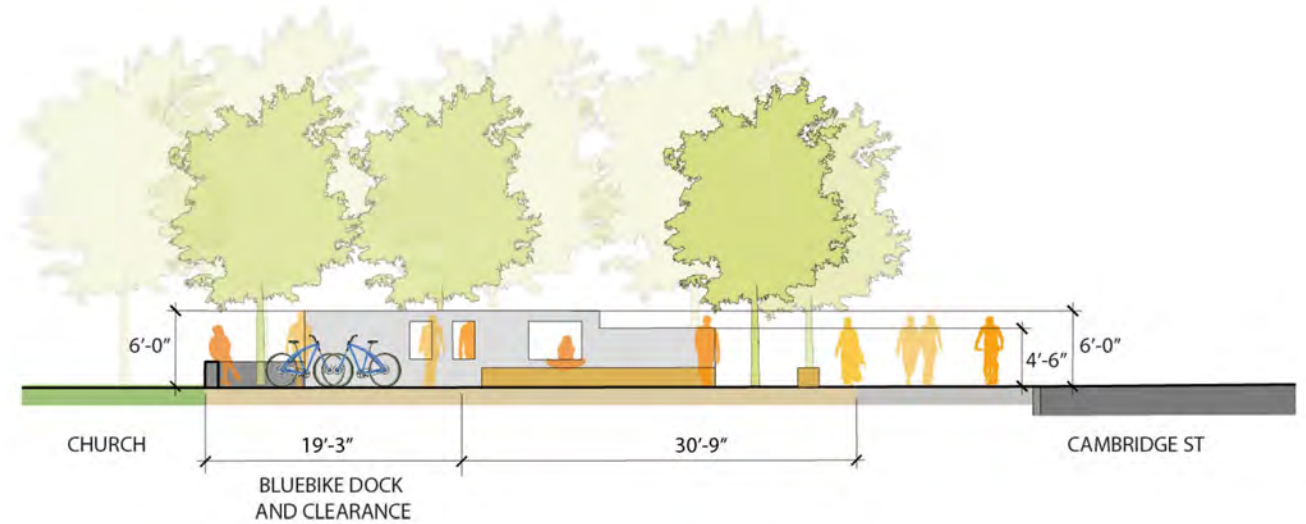

**BB**

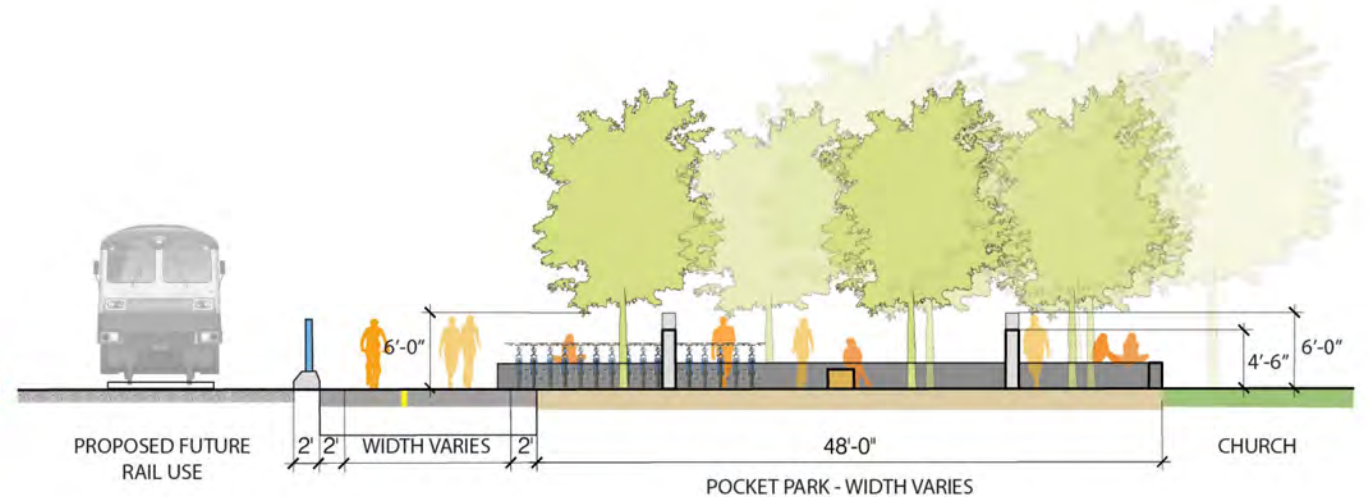



# CAMBRIDGE STREET POCKET PARK DESIGN

## Pocket Park Design Option 2: Green Alley Scheme

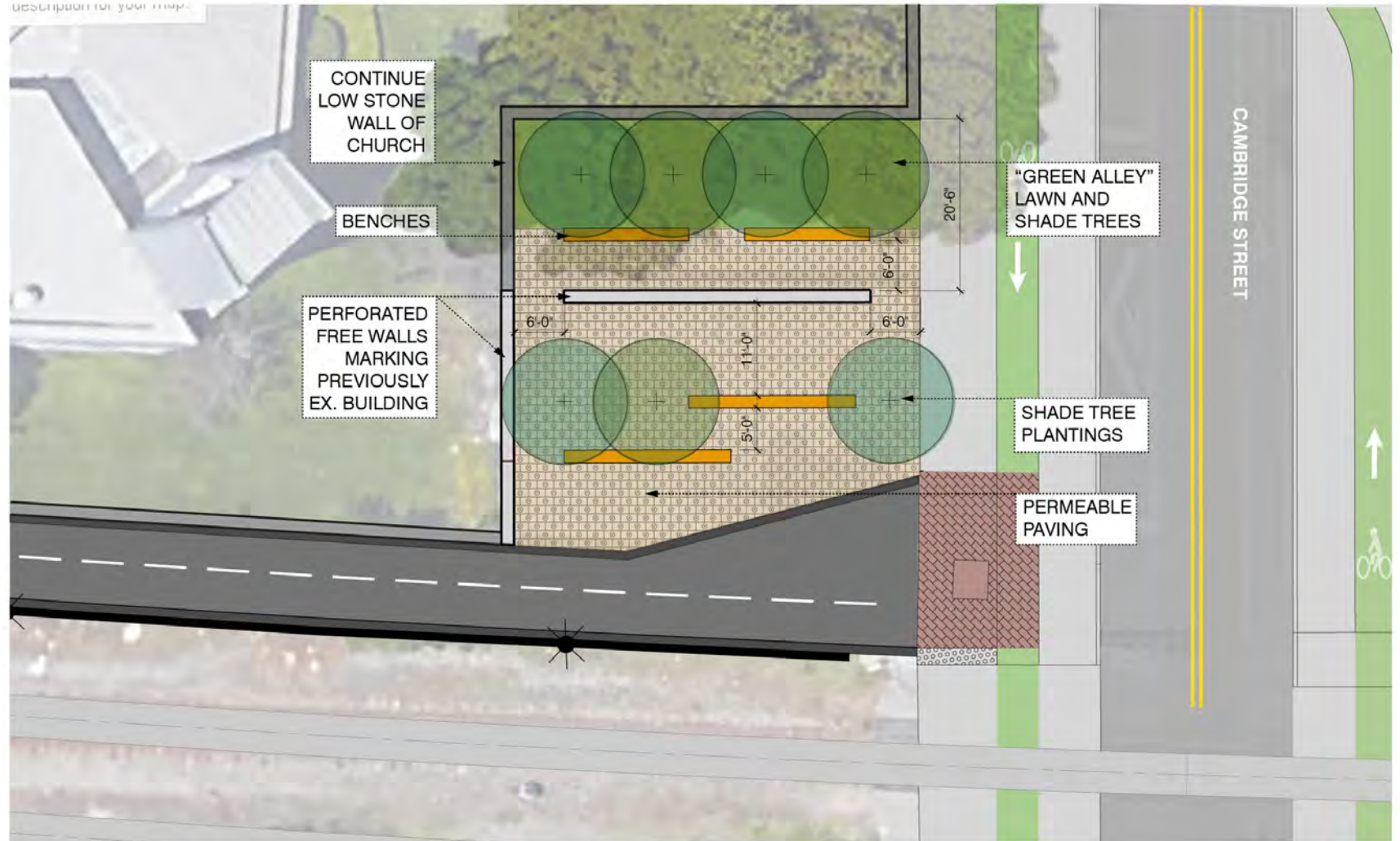

# CAMBRIDGE STREET POCKET PARK DESIGN

## Pocket Park Design Option 2: Green Alley Scheme Cross Sections

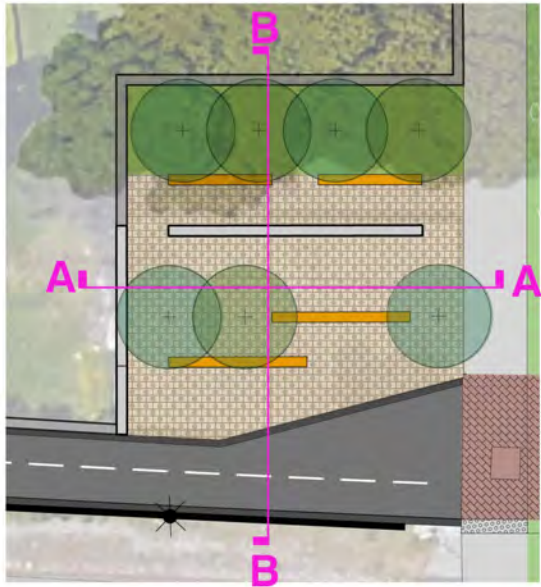

**AA**

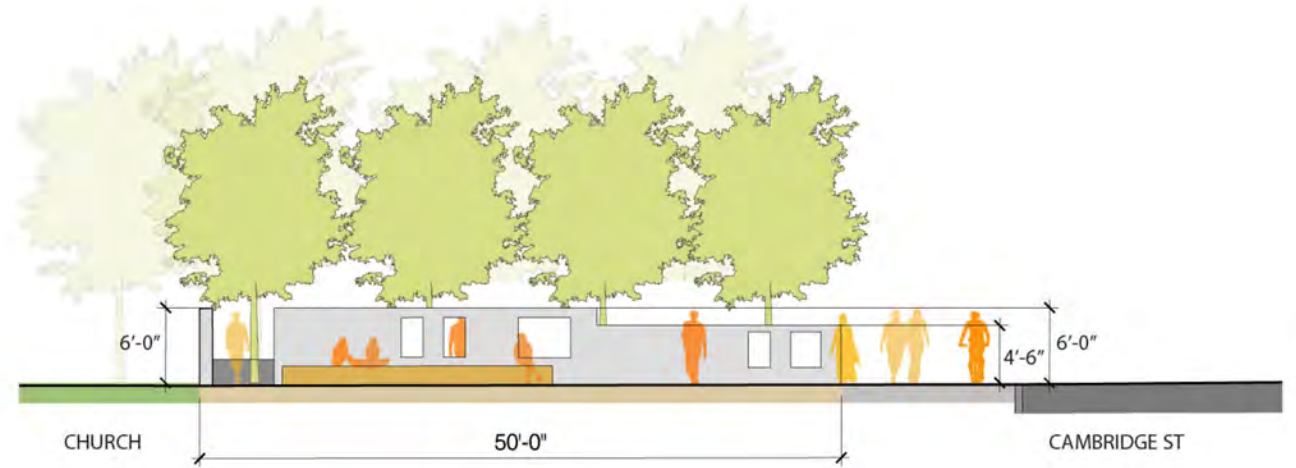

**BB**

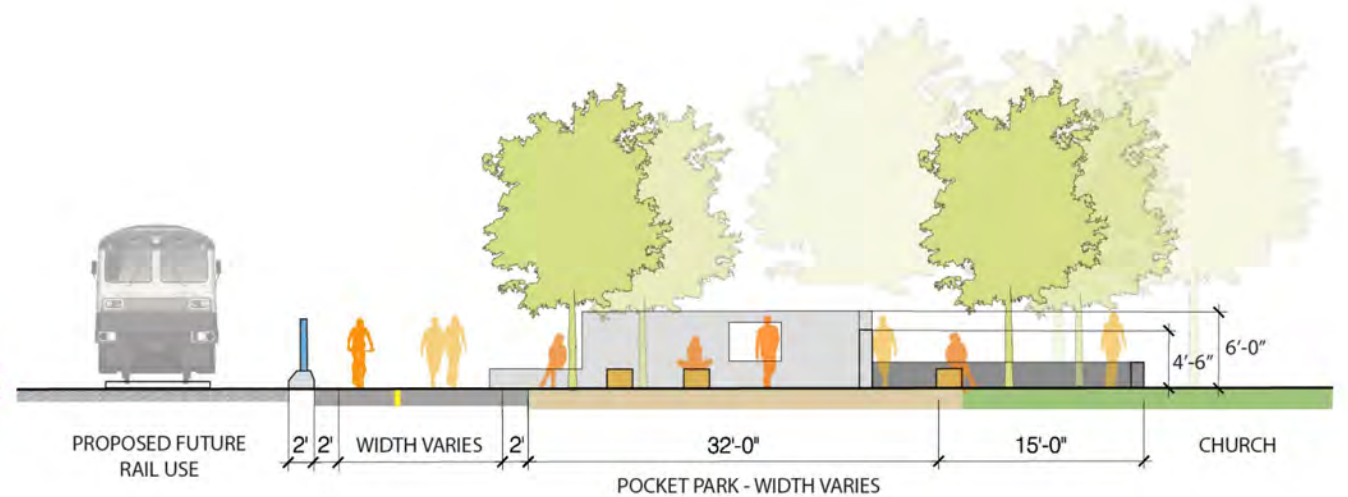





# WORKING GROUP DISCUSSION

## "Raise hand" to speak

- If you wish to speak, click on "Raise Hand" in the Zoom application
  - On the telephone, enter \* 9 on the dial pad
- Staff will call your name or phone number to acknowledge
- Before starting, please state your name and staff will confirm that we can hear you
- You will have **two minutes** to make your comment

Bottom  
Panel of  
Zoom Screen

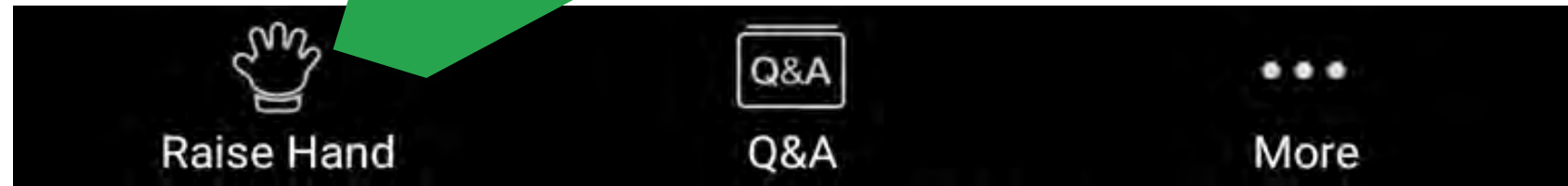





# NEXT STEPS

## Next Meetings

- Outreach for Art Free Wall
- Working Group – 75% design
- Public Meeting – 100% design
- Public Meeting – prior to construction

## Find us online

[CambridgeMA.gov/GrandJunction](http://CambridgeMA.gov/GrandJunction)

- Project updates
- Design Working Group materials
- StoryMap
- Public Meeting
- Historical documents

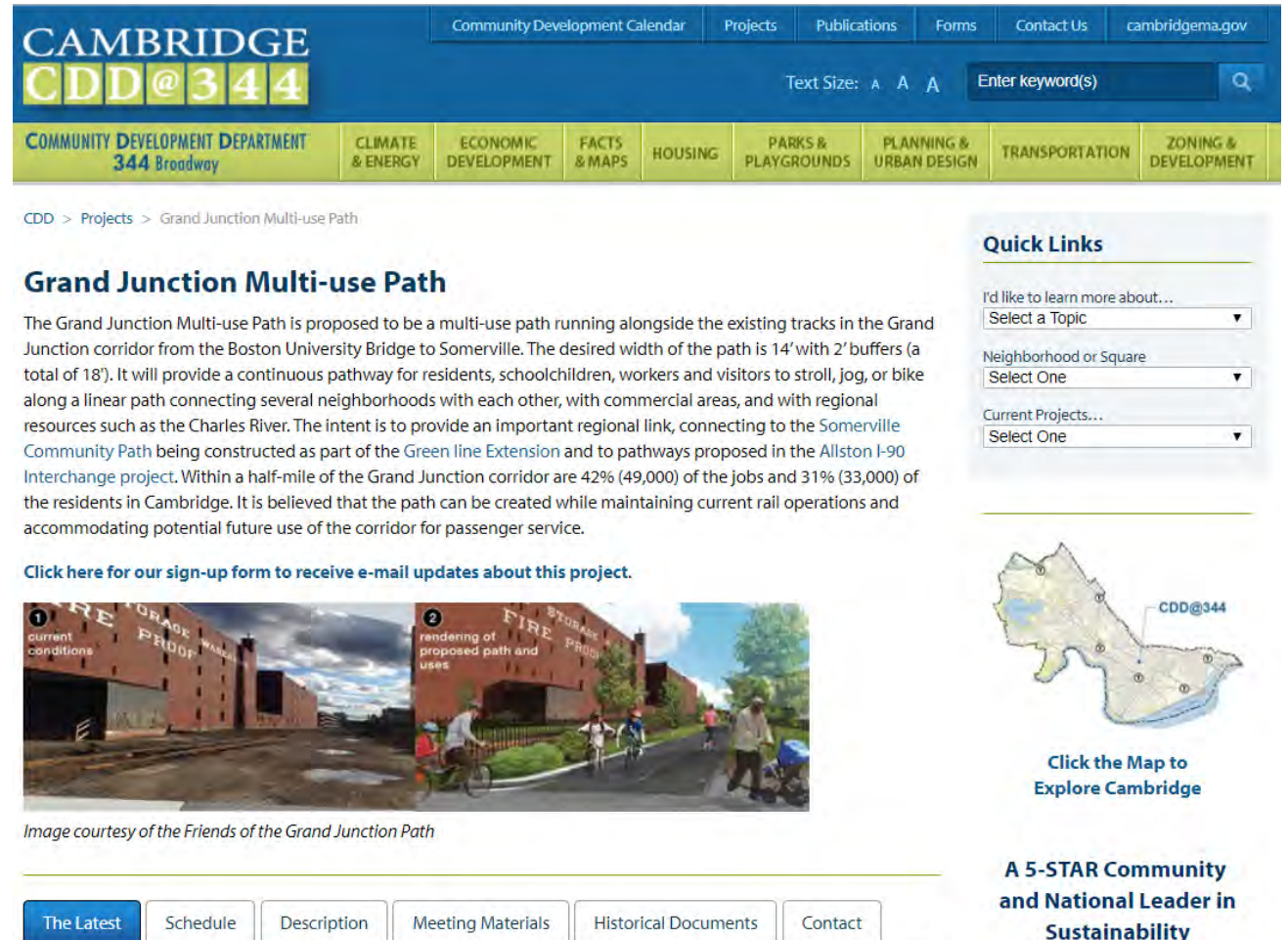

The screenshot shows the Cambridge CDD@344 website. The header includes navigation links for Community Development Calendar, Projects, Publications, Forms, Contact Us, and cambridgema.gov. A search bar is present with the text "Enter keyword(s)". Below the header is a menu with categories: COMMUNITY DEVELOPMENT DEPARTMENT (344 Broadway), CLIMATE & ENERGY, ECONOMIC DEVELOPMENT, FACTS & MAPS, HOUSING, PARKS & PLAYGROUNDS, PLANNING & URBAN DESIGN, TRANSPORTATION, and ZONING & DEVELOPMENT.

The main content area is titled "Grand Junction Multi-use Path" and includes a detailed description of the project, its location, and its benefits. A link is provided for a sign-up form to receive e-mail updates about the project.

Below the text is a photo showing two views of the path: "1 current conditions" and "2 rendering of proposed path and uses". The photo shows a brick building with "FIRE PROOF" signs and a path with people walking and cycling.

On the right side of the page, there is a "Quick Links" section with three dropdown menus: "I'd like to learn more about...", "Neighborhood or Square", and "Current Projects...". Below this is a map of Cambridge with a callout for "CDD@344". A button below the map says "Click the Map to Explore Cambridge".

At the bottom of the page, there is a navigation bar with buttons for "The Latest", "Schedule", "Description", "Meeting Materials", "Historical Documents", and "Contact".

At the bottom right of the page, there is a badge that says "A 5-STAR Community and National Leader in Sustainability".





# PUBLIC COMMENT

## "Raise hand" to speak

- If you wish to speak, click on "Raise Hand" in the Zoom application
  - On the telephone, enter \* 9 on the dial pad
- Staff will call your name or phone number to acknowledge
- Before starting, please state your name and staff will confirm that we can hear you
- You will have **two minutes** to make your comment

Bottom  
Panel of  
Zoom Screen

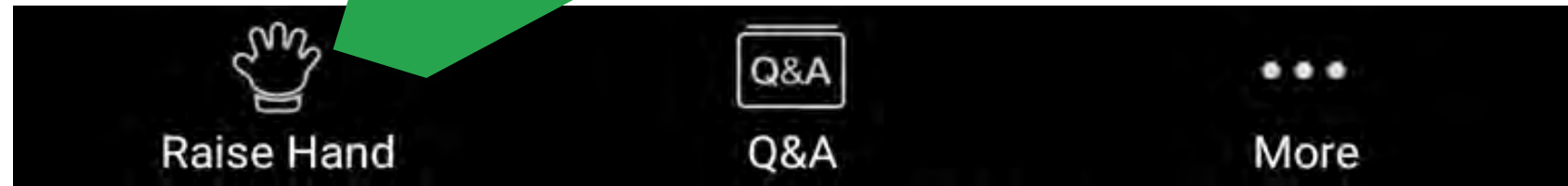





# THANK YOU

**Bill Deignan**, Transportation Program Manager

**Andrew Reker**, Transit Planner

Cambridge Community Development Department

[AREker@cambridgema.gov](mailto:AREker@cambridgema.gov)

(617) 349-6959