

October 17, 2023

City of Cambridge Planning Board
344 Broadway
Cambridge, Massachusetts 02139

Re: Use Determination at 7 Broad Canal Way, Cambridge, Massachusetts

Dear City of Cambridge Planning Board:

Depth N Green is a 9-year old all-natural cafe proudly serving traditional Indian-inspired food, sandwiches, burgers, and smoothies.

Our first location in the heritage city of Mysore, India opened in July 2014. 7 Broad Canal Way would be our first location outside India. I, the owner, Pushpir Bhetia, previously founded and ran Guru The Caterer in Somerville and Downtown Boston. Guru the Caterer was one of the highest rated restaurants in the United States. Our approach for Depth N Green is to serve high quality, all natural food, while engaging with local communities, supporting local efforts, and hosting events.

Depth N Green is based on the principle that food can be both delicious and healthy. If one looks deeply, one sees the inner connectivity of life and makes greener (healthier) and sustainable choices, hence Depth N Green came into existence. Through this founding principle Depth N Green serves divine, authentic Indian food in an inspired and sustainable manner. Shanti, the previous tenant, also was serving Indian food from the same location. The space will be used to store, stock, produce and serve our products to the community. Please see below, a photos of the space. Use of the space will remain unchanged.

As we understand, per section 13.42.5 of the Cambridge Zoning Ordinance, this location is listed for Fast Order or Quick-Service Food Establishment. The building's structure will remain unchanged. The interior layout will be updated to reflect a contemporary cafe vibe. The building's exterior and existing windows will remain unchanged. The changes we anticipate are as follows: adding our logo on the exterior, adding decals on the windows and an interior fit-out to accommodate our operations.

The logo (included below) simply consists of our brand name, Depth N Green, a leaf, and a person doing meditation. "When you look deeply...you see - Interconnectivity of Life...hence you make greener and sustainable choices in Life"...hence Depth n Green. If you look deeply (Meditate) you become conscious and start appreciating this Inner-Connectivity of Beings, and start making greener (healthier) choices in life :) Because of these integrative reasons, Depth n Green came into existence!

We anticipate that such use of 7 Broad Canal Way will require an approval by the Planning Board in accordance with the City of Cambridge Zoning Ordinance, and we respectfully request this subject to be added to the agenda for the next available Planning Board meeting.

Should you have any questions, please feel free to contact Pushpir Bhetia at hello@depthngreen.com or 917-819-9384.

Sincerely,

Pushpir Bhetia
Founder, Chef & Owner

Appendix

Goals and Objectives:

Depth N Green aims to accomplish the following goals and objectives:

- Open its first flagship location in Kendall Square vicinity
- Expecting both retail and catering revenue to 1.5 million within the first year and two million by the end of year three.
- Launch gourmet retail products that include signature spice blends, millet and other ancient grain Indian inspired cookies, ice cream, as well as pickles and chutneys.

Products and Services:

- All natural/organic, authentic Indian food as well as inspired Indian sandwiches (burgers), smoothies, desserts, and South Indian coffee (Brewed and Nitro).
- Marketplace with our signature spice blends (Garam Masala, Golden Milk, Chai Masala, Turmeric, and Kashmiri Saffron). South Indian Single Estate Coffee, Chutneys, Pickles, and prepared foods.

Pictures on the following page.



DEPTH 'N' GREEN
Aroma of inspiration in each bite



Remodeling work in progress



7 BROAD CANAL WAY
CAMBRIDGE MA 02142

REVISIONS

NUMBER:	REMARKS:	DATE:

ISSUED FOR: DATE ISSUED:

PROJECT TITLE:

DRAWING TITLE:

FLOOR PLAN

1/4" = 1'-0" PROJECT NUMBER:

DRAWN BY: CHECKED BY:

DRAWING NUMBER:

A100

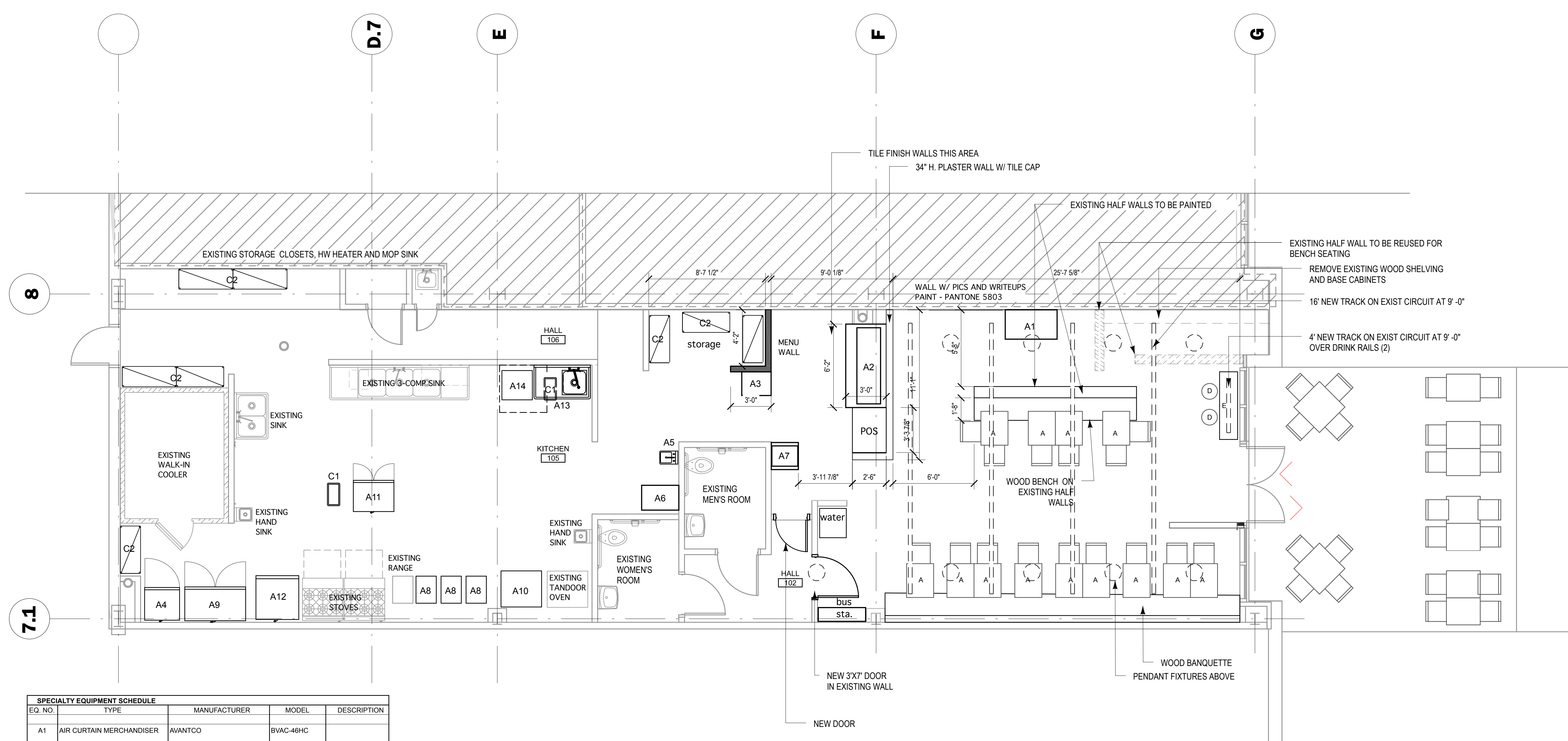

SPECIALTY EQUIPMENT SCHEDULE				
EQ. NO.	TYPE	MANUFACTURER	MODEL	DESCRIPTION
A1	AIR CURTAIN MERCHANDISER	AVANTCO	BVAC-46HC	
A2	HEATED SHELF	HATCO	GRSB-66-I	67.5" X 21" RECESSED ONTO COUNTERTOP
A3	SOFT SERVE MACHINE	COLDLINE	NEO-F3	
A4	REACH-IN BLAST CHILLER	AVANTCO	SF-10	
A5	HAND SINK W/ GOOSENECK FAUCET	REGENCY	600HS-12	
A6	ICE MACHINE	AVANTCO	KMC-H-322-A	
A7	COFFEE MACHINE	CURTIS	CBHT	
A8	STOCK POT RANGE	VULCAN	VSP100	
A9	REACH-IN FREEZER	AVANTCO	A-49F-HC	
A10	COUNTERTOP GRIDDLE	COOKING PERFORMANCE	35136GCRBN	
A11	WORKTOP FREEZER	AVANTCO	SS-UC-36F-HC	
A12	CONVECTION OVEN	COOKING PERFORMANCE	FEC-200-DK	
A13	SOILED DISHTABLE	BK RESOURCES	BKUCDT-50-R	
A14	DISHWASHER			
C1	TRASH CAN			
C2	WIRE SHELVES			CHROME WIRE SHELVING - 18 x 48
C3	EMPLOYEE COAT HOOK			

FURNITURE SCHEDULE	
TYPE MARK	TYPE
A	24" X 30" STANDARD 2 TOP TABLE
B	STANDARD CHAIR
C	
D	BAR HEIGHT STOOL
E	14"X60" DRINK RAIL

Proposed Sign:



FASTSIGNS

Make Your Statement™

Scan QR Code to visit our website



155A New Boston Street
Woburn, MA 01801
214@fastsigns.com
781-938-7700

◆
Salesperson:
Vasu Patel

◆
Client:
Depth 'N' Green

◆
Address:
7 Broad Canal Way
Cambridge, MA 02142

◆ **Final Approval Signature:**

Prior to signing off please make sure all spelling/sizing is correct. Production will not begin without a signed approval on the final layout.

Date:

All artwork designed/created is Copyright © 2023 FASTSIGNS of Woburn. No part of this artwork shall be duplicated, altered, exhibited in any manner or used for any purpose without the written permission of FASTSIGNS of Woburn.



155A New Boston Street
Woburn, MA 01801
214@fastsigns.com
781-938-7700



1 1/2" THICK ACRYLIC LETTERS
PAINTED TO PMS CODE
NON-ILLUMINATED

2 PERFORATED METAL BACKER
DISTANCE OF THE FACADE
WITH ALUMINUM TUBE FRAMING

EXAMPLE:



1/2" THICK LETTERS
WITH STUDS



Final Approval Signature:

Prior to signing off please make sure all spelling/sizing is correct. Production will not begin without a signed approval on the final layout.

Date:

All artwork designed/created is Copyright @ 2023 FASTSIGNS of Woburn. No part of this artwork shall be duplicated, altered, exhibited in any manner or used for any purpose without the written permission of FASTSIGNS of Woburn.

◆
Salesperson:
Vasu Patel

◆
Client:
Depth 'N' Green

◆
Address:
7 Broad Canal Way
Cambridge, MA 02142