



# FIRST STREET

PUD & PROJECT REVIEW SPECIAL PERMIT APPLICATION  
 REVISED MAJOR AMENDMENT PB #213A DEVELOPMENT PROPOSAL

NOVEMBER 4<sup>TH</sup>, 2015

URBAN SPACES  
 APPLICANT

APPLICANT First Street - US, LLC

ARCHITECT Perkins Eastman

PLANNING Boyes-Watson Architects

EXPANDED DEVELOPMENT PARCEL





# FIRST STREET P.U.D. APPLICATION REVISED MAJOR AMENDMENT PB #231A

## TABLE OF CONTENTS

## FIGURE NUMBER

### EXHIBIT 1 | SITE PLANS

APPROVED PB #231A DEVELOPMENT PARCEL	FIGURE 1
APPROVED AMENDMENT TO PB #231A DEVELOPMENT PARCEL 4.14.2015	FIGURE 2

### EXHIBIT 2 | AMENDED DEVELOPMENT PARCEL

PB #231A EXPANDED DEVELOPMENT PARCEL 7.24.2015	FIGURE 3
PB #231A EXPANDED DEVELOPMENT PARCEL AXONOMETRIC	FIGURE 4
EXPANDED DEVELOPMENT SITE SETBACK PLAN	FIGURE 5

### EXHIBIT 3 | GFA DIAGRAM

SQUARE FOOTAGE DIAGRAM (G.F.A.)	FIGURE 6
---------------------------------	----------

### EXHIBIT 4 | NEIGHBORHOOD MAPS

CONTEXT SITE PLAN AND OPEN SPACE	FIGURE 7
EAST CAMBRIDGE ZONING MAP	FIGURE 8

### EXHIBIT 5 | INTRO TO PROPOFIGURESED LANDSCAPE PLANS

PROPOSED EXPANDED LANDSCAPE PLAN	FIGURE 9
SITE PLAN UPDATES @ STREET EDGE	FIGURE 10

### EXHIBIT 6 | ARCHITECTURE

PARCELA   EXISTING CONDITION @ BENT STREET CORNER	FIGURE 11
PARCELA   PROPOSED RETAIL AND OFFICE RENDER	FIGURE 12
PARCELA   EXISTING CONDITION @ CHARLES STREET CORNER	FIGURE 13
PARCELA   PROPOSED OFFICE RENDER	FIGURE 14
PARCELA   EXISTING CONDITIONS AT BENT STREET CORNER	FIGURE 15
PARCELA   PROPOSED OFFICE RENDER AT BENT STREET	FIGURE 16
PARCEL B   EXISTING CONDITION @ CHARLES STREET CORNER	FIGURE 17
PARCEL B   PROPOSED RESIDENTIAL AND RETAIL RENDER	FIGURE 18
PARCEL B   EXISTING CONDITION PEDESTRIAN @ CHARLES STREET	FIGURE 19
PARCEL B   PROPOSED RESIDENTIAL RENDER	FIGURE 20
PARCEL B   EXISTING CONDITION @ CHARLES STREET TOWARDS FIRST STREET	FIGURE 21
PARCEL B   PROPOSED RESIDENTIAL RENDER	FIGURE 22
PARCEL C   EXISTING CONDITION @ CHARLES STREET MID-BLOCK	FIGURE 23
PARCEL C   PROPOSED MIDBLOCK CONNECTION RENDER	FIGURE 24

## TABLE OF CONTENTS

## FIGURE NUMBER

PARCEL C   EXISTING CONDITION @ HURLEY STREET MID-BLOCK	FIGURE 25
PARCEL C   PROPOSED RESIDENTIAL RENDER	FIGURE 26
PARCEL C   EXISTING CONDITION @ HURLEY STREET TOWARDS SECOND STREET	FIGURE 27
PARCEL C   PROPOSED HURLEY STREET EDGE RENDER	FIGURE 28
PARCEL D   EXISTING CONDITIONS HURLEY STREET CORNER	FIGURE 29
PARCEL D   PROPOSED HURLEY STREET CORNER RENDER	FIGURE 30
PARCEL D   EXISTING CONDITIONS FIRST STREET EDGE	FIGURE 31
PARCEL D   PROPOSED FIRST STREET EDGE RENDER	FIGURE 32
PARCEL D   EXISTING CONDITIONS HURLEY STREET EDGE	FIGURE 33
PARCEL D   PROPOSED HURLEY STREET EDGE RENDER	FIGURE 34
PARCEL D   EXISTING CONDITIONS AT FIRST STREET PEDESTRIAN LEVEL	FIGURE 35
PARCEL D   PROPOSED FIRST STREET SIDEWALK VIEW RENDER	FIGURE 36
PARCEL B   EXISTING CONDITIONS AT FIRST STREET PEDESTRIAN LEVEL	FIGURE 37
PARCEL B   PROPOSED RESIDENTIAL RENDER	FIGURE 38

### EXHIBIT 7 | OPEN SPACE DESIGN

PUD LANDSCAPE OPEN SPACE DESIGN	FIGURE 39
PARCEL B + PARCEL C   OPEN SPACE DESIGN	FIGURE 40
CHARLES STREET OPEN SPACE DESIGN	FIGURE 41
HURLEY STREET OPEN SPACE DESIGN	FIGURE 42
CHARLES STREET PERSPECTIVE SKETCH	FIGURE 43
HURLEY STREET EDGE SCREENING	FIGURE 44
MIDBLOCK PATH PERSPECTIVE SKETCH	FIGURE 45
SURFACE PARKING LOADING TURNING RADIUS DIAGRAM	FIGURE 46

### EXHIBIT 8 | BUILDING DESIGNS

PARCELA   DESIGN PROPOSAL	FIGURE 47
PARCELA   OFFICE FLOOR PLANS	FIGURE 48
PARCELA   OFFICE ELEVATIONS	FIGURE 49
PARCELA   OFFICE DESIGN	FIGURE 50
PARCELA   OFFICE CORNER RE-DESIGN	FIGURE 51
PARCEL B   RESIDENTIAL DESIGN	FIGURE 52
PARCEL B   RESIDENTIAL CHARLES STREET FLOOR PLANS	FIGURE 53
PARCEL B   RESIDENTIAL DESIGN	FIGURE 54
PARCEL B   RESIDENTIAL DESIGN	FIGURE 55
PARCEL B   RESIDENTIAL DESIGN	FIGURE 56

# FIRST STREET P.U.D. APPLICATION REVISED MAJOR AMENDMENT PB #231A

## TABLE OF CONTENTS

## FIGURE NUMBER

## TABLE OF CONTENTS

## FIGURE NUMBER

PARCEL B   RESIDENTIAL DESIGN	FIGURE 57
PARCEL B   RESIDENTIAL DESIGN	FIGURE 58
PARCEL C   RESIDENTIAL DESIGN	FIGURE 59
PARCEL C   RESIDENTIAL HURLEY STREET DESIGN	FIGURE 60
PARCEL C   RESIDENTIAL DESIGN	FIGURE 61
PARCEL C   HURLEY STREET ELEVATIONS	FIGURE 62
PARCEL D   RETAIL DESIGN	FIGURE 63
PARCEL D   RETAIL FLOOR PLAN	FIGURE 64
PARCEL D   RETAIL ELEVATIONS	FIGURE 65
PARCEL D   RETAIL DESIGN	FIGURE 66

MID-BLOCK ELEVATION   OFFICE BUILDING	FIGURE 84
BENT STREET ELEVATION   OFFICE BUILDING	FIGURE 85

### EXHIBIT 9 | BICYCLE PARKING PLAN AND GARAGE PLAN

BICYCLE PARKING PLAN   SHORT TERM PARKING LOCATIONS	FIGURE 67
BICYCLE PARKING PLAN   LONG TERM PARKING IN LOWER LEVEL GARAGE	FIGURE 68
PARCEL B   LOWER LEVEL GARAGE	FIGURE 69

### EXHIBIT 10 | PUD SOLAR STUDY

SOLAR STUDY	FIGURE 70
SOLAR STUDY	FIGURE 71

### EXHIBIT 11 | EXISTING SITE SURVEY

EXISTING SITE SURVEY PB #231A EXISTING	FIGURE 72
--	-----------

### EXHIBIT 12 | SITE CONTEXT ELEVATIONS

FIRST STREET ELEVATION	FIGURE 73
FIRST STREET ELEVATION	FIGURE 74
FIRST STREET ELEVATION   OFFICE BUILDING	FIGURE 75
HURLEY STREET ELEVATION   RESIDENTIAL BUILDING	FIGURE 76
HURLEY STREET ELEVATION   RETAIL BUILDING	FIGURE 77
FIRST STREET ELEVATION   OFFICE AND RESIDENTIAL BUILDING	FIGURE 78
FIRST STREET ELEVATION   RESIDENTIAL AND RETAIL BUILDING	FIGURE 79
MID-BLOCK ELEVATION   RESIDENTIAL BUILDING	FIGURE 80
MID-BLOCK ELEVATION   RETAIL AND BOTH RESIDENTIAL BUILDINGS	FIGURE 81
CHARLES STREET ELEVATION   RESIDENTIAL BUILDING	FIGURE 82
CHARLES STREET ELEVATION   OFFICE BUILDING	FIGURE 83

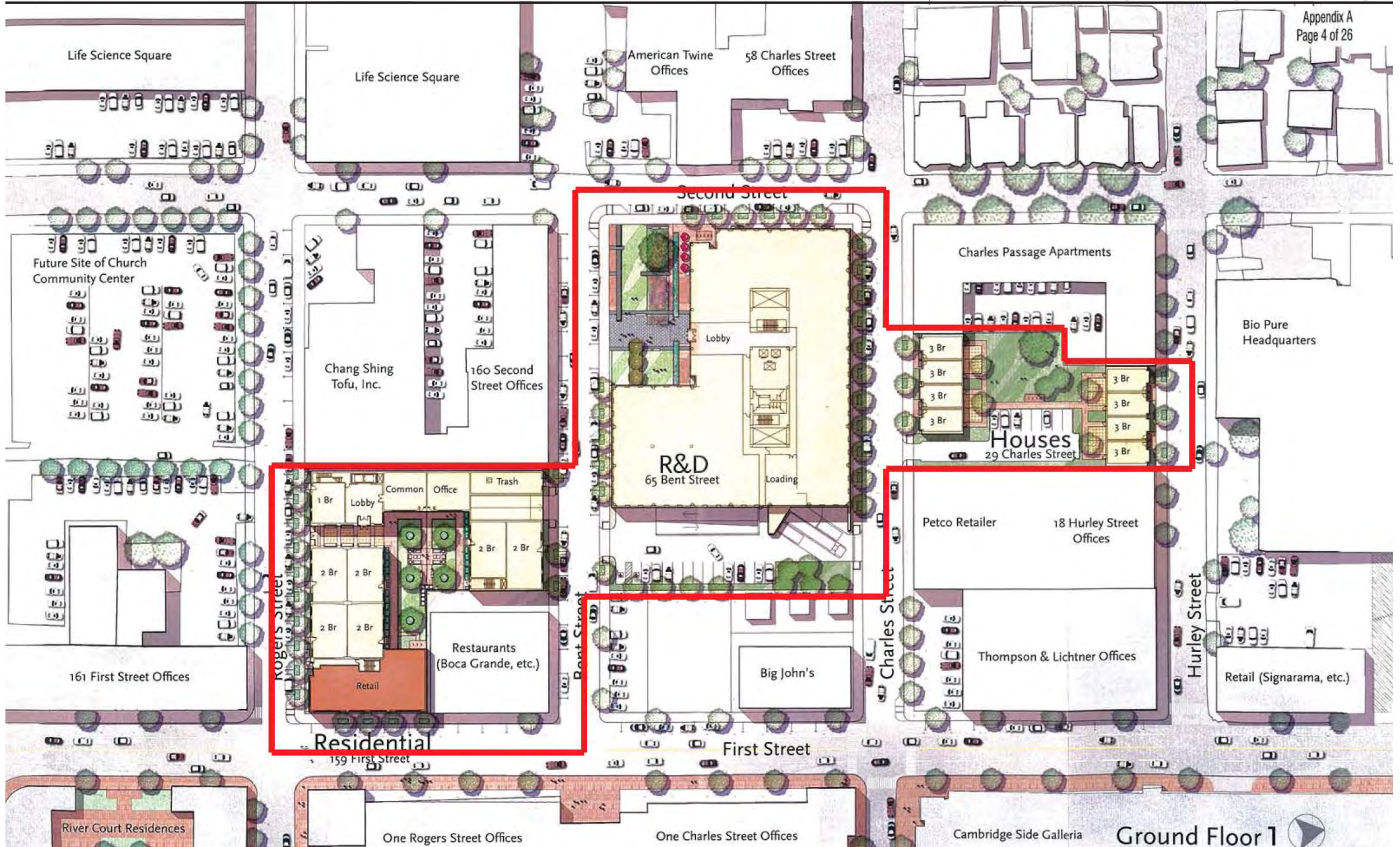



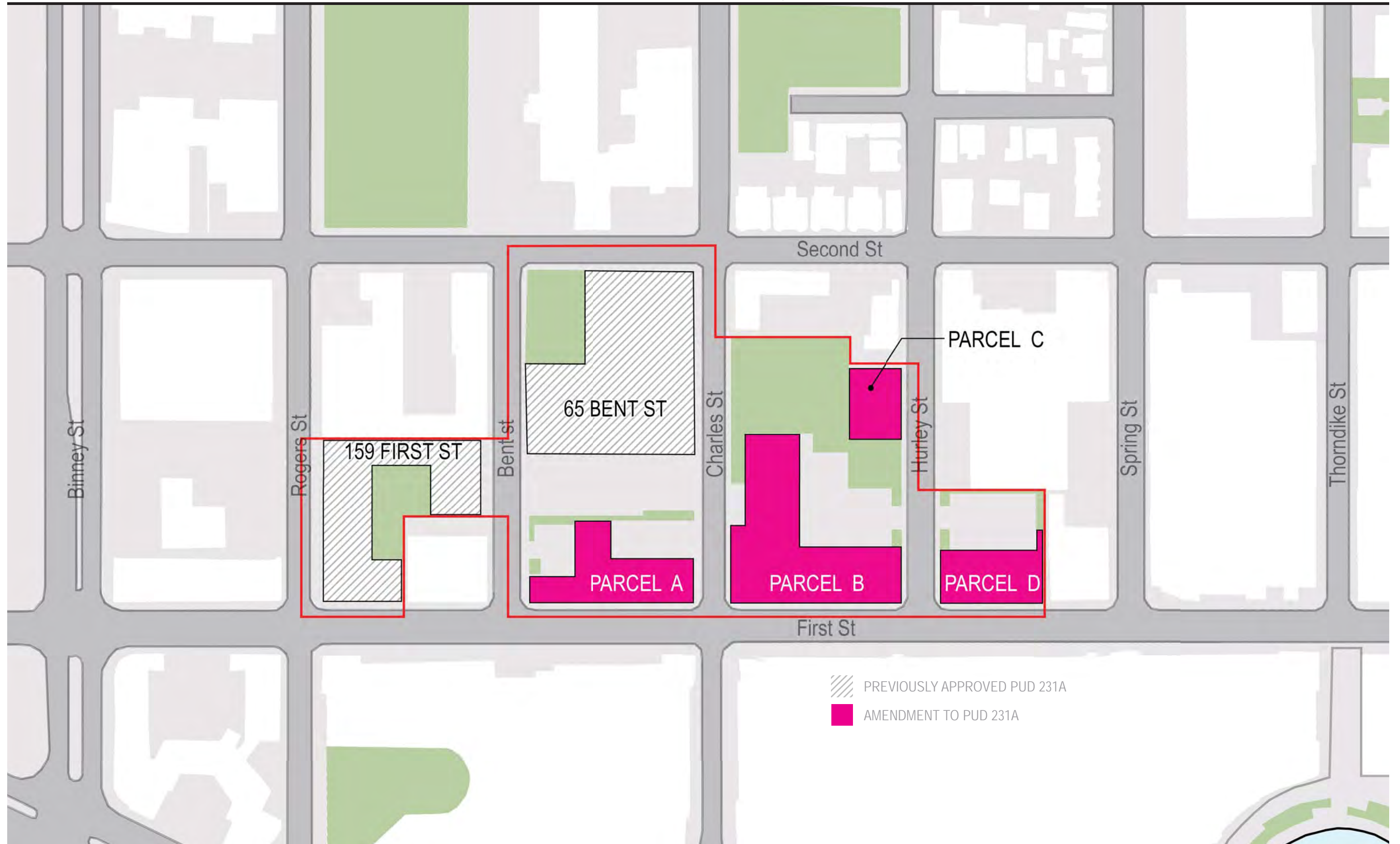

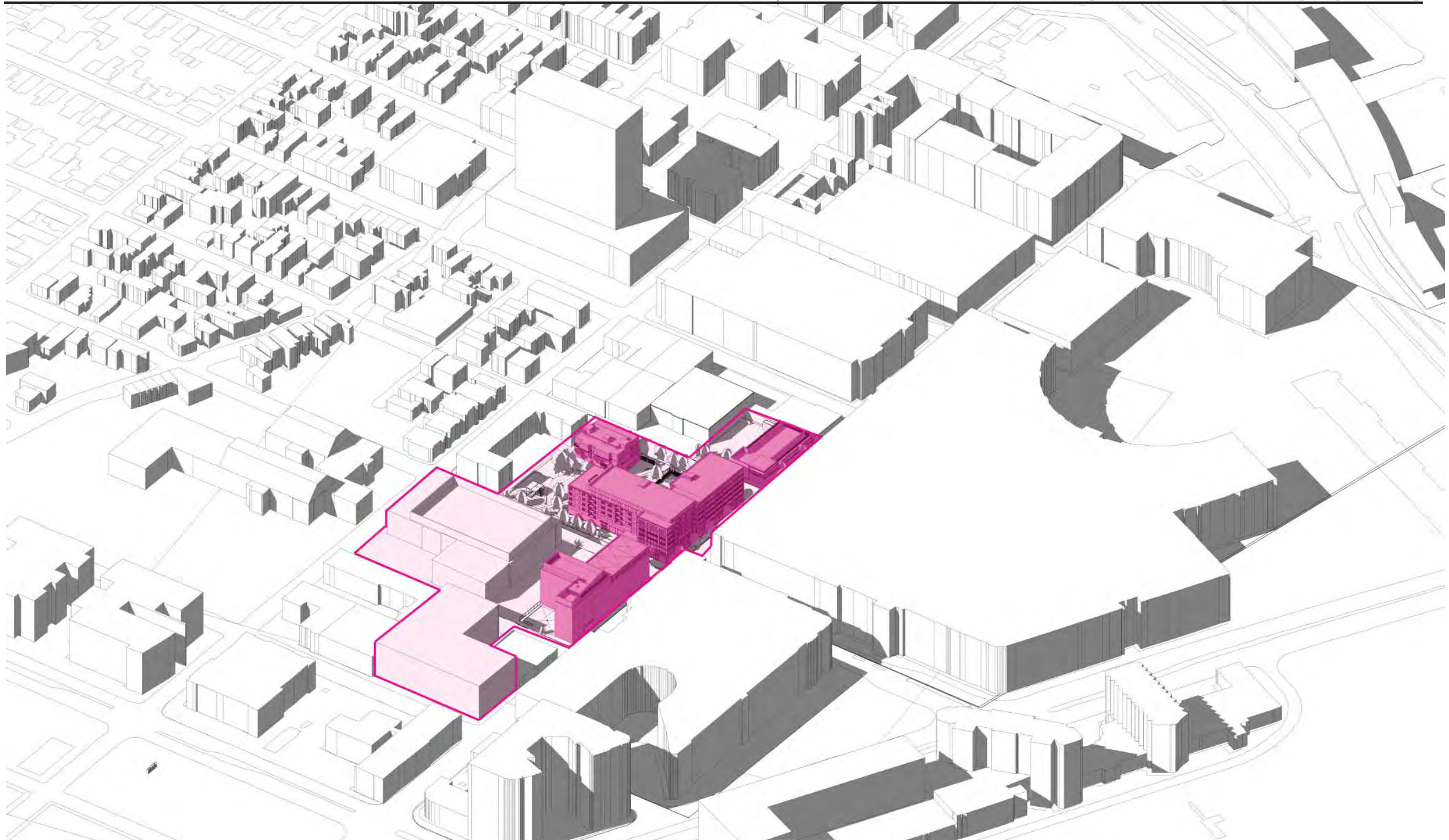



SETBACKS

THE SETBACKS PROPOSED ALONG FIRST STREET ARE INTENDED TO IMPROVE THE EXISTING CONDITION AND RESPOND TO THE INCREASED RETAIL ACIVITY IN SPECIFIC LOCATIONS. THE **PARCEL A** SIDEWALK WILL CONTINUE THE PRECEDENT THAT HAS BEEN SET AT 159 FIRST STREET BY CONTINUING AN 8'-0" SIDEWALK.

**PARCEL B** WILL SET THE BUILDING BACK FOR A WIDER PUBLIC SIDEWALK WHERE MULTIPLE RETAIL ENTRIES ARE ENVISIONED

**PARCEL D** WILL ALSO SET THE BUILDING BACK FOR A SLIGHTLY WIDER SIDEWALK FOR MULTIPLE RETAIL ENTRIES, BEFORE THE SIDEWALK RETURNS TO ITS EXISTING CONDITION OF 8'-0" MAXIMUM AT THE CURRENT "DAVID'S SHOES" STOREFRONT ON FIRST STREET

8'-0" SIDEWALK ALONG 159 FIRST STREET

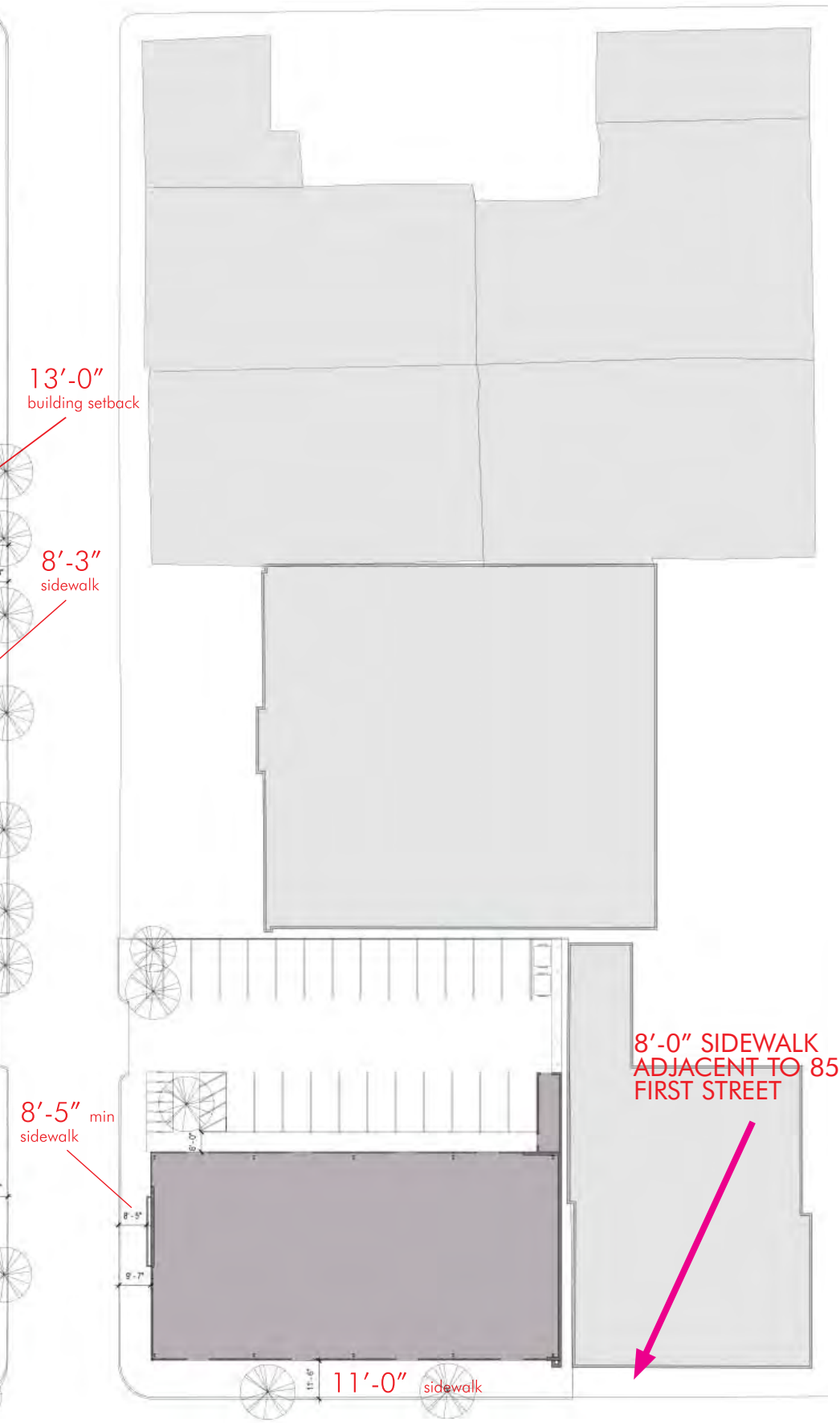
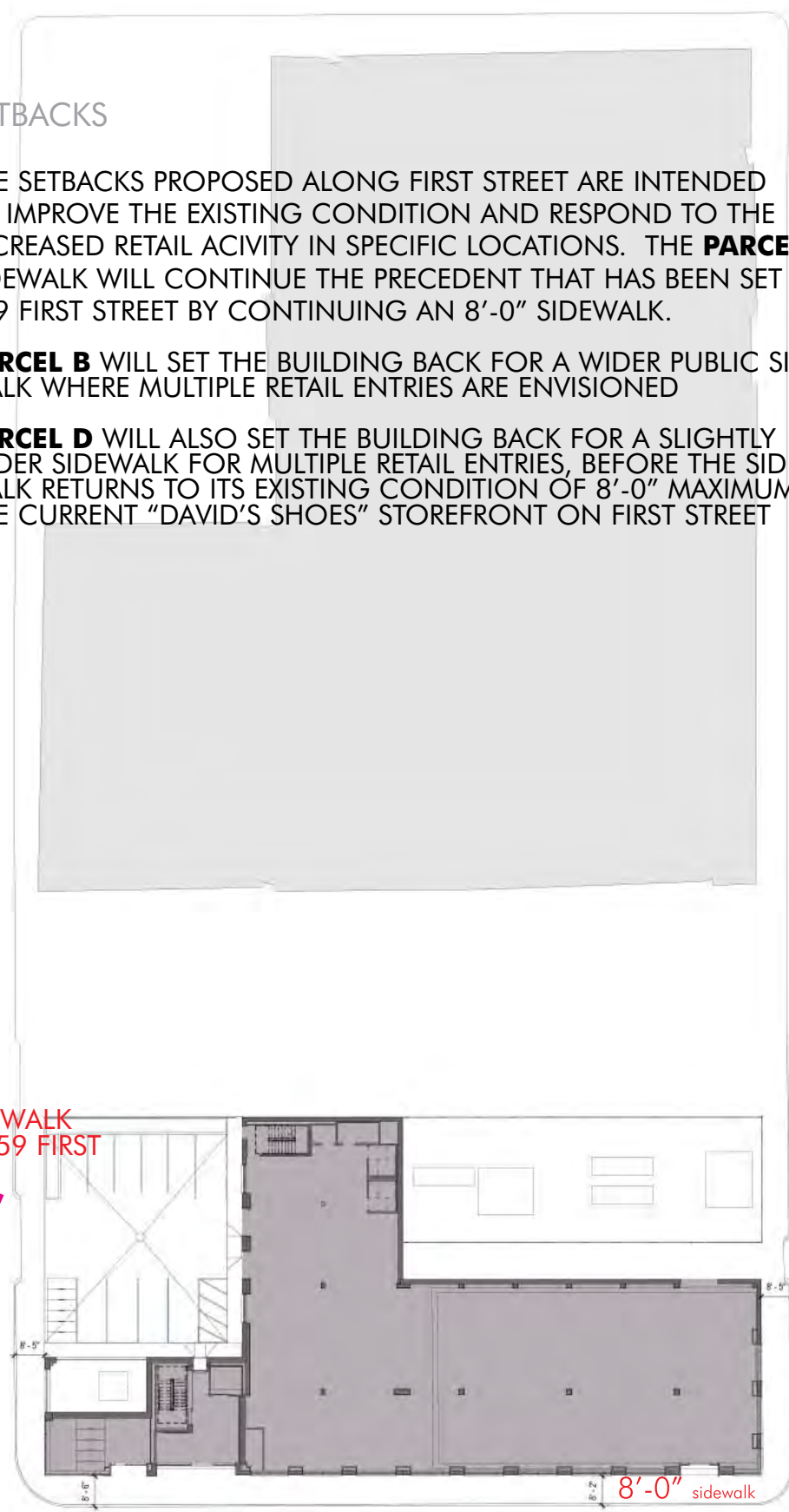

8'-0" SIDEWALK ADJACENT TO 85 FIRST STREET





-  RETAIL
-  RESIDENTIAL
-  RETAIL AT GROUND LEVEL  
RESIDENTIAL ABOVE
-  OFFICE
-  RETAIL AT GROUND LEVEL  
OFFICE ABOVE
- (A)** 121 FIRST ST. | OFFICE + RETAIL  
Retail GFA = 9,800 GSF  
Office GFA = 40,482 GSF
- (B)** 107 - 119 FIRST ST. | RETAIL  
21 CHARLES ST. | RESIDENTIAL  
Retail GFA = 14,800 GSF  
Residential GFA = 101,488 GSF
- (C)** 29 CHARLES ST. | OPEN SPACE  
22 HURLEY ST. | RESIDENTIAL  
  
Residential GFA = 18,502 GSF
- (D)** 95 FIRST ST. | RETAIL  
Retail GFA = 7,750 GSF

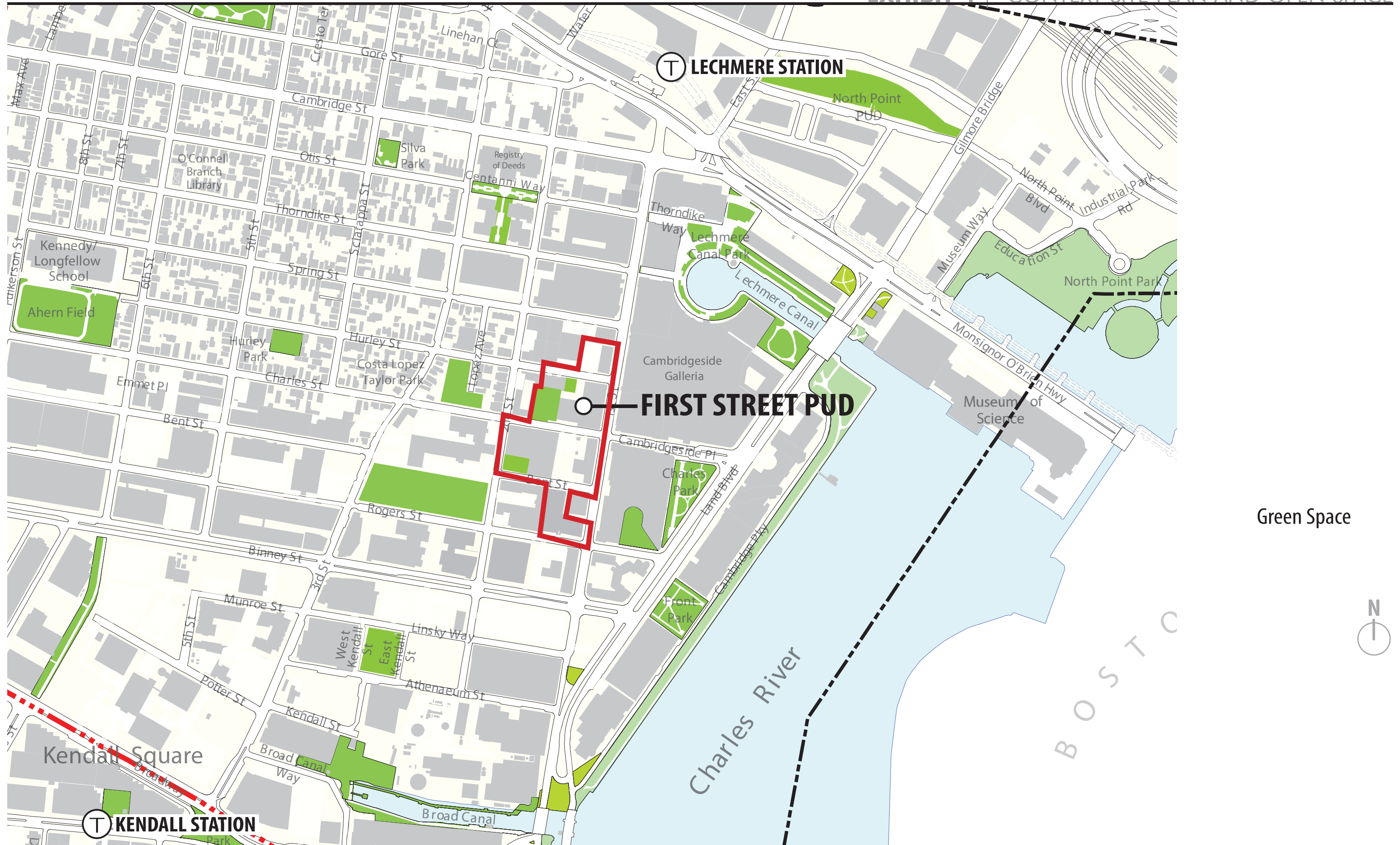

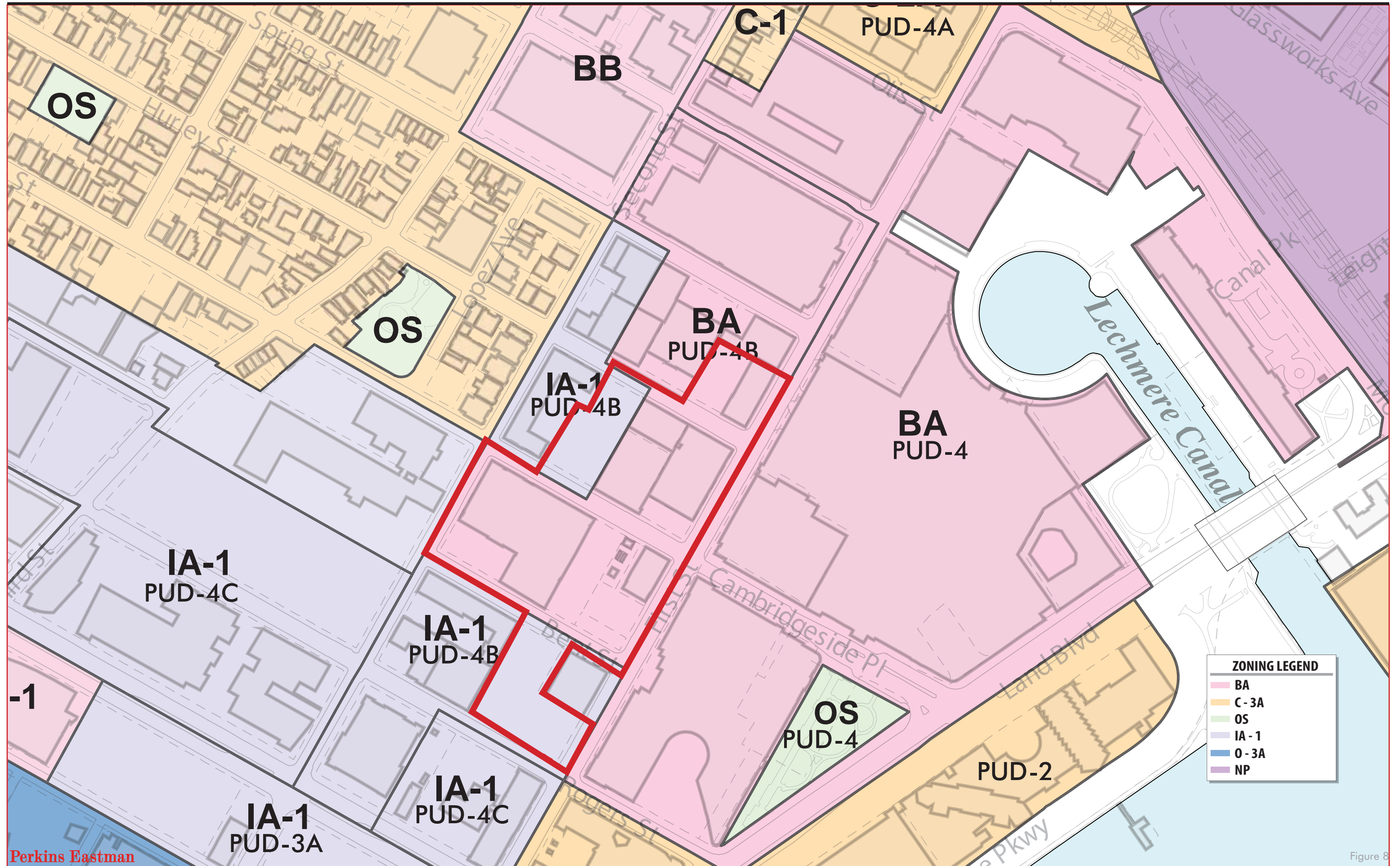



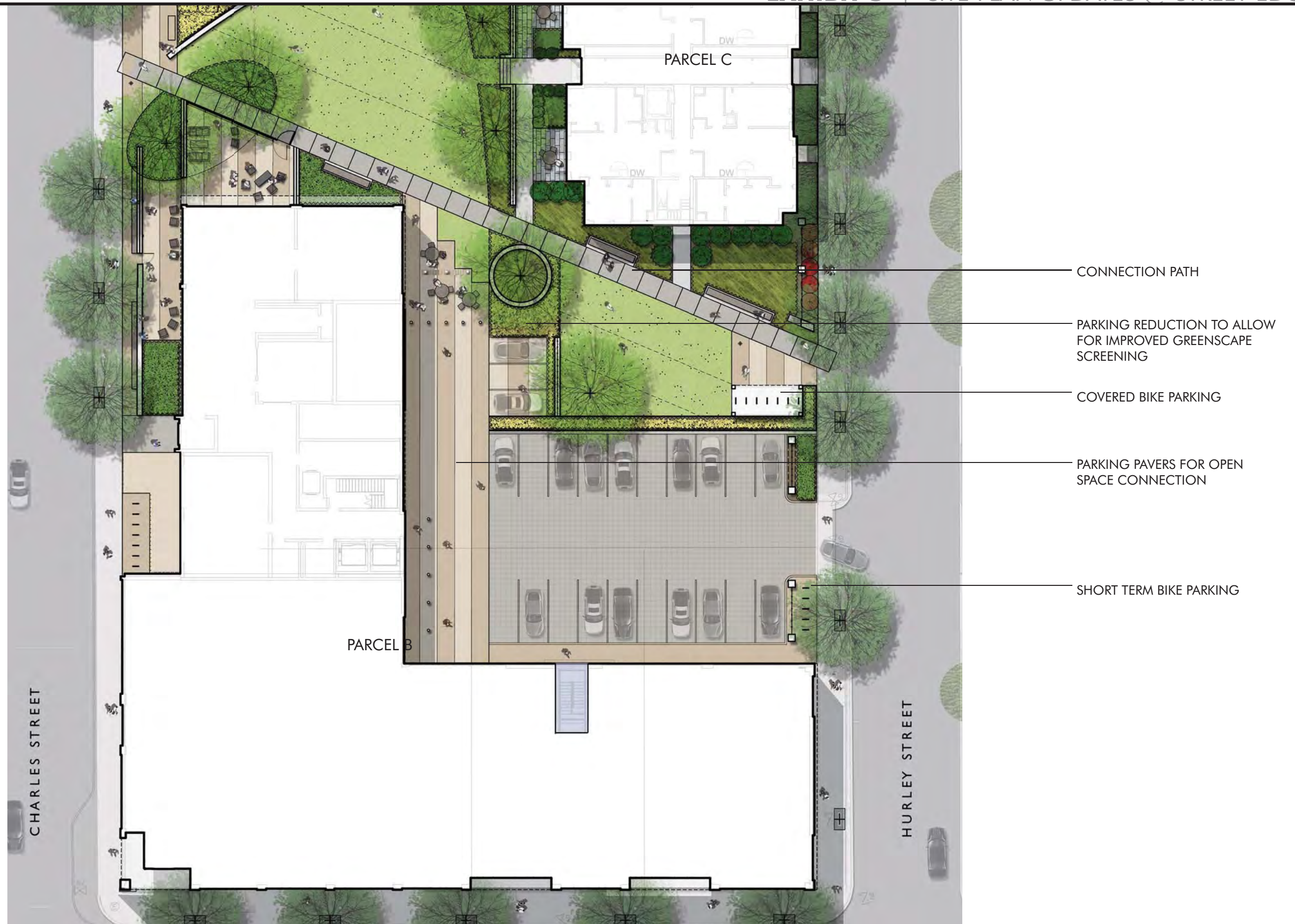

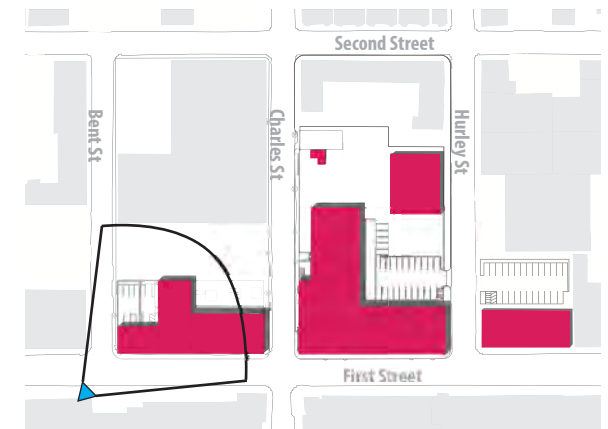
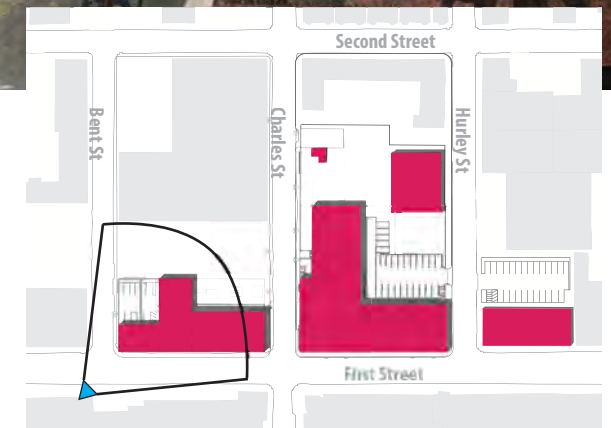

Figure 11











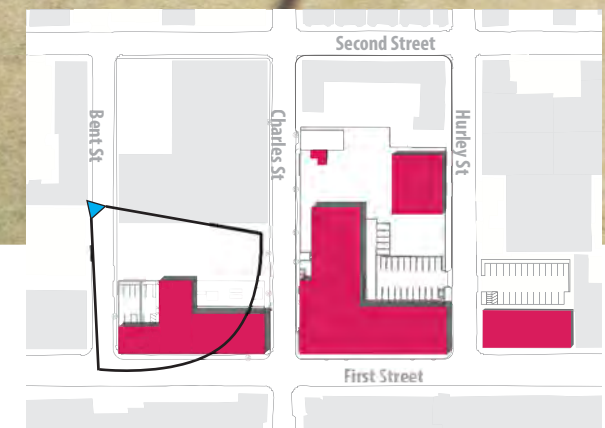

Figure 16





Perkins Eastman

Figure 18



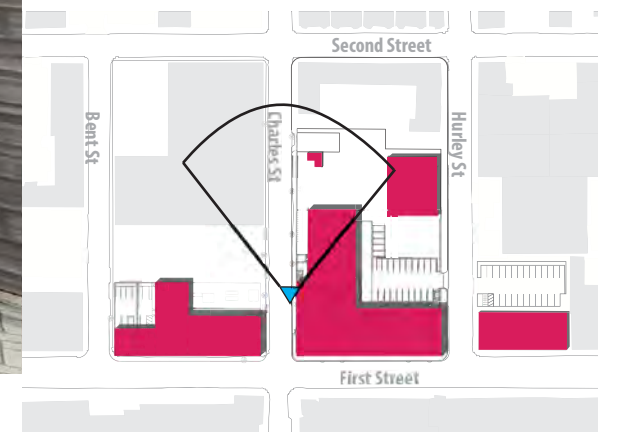
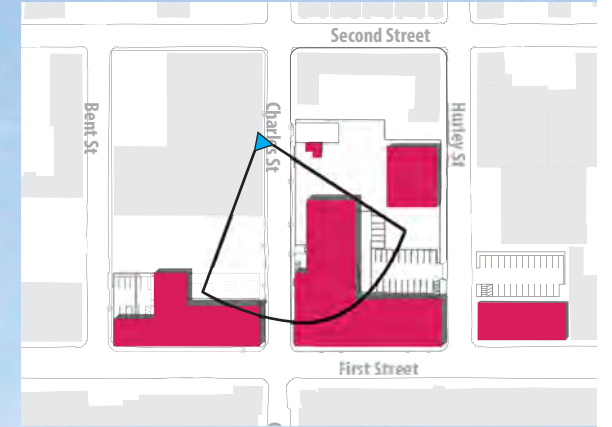

Figure 20











Perkins Eastman

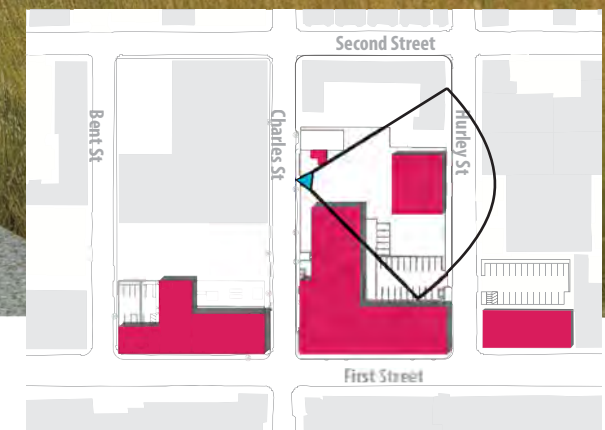

Figure 24



