

RECEIVED

SEP 09 2015



CAMBRIDGE HISTORICAL COMMISSION

831 Massachusetts Avenue, 2nd Fl., Cambridge, Massachusetts 02139

Telephone: 617 349 4683 Fax: 617 349 3116 TTY: 617 349 6112

E-mail: histcomm@cambridgema.gov URL: http://www.cambridgema.gov/Historic

CAMBRIDGE HISTORICAL COMMISSION

APPLICATION FOR CERTIFICATE

1. The undersigned hereby applies to the Cambridge Historical Commission for a Certificate of (check one box): Appropriateness,

2. Address of property: 34 Follen Street, Cambridge, Massachusetts, 02138

3. Describe the proposed alteration(s), construction or demolition in the space provided below:

Replace existing awning windows on east side, first floor with double 6 over 6 windows matching the existing 28" windows on the second floor.

Remove eastside door and wooden awning.

Replace sliding door on west side with France door with divided lights and divided sidelights.

Add 2 windows of the existing height of the second floor window that is above French door and sidelights that line up with the door and sidelights.

Replace 5 ft. board fence to the east of the front gate with 3 ft. open fence. Finish existing fence to 6 ft. with open lattice.

I certify that the information contained herein is true and accurate to the best of my knowledge and belief. The undersigned also attests that he/she has read the statements printed on the reverse.

Name of Property Owner of record: Douglas Yoffe 34 Follen Street LLC
50 Follen St. Cambridge Ma. 02138

Phone: 617-733-8031 Fax: 617-491-3460 E-mail: dougyoffe@gmail.com

Signature of Property Owner of Record: *Douglas Yoffe*

(for office use only): Date Application Received 9/9/15 Case Number: 3499 Hearing Date: 10/1/15

Type of Certificate Issued: _____ Date Issued: _____



34 FOLLEN STREET
CAMBRIDGE, MA

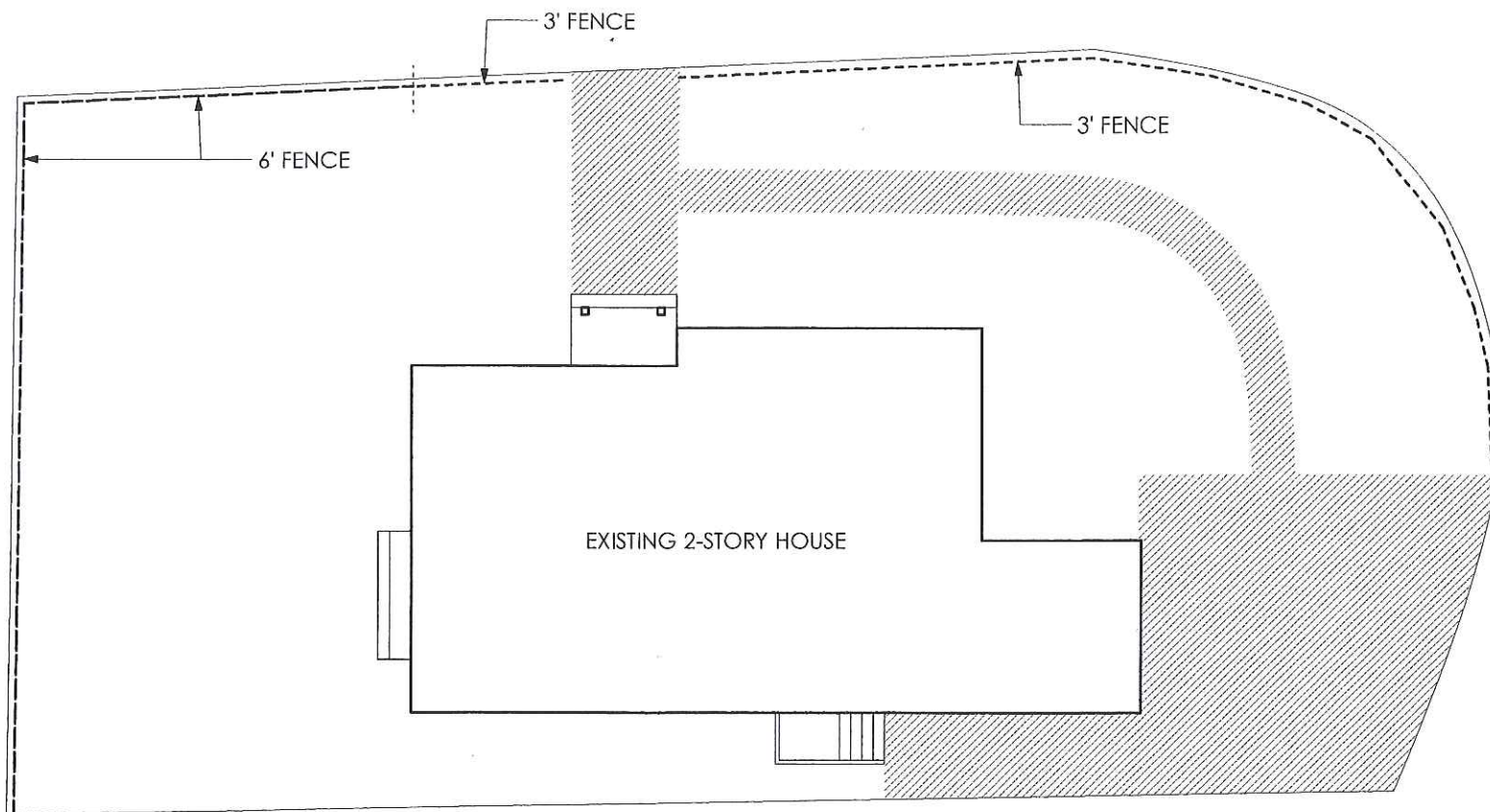

PROPOSED SITE
Scale: 1/8" = 1'-0"

RECEIVED
SEP 09 2015
CAMBRIDGE HISTORICAL COMMISSION

34 FOLLEN STREET
CAMBRIDGE, MA



(North)

FRONT EXTERIOR ELEVATION

Scale: 1/4" = 1'-0"

RECEIVED

PROPOSED

SEP 09 2015

CAMBRIDGE HISTORICAL COMMISSION

34 FOLLEN STREET
CAMBRIDGE, MA



(East)
DRIVEWAY SIDE EXTERIOR ELEVATION
Scale: 1/4" = 1'-0"

PROPOSED

RECEIVED

SEP 09 2015

CAMBRIDGE HISTORICAL COMMISSION

34 FOLLEN STREET
CAMBRIDGE, MA



(South)
REAR EXTERIOR ELEVATION
Scale: 1/4" = 1'-0"

RECEIVED

PROPOSED

SEP 09 2015

CAMBRIDGE HISTORICAL COMMISSION

34 FOLLEN STREET
CAMBRIDGE, MA



(West)

BACKYARD SIDE EXTERIOR ELEVATION

Scale: 1/4" = 1'-0"

PROPOSED

RECEIVED

SEP 09 2015

CAMBRIDGE HISTORICAL COMMISSION



Existing East Elev.



Existing (view from northeast)



Proposed East / NE



Existing West Elev.



Proposed West Elev.