

EXISTING PERSPECTIVE FROM HARVARD SQUARE

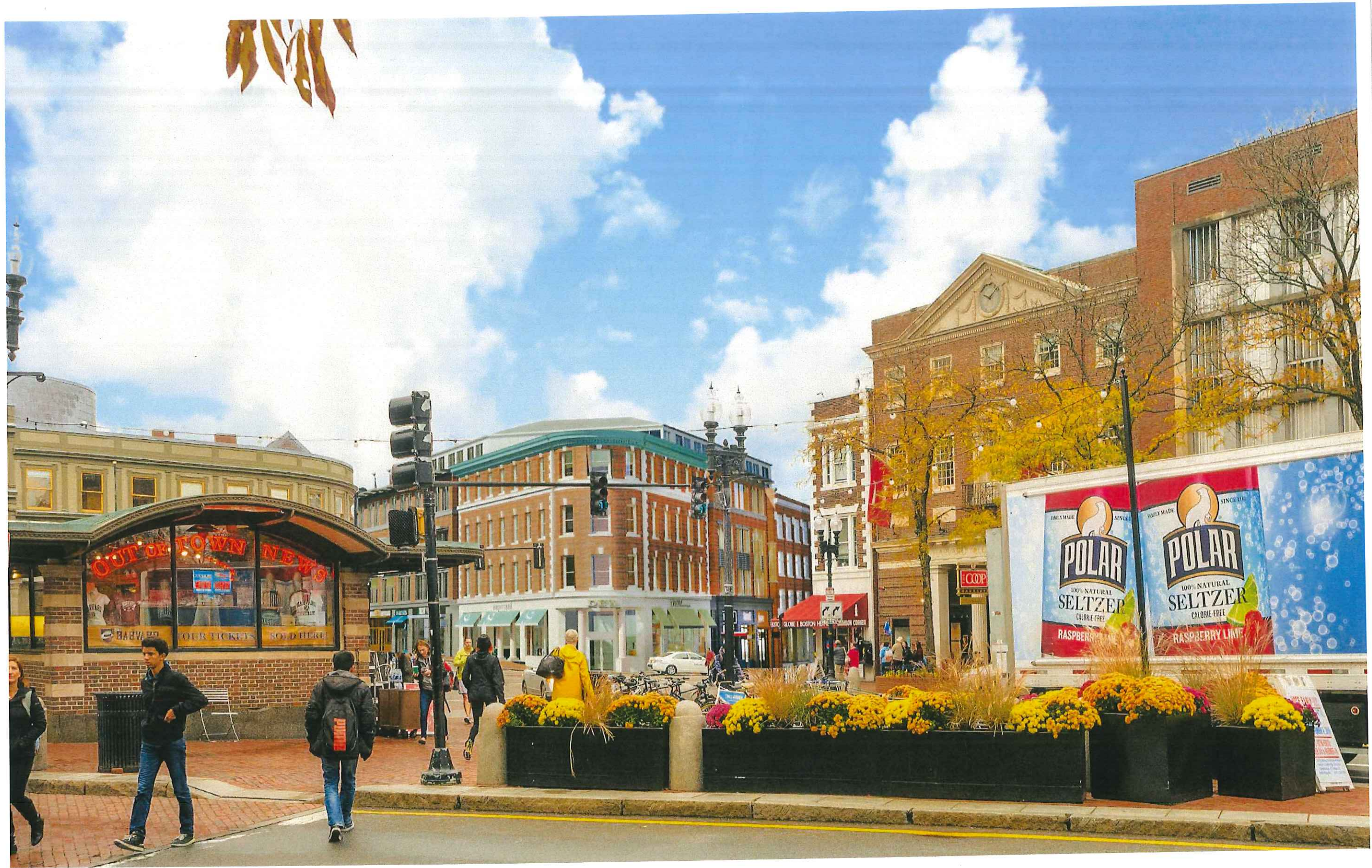

PROPOSED PERSPECTIVE FROM HARVARD SQUARE

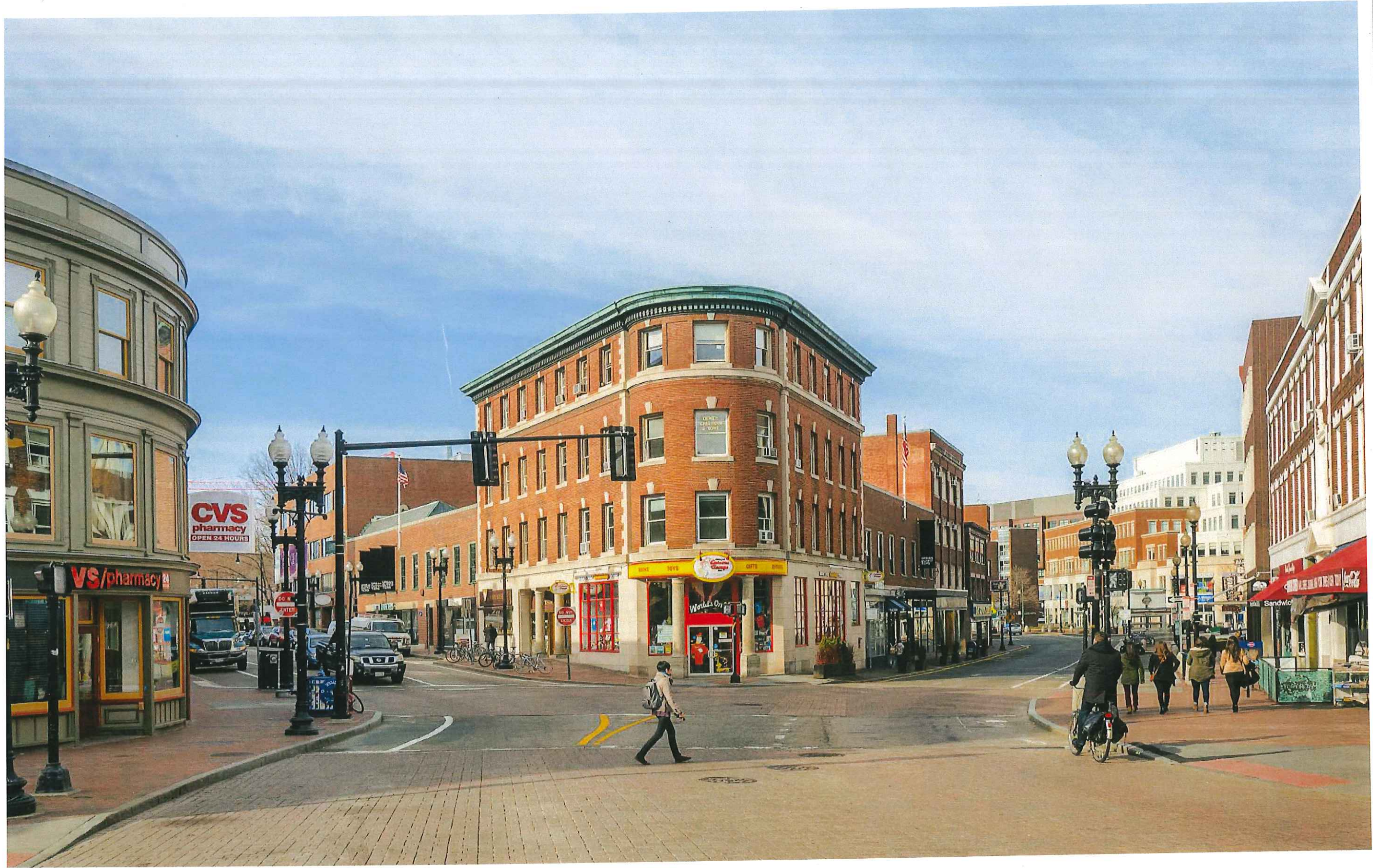

EXISTING PERSPECTIVE FROM HARVARD SQUARE



PROPOSED PERSPECTIVE FROM HARVARD SQUARE

The Collection at Harvard Square
HISTORIC COMMISSION

11.09.2016

Page 17





EXISTING PERSPECTIVE FROM HARVARD SQUARE



PROPOSED PERSPECTIVE FROM HARVARD SQUARE



EXISTING PERSPECTIVE FROM BRATTLE SQUARE



PROPOSED PERSPECTIVE FROM BRATTLE SQUARE

The Collection at Harvard Square
HISTORIC COMMISSION

11.09.2016

Page 21





EXISTING PERSPECTIVE FROM JFK STREET



PROPOSED PERSPECTIVE FROM JFK STREET



EXISTING AERIAL VIEW



PROPOSED AERIAL VIEW

The Collection at Harvard Square
HISTORIC COMMISSION

11.09.2016

Page 25



PROPOSED BRATTLE ST. ELEVATION



PROPOSED JFK ST. ELEVATION



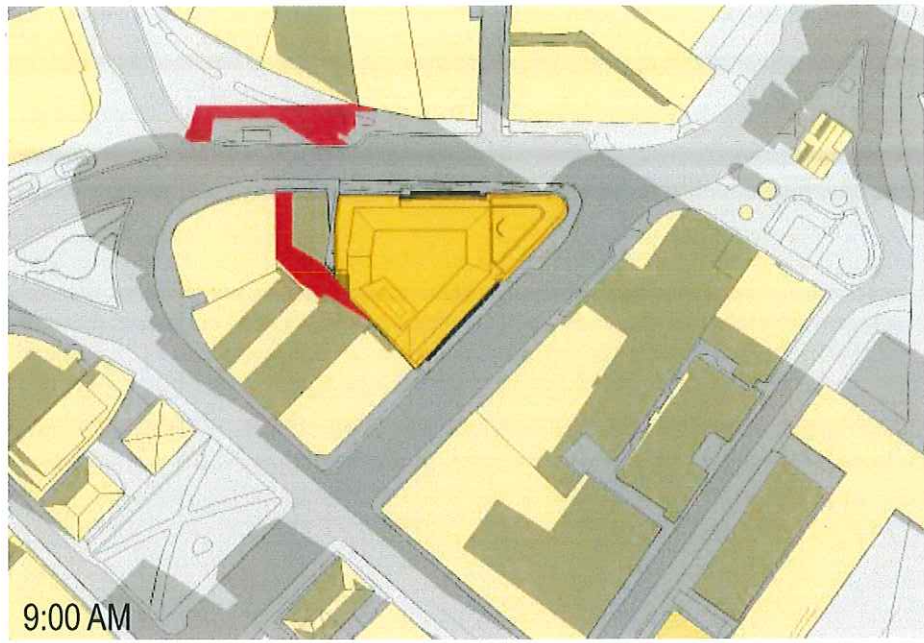

9:00 AM

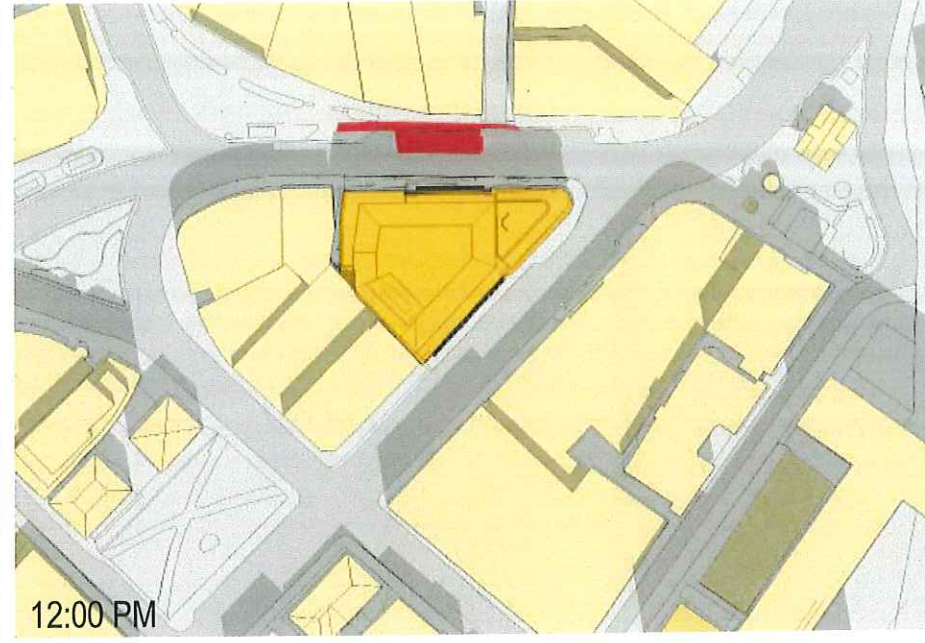

12:00 PM



3:00 PM

SHADOW STUDY: MARCH 21ST

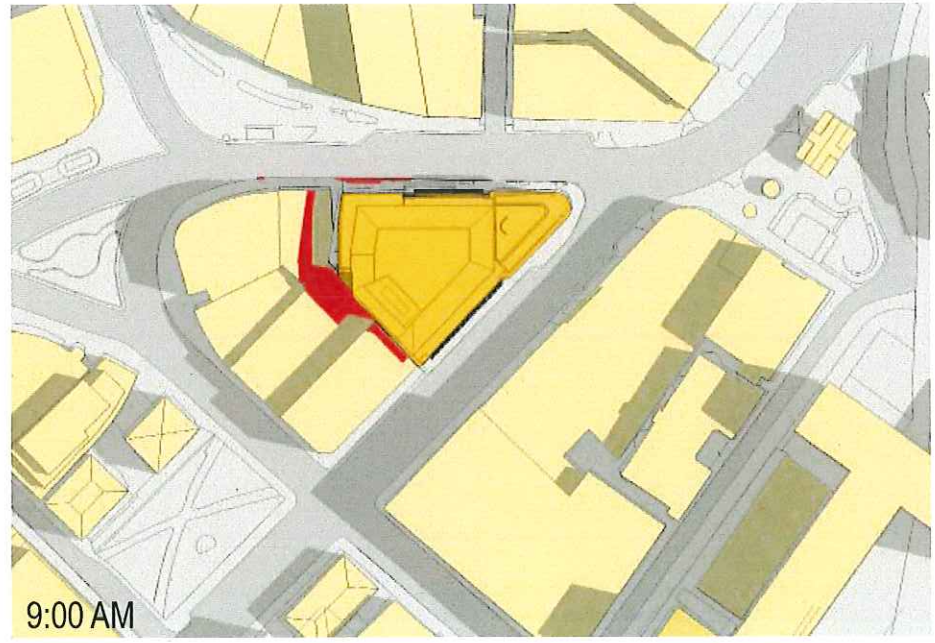

9:00 AM

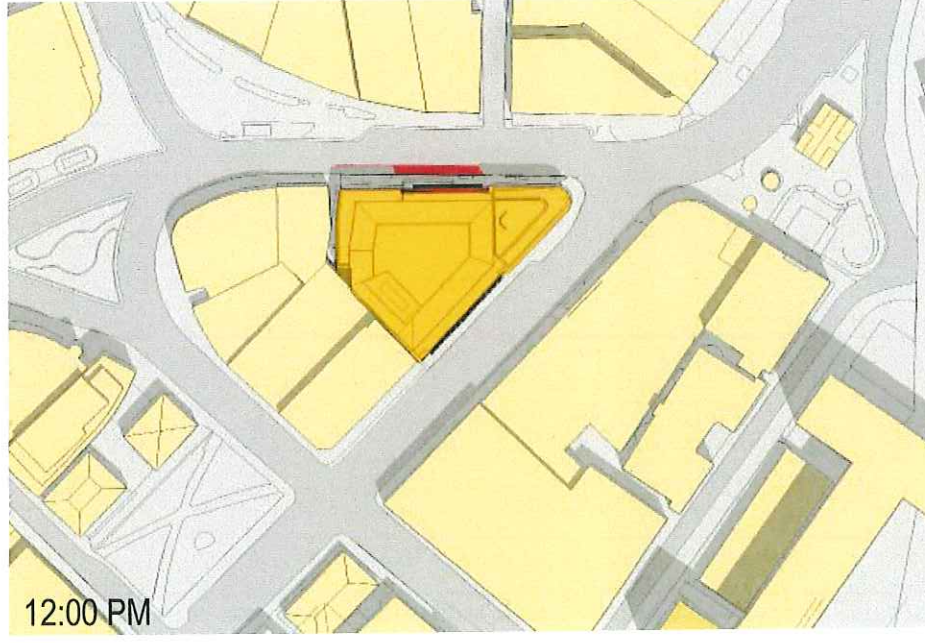



12:00 PM



3:00 PM

SHADOW STUDY: JUNE 21ST

 Additional shadow cast by proposed addition

 Shadow cast by existing building.

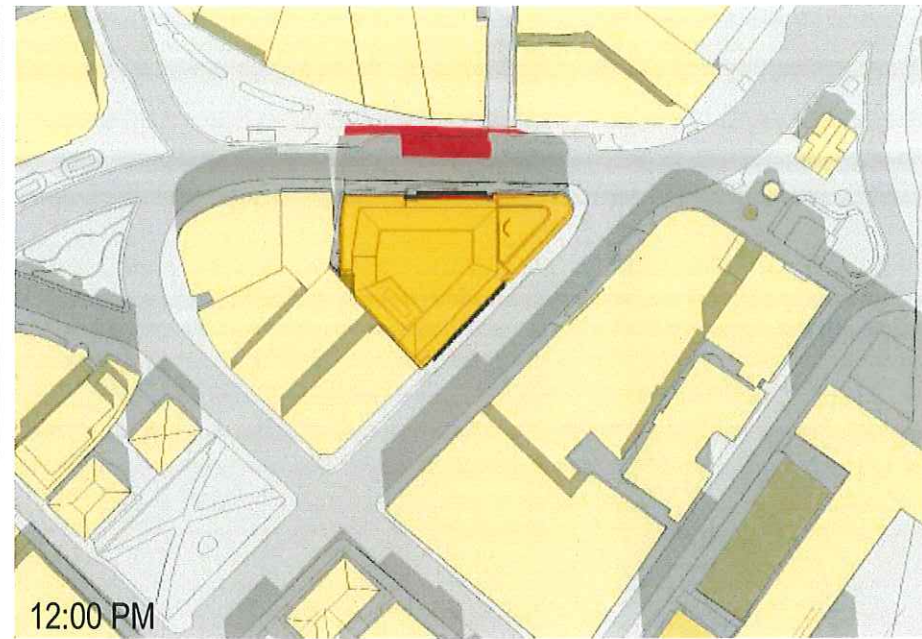
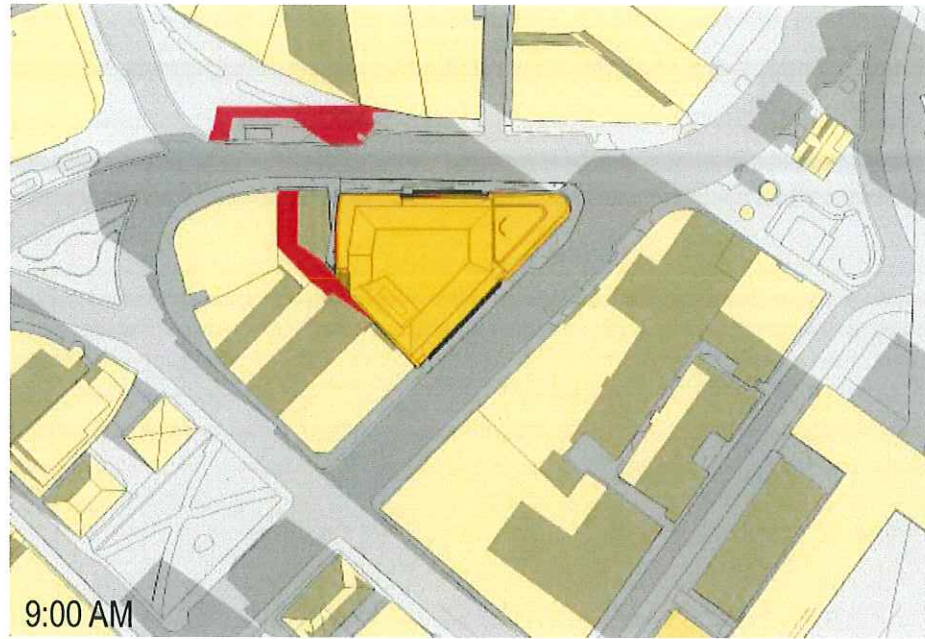

9:00 AM

12:00 PM

3:00 PM

SHADOW STUDY: SEPTEMBER 21ST

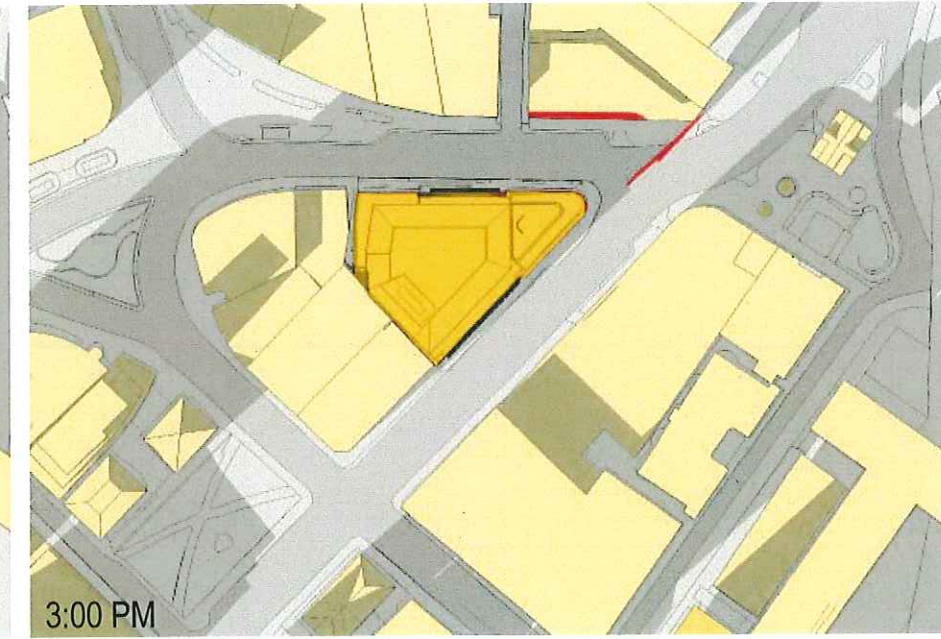
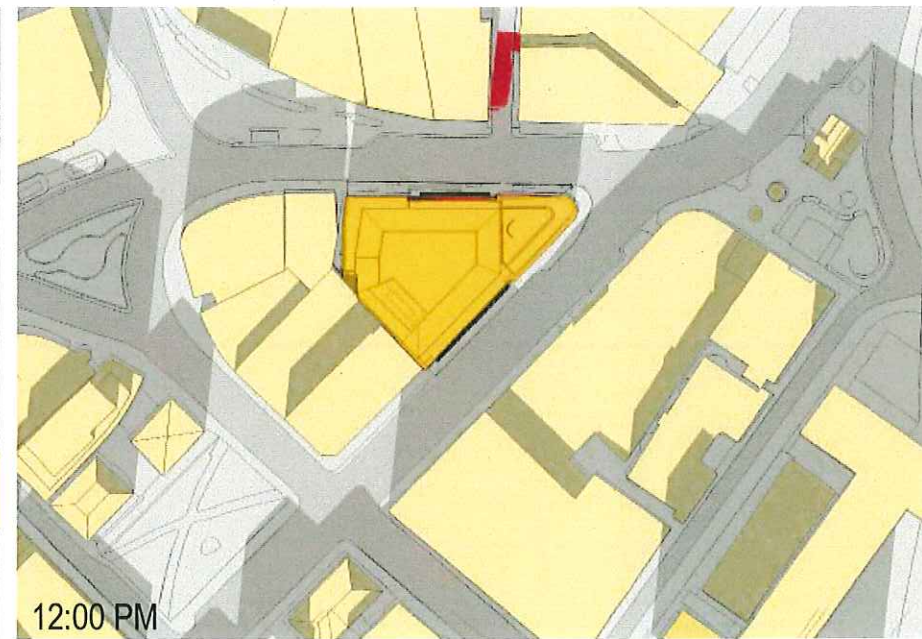



9:00 AM

12:00 PM

3:00 PM

SHADOW STUDY: DECEMBER 21ST

 Additional shadow cast by proposed addition

 Shadow cast by existing building.

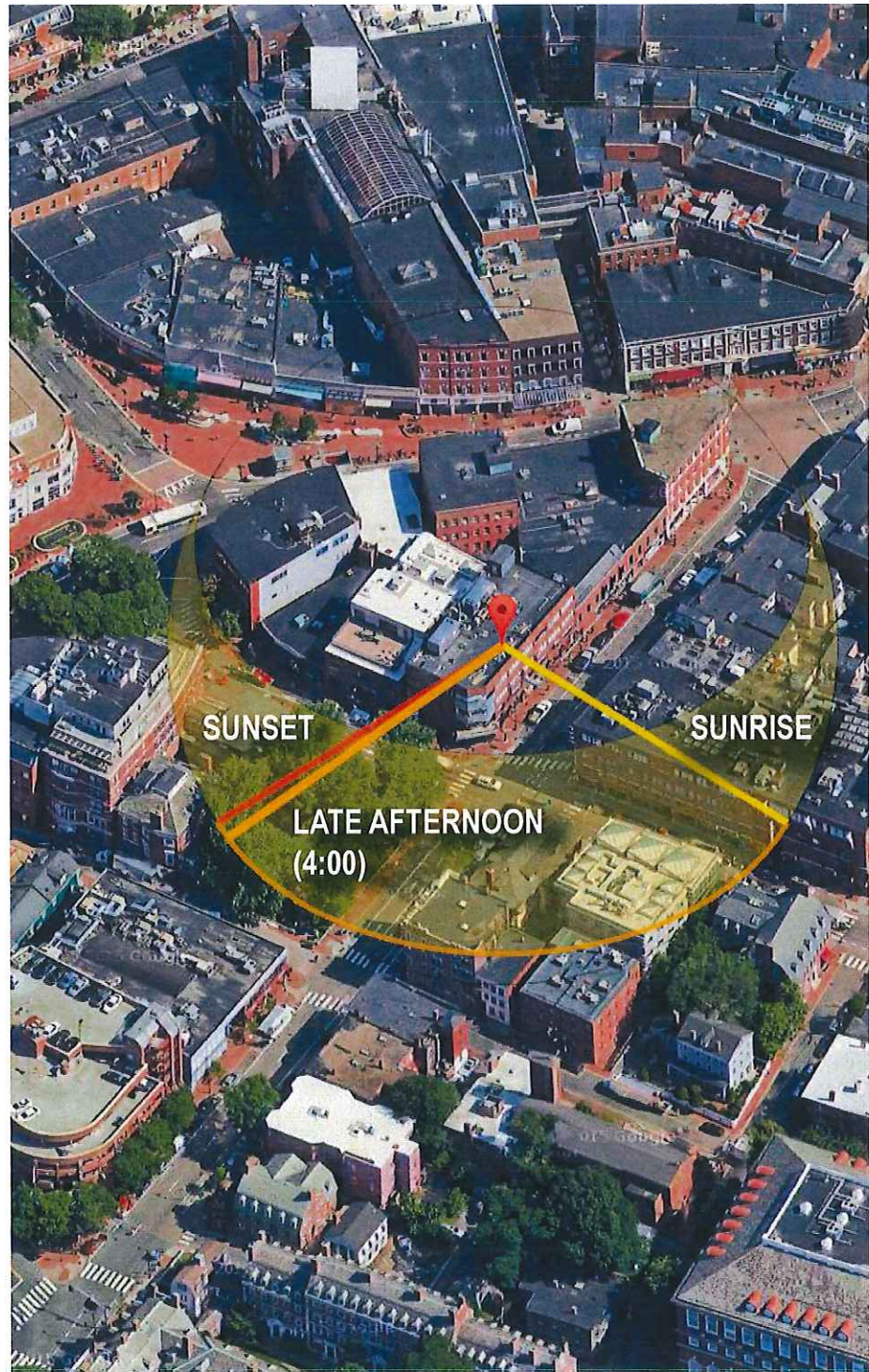

SUNPATH: DECEMBER 21ST

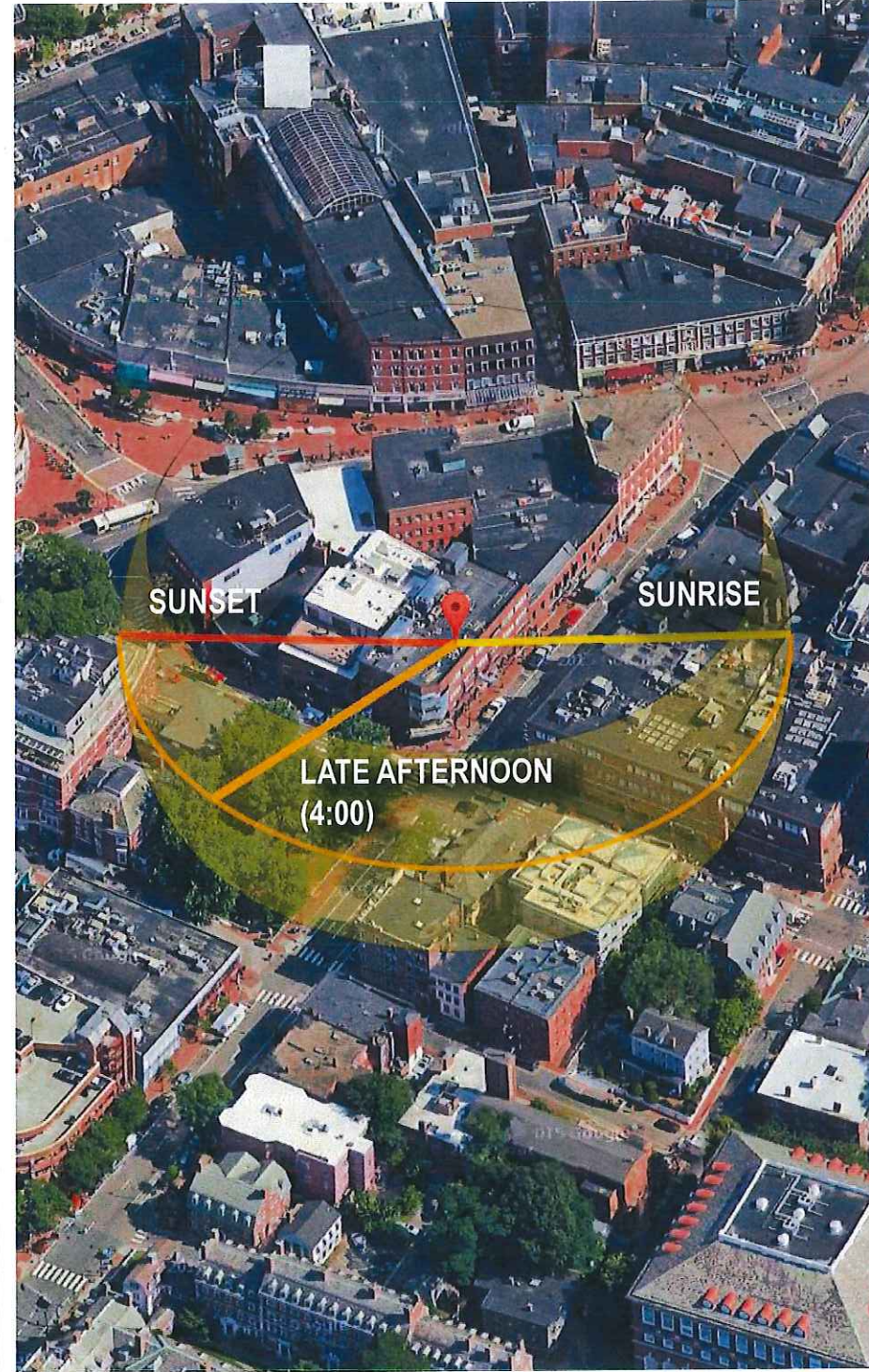

SUNPATH: MARCH/SEPTEMBER 21ST

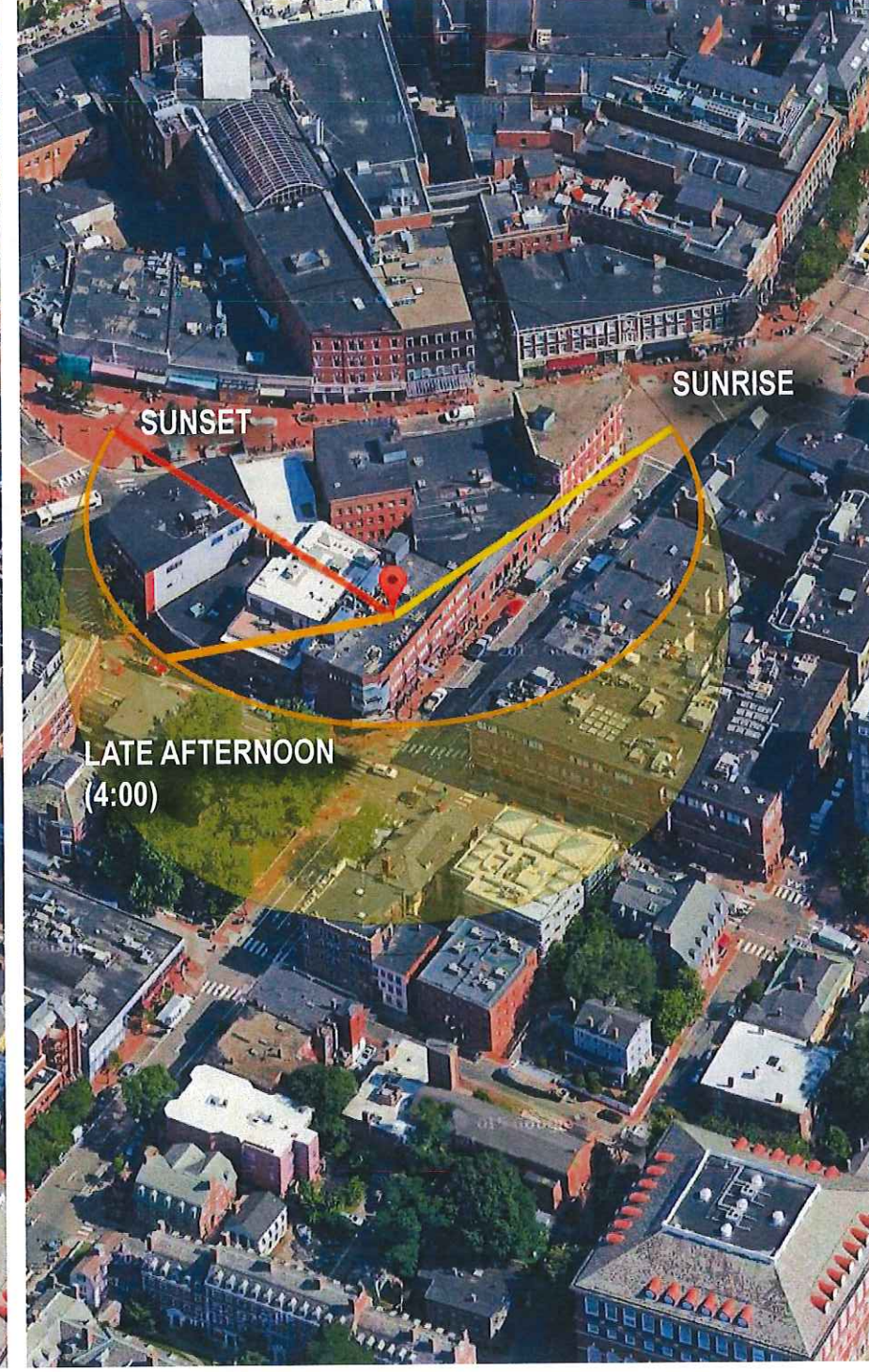

SUNPATH: JUNE 21ST

SUN PATH ANALYSIS

PCA

Architecture Planning Interiors
221 Hampshire Street Cambridge MA 02139
t: 617-547-8120 e: 617-661-4986
www.prelwiltzchinski.com

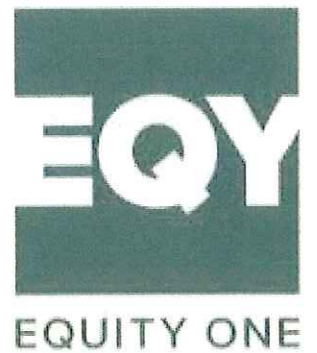

THE COLLECTION AT HARVARD SQUARE

HARVARD SQUARE, CAMBRIDGE, MA

APPENDIX: 11/09/2016 - LEASING PLAN OPTIONS



LEVEL 1 - LEASING OPTION A

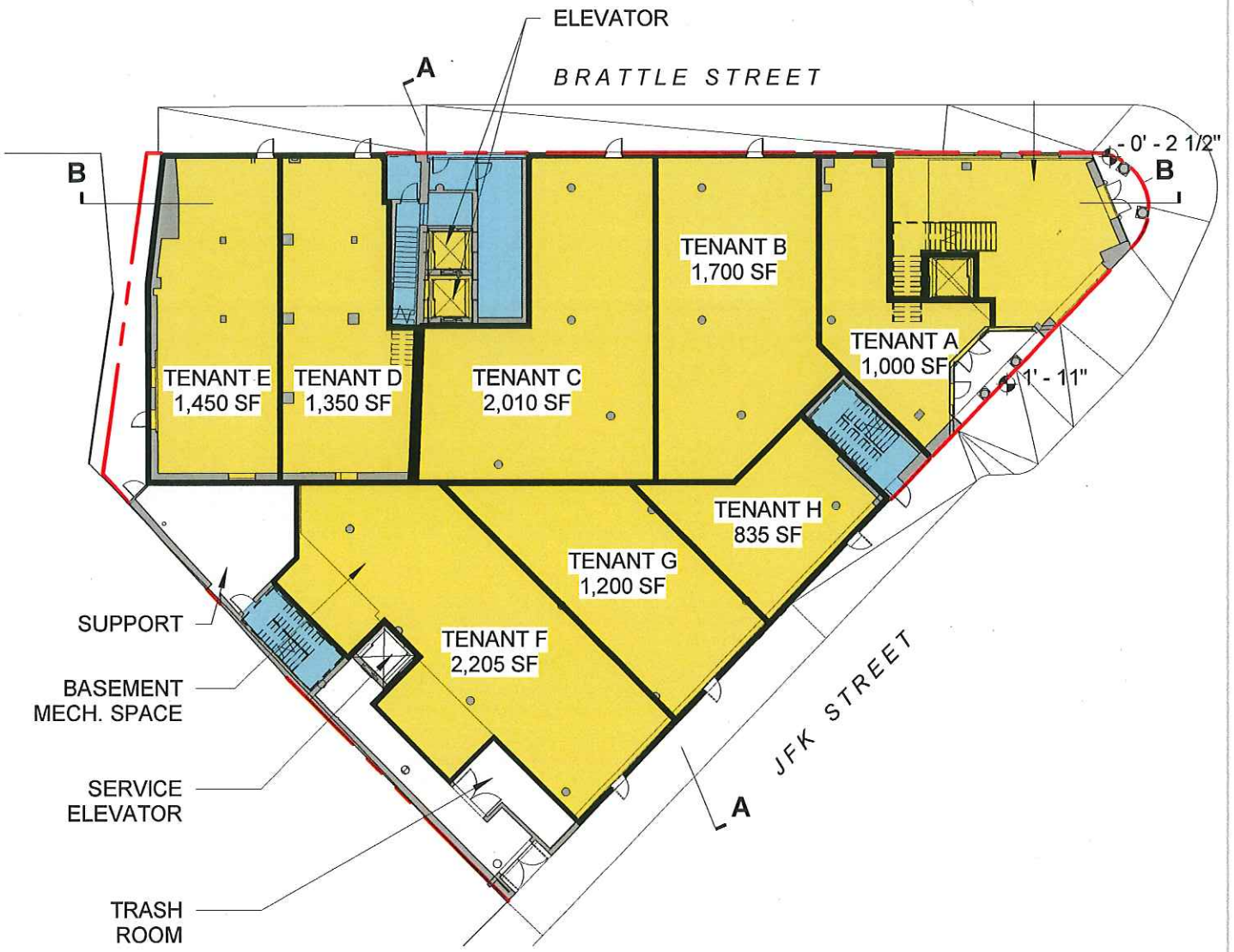

LEVEL 1 - LEASING OPTION B

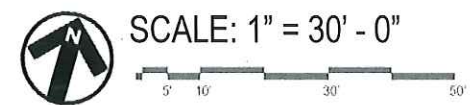

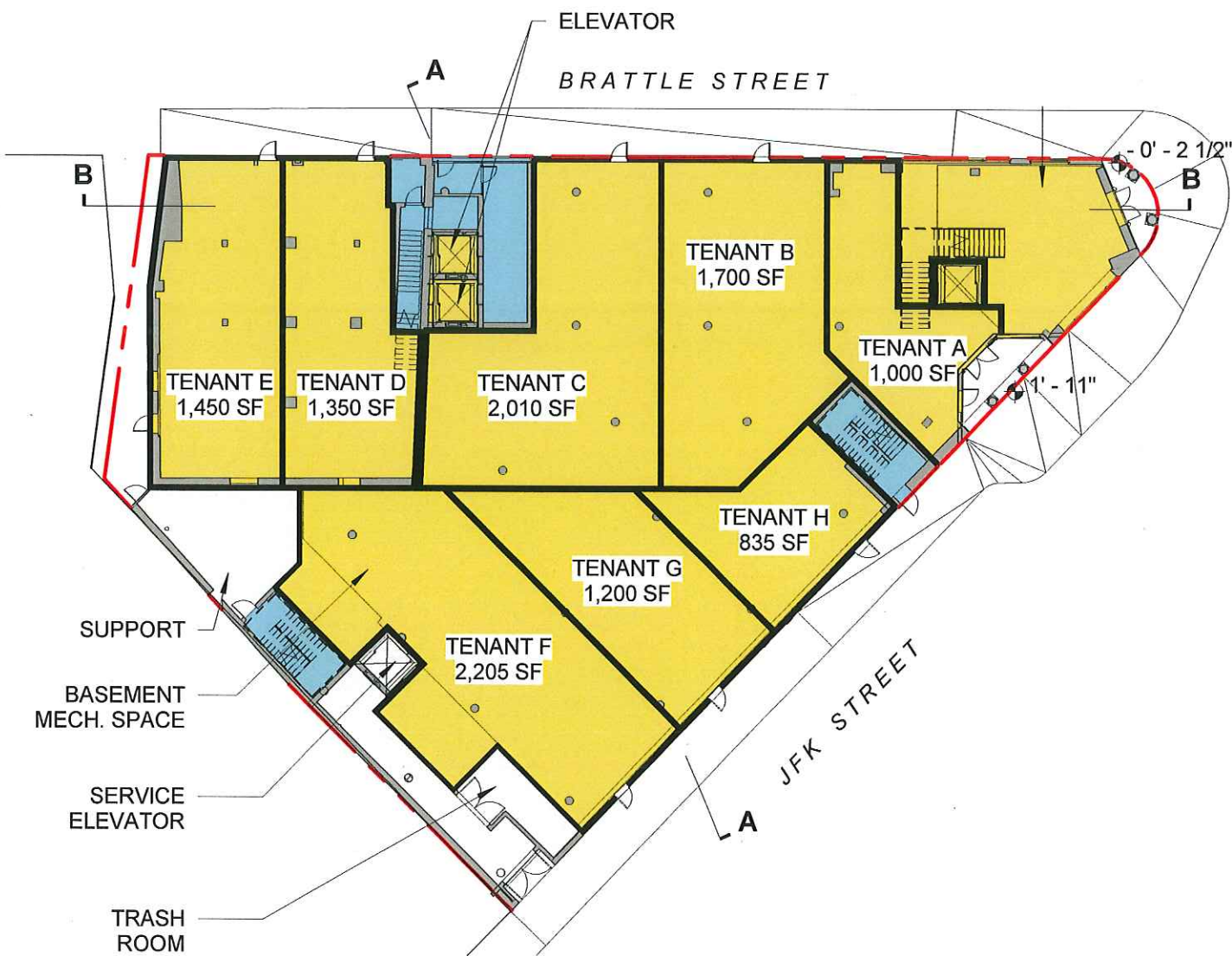

LEVEL 1 - LEASING OPTION C



LEVEL 1 - LEASING OPTION D



The Collection at Harvard Square
HISTORIC COMMISSION

APPENDIX: 11.09.2016

Page 32