



CAMBRIDGE HISTORICAL COMMISSION

831 Massachusetts Avenue, 2nd Fl., Cambridge, Massachusetts 02139
Telephone: 617 349 4683 TTY: 617 349 6112
E-mail: histcomm@cambridgema.gov URL: www.cambridgema.gov/Historic

APPLICATION FOR CERTIFICATE

1. The undersigned hereby applies to the Cambridge Historical Commission for a Certificate of (check one box): Appropriateness, Nonapplicability, or Hardship, in accordance with Chapter 40C of the Massachusetts General Laws and/or Chapter 2.78 of the Municipal Code.
2. Address of property: 3 Church Street; 1444 Mass Ave, Cambridge, Massachusetts
3. Describe the proposed alteration(s), construction or demolition in the space provided below: (An additional page can be attached, if necessary).

Change a pair of narrow doors to a single door at the Zero Church Street entrance/egress to First Parish Church. Existing c.1955 glazed "french door" style doors are damaged and need to be replaced with a ne secure door for use as the entry and exit from the Y2Y youth homeless shelter at the lower auditorium level of the meetinghouse.

One 36" wide 4-panel wood stile and rail door with upper glazed panels, dark bronze exit hardware is flanked by wall panels with trim molding aligned with the door panels. The replacement door and infill jambs are painted to match existing red doors of the church.

The existing narrow concrete step at the door threshold will be overlaid with composite board decking, projecting 44" from the face of the out-swing exit door. The projecting step is returned to the existing buttresses to avoid sidewalk trip hazard and to allow for a wall-mounted iron handrail.

I certify that the information contained herein is true and accurate to the best of my knowledge and belief. The undersigned also attests that he/she has read the statements printed on the reverse.

Name of Property Owner of Record: First Parish Church Unitarian

Mailing Address: 3 Church Street

Telephone/Fax: 617-876-7772

E-mail: clewis@firstparishcambridge.org

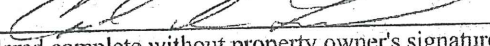
Signature of Property Owner of Record: 
(Required field; application will not be considered complete without property owner's signature)

Name of proponent, if not record owner: David W. Torrey AIA

Mailing Address: Torrey Architecture, Inc., 75 Kneeland St 3rd Fl., Boston, MA 02111

Telephone/Fax: 617-227-1477 ext 111

E-mail: david@torreyarchitecture.com

(for office use only):

Date Application Received: 5/14/19 Case Number: 4115 Hearing Date: 6/6/19

Type of Certificate Issued: _____ Date Issued: _____

HARRING
DOOR

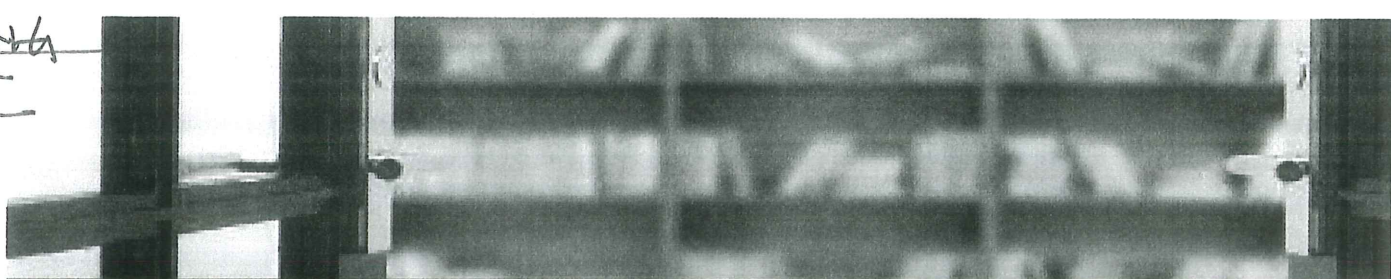

ASPIRO™ SERIES | HARRING®

AUTHENTIC STILE & RAIL DOORS

Make a Statement with Every Opening



Traditional and beautiful stile and rail construction that creates enduring beauty in any space.

Harring Authentic Stile & Rail doors offer architecturally crafted doors that range from custom statements to functional solutions.

The Aspiro Series embodies the highest aesthetic and performance qualities and are ideal for use in spaces that will create the most impactful experience.

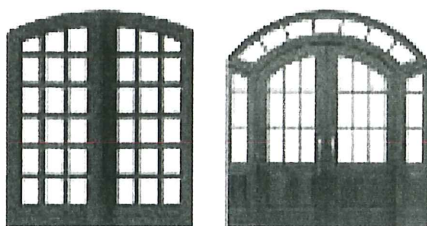

CUSTOM CONSTRUCTIONS

Our flexibility in tooling, manufacturing and equipment - paired with a creative team capable of building outside the norm - means we can produce a wide range of custom width, height and thicknesses for our door constructions.

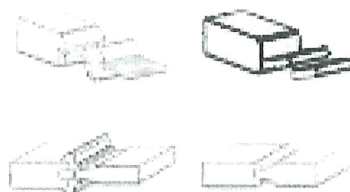

CUSTOM PROFILED CONSTRUCTIONS

Our versatility allows us to provide both standard and custom profiles.

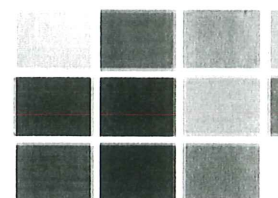

Standard Stain Options

CUSTOM VENEERS & STAINS

We work with a variety of domestic and exotic veneer species & stain options for your project a custom fit

A104

HARBING DOORS

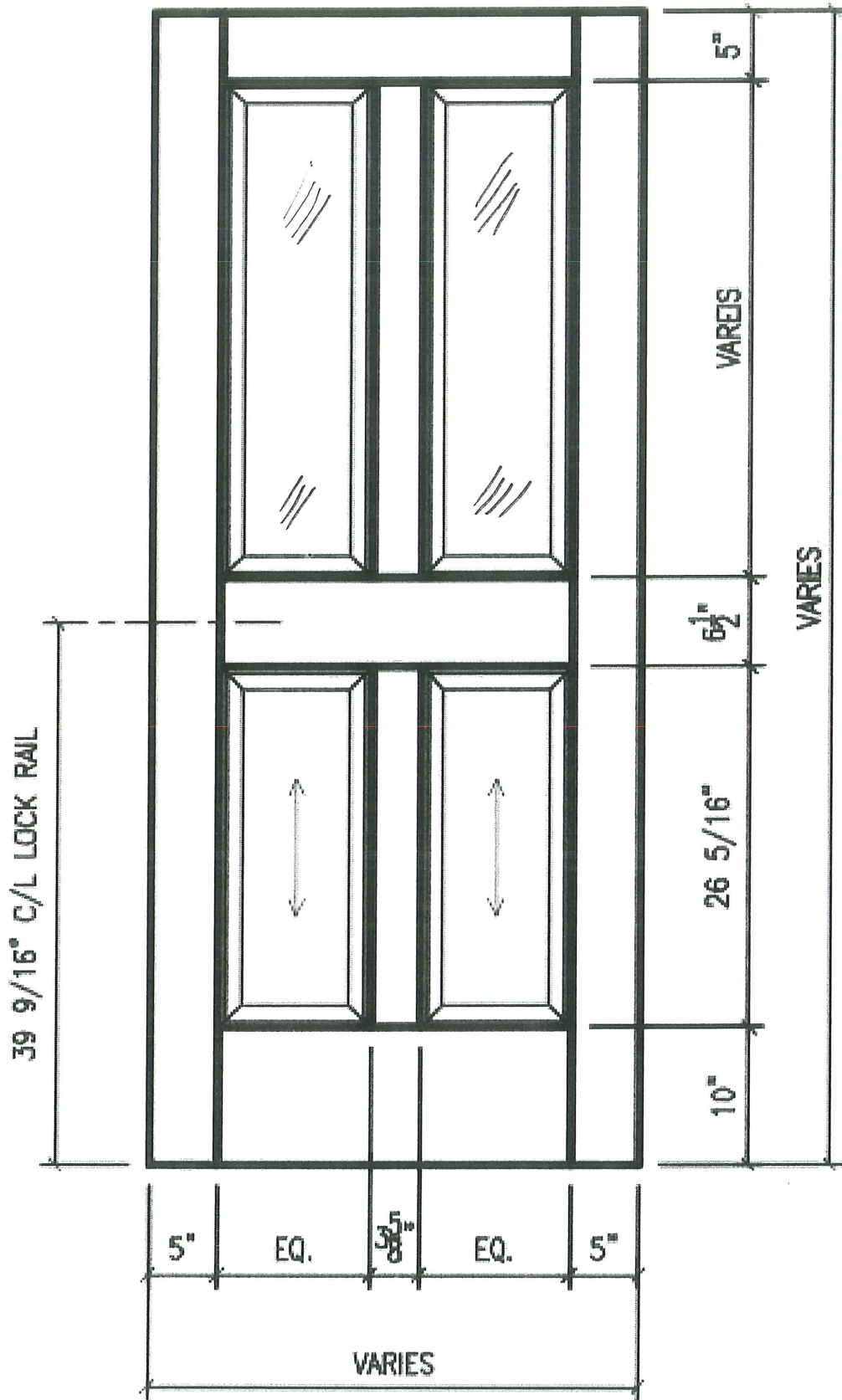

DOOR HARDWARE
VON DUPRIN
OIL-RUBBED BRONZE

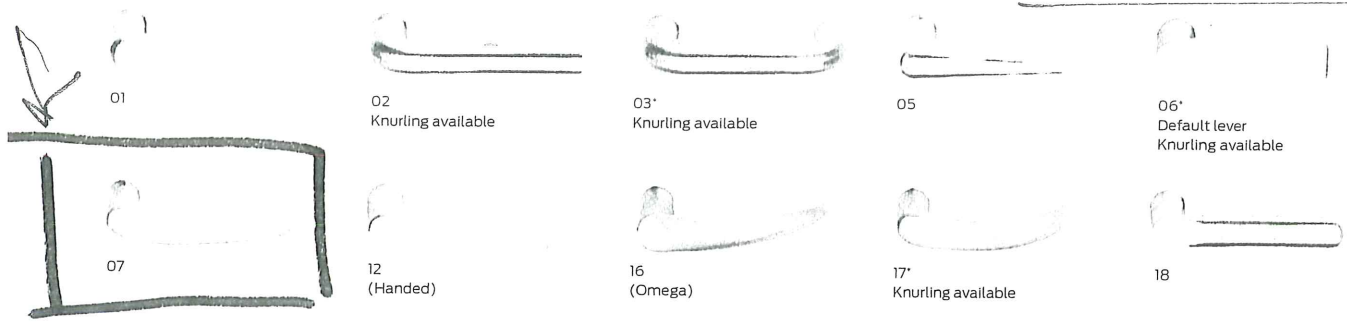

The universal center case provides a simple path to new technology without the cost of replacing the entire device. Whether it's adding trim, switching handing or introducing new features, Von Duprin makes it simple with a wide variety of upgradeable kits for the 98/99 Series. In addition to evolving with security needs, Von Duprin' exit devices are manufactured to meet the highest performance and safety standards.

Passion driving performance

With superior products comes exceptional customer care. Von Duprin customers are supported by industry-leading expertise. Allegion's representatives average more than 15 years of experience, so you're assured to receive knowledgeable advice on fire and life safety codes, installation resources and more. And for those looking to take their skills to the next level, Allegion offers instructor-led workshops, videos and online courses. It's another way Von Duprin stands by our customers—today, tomorrow and for years to come.

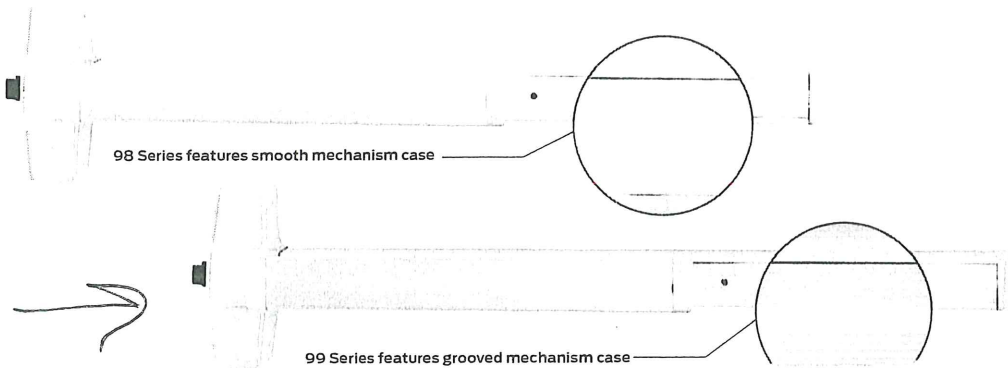

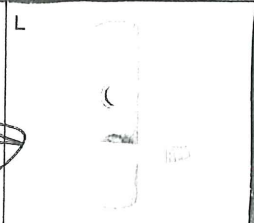
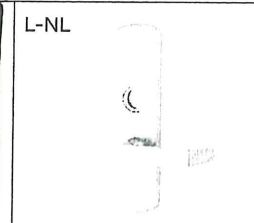
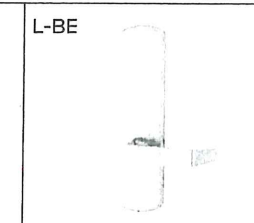
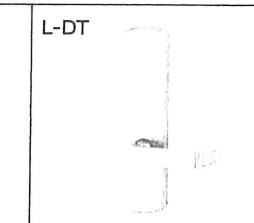
	L	L-NL	L-BE	L-DT
				
	Lever Key locks and unlocks	Lever – night latch Key retracts latchbolt	Lever – blank escutcheon Always operable (no cylinder)	Lever dummy trim pull when dogged
Product description	98L 99L	98L-NL 99L-NL	98L-BE 99L-BE	98L-DT 99L-DT
Trim description	996L-R/V*	996L-NL-R/V	996L-BE-R/V*	996L-DT
Escutcheon plate size	2 ³ / ₄ " x 10 ³ / ₄ " x 2 ⁷ / ₃₂ " (70x273x21mm)	2 ³ / ₄ " x 10 ³ / ₄ " x 2 ⁷ / ₃₂ " (70x273x21mm)	2 ³ / ₄ " x 10 ³ / ₄ " x 2 ⁷ / ₃₂ " (70x273x21mm)	2 ³ / ₄ " x 10 ³ / ₄ " x 2 ⁷ / ₃₂ " (70x273x21mm)
Pull center to center	—	—	—	—
Projection	2 ⁷ / ₈ " (73mm)	2 ⁷ / ₈ " (73mm)	2 ⁷ / ₈ " (73mm)	2 ⁷ / ₈ " (73mm)
ANSI function	08	03	14	02
Cylinder type	Rim	Rim	—	—
Handing	Handed/Reversible	Handed/Reversible	Handed/Reversible	Handed/Reversible
Optional #425 SNB quantity for device	2	2	2	2

* Electrified lever operation available

Rim exit device

■ STAINLESS Type 304 (18-8), 20' lengths, except as noted ■ STEEL C1010, 20' lengths

Scale: 6" = 1'-0", except as noted

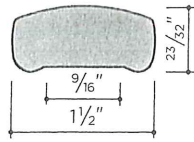

■ **6503** Stainless 2.54 lb/ft
No fittings available
16' lengths

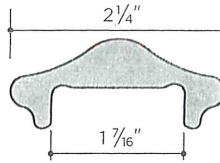

■ **6513** Stainless 2.85 lb/ft
Fittings: N

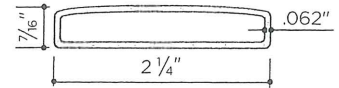

■ **6512** Stainless 1.00 lb/ft
Fittings: N

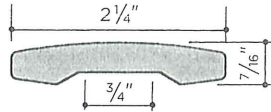

■ **6502** Stainless 2.80 lb/ft
No fittings available
16' lengths

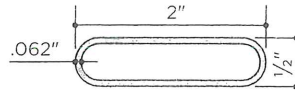

■ **4488** Stainless .944 lb/ft
Fittings: N Suitable for elevator cab handrails

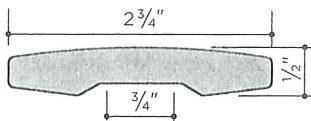

■ **6501** Stainless 4.05 lb/ft
No fittings available
16' lengths

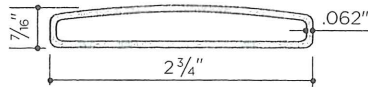

■ **6511** Stainless 1.25 lb/ft
Fittings: N

Steel mouldings are hot-rolled carbon steel, C1010. Fittings are cast in malleable iron, making them weldable and bendable.

Symbols and Letter Designations for Stainless Steel Handrail Fittings

When specifying a fitting, add fitting designation to handrail moulding number (e.g. 4488-B-N).

See page 117 for available channel sizes.

STAINLESS

C		Corner Bend
N		Square End Piece

Symbols and Letter Designations for Steel Handrail Fittings

When specifying a fitting, add fitting designation to handrail moulding number (e.g. 4441-V).

See page 111 for available channel sizes.

MALLEABLE IRON

B		Bevel Lamb's Tongue
C		Corner Bend
CC		Channel Corner Bend
CL		Left Channel Lateral Scroll
CR		Right Channel Lateral Scroll
F		Terminal

TRADITIONAL RAILING COMPONENTS

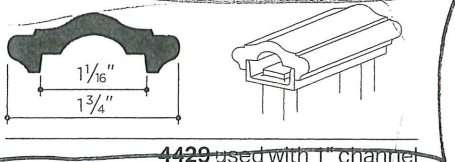

4429 used with T channel

■ **4429** Prime Domestic Steel 1.50 lb/ft
Fittings: B-C-CC-CL-CR-E-F-GL-GR-JL-JR-L-N-S-SL-SR-T-U-UC-UL-V

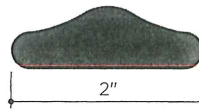

■ **4416** Steel 3.15 lb/ft
No fittings available

Loafer Rail



HANDRAIL FITTINGS

■ ALUMINUM ■ BRONZE ■ NICKEL-SILVER ■ MALLEABLE IRON / STEEL

HANDRAIL FITTINGS

Satin finish, except as noted. Bronze and nickel-silver fittings are lacquered.
See pages 39-40 for specific fittings availability.

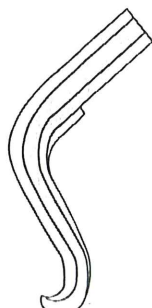

B Bevel Lamb's Tongue

4441-B

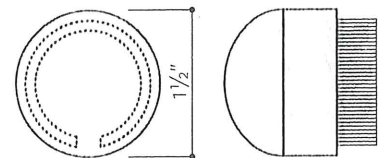
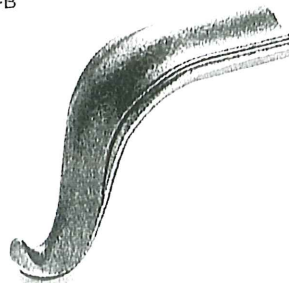

D Domed End Cap

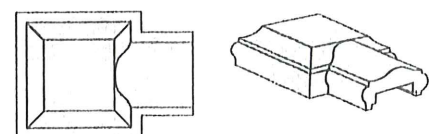

F Terminal

TRADITIONAL

TORREY ARCHITECTURE

75 Kneeland Street
 Boston, MA 02111
 617-227-1477
www.torreyarchitecture.com

STRUCTURAL ENGINEER
 Structures North Consulting Engineers, Inc
 69 Washington Street, Suite 401
 Salem, MA 01970
 978-745-8817

MECHANICAL/PLUMBING/ELECTRICAL ENGINEER
 Nanan Stani Engineering, Inc
 43 Bradford Street
 Concord, MA 01742-2972
 781-399-2250

SITE SURVEYORS
 DGT Associates Surveying and Engineering
 603 Summer Street, 1st Floor
 Boston, MA 02127
 617-275-0541

HAZARDOUS MATERIAL CONSULTANT
 Fuss & O'Neil
 108 Myrtle Street, Suite 502
 Quincy, MA 02171
 617-282-2409

STEEPLEJACK/CONTRACTOR
 American Steeple & Tower
 378 Essex Street
 Salem, MA 01970
 978-744-7194

No.	Description	Date
	EXISTING CONDITIONS	04/18/19

FIRST PARISH
 CAMBRIDGE, MA

ZERO CHURCH STREET
 ENTRANCE VIEW,
 BEFORE AND AFTER
 5-16-19 CHC
 SUBMISSION

REMOVE EXISTING
 LOUDSPEAKER AND
 LIGHT FIXTURES

INSTALL TWO WALL
 LANTERN LIGHT
 FIXTURES TO MATCH
 AT 3 CHURCH STREET
 ENTRANCE

EXISTING SIGN,
 WINDOW AND
 PAINTED ARCH
 TRIMWORK TO
 REMAIN

REMOVE TWO
 BULLETIN CABINETS,
 INSTALL NEW SIGN

REPLACEMENT DOOR
 AND PANEL-TRIMMED
 SIDEWALLS, PAINTED
 TO MATCH EXISTING
 FRONT ENTRY DOOR

VON DUPRIN
 ENTRANCE/EGRESS
 HARDWARE, OIL-
 RUBBED BRONZE
 FINISH

WALL-MOUNTED IRON
 HANDRAIL

PAINTED WOOD
 DECKING LANDING
 PLATFORM OVER
 EXISTING CONCRETE
 STEP

