

UTILITY KEY PLAN		
ALIGNMENT	LAYOUT AREA	UTILITY CONSTRUCTION PLAN
CONCORD AVE	1	U-1
	2	U-2
	3	U-3
	4	U-4
BAY STATE RD, FIELD ST, FAYERWEATHER ST	5	U-5
	6	U-6
	7	U-7
BIRCH ST	8	U-8
FERN ST	9	U-9
C. BURNS RD	10	U-10
ALPINE ST, GARDEN ST	11	U-11
	12	U-12
	13	U-13
CHILTON ST	14	U-14
	15	U-15
FAYERWEATHER ST	16	U-16
WALDEN ST	17	U-17
SAVILLE ST	18	U-18
COPLEY ST	19	U-19
HAZEL ST	20	U-20
IVY ST	21	U-21

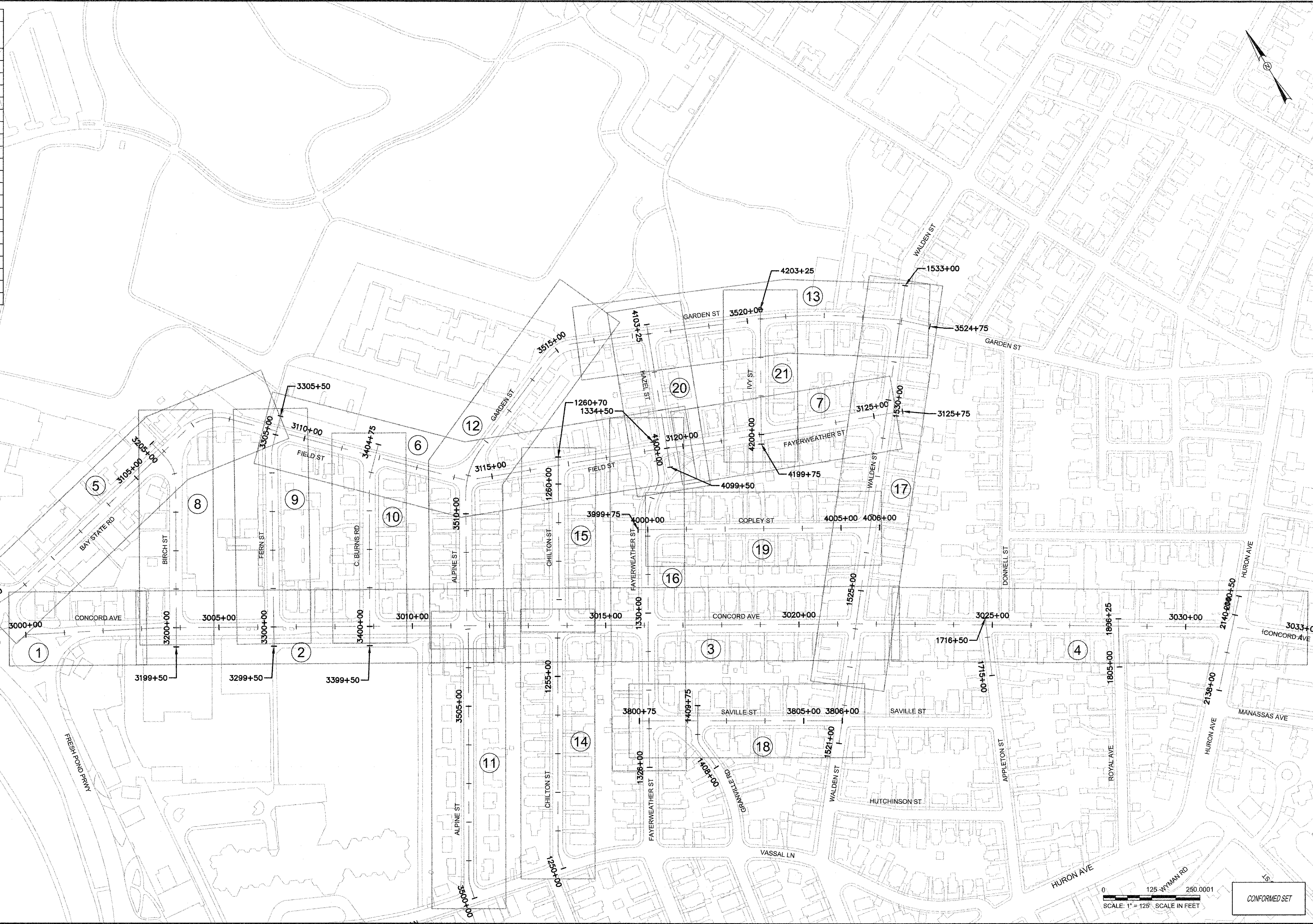

CAD FILE: G:\clients\cambridge\MA\2012566\01-A-Concord Ave (Contract 9)\Drawings\Civil\Detail\2012566\001A\_UG-Keyplan.dwg  
 LAYOUT: Utility Keyplan\_PLOTTED: 2/12/2014 2:48 PM BY: hys hargis

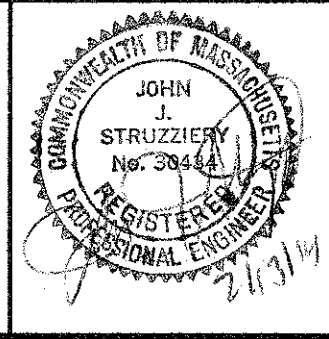

Scale	AS NOTED		
Date	FEBRUARY 2014		
Job No.	20120256.001A		
Designed by	TAL/JRB/FMM		
Drawn by	KJL/DRM/BMS/DRB		
Checked by	CMC/TJR	No.	Description
Approved by	BJM		Date
REVISIONS			

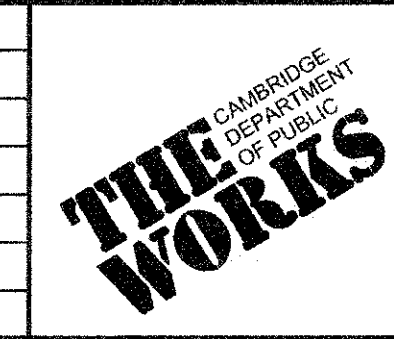

Client	CITY OF CAMBRIDGE, MASSACHUSETTS
Project	CONCORD (CONTRACT 9) SEWER SEPARATION AND SURFACE IMPROVEMENTS PROJECT
Drawing	UTILITY GENERAL UTILITY KEYPLAN

Sheet	UG-1
File No.	6228

0 125 250.0001  
 SCALE: 1" = 125' SCALE IN FEET

CONFORMED SET

# TEST PIT SCHEDULE

CONCORD AVENUE			
TEST PIT #	STREET	STATION	REASON FOR TEST PIT
TP-101	CONCORD AVE	3000+34, 13' L	CONFIRM LOCATION OF WATER SERVICE
TP-102	CONCORD AVE	3001+57, 12' L	CONFIRM LOCATION OF WATER SERVICE
TP-103	CONCORD AVE	3002+09, 13' L	CONFIRM LOCATION OF WATER SERVICE
TP-104	CONCORD AVE	3002+53, 11' L	CONFIRM LOCATION OF WATER SERVICE
TP-105	CONCORD AVE	3002+96, 10' L	CONFIRM LOCATION OF WATER SERVICE
TP-106	CONCORD AVE	3003+27, 16' R	LOCATE ELECTRIC AND TELECOM TO VERIFY CLEARANCE FOR DROP INLET AND DRAIN MANHOLE
TP-107	CONCORD AVE	3003+56, 8' L	CONFIRM LOCATION OF WATER SERVICE
TP-108	CONCORD AVE	3003+80, 14' R	LOCATE ELECTRIC AND TELECOM TO VERIFY VERTICAL CLEARANCE AND COVER FOR WATER MAIN
TP-109	CONCORD AVE	3004+41, 6' L	CONFIRM LOCATION OF WATER SERVICE
TP-110	CONCORD AVE	3004+92, 7' L	LOCATE TELECOM TO VERIFY CLEARANCE FOR SEWER MANHOLE
TP-111	CONCORD AVE	3004+92, 18' R	LOCATE TELECOM, ELECTRIC AND WATER TO VERIFY CLEARANCE FOR SEWER SERVICE
TP-112	CONCORD AVE	3005+12, 17' R	LOCATE TELECOM, ELECTRIC AND WATER TO VERIFY CLEARANCE FOR DRAIN LATERAL AND SERVICE
TP-112A	CONCORD AVE	3005+12, 24' R	CONFIRM ALIGNMENT OF WATER MAIN RELOCATION AROUND DRAIN MANHOLE
TP-113	CONCORD AVE	3005+25, 7' L	LOCATE TELECOM TO VERIFY CLEARANCE FOR CATCH BASIN AND DRAIN LATERAL
TP-114	CONCORD AVE	3005+30, 14' R	LOCATE TELECOM AND ELECTRIC TO VERIFY CLEARANCE FOR DRAIN MANHOLE AND DRAIN LATERALS
TP-115	CONCORD AVE	3006+49, 15' R	LOCATE TELECOM AND ELECTRIC TO VERIFY VERTICAL CLEARANCE AND COVER FOR WATER MAIN
TP-116	CONCORD AVE	3006+49, 15' L	LOCATE TELECOM AND ELECTRIC TO VERIFY VERTICAL CLEARANCE AND COVER FOR WATER MAIN
TP-117	CONCORD AVE	3006+80, 8' L	CONFIRM LOCATION OF WATER SERVICE
TP-118	CONCORD AVE	3007+11, 20' R	LOCATE ELECTRIC AND WATER TO VERIFY CLEARANCE FOR DROP INLET AND DRAIN PIPE
TP-119	CONCORD AVE	3007+23, 8' L	CONFIRM LOCATION OF WATER SERVICE
TP-120	CONCORD AVE	3007+64, 8' L	CONFIRM LOCATION OF WATER SERVICE AND LOCATE TELECOM
TP-121	CONCORD AVE	3007+69, 20' R	LOCATE ELECTRIC AND WATER TO VERIFY CLEARANCE FOR DROP INLET
TP-122	CONCORD AVE	3008+03, 8' L	CONFIRM LOCATION OF WATER SERVICE
TP-123	CONCORD AVE	3008+72, 18' R	LOCATE TELECOM AND ELECTRIC TO VERIFY VERTICAL CLEARANCE AND COVER FOR WATER MAIN
TP-124	CONCORD AVE	3008+86, 20' R	LOCATE CATCH BASIN LATERAL
TP-125	CONCORD AVE	3008+97, 17' L	LOCATE ELECTRIC TO VERIFY CLEARANCE FOR DRAIN MANHOLE
TP-126	CONCORD AVE	3009+40, 8' L	LOCATE TELECOM AND ELECTRIC TO VERIFY CLEARANCE FOR CATCH BASIN
TP-127	CONCORD AVE	3009+70, 12' L	LOCATE TELECOM AND ELECTRIC TO VERIFY CLEARANCE FOR DRAIN MANHOLE AND LATERAL
TP-127A	CONCORD AVE	3009+78, 16' L	LOCATE ELECTRIC TO VERIFY CLEARANCE FOR DRAIN MANHOLE
TP-128	CONCORD AVE	3009+84, 19' R	LOCATE CATCH BASIN LATERAL
TP-129	CONCORD AVE	3010+09, 7' L	CONFIRM LOCATION OF WATER SERVICE
TP-130	CONCORD AVE	3010+77, 7' L	CONFIRM LOCATION OF WATER SERVICE
TP-131	CONCORD AVE	3011+26, 17' R	LOCATE ELECTRIC AND TELECOM TO VERIFY VERTICAL CLEARANCE AND COVER FOR WATER MAIN
TP-132	CONCORD AVE	3011+82, 19' R	LOCATE TELECOM AND ELECTRIC TO VERIFY CLEARANCE FOR CATCH BASIN
TP-133	CONCORD AVE	3011+84, 10' L	LOCATE TELECOM AND ELECTRIC TO VERIFY CLEARANCE FOR CATCH BASIN
TP-134	CONCORD AVE	3012+30, 6' L	CONFIRM LOCATION OF WATER SERVICE
TP-135	CONCORD AVE	3012+83, 6' L	CONFIRM LOCATION OF WATER SERVICE
TP-136	CONCORD AVE	3013+75, 13' L	LOCATE TELCOM AND ELECTRIC TO VERIFY VERTICAL CLEARANCE AND COVER FOR WATER MAIN
TP-137	CONCORD AVE	3014+31, 19' R	LOCATE TELECOM AND ELECTRIC TO VERIFY CLEARANCE FOR CATCH BASIN
TP-138	CONCORD AVE	3014+31, 10' L	LOCATE TELECOM AND ELECTRIC TO VERIFY CLEARANCE FOR CATCH BASIN
TP-139	CONCORD AVE	3016+19, 8' R	LOCATE TELECOM TO VERIFY VERTICAL CLEARANCE AND COVER FOR WATER MAIN
TP-140	CONCORD AVE	3020+05, 14' L	LOCATE ELECTRIC TO VERIFY CLEARANCE FOR DROP INLET
TP-140A	CONCORD AVE	3021+09, 28' R	LOCATE ELECTRIC TO VERIFY CLEARANCE FOR TRAFFIC SIGNAL POST
TP-140B	CONCORD AVE	3021+11, 15' L	LOCATE ELECTRIC TO VERIFY CLEARANCE FOR TRAFFIC SIGNAL POST
TP-141	CONCORD AVE	3022+14, 18' R	LOCATE TELECOM AND WATER TO VERIFY CLEARANCE FOR CATCH BASIN
TP-142	CONCORD AVE	3022+14, 11' L	LOCATE TELECOM AND ELECTRIC TO VERIFY CLEARANCE FOR CATCH BASIN
TP-143	CONCORD AVE	3023+94, 12' L	LOCATE ELECTRIC TO VERIFY CLEARANCE FOR PROPOSED TREE
TP-144	CONCORD AVE	3025+31, 20' R	LOCATE ELECTRIC AND WATER TO VERIFY CLEARANCE FOR CATCH BASIN
TP-145	CONCORD AVE	3025+82, 6' L	LOCATE GAS TO VERIFY CLEARANCE FOR CATCH BASIN
TP-146	CONCORD AVE	3028+60, 18' R	LOCATE ELECTRIC AND WATER TO VERIFY CLEARANCE FOR CATCH BASIN
TP-147	CONCORD AVE	3028+74, 7' L	LOCATE CTV, GAS AND TELECOM TO VERIFY CLEARANCE FOR CATCH BASIN
TP-148	CONCORD AVE	3030+74, 14' L	LOCATE TELECOM TO VERIFY CLEARANCE FOR MAST ARM FOUNDATION
TP-149	CONCORD AVE	3030+84, 24' R	LOCATE ELECTRIC TO VERIFY CLERANCE FOR TRAFFIC SIGNAL POST
TP-150	CONCORD AVE	3030+92, 14' L	LOCATE TELECOM TO VERIFY CLEARANCE FOR TRAFFIC SIGNAL POST
TP-151	CONCORD AVE	3031+12, 29' L	LOCATE ELECTRIC TO VERIFY CLEARANCE FOR TRAFFIC SIGNAL POST
TP-152	CONCORD AVE	3031+62, 25' R	LOCATE ELECTRIC TO VERIFY CLEARANCE FOR TRAFFIC SIGNAL POST
TP-153	CONCORD AVE	3031+69, 18' L	LOCATE TELECOM TO VERIFY CLEARANCE FOR TRAFFIC SIGNAL POST

BAY STATE ROAD, FIELD STREET, FAYERWEATHER STREET (EAST OF FIELD STREET)			
TEST PIT #	STREET	STATION	REASON FOR TEST PIT
TP-201	BAY STATE RD	3100+80, 17' R	LOCATE TELECOM AND ELECTRIC TO VERIFY CLEARANCE FOR DROP INLET AND DRAIN LATERAL
TP-202	BAY STATE RD	3101+37, 5' L	LOCATE ELECTRIC TO VERIFY VERTICAL CLEARANCE AND COVER FOR WATER MAIN
TP-203	BAY STATE RD	3102+72, 15' R	LOCATE ELECTRIC TO VERIFY CLEARANCE FOR CATCH BASIN
TP-204	BAY STATE RD	3102+72, 11' L	LOCATE ELECTRIC AND GAS TO VERIFY CLEARANCE FOR DRAIN MANHOLE AND DROP INLETS
TP-204A	BAY STATE RD	3102+73, 17' L	LOCATE GAS TO VERIFY CLEARANCE FOR DRAIN MANHOLE
TP-205	BAY STATE RD	3105+77, 18' R	LOCATE ELECTRIC TO VERIFY VERTICAL CLEARANCE AND COVER FOR WATER MAIN
TP-206	BAY STATE RD	3106+39, 16' R	LOCATE ELECTRIC AND GAS TO VERIFY CLEARANCE FOR DRAIN MANHOLES AND DROP INLETS
TP-207	BAY STATE RD	3106+49, 10' L	LOCATE ELECTRIC TO VERIFY CLEARANCE FOR CATCH BASIN
TP-208	BAY STATE RD	3107+22, 9' R	VERIFY CONNECTION POINT TO 8" DI WATER MAIN
TP-209	FIELD ST	3108+31, 8' R	VERIFY CONNECTION POINT TO 8" DI WATER MAIN
TP-210	FIELD ST	3109+32, 17' R	LOCATE ELECTRIC TO VERIFY VERTICAL CLEARANCE AND COVER FOR WATER MAIN
TP-211	FIELD ST	3110+10, 14' R	LOCATE ELECTRIC TO VERIFY CLEARANCE FOR CATCH BASIN
TP-212	FIELD ST	3110+10, 8' L	LOCATE ELECTRIC TO VERIFY CLEARANCE FOR CATCH BASIN
TP-212A	FIELD ST	3110+10, 12' L	LOCATE GAS TO VERIFY CLEARANCE FOR DRAIN MANHOLE
TP-213	FIELD ST	3111+81, 16' R	LOCATE ELECTRIC TO VERIFY VERTICAL CLEARANCE AND COVER FOR WATER MAIN
TP-214	FIELD ST	3113+05, 7' L	LOCATE ELECTRIC TO VERIFY CLEARANCE FOR CATCH BASIN
TP-215	FIELD ST	3113+07, 12' R	LOCATE ELECTRIC TO VERIFY CLEARANCE FOR CATCH BASIN
TP-216	FIELD ST	3113+79, 11' R	LOCATE ELECTRIC TO VERIFY VERTICAL CLEARANCE AND COVER FOR WATER MAIN

BIRCH STREET, FERN STREET, CORP. BURNS ROAD			
TEST PIT #	STREET	STATION	REASON FOR TEST PIT
TP-301	BIRCH ST	3200+34, 12' L	LOCATE CTV TO VERIFY CLEARANCE FOR HYDRANT LATERAL
TP-302	BIRCH ST	3200+47, 5' L	LOCATE ELECTRIC TO VERIFY VERTICAL CLEARANCE AND COVER FOR WATER MAIN
TP-303	BIRCH ST	3202+70, 12' L	CONFIRM LOCATION OF EXIST. WATER FOR HORIZONTAL CLEARANCE OF PROPOSED WATER CORRIDOR
TP-304	FERN ST	3300+37, 16' L	LOCATE ELECTRIC AND CTV TO VERIFY CLEARANCE FOR HYDRANT LATERAL
TP-305	C. BURNS RD	3401+80, 9' L	CONFIRM LOCATION OF EXIST. WATER FOR HORIZONTAL CLEARANCE OF PROPOSED WATER CORRIDOR

ALPINE STREET, GARDEN STREET			
TEST PIT #	STREET	STATION	REASON FOR TEST PIT
TP-401	ALPINE ST	3506+56, 9' R	LOCATE TELECOM TO VERIFY CLEARANCE FOR CATCH BASIN
TP-401A	ALPINE ST	3507+42, 17' L	LOCATE ELECTRIC TO VERIFY CLEARANCE FOR TRAFFIC SIGNAL POST
TP-402	ALPINE ST	3510+56, 12' R	LOCATE GAS SERVICE TO VERIFY CLEARANCE FOR CATCH BASIN
TP-403	GARDEN ST	3511+04, 39' L	LOCATE ELECTRIC TO VERIFY DEPTH OF CURB
TP-404	GARDEN ST	3511+28, 13' L	LOCATE ELECTRIC TO VERIFY DEPTH OF CURB
TP-405	GARDEN ST	3512+42, 12' R	LOCATE ELECTRIC TO VERIFY CLEARANCE FOR SEWER ALIGNMENT, DRAIN LATERAL, AND VERTICAL CLEARANCE AND COVER FOR WATER MAIN
TP-406	GARDEN ST	3512+42, 7' L	LOCATE ELECTRIC TO VERIFY CLEARANCE FOR CATCH BASIN
TP-406A	GARDEN ST	3512+42, 13' L	LOCATE GAS TO VERIFY CLEARANCE FOR CATCH BASIN
TP-407	GARDEN ST	3512+98, 14' L	LOCATE GAS AND ELECTRIC TO VERIFY CLEARANCE FOR DRAIN MANHOLE AND SERVICE
TP-407A	GARDEN ST	3512+99, 5' L	LOCATE ELECTRIC TO VERIFY CLEARANCE FOR DRAIN MANHOLE
TP-408	GARDEN ST	3515+08, 5' L	LOCATE ELECTRIC TO VERIFY CLEARANCE FOR SEWER MANHOLE
TP-409	GARDEN ST	3515+33, 17' L	LOCATE SANITARY SERVICE
TP-410	GARDEN ST	3515+54, 7' L	LOCATE ELECTRIC TO VERIFY CLEARANCE FOR CATCH BASIN
TP-411	GARDEN ST	3517+83, 6' L	LOCATE ELECTRIC TO VERIFY CLEARANCE FOR CATCH BASIN AND DRAIN LATERAL
TP-412	GARDEN ST	3517+89, 18' R	LOCATE ELECTRIC TO VERIFY CLEARANCE FOR CATCH BASIN
TP-413	GARDEN ST	3518+68, 6' L	LOCATE ELECTRIC TO VERIFY CLEARANCE FOR HYDRANT LATERAL
TP-414	GARDEN ST	3520+18, 19' R	LOCATE ELECTRIC TO VERIFY CLEARANCE FOR DRAIN AND VERTICAL CLEARANCE AND COVER FOR WATER MAIN
TP-415	GARDEN ST	3520+46, 2' L	LOCATE ELECTRIC TO VERIFY CLEARANCE FOR DRAIN LATERAL
TP-416	GARDEN ST	3520+99, 16' R	LOCATE ELECTRIC TO VERIFY CLEARANCE FOR DROP INLET, DRAIN LATERAL, AND DRAIN MANHOLE
TP-417	GARDEN ST	3523+73, 11' R	LOCATE ELECTRIC AND WATER TO VERIFY CLEARANCE FOR WATER MAIN

CHILTON STREET			
TEST PIT #	STREET	STATION	REASON FOR TEST PIT
TP-501	CHILTON ST	1255+20, 7' L	LOCATE TELECOM TO VERIFY VERTICAL CLEARANCE AND COVER FOR WATER MAIN
TP-502	CHILTON ST	1255+77, 10' L	LOCATE TELECOM AND ELECTRIC TO VERIFY CLEARANCE FOR CATCH BASIN
TP-503	CHILTON ST	1255+79, 14' R	LOCATE ELECTRIC TO VERIFY CLEARANCE FOR CATCH BASIN
TP-504	CHILTON ST	1257+40, 5' L	LOCATE ELECTRIC TO VERIFY CLEARANCE FOR SEWER, DRAIN AND WATER

FAYERWEATHER STREET (SOUTH OF FIELD STREET)			
TEST PIT #	STREET	STATION	REASON FOR TEST PIT
TP-601	FAYERWEATHER ST	1327+30, 3' L	LOCATE EXISTING PILES FOR CONDITION ASSESSMENT AND ORGANICS
TP-602	FAYERWEATHER ST	1327+97, 3' L	LOCATE EXISTING PILES FOR CONDITION ASSESSMENT AND ORGANICS
TP-603	FAYERWEATHER ST	1328+09, 2' R	LOCATE ORGANICS AT PROPOSED STORM DRAIN LOCATION
TP-604	FAYERWEATHER ST	1329+17, 16' L	LOCATE TELECOM AND ELECTRIC TO VERIFY CLEARANCE FOR CATCH BASIN
TP-605	FAYERWEATHER ST	1329+99, 5' R	LOCATE TELECOM AND ELECTRIC TO VERIFY HYDRANT LOCATION AND VERTICAL CLEARANCE AND COVER FOR WATER MAIN

WALDEN STREET			
TEST PIT #	STREET	STATION	REASON FOR TEST PIT
TP-701	WALDEN ST	1524+74, 10' R	LOCATE GAS AND CTV TO VERIFY CLEARANCE FOR SEWER MANHOLE
TP-702	WALDEN ST	1526+53, 21' L	LOCATE ELECTRIC TO VERIFY VERTICAL CLEARANCE AND COVER FOR WATER MAIN
TP-703	WALDEN ST	1526+95, 12' R	LOCATE GAS TO VERIFY CLEARANCE FOR CATCH BASIN
TP-704	WALDEN ST	1526+96, 19' L	LOCATE ELECTRIC TO VERIFY CLEARANCE FOR CATCH BASIN
TP-705	WALDEN ST	1526+97, 10' L	LOCATE WATER TO VERIFY CLEARANCE FOR CATCH BASIN AND DRAIN LATERAL
TP-706	WALDEN ST	1528+63, 13' R	LOCATE GAS TO VERIFY CLEARANCE FOR DRAIN MANHOLE AND DRAIN LATERAL
TP-707	WALDEN ST	1529+00, 16' L	LOCATE WATER AND ELECTRIC TO VERIFY CLEARANCE FOR DROP INLET AND DRAIN LATERAL
TP-708	WALDEN ST	1529+51, 23' L	LOCATE ELECTRIC TO VERIFY VERTICAL CLEARANCE AND COVER FOR WATER MAIN
TP-709	WALDEN ST	1531+67, 16' L	LOCATE WATER TO VERIFY CLEARANCE FOR DROP INLET
TP-710	WALDEN ST	1531+76, 12' R	LOCATE GAS TO VERIFY CLEARANCE FOR DRAIN MANHOLE, CATCH BASIN AND DRAIN LATERAL
TP-711	WALDEN ST	1532+12, 9' R	LOCATE GAS AND ELECTRIC TO VERIFY CLEARANCE FOR DRAIN PIPE
TP-712	WALDEN ST	1532+40, 13' L	LOCATE WATER AND GAS TO VERIFY CLEARANCE FOR DROP INLET AND DRAIN LATERAL
TP-713	WALDEN ST	1531+67, 16' L	LOCATE ELECTRIC TO VERIFY CLEARANCE FOR TRAFFIC SIGNAL POST
TP-714	WALDEN ST	1532+21, 25' R	LOCATE ELECTRIC TO VERIFY CLEARANCE FOR TRAFFIC SIGNAL POST

SAVILLE STREET, COPLEY STREET, HAZEL STREET, IVY STREET			
TEST PIT #	STREET	STATION	REASON FOR TEST PIT
TP-801	SAVILLE ST	3801+51, 7' R	LOCATE GAS TO VERIFY CLEARANCE FOR CATCH BASIN AND DRAIN LATERAL
TP-802	SAVILLE ST	3802+18, 3' L	LOCATE EXISTING PILES FOR CONDITION ASSESSMENT AND ORGANICS
TP-803	SAVILLE ST	3803+59, 7' R	LOCATE GAS TO VERIFY CLEARANCE FOR CATCH BASIN AND DRAIN LATERAL
TP-804	SAVILLE ST	3803+91, 5' L	LOCATE ORGANICS AT PROPOSED STORM DRAIN LOCATION
TP-805	SAVILLE ST	3804+49, 9' L	LOCATE TELECOM TO VERIFY WATER MAIN ALIGNMENT
TP-806	SAVILLE ST	3805+16, 9' L	LOCATE TELECOM TO VERIFY WATER MAIN ALIGNMENT
TP-807	HAZEL ST	4102+63, 14' R	LOCATE GAS AND ELECTRIC TO VERIFY CLEARANCE FOR CATCH BASIN AND DRAIN LATERAL

- NOTES:
- UNLESS OTHERWISE NOTED, WATER MAINS SHALL BE INSTALLED WITH MINIMUM 5.0' COVER. WATER MAIN ELEVATIONS LISTED IN THE DRAWINGS REFER TO TOP OF WATER MAIN.
  - CONTRACTOR TO PROVIDE 1" CHLORINATION TAP AT ALL LOCATIONS WHERE PROP WATER MAIN CONNECTS TO EXISTING WATER MAIN.
  - WATER GATES, BOXES, HYDRANTS SHALL BE INSTALLED TO EXISTING GRADE AND ADJUSTED TO FINAL GRADE ELEVATIONS DURING SURFACE RESTORATION WORK.
  - ALL NEW AND RELOCATED HYDRANTS TO BE FLOW TESTED IN COORDINATION WITH THE CWD AND PAINTED PER THE CWD SPECIFICATIONS. CONTRACTOR TO COORDINATE WITH CWD FOR PAINT SPECIFICATIONS/COLOR.
  - GEOTECHNICAL MONITORING POINTS AND LOCATIONS SHALL BE DETERMINED IN THE FIELD PRIOR TO EXCAVATION, BY THE ENGINEER. SEE SPECIFICATIONS FOR ADDITIONAL REQUIREMENTS.
  - AT ALL LOCATIONS WHERE STEEL GAS MAINS ARE ENCOUNTERED, THERE IS THE POTENTIAL OF ASBESTOS FIBERS WITHIN THE COAL-TAR WRAP. WHERE IT IS REQUIRED TO REMOVE THESE ABANDONED SECTIONS, CONTRACTOR WILL BE REQUIRED TO REMOVE THE SECTIONS WITH THE USE OF HAND TOOLS AND PLACE IN LINED ROLL OF BINS PROVIDED BY NSTAR GAS. COORDINATED WITH NSTAR GAS ON THE DISPOSAL OF THE PIPE. NSTAR GAS WILL BE RESPONSIBLE FOR DISPOSAL THE REMOVED SECTIONS.
  - REFER TO TEMPORARY WATER PLANS FOR WATER BYPASS LOCATIONS.
  - CONTRACTOR TO CONDUCT TEST PITS AT LOCATIONS SHOWN ON THE CONTRACT DRAWINGS OR AS OTHERWISE REQUIRED BY THE ENGINEER. WHERE CONTRACTOR IS REQUIRED TO VERIFY CLEARANCE BETWEEN UTILITIES, AND IF REQUIRED CLEARANCE CANNOT BE OBTAINED, CONTRACTOR SHALL COORDINATE RELOCATION WITH UTILITY COMPANIES.
  - REFER TO UTILITY SHEETS FOR SPECIFIC UTILITY NOTES.

CONFIRMED SET

CAD FILE: G:\electric\cambridge MA\3072266-01-A - Concord Ave (Contract 9)\Drawings\Civil\Production Drawings\Utility Coordination\Plan\Utility\_General.dwg  
 LAYOUT: UtilityGeneral  
 PLOTTED: 2/12/2014 2:00 PM BY: Kyle Langford

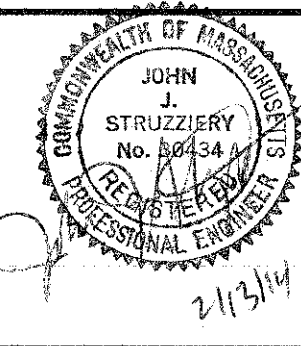

Scale	AS NOTED
Date	FEBRUARY 2014
Job No.	20120256.001A
Designed by	TAL/JRB/FMM
Drawn by	KJJ/DRM/BMS/DRB
Checked by	CMC/TJR
Approved by	BJM
No.	
Description	
Date	
REVISIONS	



Client	CITY OF CAMBRIDGE, MASSACHUSETTS	Sheet	UG-2
Project	CONCORD (CONTRACT 9) SEWER SEPARATION AND SURFACE IMPROVEMENTS PROJECT	File No.	6228
Drawing	UTILITY GENERAL GENERAL NOTES & TEST PIT SCHEDULE		