

FAWCETT STREET EASEMENT
SCALE: 1" = 20'

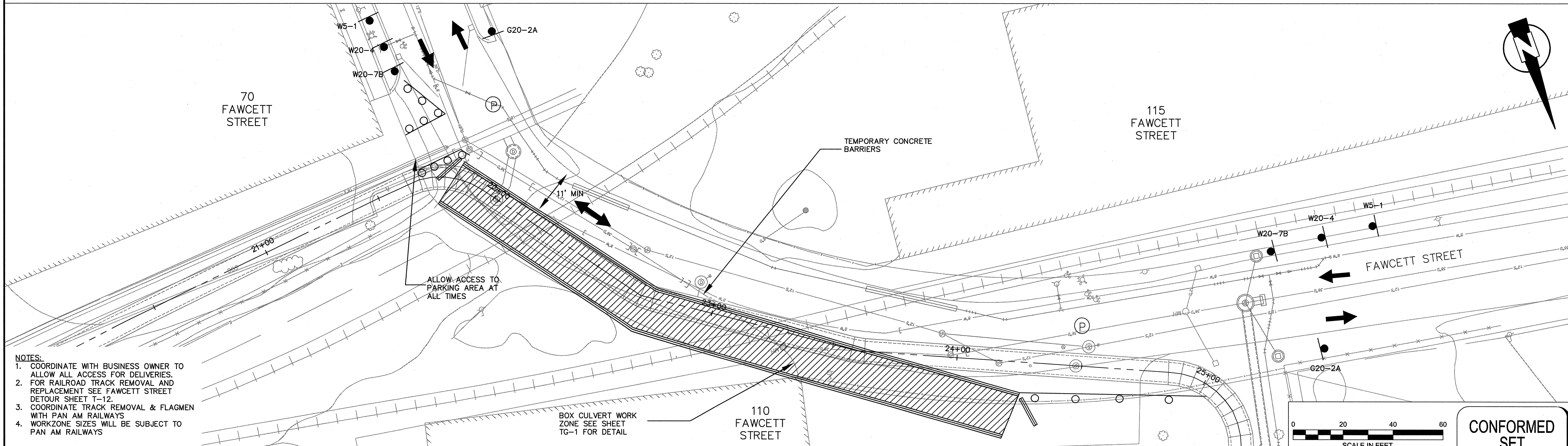

FAWCETT STREET WORK ZONE
SCALE: 1" = 20'

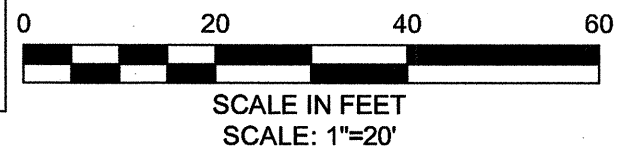

CONFORMED SET

SEA
SEA CONSULTANTS INC.
Scientists/Engineers/Architects

MWH

Bioengineering GROUP
18 Commercial Street
Salem, MA 01970
T: 978.740.0096
F: 978.740.0097
www.bioengineering.com

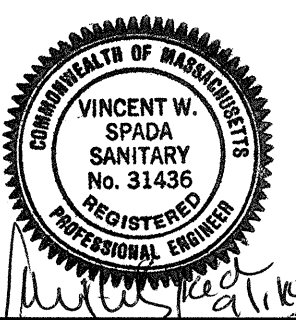

| | | | |
|-------------|-------------------|-----|-------------|
| Scale | AS NOTED | | |
| Date | SEPTEMBER 1, 2010 | | |
| Job No. | 1998400.12 | | |
| Designed by | SFJ | | |
| Drawn by | NJE | | |
| Checked by | FGA | No. | Description |
| Approved by | VWS | | Date |
| REVISIONS | | | |

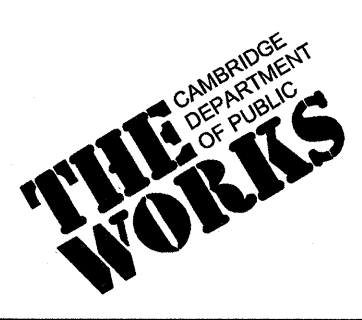

CITY OF CAMBRIDGE, MASSACHUSETTS
CAMBRIDGEPARK DRIVE AREA DRAINAGE IMPROVEMENTS
CONTRACT NO. 12
TRAFFIC MANAGEMENT PLAN
PHASE 7

Sheet No.
T-7
File No.

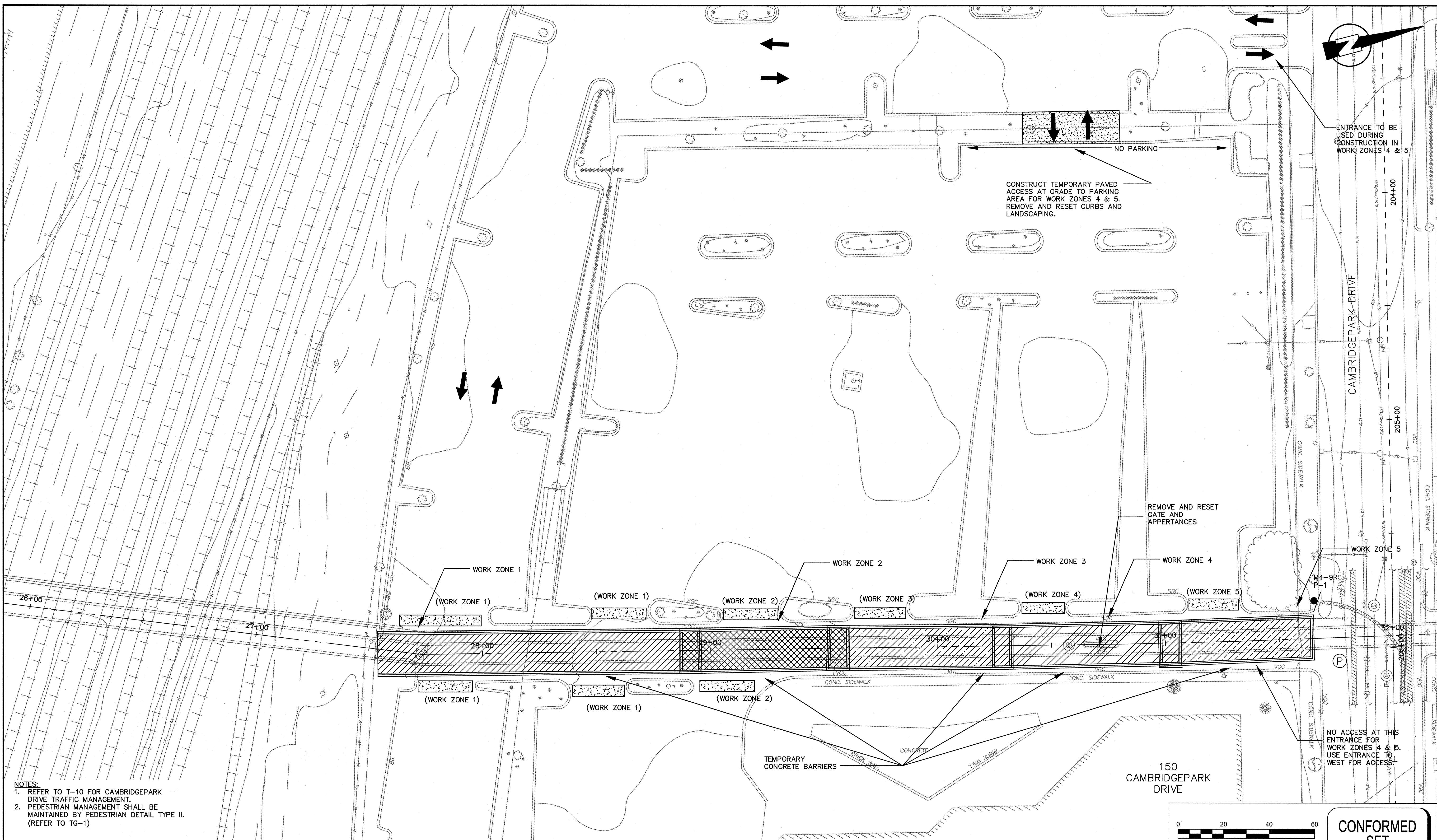

NOTES:
 1. REFER TO T-10 FOR CAMBRIDGEPARK DRIVE TRAFFIC MANAGEMENT.
 2. PEDESTRIAN MANAGEMENT SHALL BE MAINTAINED BY PEDESTRIAN DETAIL TYPE II. (REFER TO TG-1)

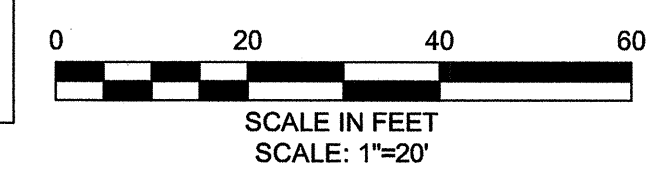

CONFORMED SET

SOUTHERN PARKING LOT 150 CAMBRIDGEPARK DRIVE
 SCALE: 1" = 20'

SEA
 SEA CONSULTANTS INC.
 Scientists/Engineers/Architects

MWH

Bioengineering GROUP
 18 Commercial Street
 Salem, MA 01970
 T: 978.740.0096
 F: 978.740.0097
 www.bioengineering.com

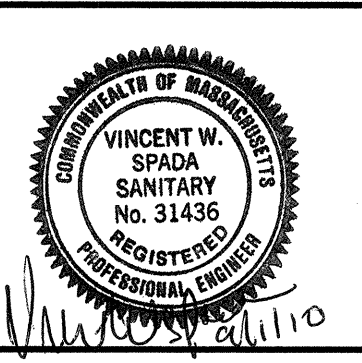

| | | | | |
|-------------|-------------------|-----|-------------|------|
| Scale | AS NOTED | | | |
| Date | SEPTEMBER 1, 2010 | | | |
| Job No. | 1998400.12 | | | |
| Designed by | SFJ | | | |
| Drawn by | NJE | | | |
| Checked by | FGA | No. | Description | Date |
| Approved by | VWS | | REVISIONS | |

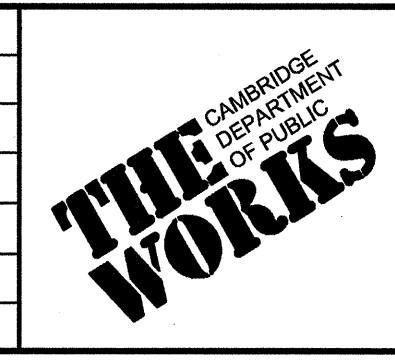

CITY OF CAMBRIDGE, MASSACHUSETTS
 CAMBRIDGEPARK DRIVE AREA DRAINAGE IMPROVEMENTS
 CONTRACT NO. 12
 TRAFFIC MANAGEMENT PLAN
 PHASE 8

Sheet No. **T-8**
 File No.

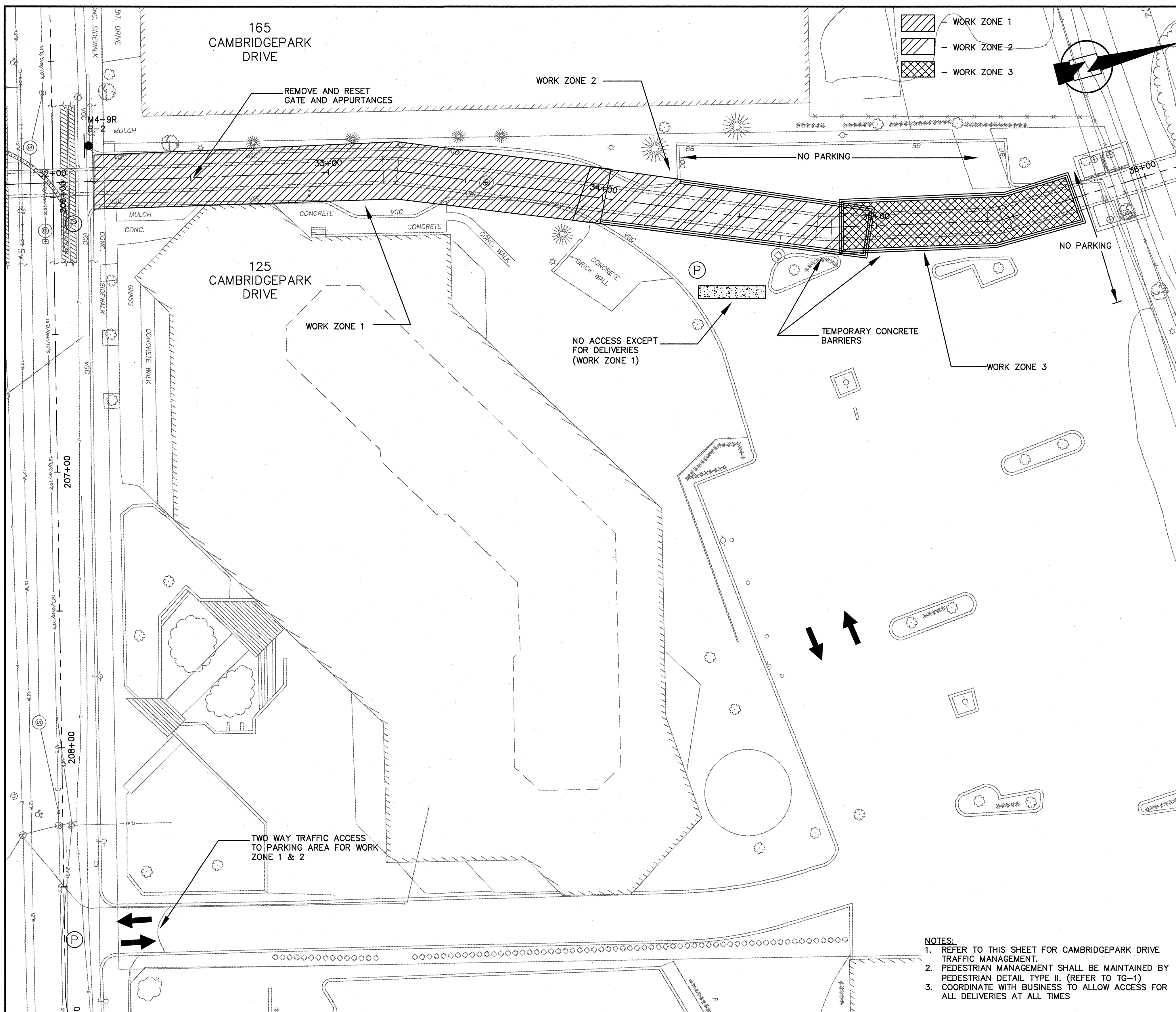

NORTHERN PARKING LOT 125 CAMBRIDGEPARK DRIVE
SCALE: 1" = 20'

- NOTES:
1. REFER TO THIS SHEET FOR CAMBRIDGEPARK DRIVE TRAFFIC MANAGEMENT.
 2. PEDESTRIAN MANAGEMENT SHALL BE MAINTAINED BY PEDESTRIAN DETAIL TYPE II. (REFER TO TG-1)
 3. COORDINATE WITH BUSINESS TO ALLOW ACCESS FOR ALL DELIVERIES AT ALL TIMES

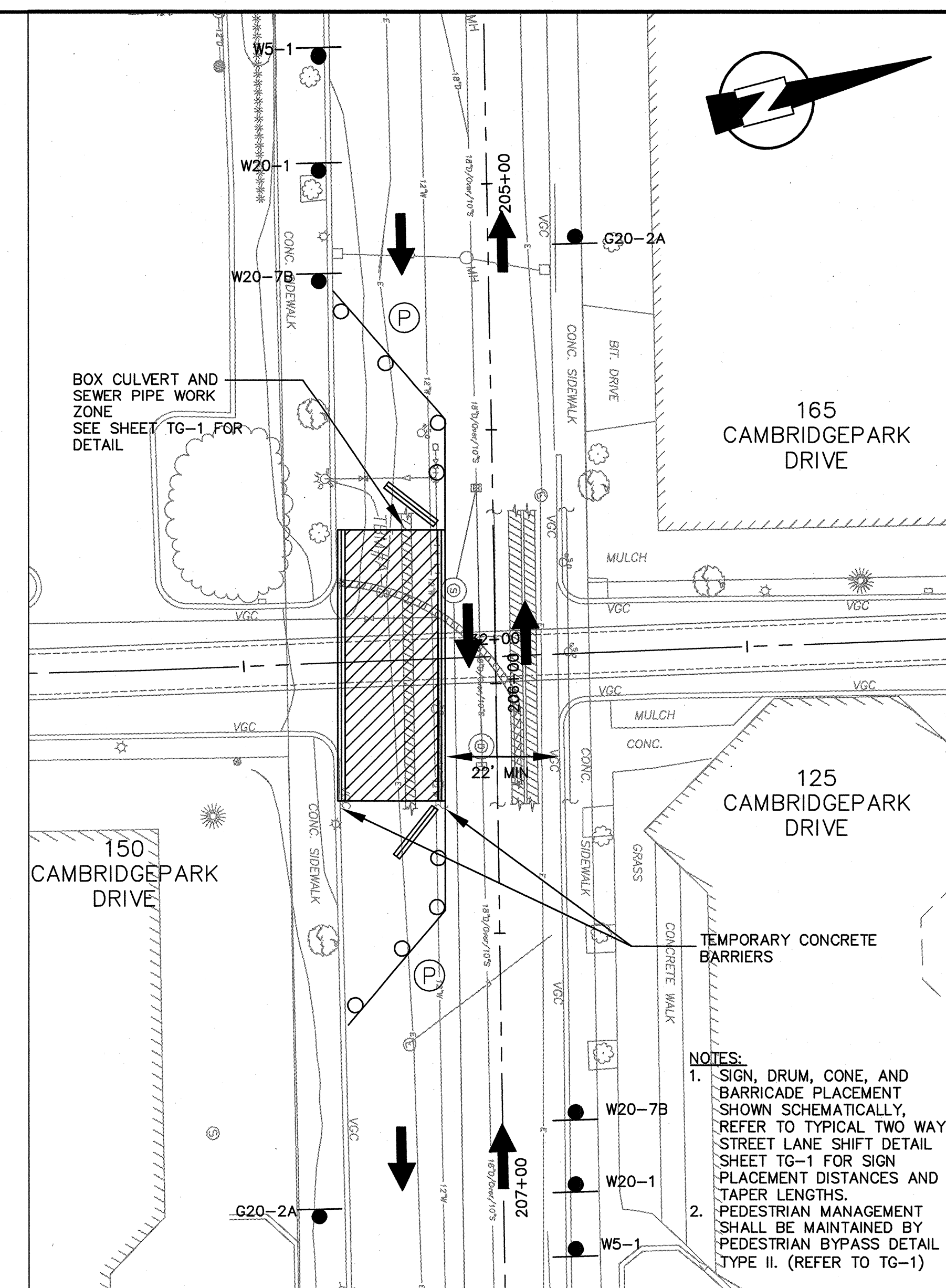

CAMBRIDGEPARK DRIVE TYPICAL TWO WAY STREET
LANE SHIFT
SCALE: 1" = 20'

- NOTES:
1. SIGN, DRUM, CONE, AND BARRICADE PLACEMENT SHOWN SCHEMATICALLY, REFER TO TYPICAL TWO WAY STREET LANE SHIFT DETAIL SHEET TG-1 FOR SIGN PLACEMENT DISTANCES AND TAPER LENGTHS.
 2. PEDESTRIAN MANAGEMENT SHALL BE MAINTAINED BY PEDESTRIAN BYPASS DETAIL TYPE II. (REFER TO TG-1)

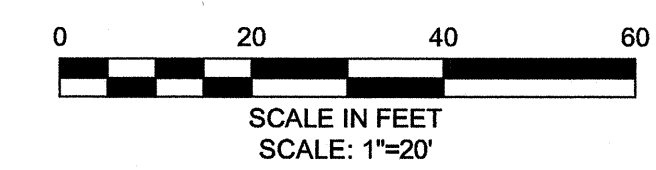

CONFORMED SET

SEA
SEA CONSULTANTS INC.
Scientists/Engineers/Architects

MWH

Bioengineering GROUP
18 Commercial Street
Salem, MA 01970
T: 978.740.0096
F: 978.740.0097
www.bioengineering.com

VINCENT W. SPADA
SANITARY
No. 31436
REGISTERED ENGINEER

| | | | | |
|-------------|--------------|-----|-------------|------|
| Scale | AS NOTED | | | |
| Date | MAY 10, 2010 | | | |
| Job No. | 1998400.12 | | | |
| Designed by | SFJ | | | |
| Drawn by | NJE | | | |
| Checked by | FGA | No. | Description | Date |
| Approved by | VWS | | REVISIONS | |

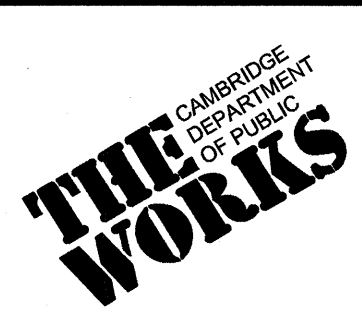

CITY OF CAMBRIDGE, MASSACHUSETTS
CAMBRIDGEPARK DRIVE AREA DRAINAGE IMPROVEMENTS
CONTRACT NO. 12
TRAFFIC MANAGEMENT PLAN
PHASE 9

Sheet No. T-9
File No.

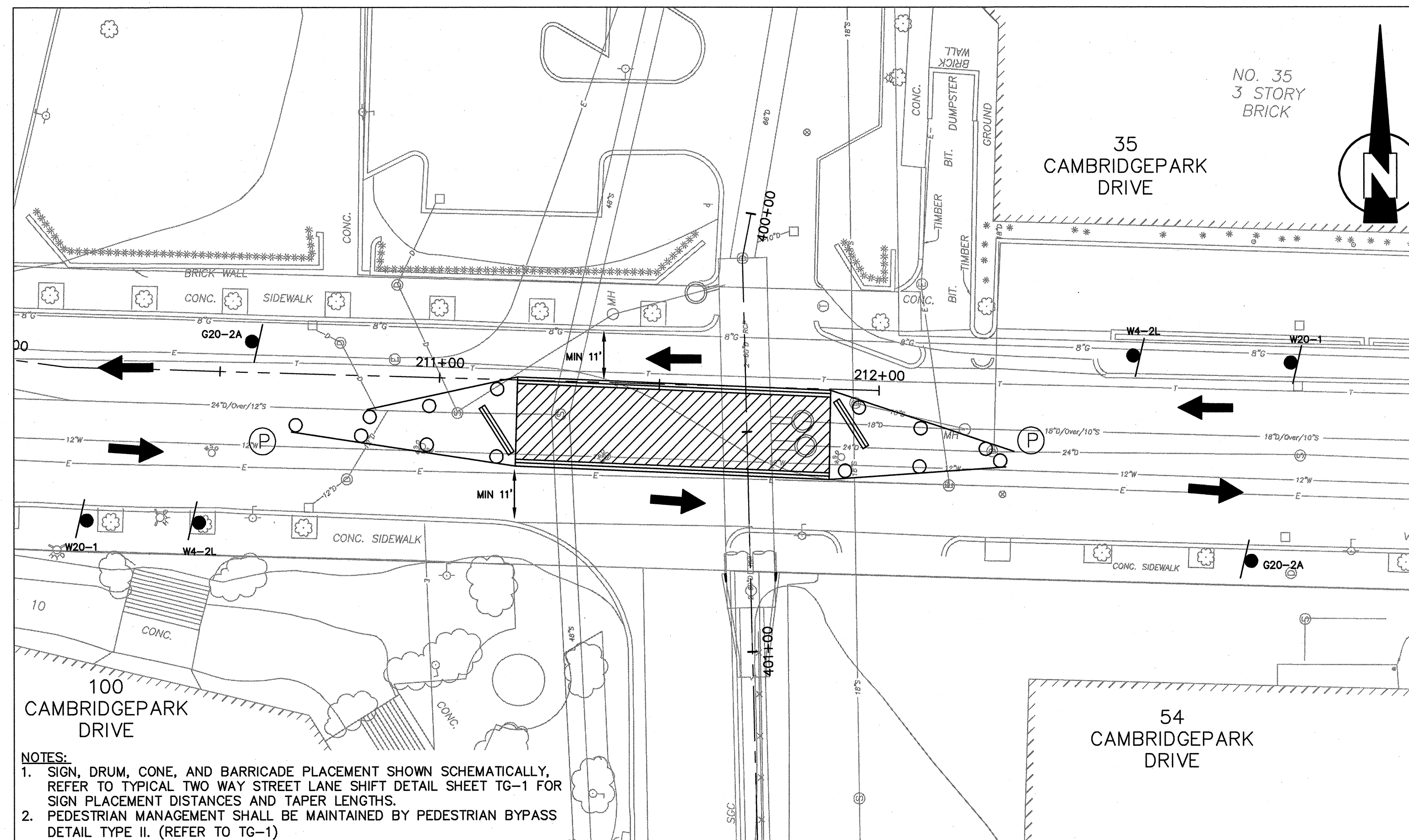

NOTES:
 1. SIGN, DRUM, CONE, AND BARRICADE PLACEMENT SHOWN SCHEMATICALLY. REFER TO TYPICAL TWO WAY STREET LANE SHIFT DETAIL SHEET TG-1 FOR SIGN PLACEMENT DISTANCES AND TAPER LENGTHS.
 2. PEDESTRIAN MANAGEMENT SHALL BE MAINTAINED BY PEDESTRIAN BYPASS DETAIL TYPE II. (REFER TO TG-1)

CAMBRIDGEPARK DRIVE SEWER INSTALLATION
 1" = 20'

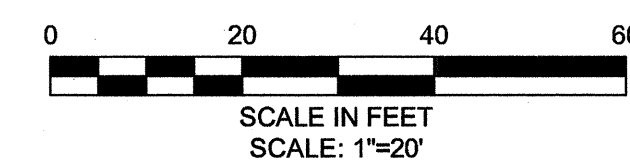

CONFORMED SET



| | | | | |
|-------------|-------------------|-----|-------------|------|
| Scale | AS NOTED | | | |
| Date | SEPTEMBER 1, 2010 | | | |
| Job No. | 1998400.12 | | | |
| Designed by | SFJ | | | |
| Drawn by | NJE | | | |
| Checked by | FGA | No. | Description | Date |
| Approved by | VWS | | REVISIONS | |

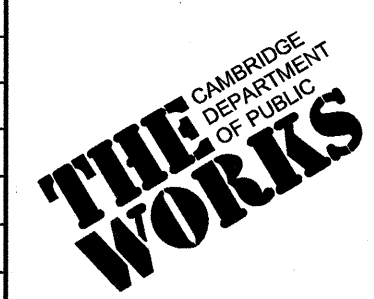

| | |
|--|-----------|
| CITY OF CAMBRIDGE, MASSACHUSETTS | Sheet No. |
| CAMBRIDGEPARK DRIVE AREA DRAINAGE IMPROVEMENTS | T-10 |
| CONTRACT NO. 12 | File No. |
| TRAFFIC MANAGEMENT PLAN | |
| PHASE 10 | |

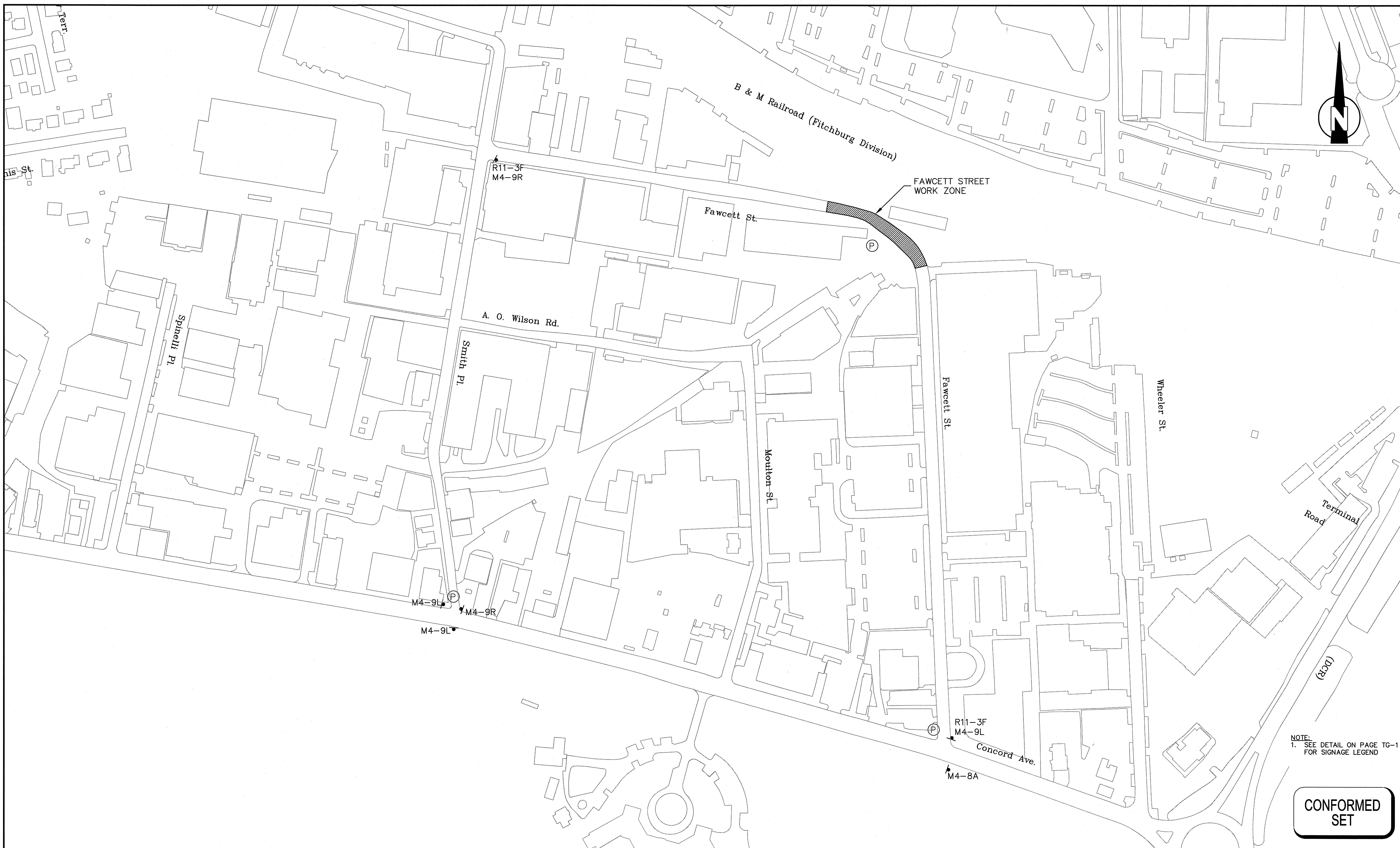

NOTE:
1. SEE DETAIL ON PAGE TG-1 FOR SIGNAGE LEGEND

CONFORMED SET

SEA
SEA CONSULTANTS INC.
Scientists/Engineers/Architects

MWH

Bioengineering GROUP
18 Commercial Street
Salem, MA 01970
T: 978.740.0096
F: 978.740.0097
www.bioengineering.com

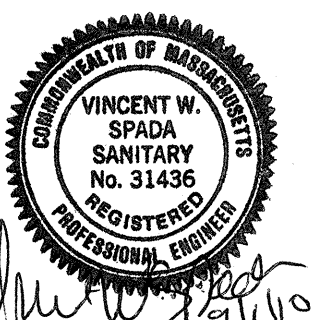

| | | | | |
|-------------|-------------------|-----|-------------|------|
| Scale | NO SCALE | | | |
| Date | SEPTEMBER 1, 2010 | | | |
| Job No. | 1998400.12 | | | |
| Designed by | SFJ | | | |
| Drawn by | NJE | | | |
| Checked by | FGA | No. | Description | Date |
| Approved by | VWS | | REVISIONS | |



CITY OF CAMBRIDGE, MASSACHUSETTS
CAMBRIDGEPARK DRIVE AREA DRAINAGE IMPROVEMENTS
CONTRACT NO. 12
TRAFFIC MANAGEMENT PLAN
FAWCETT STREET DETOUR PLAN

Sheet No. **T-11**
File No.

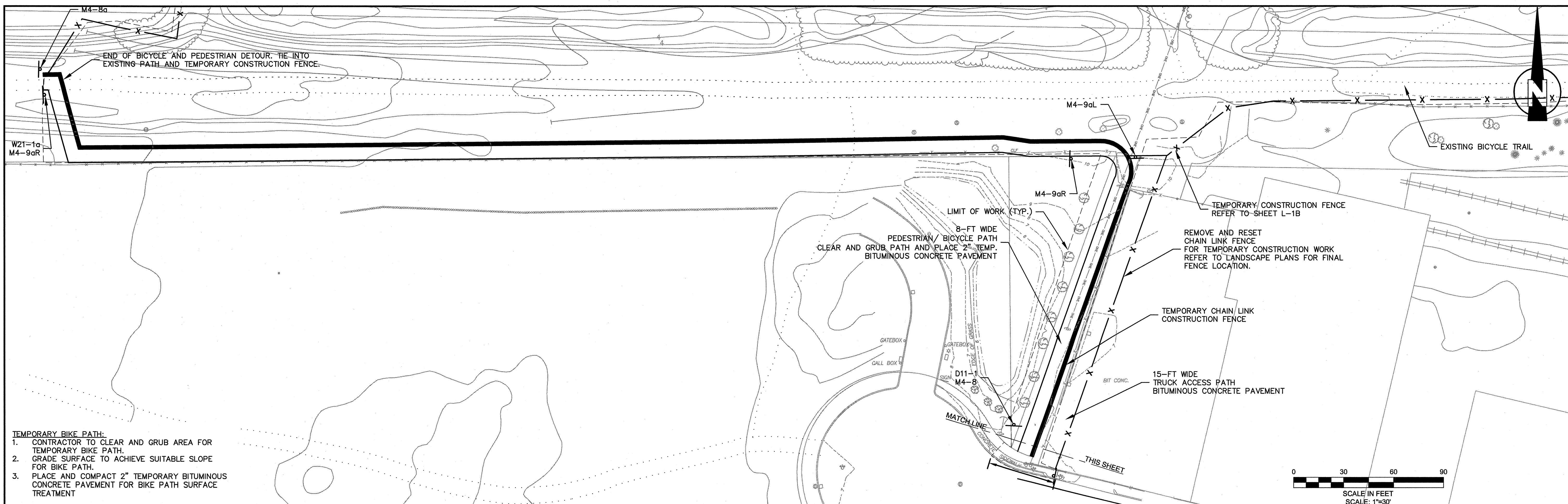

- TEMPORARY BIKE PATH:**
1. CONTRACTOR TO CLEAR AND GRUB AREA FOR TEMPORARY BIKE PATH.
 2. GRADE SURFACE TO ACHIEVE SUITABLE SLOPE FOR BIKE PATH.
 3. PLACE AND COMPACT 2" TEMPORARY BITUMINOUS CONCRETE PAVEMENT FOR BIKE PATH SURFACE TREATMENT

PLAN
SCALE: 1" = 30'

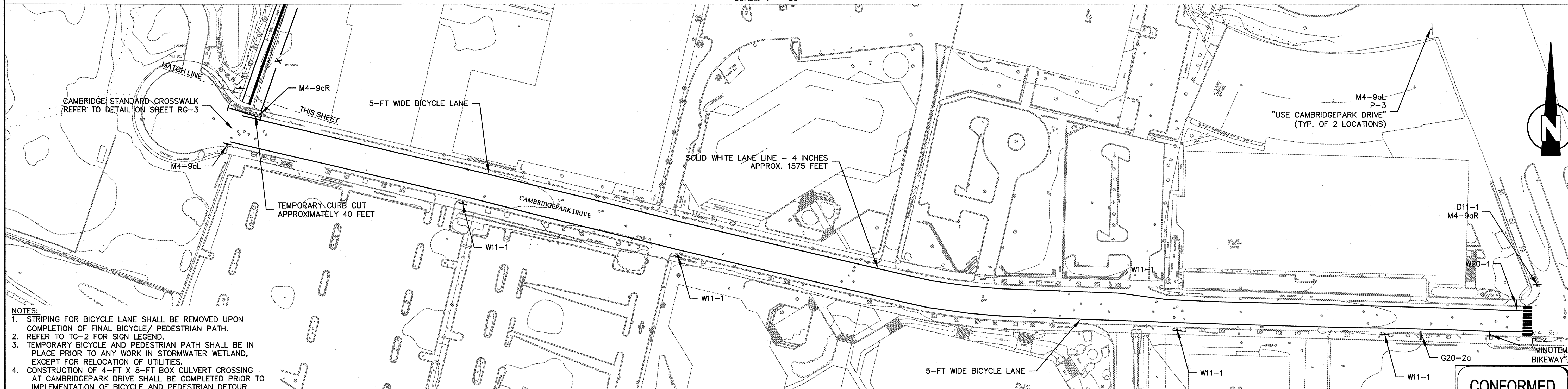
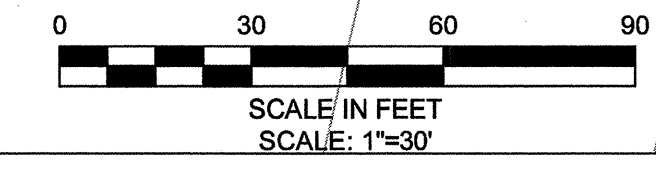

- NOTES:**
1. STRIPING FOR BICYCLE LANE SHALL BE REMOVED UPON COMPLETION OF FINAL BICYCLE/ PEDESTRIAN PATH. REFER TO TG-2 FOR SIGN LEGEND.
 2. TEMPORARY BICYCLE AND PEDESTRIAN PATH SHALL BE IN PLACE PRIOR TO ANY WORK IN STORMWATER WETLAND, EXCEPT FOR RELOCATION OF UTILITIES.
 3. CONSTRUCTION OF 4-FT X 8-FT BOX CULVERT CROSSING AT CAMBRIDGEPARK DRIVE SHALL BE COMPLETED PRIOR TO IMPLEMENTATION OF BICYCLE AND PEDESTRIAN DETOUR.

PLAN
SCALE: 1" = 60'

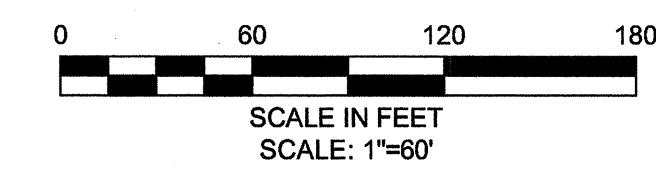

CONFORMED SET

SEA
SEA CONSULTANTS INC.
Scientists/Engineers/Architects

MWH

Bioengineering GROUP
18 Commercial Street
Salem, MA 01970
T: 978.740.0096
F: 978.740.0097
www.bioengineering.com

VINCENT W. SPADA
SANITARY
No. 31436
REGISTERED PROFESSIONAL ENGINEER

| | | | | |
|-------------|-------------------|-----|-------------|------|
| Scale | AS NOTED | | | |
| Date | SEPTEMBER 1, 2010 | | | |
| Job No. | 1998400.12 | | | |
| Designed by | LNS | | | |
| Drawn by | LNS | | | |
| Checked by | FGA | No. | Description | Date |
| Approved by | VWS | | REVISIONS | |

THE WORKS
CAMBRIDGE DEPARTMENT OF PUBLIC WORKS

CITY OF CAMBRIDGE, MASSACHUSETTS
CAMBRIDGEPARK DRIVE AREA DRAINAGE IMPROVEMENTS
CONTRACT NO. 12
TRAFFIC MANAGEMENT PLAN STORMWATER WETLAND AREA
BICYCLE AND PEDESTRIAN DETOUR

Sheet No.
T-12
File No.

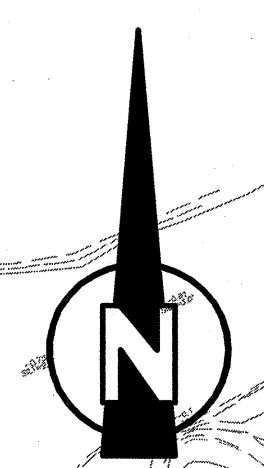
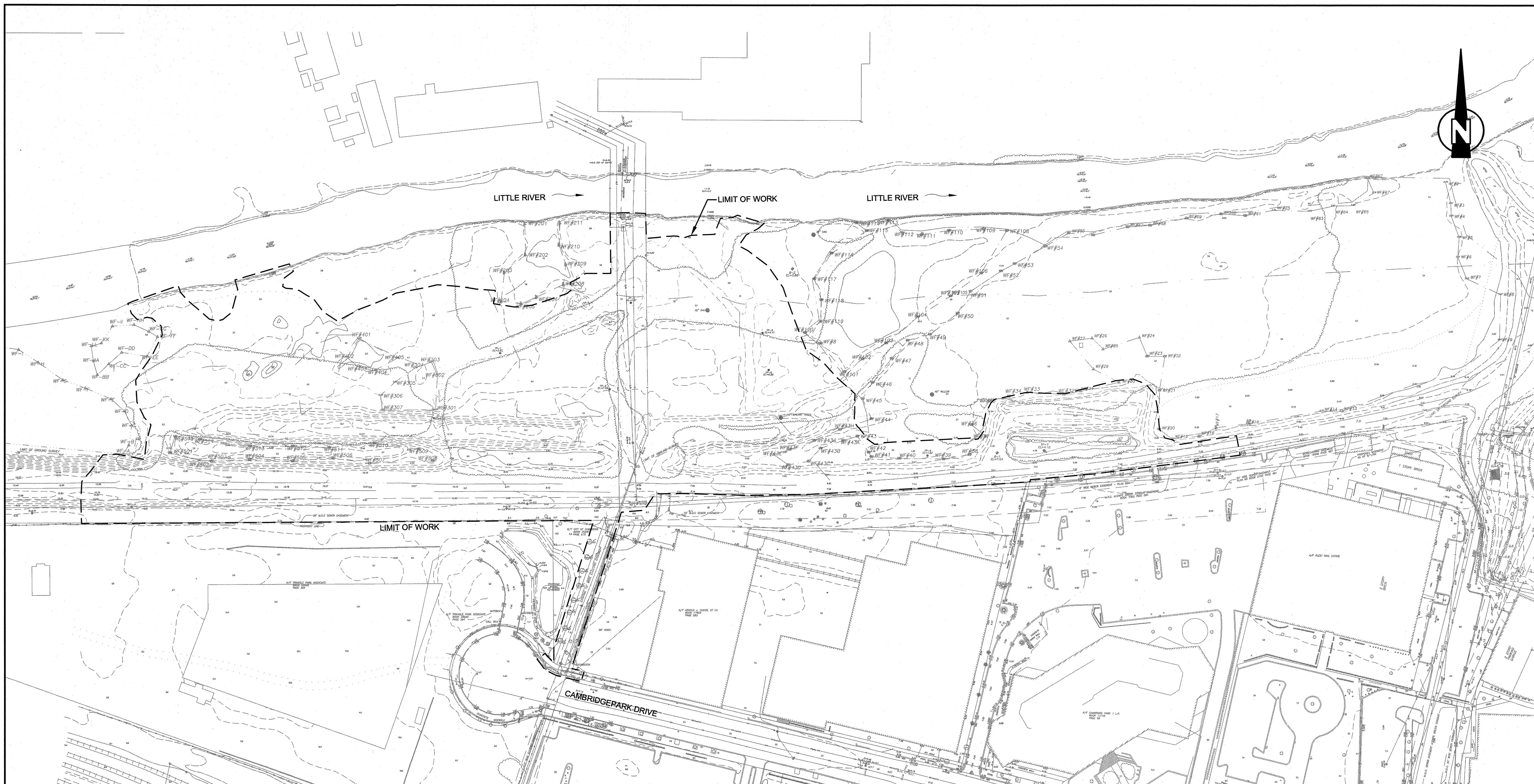

PLAN
SCALE: 1"=60'

NOTES:
1. SEE SHEET CG-1 FOR SURVEY LEGEND.
2. SEE SHEET LG-1 FOR GENERAL NOTES PERTAINING TO WORK IN STORMWATER WETLAND BASIN AREA.

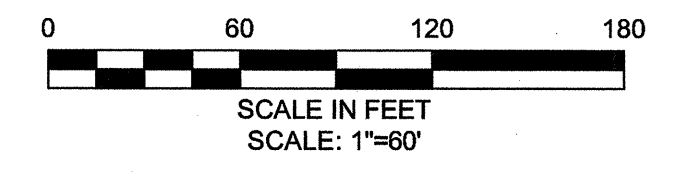

CONFORMED SET

SEA
SEA CONSULTANTS INC.
Scientists/Engineers/Architects

MWH

Bioengineering GROUP
18 Commercial Street
Salem, MA 01970
T: 978.740.0096
F: 978.740.0097
www.bioengineering.com

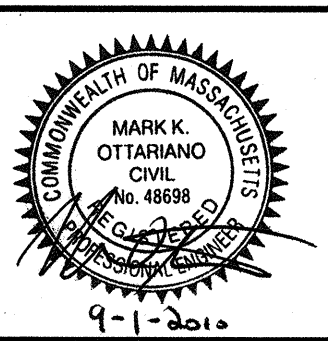

| | | | | |
|-------------|-------------------|-----|-------------|------|
| Scale | 1"=60' | | | |
| Date | SEPTEMBER 1, 2010 | | | |
| Job No. | CAM | | | |
| Designed by | EJW | | | |
| Drawn by | MKO | | | |
| Checked by | RWG | No. | Description | Date |
| Approved by | RWG | | REVISIONS | |

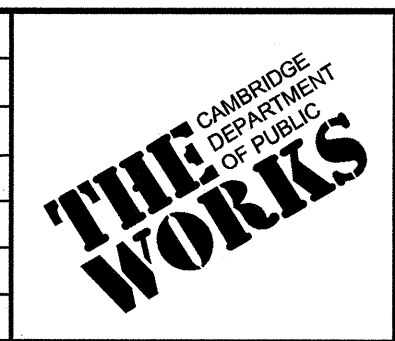

CITY OF CAMBRIDGE, MASSACHUSETTS
CAMBRIDGEPARK DRIVE AREA DRAINAGE IMPROVEMENTS
CONTRACT NO. 12
STORMWATER TREATMENT AREA AND MITIGATION AREA
EXISTING CONDITIONS PLAN

Sheet No. **EC-1**
File No.