

STA 104+68.99 BREWSTER ST =
STA 200+00.00 RIEDESEL AVE =

PROP RAISED CW
(SEE DETAIL SHEET R-52)
PROP CEM CONC
SDWK (TYP)

PROP GRAN TRANS
CURB (TYP)
D31CBN1908
REPLACE FRAME AND COVER
RIM = 35.74

PROTECT & MAINTAIN
EXIST IRRIGATION
R&R COBBLES

ADA ACCESSIBLE PATH
RIEDESEL AVE
CONST BL

PROP GRAN TRANSITION
CURB (TYP)
D31CBN1907
REPLACE FRAME AND GRATE
RIM = 28.27

ITEM 2647.01 PAY LIMITS
SEE NOTE 12
PROP RAISED CW (SEE
DETAIL SHEET R-52)

PROP GRAN TRANS
CURB (TYP)

D31DMH1910

DMH-02
RIM = 35.63

CB-01
RIM = 35.62

PROP BACK OF SDWK
ADJUSTMENT (TYP)

PROP DETECTABLE
WARNING PANEL (TYP)

PROTECT AND MAINTAIN
EXIST TREE (TYP)

PROP CEM CONC
DWCY (TYP)

PROTECT & MAINTAIN
EXIST IRRIGATION

PROTECT & MAINTAIN
EXIST IRRIGATION
PROP LOAM & SEED
(TYP)

PROP FULL
DEPTH PVMT

PROP FLEXIPAVE

D31DMH1905
RECONSTRUCT EXIST DMH
CONE AND BRICKS
RIM = 28.27

MEET EXIST
BRICK SDWK

D31CBN1906
REPLACE FRAME AND GRATE
RIM = 28.37
PROP GRAN TRANSITION
CURB (TYP)

NOTES:

1. CONTRACTOR SHALL ADJUST EXISTING UTILITY COVERS AND CASTINGS TO REGRADED SURFACES. THE CONTRACTOR SHALL COORDINATE WITH RESPECTIVE UTILITY COMPANIES FOR GAS/TELECOM/CABLE/ELECTRIC.
2. ALL VERTICAL GRANITE CURBING WITHIN WORK LIMITS SHALL BE REMOVED AND RESET UNLESS OTHERWISE NOTED.
3. CONTRACTOR SHALL MAINTAIN A MINIMUM OF 3'-0" WIDE SIDEWALK BEHIND EXISTING TREES AND 4'-0" WIDE SIDEWALK BEHIND PROPOSED TREE LOCATIONS UNLESS THE SIDEWALK HAS BEEN IDENTIFIED ON THE PLANS AS BEING WITHIN AN ADA VARIANCE LOCATION.
4. ALL EXISTING TREES AND SHRUBS SHALL BE RETAINED UNLESS OTHERWISE NOTED. PROPOSED TREES INSTALLED BY OTHERS UNLESS OTHERWISE NOTED.
5. ALL EXISTING FEATURES AT THE BACK OF SIDEWALK SHALL REMAIN IN PLACE UNLESS OTHERWISE NOTED. DAMAGES OR DISLODGING OF FEATURES AT BACK OF SIDEWALK SHALL BE REPAIRED/REPLACED AT NO ADDITIONAL COST TO THE OWNER.
6. CONTRACTOR SHALL MATCH THE EXISTING GRADE AT THE LIMITS OF CONSTRUCTION. FOR PAVEMENT LIMITS, THE JOINT BETWEEN EXISTING AND PROPOSED PAVEMENT SHALL BE TREATED WITH INFRARED PAVEMENT SEALANT AND HOT POURED RUBBERIZED ASPHALT SEALER.
7. ALL EXISTING SIGNS SHALL BE REMOVED AND REPLACED UNLESS OTHERWISE NOTED. ALL REINSTALLED SIGNS OR PROPOSED SIGNS SHALL BE LOCATED A LATERAL CLEARANCE OF 1' FROM THE CURB.

8. WHERE SIDEWALKS ARE LESS THAN 5' WIDE, PASSING ZONES HAVE BEEN IDENTIFIED EVERY 200' WITHIN ACCESSIBLE ROUTES. PASSING ZONES SHALL BE A MINIMUM SIZE OF 5'X5' AND HAVE A MAXIMUM SLOPE OF 1.5% IN ALL DIRECTIONS. ADA ACCESSIBLE ROUTES ARE NOTED ON THE DRAWINGS.
9. LOCATIONS WHERE CONCRETE OR BRICK SIDEWALKS ARE UNABLE TO BE INSTALLED DUE TO THE PRESENCE OF ROOTS AT EXISTING TREES, APPROXIMATE LIMITS OF FLEXI-PAVE ARE INDICATED ON THE DRAWINGS. LIMITS OF FLEXI-PAVE SHALL BE FINALIZED IN THE FIELD UPON THE REMOVAL OF THE EXISTING SIDEWALK AND REVIEW OF ROOT LOCATIONS.
10. CONTRACTOR SHALL NOT PERFORM ANY WORK ON PRIVATE PROPERTY UNTIL A SIGNED RIGHT-OF-ENTRY (ROE) IS RECEIVED BY DPW FROM THE PROPERTY OWNER. ROEs SHALL BE PERFORMED BY THE DPW PROJECT MANAGER.
11. CONTRACTOR SHALL CONDUCT PRE-CONSTRUCTION DOCUMENTATION OF EXISTING COBBLE POSITIONS AND RESET COBBLES IN SAME ORIENTATION AND PATTERN DURING RECONSTRUCTION. SEE SPECIAL PROVISIONS.
12. CONTRACTOR SHALL FURNISH AND INSTALL ALL PIPE, FITTINGS, AND VALVES TO DISCONNECT AND CAP THE EXISTING 6-INCH RIEDESEL AVENUE WATER MAIN FROM THE EXISTING 12-INCH BRATTLE STREET WATER MAIN AND CONNECT THE NEWLY CONSTRUCTED RIEDESEL AVENUE WATER MAIN (8-INCH) INSTALLED BY THE CITY OF CAMBRIDGE TO THE EXISTING BRATTLE STREET WATER MAIN (12-INCH). CONTRACTOR SHALL MILL AND OVERLAY (225 SY) PAY LIMITS IN CONFORMANCE WITH RIEDESEL AVENUE SECTION ON RG-1. PLEASE REFER TO SPECIFICATION APPENDIX E FOR WATER MAIN PLANS PREPARED BY CAMBRIDGE WATER DEPARTMENT.

LEGEND:

--- ACCESSIBLE ROUTE

ISSUED FOR BID

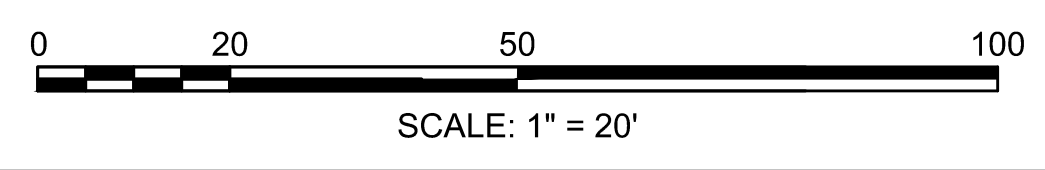

CAD FILE: I:\eng\16042-48 Cambridge Chapter 90 Contract 23A-DWG\Design\Riedesel St_Construction Plans.dwg LAYOUT: 1 PLOTTED: 10/10/2018 9:46 AM BY: moynar.david



27 Congress Street, Salem, MA 01970
tel. 978-740-0096 www.hatch.com

Scale	AS NOTED			
Date	OCTOBER 2018			
Job No.	20170208.019A			
Designed by	JRH			
Drawn by	JRH			
Checked by	PFB	No.	Description	Date
Approved by	PFB		REVISIONS	



Client	CITY OF CAMBRIDGE, MASSACHUSETTS
Project	CHAPTER 90 CONTRACT 23A ROADWAY IMPROVEMENT PROJECT
Drawing	RIEDESEL AVENUE CONSTRUCTION PLANS SHEET 1 OF 1

Sheet	R-1
File No.	XXXX

NOTES:

1. CONTRACTOR SHALL ADJUST EXISTING UTILITY COVERS AND CASTINGS TO REGRADED SURFACES. THE CONTRACTOR SHALL COORDINATE WITH RESPECTIVE UTILITY COMPANIES FOR GAS/TELECOM/CABLE/ELECTRIC.
2. ALL VERTICAL GRANITE CURBING WITHIN WORK LIMITS SHALL BE REMOVED AND RESET UNLESS OTHERWISE NOTED.
3. CONTRACTOR SHALL MAINTAIN A MINIMUM OF 3'-0" WIDE SIDEWALK BEHIND EXISTING TREES AND 4'-0" WIDE SIDEWALK BEHIND PROPOSED TREE LOCATIONS UNLESS THE SIDEWALK HAS BEEN IDENTIFIED ON THE PLANS AS BEING WITHIN AN ADA VARIANCE LOCATION.
4. ALL EXISTING TREES AND SHRUBS SHALL BE RETAINED UNLESS OTHERWISE NOTED. PROPOSED TREES INSTALLED BY OTHERS UNLESS OTHERWISE NOTED.
5. ALL EXISTING FEATURES AT THE BACK OF SIDEWALK SHALL REMAIN IN PLACE UNLESS OTHERWISE NOTED. DAMAGES OR DISLODGING OF FEATURES AT BACK OF SIDEWALK SHALL BE REPAIRED/REPLACED AT NO ADDITIONAL COST TO THE OWNER.
6. CONTRACTOR SHALL MATCH THE EXISTING GRADE AT THE LIMITS OF CONSTRUCTION. FOR PAVEMENT LIMITS, THE JOINT BETWEEN EXISTING AND PROPOSED PAVEMENT SHALL BE TREATED WITH INFRARED PAVEMENT SEALANT AND HOT POURED RUBBERIZED ASPHALT SEALER.

NOTES:

7. ALL EXISTING SIGNS SHALL BE REMOVED AND REPLACED UNLESS OTHERWISE NOTED. ALL REINSTALLED SIGNS OR PROPOSED SIGNS SHALL BE LOCATED A LATERAL CLEARANCE OF 1' FROM THE CURB.
8. WHERE SIDEWALKS ARE LESS THAN 5' WIDE, PASSING ZONES HAVE BEEN IDENTIFIED EVERY 200' WITHIN ACCESSIBLE ROUTES. PASSING ZONES SHALL BE A MINIMUM SIZE OF 5'X5' AND HAVE A MAXIMUM SLOPE OF 1.5% IN ALL DIRECTIONS. ADA ACCESSIBLE ROUTES ARE NOTED ON THE DRAWINGS.
9. LOCATIONS WHERE CONCRETE OR BRICK SIDEWALKS ARE UNABLE TO BE INSTALLED DUE TO THE PRESENCE OF ROOTS AT EXISTING TREES, APPROXIMATE LIMITS OF FLEXI-PAVE ARE INDICATED ON THE DRAWINGS. LIMITS OF FLEXI-PAVE SHALL BE FINALIZED IN THE FIELD UPON THE REMOVAL OF THE EXISTING SIDEWALK AND REVIEW OF ROOT LOCATIONS. FOR FLEXIBLE POROUS PAVING, REFER TO SPECIFICATION SECTION 02520.
10. CONTRACTOR SHALL NOT PERFORM ANY WORK ON PRIVATE PROPERTY UNTIL A SIGNED RIGHT-OF-ENTRY (ROE) IS RECEIVED BY DPW FROM THE PROPERTY OWNER. ROEs SHALL BE PERFORMED BY THE DPW PROJECT MANAGER.

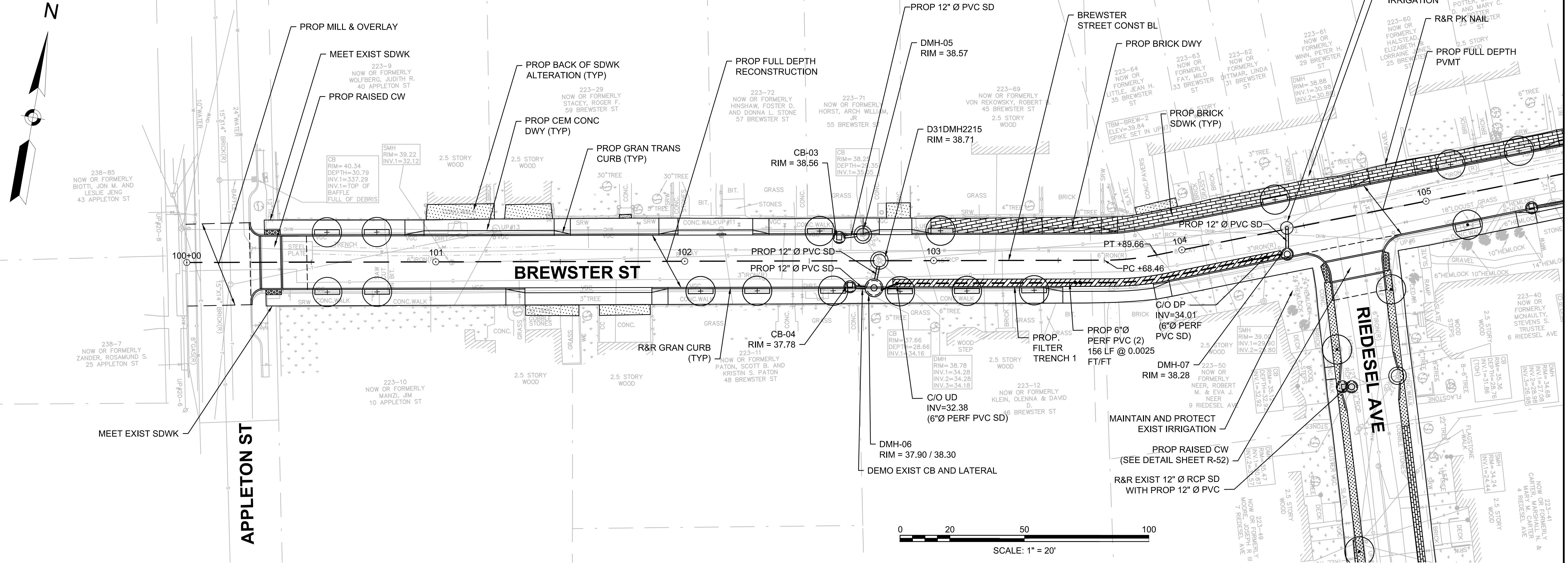

CAD FILE: I:\eng\16042-48 Cambridge\Chapter 90 Contract 23A\DWG\Design\Brewster St_Construction Plans.dwg LAYOUT: 1 PLOTTED: 10/10/2018 9:50 AM BY: moyer.david

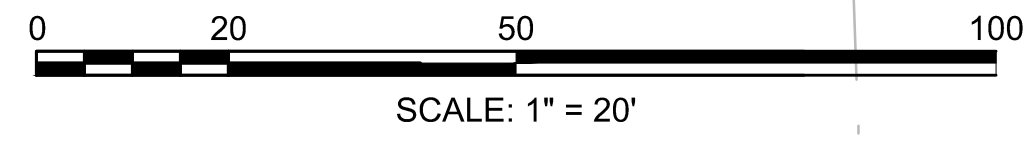

ISSUED FOR BID



27 Congress Street, Salem, MA 01970
tel. 978-740-0096 www.hatch.com

Scale	AS NOTED		
Date	OCTOBER 2018		
Job No.	20170208.019A		
Designed by	JRH		
Drawn by	JRH		
Checked by	PFB	No.	Description
Approved by	PFB		REVISIONS



Client	CITY OF CAMBRIDGE, MASSACHUSETTS
Project	CHAPTER 90 CONTRACT 23A ROADWAY IMPROVEMENT PROJECT
Drawing	BREWSTER STREET CONSTRUCTION PLAN SHEET 1 OF 2

Sheet	R-2
File No.	XXXX