

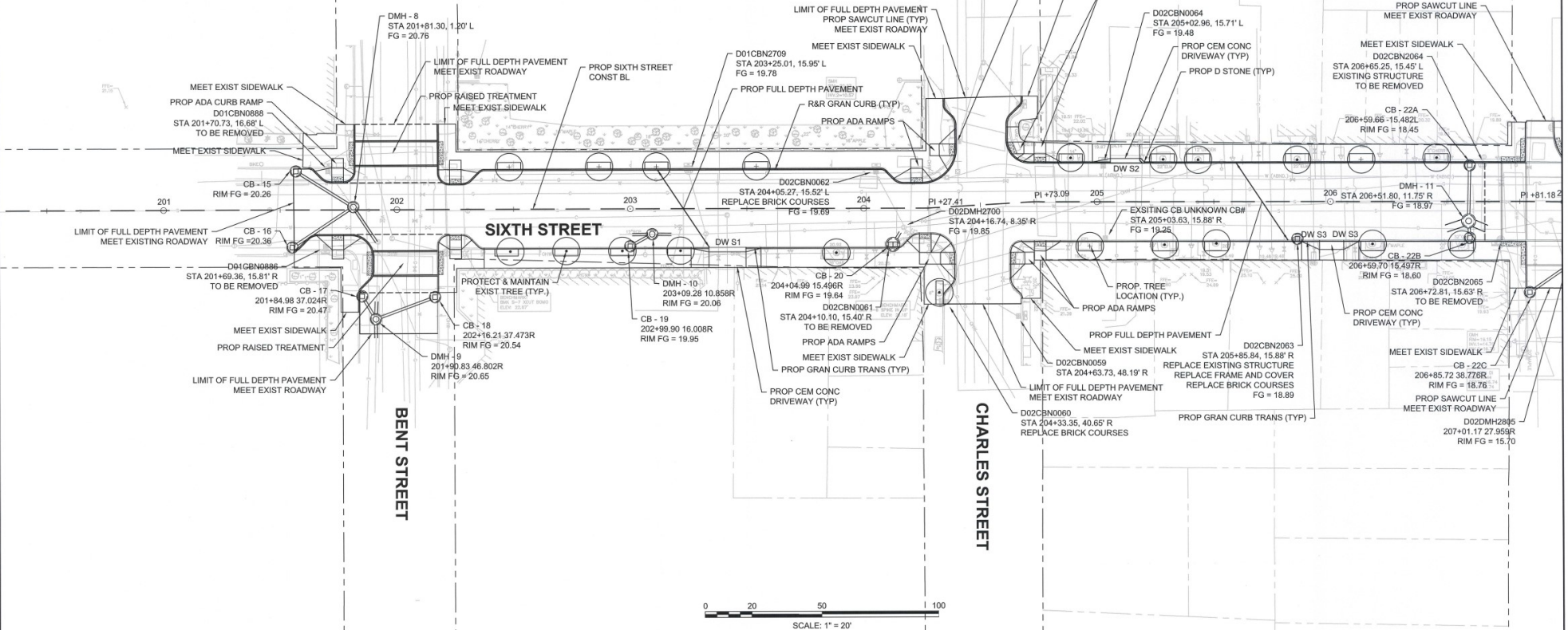

**NOTES:**

- CONTRACTOR SHALL ADJUST EXISTING UTILITY COVERS AND CASTINGS TO REGRADED SURFACES. THE CONTRACTOR SHALL COORDINATE WITH RESPECTIVE UTILITY COMPANIES FOR GAS/TELECOM/CABLE/ELECTRIC.
- ALL VERTICAL GRANITE CURBING WITHIN WORK LIMITS SHALL BE REMOVED, AND RESET UNLESS OTHERWISE NOTED.
- CONTRACTOR SHALL MAINTAIN A MINIMUM OF 3'-0" WIDE SIDEWALK BEHIND EXISTING TREES AND 4'-0" WIDE SIDEWALK BEHIND PROPOSED TREE LOCATIONS UNLESS THE SIDEWALK HAS BEEN IDENTIFIED ON THE PLANS AS BEING WITHIN AN ADA VARIANCE LOCATION.
- ALL EXISTING TREES AND SHRUBS SHALL BE RETAINED UNLESS OTHERWISE NOTED. PROPOSED TREES INSTALLED BY OTHERS UNLESS OTHERWISE NOTED.
- ALL EXISTING FEATURES AT THE BACK OF SIDEWALK SHALL REMAIN IN PLACE UNLESS OTHERWISE NOTED. DAMAGES OR DISLODGING OF FEATURES AT BACK OF SIDEWALK SHALL BE REPAIRED/REPLACED AT NO ADDITIONAL COST TO THE OWNER.
- CONTRACTOR SHALL MATCH THE EXISTING GRADE AT THE LIMITS OF CONSTRUCTION. FOR PAVEMENT LIMITS, THE JOINT BETWEEN EXISTING AND PROPOSED PAVEMENT SHALL BE TREATED WITH INFRARED PAVEMENT SEALANT AND HOT POURED RUBBERIZED ASPHALT SEALER.
- ALL EXISTING SIGNS SHALL BE REMOVED AND REPLACED UNLESS OTHERWISE NOTED. ALL REINSTALLED SIGNS OR PROPOSED SIGNS SHALL BE LOCATED A LATERAL CLEARANCE OF 1' FROM THE CURB.
- WHERE SIDEWALKS ARE LESS THAN 5' WIDE, PASSING ZONES HAVE BEEN IDENTIFIED EVERY 200' WITHIN ACCESSIBLE ROUTES. PASSING ZONES SHALL BE A MINIMUM SIZE OF 5'X5' AND HAVE A MAXIMUM SLOPE OF 1.5% IN ALL DIRECTIONS. ADA ACCESSIBLE ROUTES ARE NOTED ON THE DRAWINGS.
- LOCATIONS WHERE CONCRETE OR BRICK SIDEWALKS ARE UNABLE TO BE INSTALLED DUE TO THE PRESENCE OF ROOTS AT EXISTING TREES, APPROXIMATE LIMITS OF FLEXI-PAVE ARE INDICATED ON THE DRAWINGS. LIMITS OF FLEXI-PAVE SHALL BE FINALIZED IN THE FIELD UPON THE REMOVAL OF THE EXISTING SIDEWALK AND REVIEW OF ROOT LOCATIONS. FOR FLEXIBLE POROUS PAVING, REFER TO SPECIFICATION 02520.
- CONTRACTOR SHALL NOT PERFORM ANY WORK ON PRIVATE PROPERTY UNTIL A SIGNED RIGHT-OF-ENTRY (ROE) IS RECEIVED BY DPW FROM THE PROPERTY OWNER. ROES SHALL BE PERFORMED BY THE DPW PROJECT MANAGER.

CONTINUE ON SHEET R-6



ISSUED FOR BID

DATE PLOTTED: 1/20/2020 10:44:41 AM; PLOT: CONSTRUCTION (BOTH) DWG; LAYOUT: BOTH 1 - PLOTTED: 2/25/2020 8:47 AM; PLOT: SHEET R-6



Scale	AS NOTED			
Date	FEBRUARY 2019			
Job No.	20170208-016A			
Designed by	DTM			
Drawn by	DTM			
Checked by	PFB	No.	Description	Date
Approved by	PFB		REVISIONS	



Client	CITY OF CAMBRIDGE, MASSACHUSETTS
Project	CHAPTER 90 CONTRACT 23B ROADWAY IMPROVEMENT PROJECT
Drawing	SIXTH STREET CONSTRUCTION PLANS SHEET 1 OF 3

Sheet	R-5
File No.	8435

CONTINUED ON SHEET R-5

CONTINUED ON SHEET R-7

NOTES:

- CONTRACTOR SHALL ADJUST EXISTING UTILITY COVERS AND CASTINGS TO REGRADED SURFACES. THE CONTRACTOR SHALL COORDINATE WITH RESPECTIVE UTILITY COMPANIES FOR GAS/TELECOM/CABLE/ELECTRIC.
- ALL VERTICAL GRANITE CURBING WITHIN WORK LIMITS SHALL BE REMOVED AND RESET UNLESS OTHERWISE NOTED.
- CONTRACTOR SHALL MAINTAIN A MINIMUM OF 3'-0" WIDE SIDEWALK BEHIND EXISTING TREES AND 4'-0" WIDE SIDEWALK BEHIND PROPOSED TREE LOCATIONS UNLESS THE SIDEWALK HAS BEEN IDENTIFIED ON THE PLANS AS BEING WITHIN AN ADA VARIANCE LOCATION.
- ALL EXISTING TREES AND SHRUBS SHALL BE RETAINED UNLESS OTHERWISE NOTED. PROPOSED TREES INSTALLED BY OTHERS UNLESS OTHERWISE NOTED.
- ALL EXISTING FEATURES AT THE BACK OF SIDEWALK SHALL REMAIN IN PLACE UNLESS OTHERWISE NOTED. DAMAGES OR DISLDDING OF FEATURES AT BACK OF SIDEWALK SHALL BE REPAIRED/REPLACED AT NO ADDITIONAL COST TO THE OWNER.
- CONTRACTOR SHALL MATCH THE EXISTING GRADE AT THE LIMITS OF CONSTRUCTION. FOR PAVEMENT LIMITS, THE JOINT BETWEEN EXISTING AND PROPOSED PAVEMENT SHALL BE TREATED WITH INFRARED PAVEMENT SEALANT AND HOT POURED RUBBERIZED ASPHALT SEALER.
- ALL EXISTING SIGNS SHALL BE REMOVED AND REPLACED UNLESS OTHERWISE NOTED. ALL REINSTALLED SIGNS OR PROPOSED SIGNS SHALL BE LOCATED A LATERAL CLEARANCE OF 1' FROM THE CURB.
- WHERE SIDEWALKS ARE LESS THAN 5' WIDE, PASSING ZONES HAVE BEEN IDENTIFIED EVERY 200' WITHIN ACCESSIBLE ROUTES. PASSING ZONES SHALL BE A MINIMUM SIZE OF 5X5' AND HAVE A MAXIMUM SLOPE OF 1.5% IN ALL DIRECTIONS. ADA ACCESSIBLE ROUTES ARE NOTED ON THE DRAWINGS.
- LOCATIONS WHERE CONCRETE OR BRICK SIDEWALKS ARE UNABLE TO BE INSTALLED DUE TO THE PRESENCE OF ROOTS AT EXISTING TREES; APPROXIMATE LIMITS OF FLEXI-PAVE ARE INDICATED ON THE DRAWINGS. LIMITS OF FLEXI-PAVE SHALL BE FINALIZED IN THE FIELD UPON THE REMOVAL OF THE EXISTING SIDEWALK AND REVIEW OF ROOT LOCATIONS. FOR FLEXIBLE POROUS PAVING, REFER TO SPECIFICATION SECTION 02520.
- CONTRACTOR SHALL NOT PERFORM ANY WORK ON PRIVATE PROPERTY UNTIL A SIGNED RIGHT-OF-ENTRY (ROE) IS RECEIVED BY DPW FROM THE PROPERTY OWNER. ROEs SHALL BE PERFORMED BY THE DPW PROJECT MANAGER.

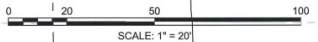
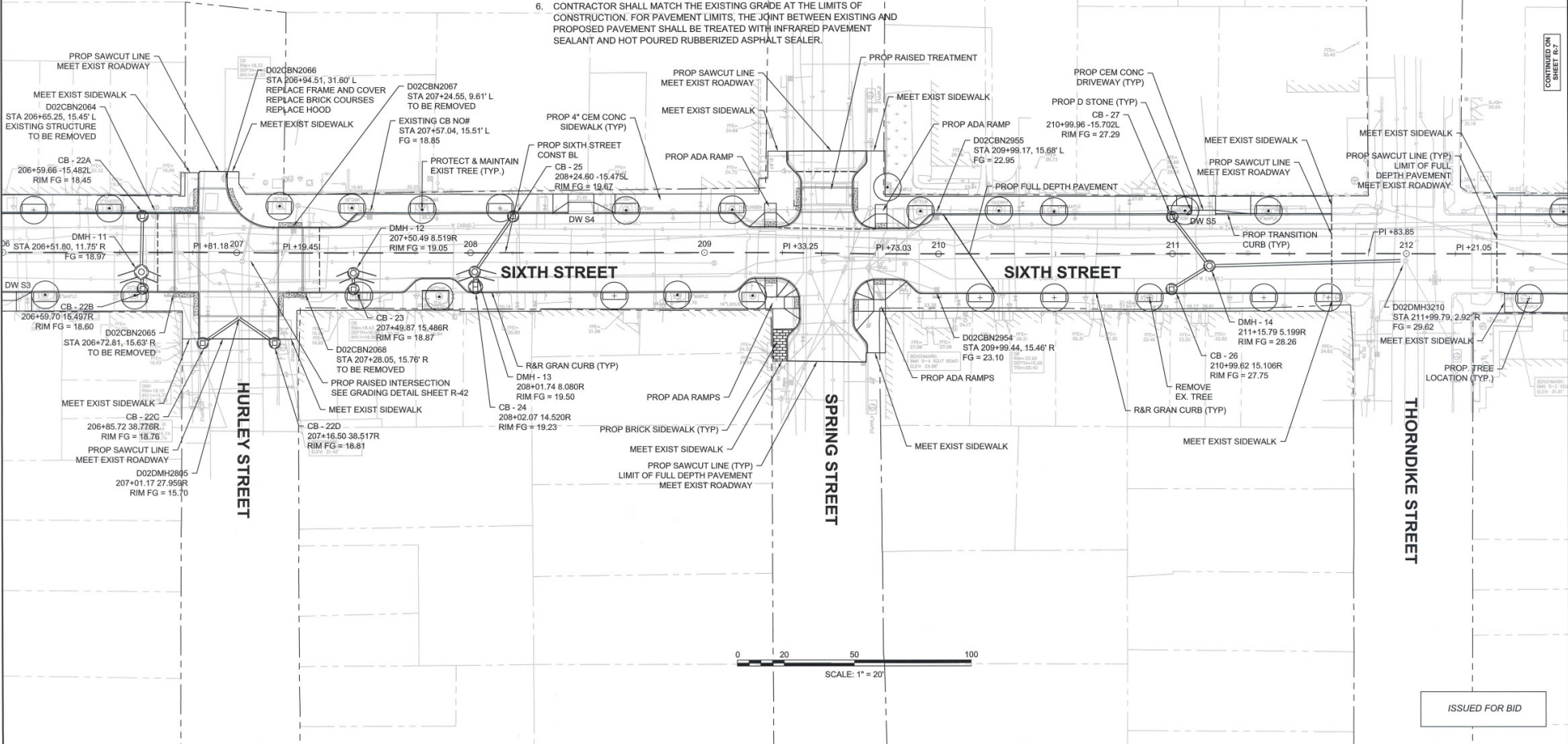

ISSUED FOR BID

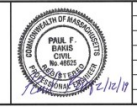

Scale	AS NOTED
Date	FEBRUARY 2018
Job No.	20170208-0154
Designed by	OTM
Drawn by	OTM
Checked by	PF8
Approved by	PF8



Client	CITY OF CAMBRIDGE, MASSACHUSETTS
Project	CHAPTER 90 CONTRACT 23B ROADWAY IMPROVEMENT PROJECT
Drawing	SIXTH STREET CONSTRUCTION PLANS SHEET 2 OF 3

Sheet	R-6
File No.	8435

CADD FILE: I:\projects\2017\0208-0154\CONSTRUCTION\BOTH\Reg\_LANDT\_BV1712\_PLOT021.dwg; PLOT: CONSTRUCTION\BOTH\Reg\_LANDT\_BV1712\_PLOT021.dwg; 2/20/18 4:47 PM; PLOT: 2/20/18 4:47 PM

- NOTES:
- CONTRACTOR SHALL ADJUST EXISTING UTILITY COVERS AND CASTINGS TO REGRADED SURFACES. THE CONTRACTOR SHALL COORDINATE WITH RESPECTIVE UTILITY COMPANIES FOR GAS/TELECOM/CABLE/ELECTRIC.
  - ALL VERTICAL GRANITE CURBING WITHIN WORK LIMITS SHALL BE REMOVED AND RESET UNLESS OTHERWISE NOTED.
  - CONTRACTOR SHALL MAINTAIN A MINIMUM OF 3'-0" WIDE SIDEWALK BEHIND EXISTING TREES AND 4'-0" WIDE SIDEWALK BEHIND PROPOSED TREE LOCATIONS UNLESS THE SIDEWALK HAS BEEN IDENTIFIED ON THE PLANS AS BEING WITHIN AN ADA VARIANCE LOCATION.
  - ALL EXISTING TREES AND SHRUBS SHALL BE RETAINED UNLESS OTHERWISE NOTED. PROPOSED TREES INSTALLED BY OTHERS UNLESS OTHERWISE NOTED.
  - ALL EXISTING FEATURES AT THE BACK OF SIDEWALK SHALL REMAIN IN PLACE UNLESS OTHERWISE NOTED. DAMAGES OR DISLODGING OF FEATURES AT BACK OF SIDEWALK SHALL BE REPAIRED/REPLACED AT NO ADDITIONAL COST TO THE OWNER.
  - CONTRACTOR SHALL MATCH THE EXISTING GRADE AT THE LIMITS OF CONSTRUCTION. FOR PAVEMENT LIMITS, THE JOINT BETWEEN EXISTING AND PROPOSED PAVEMENT SHALL BE TREATED WITH INFRARED PAVEMENT SEALANT AND HOT POURED RUBBERIZED ASPHALT SEALER.
  - ALL EXISTING SIGNS SHALL BE REMOVED AND REPLACED UNLESS OTHERWISE NOTED. ALL REINSTALLED SIGNS OR PROPOSED SIGNS SHALL BE LOCATED AT A LATERAL CLEARANCE OF 1' FROM THE CURB.
  - WHERE SIDEWALKS ARE LESS THAN 5' WIDE, PASSING ZONES HAVE BEEN IDENTIFIED EVERY 200' WITHIN ACCESSIBLE ROUTES. PASSING ZONES SHALL BE A MINIMUM SIZE OF 5X5' AND HAVE A MAXIMUM SLOPE OF 1.5% IN ALL DIRECTIONS. ADA ACCESSIBLE ROUTES ARE NOTED ON THE DRAWINGS.
  - LOCATIONS WHERE CONCRETE OR BRICK SIDEWALKS ARE UNABLE TO BE INSTALLED DUE TO THE PRESENCE OF ROOTS AT EXISTING TREES, APPROXIMATE LIMITS OF FLEXI-PAVE ARE INDICATED ON THE DRAWINGS. LIMITS OF FLEXI-PAVE SHALL BE FINALIZED IN THE FIELD UPON THE REMOVAL OF THE EXISTING SIDEWALK AND REVIEW OF ROOT LOCATIONS. FOR FLEXIBLE POROUS PAVING, REFER TO SPECIFICATION SECTION 02520.
  - CONTRACTOR SHALL NOT PERFORM ANY WORK ON PRIVATE PROPERTY UNTIL A SIGNED RIGHT-OF-ENTRY (ROE) IS RECEIVED BY DPW FROM THE PROPERTY OWNER. ROES SHALL BE PERFORMED BY THE DPW PROJECT MANAGER.

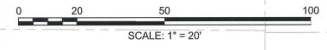
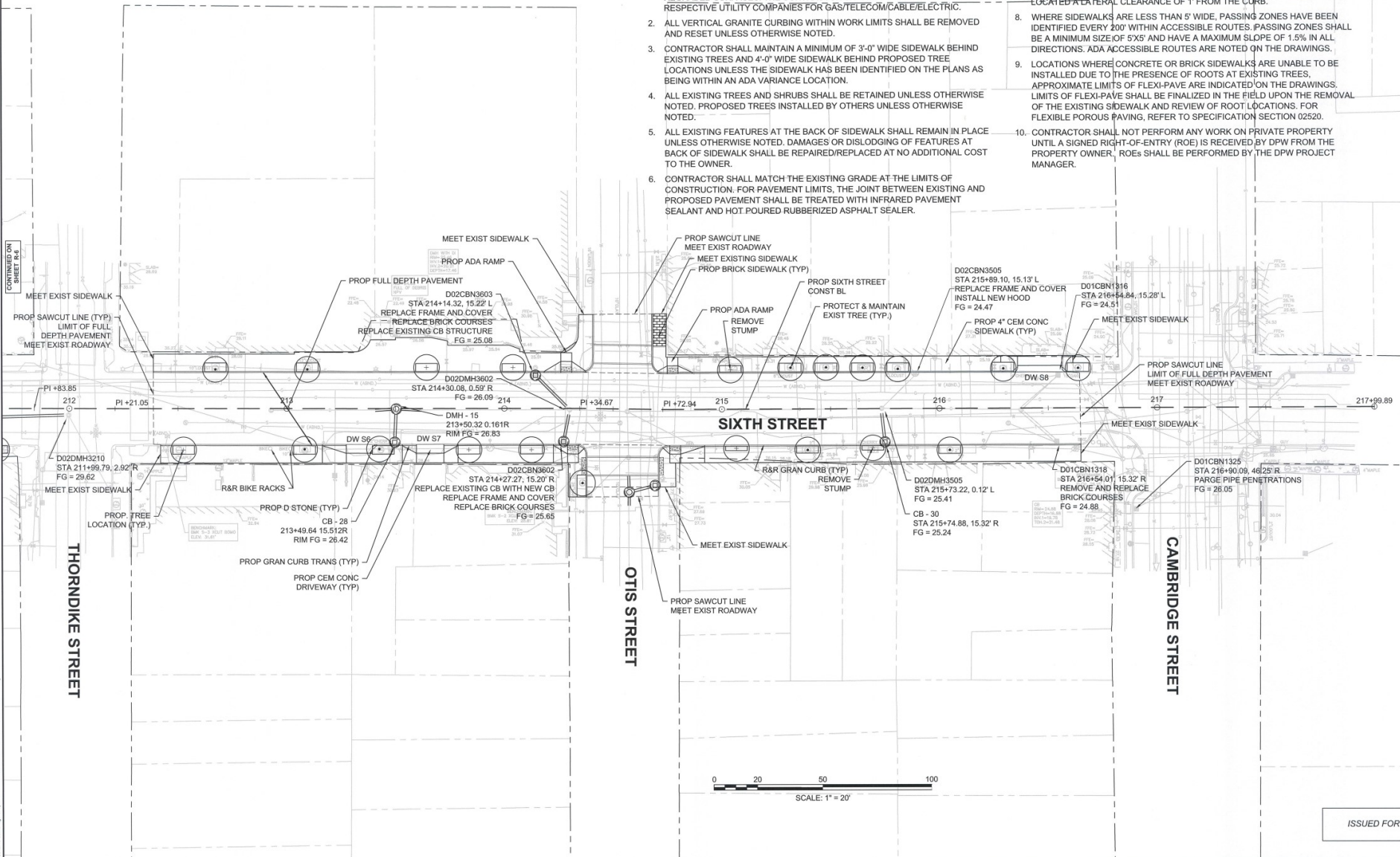

ISSUED FOR BID

D02CBN3603 STA 214+14.32, 15.22' L REPLACE FRAME AND COVER REPLACE BRICK COURSES REPLACE EXISTING CB STRUCTURE FG = 25.08  
 D02DMH3602 STA 214+30.08, 0.59' R FG = 26.09  
 DMH-15 213+50.32, 0.161' R RIM FG = 26.83  
 D02CBN3602 STA 214+27.27, 15.20' R REPLACE EXISTING CB WITH NEW CB REPLACE FRAME AND COVER REPLACE BRICK COURSES FG = 25.65  
 D02DMH3505 STA 215+73.22, 0.12' L FG = 25.41  
 CB-30 STA 215+74.88, 15.32' R FG = 25.24  
 D02CBN3505 STA 215+89.10, 15.13' L REPLACE FRAME AND COVER INSTALL NEW HOOD FG = 24.47  
 D01CBN1916 STA 216+54.84, 15.28' L FG = 24.51  
 D01CBN1318 STA 216+54.01, 15.32' R REMOVE AND REPLACE BRICK COURSES FG = 24.88  
 D01CBN1325 STA 216+90.09, 46.25' R PARGE PIPE PENETRATIONS FG = 26.05



Scale	AS NOTED			
Date	FEBRUARY 2019			
Job No.	20170208-0184			
Designed by	DTM			
Drawn by	DTM			
Checked by	PFB	No.	Description	Date
Approved by	PFB		REVISIONS	



Client	CITY OF CAMBRIDGE, MASSACHUSETTS
Project	CHAPTER 90 CONTRACT 23B ROADWAY IMPROVEMENT PROJECT
Drawing	SIXTH STREET CONSTRUCTION PLANS SHEET 3 OF 3

Sheet	R-7
File No.	8435