

# Porter Square Design Project

City of Cambridge  
and  
Porter Square Citizen Advisory Committee

*In Association With:  
Earth Tech, Inc.  
Halvorson Design Partnership*

Community Meeting – February 26, 2003

# AGENDA

- 1. *PROJECT BACKGROUND AND DESIGN PROCESS***
- 2. *PROJECT GOALS***
- 3. *ADVISORY COMMITTEE PERSPECTIVE***
- 4. *REVIEW OF PLAN***
- 5. *SMALL GROUP DISCUSSIONS***
- 6. *REPORTING BACK***
- 7. *NEXT STEPS***

# AGENDA

1. ***PROJECT BACKGROUND AND DESIGN PROCESS***
2. *PROJECT GOALS*
3. *ADVISORY COMMITTEE PERSPECTIVE*
4. *REVIEW OF PLAN*
5. *SMALL GROUP DISCUSSIONS*
6. *REPORTING BACK*
7. *NEXT STEPS*



# PROJECT AREA

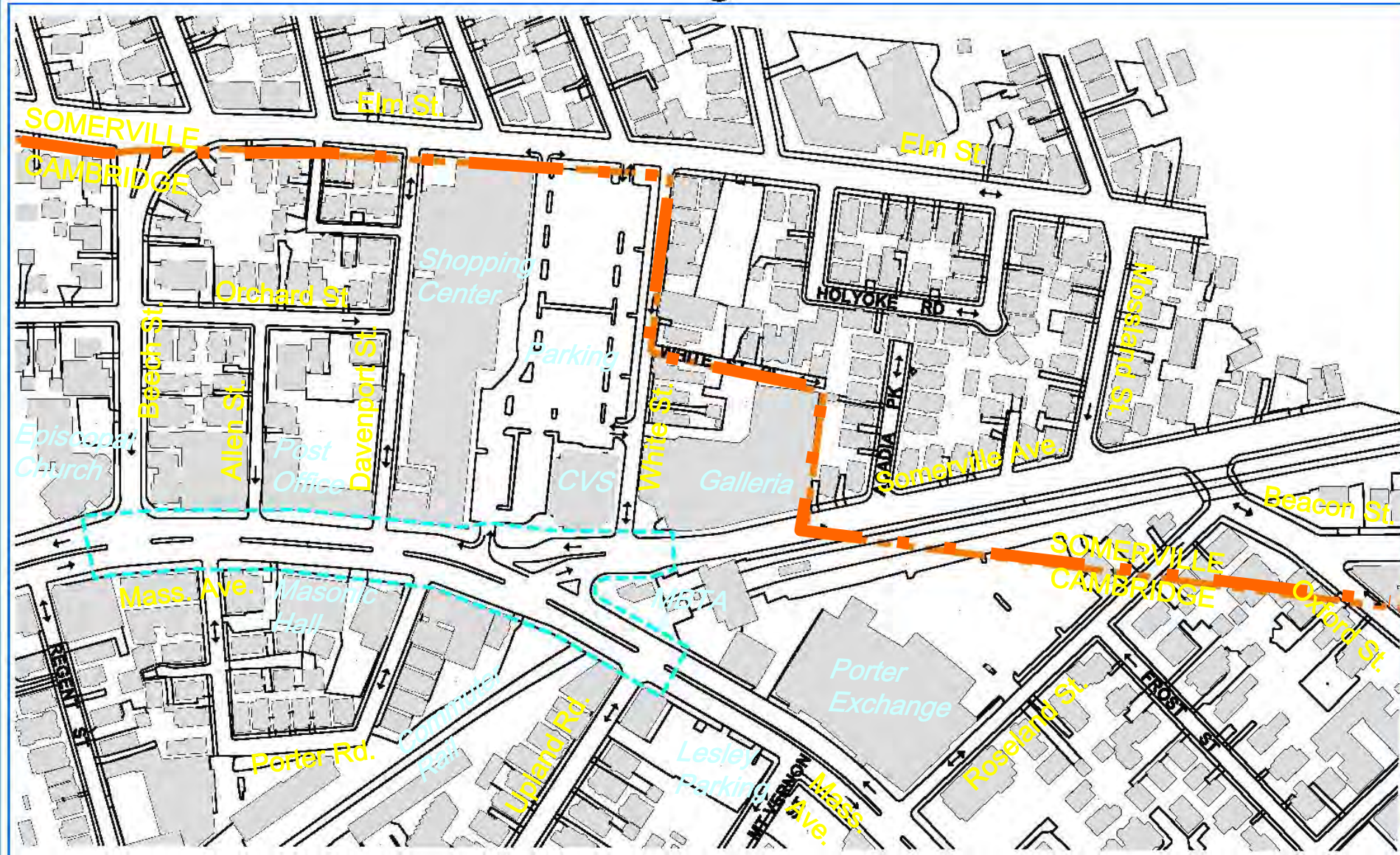

PORTER SQUARE DESIGN PROJECT



# BACKGROUND AND PROCESS

- ***PORTER SQUARE CAC FORMED IN 1997***
  - ***14 Members Including Residents and Business Owners***
- ***CAC MET DURING 1997-1998***
- ***CAC RECONVENED IN FALL 2002***
- ***DESIGN THROUGH SUMMER 2003***
- ***CONSTRUCTION IN EARLY 2004***

# AGENDA

1. *PROJECT BACKGROUND AND DESIGN PROCESS*
2. ***PROJECT GOALS***
3. *ADVISORY COMMITTEE PERSPECTIVE*
4. *REVIEW OF PLAN*
5. *SMALL GROUP DISCUSSIONS*
6. *REPORTING BACK*
7. *NEXT STEPS*

# GOALS AND CHALLENGES

- *Reduce Vehicular Dominance*
- *Improve Conditions for Pedestrians, Cyclists, Transit Users*
- *Reduce Cut-Through and Shopping Center Traffic on Local Streets*
- *Improve Streetscape – Create Sense of Place*
- *Improve Traffic Safety for All Users*
- *Maintain Traffic Level of Service at or Near Existing Conditions*



# REDUCE VEHICULAR DOMINANCE





# IMPROVE CONDITIONS FOR PEDS/BIKES/TRANSIT USERS





# REDUCE TRAFFIC ON LOCAL STREETS

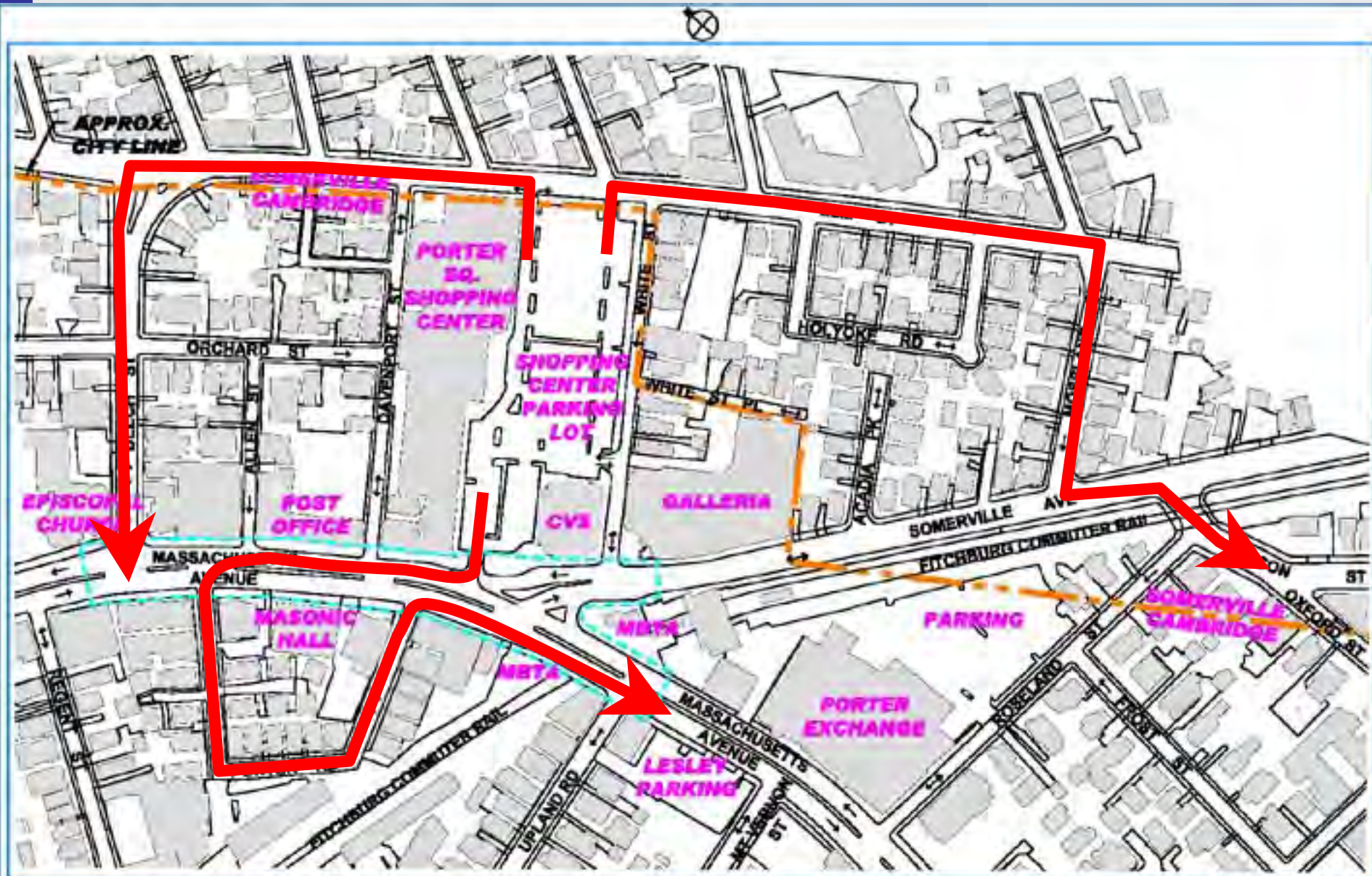

PORTER SQUARE DESIGN PROJECT





# IMPROVE STREETSCAPE / CREATE SENSE OF PLACE



# IMPROVE TRAFFIC SAFETY FOR ALL USERS

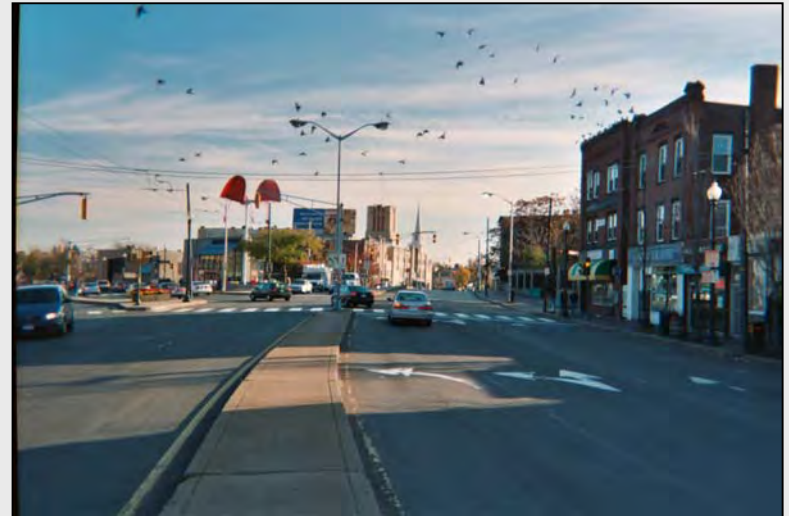



# MAINTAIN TRAFFIC LEVEL-OF-SERVICE AT OR NEAR EXISTING CONDITIONS



# AGENDA

1. *PROJECT BACKGROUND AND DESIGN PROCESS*
2. *PROJECT GOALS*
3. ***ADVISORY COMMITTEE PERSPECTIVE***
4. *REVIEW OF PLAN*
5. *SMALL GROUP DISCUSSIONS*
6. *REPORTING BACK*
7. *NEXT STEPS*

# AGENDA

1. *PROJECT BACKGROUND AND DESIGN PROCESS*
2. *PROJECT GOALS*
3. *ADVISORY COMMITTEE PERSPECTIVE*
4. ***REVIEW OF PLAN***
5. *SMALL GROUP DISCUSSIONS*
6. *REPORTING BACK*
7. *NEXT STEPS*



# PROJECT AREA

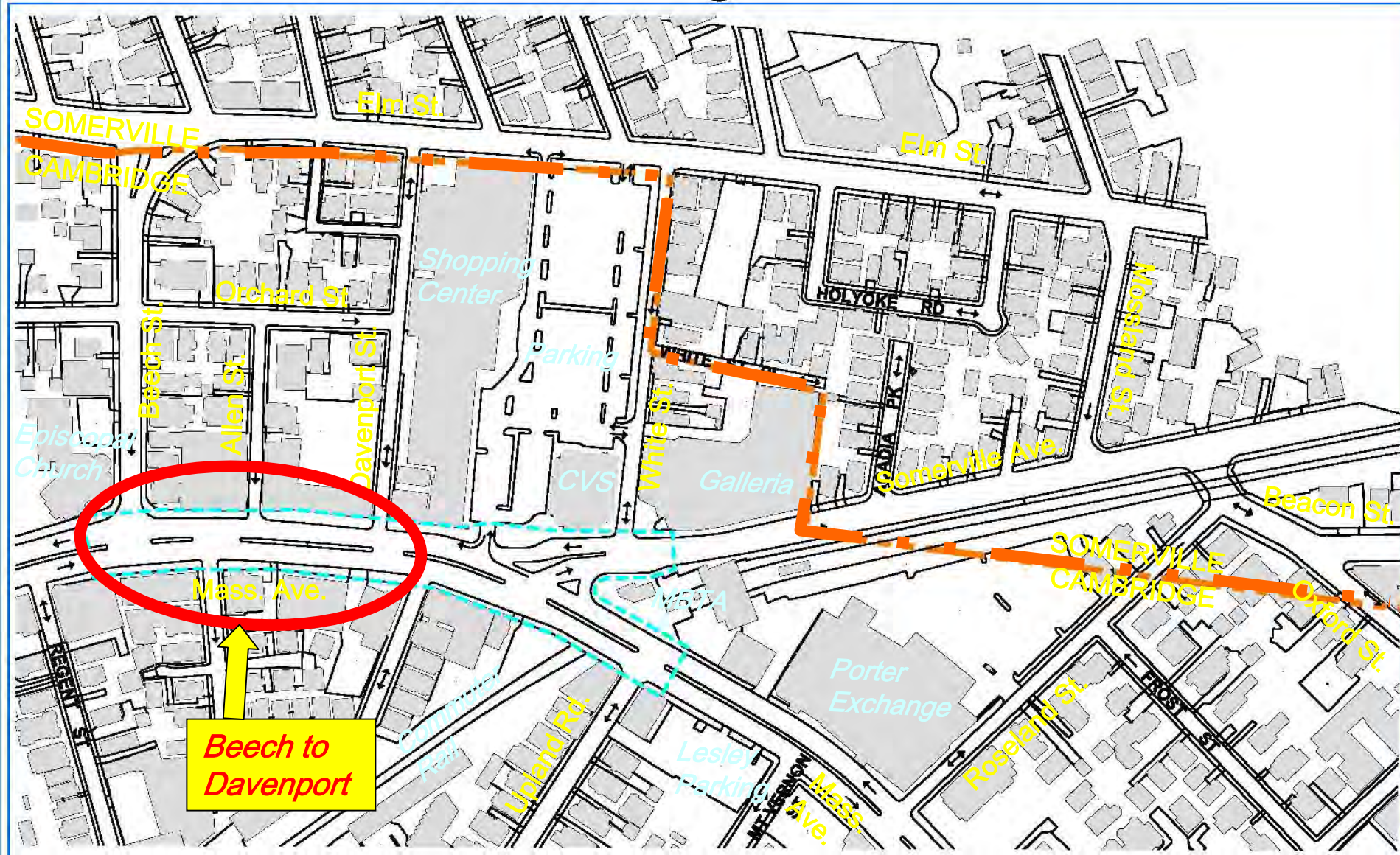

PORTER SQUARE DESIGN PROJECT





# BEECH ST. TO DAVENPORT ST.

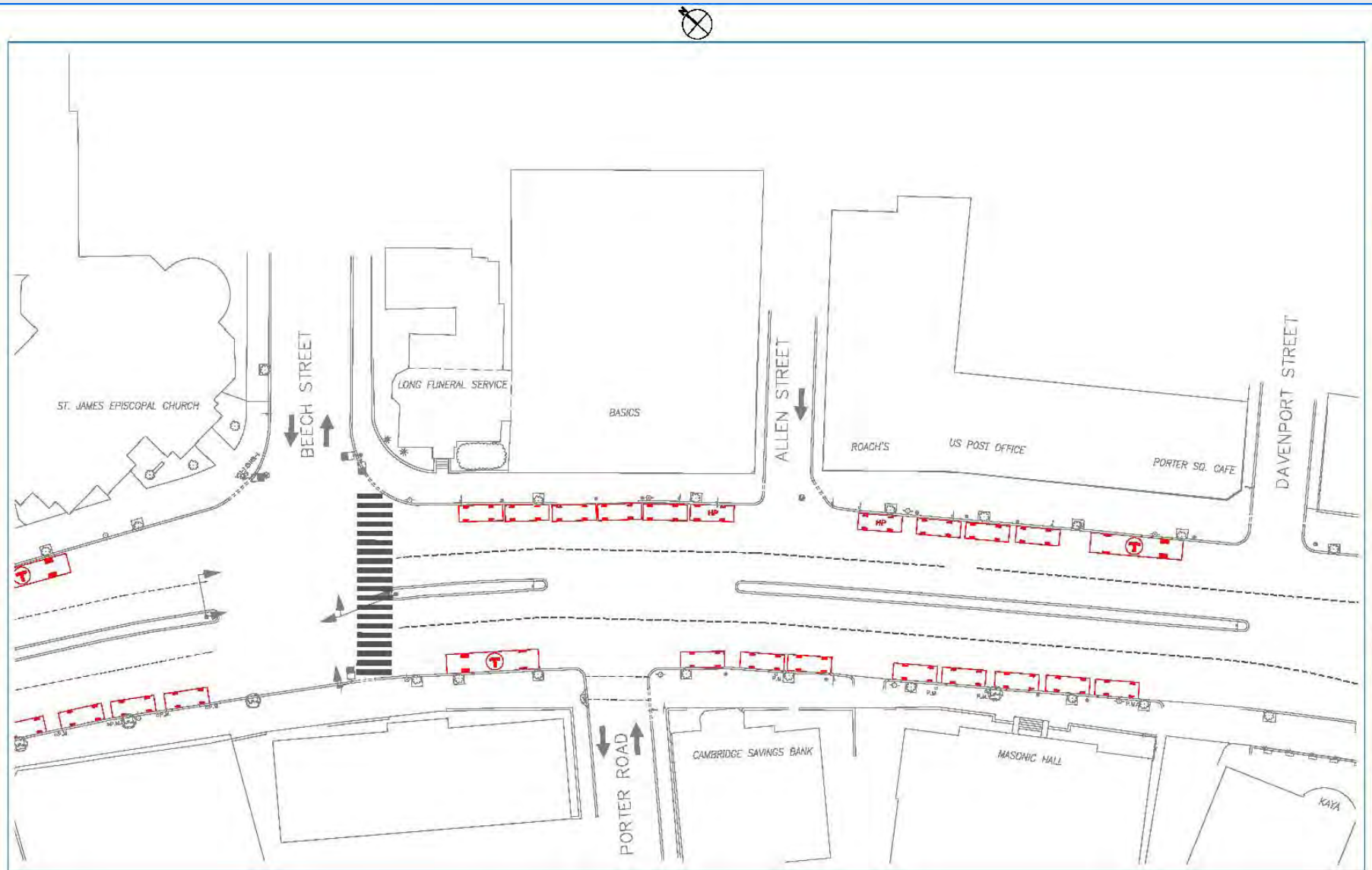

PORTER SQUARE DESIGN PROJECT

# BEECH ST. TO DAVENPORT ST.

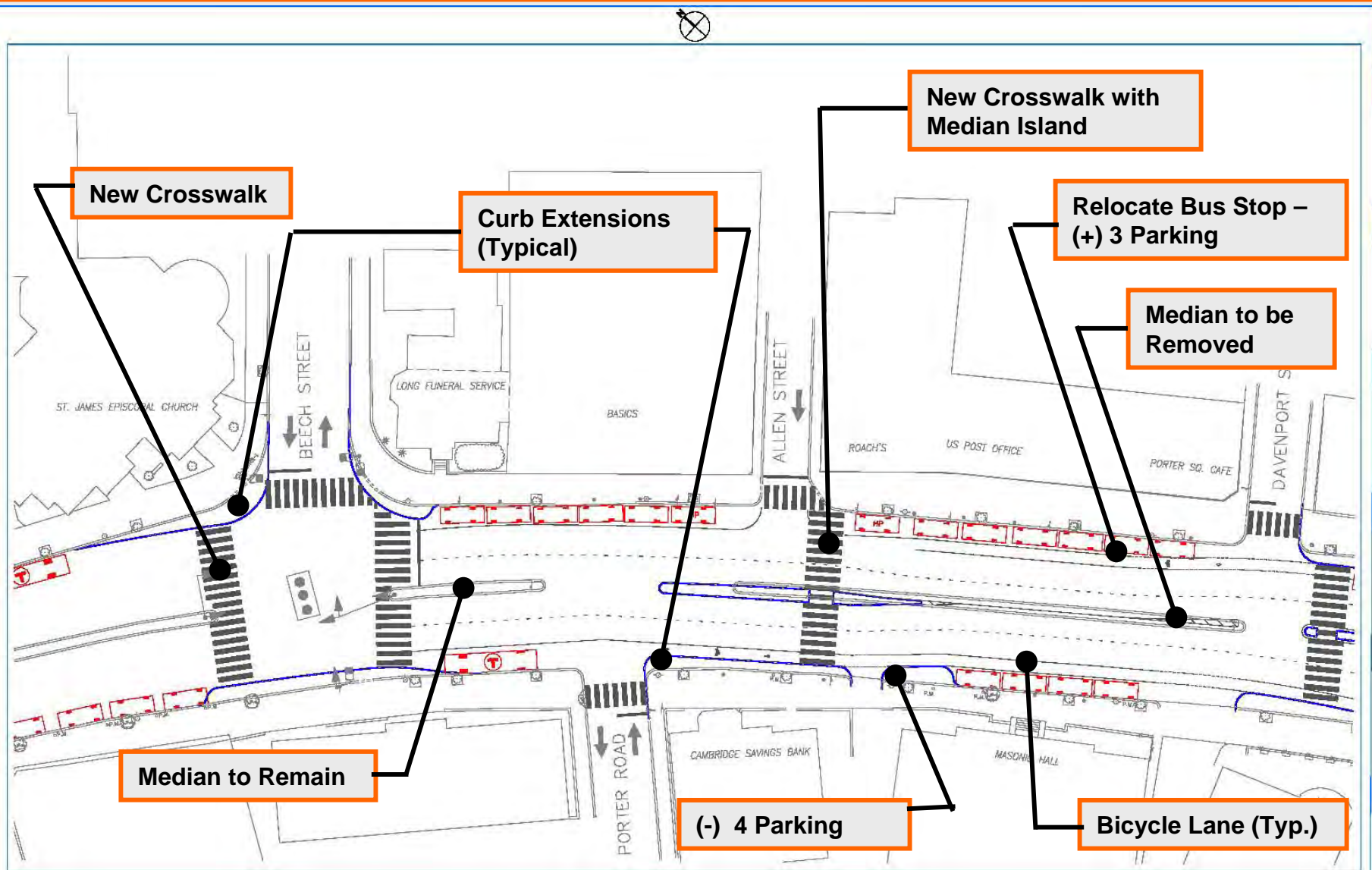

PORTER SQUARE DESIGN PROJECT



# PROJECT AREA

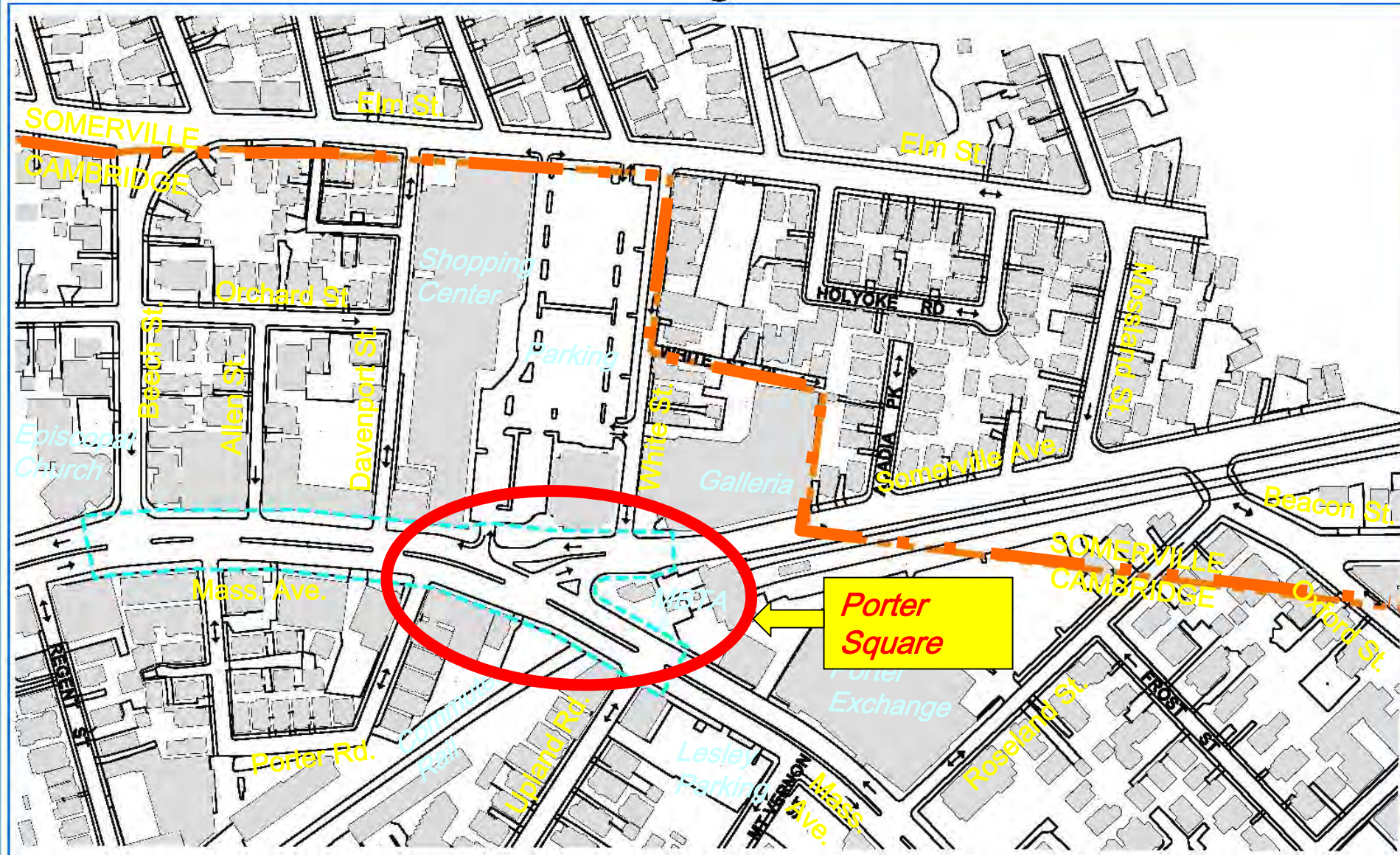

PORTER SQUARE DESIGN PROJECT





# PORTER SQUARE

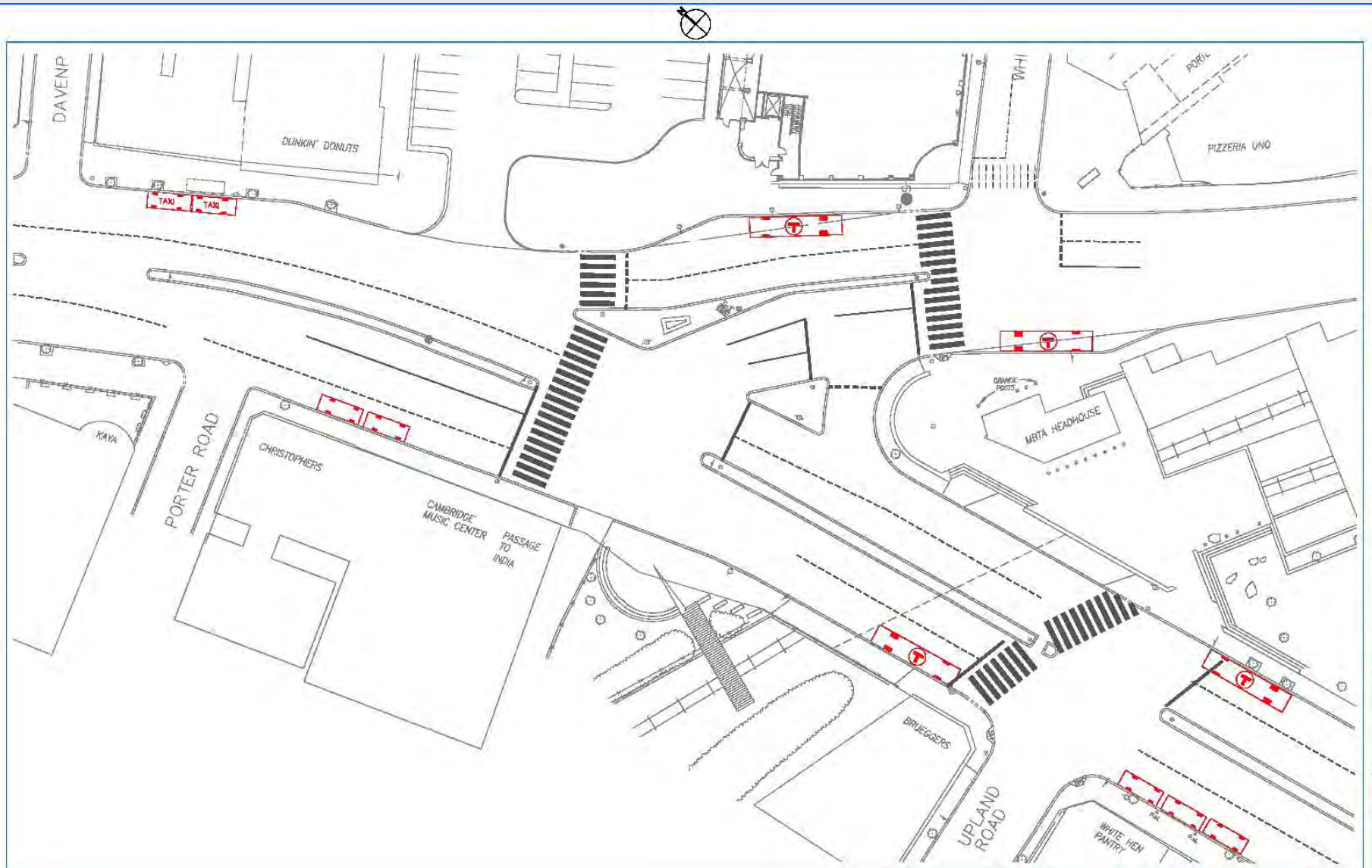

PORTER SQUARE DESIGN PROJECT



# PORTER SQUARE

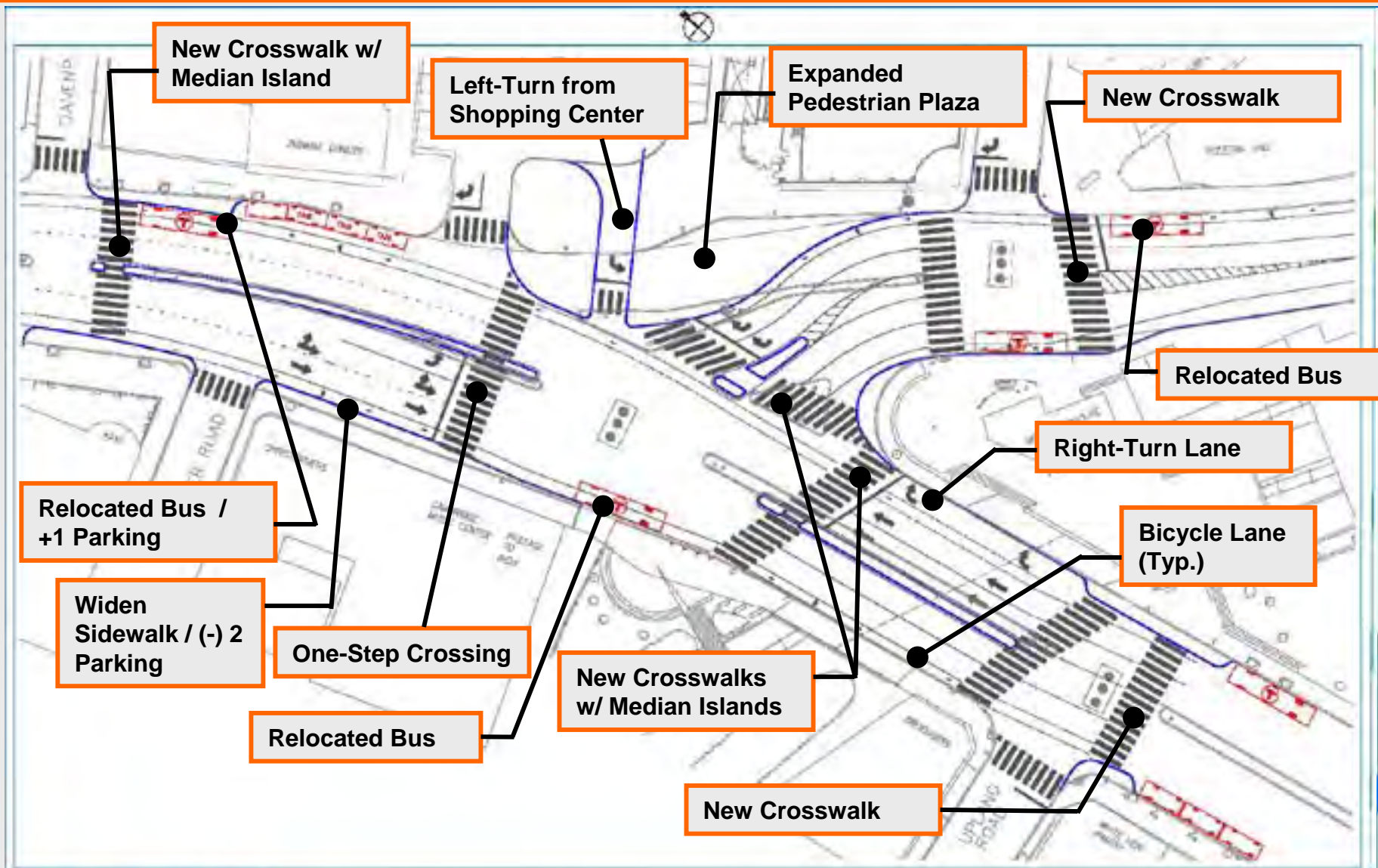

# SIGNAL TIMING (A.M. PEAK)

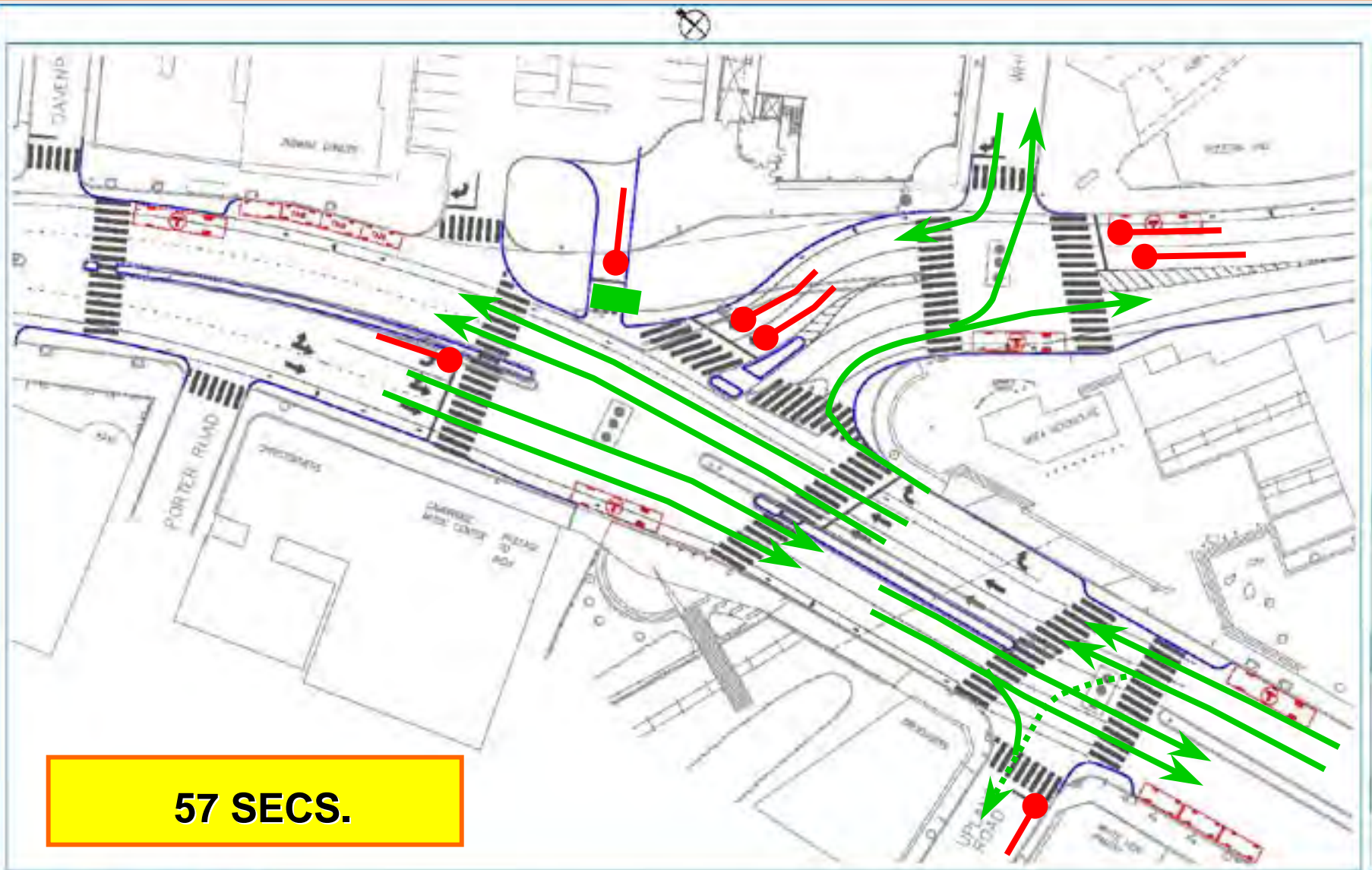

**57 SECS.**



# SIGNAL TIMING (A.M. PEAK)

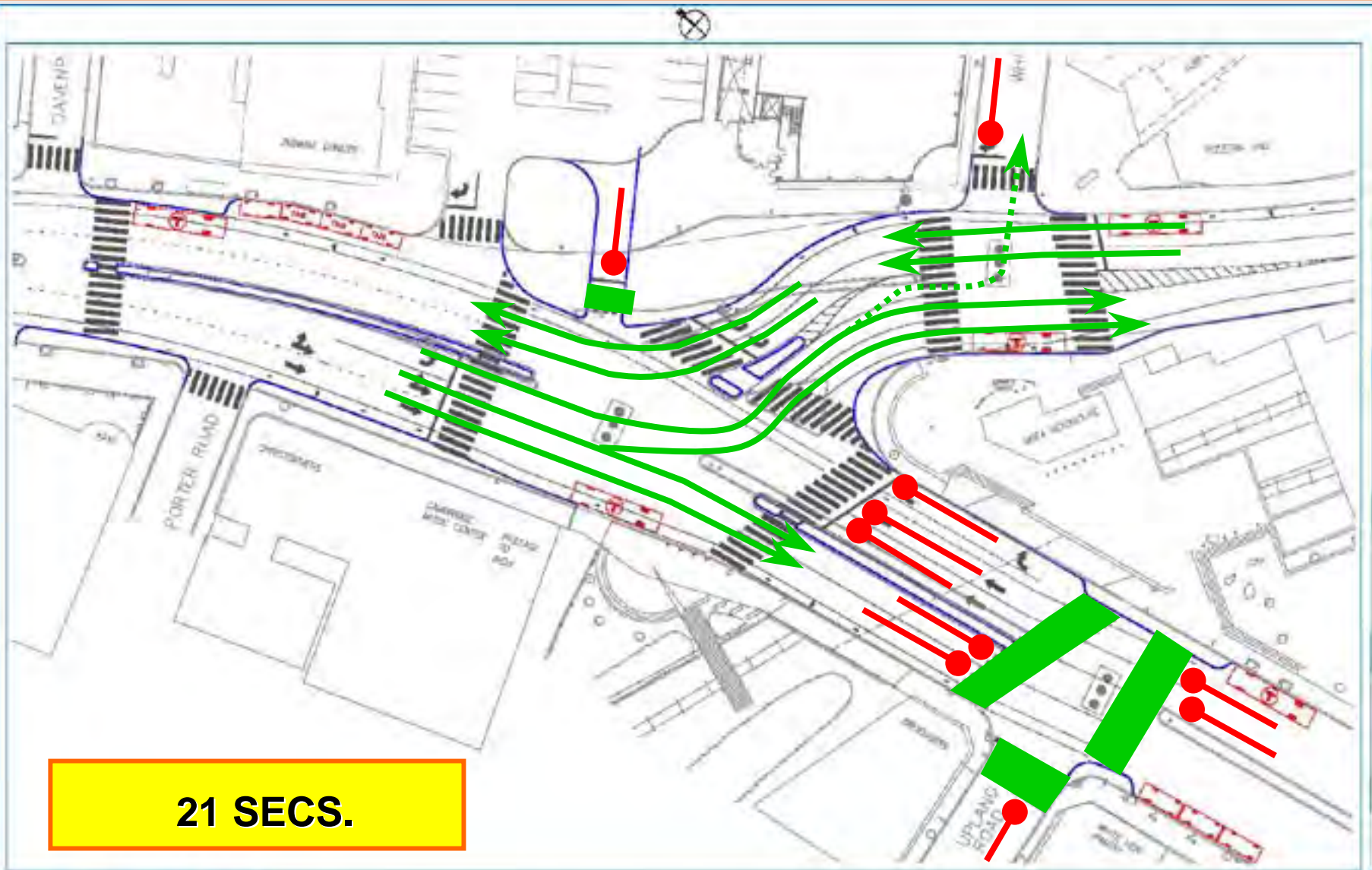

# SIGNAL TIMING (A.M. PEAK)

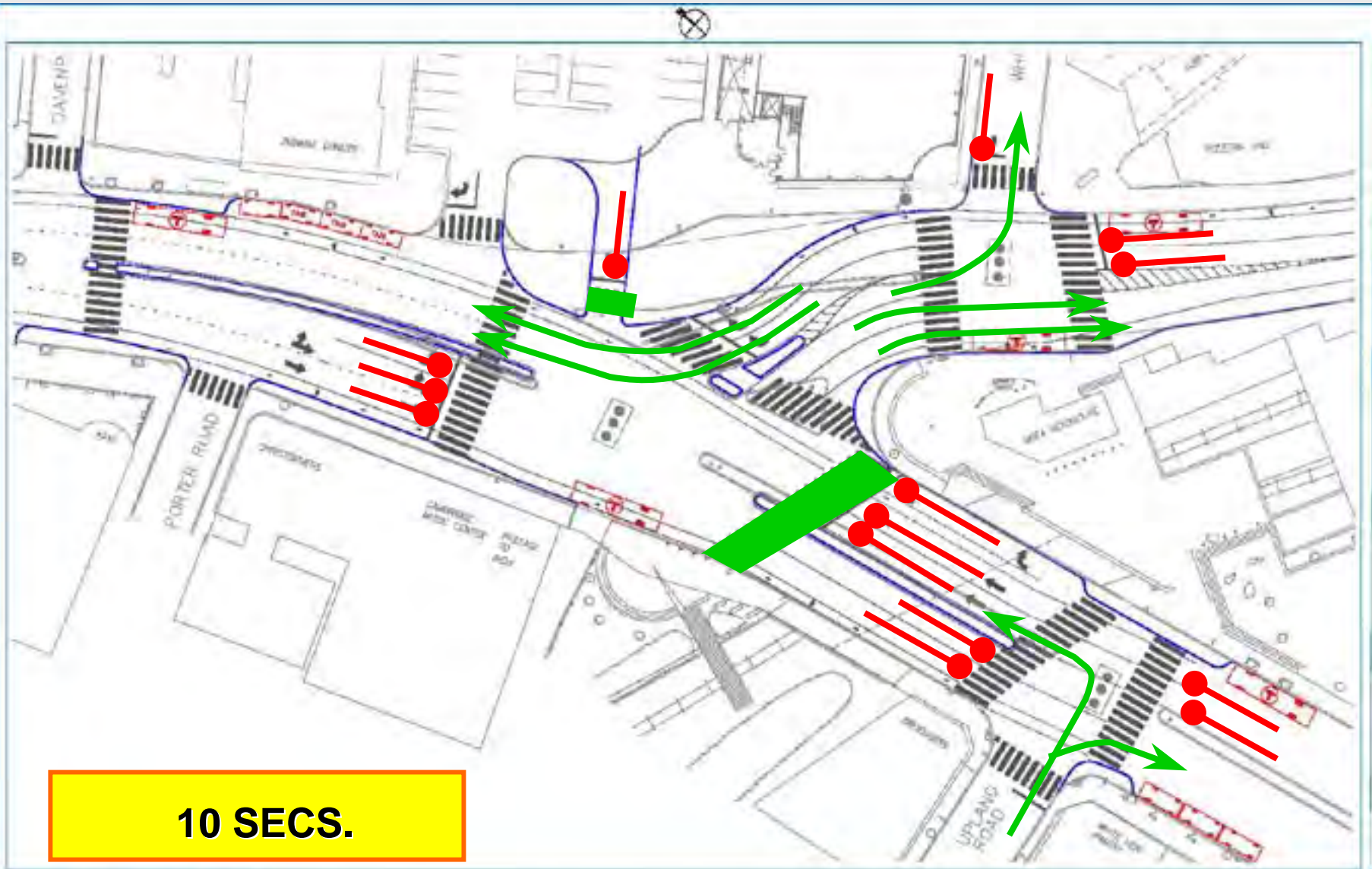

10 SECS.



# SIGNAL TIMING (A.M. PEAK)

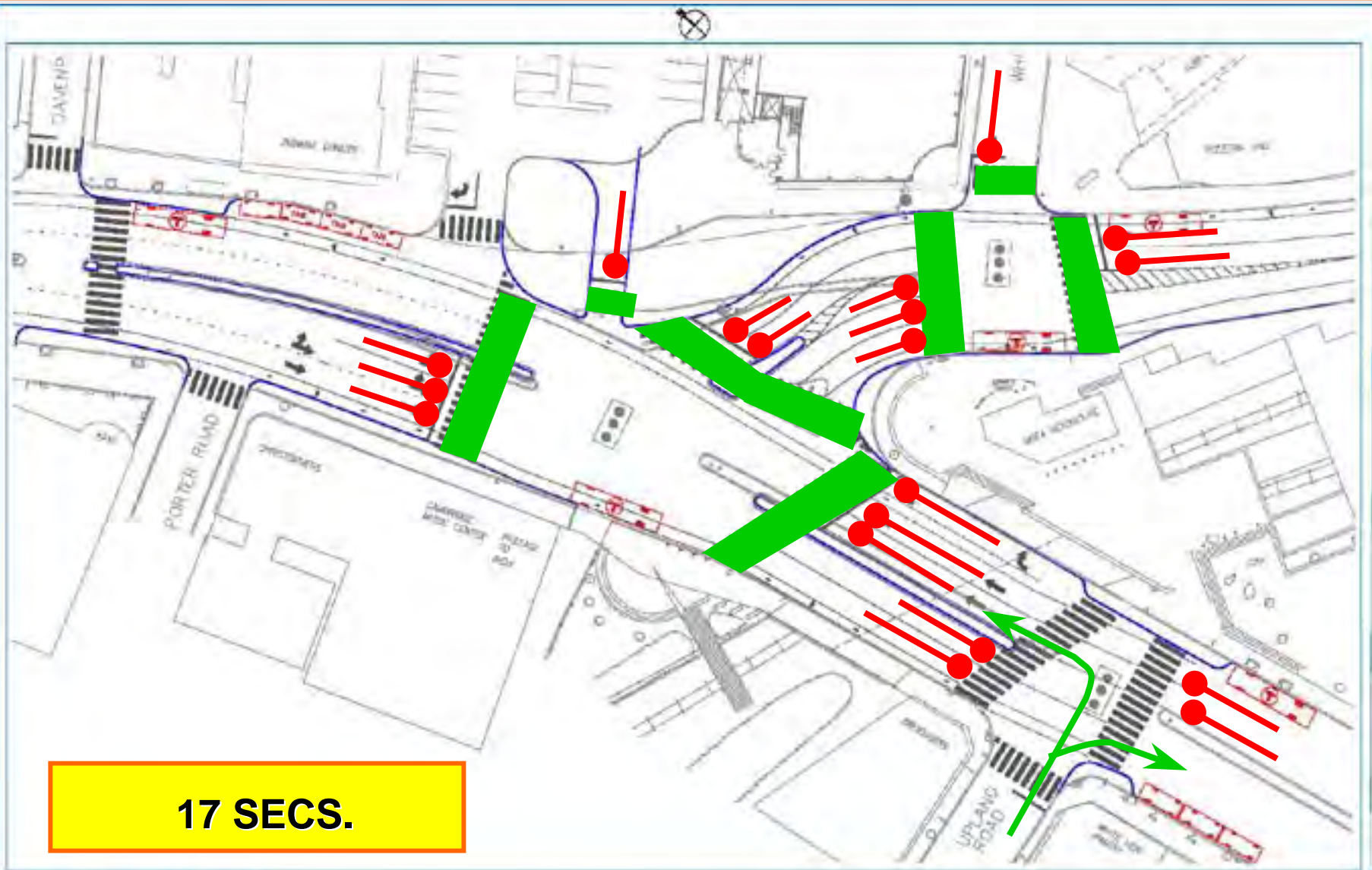

17 SECS.

# SIGNAL TIMING (A.M. PEAK)

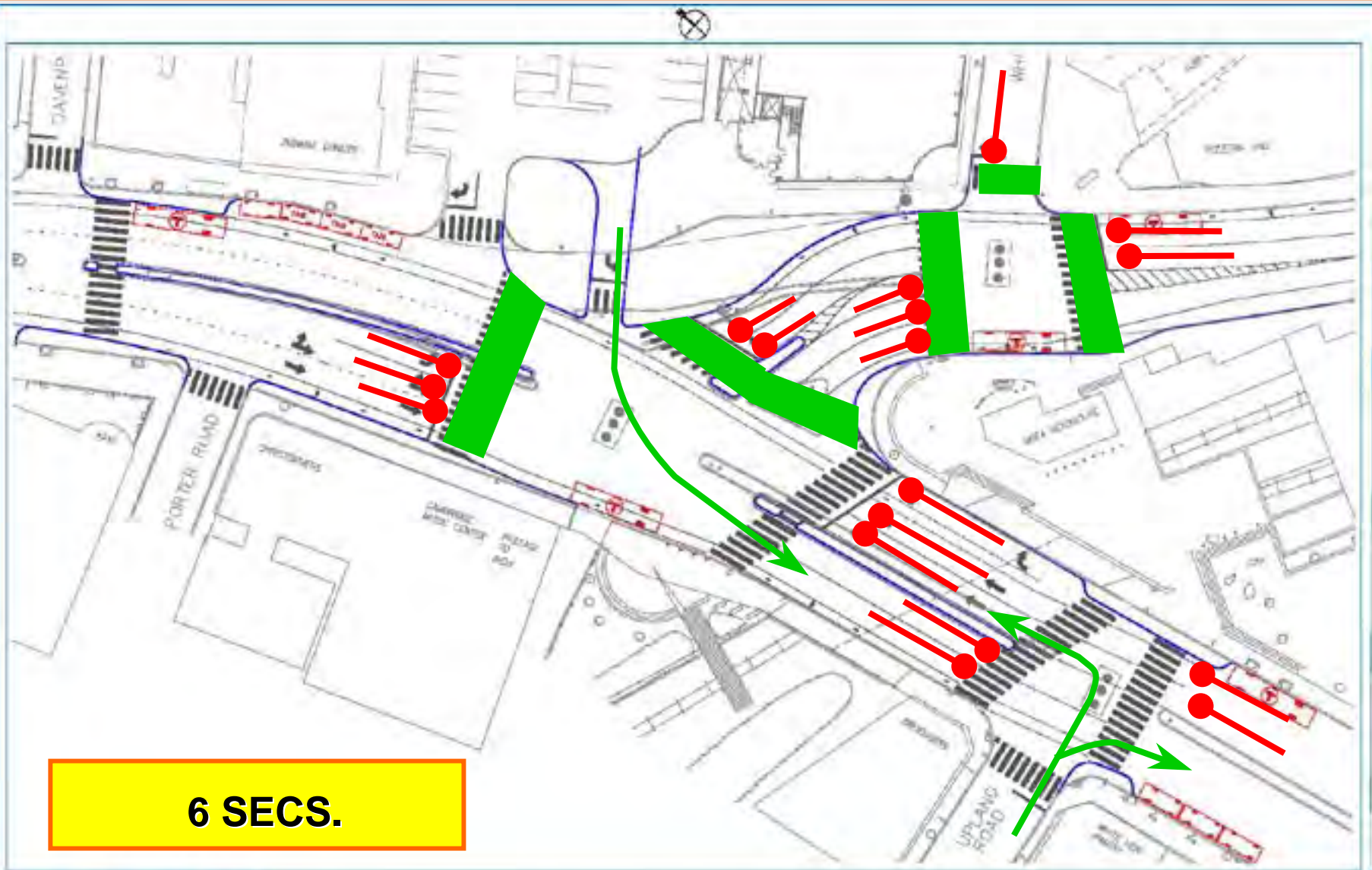

6 SECS.



# SIGNAL TIMING (A.M. PEAK)

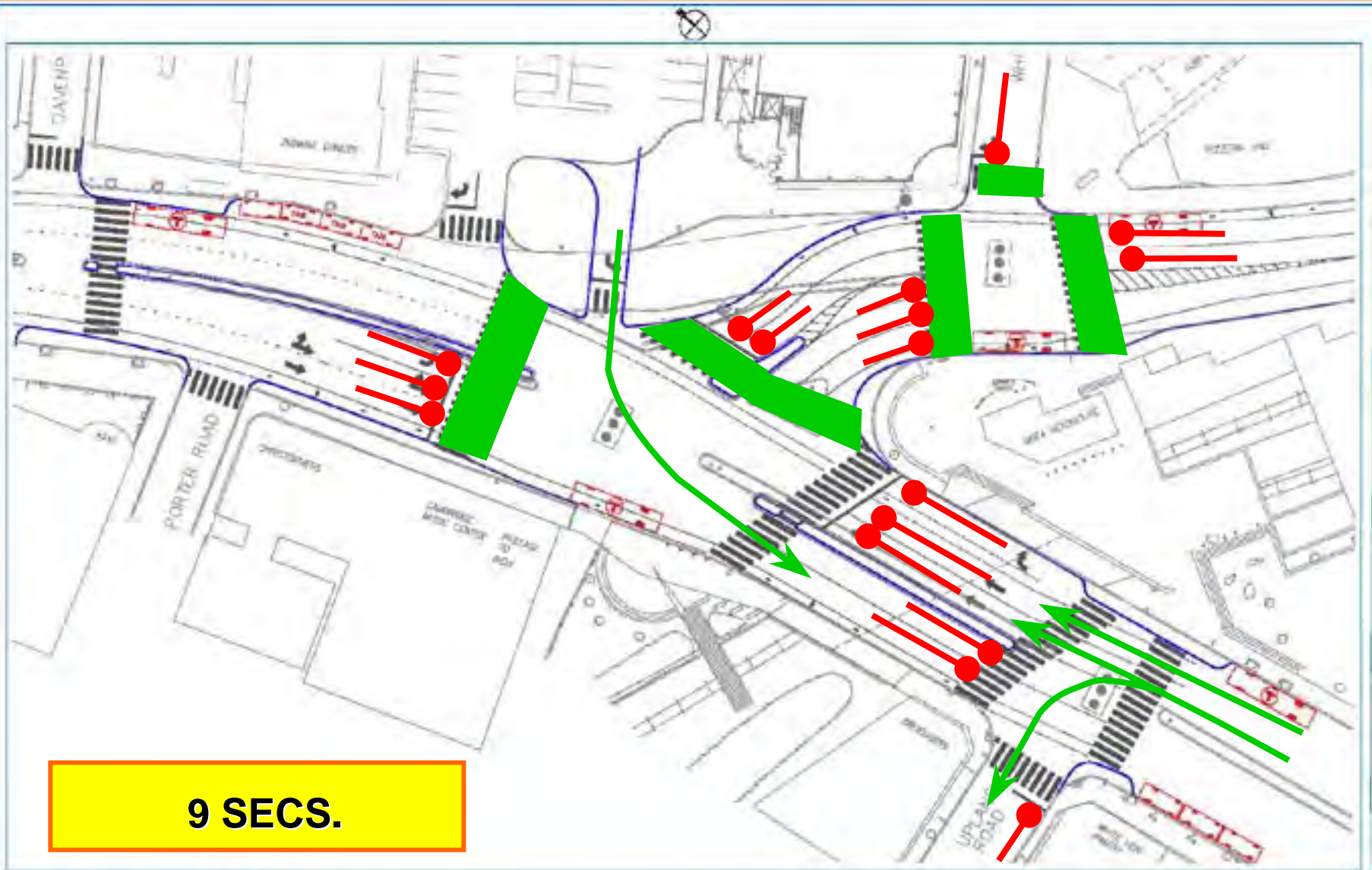

9 SECS.



# CROSSWALK TIME PER 120-SEC CYCLE

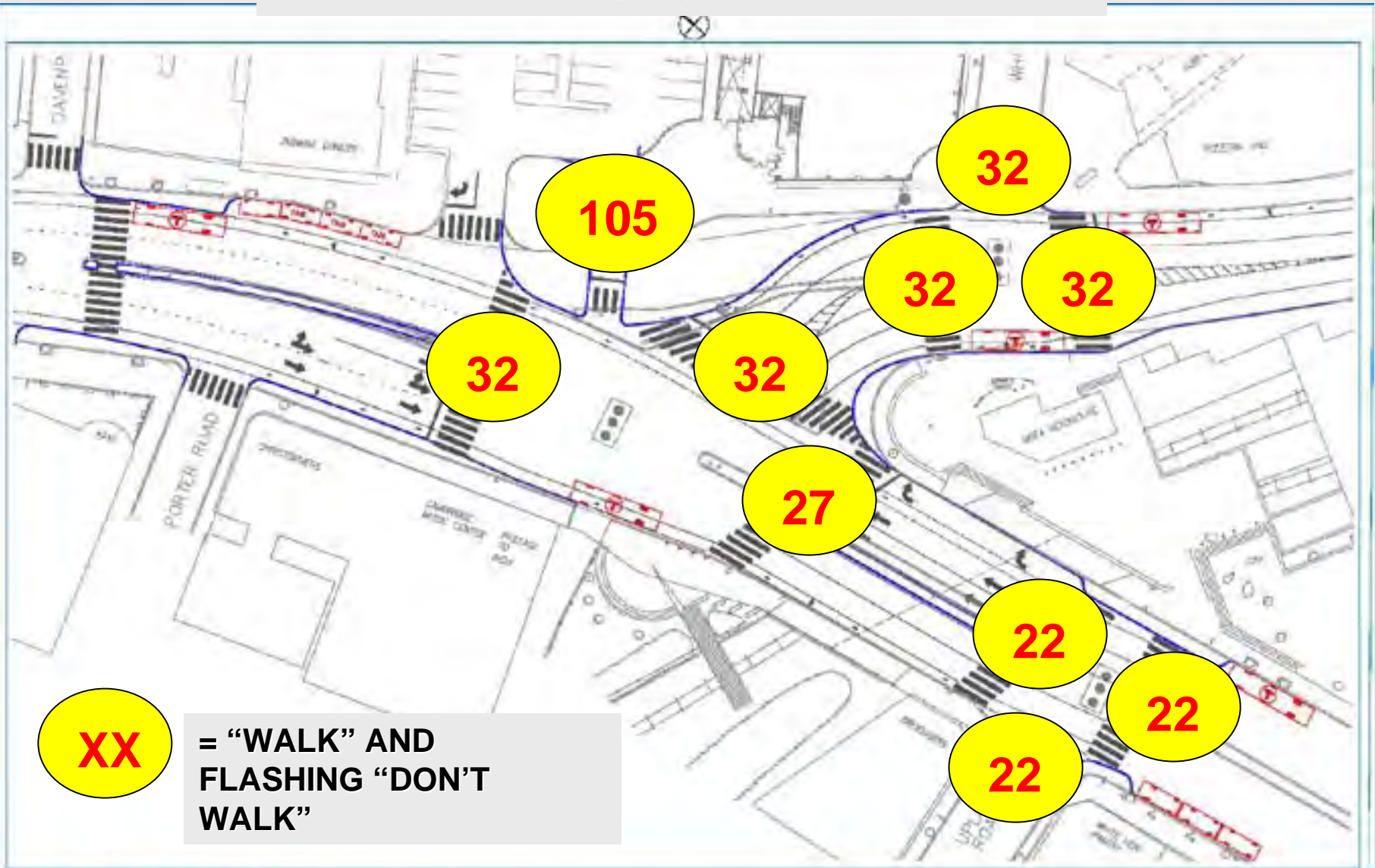

## STREETSCAPE AND PLAZA DESIGN





# STREETSCAPE AND PLAZA DESIGN

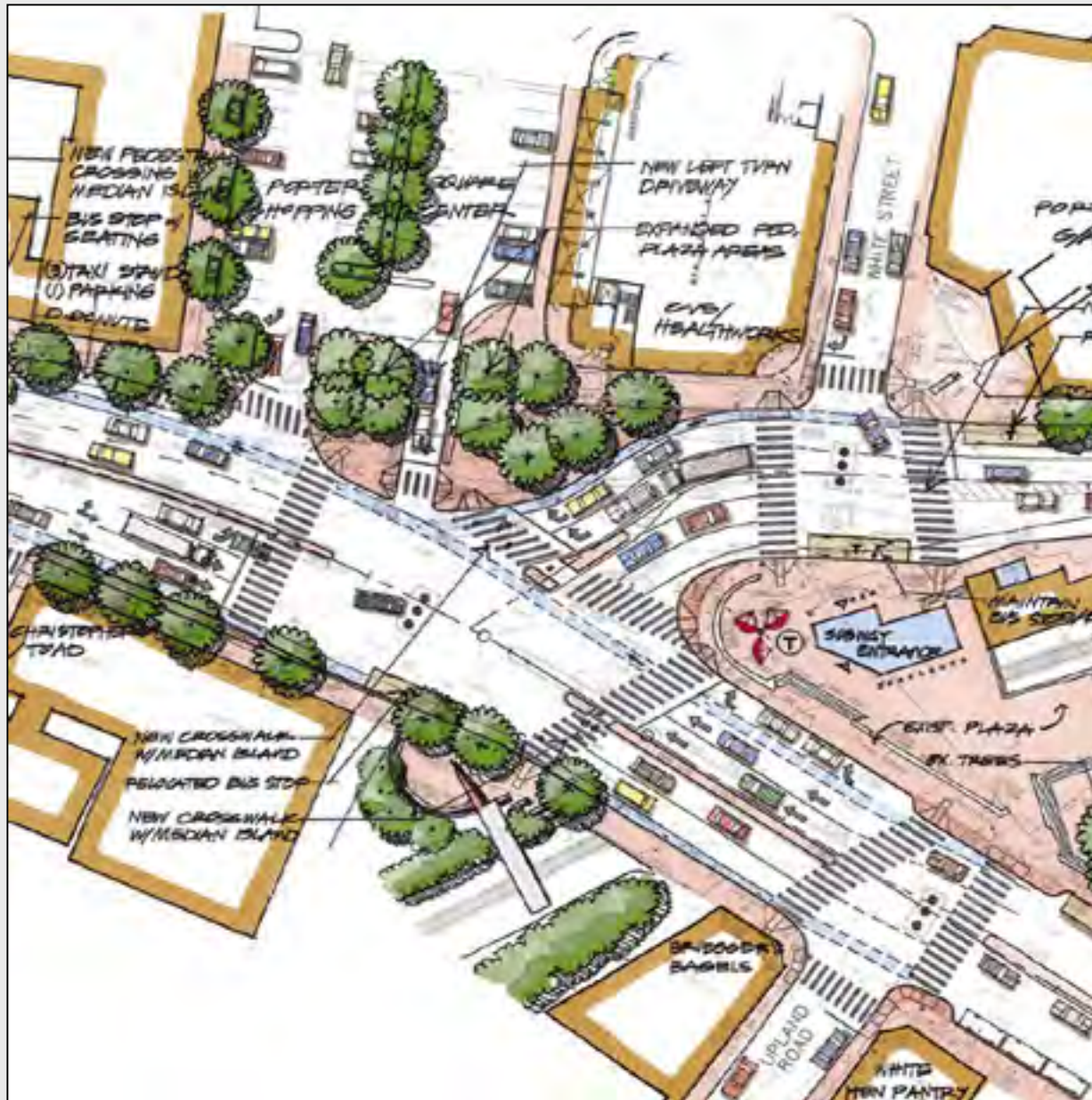



# STREETSCAPE AND PLAZA DESIGN



## REDUCE VEHICULAR DOMINANCE

- ✓ **REALIGN ROADWAYS TO  
REDUCE PAVEMENT AREA AND  
CREATE SIGNIFICANT NEW  
PEDESTRIAN SPACE**



# IMPROVE CONDITIONS FOR PEDS/BIKES/TRANSIT USERS

- ✓ ***ADD 7 NEW CROSSWALKS***
- ✓ ***LONGER CROSSING  
TIMES / ELIMINATE 2-STEP  
CROSSINGS***
- ✓ ***PROVIDE BICYCLE LANES***
- ✓ ***COORDINATE BUS STOPS /  
CROSSWALK LOCATIONS***





# REDUCE TRAFFIC ON LOCAL STREETS

✓ ***PROVIDE BETTER BALANCE  
OF VEHICLES EXITING THE  
SHOPPING CENTER***



# IMPROVE STREETScape / CREATE SENSE OF PLACE

- ✓ ***UPGRADE PLANTINGS, SIDEWALKS, LIGHTING***
- ✓ ***INCORPORATE ARTWORK INTO PLAZA***
- ✓ ***ESTABLISH COMMON DESIGN ELEMENTS***





# MAINTAIN TRAFFIC LOS AT OR NEAR EXISTING

- ✓ ***INCREASED DELAY IN MORNING PEAK AT SIGNALIZED INTERSECTIONS***
- ✓ ***IMPACTS ARE WITHIN REASONABLE LIMITS FOR URBAN AREA SUCH AS PORTER SQUARE***
- ✓ ***DECREASED DELAY AT UNSIGNALIZED INTERSECTIONS***



## COMPARISON OF EXISTING VS. PROPOSED

|   | <u>Existing</u> | <u>Proposed</u>    |
|---|-----------------|--------------------|
| # OF CROSSWALKS IN PROJECT AREA:                    | 4               | 11                 |
| % PEDESTRIAN PHASE IN PORTER SQ. SIGNAL CYCLE:      | 18%             | 26%                |
| # OF LEGAL TURNS FROM SHOPPING CTR. TO MASS AVE SB: | 0               | Up to 150 per hour |
| # OF PARKING SPACES IN PROJECT AREA:                | 20              | 18                 |



# AGENDA

1. *PROJECT BACKGROUND AND DESIGN PROCESS*
2. *PROJECT GOALS*
3. *ADVISORY COMMITTEE PERSPECTIVE*
4. *REVIEW OF PLAN*
5. ***SMALL GROUP DISCUSSIONS***
6. *REPORTING BACK*
7. *NEXT STEPS*

# SMALL GROUP DISCUSSIONS





# AGENDA

1. *PROJECT BACKGROUND AND DESIGN PROCESS*
2. *PROJECT GOALS*
3. *ADVISORY COMMITTEE PERSPECTIVE*
4. *REVIEW OF PLAN*
5. *SMALL GROUP DISCUSSIONS*
- 6. *REPORTING BACK***
7. *NEXT STEPS*

# AGENDA

1. *PROJECT BACKGROUND AND DESIGN PROCESS*
2. *PROJECT GOALS*
3. *ADVISORY COMMITTEE PERSPECTIVE*
4. *REVIEW OF PLAN*
5. *SMALL GROUP DISCUSSIONS*
6. *REPORTING BACK*
7. ***NEXT STEPS***