

STREETSCAPE IMPROVEMENTS

VASSAL LANE

April 7, 2015

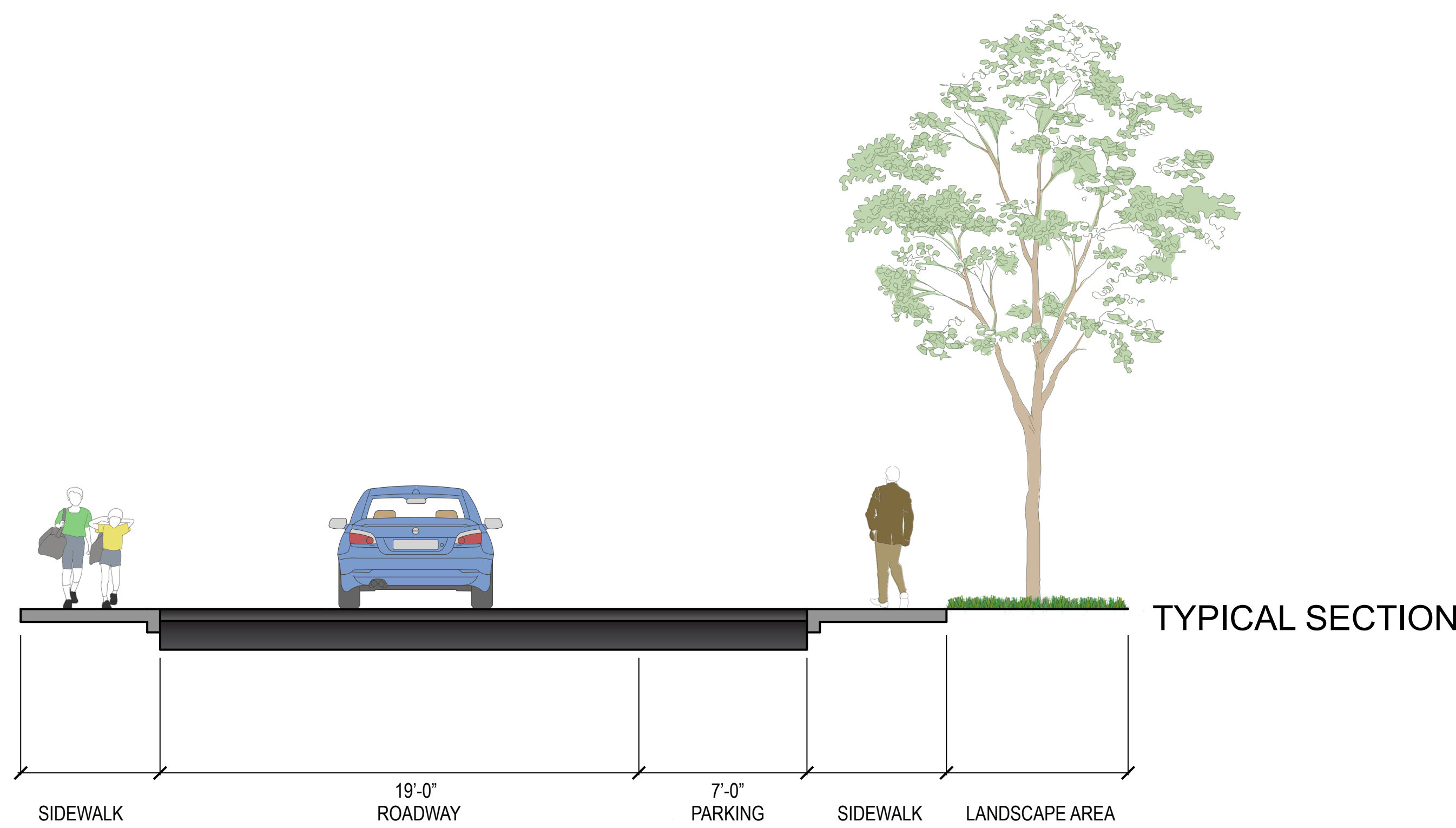

LEGEND

PROPOSED SIDEWALK

PROPOSED LAWN AREA

TRAFFIC LANE DIRECTION

AT-GRADE CROSSWALK

RAISED CROSSWALK

EXISTING TREE TO REMAIN (13)

REMOVE AND REPLACE (2)

PROPOSED TREE (6)

SCALE: 1" = 20'-0"



LOSS OF PARKING: 0

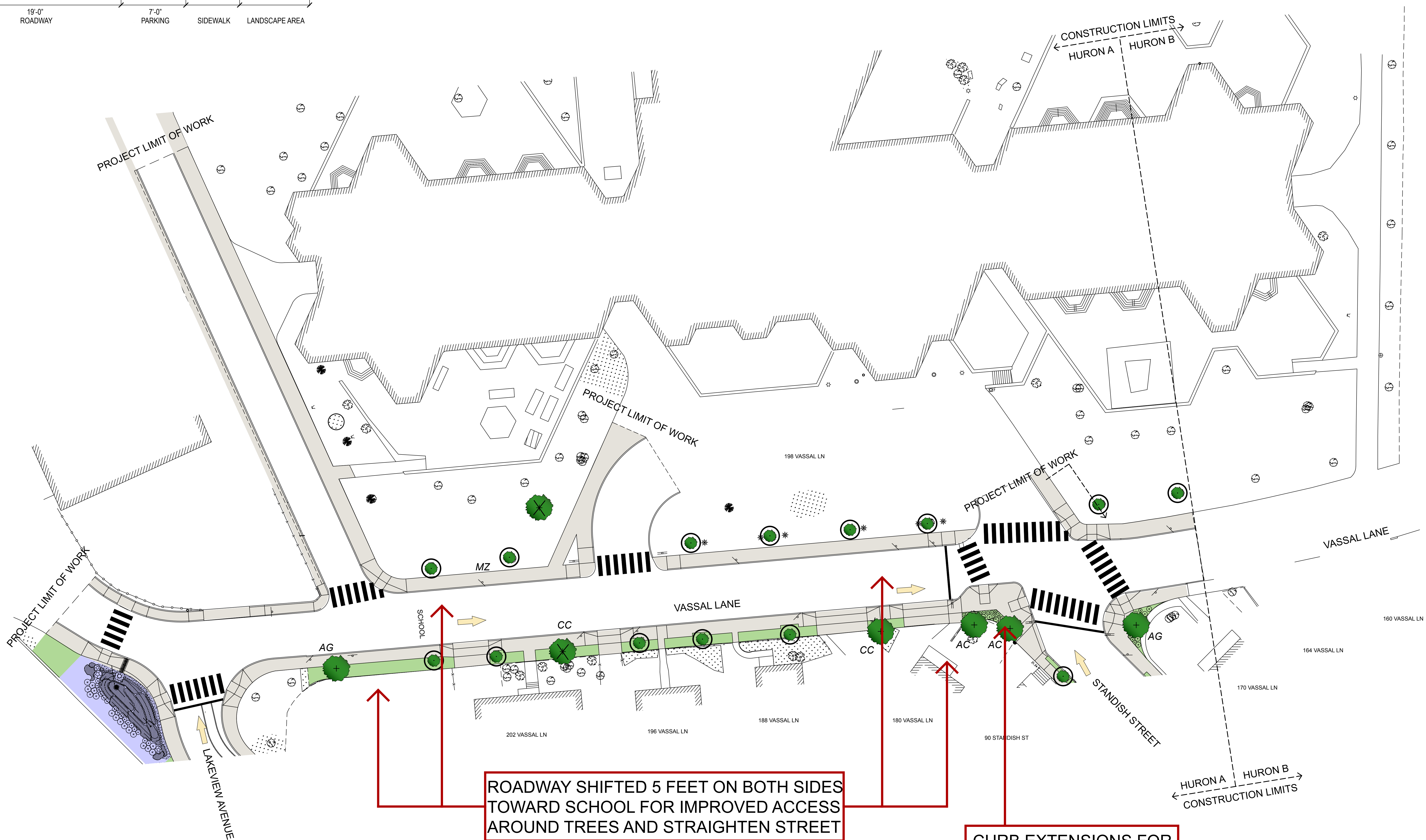

SYM.	SCIENTIFIC NAME	COMMON NAME	MINIMUM SIZE	MIN. ROOT BALL DIA.
AR1	<i>Acer rubrum</i>	Red Maple	3" cal.	32"
AR2	<i>Acer rubrum</i> 'Armstrong'	Armstrong Red Maple	3" cal.	32"
GB	<i>Ginkgo biloba</i>	Ginkgo	3" cal.	32"
GT	<i>Gleditsia triacanthos</i> var. <i>inermis</i>	Thornless Honeylocust	3" cal.	32"
GD	<i>Gymnocladus dioica</i>	Kentucky Coffeetree	3" cal.	32"
LS	<i>Liquidambar styraciflua</i>	Sweetgum	3" cal.	32"
LT	<i>Liriodendron tulipifera</i>	Tuliptree	3" cal.	32"
PA	<i>Platanus x acerifolia</i>	London Planetree	3" cal.	32"
QE	<i>Quercus rubra</i> 'Fastigiata'	Columnar English Oak	3" cal.	32"
QR	<i>Quercus rubra</i>	Red Oak	3" cal.	32"
TT	<i>Tilia tomentosa</i>	Silver Linden	3" cal.	32"
UA	<i>Ulmus americana</i> 'Princeton'	Princeton American Elm	3" cal.	32"

SYM.	SCIENTIFIC NAME	COMMON NAME	MINIMUM SIZE	MIN. ROOT BALL DIA.
AA	<i>Amelanchier arborea</i> 'Autumn Brilliance'	Downy Serviceberry	10' Ht.	32"
AC	<i>Acer campestre</i>	Hedge Maple	3" cal.	32"
AG	<i>Amelanchier grandifolia</i>	Apple Serviceberry	10' Ht.	32"
CC	<i>Cercis canadensis</i>	Eastern Redbud	3" cal.	24"
MZ	<i>Malus x zumi</i> var. 'calocarpa'	Redbud Crabapple	3" cal.	32"
PK	<i>Prunus serrulata</i> 'Kwanzan'	Kwanzan Cherry	3" cal.	32"
PS	<i>Prunus serrulata</i> 'Snowgoose'	Snowgoose Cherry	3" cal.	32"
PX	<i>Prunus x incam</i> 'Okame'	Okame Cherry	3" cal.	24"
PY	<i>Prunus x yedoensis</i> 'Akebono'	Akebono Cherry	3" cal.	24"
SR	<i>Syringa reticulata</i>	Japanese Tree Lilac	3" cal.	24"