

STREETSCAPE IMPROVEMENTS

LARCH ROAD (NORTH)

April 7, 2015

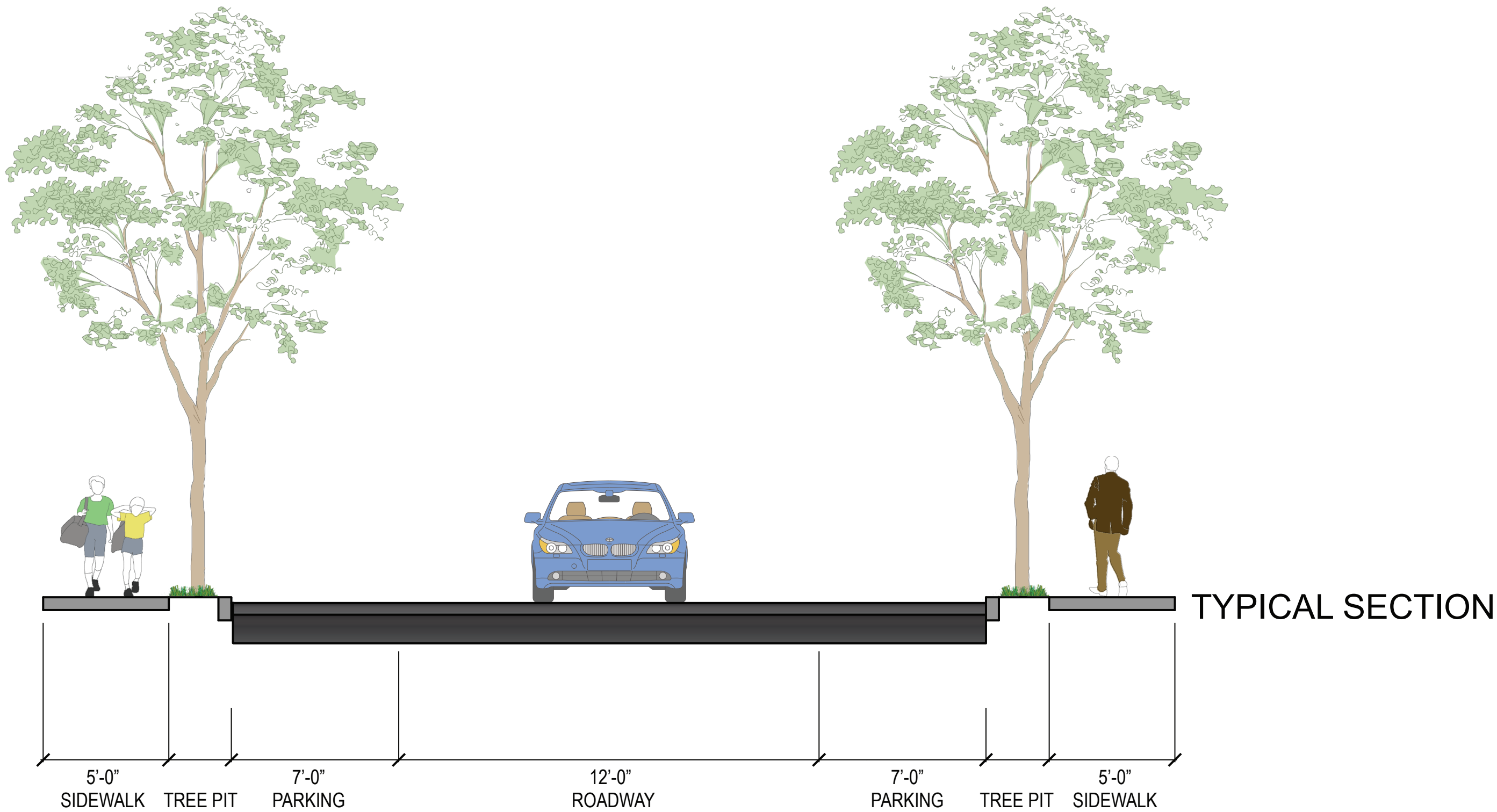

LEGEND

- PROPOSED SIDEWALK
- PROPOSED GRASS STRIP
- TRAFFIC LANE DIRECTION
- AT-GRADE CROSSWALK
- RAISED CROSSWALK

- EXISTING TREE TO REMAIN (8)
- REMOVE AND REPLACE (1)
- PROPOSED TREE (3)
- PROPOSED PLANTING

SCALE: 1" = 20'-0"

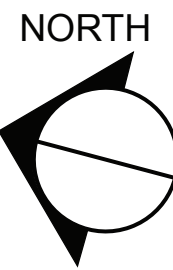

LOSS OF PARKING: 0

SYM.	SCIENTIFIC NAME	COMMON NAME	MINIMUM SIZE	MIN. ROOT BALL DIA.
AA	Amelanchier arborea 'Autumn Brilliance'	Downy Serviceberry	10' Ht.	32"
AC	Acer campestre	Hedge Maple	3" cal.	32"
AG	Amelanchier grandifolia	Apple Serviceberry	10' Ht.	32"
CC	Cercis canadensis	Eastern Redbud	3" cal.	24"
MZ	Malus x zumi var 'calocarpa'	Redbud Crabapple	3" cal.	32"
PK	Prunus serrulata 'Kwanzan'	Kwanzan Cherry	3" cal.	32"
PS	Prunus serrulata 'Snowgoose'	Snowgoose Cherry	3" cal.	32"
PX	Prunus x incam 'Okame'	Okame Cherry	3" cal.	24"
PY	Prunus x yedoensis 'Akebono'	Akebono Cherry	3" cal.	24"
SR	Syringa reticulata	Japanese Tree Lilac	3" cal.	24"

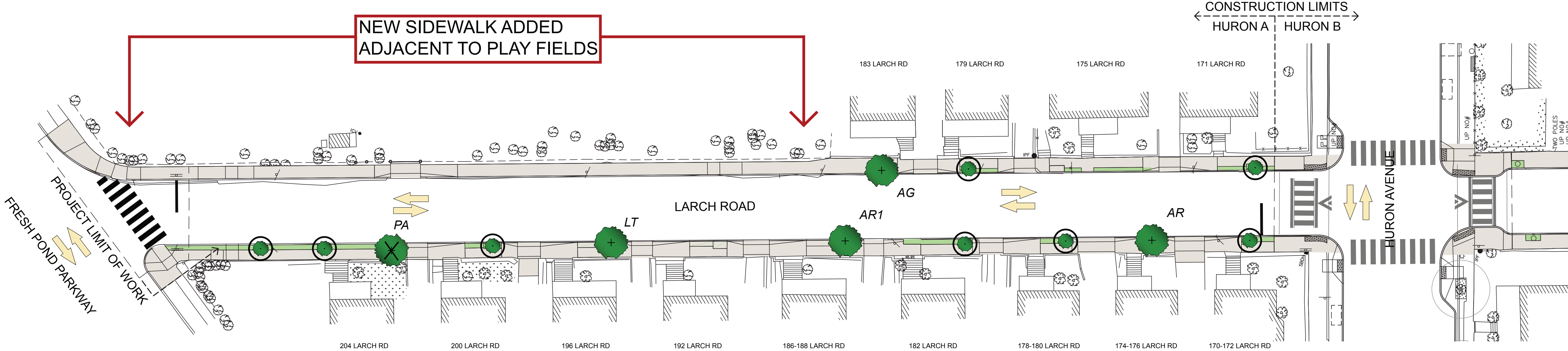

SYM.	SCIENTIFIC NAME	COMMON NAME	MINIMUM SIZE	MIN. ROOT BALL DIA.
AR1	Acer rubrum	Red Maple	3" cal.	32"
AR2	Acer rubrum 'Armstrong'	Armstrong Red Maple	3" cal.	32"
GB	Ginkgo biloba	Ginkgo	3" cal.	32"
GT	Gleditsia triacanthos var. inermis	Thornless Honeylocust	3" cal.	32"
GD	Gymnocladus dioicus	Kentucky Coffeetree	3" cal.	32"
LS	Liquidambar styraciflua	Sweetgum	3" cal.	32"
LT	Liriodendron tulipifera	Tuliptree	3" cal.	32"
PA	Platanus x acerifolia	London Planetree	3" cal.	32"
QE	Quercus rubur 'Fastigiata'	Columnar English Oak	3" cal.	32"
QR	Quercus rubra	Red Oak	3" cal.	32"
TT	Tilia tomentosa	Silver Linden	3" cal.	32"
UA	Ulmus americana 'Princeton'	Princeton American Elm	3" cal.	32"

NOTE
Larch Road (North only)- two way for local traffic only