

STREETSCAPE IMPROVEMENTS

VASSAL LANE

August 6, 2015

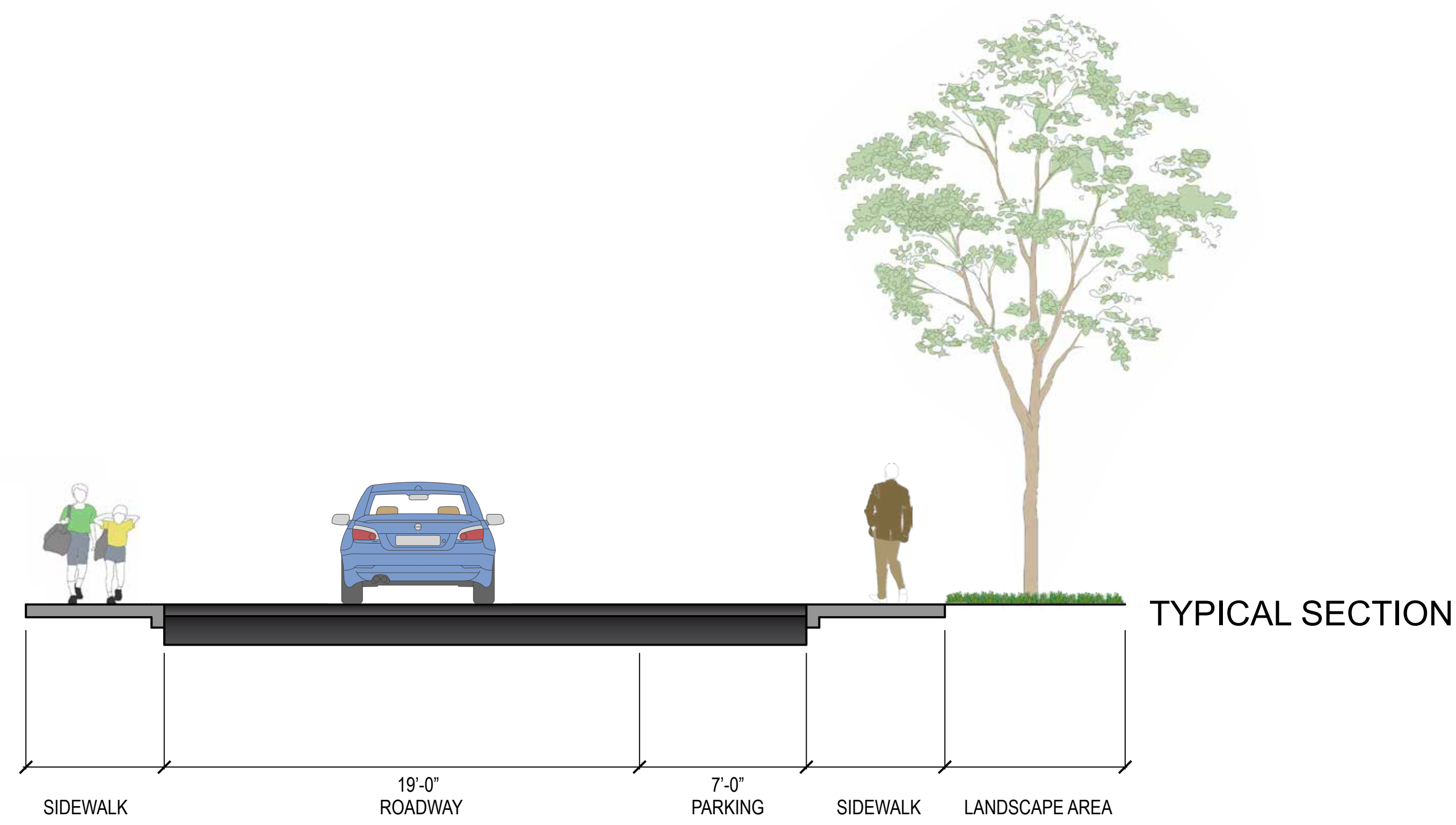

LEGEND

- PROPOSED SIDEWALK
- PROPOSED LAWN AREA
- TRAFFIC LANE DIRECTION
- AT-GRADE CROSSWALK
- RAISED CROSSWALK
- EXISTING TREE TO REMAIN (14)
- REMOVE AND REPLACE (2)
- PROPOSED TREE (5)

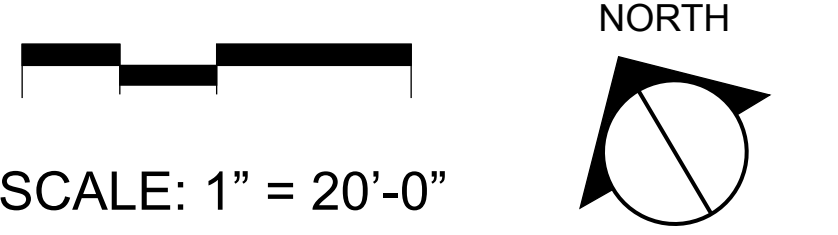

LOSS OF PARKING: 0

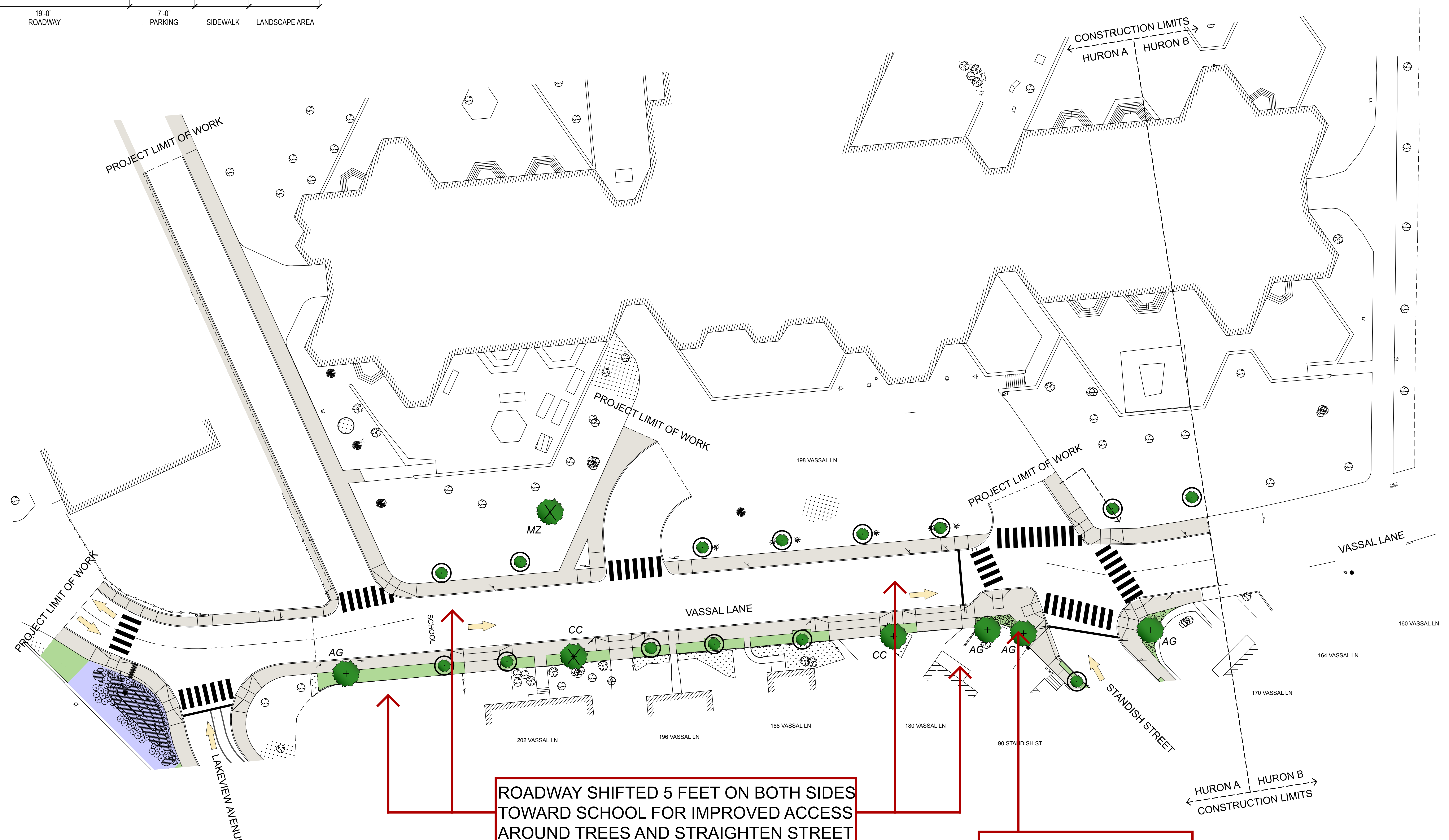

ROADWAY SHIFTED 5 FEET ON BOTH SIDES TOWARD SCHOOL FOR IMPROVED ACCESS AROUND TREES AND STRAIGHTEN STREET

CURB EXTENSIONS FOR PEDESTRIAN SAFETY

SYM.	SCIENTIFIC NAME	COMMON NAME	MINIMUM SIZE	MIN. ROOT BALL DIA.
AR1	<i>Acer rubrum</i>	Red Maple	3" cal.	32"
AR2	<i>Acer rubrum</i> 'Armstrong'	Armstrong Red Maple	3" cal.	32"
GB	<i>Ginkgo biloba</i>	Ginkgo	3" cal.	32"
GT	<i>Gleditsia triacanthos</i> var. <i>inermis</i>	Thornless Honeylocust	3" cal.	32"
GD	<i>Gymnocladus dioica</i>	Kentucky Coffeetree	3" cal.	32"
LS	<i>Liquidambar styraciflua</i>	Sweetgum	3" cal.	32"
LT	<i>Liriodendron tulipifera</i>	Tuliptree	3" cal.	32"
PA	<i>Platanus x acerifolia</i>	London Planetree	3" cal.	32"
OE	<i>Quercus rubra</i> 'Fastigiata'	Columnar English Oak	3" cal.	32"
QR	<i>Quercus rubra</i>	Red Oak	3" cal.	32"
TT	<i>Tilia tomentosa</i>	Silver Linden	3" cal.	32"
UA	<i>Ulmus americana</i> 'Princeton'	Princeton American Elm	3" cal.	32"

SYM.	SCIENTIFIC NAME	COMMON NAME	MINIMUM SIZE	MIN. ROOT BALL DIA.
AA	<i>Amelanchier arborea</i> 'Autumn Brilliance'	Downy Serviceberry	10' Ht.	32"
AC	<i>Acer campestre</i>	Hedge Maple	3" cal.	32"
AG	<i>Amelanchier grandifolia</i>	Apple Serviceberry	10' Ht.	32"
CC	<i>Cercis canadensis</i>	Eastern Redbud	3" cal.	24"
MZ	<i>Malus x zumi</i> var. 'calocarpa'	Redbud Crabapple	3" cal.	32"
PK	<i>Prunus serrulata</i> 'Kwanzan'	Kwanzan Cherry	3" cal.	32"
PS	<i>Prunus serrulata</i> 'Snowgoose'	Snowgoose Cherry	3" cal.	32"
PX	<i>Prunus x incam</i> 'Okame'	Okame Cherry	3" cal.	24"
PY	<i>Prunus x yedoensis</i> 'Akebono'	Akebono Cherry	3" cal.	24"
SR	<i>Syringa reticulata</i>	Japanese Tree Lilac	3" cal.	24"