

**MID-BLOCK RAISED CROSSWALK ISOMETRIC PLAN**

NTS

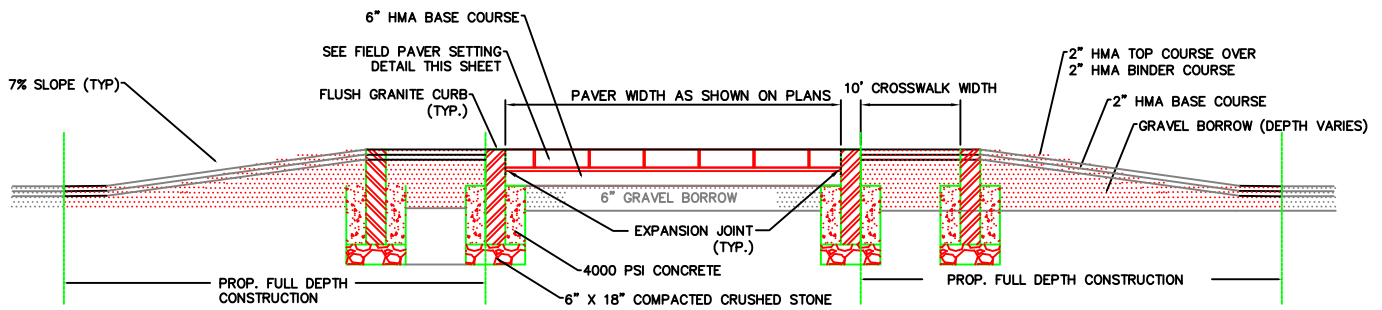

**SECTION A-A**

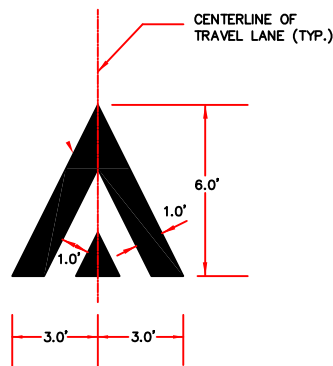

**RAMP MARKING DETAIL**

NTS

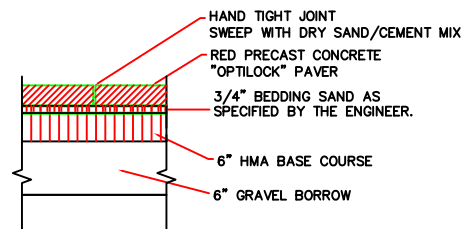

**"FIELD" PAVER SETTING DETAIL**

NTS



**RAISED INTERSECTION / RAISED CROSSWALK DETAIL**

**CITY OF CAMBRIDGE STANDARD SPECIFICATIONS AND DETAILS**

SCALE: NTS

DATE OF ISSUE: 5/2010

SPEC. SECTION REF#:

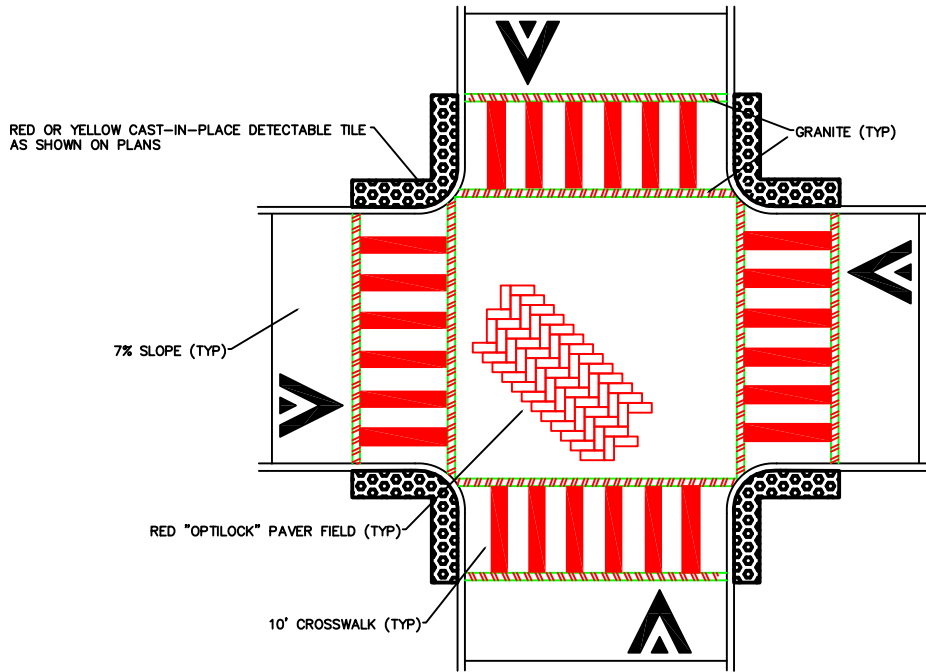

4-WAY RAISED INTERSECTION PLAN  
NTS

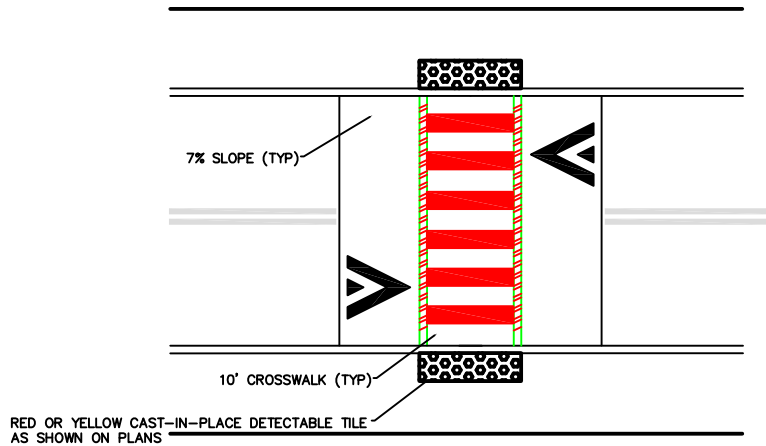

MID-BLOCK RAISED CROSSWALK DETAIL

CITY OF CAMBRIDGE STANDARD SPECIFICATIONS AND DETAILS

SCALE: NTS

DATE OF ISSUE: 5/2010

SPEC. SECTION REF#:

