

HARVARD SQUARE KIOSK AND PLAZA

Project Background

In conjunction with the Harvard Square Kiosk and Plaza Working Group process, the City of Cambridge has been developing design concepts for renovating the historic Harvard Square Kiosk. The project involves carefully restoring architectural details, adapting for future use, and redesigning the Plaza to improve accessibility and enhance the flexibility of the space.

Public Process

In 2017, the City established a Harvard Square Kiosk and Plaza Working Group to create a vision for the future use, operation, and governance of the Harvard Square Kiosk and Plaza.

The Working Group process has involved broad public input, including surveys, community meetings, pop-up workshops, and a Call for Ideas.

Based on this community feedback and regular meetings, the Working Group developed a set of recommendations for the future of this space in the heart of Harvard Square.

Summary of Vision and Recommendations for the Kiosk and Plaza

The Working Group envisions the Harvard Square Kiosk and Plaza to be flexible, dynamic, and welcoming community assets that enhance the everyday life of Harvard Square, act as platforms for community gatherings, including civic, artistic, and social activities, and attract and serve a broad range of people, including residents, students, visitors, etc.

The interior of the Kiosk would function as a flexible space accommodating permanent and temporary community uses:

- Permanent uses would feature a Visitor Information Center with displays focused on Cambridge history and happenings and the provision of news, brochures, and other materials.
- Temporary programming would occur inside the Kiosk and around the Plaza intermittently throughout the span of a typical week, which could include functions such as: small performances, historical exhibits, interactive installations, family oriented activities, voter registration, sampling of goods or services, and other entertaining, educational, festive, civic, and community-oriented activities.

More detail on the Working Group process and recommendations is featured in a report available at www.cambridgema.gov/harvardsquarekiosk.

Project Timeline

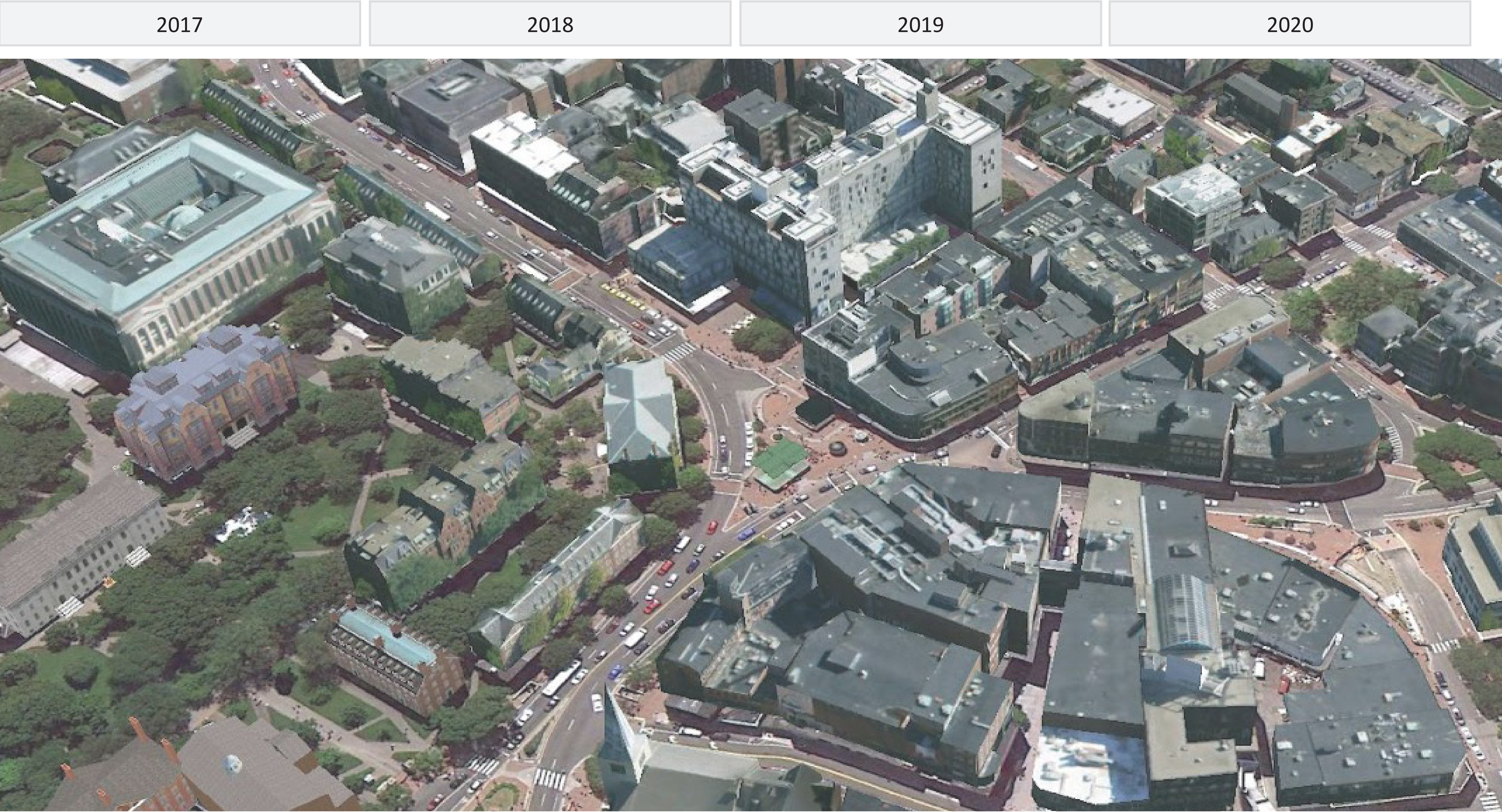
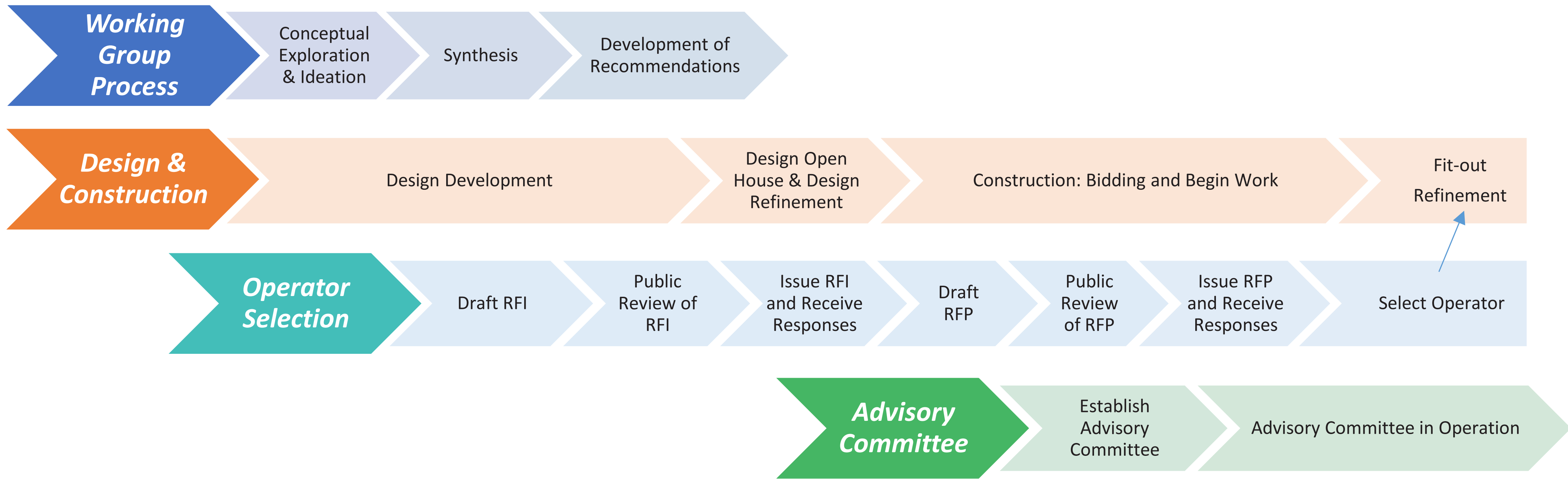

HARVARD SQUARE KIOSK AND PLAZA

Project Background

In conjunction with the Harvard Square Kiosk and Plaza Working Group process, the City of Cambridge has been developing design concepts for renovating the historic Harvard Square Kiosk. The project involves carefully restoring architectural details, adapting for future use, and redesigning the Plaza to improve accessibility and enhance the flexibility of the space.

Public Process

In 2017, the City established a Harvard Square Kiosk and Plaza Working Group to create a vision for the future use, operation, and governance of the Harvard Square Kiosk and Plaza.

The Working Group process has involved broad public input, including surveys, community meetings, pop-up workshops, and a Call for Ideas.

Based on this community feedback and regular meetings, the Working Group developed a set of recommendations for the future of this space in the heart of Harvard Square.

Summary of Vision and Recommendations for the Kiosk and Plaza

The Working Group envisions the Harvard Square Kiosk and Plaza to be flexible, dynamic, and welcoming community assets that enhance the everyday life of Harvard Square, act as platforms for community gatherings, including civic, artistic, and social activities, and attract and serve a broad range of people, including residents, students, visitors, etc.

The interior of the Kiosk would function as a flexible space accommodating permanent and temporary community uses:

- Permanent uses would feature a Visitor Information Center with displays focused on Cambridge history and happenings and the provision of news, brochures, and other materials.
- Temporary programming would occur inside the Kiosk and around the Plaza intermittently throughout the span of a typical week, which could include functions such as: small performances, historical exhibits, interactive installations, family oriented activities, voter registration, sampling of goods or services, and other entertaining, educational, festive, civic, and community-oriented activities.

More detail on the Working Group process and recommendations is featured in a report available at www.cambridgema.gov/harvardsquarekiosk.

Project Timeline

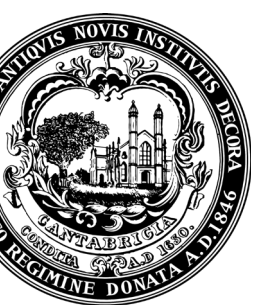
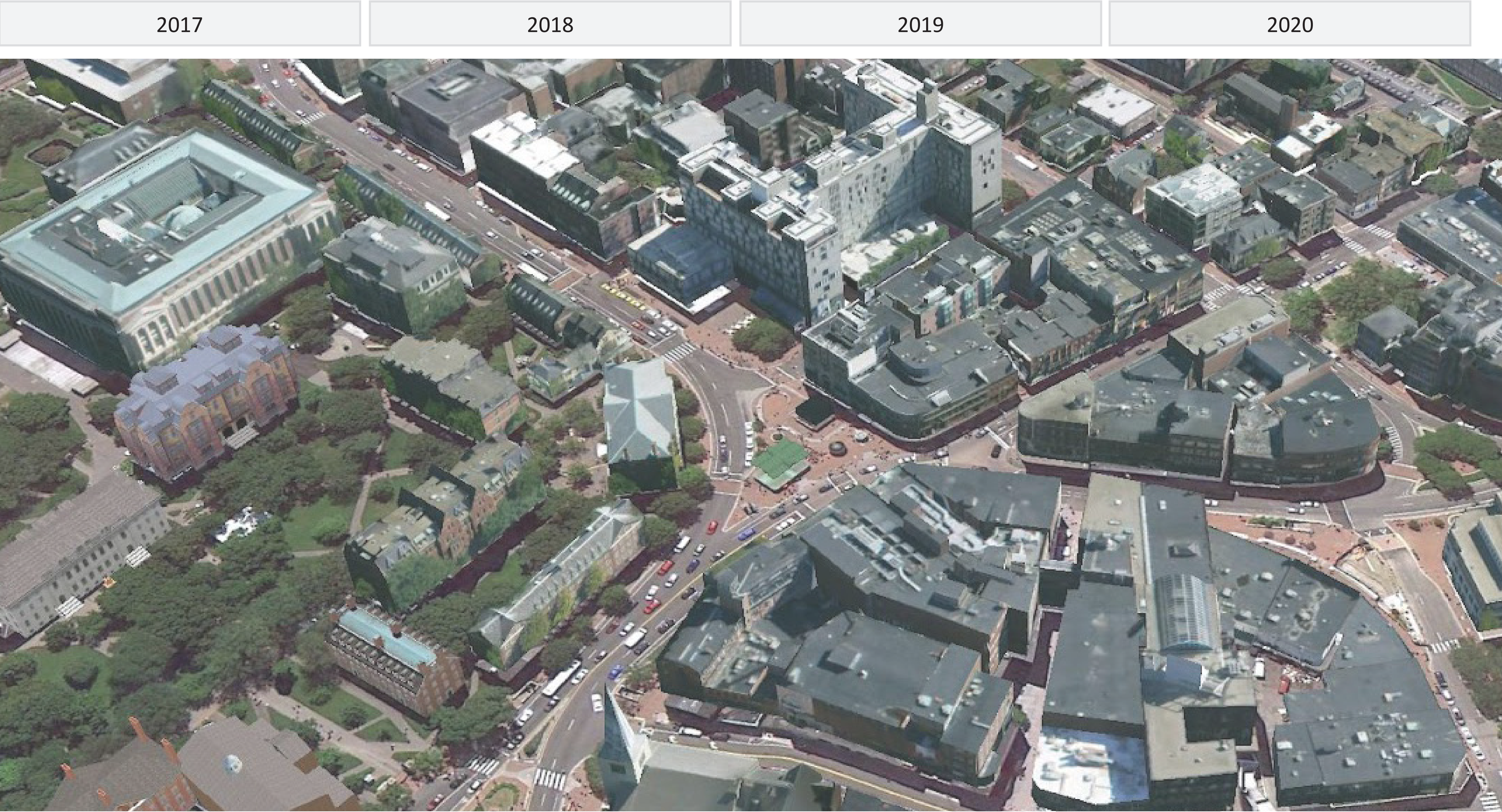
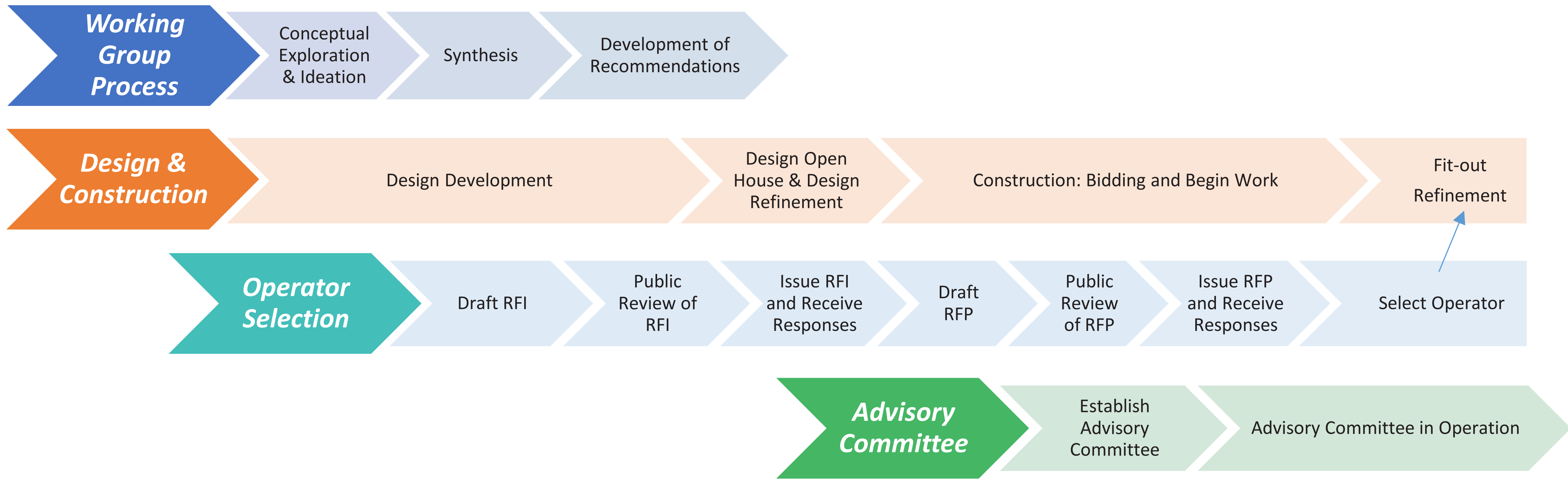

FEATURES AND ACCESSIBLE ROUTES

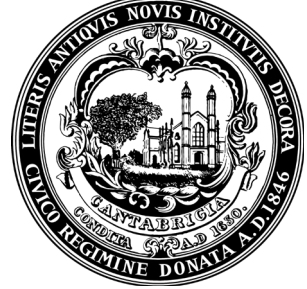
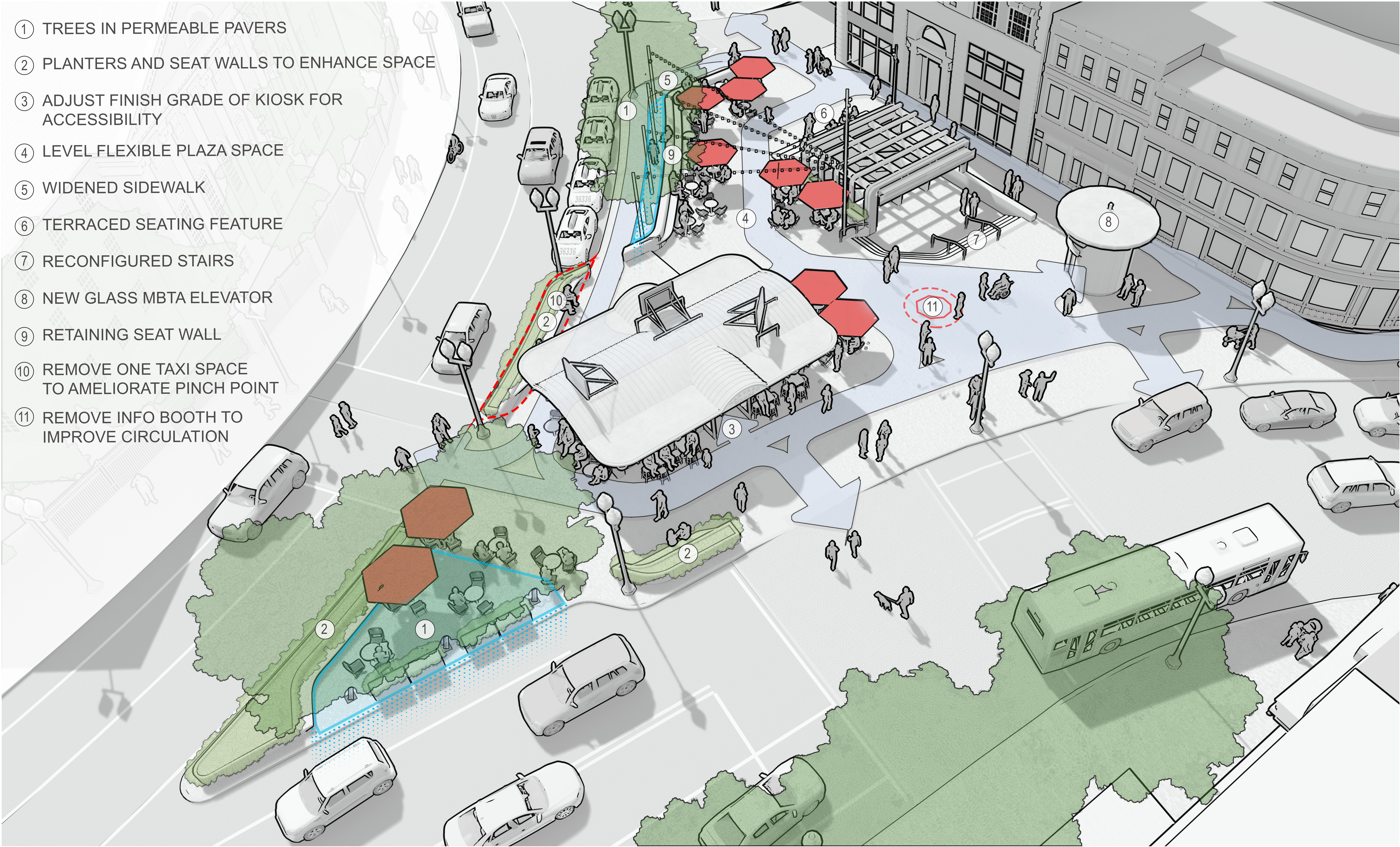

PERSPECTIVE VIEW FROM DUNSTER STREET - PLAZA AT NIGHT

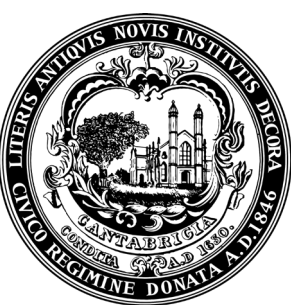

PERSPECTIVE VIEW OF NORTHERN PLAZA SPACE

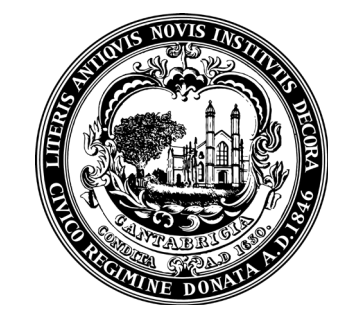

PERSPECTIVE VIEW FROM DUNSTER STREET - PLAZA

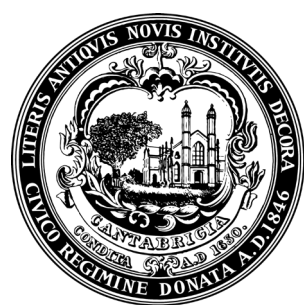

FURNITURE OPTIONS



HARVARD SQUARE EXISTING FURNITURE



FURNITURE PRECEDENT: HARVARD YARD



FURNITURE PRECEDENT: SMITH CENTER

Color palette and material options:

- Color Swatches:** A row of 15 colored circles (black, blue, yellow, red, green, dark blue, grey, white).
- Metallic:** A row of 5 metallic color swatches.
- Designer Partner Architectural Series:** A row of 5 color swatches.
- LANDSCAPE FORMS:** A grid of 15 material and color swatches.
- KETAL:** A row of 15 color swatches.
- COLOR OPTIONS:** A row of 15 color swatches.

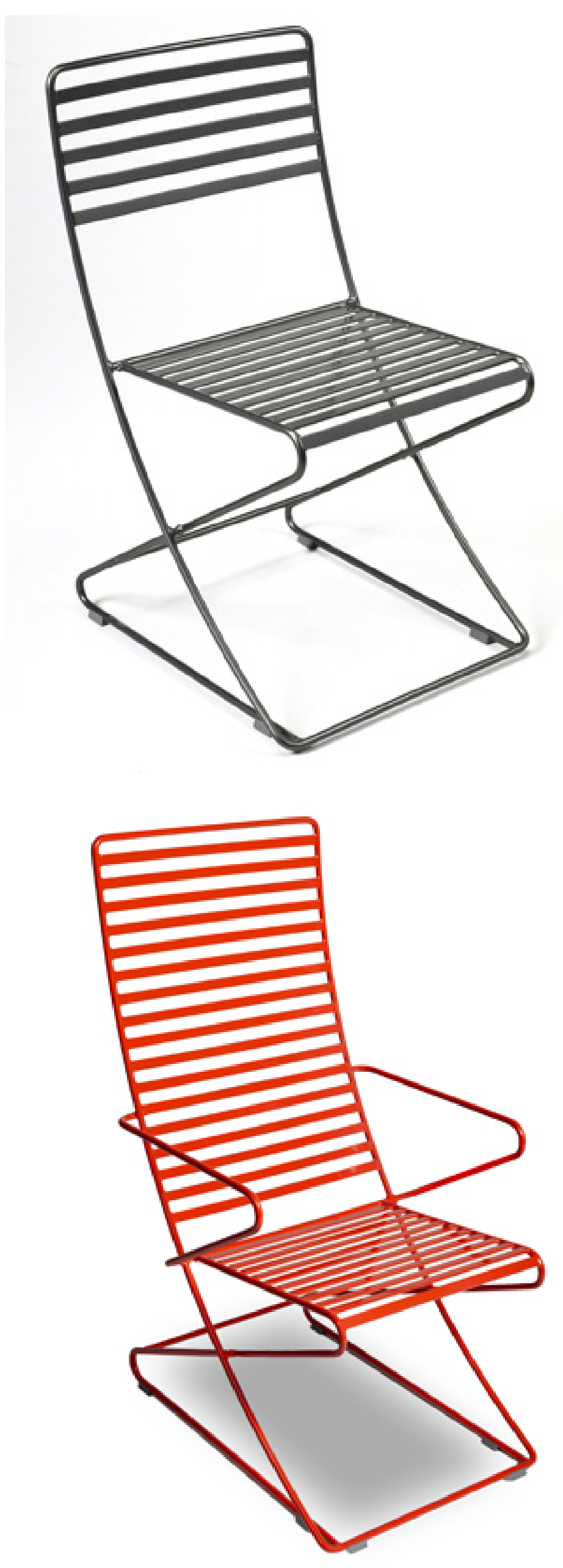

A. LANDSCAPE FORMS- PARC CENTRE (CURRENT FURNITURE)

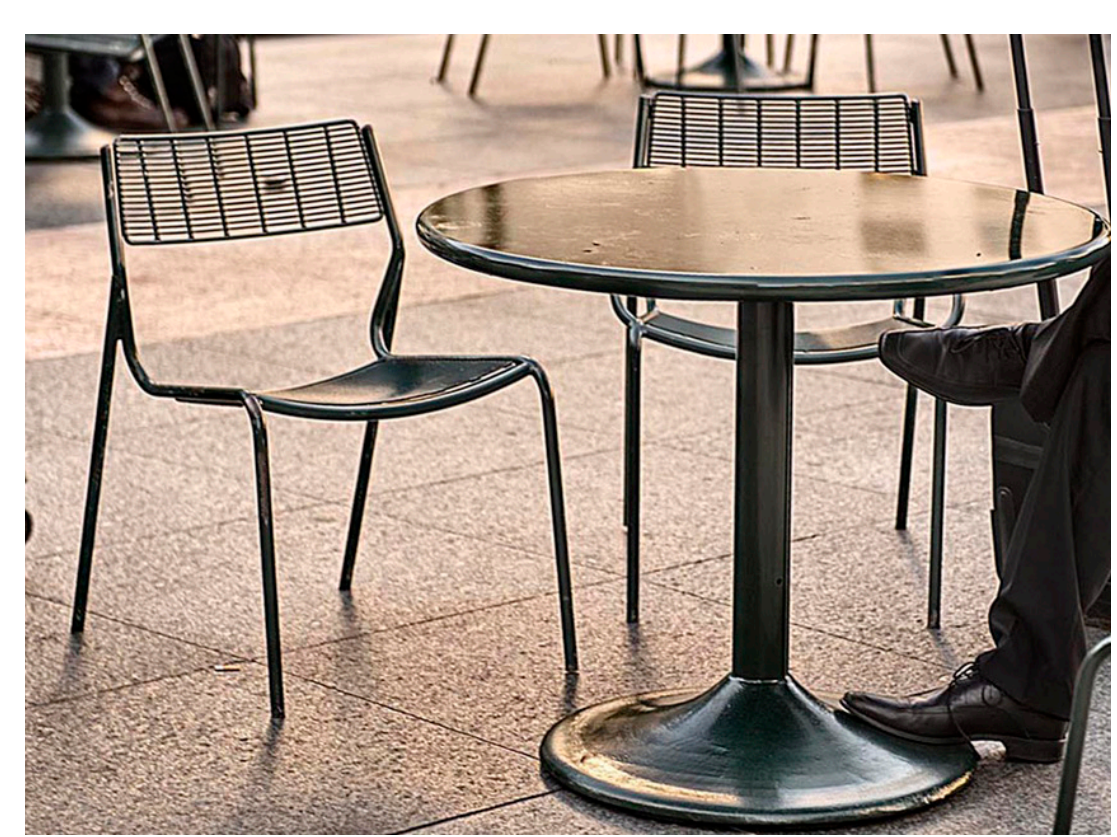

B. LANDSCAPE FORMS- VERONA

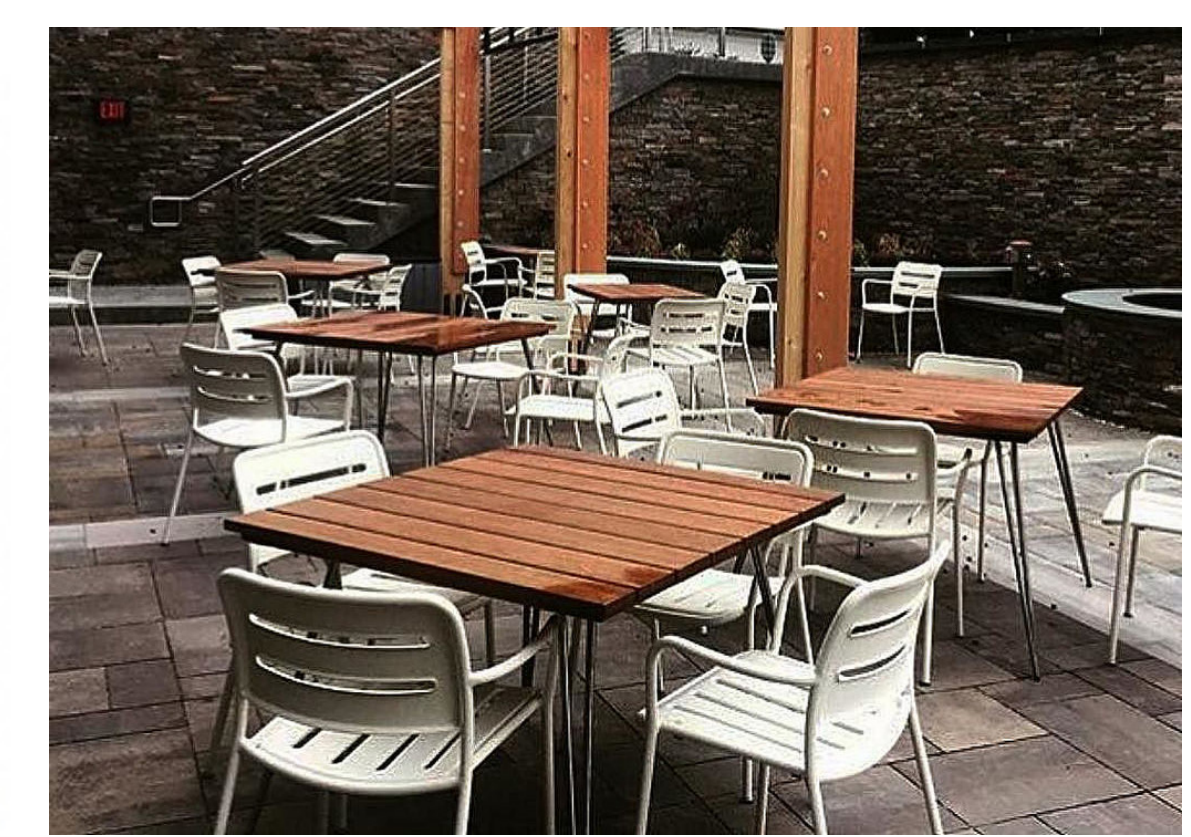

C. KETAL- VILLAGE

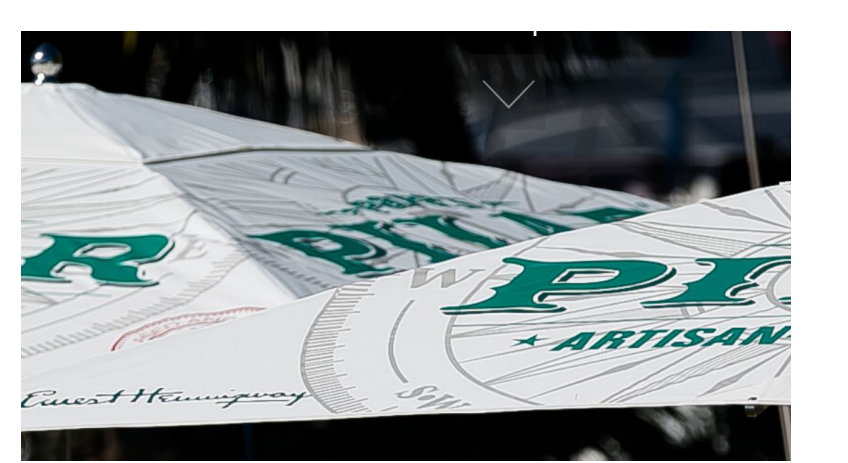

UMBRELLA VARIATIONS



KEY DESIGN CONSIDERATIONS

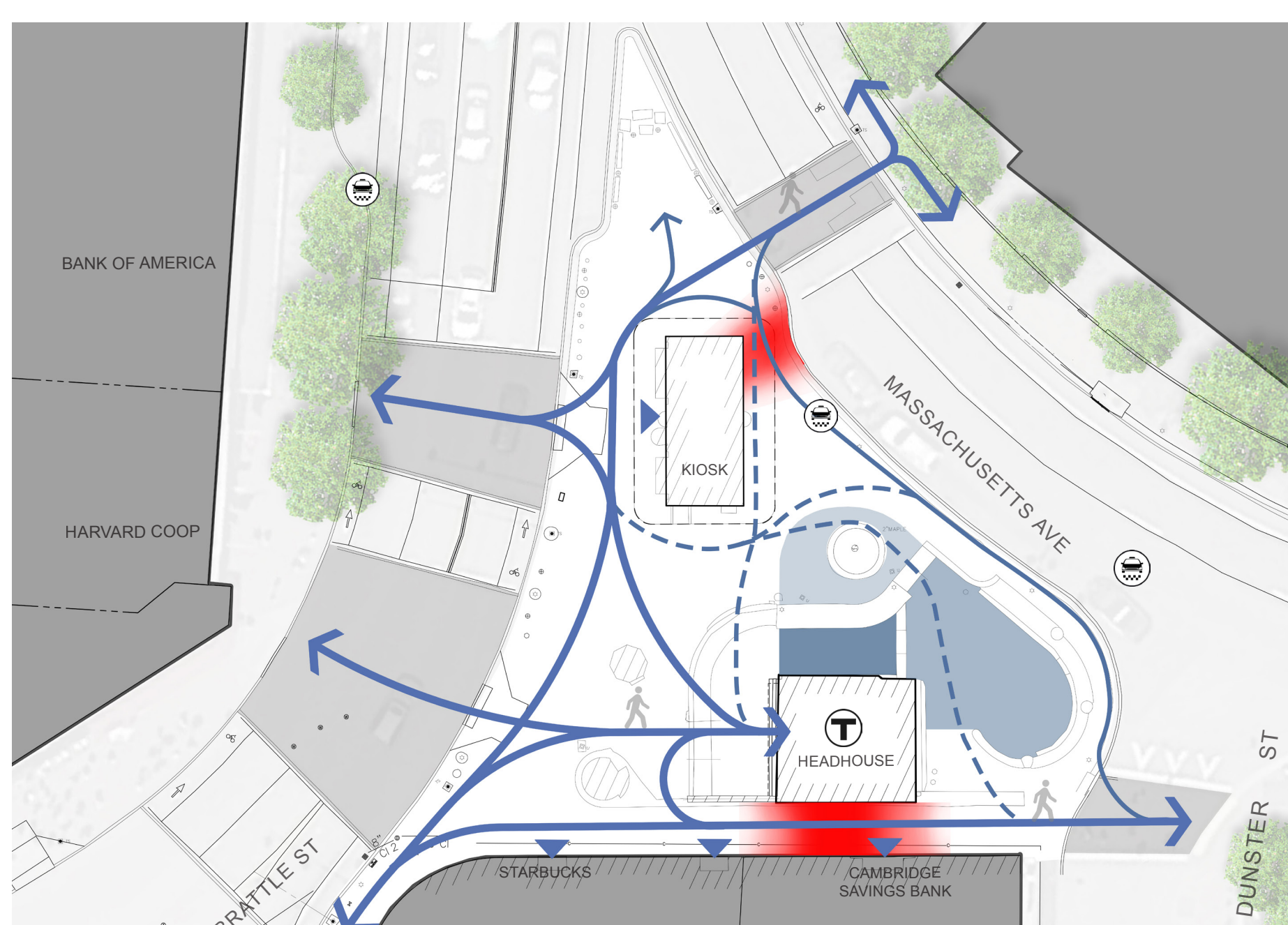

PEDESTRIAN CIRCULATION

- MAJOR
- MINOR
- OCCASIONAL
- PINCH POINT

EXISTING CIRCULATION

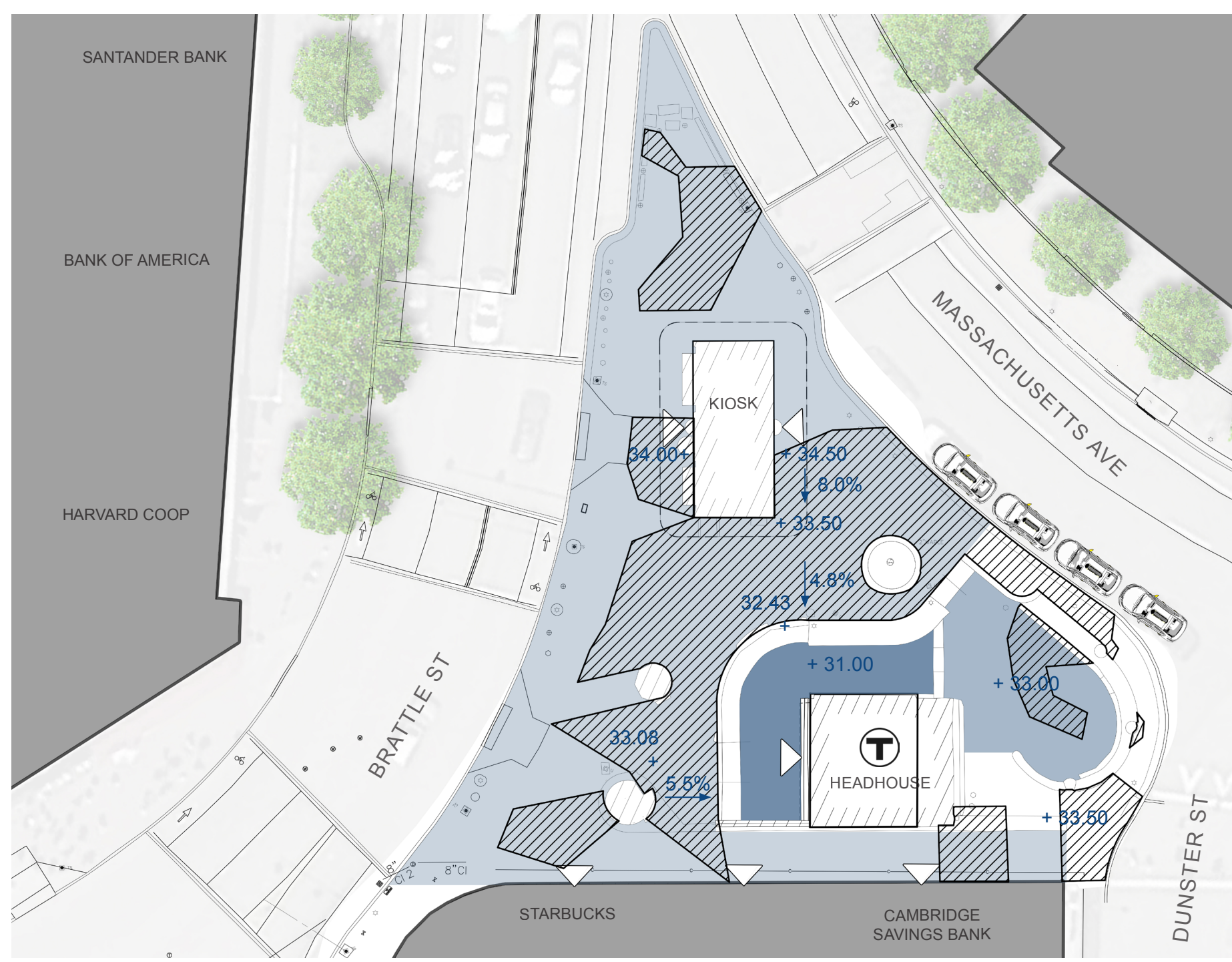

EXISTING ELEVATION

- UPPER
- INTERMEDIATE
- LOWER
- NON-COMPLIANT ADA ACCESSIBILITY
- > 2% PLAZA SLOPES
- > 2% CROSS SLOPES
- > 5% RUNNING SLOPES

EXISTING NON-COMPLIANT SLOPES

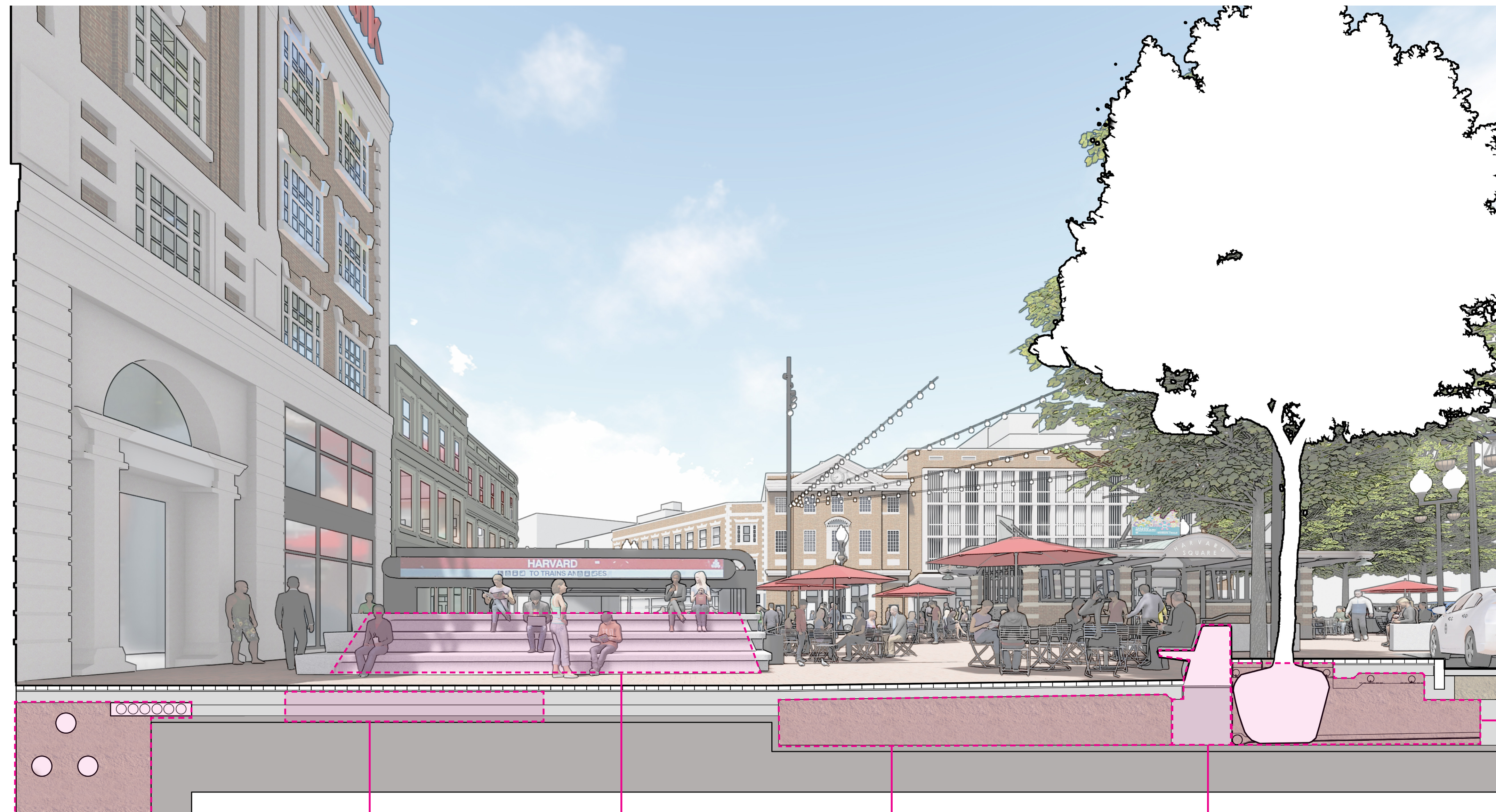

UTILITY CORRIDOR MINIMAL CLEARANCE OVER TUNNEL ROOF MBTA STATION SLOPED ROOF TO REMAIN INADEQUATE SOIL DEPTH FOR TREE PLANTING RETAINING WALL REQUIRED TO NEGOTIATE TRANSITION FROM MASS AVE. TO PLAZA WATERPROOFED TREEWAY ON TUNNEL ROOF

PROJECT CONSTRAINTS

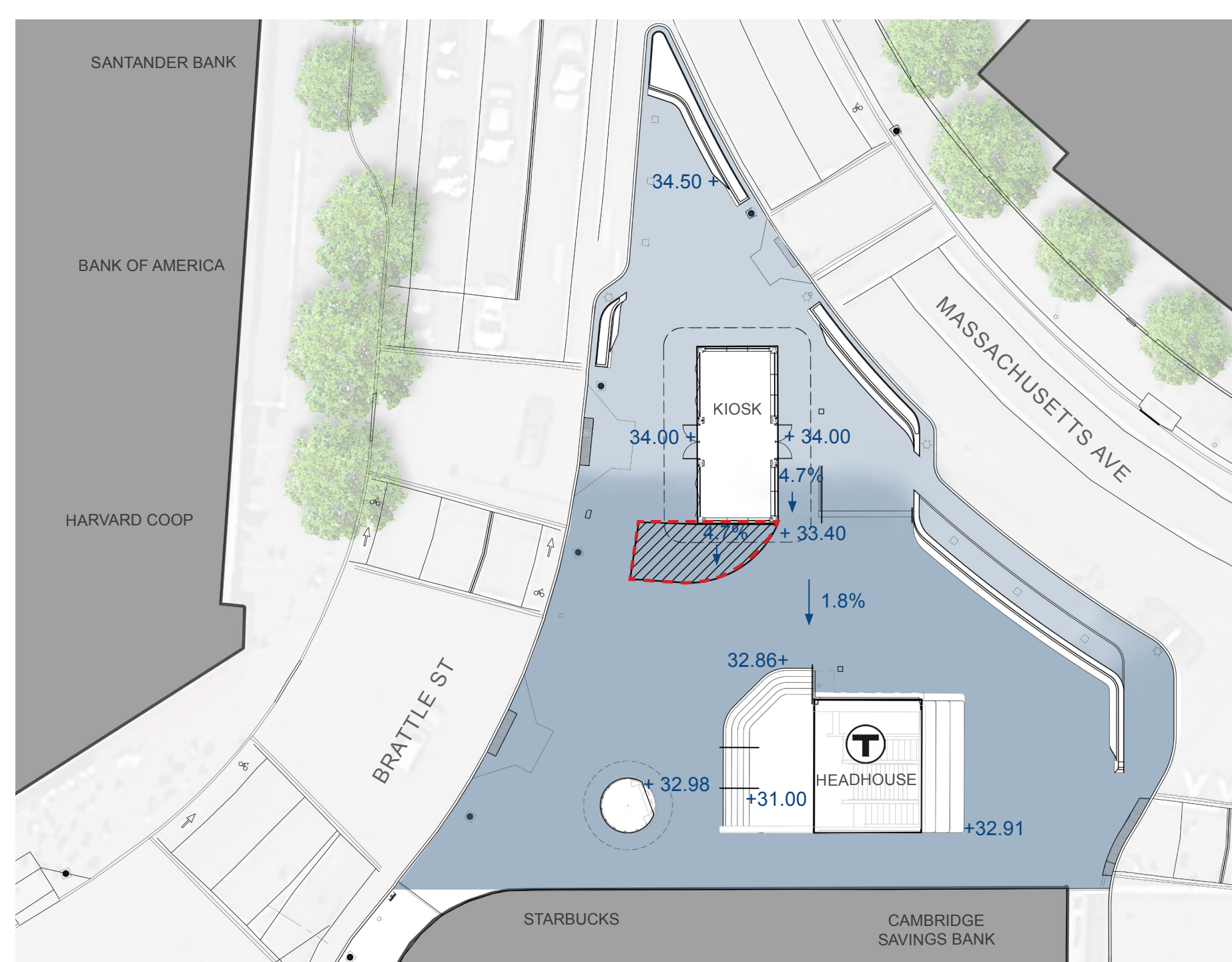

PROPOSED ELEVATION

- UPPER
- INTERMEDIATE
- LOWER
- NON-COMPLIANT ADA ACCESSIBILITY
- > 2% PLAZA SLOPES
- > 2% CROSS SLOPES
- > 5% RUNNING SLOPES
- AREA REQUIRING VARIANCE

PROPOSED ACCESSIBILITY DIAGRAM



CURB LINE MODIFICATIONS

- EXPANDED PLAZA AREA

CURB LINE MODIFICATIONS TO AMELIORATE PINCH POINT

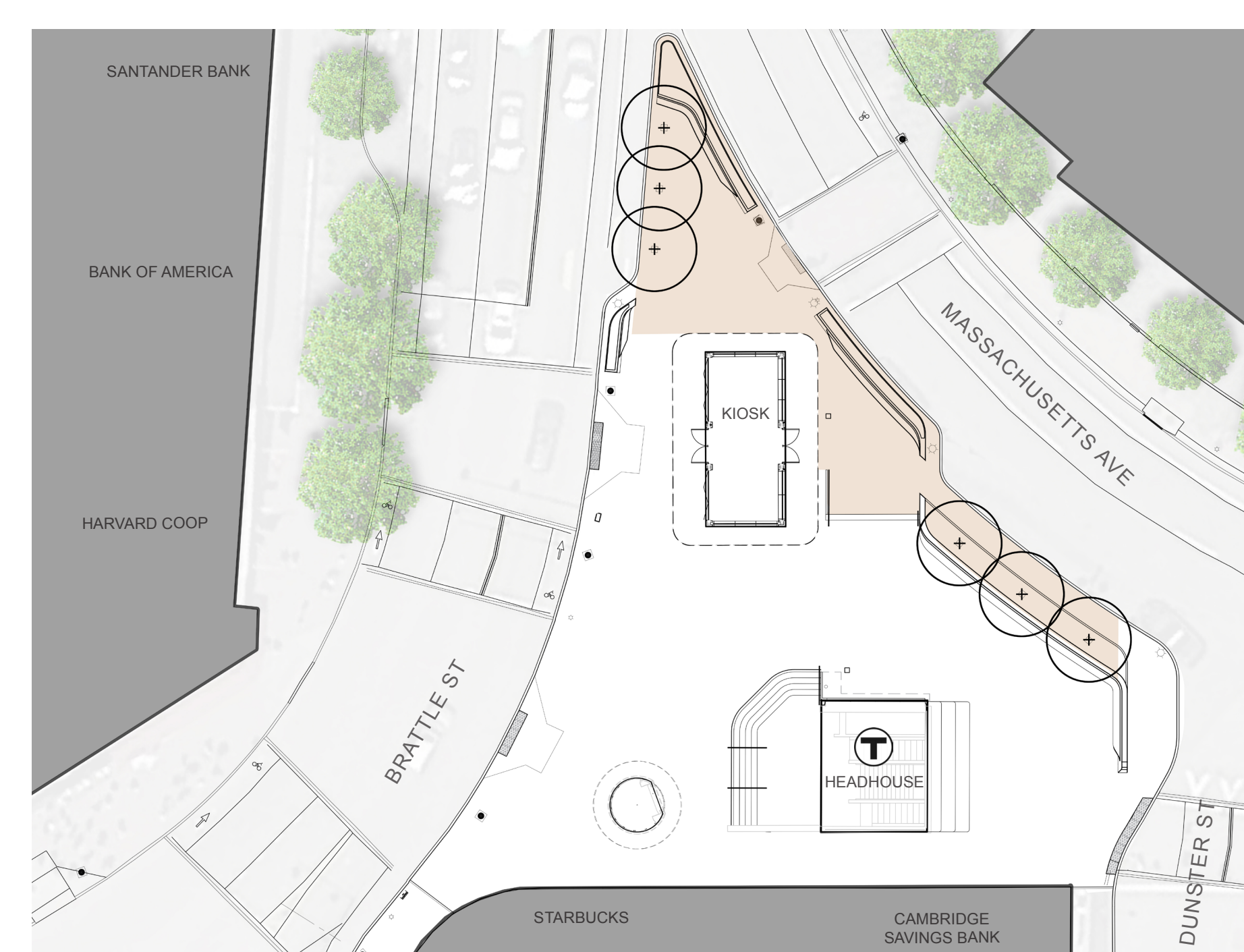

TREE PLANTING AREAS

ADEQUATE SOIL DEPTH FOR TREE PLANTING



PROPOSED SITE PLAN



- TREES IN PERMEABLE PAVERS
- TABLES AND CHAIRS
- WIRECUT BRICK PAVING- HARVARD SQUARE STANDARD
- PLANTERS TO BUFFER THE PLAZA
- REMOVE ONE TAXI SPACE TO AMELIORATE PINCH POINT
- LOWER FINISH GRADE OF KIOSK FOR ACCESSIBILITY
- TREES IN PERMEABLE PAVERS
- CATENARY LIGHTS
- RETAINING SEAT WALL
- TABLES AND CHAIRS
- LEVEL FLEXIBLE PLAZA SPACE
- WIDENED SIDEWALK
- TERRACED SEATING FEATURE
- RECONFIGURED STAIRS
- NEW GLASS MBTA ELEVATOR

