



**CITY OF
CAMBRIDGE**

Department of
Transportation

Welcome to the March 2026 Transit Advisory Committee Meeting

March 5, 2026 | 6 p.m. - 7:30 p.m.

02. Presentation: Charles River Crossings and Alewife Station Access Road Subcommittee Update

Charles River Crossings and Alewife Station Access Road

TAC Subcommittee Update | March 5, 2026

Charles River Crossings

Charles River Crossings - Project Overview

- Bridges are major sources of bus delay
- We can advocate for bus priority on bridges and nearby roads
- Need to work with DCR, MassDOT, and Cambridge for different roads

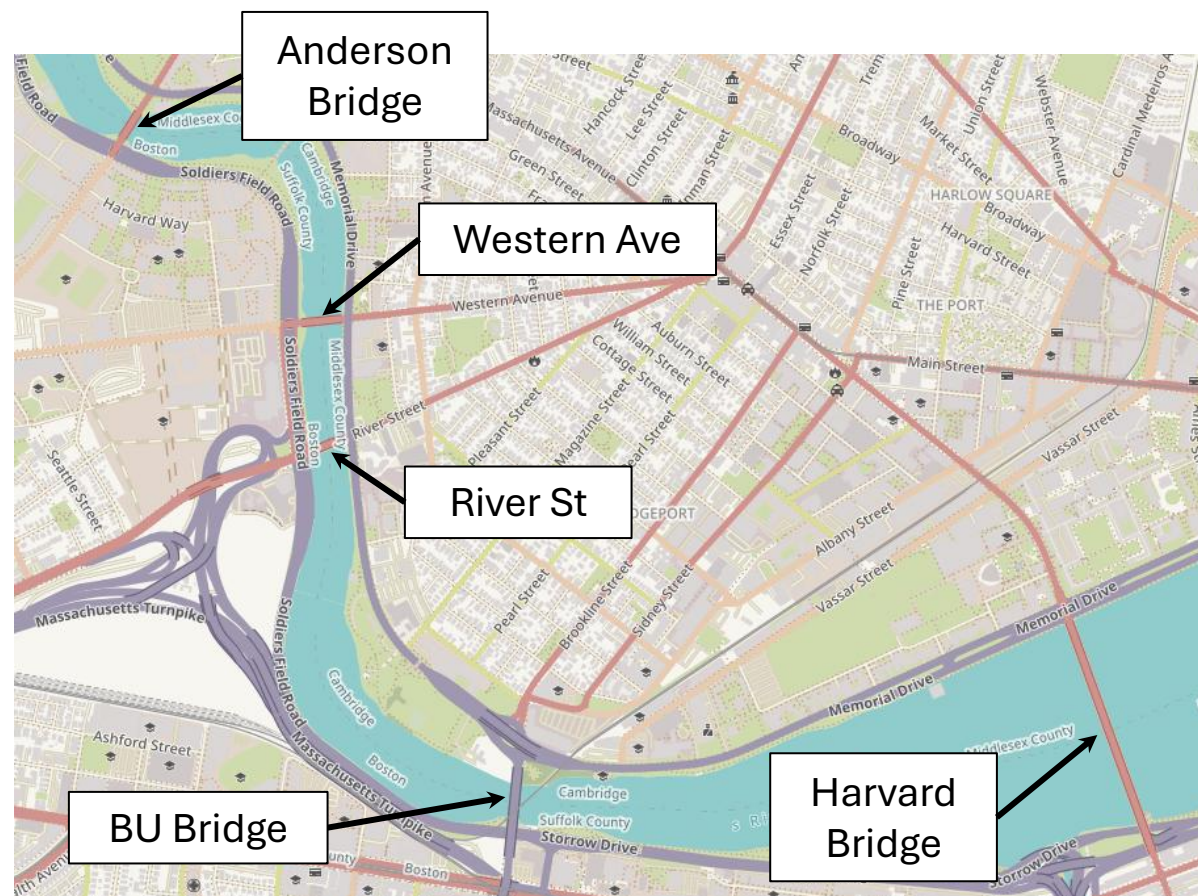

Image: OpenStreetMap

Cambridge River Crossings - Sites of Interest

Anderson Bridge

Route	Time of Day	Bus Service Composite Grade
66	AM Peak	Inbound: F Outbound: E
66	PM Peak	Inbound: F Outbound: E
86	AM Peak	Inbound: F Outbound: E
86	PM Peak	Inbound: F Outbound: E

Grades given by Cambridge Bus Delay and Unreliability Study, 2018

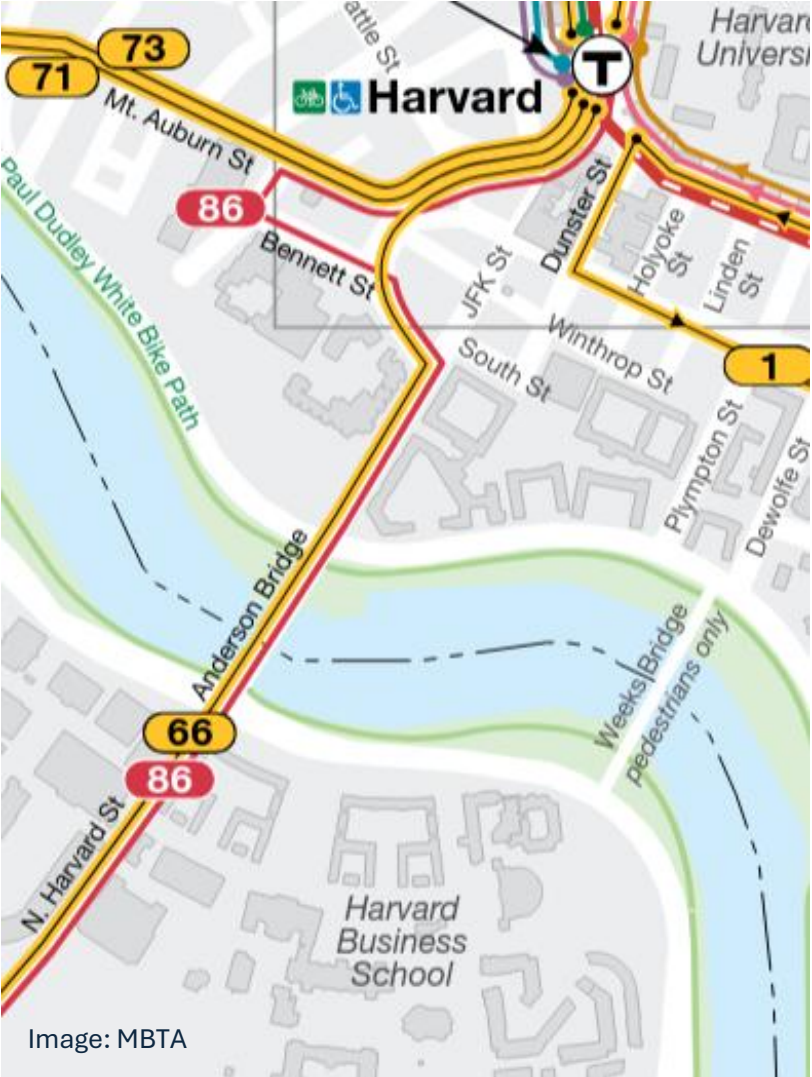

Cambridge River Crossings - Sites of Interest

Western Ave and River St Bridges

Route	Time of Day	Bus Service Composite Grade
64	AM Peak	Inbound (River St): F Outbound (Western Ave): C
64	PM Peak	Inbound (River St): F Outbound (Western Ave): C
70	AM Peak	Inbound (River St): F Outbound (Western Ave): E
70	PM Peak	Inbound (River St): E Outbound (Western Ave): E

Grades given by Cambridge Bus Delay and Unreliability Study, 2018



Image: MBTA

Cambridge River Crossings - Sites of Interest

BU Bridge

Route	Time of Day	Bus Service Composite Grade
47	AM Peak	Inbound: E Outbound: D
47	PM Peak	Inbound: F Outbound: E
CT2	AM Peak	Inbound: E Outbound: C
CT2	PM Peak	Inbound: F Outbound: C



Grades given by Cambridge Bus Delay and Unreliability Study, 2018

Image: MBTA

Cambridge River Crossings - Sites of Interest

Harvard Bridge

Route	Time of Day	Bus Service Composite Grade
1	AM Peak	Inbound: D Outbound: E
1	PM Peak	Inbound: F Outbound: D



Grades given by Cambridge Bus Delay and Unreliability Study, 2018

Cambridge River Crossings - Sources of Support

- MBTA Bus Priority Vision
 - Anderson and Western Ave bridges need new bus priority
 - River St bridge marked as in progress
 - BU Bridge not marked for priority
 - Harvard Bridge marked with existing priority
- Envision Cambridge
 - Collaborate with MBTA, MassDOT, surrounding communities to support bus priority initiatives

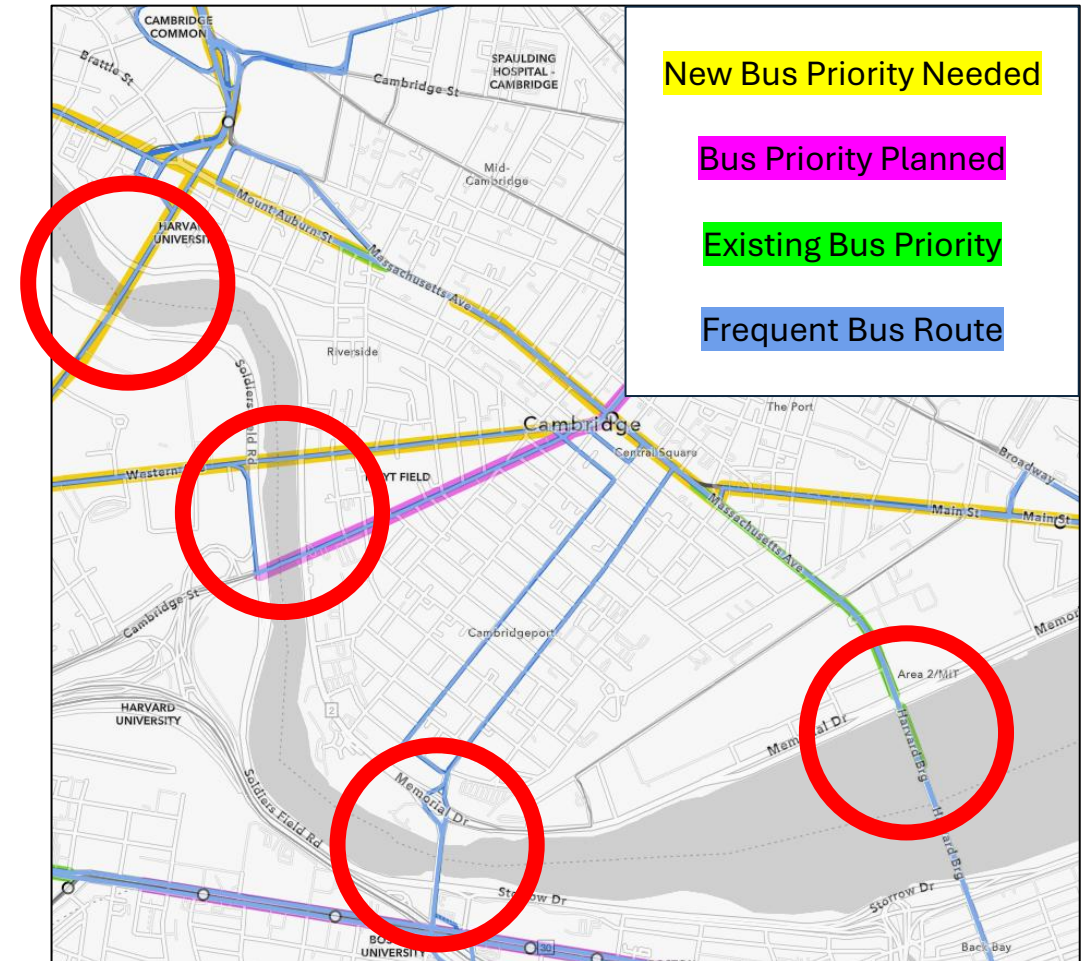

Alewife Station Access Road

Alewife Station Access Road - Project Overview

- I.Q.H.Q. found it feasible to add a bus lane and signal priority to the Alewife Station Access Road
- We can advocate for the implementation of bus priority treatments
- Need to work with MBTA, MassDOT, DCR



Alewife Station Access Road - Impact

- Road used by outbound routes 62, 67, 76, and 350
- 61 trips per weekday with Bus Network Redesign changes
- Average car queues expected to match bus lane length

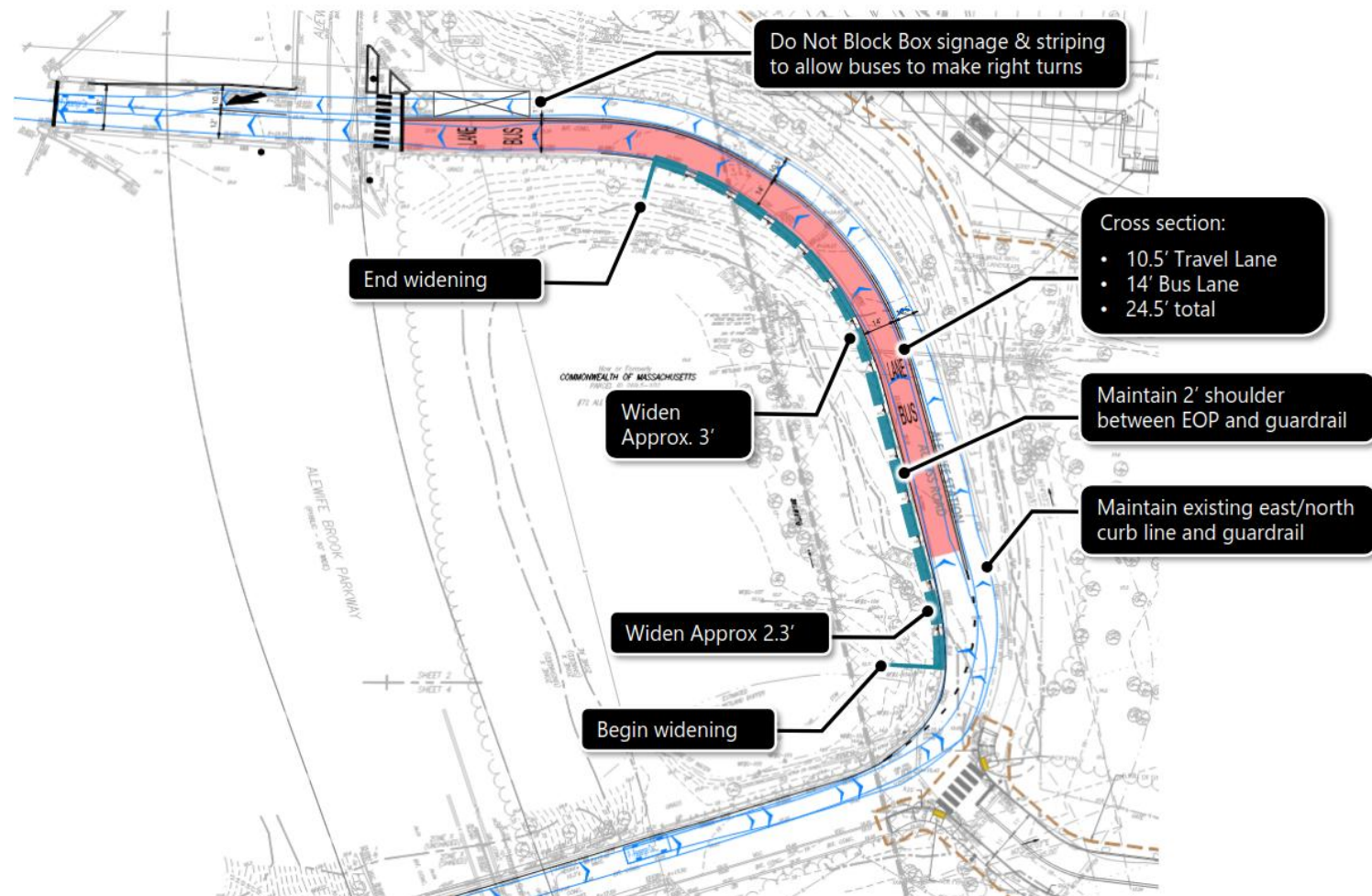

Next Steps

- Subcommittee will draft letters to state agencies this month
- Full committee can review & revise letters during April TAC meeting
- Subcommittee will incorporate revisions and send letters