

Master Plan Special Permit PB 198

Minor Amendment to the Master Plan and Design Review of Building 400, Building 500 and Garage B

Volume II - Renderings

July 30, 2014



July 30, 2014

Owner

BHX, LLC
Trustee of
ACORN PARK HOLDINGS
REALTY TRUST,
c/o Robert A. Schlager, CPM
ras@bulfinch.com
250 First Avenue, Suite 200
Needham, MA 02494-2805
T: (781) 707-4000, x122
F: (781) 707 4001

Developer

The Bulfinch Companies, Inc.
250 First Avenue, Suite 200
Needham, Ma 02494-2805
T: (781) 707 4000
F: (781) 707 4001
www.bulfinch.com
Robert A. Schlager, CPM
ras@bulfinch.com
Mark R. DiOrio, Esq.
mrd@bulfinch.com

Survey Engineer

BSC Group
15 Elkins Street
Boston, MA 02127
T: (617) 896-4300
F: (617) 896-4301
Dave Varga, P.E. - Utilities Engineer
DVarga@bscgroup.com
Dave Biancavilla, P.E. LEED AP,
Project Principal
DBiancavilla@bscgroup.com

Transportation Engineer

Vanasse & Associates, Inc.
Giles Ham, P.E.
gham@rdva.com
Scott Thornton, P.E.
sthornton@rdva.com
10 New England Buisness Center Dr.
Suite 314
Andover, MA 01810-1066
T: (978) 474-8800
F: (978) 688 6508

Legal Counsel

Dain, Torpy, Le Ray, Wiest & Garner, PC
Charles N Le Ray, Attorney & LEED AP
745 Atlantic Avenue, 5th Floor
Boston, MA 02111
T: (617) 542-4880
F: (617) 542 4808
cleray@daintorphy.com

Architect

ADD Inc
311 Summer Street
Boston, MA 02210
T: (617) 234-3100
F: (617) 661-7118
Larry Grossman, AIA
lgrossman@addinc.com

Structural Engineer

Simpson Gumpertz & Heger, Inc
41 Seyon Street
building #1, Suite 500
Waltham, MA 02453
T: (781) 907 9000
F: (781) 907 9009
Pedro Sifre, Project Engineer, x377
pjsifre@sggh.com

Geotechnical Engineer

McPhail Associates
30 Norfolk Street
Cambridge, MA 02319
T: (617) 868-1420
F: (617) 868-1423
www.mcphailgeo.com

Code Consultant

Remmer Consulting
Norton Remmer, P.E.
18 John Street Place
Worcester, MA 01609
T: (508) 756-2777
F: (508) 756-3840
C: (617) 719-7300
remmer.consulting@verizon.net

MEP / FP Engineer

AHA Consulting Engineers
10 Maguire Road, Suite 121
Lexington, MA 02421
T: (781) 372-3000
F: (781) 372-3100
Martin Holloran
Marty_Holloran@aha-engineers.com

Civil Coordinator

Paul Finger Associates
Paul Finger, RLA
281 Winter Street
Waltham, MA 02451-8740
T: (617) 647-4900
F: (781) 647-1423
C: (508) 954-6302
pfinger@pfai.net

Noise Consultant

Acentech
33 Moulton Street
Cambridge, MA 02139
T: (617) 499-8000
F: (617) 499-8074
www.acentech.com

Wetlands Scientist

Ingebor E. Hegemann, PWS
Senior Vice President
BSC Group
33 Waldo Street
Worcester, MA 01608
T: (508) 792-4500
F: (508) 792-4509
ihegemann@bscgroup.com

July 30, 2014



Building 100

Building 200/300



Garage A

Bowling Alley

July 30, 2014



Conditions of Site: 2014 Aerial Image



July 30, 2014





Elevation along Acorn Park Drive

July 30, 2014



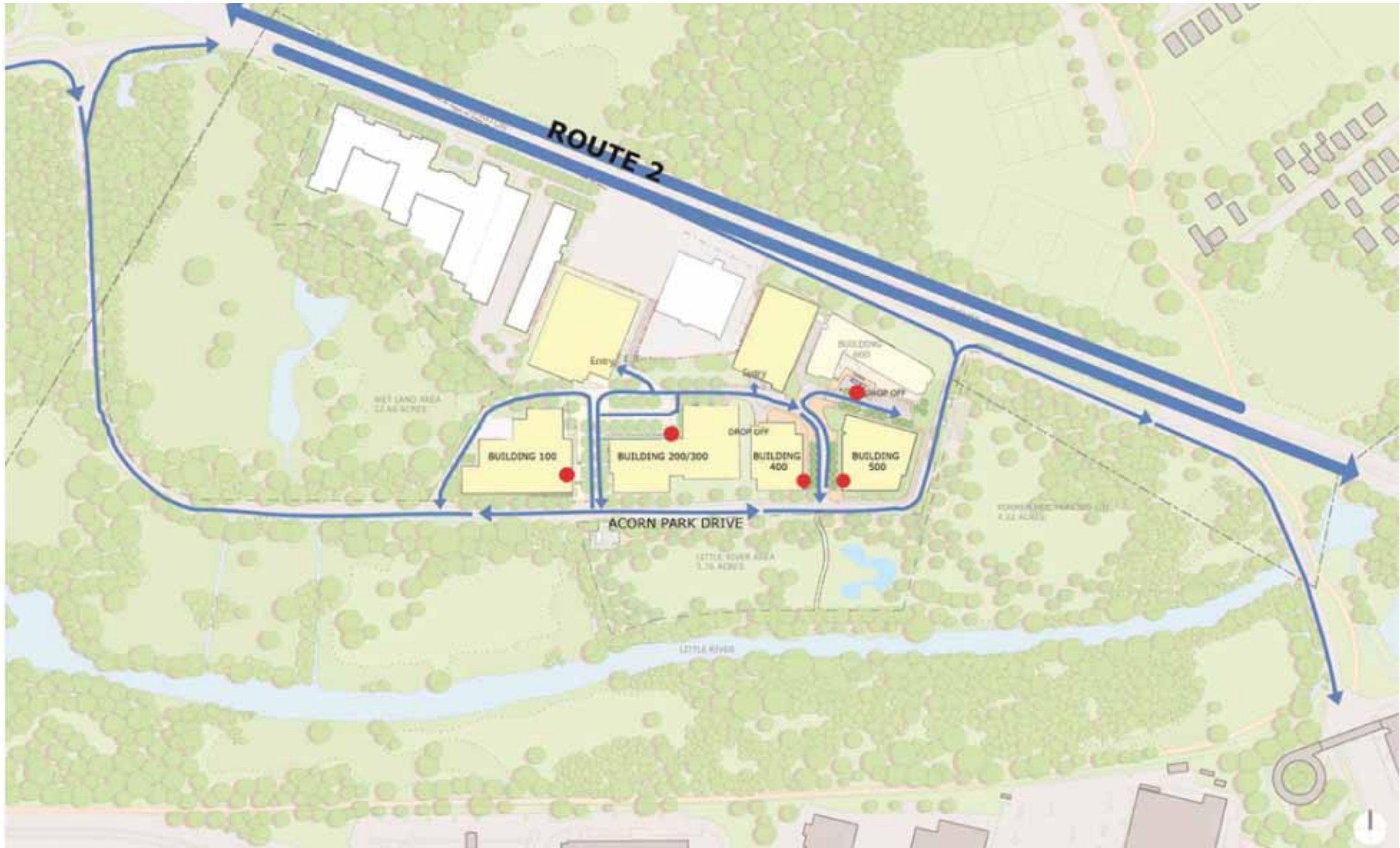

July 30, 2014



Automobile Circulation - Proposed

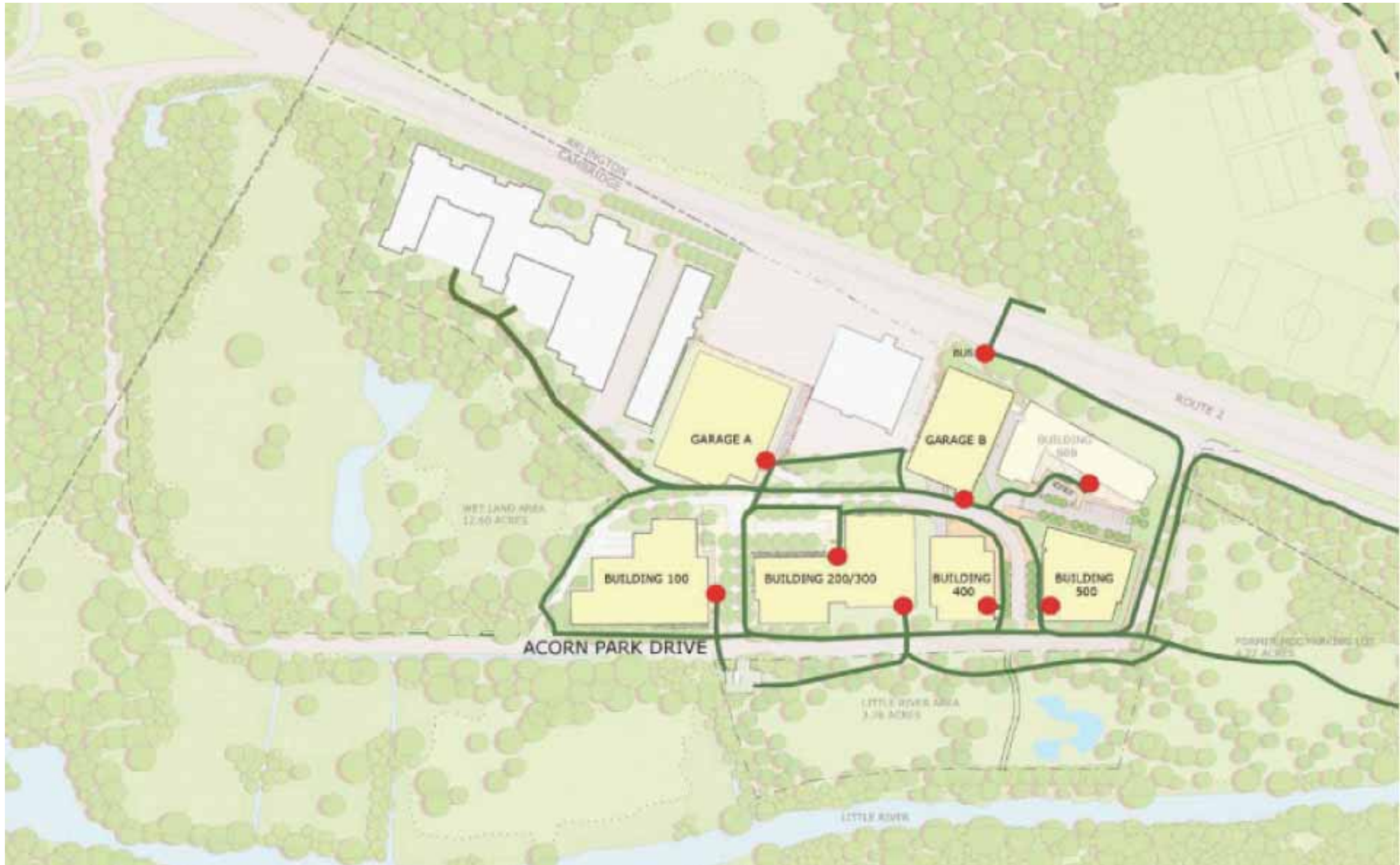

July 30, 2014



Pedestrian Circulation - Proposed

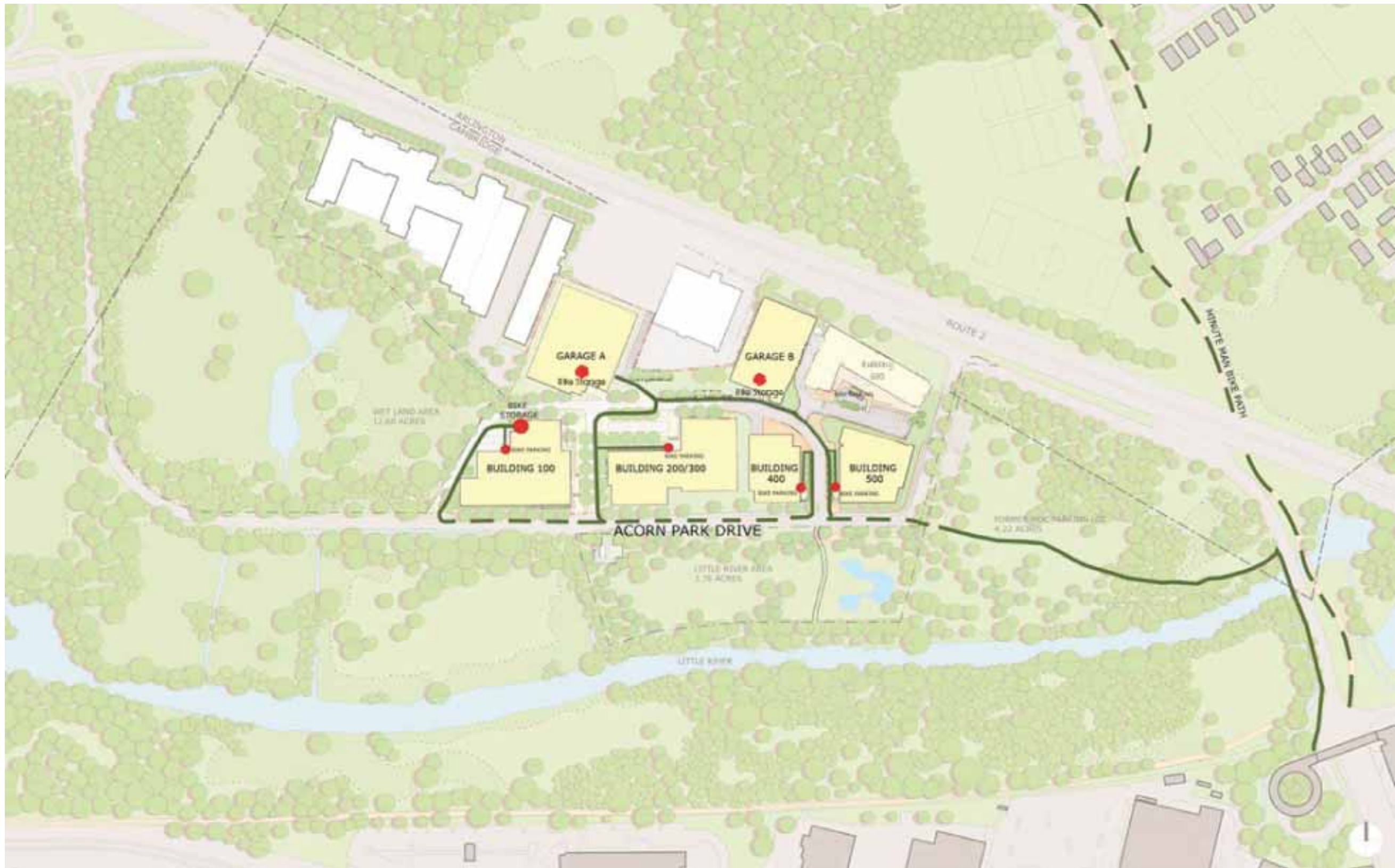

July 30, 2014

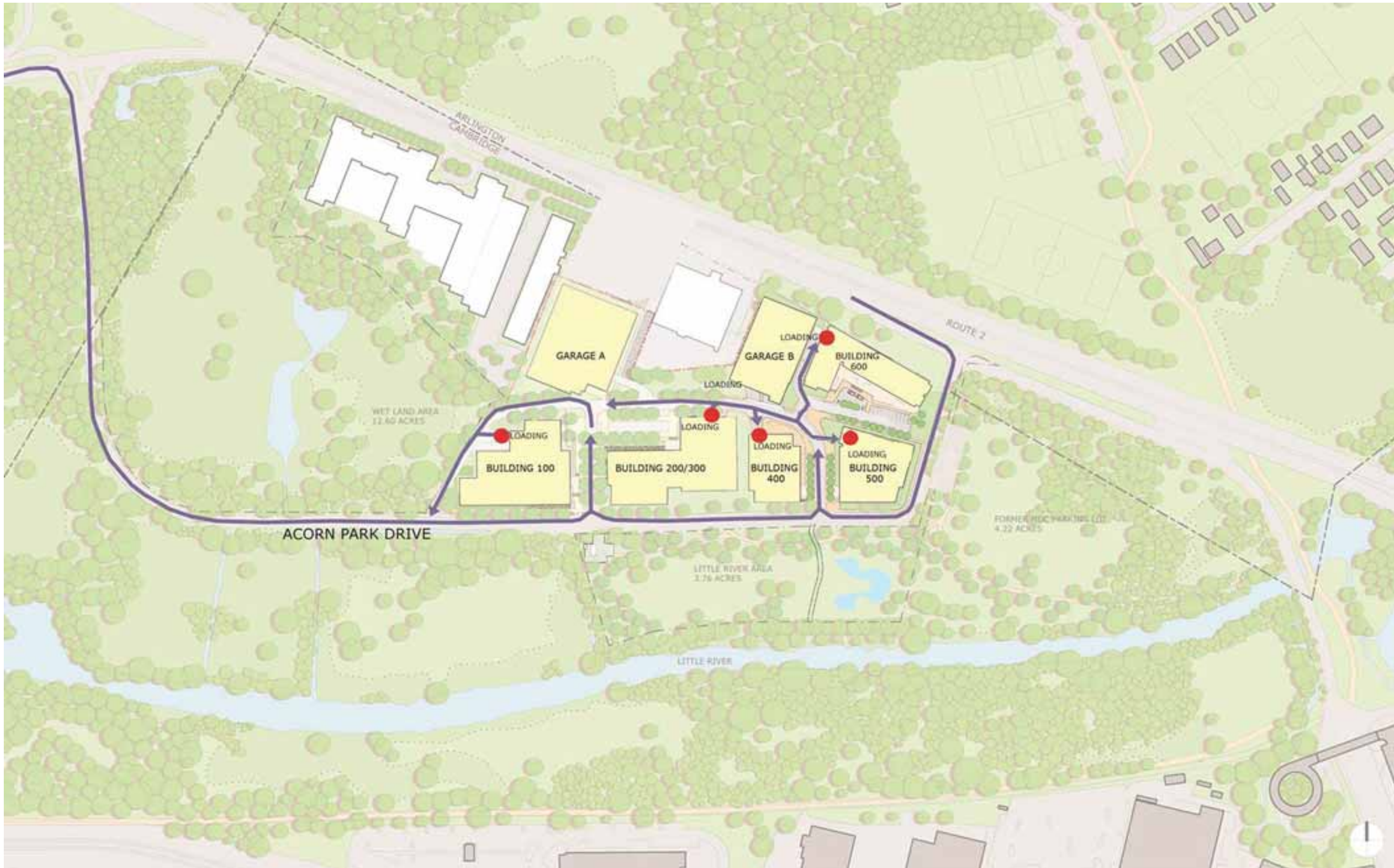

July 30, 2014

Architecture

ADD Inc

July 30, 2014





Key

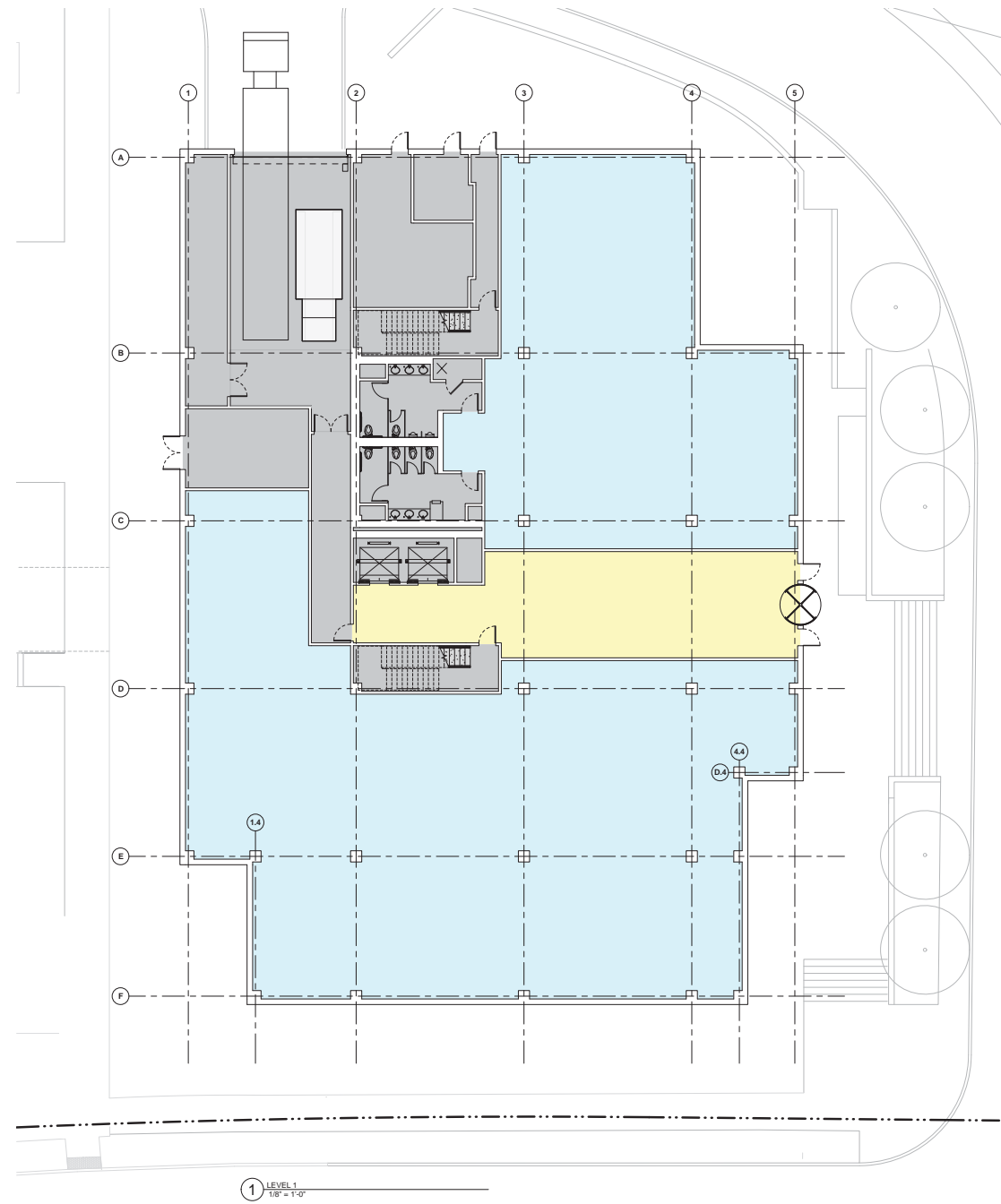

Ground Floor Plan

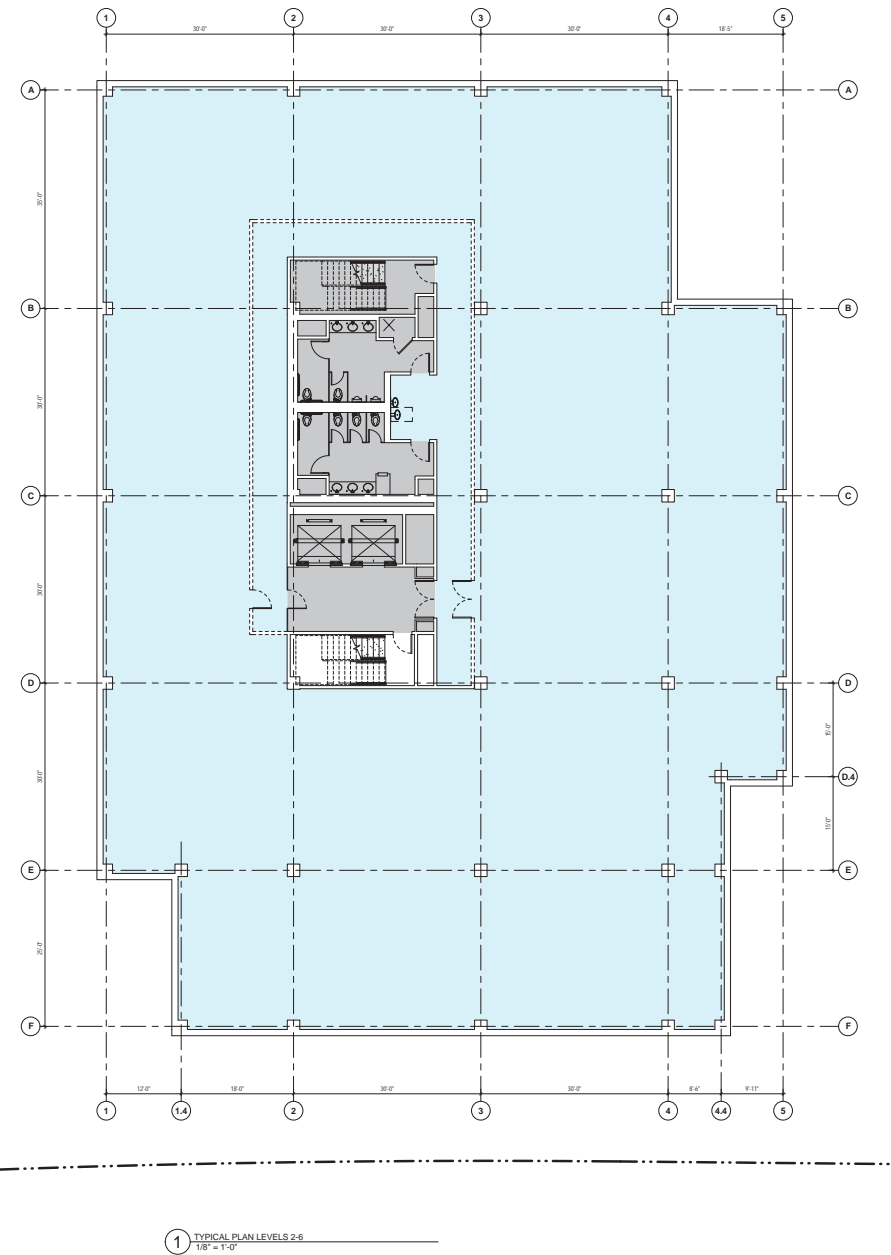

Typical Floor Plan

July 30, 2014





South Elevation



East Elevation

July 30, 2014





Entry along Acorn Park Drive

July 30, 2014





July 30, 2014



Building 400 Renderings

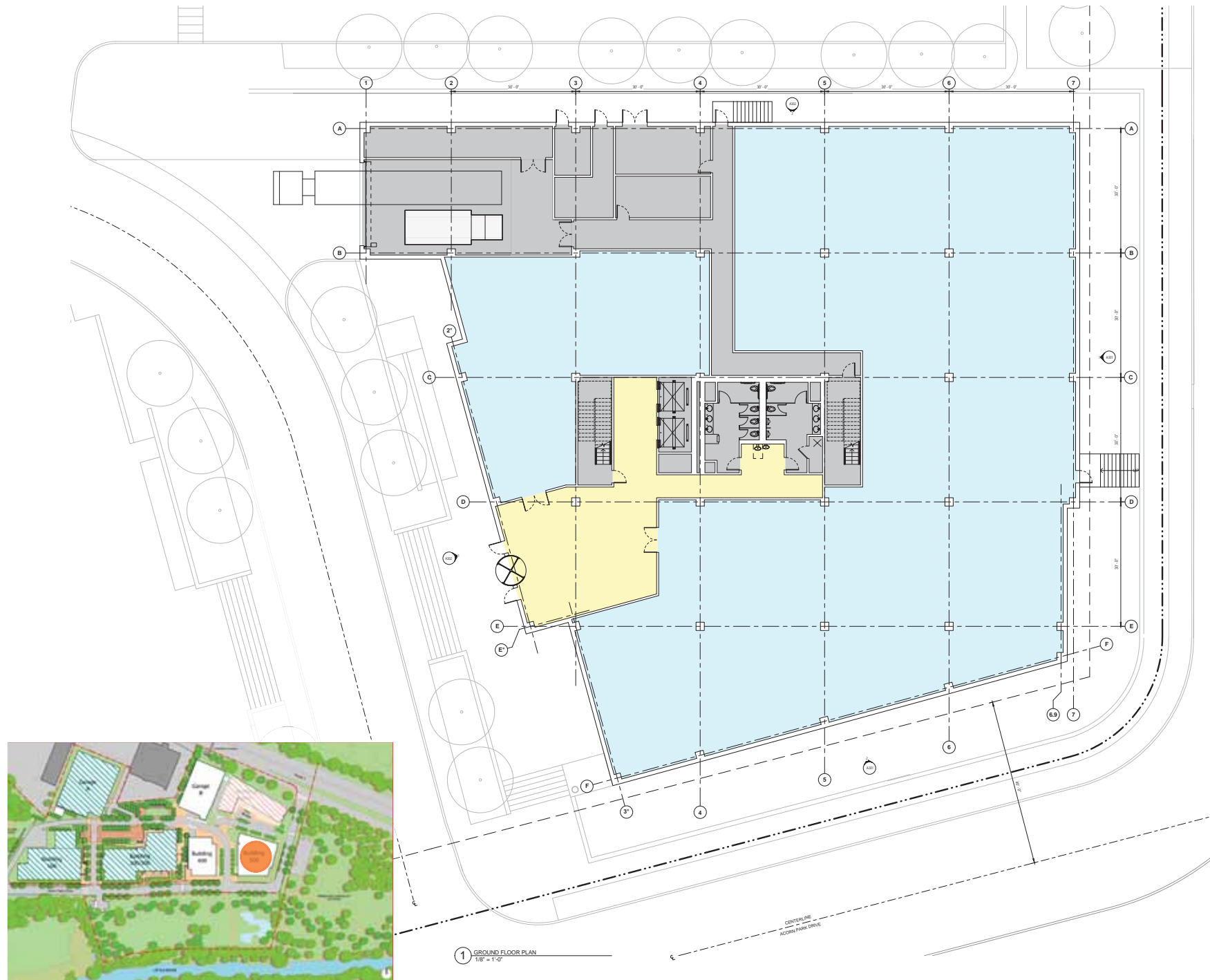

Key

Ground Floor Plan

Typical Floor Plan

July 30, 2014





South Elevation



East Elevation

July 30, 2014





Building 500 Approach from Resotored MDC Lot

July 30, 2014





July 30, 2014



Building 500 Renderings



Key

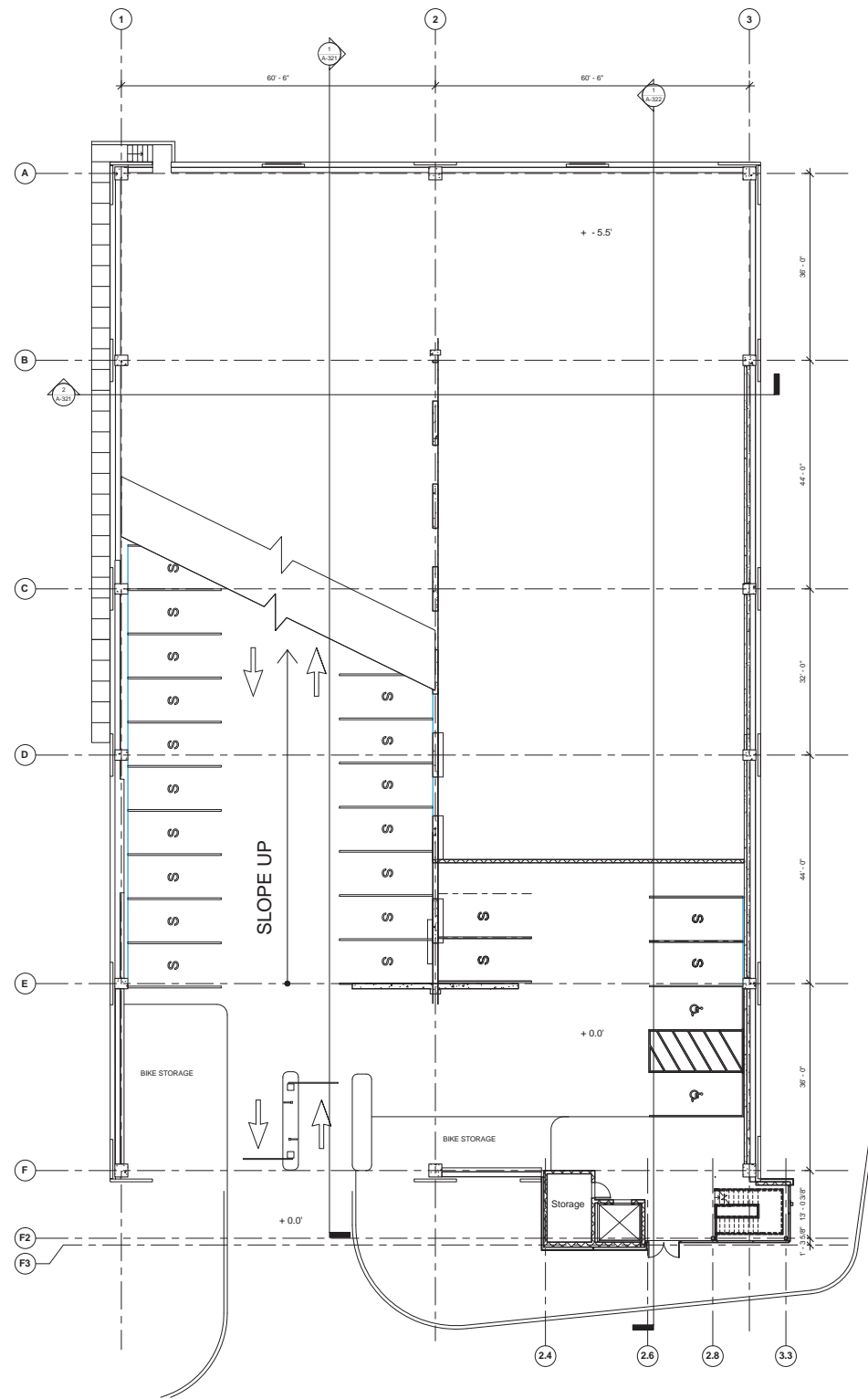

Ground Floor Plan

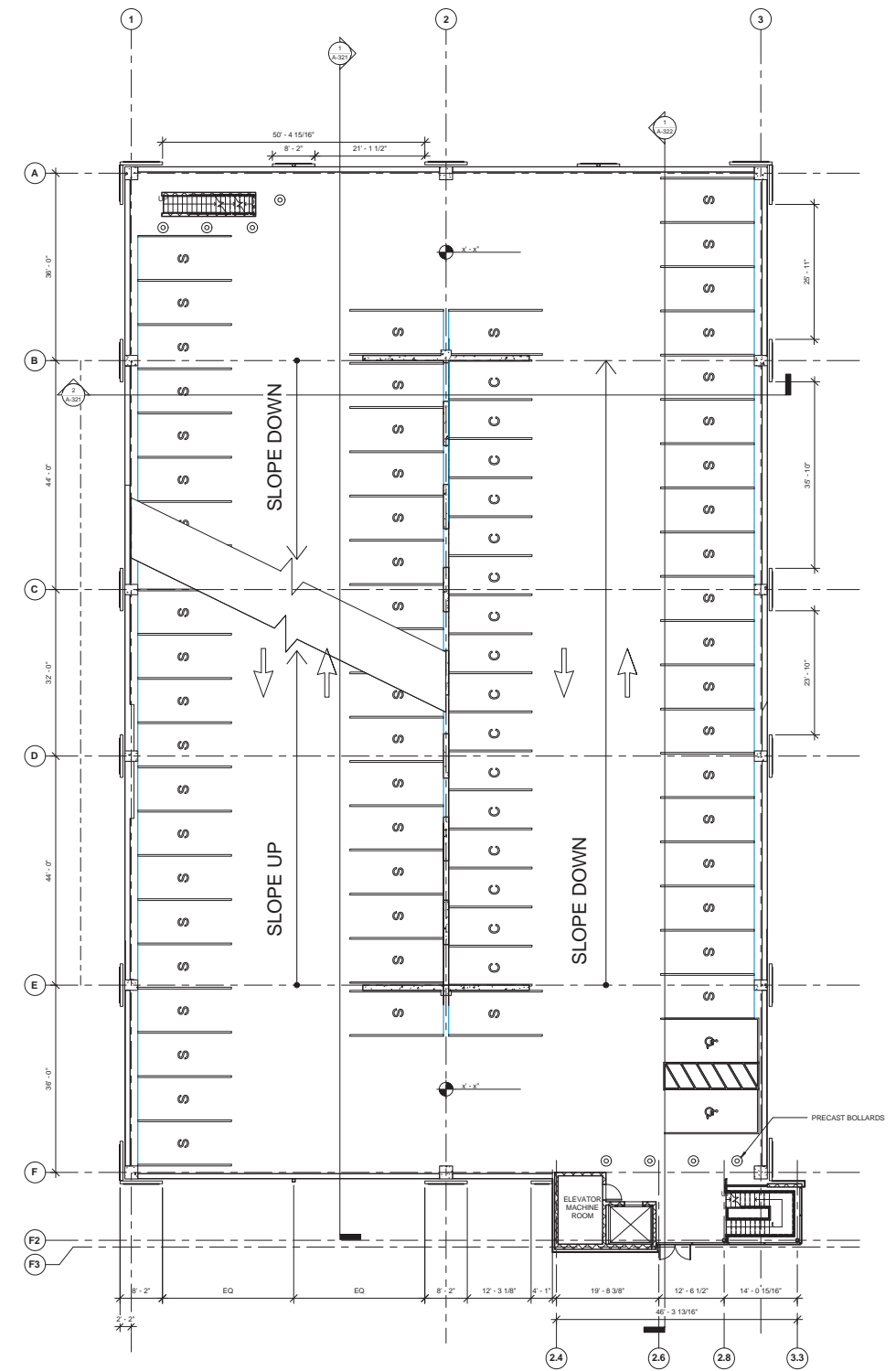

Second Floor

July 30, 2014





Key

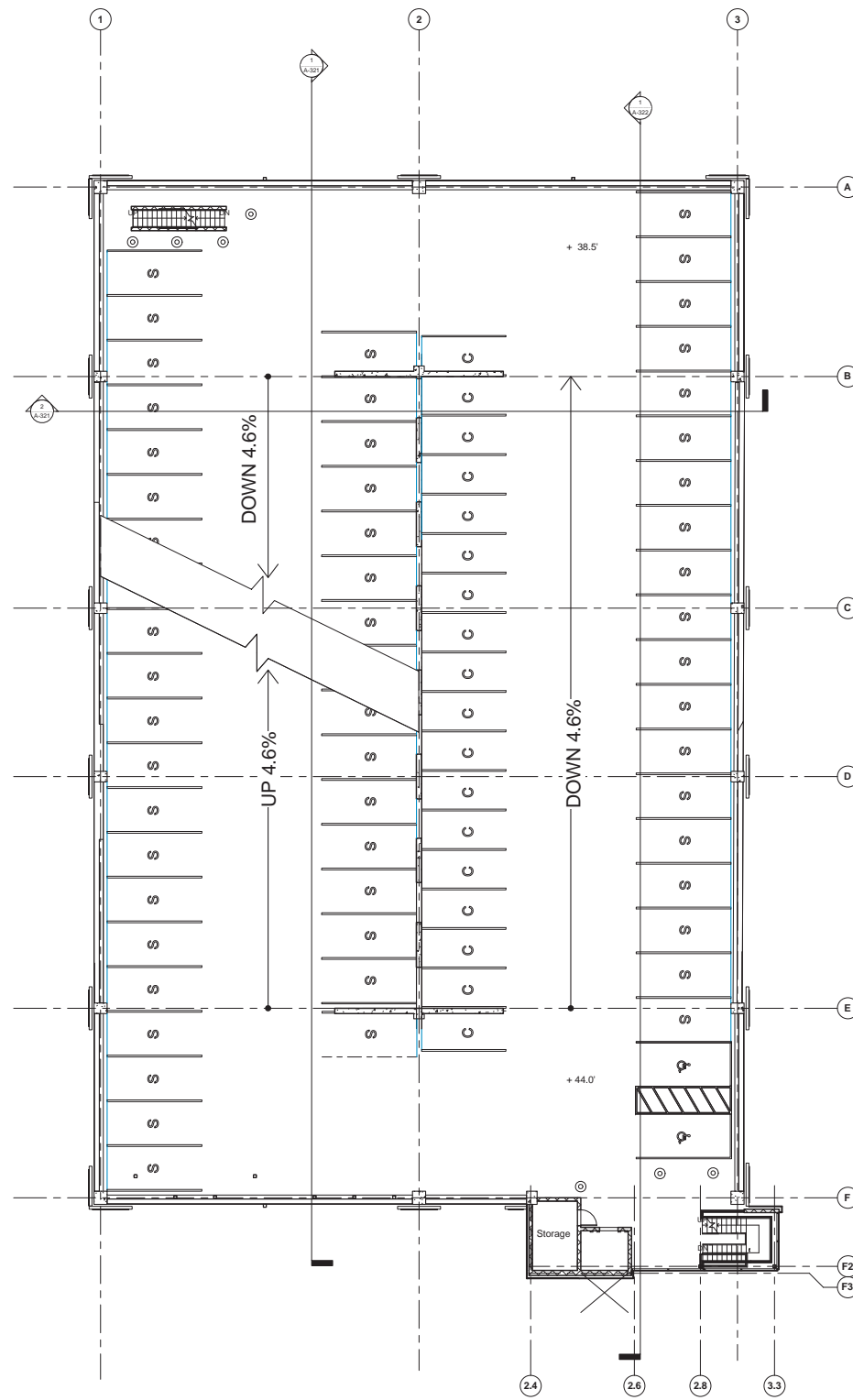

Typical Floor 3-5

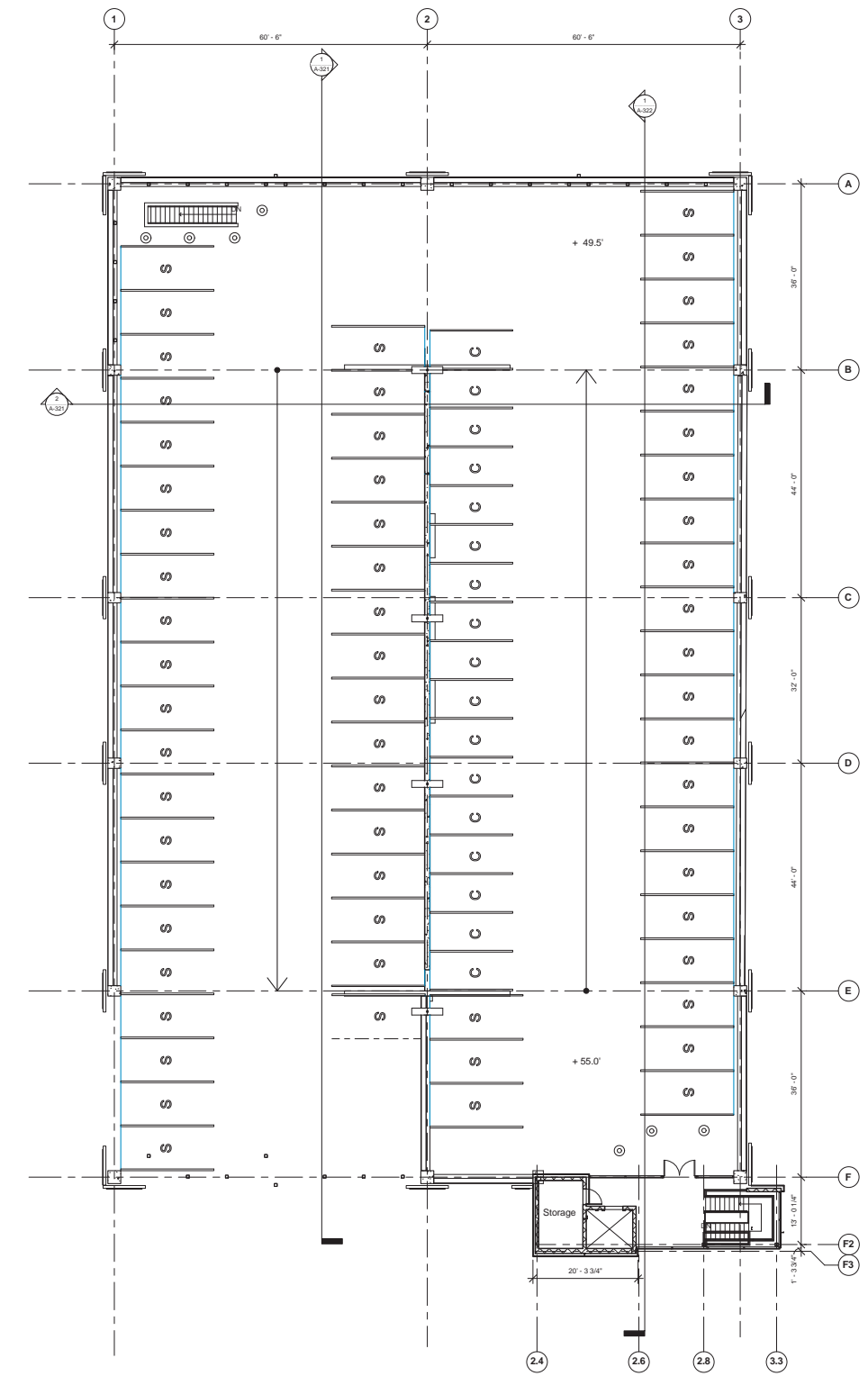

6th Floor

July 30, 2014





South Elevation



East Elevation

July 30, 2014



Garage Entry

July 30, 2014





July 30, 2014





July 30, 2014





RED OAK



BOLLARD AT PEDESTRIAN / VEHICULAR EDGE



VEHICULAR LIGHT



WOOD PERGOLA AT NORTH GARDEN



HONEY LOCUST



WARM TONE UNIT PAVER



PEDESTRIAN LIGHT & TRASH RECEPTACLE



INFORMAL SEATING / IMPROMPTU SCULPTURE



VINES ON PERGOLA



GRANITE & STONE SEAT WALL



GROUNDCOVER BEDS TO SOFTEN PAVED AREAS



BOLLARD LIGHT BICYCLE RACK



BENCH / FORMAL SEATING

July 30, 2014



July 30, 2014





July 30, 2014





July 30, 2014