

PROJECT NAME

**YAMBA HARVEST**

PROJECT ADDRESS

580 Massachusetts Avenue Cambridge, MA

CLIENT

**Home Grown 617 LLC**

ARCHITECT



**KHALSA**

17 IVALOO STREET SUITE 400  
SOMERVILLE, MA 02143  
TELEPHONE: 617-591-8682

CONSULTANTS:

# PROJECT: YAMBA HARVEST DISPENSARY

PROJECT ADDRESS:  
580 MASSACHUSETTS AVE  
CAMBRIDGE MASSACHUSETTS

ARCHITECT:  
**KHALSA DESIGN INC.**  
ADDRESS:  
17 IVALOO STREET, SUITE 400  
SOMERVILLE, MA 02143

CLIENT:  
**HomeGrown 617 LLC**

## CITY OF CAMBRIDGE PRESENTATION 08-21-2019

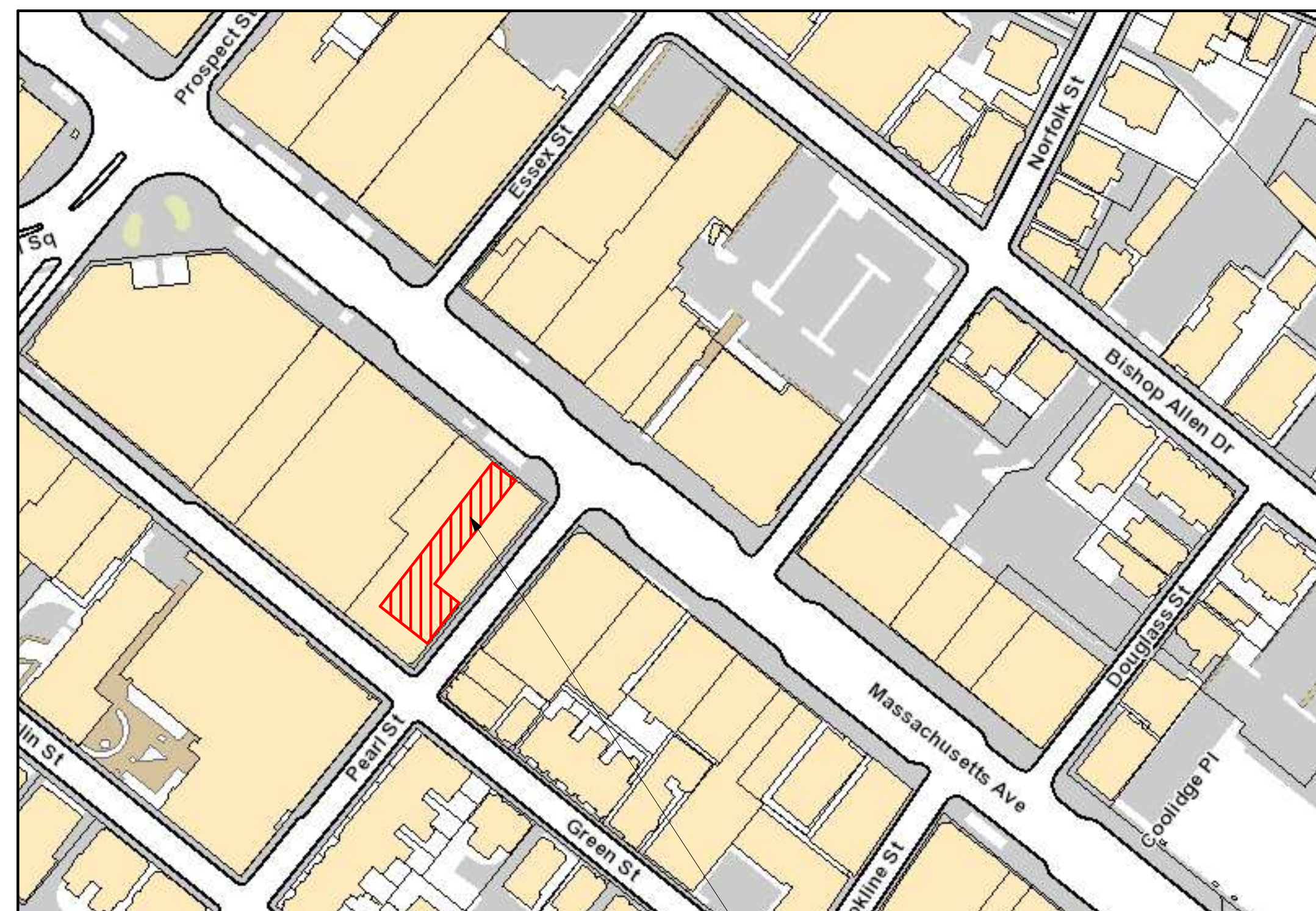

PROJECT LOCUS

Architectural Drawing List

Sheet Number	Sheet Name	Sheet Issue Date
A-000	Cover Sheet	08/02/19
A-020	Locus/ Context Plan	08/02/19
A-021	Expanded Locus Plan	08/02/19
A-022	Site Plan / Logistics	08/02/19
A-100	Proposed Dispensary Floor Plan	08/02/19
A-101	Enlarged Dispensary Floor Plan	08/02/19
A-102	Bike Room Plans	08/02/19
A-300	Exterior Elevations	08/02/19

COPYRIGHT KDI © 2019  
THESE DRAWINGS ARE NOW AND DO  
REMAIN THE SOLE PROPERTY OF KHALSA  
DESIGN INC. USE OF THESE PLANS OR ANY  
FORM OF REPRODUCTION OF THIS DESIGN  
IN WHOLE OR IN PART WITHOUT EXPRESS  
WRITTEN CONSENT IS PROHIBITED AND  
SHALL RESULT IN THE FULLEST EXTENT  
OF PROSECUTION UNDER LAW

REGISTRATION



Project number 19029  
Date 07/29/2019  
Drawn by WC  
Checked by JSK  
Scale

REVISIONS

No.	Description	Date

Cover Sheet

**A-000**

YAMBA HARVEST

PROJECT NAME

# YAMBA HARVEST

PROJECT ADDRESS  
580 Massachusetts Avenue Cambridge, MA

CLIENT

Home Grown 617 LLC

ARCHITECT



17 IVALOO STREET SUITE 400  
SOMERVILLE, MA 02143  
TELEPHONE: 617-591-8682 FAX: 617-591-2086

CONSULTANTS:

COPYRIGHT KDI © 2015  
THESE DRAWINGS ARE NOW AND DO  
REMAIN THE SOLE PROPERTY OF KHALSA  
DESIGN INC. USE OF THESE PLANS OR ANY  
FORM OF REPRODUCTION OF THIS DESIGN  
IN WHOLE OR IN PART WITHOUT EXPRESS  
WRITTEN CONSENT IS PROHIBITED AND  
SHALL RESULT IN THE FULLEST EXTENT  
OF PROSECUTION UNDER LAW

### REGISTRATION

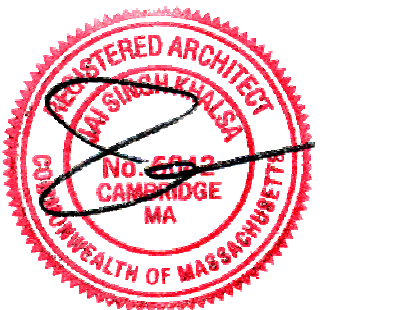

Project number 19029  
Date 07/29/2019  
Drawn by WC  
Checked by JSK  
Scale 12" = 1'-0"

### REVISIONS

No.	Description	Date

Locus/ Context Plan

# A-020

YAMBA HARVEST

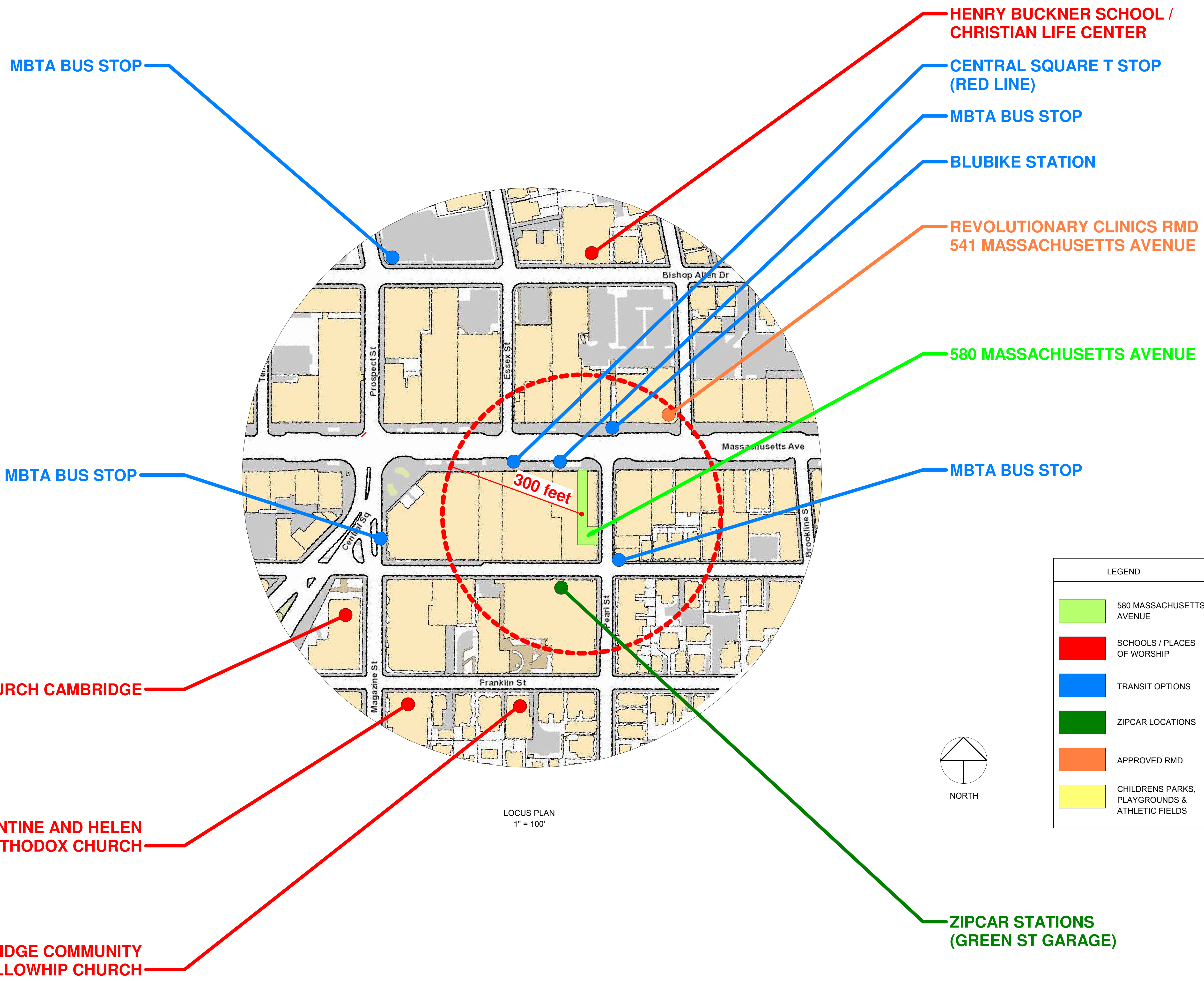

**LEGEND**

- 580 MASSACHUSETTS AVENUE
- SCHOOLS / PLACES OF WORSHIP
- TRANSIT OPTIONS
- ZIPCAR LOCATIONS
- APPROVED RMD
- CHILDRENS PARKS, PLAYGROUNDS & ATHLETIC FIELDS

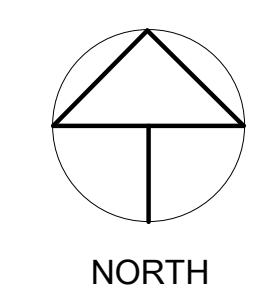

LOCUS PLAN  
1" = 100'

FIRST BAPTIST CHURCH CAMBRIDGE

SAINTS CONSTANTINE AND HELEN  
GREEK ORTHODOX CHURCH

CAMBRIDGE COMMUNITY  
FELLOWSHIP CHURCH

ZIPCAR STATIONS  
(GREEN ST GARAGE)

MBTA BUS STOP

REVOLUTIONARY CLINICS RMD  
541 MASSACHUSETTS AVENUE

BLUBIKE STATION

MBTA BUS STOP

CENTRAL SQUARE T STOP  
(RED LINE)

HENRY BUCKNER SCHOOL /  
CHRISTIAN LIFE CENTER

580 MASSACHUSETTS AVENUE

MBTA BUS STOP

MBTA BUS STOP

\\TKG-SERVER\Draw\1919033\_580 Mass Ave Dispensary\bin\03 Drawings\00\_ARCH\_SD\_DD\580 Mass Ave Dispensary 8.14.19.dwg

**PROJECT NAME**  
**YAMBA HARVEST**

**PROJECT ADDRESS**  
 580 Massachusetts Avenue Cambridge, MA

**CLIENT**  
 Home Grown 617 LLC

**ARCHITECT**  
  
**KHALSA**  
 17 IVALOO STREET SUITE 400  
 SOMERVILLE, MA 02143  
 TELEPHONE: 617-591-8682

**CONSULTANTS:**

COPYRIGHT KDI © 2019  
 THESE DRAWINGS ARE NOW AND DO  
 REMAIN THE SOLE PROPERTY OF KHALSA  
 DESIGN INC. USE OF THESE PLANS OR ANY  
 FORM OF REPRODUCTION OF THIS DESIGN  
 IN WHOLE OR IN PART WITHOUT EXPRESS  
 WRITTEN CONSENT IS PROHIBITED AND  
 SHALL RESULT IN THE FULLEST EXTENT  
 OF PROSECUTION UNDER LAW

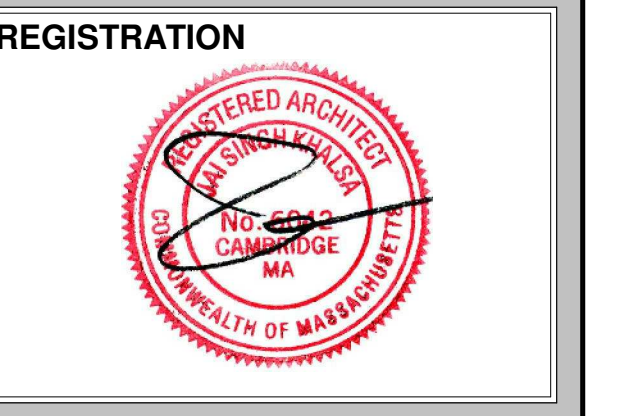

Project number 19029  
 Date 07/29/2019  
 Drawn by WC  
 Checked by JSK  
 Scale 12" = 1'-0"

**REVISIONS**

No.	Description	Date

Expanded Locus  
 Plan

**A-021**  
 YAMBA HARVEST

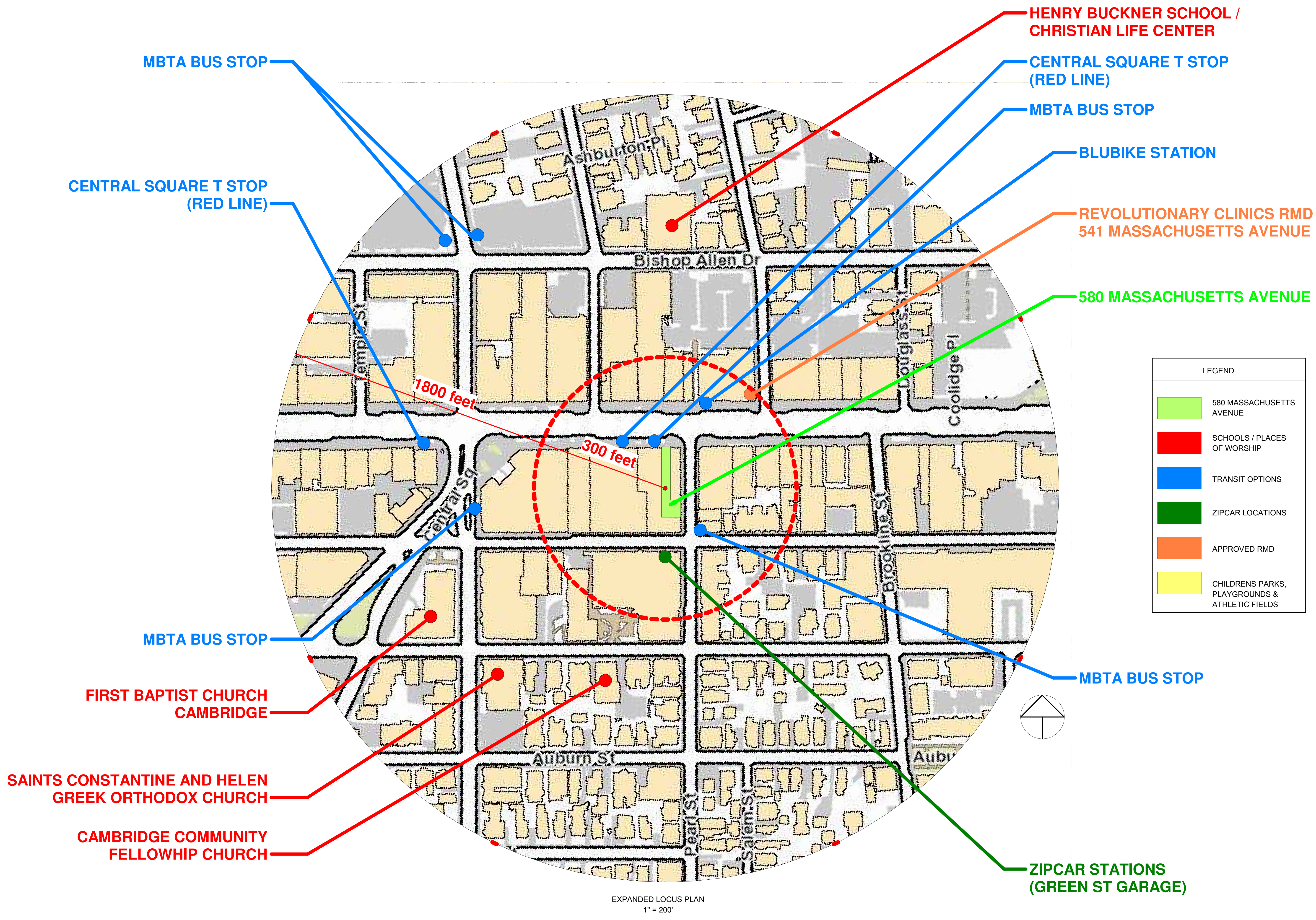

I:\TKG-SERVER\Drawn\1919033\_580 Mass Ave Dispensary\bin\03 Drawings\00\_ARCH\_SD\_DD\580 Mass Ave Dispensary 8.14.19.rvt  
 8/20/2019 3:26:22 PM

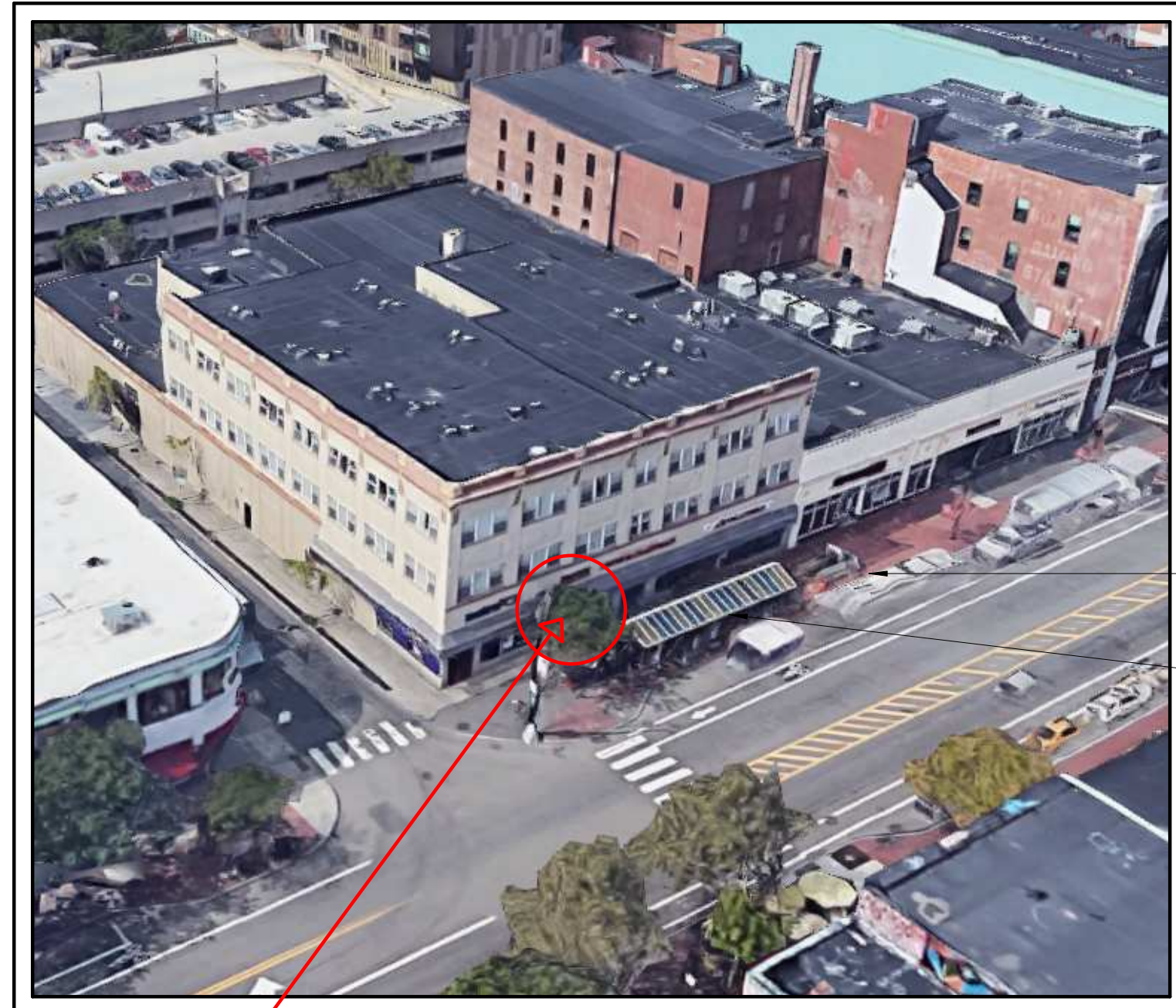

**AERIAL FRONT VIEW**



**AERIAL SITE PLAN**



**EXISTING ENTRANCE**



**EXISTING SIGNAGE**



**LOADING LOCATION**

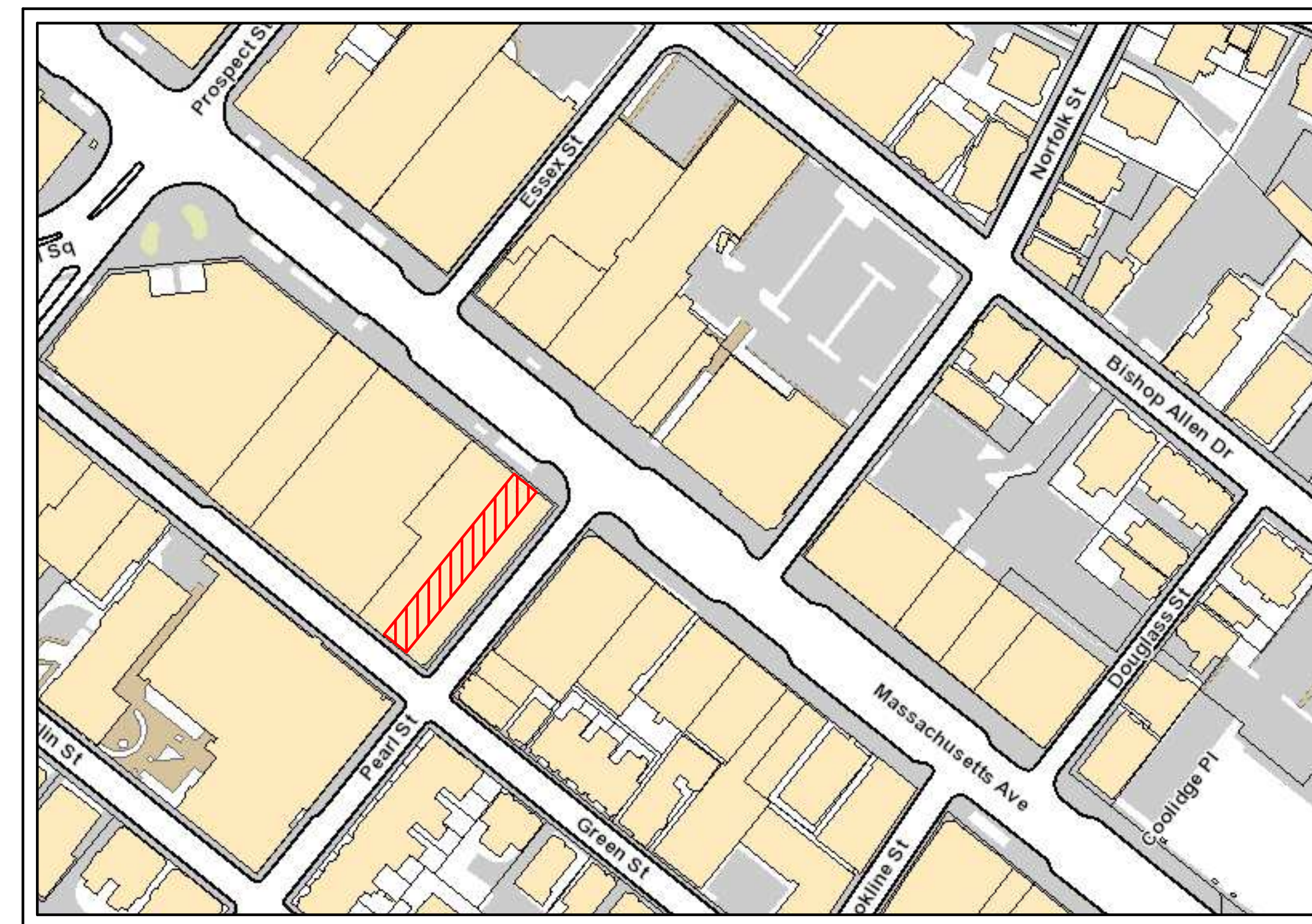

**CAMBRIDGE GIS MAP**

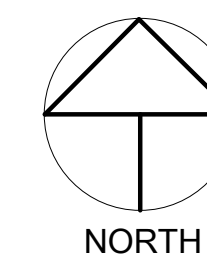

**NEW DOORS ON PEARL ST**



**AERIAL REAR VIEW**



**EXIT LOCATION**

- NOTES:**
1. THE BUILDING AND ALL COMMERCIAL/ RETAIL SPACES ARE EXISTING
  2. ALL DIMENSIONS AND SQUARE FOOTAGE INDICATED ARE PROVIDED BY ASSESSORS DATA BASE INFORMATION.
  3. EXISTING STREET SIDE HANDICAP PARKING AND METERED PARKING.
  4. EXISTING BICYCLE RACKS ALONG SIDEWALK.
  5. EXISTING STREET SIDE LOADING ZONES.
  6. EXISTING SIDEALKS FOR PEDESTRIAN ACCESS.
  7. ALL SITE LIGHTING IS EXISTING TO REMAIN.

**PROJECT NAME**  
**YAMBA HARVEST**

**PROJECT ADDRESS**  
 580 Massachusetts Avenue Cambridge, MA

**CLIENT**  
 Home Grown 617 LLC

**ARCHITECT**  
  
**KHALSA**

17 IVALOO STREET SUITE 400  
 SOMERVILLE, MA 02143  
 TELEPHONE: 617-591-8682

**CONSULTANTS:**

COPYRIGHT KDI © 2019  
 THESE DRAWINGS ARE NOW AND DO  
 REMAIN THE SOLE PROPERTY OF KHALSA  
 DESIGN INC. USE OF THESE PLANS OR ANY  
 FORM OF REPRODUCTION OF THIS DESIGN  
 IN WHOLE OR IN PART WITHOUT EXPRESS  
 WRITTEN CONSENT IS PROHIBITED AND  
 SHALL RESULT IN THE FULLEST EXTENT  
 OF PROSECUTION UNDER LAW



**REGISTRATION**

Project number	19029
Date	07/29/2019
Drawn by	WC
Checked by	JSK
Scale	

**REVISIONS**

No.	Description	Date

**Site Plan / Logistics**

**A-022**

YAMBA HARVEST

**PROJECT NAME**  
**YAMBA HARVEST**

**PROJECT ADDRESS**  
 580 Massachusetts Avenue Cambridge, MA

**CLIENT**  
 Home Grown 617 LLC

**ARCHITECT**



**KHALSA**

17 IVALOO STREET SUITE 400  
 SOMERVILLE, MA 02143  
 TELEPHONE: 617-591-8682 FAX:  
 617-591-2086

**CONSULTANTS:**

COPYRIGHT KDI © 2015  
 THESE DRAWINGS ARE NOW AND DO  
 REMAIN THE SOLE PROPERTY OF KHALSA  
 DESIGN INC. USE OF THESE PLANS OR ANY  
 FORM OF REPRODUCTION OF THIS DESIGN  
 IN WHOLE OR IN PART WITHOUT EXPRESS  
 WRITTEN CONSENT IS PROHIBITED AND  
 SHALL RESULT IN THE FULLEST EXTENT  
 OF PROSECUTION UNDER LAW

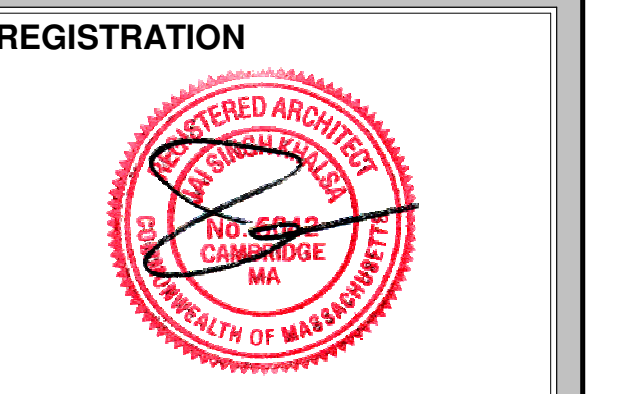

**REGISTRATION**

Project number 19029  
 Date 07/29/2019  
 Drawn by WC  
 Checked by JSK  
 Scale As indicated

**REVISIONS**

No.	Description	Date

**Proposed  
 Dispensary Floor  
 Plan**

**A-100**

YAMBA HARVEST

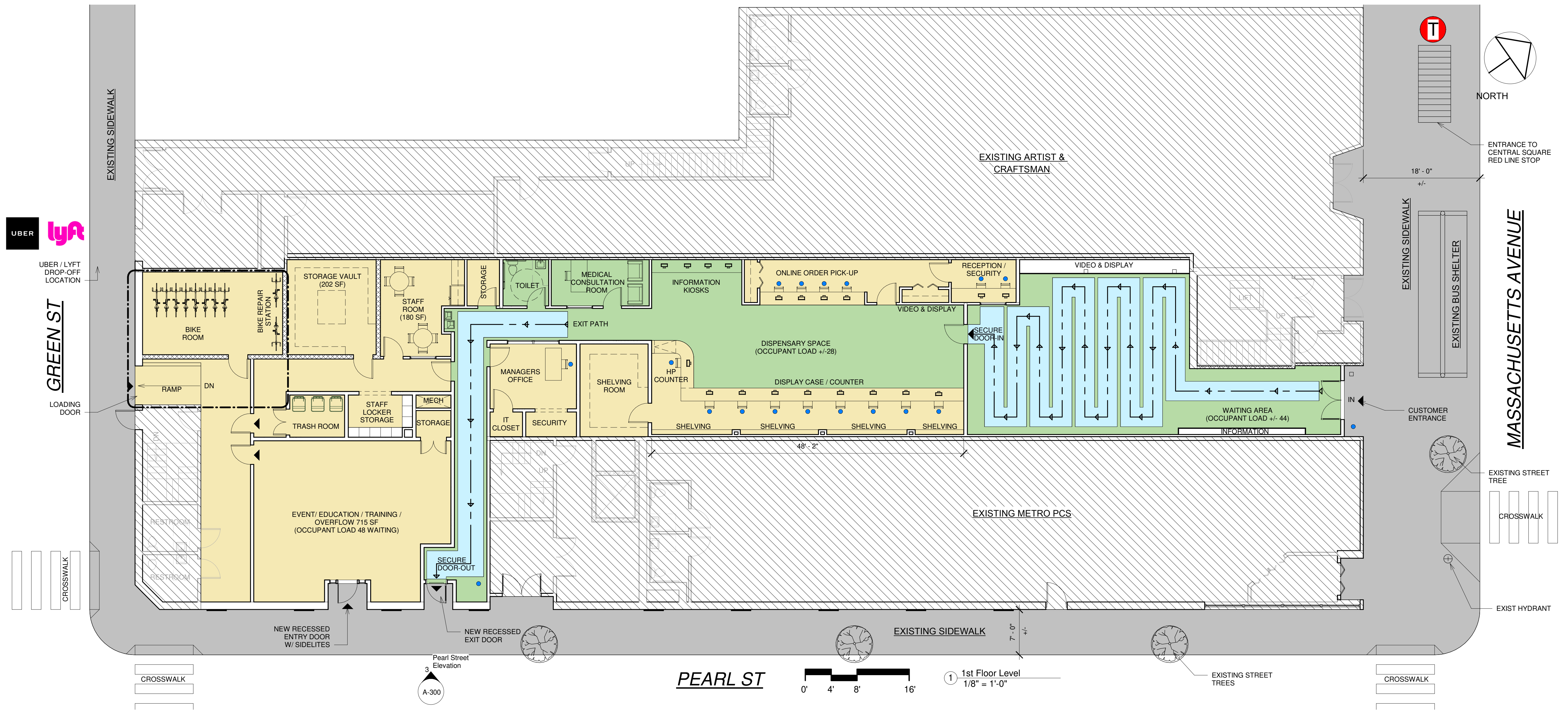

**DISPENSARY SF BREAKDOWN**

PUBLIC CUSTOMER SPACE	2,168 SQUARE FEET
EMPLOYEE SPACE	2,442 SQUARE FEET
FLEX/ OFFICE SPACE	715 SQUARE FEET

**LEGEND**

	CONSUMER SPACE (PUBLIC)
	EMPLOYEE SPACE (PRIVATE)
	EXISTING SPACE TO REMAIN
	EMPLOYEE

**DISPENSARY HIGHLIGHTS**

- LARGE EDUCATION AREA FOR GENERAL PUBLIC AT MAIN ENTRY
- IN STORE PICKUP FOR EFFICIENT ONLINE ORDERING
- PRIVATE CONSULTATION SPACE FOR MEDICAL PATIENTS
- INFORMATION TECHNOLOGY KIOSKS TO EDUCATE AND HELP CUSTOMERS NAVIGATE THE DISPENSARY PROCESS
- EMPLOYEE BREAK ROOM
- EMPLOYEE BIKE ROOM & LOCKERS
- EDUCATION & OVERFLOW SPACE

\\TKG-SERVER\Drawn\19\19029\_580 Mass Ave Dispensary-bim\03 Drawings\00\_ARCH\_SD\_DD\580 Mass Ave Dispensary 8.14.19.rvt  
 8/20/2019 3:26:27 PM

PROJECT NAME

# YAMBA HARVEST

PROJECT ADDRESS

580 Massachusetts Avenue Cambridge, MA

CLIENT

Home Grown 617 LLC

ARCHITECT



## KHALSA

17 IVALOO STREET SUITE 400  
SOMERVILLE, MA 02143  
TELEPHONE: 617-591-8682

CONSULTANTS:

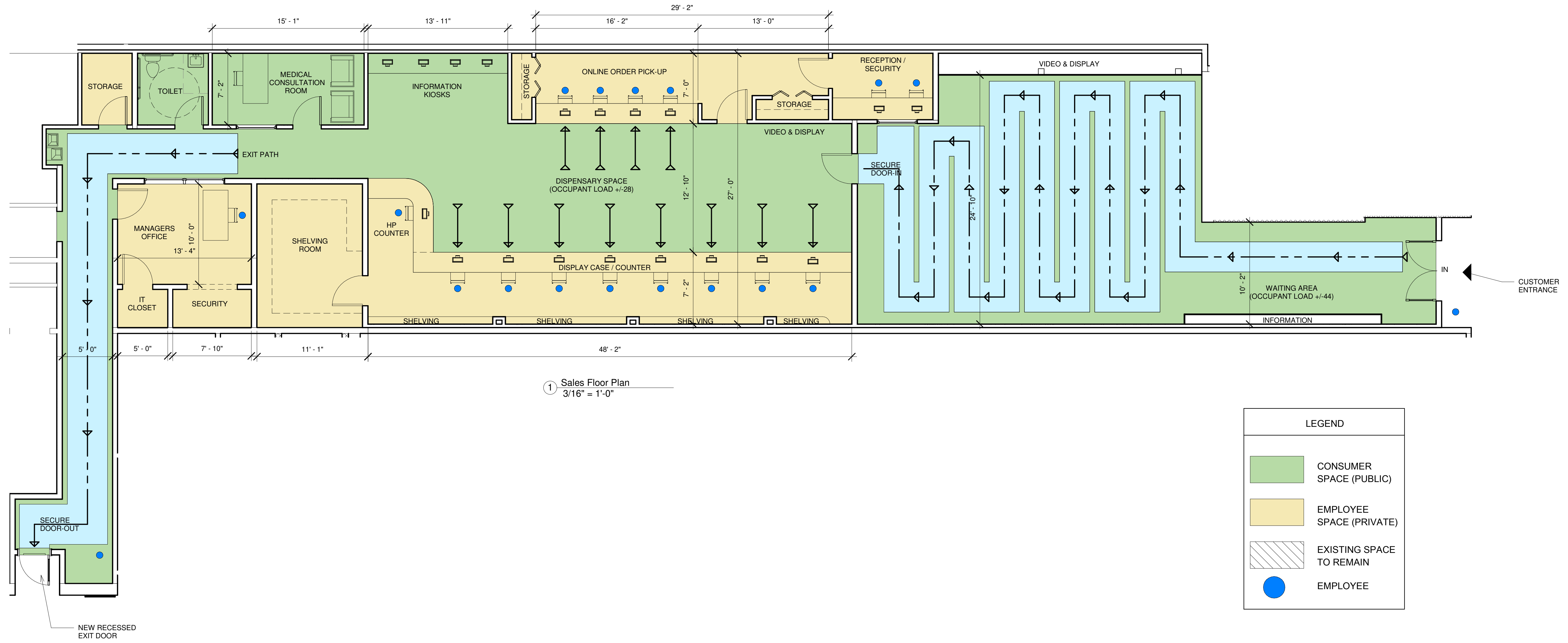

1 Sales Floor Plan  
3/16" = 1'-0"

LEGEND	
	CONSUMER SPACE (PUBLIC)
	EMPLOYEE SPACE (PRIVATE)
	EXISTING SPACE TO REMAIN
	EMPLOYEE

DISPENSARY SF BREAKDOWN	
PUBLIC CUSTOMER SPACE	2,168 SQUARE FEET
EMPLOYEE SPACE	2,442 SQUARE FEET
FLEX/ OFFICE SPACE	715 SQUARE FEET

- DISPENSARY HIGHLIGHTS**
- LARGE EDUCATION AREA FOR GENERAL PUBLIC AT MAIN ENTRY
  - IN STORE PICKUP FOR EFFICIENT ONLINE ORDERING
  - PRIVATE CONSULTATION SPACE FOR MEDICAL PATIENTS
  - INFORMATION TECHNOLOGY KIOSKS TO EDUCATE AND HELP CUSTOMERS NAVIGATE THE DISPENSARY PROCESS
  - EMPLOYEE BREAK ROOM
  - EMPLOYEE BIKE ROOM & LOCKERS
  - EDUCATION & OVERFLOW SPACE

COPYRIGHT KDI © 2019  
THESE DRAWINGS ARE NOW AND DO  
REMAIN THE SOLE PROPERTY OF KHALSA  
DESIGN INC. USE OF THESE PLANS OR ANY  
FORM OF REPRODUCTION OF THIS DESIGN  
IN WHOLE OR IN PART WITHOUT EXPRESS  
WRITTEN CONSENT IS PROHIBITED AND  
SHALL RESULT IN THE FULLEST EXTENT  
OF PROSECUTION UNDER LAW

REGISTRATION



Project number	19029
Date	07/29/2019
Drawn by	Author
Checked by	Checker
Scale	As indicated

REVISIONS

No.	Description	Date

## Enlarged Dispensary Floor Plan

# A-101

YAMBA HARVEST

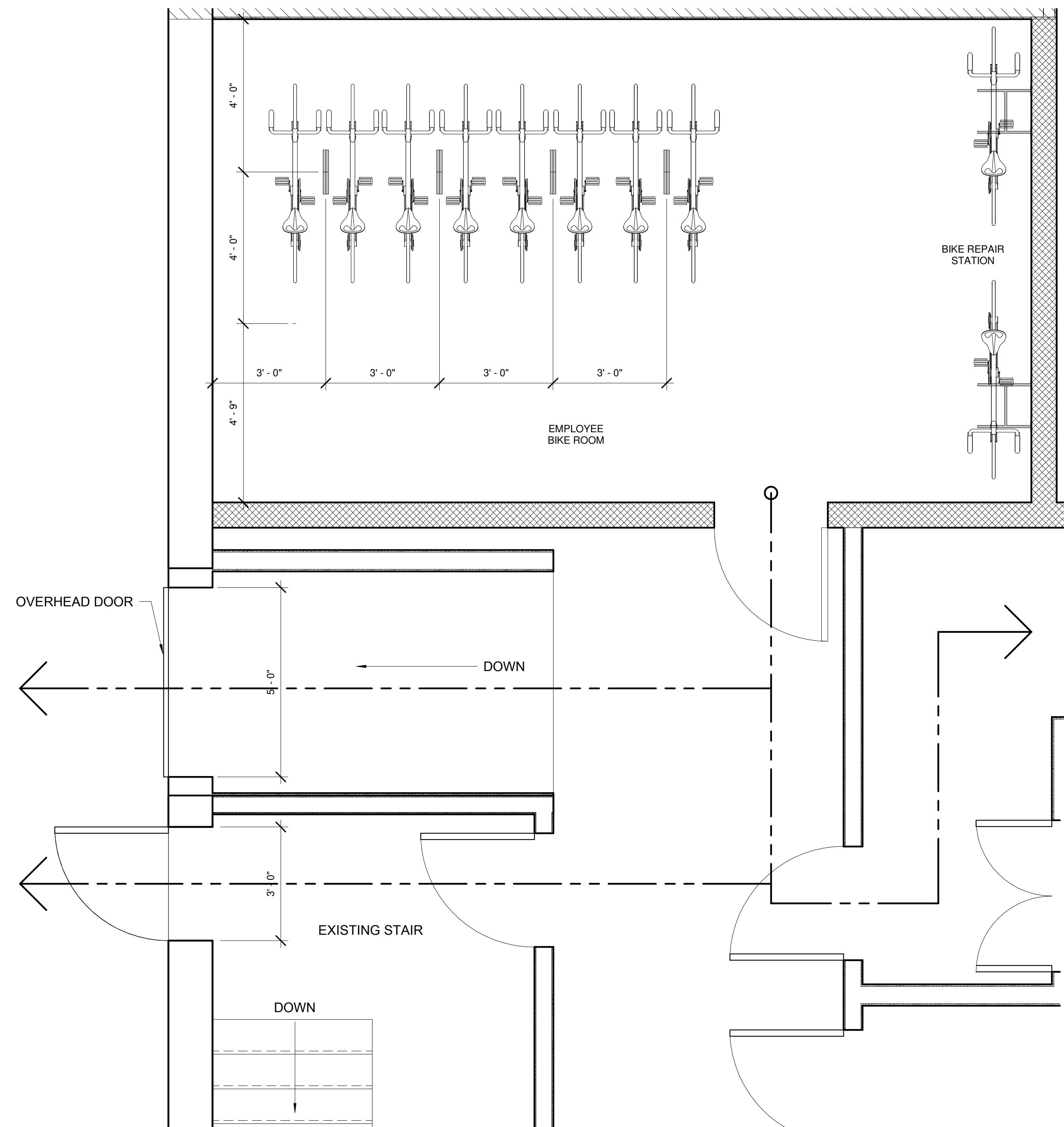

1 Bike Room Plan  
1/2" = 1'-0"

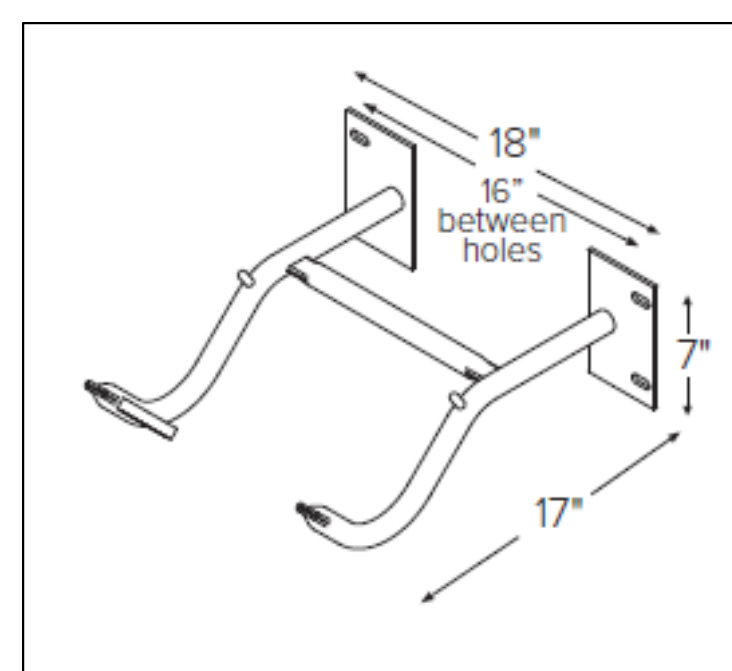

PROPOSED WALL BIKE RACK  
FOR BIKE REPAIR STATION  
RACK BY DERO

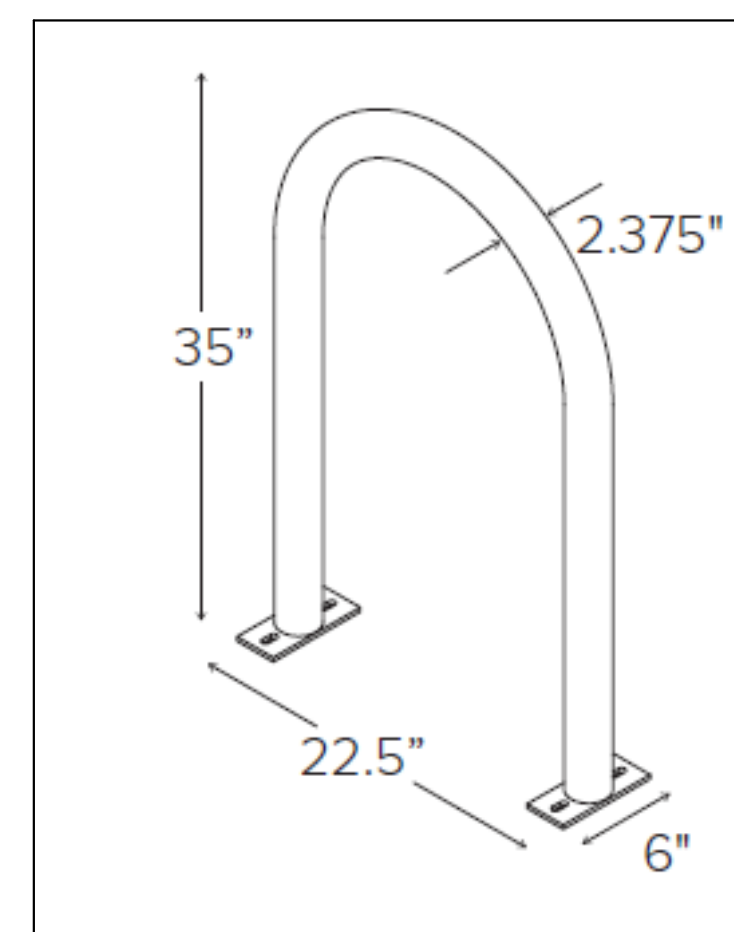

PROPOSED HEAVY DUTY HOOP  
FLOOR RACK FOR BIKE ROOM  
RACK BY DERO

PROJECT NAME  
**YAMBA HARVEST**

PROJECT ADDRESS  
580 Massachusetts Avenue Cambridge, MA

CLIENT  
**Home Grown 617 LLC**

ARCHITECT  
**DESIGN KHALSA**

17 IVALOO STREET SUITE 400  
SOMERVILLE, MA 02143  
TELEPHONE: 617-591-8682

CONSULTANTS:

COPYRIGHT KDI © 2019  
THESE DRAWINGS ARE NOW AND DO  
REMAIN THE SOLE PROPERTY OF KHALSA  
DESIGN INC. USE OF THESE PLANS OR ANY  
FORM OF REPRODUCTION OF THIS DESIGN  
WITHOUT WRITTEN CONSENT IS PROHIBITED AND  
SHALL RESULT IN THE FULLEST EXTENT  
OF PROSECUTION UNDER LAW

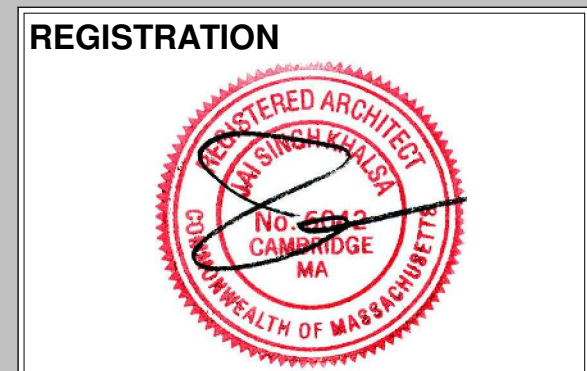

Project number	19029
Date	07/29/2019
Drawn by	WC
Checked by	JSK
Scale	1/2" = 1'-0"

No.	Description	Date

Bike Room Plans

**A-102**

YAMBA HARVEST

PROJECT NAME  
**YAMBA HARVEST**

PROJECT ADDRESS  
 580 Massachusetts Avenue Cambridge, MA

CLIENT  
**Home Grown 617 LLC**

ARCHITECT



17 IVALOO STREET SUITE 400  
 SOMERVILLE, MA 02143  
 TELEPHONE: 617-591-8682 FAX: 617-591-2086

CONSULTANTS:

COPYRIGHT KDI © 2015  
 THESE DRAWINGS ARE NOW AND DO REMAIN THE SOLE PROPERTY OF KHALSA DESIGN INC. USE OF THESE PLANS OR ANY FORM OF REPRODUCTION OF THIS DESIGN IN WHOLE OR IN PART WITHOUT EXPRESS WRITTEN CONSENT IS PROHIBITED AND SHALL RESULT IN THE FULLEST EXTENT OF PROSECUTION UNDER LAW

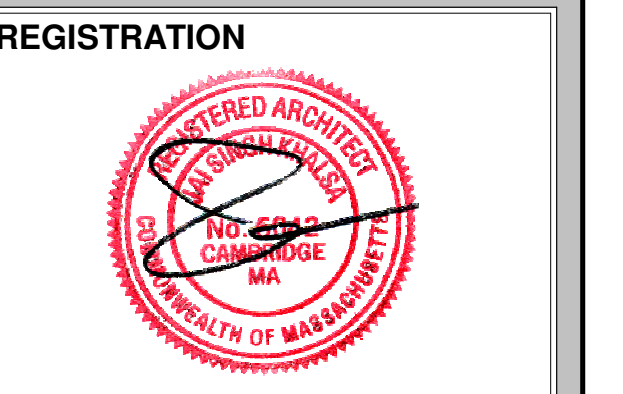

Project number 19029  
 Date 07/29/2019  
 Drawn by WC  
 Checked by JSK  
 Scale 1/8" = 1'-0"

REVISIONS

No.	Description	Date

Exterior Elevations

**A-300**

YAMBA HARVEST



① Existing Mass Ave. Elevation  
 1/8" = 1'-0"

EXISTING STOREFRONT WILL BE UPDATED. THE SIZE OF THE OPENING SHALL REMAIN UNCHANGED. EXISTING SIGNAGE WILL BE REPLACED WITH NEW SIGNAGE SAME SIZE. NEW DOUBLE DOOR



③ Pearl Street Elevation  
 1/8" = 1'-0"



② Pearl Street looking towards Green St.



④ Pearl Street looking towards Mass Ave.

\\TKG-SERVER\Drawn\1919033\_580 Mass Ave Dispensary\bin\03 Drawings\00\_ARCH\_SD\_DD\580 Mass Ave Dispensary 8.14.19.dwg 8/20/2019 3:26:31 PM