

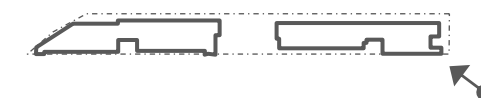

3.1 RENDERING VIEW FROM BRIGGS FIELD
MIT WEST CAMPUS GRADUATE DORMITORY PROJECT





3.2 RENDERING EAST BUILDING ENTRY COURT
MIT WEST CAMPUS GRADUATE DORMITORY PROJECT





3.3 RENDERING EAST BUILDING LOGGIA
MIT WEST CAMPUS GRADUATE DORMITORY PROJECT





3.4 RENDERING WEST BUILDING LOUNGE AT CENTRAL PLAZA
MIT WEST CAMPUS GRADUATE DORMITORY PROJECT

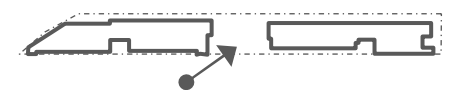



3.5 RENDERING VIEW FROM AUDREY STREET
MIT WEST CAMPUS GRADUATE DORMITORY PROJECT



17 DECEMBER 2020 | © KIERANTIMBERLAKE



3.6 RENDERING WEST BUILDING ENTRY COURT
MIT WEST CAMPUS GRADUATE DORMITORY PROJECT

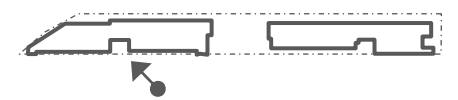



3.7 RENDERING VIEW FROM GRAND JUNCTION
MIT WEST CAMPUS GRADUATE DORMITORY PROJECT

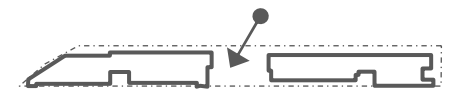



3.8 RENDERING VIEW FROM RAIL CROSSING
MIT WEST CAMPUS GRADUATE DORMITORY PROJECT





3.9 RENDERING CENTRAL PLAZA AERIAL
MIT WEST CAMPUS GRADUATE DORMITORY PROJECT





3.10 RENDERING CENTRAL PLAZA LOOKING NORTHWEST
MIT WEST CAMPUS GRADUATE DORMITORY PROJECT





EAST BUILDING - NORTH GARDENS



WEST BUILDING - NORTH GARDENS AMENITY TERRACE

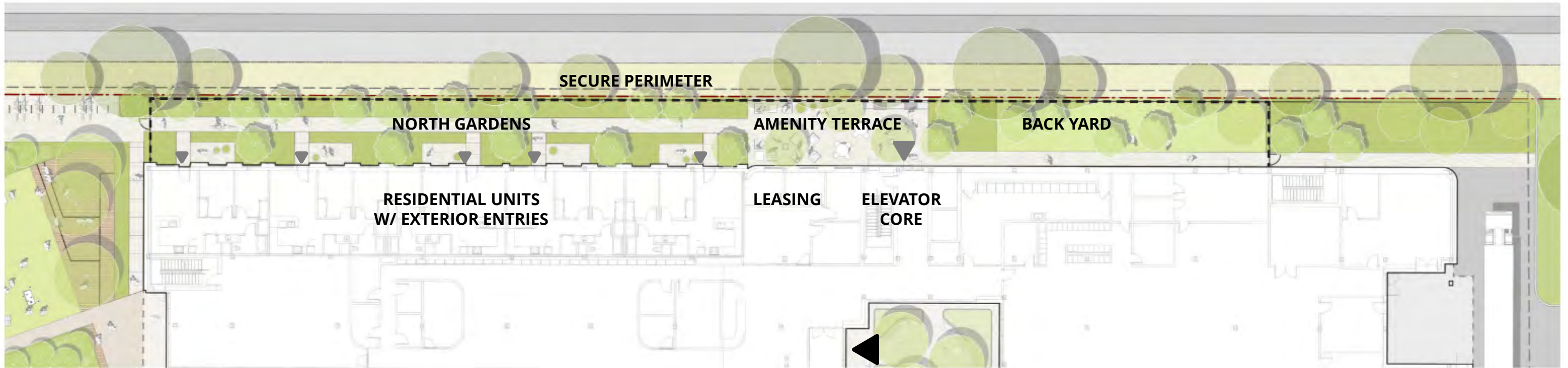

EAST BUILDING - NORTH GARDENS

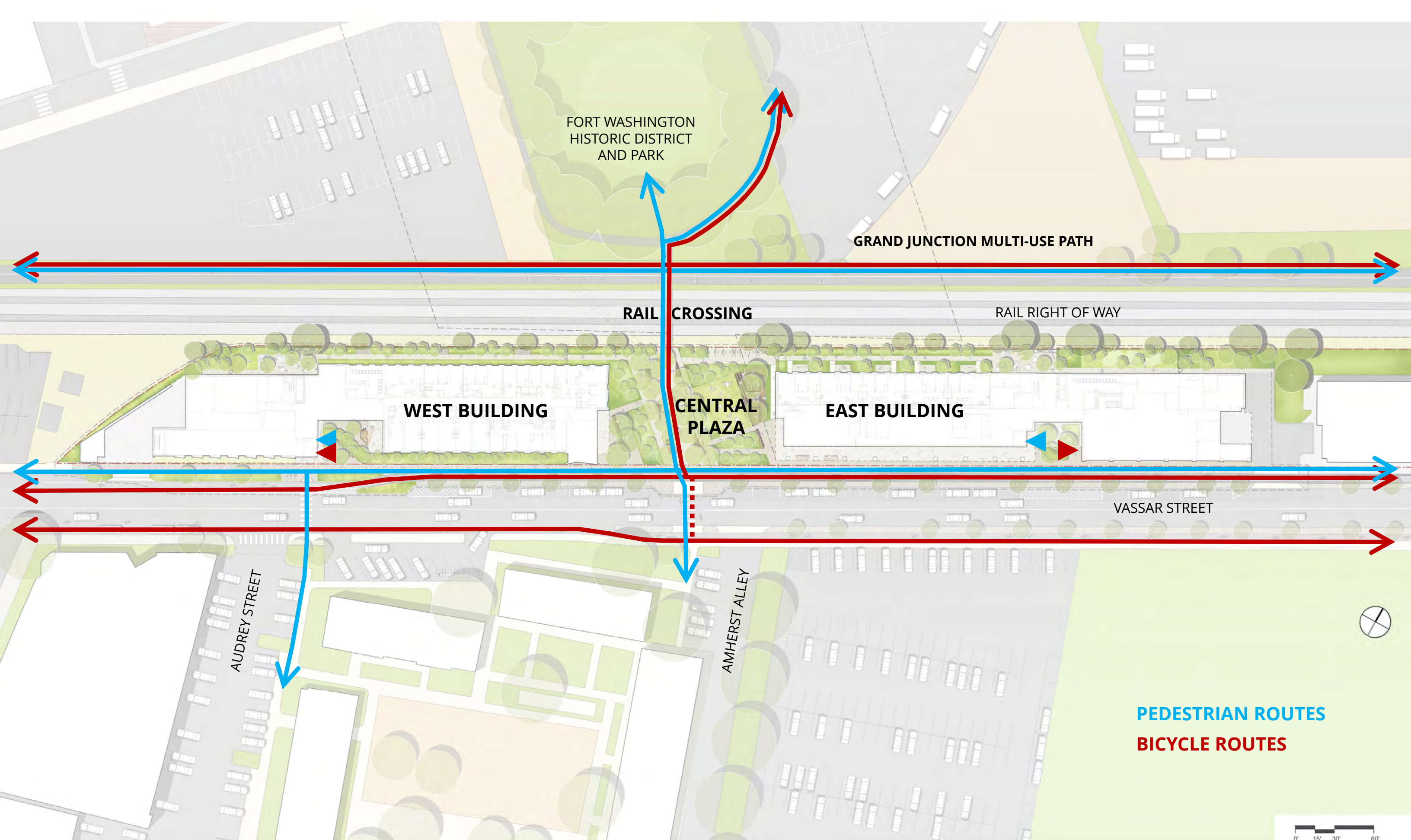

PEDESTRIAN ROUTES
BICYCLE ROUTES

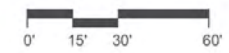

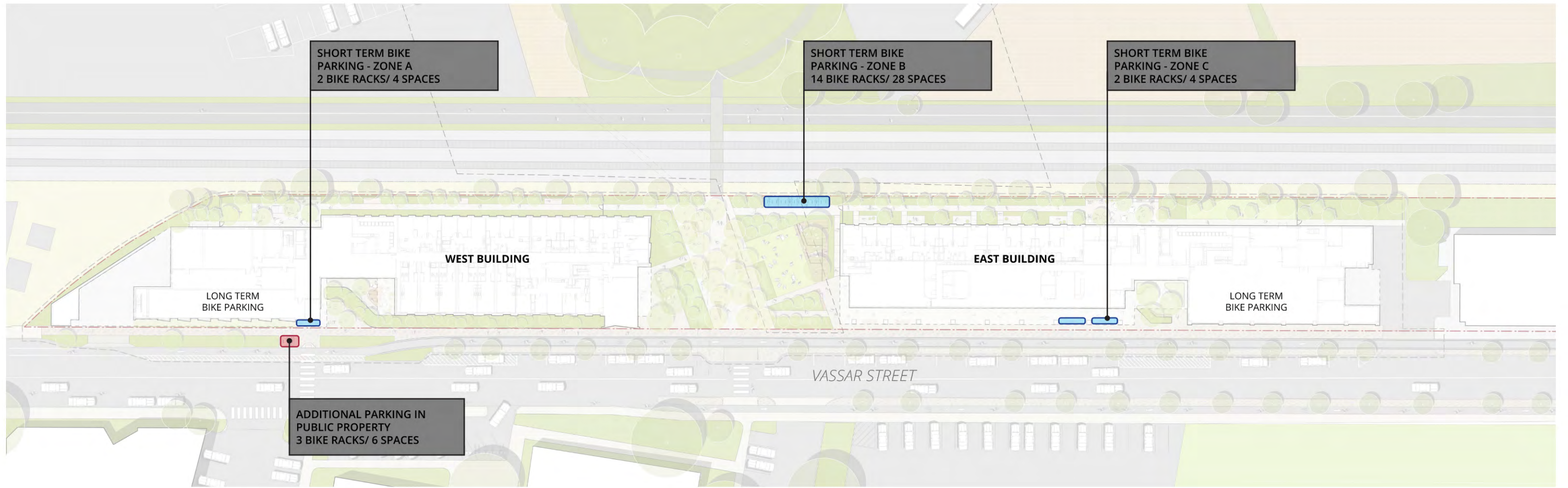

SHORT TERM BIKE PARKING A
2 BIKE RACKS/ 4 SPACES

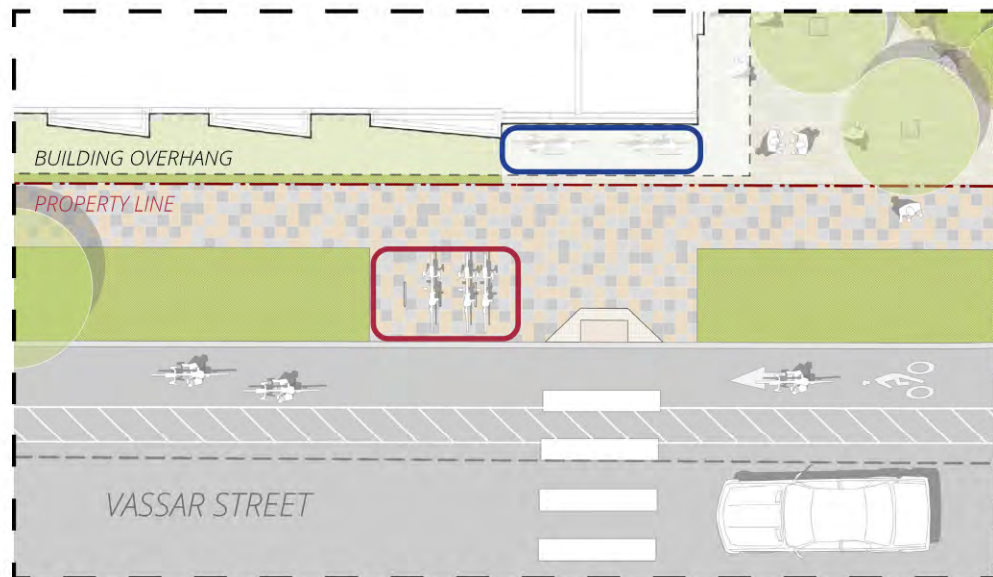

SHORT TERM BIKE PARKING B
14 BIKE RACKS/ 28 SPACES

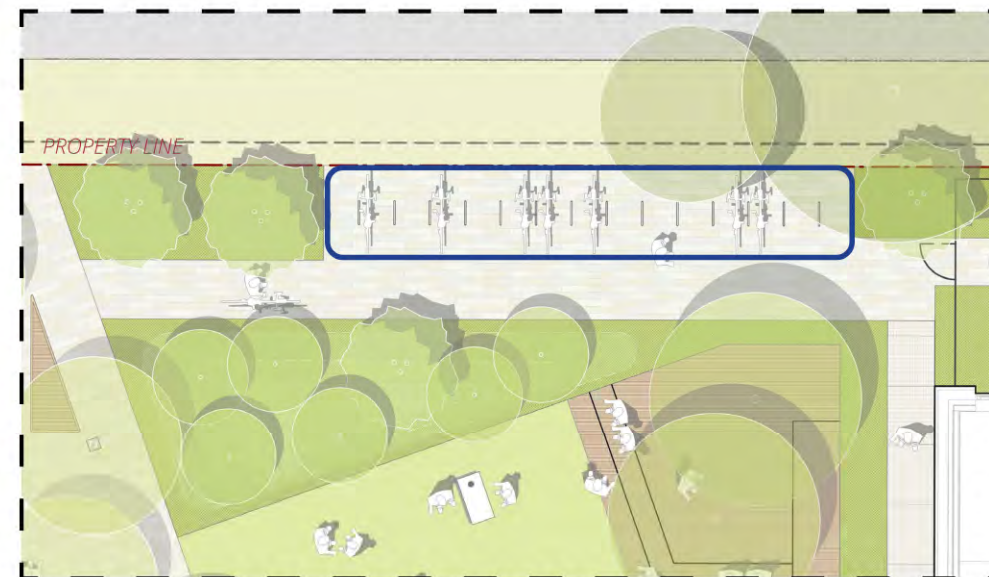

SHORT TERM BIKE PARKING C
2 BIKE RACKS/ 4 SPACES

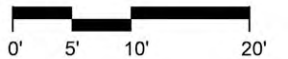
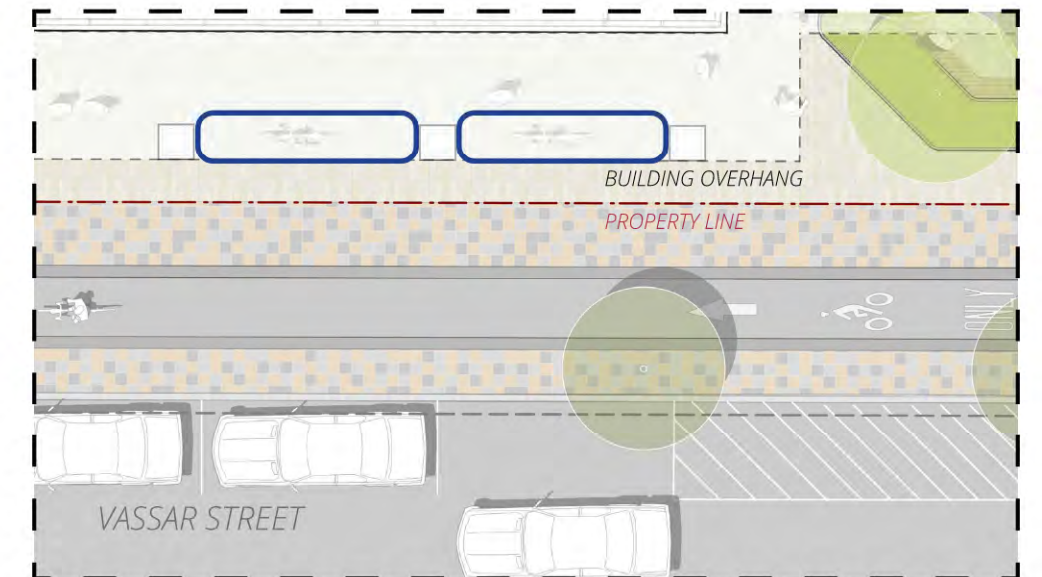

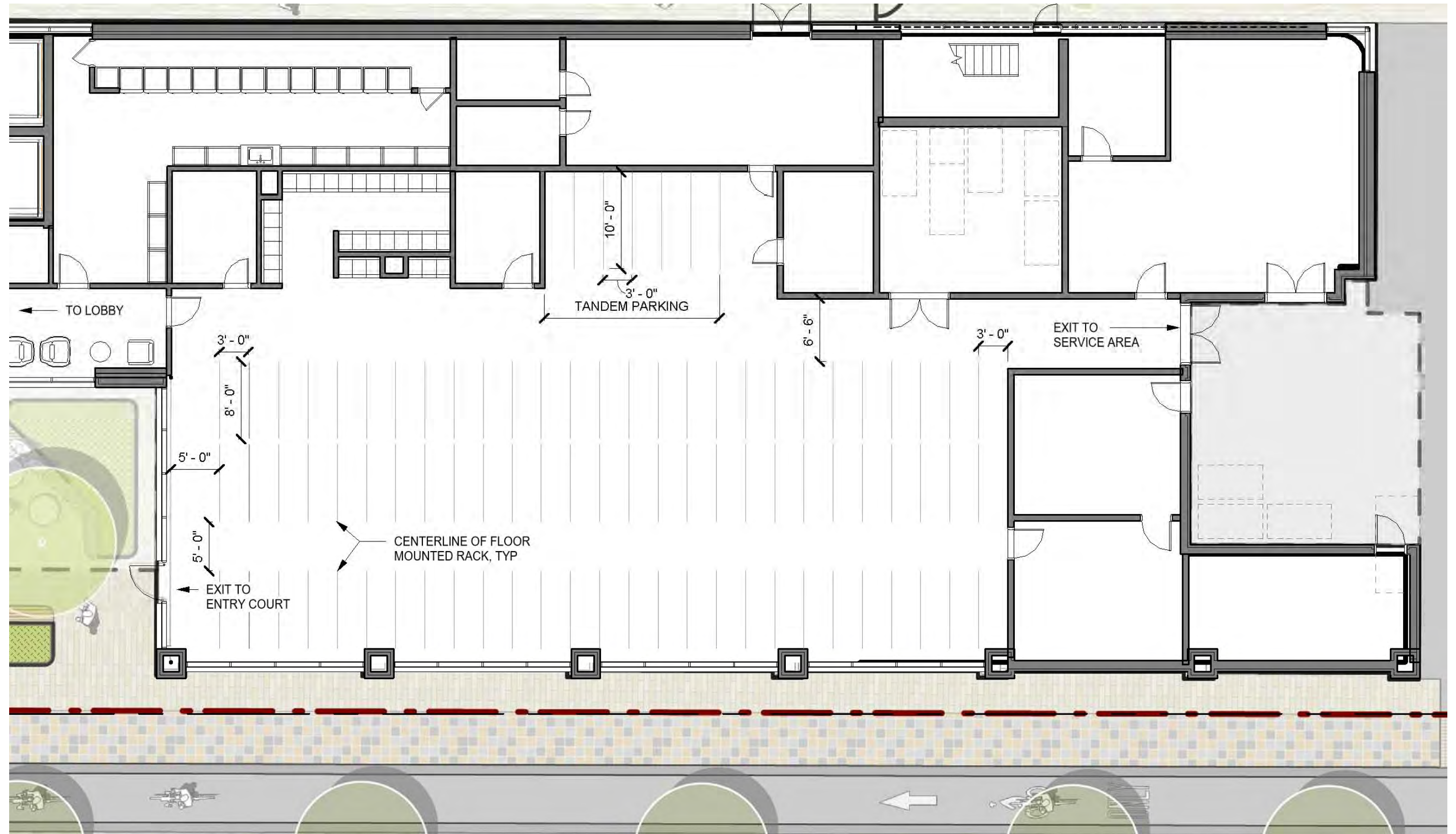

4.2E TRANSPORTATION EAST BUILDING LONG TERM BICYCLE PARKING
MIT WEST CAMPUS GRADUATE DORMITORY PROJECT

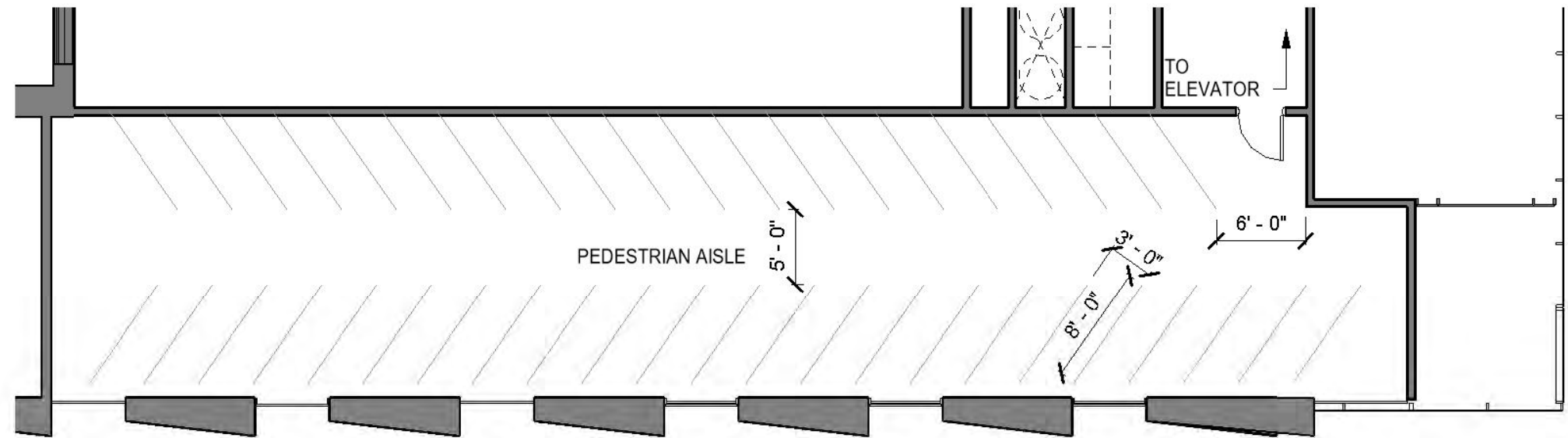

LONG TERM BICYCLE PARKING - LEVEL 2

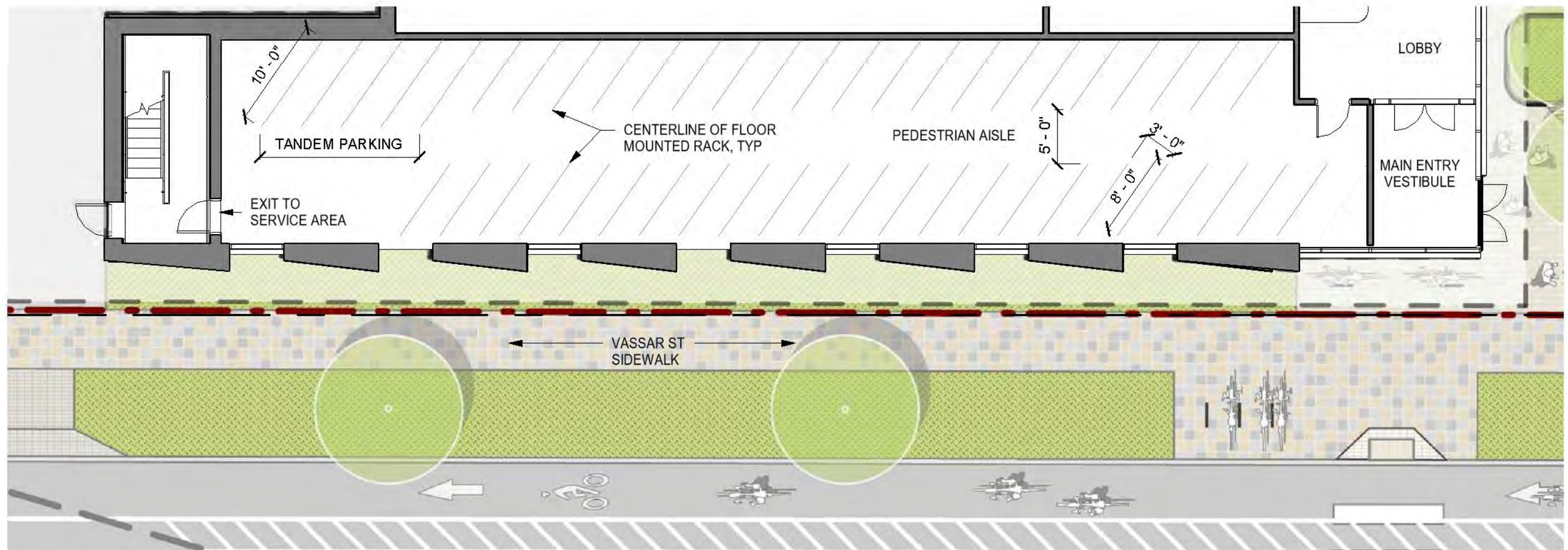

LONG TERM BICYCLE PARKING - LEVEL 1



EXISTING BIKE LANE

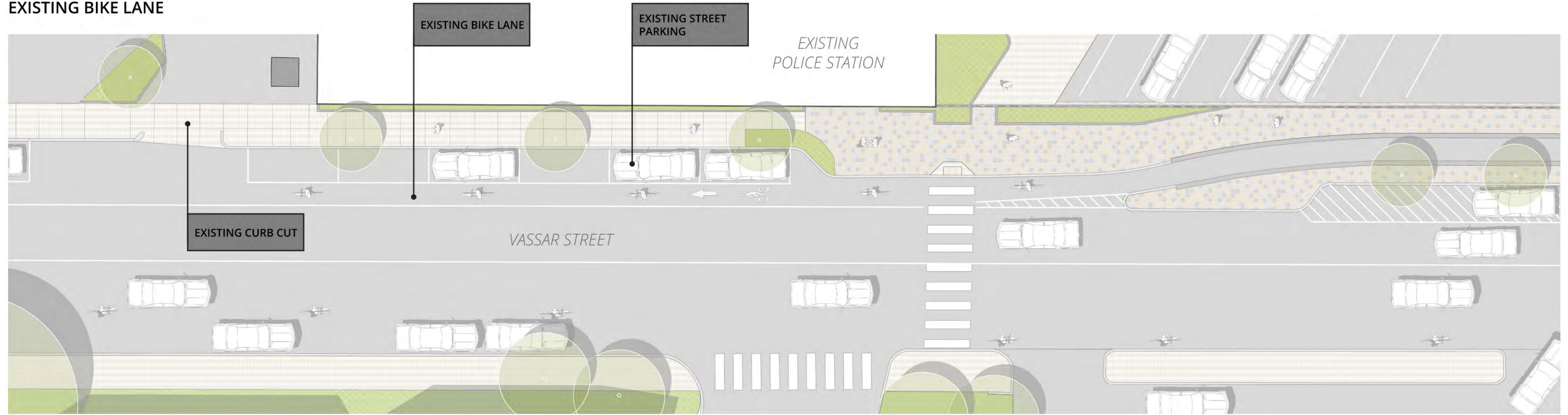

PROPOSED BIKE LANE

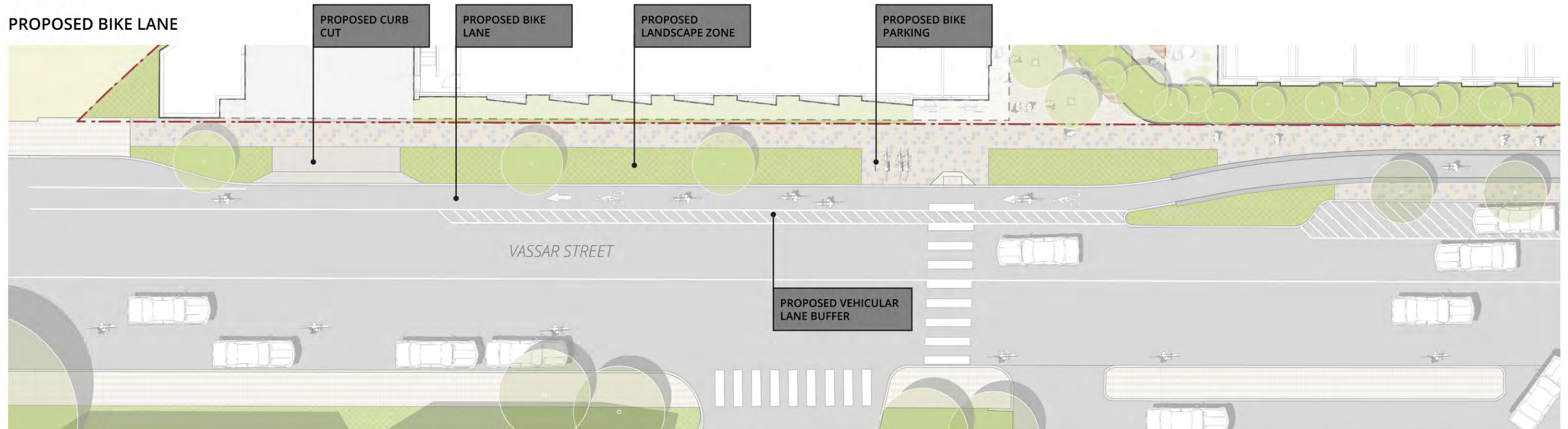



4.4 TRANSPORTATION LOADING AND SERVICE
 MIT WEST CAMPUS GRADUATE DORMITORY PROJECT

Appendix A.1



Summer Solstice

9 AM



12 PM



4 PM



Spring/Fall Equinox

9 AM



12 PM



4 PM



Winter Solstice

9 AM



12 PM



4 PM

Appendix A.2

TREE MITIGATION REPORT

TOTAL DBH OF SIGNIFICANT TREES: 374"

DBH to Mitigate: 374"

STREET TREES HIGHLIGHTED IN GRAY

DBH	Treelid	Tree_Code	Condition	Location_V	Location_T	Root_Inf	RCX	Defect_1	Defect_2	Defect_3	Defect_4	Defect_5	Defect_6	Work_Phase	Prune	Pruning_Goal	Removal	BTRA	Overall Tree Risk Rating	plantPartC	PrimTarg	SecondTarg	Likely_Fal	Likely_imp	Consequenc	Pest_Dis_1	Pest_Dis_2	
20.0	1051	PINI Pinus nigra	Poor	Good	Open	<25%	Wound-stem	Dead branches >2	1	Remove	Yes	Low	Branches	Sidewalk	Probable	Low	Mi....r	Borers	Diplodia tip b	
4.0	1052	SYRE Syringa reticulata	Poor	Poor	Street tree	>75%	Wound-stem	Fungl/conks	Wound-root flare	Co-dominant stems	Poor branch structure	Low vigor	1	Remove	Yes	Low	Stem	Sidewalk	Improbable	Low	Mi....r	
5.0	1053	SYRE Syringa reticulata	Poor	Poor	Street tree	>75%	Wound-stem	Buried root collar	Co-dominant stems	Poor branch structure	Dead branches <=2	Dieback (severe)	1	Remove	Yes	Low	Stem	Sidewalk	Possible	Low	Mi....r	
5.0	1054	SYRE Syringa reticulata	Poor	Poor	Street tree	>75%	Wound-root flare	Dead branches >2	Dieback (severe)	1	Remove	Yes	Low	Stem	Sidewalk	Possible	Low	Mi....r	
7.0	1055	ULS Ulmus sp	Good	Poor	Street tree	>75%	Yes	Buried root collar	
9.0	1056	ULS Ulmus sp	Good	Fair	Street tree	>75%	Wound-stem	Yes	Low	Branches	Sidewalk	Possible	Low	Mi....r	
7.0	1057	ULS Ulmus sp	Good	Fair	Street tree	>75%	Yes	Wound-stem	Uneven crown	Wound-branch	Yes	Low	Branches	Sidewalk	Possible	Low	Mi....r	
7.0	1058	ULS Ulmus sp	Fair	Fair	Street tree	>75%	Yes	Buried root collar	Dead branches <=2	Yes	Low	Branches	Sidewalk	Probable	Low	Mi....r	
7.0	1059	ULS Ulmus sp	Fair	Fair	Street tree	>75%	Yes	Buried root collar	Uneven crown	Dead branches <=2	Yes	Low	Branches	Sidewalk	Probable	Low	Mi....r	
7.0	1060	ULS Ulmus sp	Fair	Fair	Street tree	>75%	Wound-stem	Yes	Low	Branches	Sidewalk	Possible	Low	Mi....r	
8.0	1061	ULS Ulmus sp	Fair	Fair	Street tree	>75%	Yes	Wound-stem	Low vigor	Buried root collar	Yes	Low	Branches	Sidewalk	Probable	Low	Mi....r	
8.0	1062	ULS Ulmus sp	Good	Fair	Street tree	>75%	Yes	Buried root collar	Yes	Low	Roots	Sidewalk	Improbable	Low	Significant	
6.0	1063	ULS Ulmus sp	Poor	Fair	Open	>75%	Wound-stem	Buried root collar	Dead branches <=2	Dieback (moderate)	1	Remove	Yes	Low	Branches	Sidewalk	Probable	Low	Mi....r	
7.0	1064	ULS Ulmus sp	Poor	Fair	Street tree	>75%	Buried root collar	Dead branches <=2	Dieback (moderate)	1	Remove	Yes	Low	Branches	Sidewalk	Probable	Low	Mi....r	
7.0	1065	ULS Ulmus sp	Fair	Fair	Street tree	>75%	Yes	Buried root collar	Low vigor	Yes	Low	Branches	Sidewalk	Possible	Low	Mi....r	
8.0	1066	ULS Ulmus sp	Good	Fair	Street tree	>75%	Yes	Buried root collar	Yes	Low	Roots	Sidewalk	Improbable	Low	Significant	
7.0	1067	ULS Ulmus sp	Fair	Fair	Street tree	>75%	Yes	Buried root collar	Low vigor	Yes	Low	Branches	Sidewalk	Possible	Low	Mi....r	
7.0	1068	ULS Ulmus sp	Fair	Fair	Street tree	>75%	Yes	Buried root collar	Low vigor	Yes	Low	Roots	Sidewalk	Improbable	Low	Significant	
6.0	1069	ULS Ulmus sp	Fair	Fair	Foundation	>75%	Yes	Buried root collar	Low vigor	Yes	Low	Branches	Sidewalk	Possible	Low	Mi....r	
6.0	1070	ULS Ulmus sp	Good	Good	Open	<25%	Yes	Buried root collar	Yes	Low	Branches	Sidewalk	Possible	Low	Mi....r	
11.0	1071	FRPE Fraxinus pennsylvanica	Fair	Good	Median	25-50%	Co-dominant stems	Poor branch structure	Yes	Low	Branches	Parking	Possible	Low	Significant	
11.0	1072	FRPE Fraxinus pennsylvanica	Fair	Good	Median	<25%	Co-dominant stems	Poor branch structure	Dead branches <=2	Low vigor	1	Remove	Yes	Low	Branches	Sidewalk	Possible	Low	Significant	Emerald ash borer (suspected)	
11.0	1073	FRPE Fraxinus pennsylvanica	Poor	Good	Open	<25%	Co-dominant stems	Poor branch structure	Dead branches >2	Low vigor	1	Remove	Yes	Low	Branches	Sidewalk	Possible	Low	Significant	
13.0	1074	FRPE Fraxinus pennsylvanica	Good	Good	Open	<25%	Co-dominant stems	Poor branch structure	Yes	Low	Branches	Walking path	Sidewalk	Possible	Very low	Significant	
12.0	1075	FRPE Fraxinus pennsylvanica	Fair	Good	Open	<25%	Broken branch(s)	Co-dominant stems	Poor branch structure	1	Yes	Reduce risk of bran	Yes	Low	Branches	Parking	Imminent	Very low	Mi....r	
12.0	1076	FRPE Fraxinus pennsylvanica	Good	Good	Open	<25%	Co-dominant stems	Poor branch structure	Yes	Low	Branches	Parking	Possible	Low	Mi....r	
14.0	1077	FRPE Fraxinus pennsylvanica	Fair	Good	Open	<25%	Co-dominant stems	Poor branch structure	Dead branches >2	1	Remove	Yes	Low	Branches	Sidewalk	Probable	Low	Mi....r	Emerald ash borer (suspected)	
16.0	1078	FRPE Fraxinus pennsylvanica	Poor	Good	Median	25-50%	Dead branches >2	Dieback (moderate)	Co-dominant stems	Poor branch structure	1	Remove	Yes	Low	Branches	Parking	Probable	Medium	Mi....r	Emerald ash borer (suspected)	
14.0	1079	FRPE Fraxinus pennsylvanica	Poor	Good	Median	25-50%	Dead branches >2	Dieback (moderate)	Co-dominant stems	Poor branch structure	1	Remove	Yes	Low	Branches	Parking	Probable	Low	Mi....r	
14.0	1080	FRPE Fraxinus pennsylvanica	Poor	Good	Median	51-75%	Dead branches >2	Dieback (moderate)	Co-dominant stems	Poor branch structure	Dieback (moderate)	Remove	Yes	Low	Branches	Parking	Probable	Low	Mi....r	Emerald ash borer (suspected)
12.0	1081	FRPE Fraxinus pennsylvanica	Poor	Good	Median	51-75%	Dead branches >2	Dieback (moderate)	Remove	Yes	Low	Branches	Parking	Probable	Low	Mi....r	Emerald ash borer (suspected)
12.0	1082	FRPE Fraxinus pennsylvanica	Poor	Good	Median	>75%	Dead branches >2	Dieback (moderate)	Co-dominant stems	Poor branch structure	Remove	Yes	Low	Branches	Parking	Probable	Medium	Mi....r	Emerald ash borer (suspected)
13.0	1083	FRPE Fraxinus pennsylvanica	Poor	Poor	Median	>75%	Co-dominant stems	Poor branch structure	Included bark	Dead branches >2	Dieback (moderate)	1	Remove	Yes	Low	Branches	Parking	Probable	Medium	Mi....r	
13.0	1084	FRPE Fraxinus pennsylvanica	Poor	Poor	Median	>75%	Co-dominant stems	Poor branch structure	Included bark	Dead branches >2	Dieback (moderate)	1	Remove	Yes	Low	Branches	Parking	Probable	Medium	Mi....r	Emerald ash borer (suspected)	
12.0	1085	FRPE Fraxinus pennsylvanica	Poor	Good	Median	>75%	Co-dominant stems	Poor branch structure	Included bark	Dead branches >2	Dieback (moderate)	1	Remove	Yes	Low	Branches	Parking	Probable	Medium	Mi....r	Emerald ash borer (suspected)	
13.0	1086	FRPE Fraxinus pennsylvanica	Poor	Poor	Median	>75%	Dead branches >2	Dieback (moderate)	Co-dominant stems	Poor branch structure	Remove	Yes	Low	Branches	Parking	Probable	Low	Mi....r	Emerald ash borer (suspected)
16.0	1087	FRPE Fraxinus pennsylvanica	Fair	Poor	Median	>75%	Dead branches >2	Poor branch structure	Co-dominant stems	Low vigor	Remove	Yes	Low	Branches	Parking	Probable	Low	Mi....r	Emerald ash borer (suspected)
11.0	1088	FRPE Fraxinus pennsylvanica	Poor	Poor	Median	>75%	Dieback (moderate)	Dead branches >2	Co-dominant stems	Poor branch structure	Remove	Yes	Low	Branches	Parking	Probable	Medium	Mi....r	Emerald ash borer (suspected)
13.0	1089	FRPE Fraxinus pennsylvanica	Poor	Poor	Median	>75%	Dead branches >2	Dieback (moderate)	Co-dominant stems	Poor branch structure	Dieback (moderate)	Remove	Yes	Low	Branches	Parking	Probable	Medium	Mi....r
12.0	1090	FRPE Fraxinus pennsylvanica	Poor	Poor	Median	>75%	Dead branches >2	Dieback (moderate)	Poor branch structure	Co-dominant stems	Remove	Yes	Low	Branches	Parking	Walking path	Probable	Low	Mi....r	Emerald ash borer (suspected)
13.0	1091	FRPE Fraxinus pennsylvanica	Poor	Poor	Median	>75%	Co-dominant stems	Poor branch structure	Dead branches >2	Dieback (moderate)	Remove	Yes	Low	Branches	Parking	Probable	Low	Mi....r	Emerald ash borer (suspected)
14.0	1092	FRPE Fraxinus pennsylvanica	Poor	Poor	Median	>75%	Dead branches >2	Dieback (moderate)	Poor branch structure	Co-dominant stems	Remove	Yes	Low	Branches	Parking	Probable	Low	Mi....r	Emerald ash borer (suspected)
11.0	1093	FRPE Fraxinus pennsylvanica	Fair	Poor	Median	>75%	Co-dominant stems	Poor branch structure	Dead branches >2	Uneven crown	Remove	Yes	Low	Branches	Parking	Possible	Low	Mi....r	Emerald ash borer (suspected)
10.0	1094	FRPE Fraxinus pennsylvanica	Poor	Poor	Median	>75%	Co-dominant stems	Poor branch structure	Low vigor	Remove	Yes	Low	Branches	Parking	Probable	Low	Mi....r	Emerald ash borer (suspected)
11.0	1095	FRPE Fraxinus pennsylvanica	Poor	Poor	Median	>75%	Dead branches >2	Dieback (moderate)	Co-dominant stems	Poor branch structure	Remove	Yes	Low	Branches	Parking	Probable	Low	Mi....r	Emerald ash borer (suspected)
12.0	1096	FRPE Fraxinus pennsylvanica	Poor	Poor	Median	>75%	Co-dominant stems	Included bark	Poor branch structure	Dead branches >2	Dieback (moderate)	Remove	Yes	Low	Branches	Parking	Probable	Low	Mi....r	Emerald ash borer (suspected)
15.0	1097	FRPE Fraxinus pennsylvanica	Fair	Poor	Median	>75%	Co-dominant stems	Poor branch structure	Low vigor	Remove	Yes	Low	Branches	Parking	Probable	Low	Mi....r	Emerald ash borer (suspected)
12.0	1098	FRPE Fraxinus pennsylvanica	Poor	Poor	Median	>75%	Dead branches >2	Dieback (moderate)	Co-dominant stems	Poor branch structure	Remove	Yes	Low	Branches	Parking	Probable	Medium	Mi....r	Emerald ash borer (suspected)
12.0	1099	FRPE Fraxinus pennsylvanica	Poor	Poor	Median	>75%	Dead branches >2	Dieback (moderate)	Poor branch structure	Co-dominant stems	Remove	Yes	Low	Branches	Parking	Probable	Low	Mi....r	Emerald ash borer (suspected)
16.0	1100	FRPE Fraxinus pennsylvanica	Good	Fair	Median	51-75%																						

MIT GRADUATE HOUSING

Existing Tree Inventory

 EXISTING TREES TO BE REPLACED: SEE MITIGATION PLAN

 STREET TREE PLANTING IN R.O.W. ALONG VASSAR STREET: 19 TREES.
SPECIES: Ulmus (16), Syringa reticulata (3)

 *Fraxinus pennsylvanica*
GREEN ASH

 *Pinus resinosa*
RED PINE

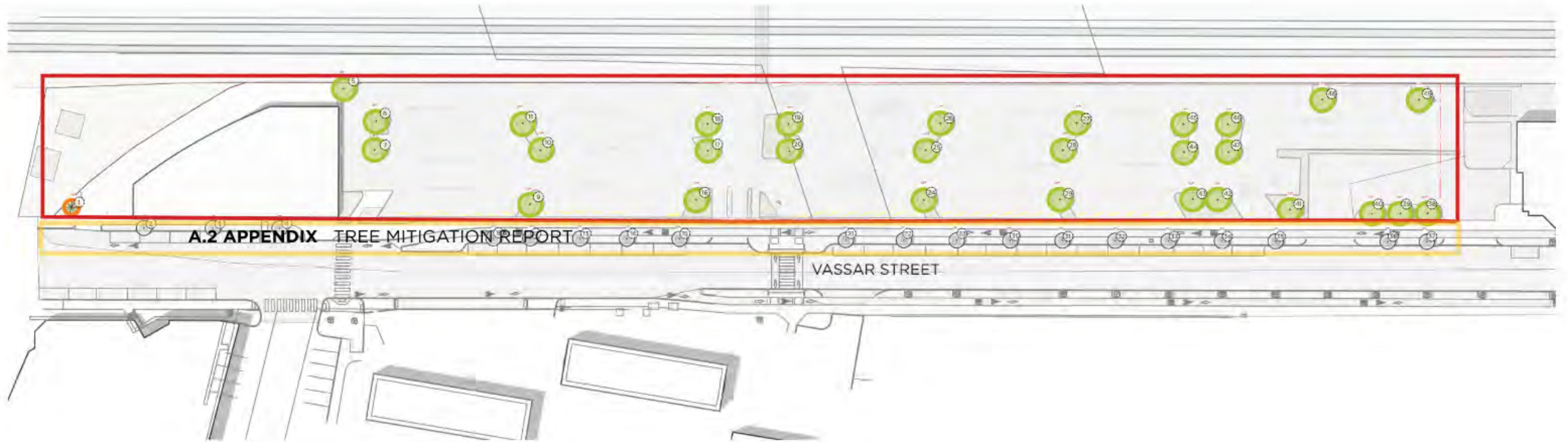

MIT GRADUATE HOUSING
Existing Tree Schedule

DBH	Tree Code	Tree Code	Condition	Location_V	Location_T	Root Inf	RCX	Defect_1	Defect_2	Defect_3	Defect_4	Defect_5	Defect_6	Work Phase	Prune	Pruning Goal	Removal	STRA	Overall Tree Risk Rating	PlantPart	ItemFarg	SecondFarg	Likely_Fal	Likely_Imp	Consequenc	Post_Db_1	
20.0	1051	PN1	Pinus nigra	Good	Open	<25%	---	Wound-stem	Dead branches >2	---	---	---	---	---	---	---	Remove	Yes	Low	Branches	Sidewalk	---	Probable	Low	ML...	Bowers	
4.0	1052	FR1	Fraxinus pennsylvanica	Poor	Street tree	>75%	---	Wound-stem	Hung/corals	Wound root flare	Co-dominant stems	Poor branch structure	Low vigor	---	---	---	Remove	Yes	Low	Stem	Sidewalk	---	Impossible	Low	ML...	---	
5.0	1053	FR1	Fraxinus pennsylvanica	Poor	Street tree	>75%	---	Wound-stem	Barred root collar	Co-dominant stems	Poor branch structure	Dead branches <=2	Dieback (severe)	---	---	---	Remove	Yes	Low	Stem	Sidewalk	---	Probable	Low	ML...	---	
5.0	1054	FR1	Fraxinus pennsylvanica	Poor	Street tree	>75%	---	Wound-stem	Dead branches >2	Dieback (severe)	---	---	---	---	---	---	Remove	Yes	Low	Stem	Sidewalk	---	Probable	Low	ML...	---	
7.0	1055	UL1	Ulmus sp	Good	Street tree	>75%	Yes	Barred root collar	---	---	---	---	---	---	---	---	---	Low	---	---	---	---	---	---	---	---	
9.0	1056	UL1	Ulmus sp	Good	Street tree	>75%	---	Wound-stem	---	---	---	---	---	---	---	---	---	Yes	Low	Branches	Sidewalk	---	Probable	Low	ML...	---	
7.0	1057	UL1	Ulmus sp	Good	Street tree	>75%	Yes	Wound-stem	Uneven crown	Wound branch	---	---	---	---	---	---	---	Yes	Low	Branches	Sidewalk	---	Probable	Low	ML...	---	
7.0	1058	UL1	Ulmus sp	Fair	Street tree	>75%	Yes	Barred root collar	Dead branches <=2	---	---	---	---	---	---	---	---	Yes	Low	Branches	Sidewalk	---	Probable	Low	ML...	---	
7.0	1059	UL1	Ulmus sp	Fair	Street tree	>75%	Yes	Barred root collar	Uneven crown	Dead branches <=2	---	---	---	---	---	---	---	Yes	Low	Branches	Sidewalk	---	Probable	Low	ML...	---	
7.0	1060	UL1	Ulmus sp	Fair	Street tree	>75%	---	Wound-stem	---	---	---	---	---	---	---	---	---	Yes	Low	Branches	Sidewalk	---	Probable	Low	ML...	---	
8.0	1061	UL1	Ulmus sp	Fair	Street tree	>75%	Yes	Wound-stem	Low vigor	Barred root collar	---	---	---	---	---	---	---	Yes	Low	Branches	Sidewalk	---	Probable	Low	ML...	---	
8.0	1062	UL1	Ulmus sp	Good	Street tree	>75%	Yes	Barred root collar	---	---	---	---	---	---	---	---	---	Yes	Low	Roots	Sidewalk	---	Impossible	Low	Significant	---	
6.0	1063	UL1	Ulmus sp	Poor	Open	>75%	---	Barred root collar	Barred root collar	Dead branches <=2	Dieback (moderate)	---	---	---	---	---	Remove	Yes	Low	Branches	Sidewalk	---	Probable	Low	ML...	---	
7.0	1064	UL1	Ulmus sp	Poor	Street tree	>75%	---	Barred root collar	Dead branches <=2	Dieback (moderate)	---	---	---	---	---	---	Remove	Yes	Low	Branches	Sidewalk	---	Probable	Low	ML...	---	
7.0	1065	UL1	Ulmus sp	Fair	Street tree	>75%	Yes	Barred root collar	Low vigor	---	---	---	---	---	---	---	---	Yes	Low	Branches	Sidewalk	---	Probable	Low	ML...	---	
8.0	1066	UL1	Ulmus sp	Good	Street tree	>75%	---	Barred root collar	---	---	---	---	---	---	---	---	---	Yes	Low	Roots	Sidewalk	---	Impossible	Low	Significant	---	
7.0	1067	UL1	Ulmus sp	Fair	Street tree	>75%	Yes	Barred root collar	Low vigor	---	---	---	---	---	---	---	---	Yes	Low	Branches	Sidewalk	---	Probable	Low	ML...	---	
7.0	1068	UL1	Ulmus sp	Fair	Street tree	>75%	Yes	Barred root collar	Low vigor	---	---	---	---	---	---	---	---	Yes	Low	Roots	Sidewalk	---	Impossible	Low	Significant	---	
6.0	1069	UL1	Ulmus sp	Fair	Foundation	>75%	Yes	Barred root collar	Low vigor	---	---	---	---	---	---	---	---	Yes	Low	Branches	Sidewalk	---	Probable	Low	ML...	---	
6.0	1070	UL1	Ulmus sp	Good	Open	<25%	Yes	Barred root collar	---	---	---	---	---	---	---	---	---	Yes	Low	Branches	Sidewalk	---	Probable	Low	ML...	---	
11.0	1071	FR1	Fraxinus pennsylvanica	Fair	Good	Median	25-50%	---	Co-dominant stems	Poor branch structure	---	---	---	---	---	---	---	Yes	Low	Branches	Parking	---	Probable	Low	Significant	---	
11.0	1072	FR1	Fraxinus pennsylvanica	Fair	Good	Median	<25%	---	Co-dominant stems	Poor branch structure	Dead branches <=2	Low vigor	---	---	---	---	---	Remove	Yes	Low	Branches	Sidewalk	---	Probable	Low	Significant	Emerald ash borer (suspected)
11.0	1073	FR1	Fraxinus pennsylvanica	Poor	Good	Open	<25%	---	Co-dominant stems	Poor branch structure	Dead branches >2	Low vigor	---	---	---	---	---	Remove	Yes	Low	Branches	Sidewalk	---	Probable	Low	Significant	---
13.0	1074	FR1	Fraxinus pennsylvanica	Good	Good	Open	<25%	---	Co-dominant stems	Poor branch structure	---	---	---	---	---	---	---	Yes	Low	Branches	Walking path	Sidewalk	---	Probable	Very low	Significant	---
12.0	1075	FR1	Fraxinus pennsylvanica	Fair	Good	Open	<25%	---	Broken branch(s)	Co-dominant stems	Poor branch structure	---	---	---	---	---	---	Yes	Low	Branches	Parking	---	Imminent	Very low	ML...	---	
12.0	1076	FR1	Fraxinus pennsylvanica	Good	Good	Open	<25%	---	Co-dominant stems	Poor branch structure	---	---	---	---	---	---	---	Yes	Low	Branches	Parking	---	Probable	Low	ML...	---	
14.0	1077	FR1	Fraxinus pennsylvanica	Fair	Good	Open	<25%	---	Co-dominant stems	Poor branch structure	Dead branches >2	---	---	---	---	---	---	Remove	Yes	Low	Branches	Sidewalk	---	Probable	Low	ML...	---
16.0	1078	FR1	Fraxinus pennsylvanica	Poor	Good	Median	25-50%	---	Co-dominant stems	Poor branch structure	Dead branches >2	Dieback (moderate)	Co-dominant stems	Poor branch structure	---	---	---	Remove	Yes	Low	Branches	Parking	---	Probable	Low	ML...	Emerald ash borer (suspected)
14.0	1079	FR1	Fraxinus pennsylvanica	Poor	Good	Median	25-50%	---	Dead branches >2	Dieback (moderate)	Co-dominant stems	Poor branch structure	---	---	---	---	---	Remove	Yes	Low	Branches	Parking	---	Probable	Low	ML...	Emerald ash borer (suspected)
14.0	1080	FR1	Fraxinus pennsylvanica	Poor	Good	Median	51-75%	---	Dead branches >2	Dieback (moderate)	Co-dominant stems	Poor branch structure	---	---	---	---	---	Remove	Yes	Low	Branches	Parking	---	Probable	Low	ML...	Emerald ash borer (suspected)
12.0	1081	FR1	Fraxinus pennsylvanica	Poor	Good	Median	51-75%	---	Dead branches >2	Dieback (moderate)	---	---	---	---	---	---	---	Remove	Yes	Low	Branches	Parking	---	Probable	Low	ML...	Emerald ash borer (suspected)
12.0	1082	FR1	Fraxinus pennsylvanica	Poor	Good	Median	>75%	---	Dead branches >2	Dieback (moderate)	Co-dominant stems	Poor branch structure	---	---	---	---	---	Remove	Yes	Low	Branches	Parking	---	Probable	Low	ML...	Emerald ash borer (suspected)
13.0	1083	FR1	Fraxinus pennsylvanica	Poor	Poor	Median	>75%	---	Co-dominant stems	Poor branch structure	Included bark	Dead branches >2	Dieback (moderate)	---	---	---	---	Remove	Yes	Low	Branches	Parking	---	Probable	Medium	ML...	Emerald ash borer (suspected)
13.0	1084	FR1	Fraxinus pennsylvanica	Poor	Poor	Median	>75%	---	Co-dominant stems	Poor branch structure	Included bark	Dead branches >2	Dieback (moderate)	---	---	---	---	Remove	Yes	Low	Branches	Parking	---	Probable	Medium	ML...	Emerald ash borer (suspected)
12.0	1085	FR1	Fraxinus pennsylvanica	Poor	Good	Median	>75%	---	Co-dominant stems	Poor branch structure	Included bark	Dead branches >2	Dieback (moderate)	---	---	---	---	Remove	Yes	Low	Branches	Parking	---	Probable	Medium	ML...	Emerald ash borer (suspected)
13.0	1086	FR1	Fraxinus pennsylvanica	Poor	Poor	Median	>75%	---	Co-dominant stems	Poor branch structure	Included bark	Dead branches >2	Dieback (moderate)	---	---	---	---	Remove	Yes	Low	Branches	Parking	---	Probable	Low	ML...	Emerald ash borer (suspected)
16.0	1087	FR1	Fraxinus pennsylvanica	Fair	Poor	Median	>75%	---	Dead branches >2	Poor branch structure	Co-dominant stems	Poor branch structure	Low vigor	---	---	---	---	Remove	Yes	Low	Branches	Parking	---	Probable	Low	ML...	Emerald ash borer (suspected)
11.0	1088	FR1	Fraxinus pennsylvanica	Poor	Poor	Median	>75%	---	Dieback (moderate)	Co-dominant stems	Poor branch structure	Dead branches >2	Dieback (moderate)	---	---	---	---	Remove	Yes	Low	Branches	Parking	---	Probable	Medium	ML...	Emerald ash borer (suspected)
13.0	1089	FR1	Fraxinus pennsylvanica	Poor	Poor	Median	>75%	---	Dead branches >2	Co-dominant stems	Poor branch structure	Dieback (moderate)	---	---	---	---	---	Remove	Yes	Low	Branches	Parking	---	Probable	Low	ML...	Emerald ash borer (suspected)
12.0	1090	FR1	Fraxinus pennsylvanica	Poor	Poor	Median	>75%	---	Dead branches >2	Co-dominant stems	Poor branch structure	Dieback (moderate)	---	---	---	---	---	Remove	Yes	Low	Branches	Parking	Walking path	Probable	Low	ML...	Emerald ash borer (suspected)
13.0	1091	FR1	Fraxinus pennsylvanica	Poor	Poor	Median	>75%	---	Co-dominant stems	Poor branch structure	Dead branches >2	Dieback (moderate)	---	---	---	---	---	Remove	Yes	Low	Branches	Parking	---	Probable	Low	ML...	Emerald ash borer (suspected)
14.0	1092	FR1	Fraxinus pennsylvanica	Poor	Poor	Median	>75%	---	Dead branches >2	Dieback (moderate)	Poor branch structure	Co-dominant stems	Uneven crown	---	---	---	---	Remove	Yes	Low	Branches	Parking	---	Probable	Low	ML...	Emerald ash borer (suspected)
11.0	1093	FR1	Fraxinus pennsylvanica	Fair	Poor	Median	>75%	---	Co-dominant stems	Poor branch structure	Dead branches >2	---	---	---	---	---	---	Remove	Yes	Low	Branches	Parking	---	Probable	Low	ML...	Emerald ash borer (suspected)
10.0	1094	FR1	Fraxinus pennsylvanica	Poor	Poor	Median	>75%	---	Co-dominant stems	Poor branch structure	Low vigor	---	---	---	---	---	---	Remove	Yes	Low	Branches	Parking	---	Probable	Low	ML...	Emerald ash borer (suspected)
11.0	1095	FR1	Fraxinus pennsylvanica	Poor	Poor	Median	>75%	---	Dead branches >2	Dieback (moderate)	Co-dominant stems	Poor branch structure	---	---	---	---	---	Remove	Yes	Low	Branches	Parking	---	Probable	Low	ML...	Emerald ash borer (suspected)
12.0	1096	FR1	Fraxinus pennsylvanica	Poor	Poor	Median	>75%	---	Co-dominant stems	Poor branch structure	Included bark	Dead branches >2	Dieback (moderate)	---	---	---	---	Remove	Yes	Low	Branches	Parking	---	Probable	Low	ML...	Emerald ash borer (suspected)
15.0	1097	FR1	Fraxinus pennsylvanica	Fair	Poor	Median	>75%	---	Co-dominant stems	Poor branch structure	Low vigor	---	---	---	---	---	---	Remove	Yes	Low	Branches	Parking	---	Probable	Low	ML...	Emerald ash borer (suspected)
12.0	1098	FR1	Fraxinus pennsylvanica	Poor	Poor	Median	>75%	---	Dead branches >2	Dieback (moderate)	Co-dominant stems	Poor branch structure	---	---	---	---	---	Remove	Yes	Low	Branches	Parking	---	Probable	Medium	ML...	Emerald ash borer (suspected)
12.0	1099	FR1	Fraxinus pennsylvanica	Poor	Poor	Median	>75%	---	Dead branches >2	Dieback (moderate)	Co-dominant stems	Poor branch structure	---	---	---	---	---	Remove	Yes	Low	Branches	Parking	---	Probable	Low	ML...	Emerald ash borer (suspected)
16.0	1100	FR1	Fraxinus pennsylvanica	Good	Fair	Median	51-75%	---	Co-dominant stems	Poor branch structure	Co-dominant stems	---	---	---	---	---	---	Remove	Yes	Low	Branches	Building	---	Probable	Low	Negligible	Emerald ash borer (suspected)

TOTAL DBH OF SIGNIFICANT TREES: 374"
TOTAL DBH OF TREES SAVED: 0"
DBH to Mitigate: 374"

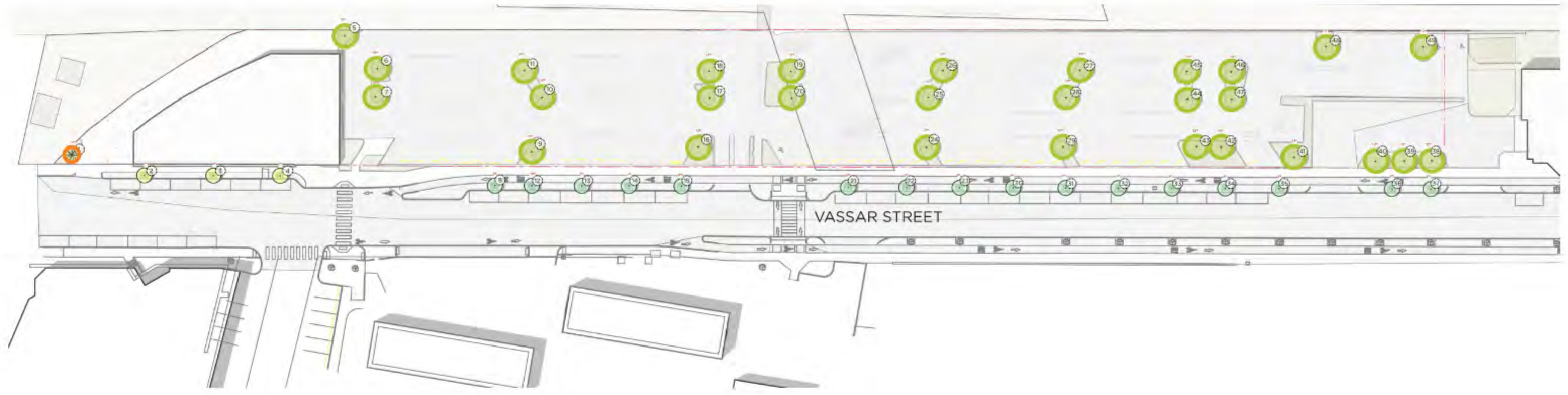
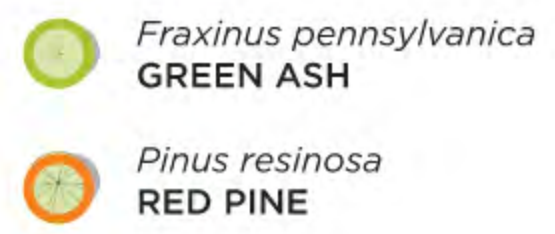

STREET TREES HIGHLIGHTED IN GRAY



MIT GRADUATE HOUSING

Proposed Tree Selection

SYMBOL	QTY	DBH	TOTAL DBH	Sample Species
	20	2"	40"	<i>Betula populifolia</i> - GRAY BIRCH <i>Cercis canadensis f. alba 'Royal White'</i> - WHITE REDBUD <i>Amelanchier canadensis</i> - SERVICEBERRY <i>Hamamelis virginiana</i> - WITCH HAZEL
	6	2"	12"	<i>Quercus muehlenbergii</i> - CHINKAPIN OAK <i>Acer rubrum</i> - RED MAPLE <i>Quercus coccinea</i> - SCARLET OAK
	6	4"	24"	<i>Platanus x acerifolia 'Bloodgood'</i> - LONDON PLANETREE <i>Acer x freemanii</i> - FREEMAN MAPLE <i>Tilia tomentosa</i> - SILVER LINDEN

SYMBOL	QTY	DBH	TOTAL DBH	Sample Species
	34	4"	136"	<i>Gleditsia triacanthos var. inermis</i> - HONEY LOCUST <i>Ginkgo biloba 'Princeton Sentry'</i> - SENTRY GINKGO <i>Liriodendron tulipifera</i> - TULIP POPLAR
	23	2"	46"	<i>Amelanchier canadensis</i> - SERVICEBERRY <i>Hamamelis virginiana</i> - WITCH HAZEL <i>Chionanthus virginicus</i> - FRINGETREE <i>Carpinus caroliniana</i> - AMERICAN HOPHORNBEAM
	50	2"	100"	<i>Hamamelis virginiana</i> - WITCH HAZEL <i>Cornus mas</i> - CORNELIAN CHERRY DOGWOOD <i>Amelanchier canadensis</i> - SERVICEBERRY <i>Ostrya virginiana</i> - EASTERN HOP HORNBEAM

TOTAL DBH OF SIGNIFICANT TREES: 374"
 TOTAL DBH OF TREES SAVED: 0"
DBH to Mitigate: 374"

DBH OF TREES REPLACED:
 40 TREES @ 4" = 160"
 102 TREES @ 2" = 198"

TOTAL REPLACED DBH = 358"

Remaining 16" DBH to be mitigated through payment into the Tree Replacement Fund.

Cost Assumptions:
 Tree: \$3,000 x 4 = \$12,000
 5 Yrs Maintenance: \$1,200 x 4 = \$4,800
 Total = \$16,800

Projected 16" DBH, 4 trees at 4" + 5 years maintenance = \$16,800 (est.)



Appendix A.3

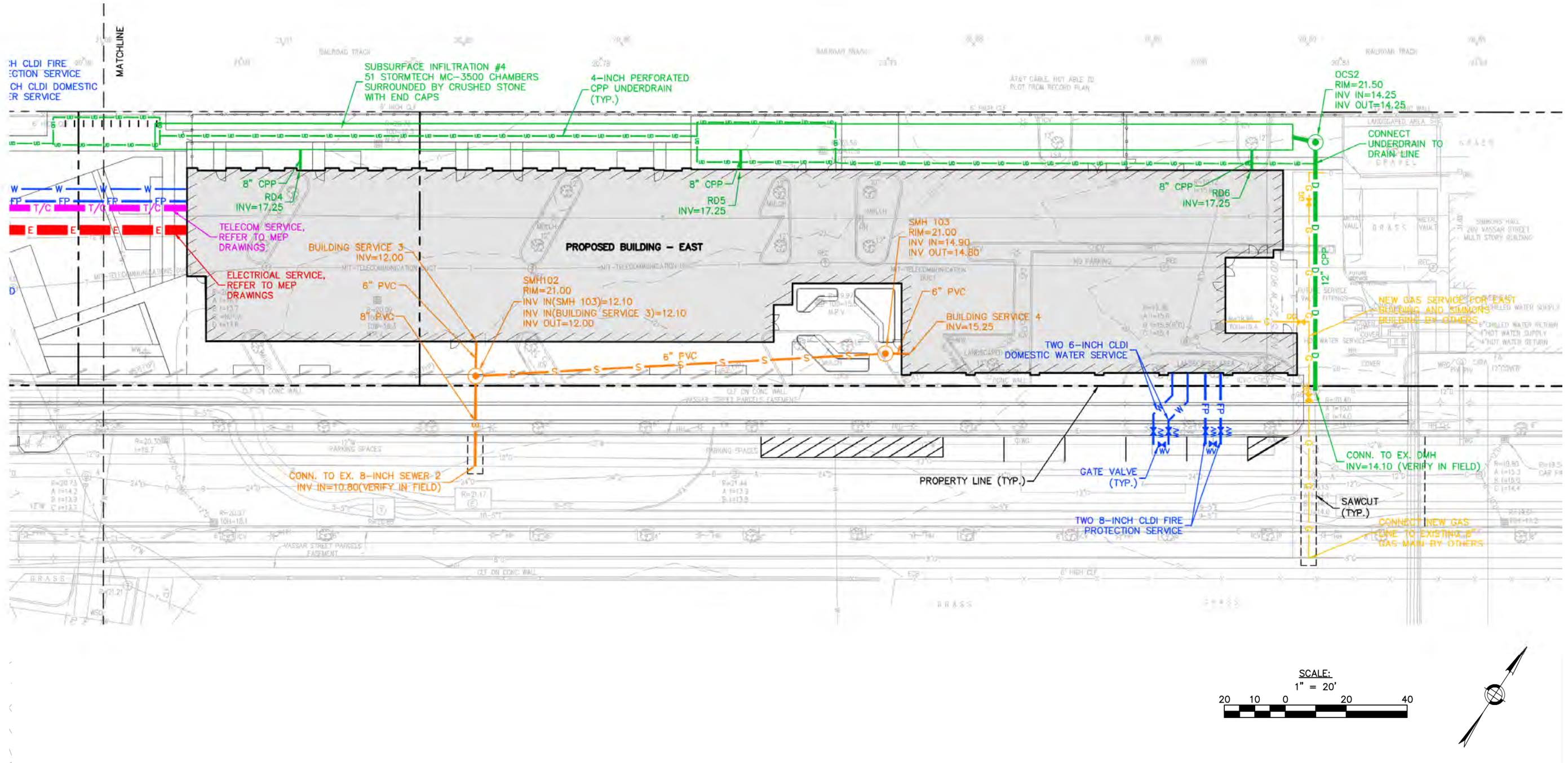

A.3 APPENDIX PROPOSED UTILITY INFRASTRUCTURE - EAST BUILDING

MIT WEST CAMPUS GRADUATE DORMITORY PROJECT

