

# CITY OF CAMBRIDGE

## GARDEN STREET CORRIDOR PROJECT

### FROM HURON AVENUE TO MASON STREET

#### SEPARATED BIKE LANES

### INDEX

DWG NO.	SHEET NO.	PLAN TITLE	PLAN TYPE
G-01	1	TITLE SHEET	GENERAL
G-02	2	GENERAL NOTES AND LEGEND	GENERAL
G-03	3	CONSTRUCTION DETAILS, SHEET 1 OF 3	DETAILS
G-04	4	CONSTRUCTION DETAILS, SHEET 2 OF 3	DETAILS
G-05	5	CONSTRUCTION DETAILS, SHEET 3 OF 3	DETAILS
E-01	6	ERADICATION PLAN, SHEET 1 OF 6	ERADICATION
E-02	7	ERADICATION PLAN, SHEET 2 OF 6	ERADICATION
E-03	8	ERADICATION PLAN, SHEET 3 OF 6	ERADICATION
E-04	9	ERADICATION PLAN, SHEET 4 OF 6	ERADICATION
E-05	10	ERADICATION PLAN, SHEET 5 OF 6	ERADICATION
E-06	11	ERADICATION PLAN, SHEET 6 OF 6	ERADICATION
PM-01	12	PAVEMENT MARKING PLAN, SHEET 1 OF 6	PAVEMENT MARKING
PM-02	13	PAVEMENT MARKING PLAN, SHEET 2 OF 6	PAVEMENT MARKING
PM-03	14	PAVEMENT MARKING PLAN, SHEET 3 OF 6	PAVEMENT MARKING
PM-04	15	PAVEMENT MARKING PLAN, SHEET 4 OF 6	PAVEMENT MARKING
PM-05	16	PAVEMENT MARKING PLAN, SHEET 5 OF 6	PAVEMENT MARKING
PM-06	17	PAVEMENT MARKING PLAN, SHEET 6 OF 6	PAVEMENT MARKING
FP-01	18	FLEXPOST PLAN, SHEET 1 OF 6	FLEXPOST
FP-02	19	FLEXPOST PLAN, SHEET 2 OF 6	FLEXPOST
FP-03	20	FLEXPOST PLAN, SHEET 3 OF 6	FLEXPOST
FP-04	21	FLEXPOST PLAN, SHEET 4 OF 6	FLEXPOST
FP-05	22	FLEXPOST PLAN, SHEET 5 OF 6	FLEXPOST
FP-06	23	FLEXPOST PLAN, SHEET 6 OF 6	FLEXPOST
S-01	24	SIGNAGE PLAN, SHEET 1 OF 6	SIGNAGE
S-02	25	SIGNAGE PLAN, SHEET 2 OF 6	SIGNAGE
S-03	26	SIGNAGE PLAN, SHEET 3 OF 6	SIGNAGE
S-04	27	SIGNAGE PLAN, SHEET 4 OF 6	SIGNAGE
S-05	28	SIGNAGE PLAN, SHEET 5 OF 6	SIGNAGE
S-06	29	SIGNAGE PLAN, SHEET 6 OF 6	SIGNAGE
SS-01	30	SIGN SUMMARY	SIGN SUMMARY



**LOCUS PLAN**  
NOT TO SCALE

ALL WORK SHALL CONFORM TO THESE PLANS, THE MASSACHUSETTS DEPARTMENT OF TRANSPORTATION STANDARD SPECIFICATIONS FOR HIGHWAYS AND BRIDGES DATED 1988, THE SUPPLEMENTAL SPECIFICATIONS DATED JUNE 15, 2012, THE 2016 CONSTRUCTION STANDARD DETAILS, THE 1968 STANDARD DRAWINGS FOR TRAFFIC SIGNALS AND HIGHWAY LIGHTING, THE MANUAL ON UNIFORM TRAFFIC CONTROL DEVICES FOR STREETS AND HIGHWAYS, 2009 EDITION, AND ALL INTERIM REVISIONS PUBLISHED BY FEDERAL HIGHWAY ADMINISTRATION. WHERE CONFLICTS EXIST, THE CITY OF CAMBRIDGE STANDARDS AND SPECIFICATIONS SHALL GOVERN.

#### PROFESSIONAL CERTIFICATION

I HEREBY CERTIFY THAT THESE PLANS WERE PREPARED OR APPROVED BY ME, AND THAT I AM A DULY LICENSED PROFESSIONAL ENGINEER UNDER THE LAWS OF THE STATE OF [STATE].  
LICENSE NO. \_\_\_\_\_  
EXPIRATION DATE: \_\_\_\_\_

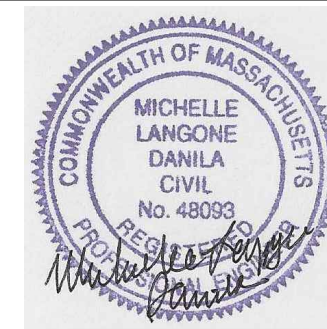

10/21/2022

#### REUSE OF DOCUMENTS

ALL DRAWINGS ARE INSTRUMENTS OF PROFESSIONAL SERVICE FOR THIS PROJECT. REUSE OR ALTERATION IS AT THE USER'S SOLE RISK.

DSGN	HS	NO.	DATE	REVISION	BY	APVD
DR	HS					
CHK	MLD					
APVD	MLD					



2 OLIVER STREET, SUITE 305  
BOSTON, MA 02109  
PHONE: 617.619.9910  
www.tooledesign.com

GARDEN STREET FROM HURON AVENUE TO MASON STREET - SEPARATED BICYCLE LANES

COMMONWEALTH OF MASSACHUSETTS

## TITLE SHEET

PROJECT NO.	6085.07
DATE	10/21/2022
DRAWING NO.	G-01
SHEET NO.	1 OF 30



**GENERAL NOTES**

1. THE CONTRACTOR SHALL COMPLY WITH ALL APPLICABLE FEDERAL, STATE, AND LOCAL LAWS, RULES, REGULATIONS AND SAFETY CODES IN THE CONSTRUCTION OF ALL IMPROVEMENTS. SIGN AND STRIPING WORK SHALL ALSO MEET ALL APPLICABLE REQUIREMENTS OF THE MANUAL OF UNIFORM TRAFFIC CONTROL DEVICES (MUTCD).
2. BASE MAPPING WAS ESTABLISHED UTILIZING GIS DATA PROVIDED BY THE CITY OF CAMBRIDGE. HYDRANTS, PARKING METERS, UTILITIES AND UTILITY POLES, LIGHT POLES, SIGNAL EQUIPMENT, STREET TREES, FENCING, AND OTHER STREET FURNITURE ARE APPROXIMATE.
3. EXISTING CONDITIONS MAY VARY FROM THOSE SHOWN ON THE PLANS. THE CONTRACTOR SHALL VERIFY EXISTING CONDITIONS AND ADJUST WORK PLAN ACCORDINGLY PRIOR TO BEGINNING CONSTRUCTION. THE CONTRACTOR SHALL REPORT ANY CONFLICTS BETWEEN EXISTING CONDITIONS AND PROPOSED FEATURES TO THE ENGINEER.
4. ALL PAVEMENT MARKINGS AND SIGNS SHALL MEET MUTCD STANDARD SPECIFICATIONS.
5. THE CONTRACTOR SHALL ERADICATE ALL EXISTING PAVEMENT MARKINGS WITHIN THE LIMITS OF WORK USING AN APPROVED, NON-DESTRUCTIVE METHOD SUCH THAT NO TRACES OF EXISTING MARKINGS REMAIN VISIBLE. THE CONTRACTOR SHALL NOT INSTALL NEW PAVEMENT MARKINGS WITHOUT FIRST ERADICATING EXISTING PAVEMENT MARKINGS, OR AS DIRECTED BY THE FIELD ENGINEER.
6. THE CONTRACTOR SHALL TAKE ADEQUATE PRECAUTIONS TO PROTECT ALL WALKS, GRADING, SIDEWALKS, AND FEATURES ADJACENT TO THE LIMITS OF WORK, AS DIRECTED BY THE ENGINEER, AND AT THE CONTRACTOR'S OWN EXPENSE, THE CONTRACTOR SHALL REPAIR, REPLACE, OR OTHERWISE MAKE GOOD ANY DAMAGE CAUSED BY THE CONTRACTOR'S OPERATIONS.
7. IT SHALL BE THE RESPONSIBILITY OF THE CONTRACTOR TO SEQUENCE THE WORK SUCH THAT THERE WILL BE NO CONFLICTS AT ANY TIME BETWEEN TRAFFIC PATTERNS AND TRAFFIC CONTROL DEVICES (TEMPORARY OR NEW) WITHIN THE LIMITS OF THE PROJECT.
8. ALL EXISTING PEDESTRIAN RAMP LOCATIONS ARE APPROXIMATE. NOT ALL EXISTING PEDESTRIAN RAMPS HAVE BEEN REVIEWED FOR ADA COMPLIANCE.
9. THE MINIMUM HEIGHT, MEASURED VERTICALLY FROM THE BOTTOM OF THE SIGN TO THE SIDEWALK, SHALL BE 7', THE MINIMUM LATERAL OFFSET, MEASURED FROM THE EDGE OF THE SIGN TO THE FACE OF THE CURB, SHALL BE 1'.
10. NEW SIGNS SHALL BE FULLY INSTALLED AT THE SAME TIME OR PRIOR TO THE INSTALLATION OF NEW PAVEMENT MARKINGS. SIGNS CONFLICTING WITH THE EXISTING PAVEMENT MARKINGS SHALL BE COVERED UNTIL THE FINAL PAVEMENT MARKINGS ARE INSTALLED ONCE THE PAVEMENT MARKINGS ARE INSTALLED, THE SIGNS SHALL BE PROMPTLY UNCOVERED.
11. ALL PARKING REGULATION SIGNS (EXISTING OR PROPOSED) SHALL BE INSTALLED AT 45 DEGREE ANGLE RELATIVE TO THE CURB LINE UNLESS OTHERWISE NOTED IN THE PLANS. ALL OTHER TRAFFIC-RELATED SIGNS (EXISTING OR PROPOSED) SHALL BE INSTALLED AT A 90 DEGREE ANGLE TO THE CURB, UNLESS OTHERWISE NOTED IN THE PLANS.
12. FLEXPOSTS TO BE CENTERED IN BUFFER SPACE UNLESS OTHERWISE NOTED.
13. THE CONTRACTOR SHALL BE FULLY RESPONSIBLE FOR ANY AND ALL DAMAGES WHICH ARE A RESULT OF THE CONTRACTOR'S ACTIVITIES OR METHOD OF CONSTRUCTION. THE CONTRACTOR SHALL REPAIR OR REPLACE ALL DAMAGED UTILITIES AND RESTORE SERVICE IN A TIMELY MANNER, PRIOR TO PROCEEDING WITH CONSTRUCTION, AT THE CONTRACTOR'S EXPENSE.
14. WHERE AN EXISTING UTILITY IS FOUND TO BE IN CONFLICT WITH THE PROPOSED WORK, THE LOCATION, ELEVATION AND SIZE OF THE UTILITY SHALL BE ACCURATELY DETERMINED WITHOUT DELAY BY THE CONTRACTOR, AND THE INFORMATION FURNISHED TO THE ENGINEER FOR RESOLUTION OF THE CONFLICT.
15. AREAS OUTSIDE THE LIMITS OF PROPOSED WORK DISTURBED BY THE CONTRACTOR'S OPERATIONS SHALL BE RESTORED BY THE CONTRACTOR TO THEIR ORIGINAL CONDITION AT THE CONTRACTORS EXPENSE.
16. THE TERM "PROPOSED" (PROP) MEANS WORK TO BE CONSTRUCTED USING NEW MATERIALS, REMOVING EXISTING MATERIALS IDENTIFIED AS "REMOVE AND STACK" (R&S), OR, WHERE APPLICABLE, RE-USING EXISTING MATERIALS IDENTIFIED AS "REMOVE AND RESET" (R&R).
17. THE TERM "MEET EX" MEANS TO MEET BOTH THE EXISTING HORIZONTAL ALIGNMENT AND ELEVATION.
18. STRIPED PARKING SPACES SHALL MAINTAIN A MINIMUM DISTANCE OF 4' FROM ALL DRIVEWAYS UNLESS OTHERWISE NOTED. CENTER PARKING SPACES BETWEEN DRIVEWAYS WHERE APPLICABLE.
19. PARKING AREAS SHOWN ARE APPROXIMATE LIMITS OF PARKING BASED UPON EXISTING SIGNED REGULATIONS. DRIVEWAYS SHOWN ON THE DRAWINGS ARE APPROXIMATE AND NOT ALL DRIVEWAYS ARE SHOWN.
20. THE CITY OF CAMBRIDGE IS RESPONSIBLE FOR THE INSTALLATION AND RELOCATION OF ALL PARKING METERS.
20. THE PREPARER OF THESE PLANS HAS NO ROLE IN THE OVERSIGHT OR OTHERWISE IN THE IMPLEMENTATION OF THESE PLANS.

**LEGEND AND ABBREVIATIONS**

EXISTING	PROPOSED	
		PAVEMENT ARROW - WHITE
		LEGEND "ONLY" - WHITE
		24" STOP LINE (UNLESS OTHERWISE NOTED)
		CROSSWALK
		4" DOUBLE YELLOW LINE
		4" DOTTED DOUBLE YELLOW LINE
		6" SOLID WHITE LINE
		6" SOLID YELLOW LINE
		6" BROKEN WHITE LINE
		6" BROKEN YELLOW LINE
		6" DOTTED WHITE LINE (2' LINE, 4' GAP)
		6" DOTTED YELLOW LINE (2' LINE, 4' GAP)
		6" DOUBLE WHITE LINE
		8" SOLID WHITE BIKE LANE LINE
		8" SOLID WHITE CHANNELIZATION LINE
		8" SOLID YELLOW CHANNELIZATION LINE
		SHARED LANE MARKING SYMBOL
		BIKE LANE MARKING SYMBOL
		BIKE LANE YIELD LINE
		BIKE DETECTOR SYMBOL
		BICYCLE BOX SYMBOL
		GREEN HIGH FRICTION SURFACE TREATMENT
		LIMIT OF WORK
		BEGIN ERADICATION
		END ERADICATION
		ERADICATE SYMBOL
		EXISTING
		RETAIN
		MOUNT
		REMOVE AND STACK
		REMOVE AND DISPOSE
		REMOVE AND RESET
		HYDRANT
		SIGN POST
		FLEX POST
		STREET LIGHT
		DOUBLE HEAD METER
		SINGLE HEAD METER
		UTILITY POLE
		NEW OR RELOCATED SIGN

**PROFESSIONAL CERTIFICATION**

I HEREBY CERTIFY THAT THESE PLANS WERE PREPARED OR APPROVED BY ME, AND THAT I AM A DULY LICENSED PROFESSIONAL ENGINEER UNDER THE LAWS OF THE STATE OF [STATE].  
 LICENSE NO. \_\_\_\_\_  
 EXPIRATION DATE: \_\_\_\_\_



**REUSE OF DOCUMENTS**

ALL DRAWINGS ARE INSTRUMENTS OF PROFESSIONAL SERVICE FOR THIS PROJECT. REUSE OR ALTERATION IS AT THE USER'S SOLE RISK.

DSGN	HS				
DR	HS				
CHK	MLD				
APVD	MLD	NO.	DATE	REVISION	BY
					APVD

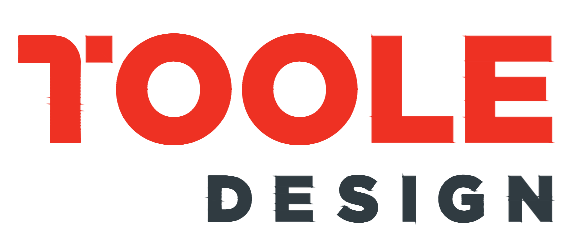

2 OLIVER STREET, SUITE 305  
 BOSTON, MA 02109  
 PHONE: 617.619.9910  
 www.tooledesign.com

GARDEN STREET FROM HURON AVENUE TO MASON STREET - SEPARATED BICYCLE LANES

COMMONWEALTH OF MASSACHUSETTS

**GENERAL NOTES & LEGEND**

PROJECT NO.	6085.07
DATE	10/21/2022
DRAWING NO.	G-02
SHEET NO.	2 OF 30

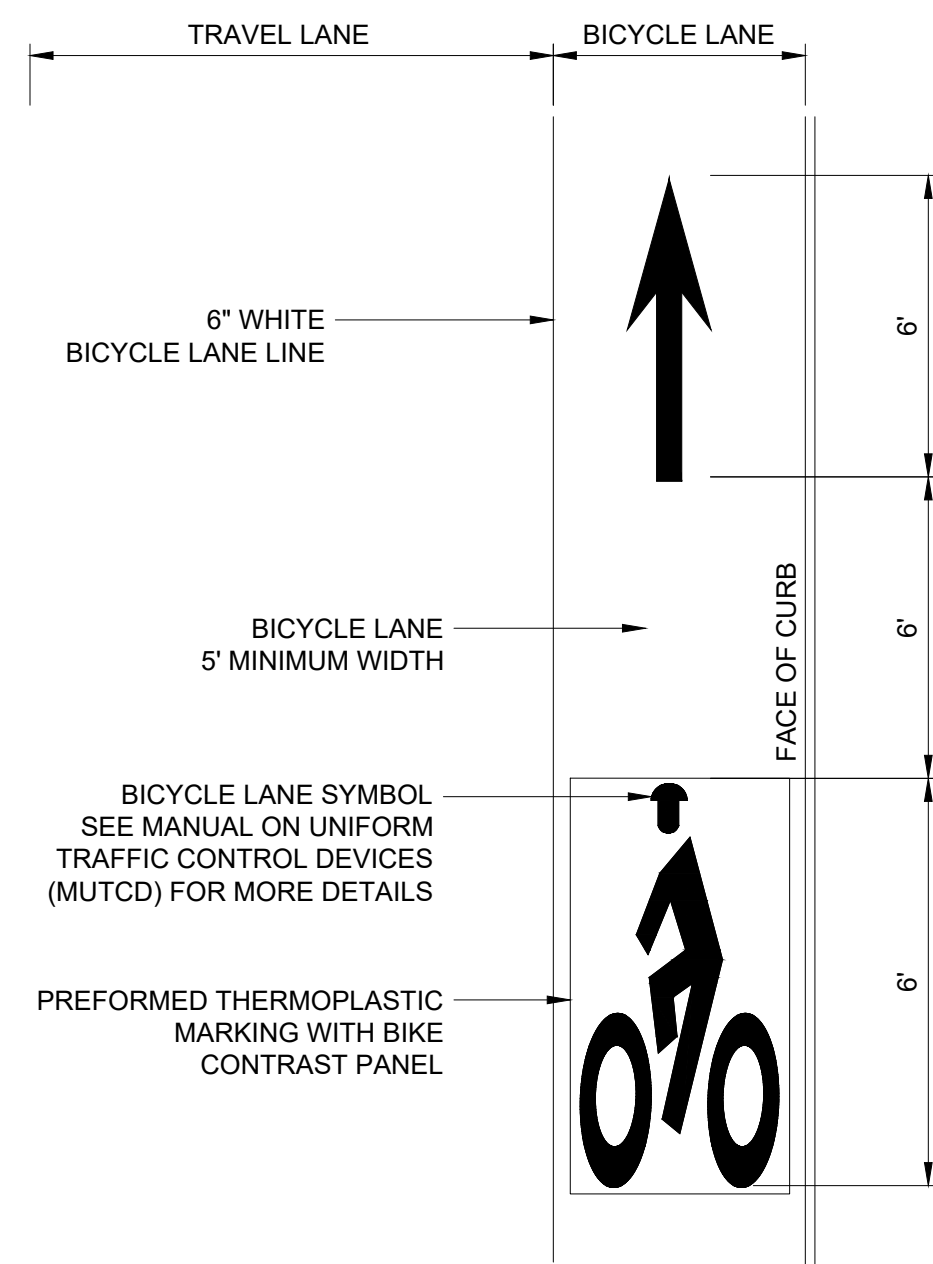

**BICYCLE LANE STRIPING NOTES:**

1. DO NOT PLACE SYMBOLS ON LANE LINES.
2. PLACE BICYCLE LANE SYMBOLS WITHIN CENTER OF BICYCLE LANE.
3. SEE PLAN SHEETS FOR SYMBOL LOCATIONS.
4. TRAVEL AND PARKING LANE WIDTHS ARE AS SHOWN ON THE DRAWINGS.
5. DO NOT PLACE SYMBOLS WITHIN DASHED LINES.

**TYPICAL BICYCLE LANE SYMBOL**  
NOT TO SCALE

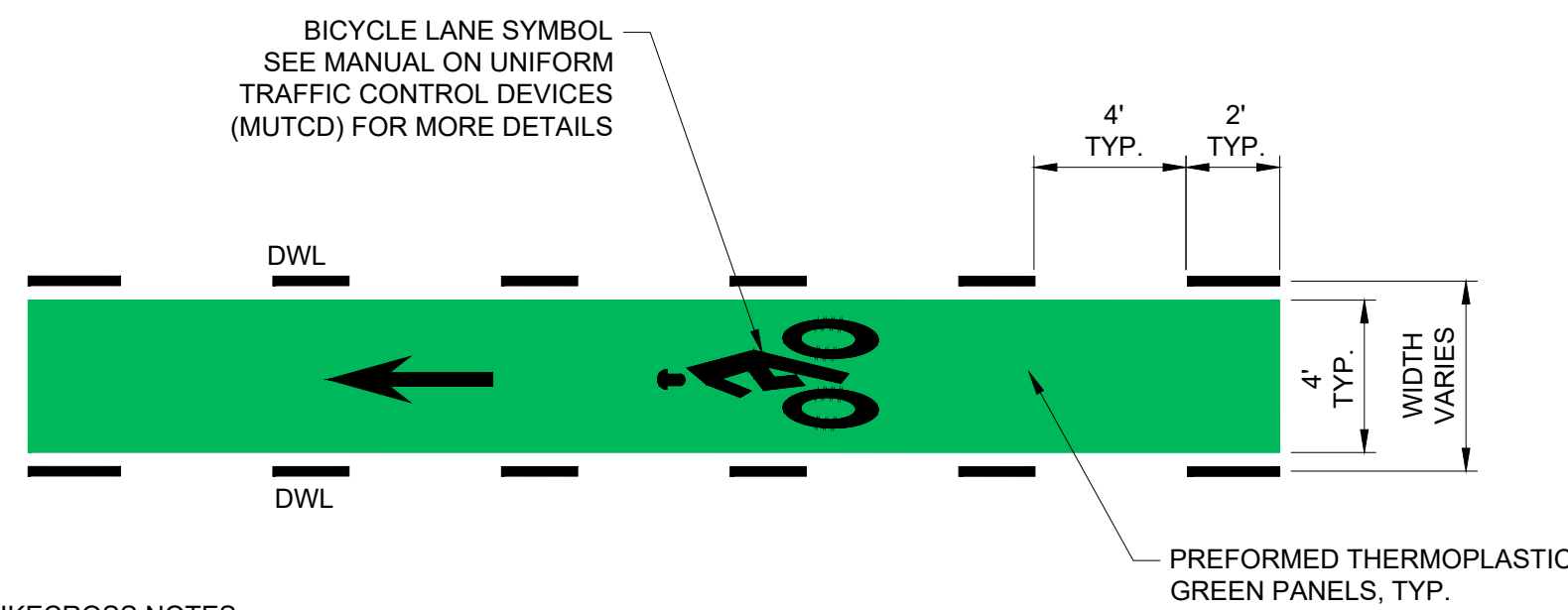

**BIKECROSS NOTES:**

1. PREFORMED THERMOPLASTIC GREEN PANELS ARE USED AS SHOWN ON THE PLANS.
2. INSTALL PREFORMED THERMOPLASTIC GREEN PANELS BETWEEN 2' DOTTED WHITE LANE LINES AS SHOWN ON PLANS.
3. INSTALL PREFORMED THERMOPLASTIC GREEN PANELS SO THAT CROSSWALK MARKINGS ARE NOT DISTURBED.
4. INSTALL PREFORMED THERMOPLASTIC GREEN PANELS SO NOT TO COVER ANY UTILITY MANHOLES AND/OR GATES.

**TYPICAL BIKECROSS**  
NOT TO SCALE

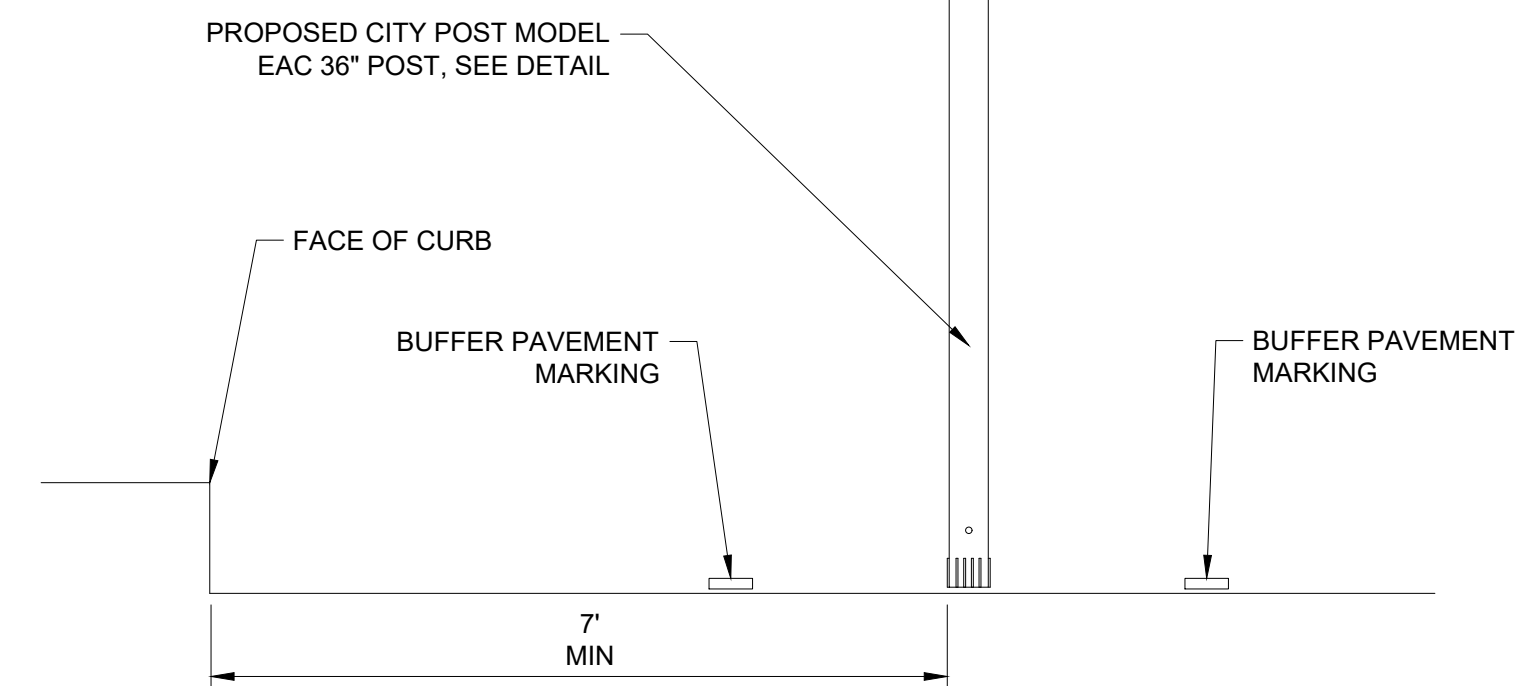

**TYPICAL LATERAL DISTANCE OF FLEXPST FROM CURB**  
(UNLESS OTHERWISE NOTED ON PLANS)  
NOT TO SCALE

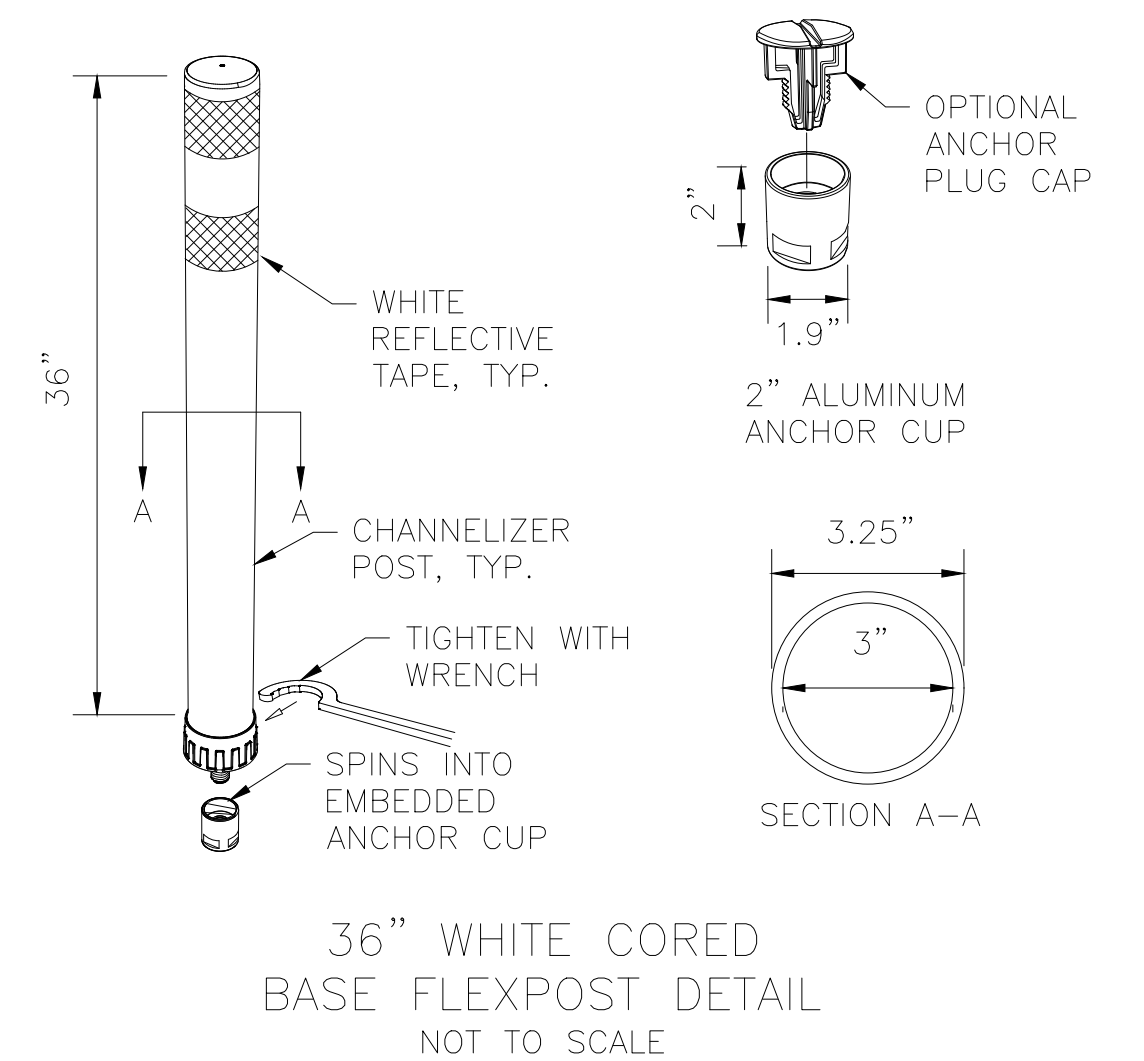

**FLEXPST NOTES:**

1. INSTALLATION TO BE COMPLETED IN ACCORDANCE WITH MANUFACTURER'S SPECIFICATIONS.
2. DIMENSIONS, MATERIALS, AND ATTACHMENTS MAY VARY BETWEEN MANUFACTURERS.
3. COLOR OF POST SHALL MATCH COLOR OF APPLICABLE EDGE LINE.
4. PER CITY OF BOSTON SPECIFICATIONS FOR IN GROUND CORED BASE FLEXPST.

**CITY POST MODEL EAC 36" POST**  
NOT TO SCALE

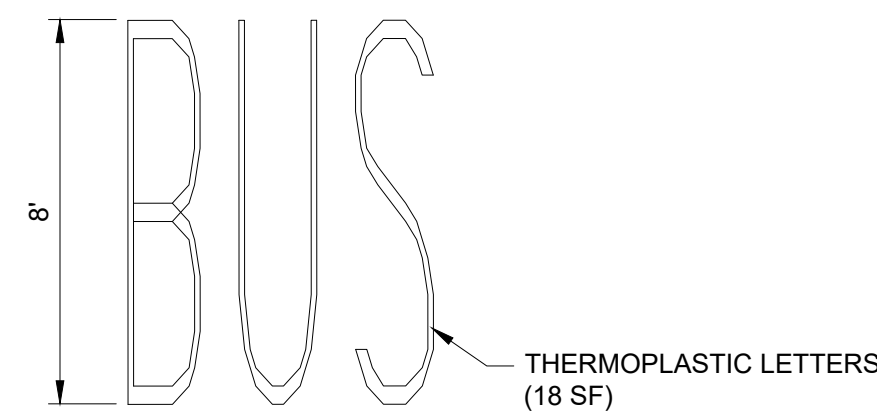

**TYPICAL "BUS" MARKING**  
NOT TO SCALE

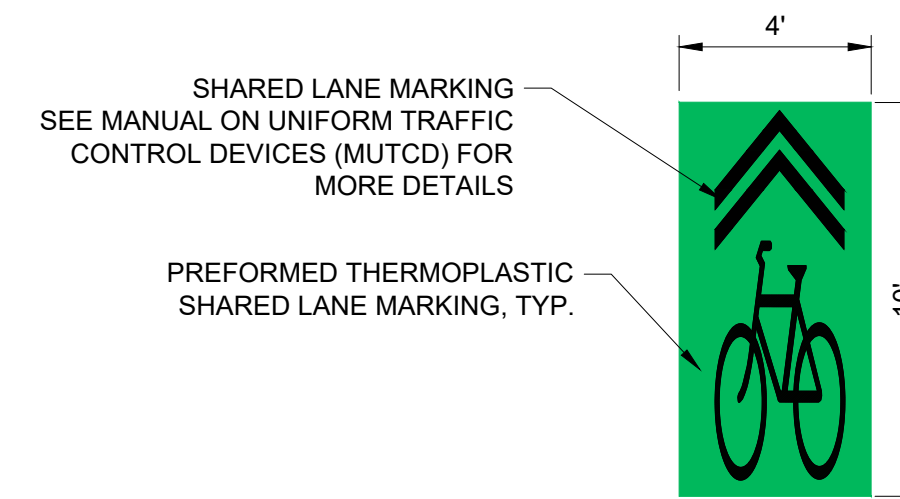

**TYPICAL SHARED LANE MARKING WITH GREEN**  
NOT TO SCALE

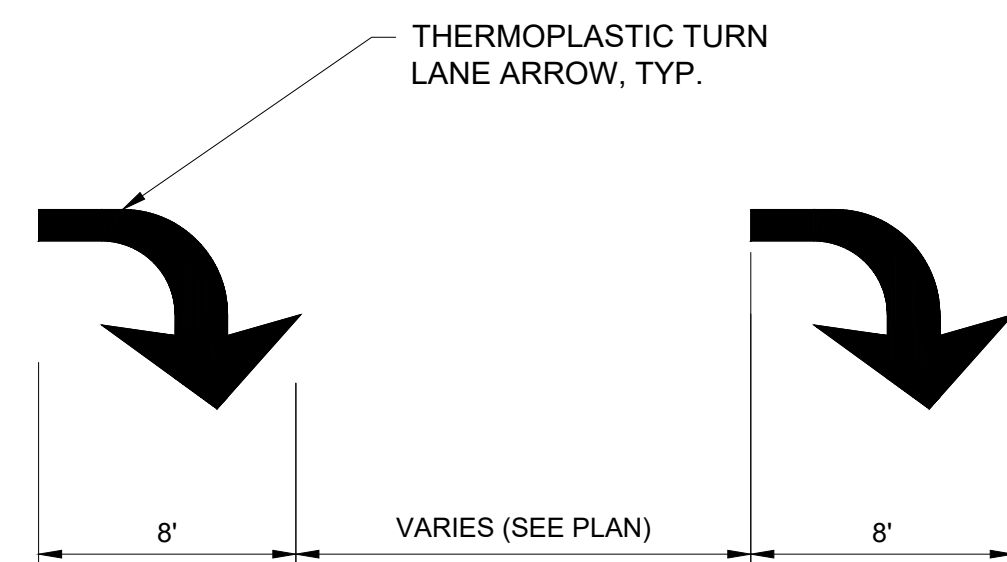

**TYPICAL PAVEMENT MARKING SYMBOLS PLACEMENT**  
NOT TO SCALE



**BIKE LANE YIELD LINE PAVEMENT MARKING DETAIL**  
NOT TO SCALE



**CROSSWALK NOTES:**

1. ALL 12" LINES SHALL BE APPLIED IN ONE APPLICATION, NO COMBINATION OF LINES (TWO - 6" LINES) WILL BE ACCEPTED.
2. LAYOUT OF CROSSWALKS SHALL BE APPROVED BY THE ENGINEER PRIOR TO APPLICATION.
3. CROSSWALK BARS SHALL BE PLACED OUTSIDE THE VEHICULAR WHEEL PATH WHEREVER POSSIBLE.

**TYPICAL CROSSWALK MARKING**  
NOT TO SCALE

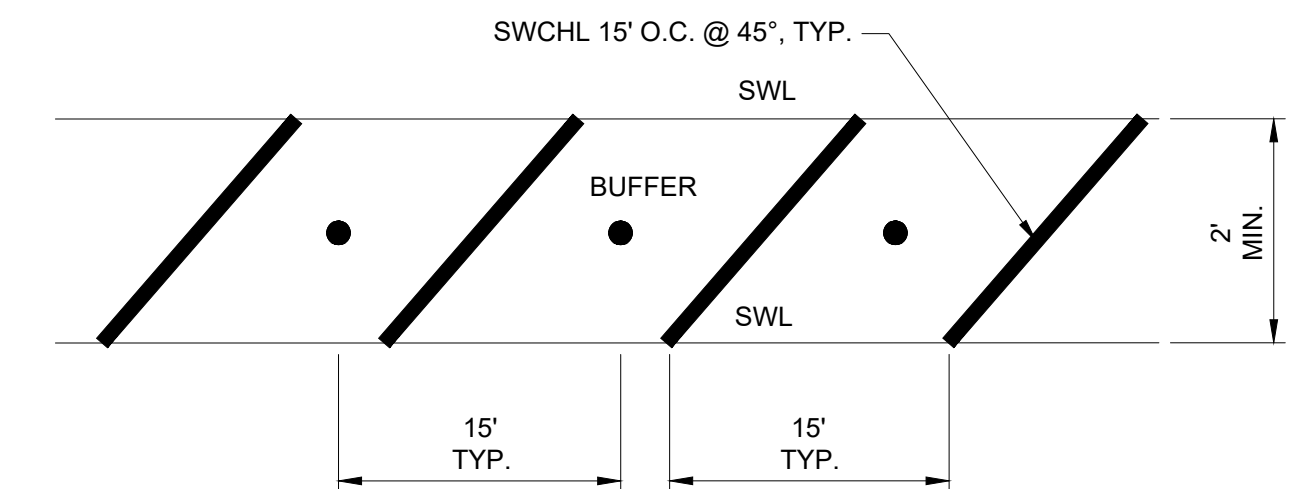

**BIKE LANE BUFFER DETAIL**  
NOT TO SCALE

**PROFESSIONAL CERTIFICATION**

I HEREBY CERTIFY THAT THESE PLANS WERE PREPARED OR APPROVED BY ME, AND THAT I AM A DULY LICENSED PROFESSIONAL ENGINEER UNDER THE LAWS OF THE STATE OF [STATE].  
LICENSE NO. \_\_\_\_\_  
EXPIRATION DATE: \_\_\_\_\_



**REUSE OF DOCUMENTS**

ALL DRAWINGS ARE INSTRUMENTS OF PROFESSIONAL SERVICE FOR THIS PROJECT. REUSE OR ALTERATION IS AT THE USER'S SOLE RISK.

DSGN	HS						
DR	HS						
CHK	MLD						
APVD	MLD	NO.	DATE	REVISION	BY	APVD	



2 OLIVER STREET, SUITE 305  
BOSTON, MA 02109  
PHONE: 617.619.9910  
www.tooledesign.com

GARDEN STREET FROM HURON AVENUE TO MASON STREET - SEPARATED BICYCLE LANES

COMMONWEALTH OF MASSACHUSETTS

**CONSTRUCTION DETAILS**

SHEET 1 OF 3

PROJECT NO.	6085.07
DATE	10/21/2022
DRAWING NO.	G-03
SHEET NO.	3 OF 30



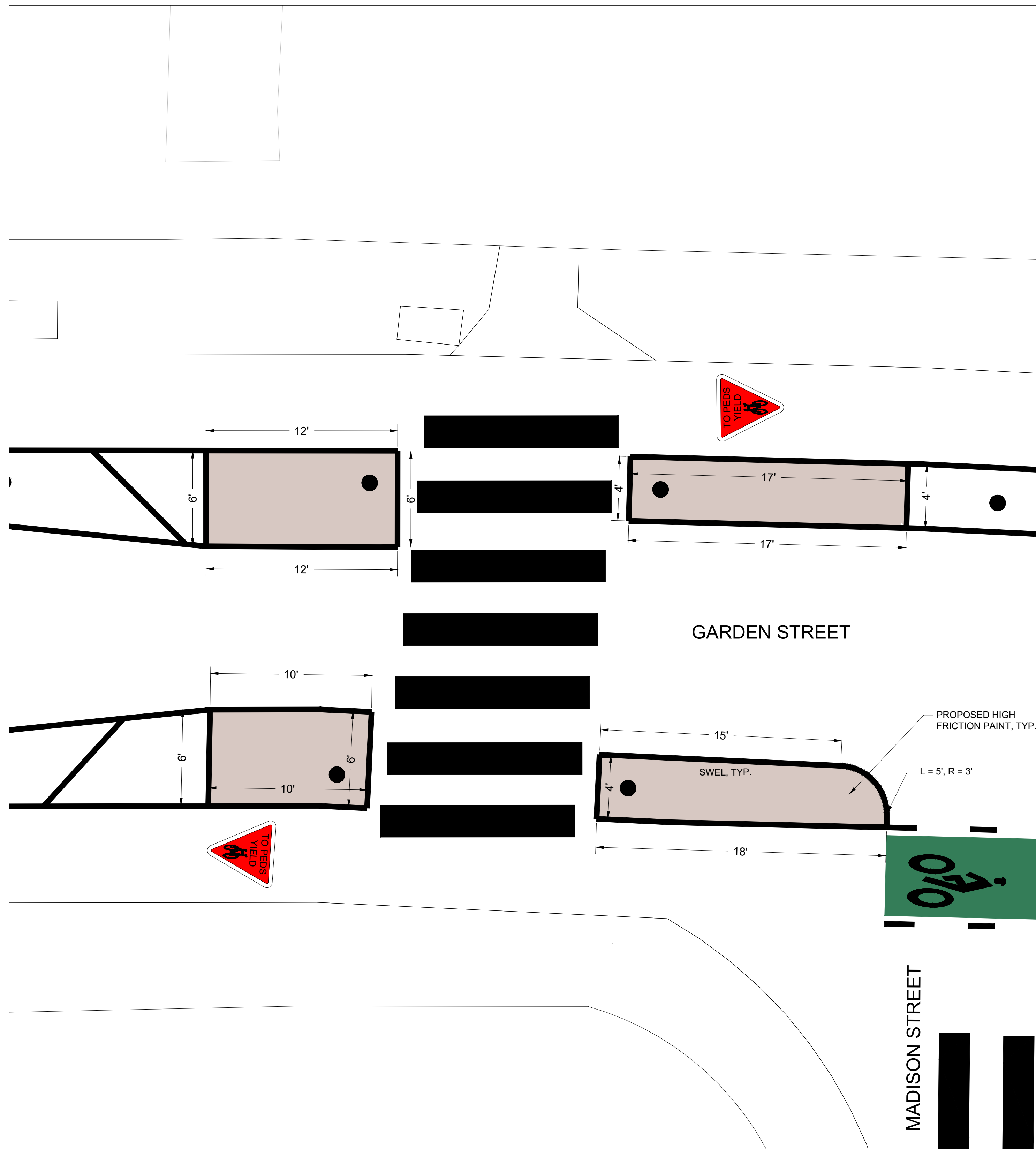

CURB EXTENSION DETAIL AT MADISON STREET  
NOT TO SCALE

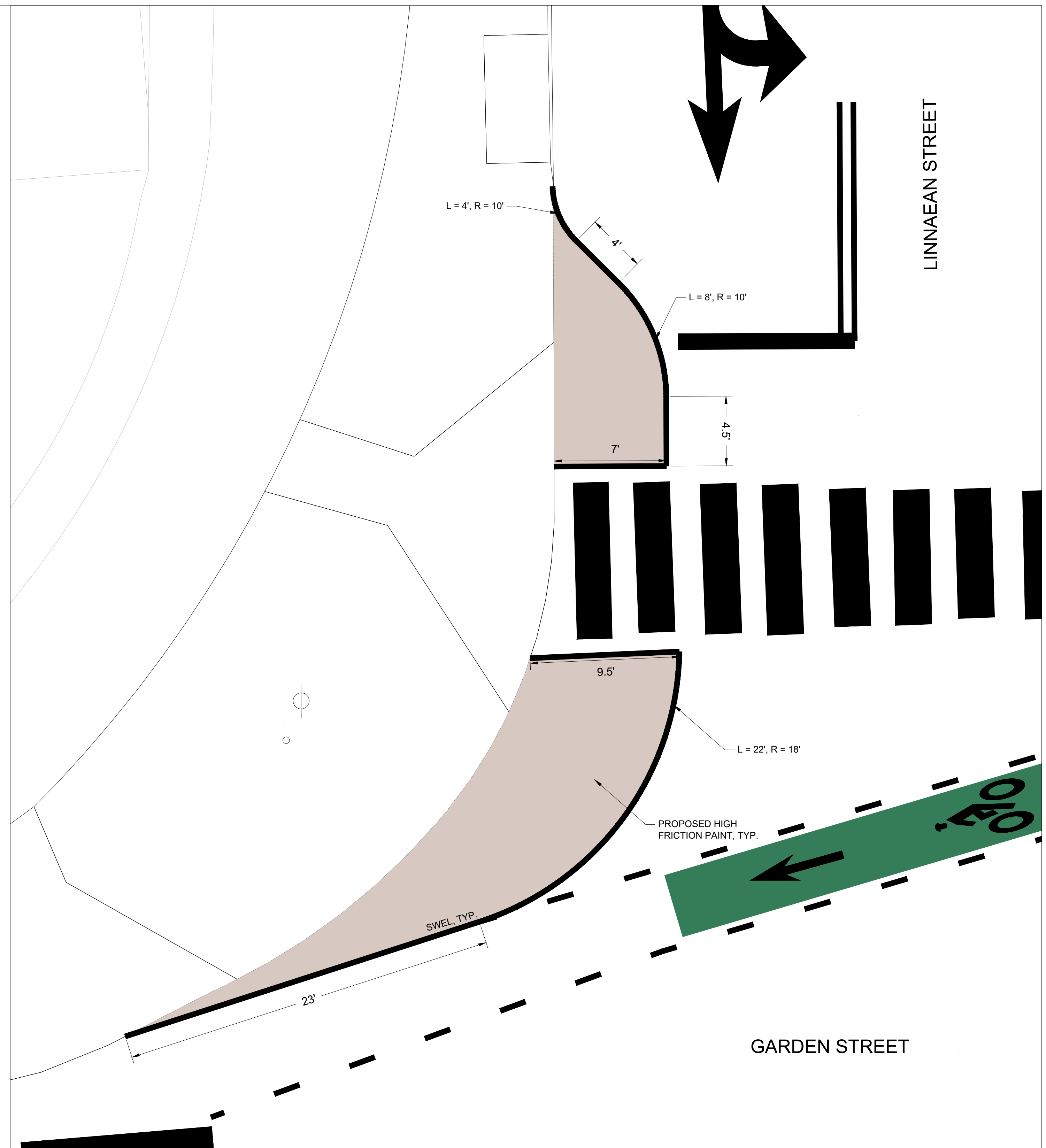

CURB EXTENSION DETAIL AT LINNAEAN STREET  
NOT TO SCALE

PROFESSIONAL CERTIFICATION

I HEREBY CERTIFY THAT THESE PLANS WERE PREPARED OR APPROVED BY ME, AND THAT I AM A DULY LICENSED PROFESSIONAL ENGINEER UNDER THE LAWS OF THE STATE OF [STATE].  
LICENSE NO. \_\_\_\_\_  
EXPIRATION DATE: \_\_\_\_\_



REUSE OF DOCUMENTS

ALL DRAWINGS ARE INSTRUMENTS OF PROFESSIONAL SERVICE FOR THIS PROJECT. REUSE OR ALTERATION IS AT THE USER'S SOLE RISK.

NO.	DATE	REVISION	BY	APVD



2 OLIVER STREET, SUITE 305  
BOSTON, MA 02109  
PHONE: 617.619.9910  
www.tooledesign.com

GARDEN STREET FROM HURON AVENUE TO MASON STREET - SEPARATED BICYCLE LANES

COMMONWEALTH OF MASSACHUSETTS

CONSTRUCTION DETAILS

SHEET 2 OF 3

PROJECT NO.	6085.07
DATE	10/21/2022
DRAWING NO.	G-04
SHEET NO.	4 OF 30

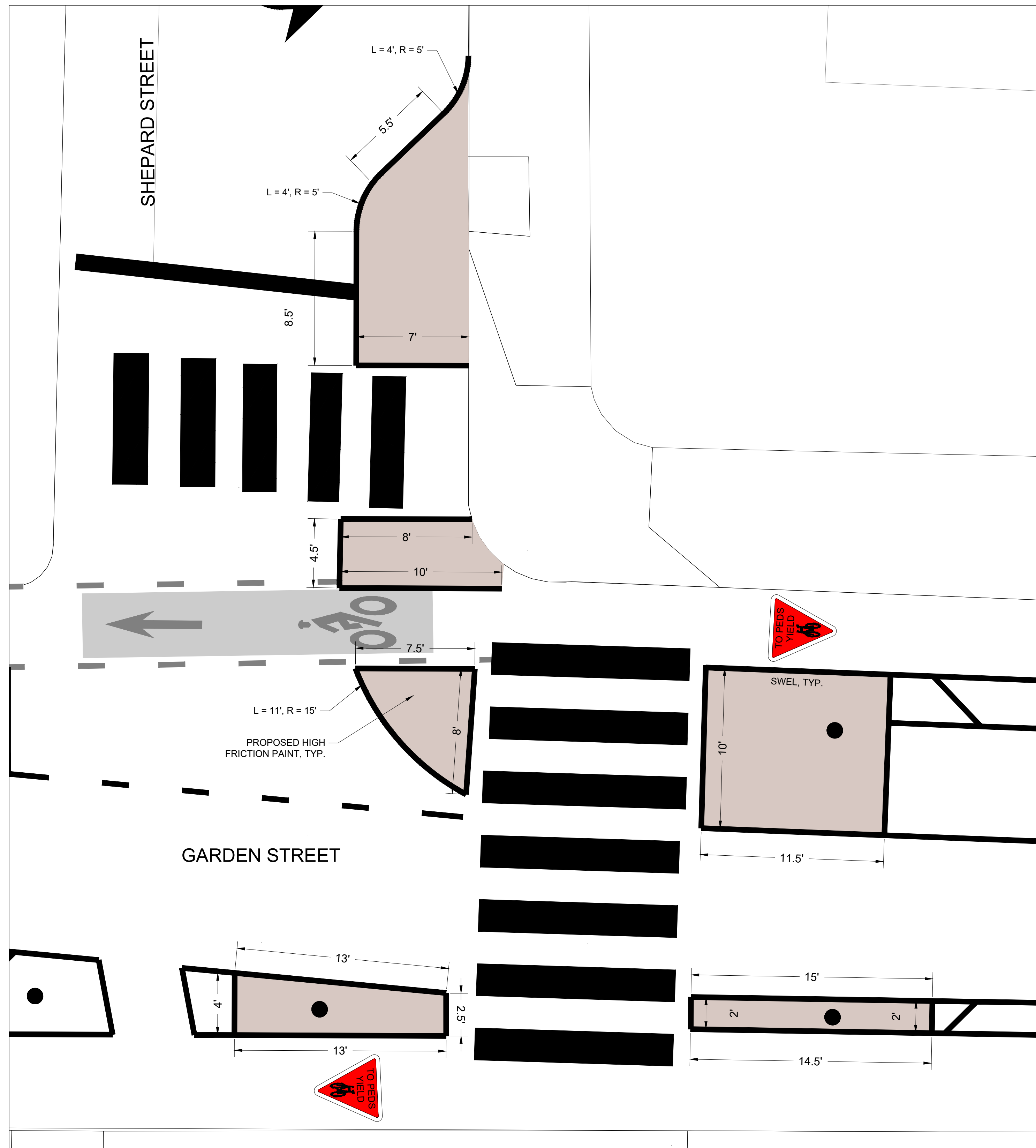

CURB EXTENSION DETAIL AT SHEPARD STREET  
NOT TO SCALE

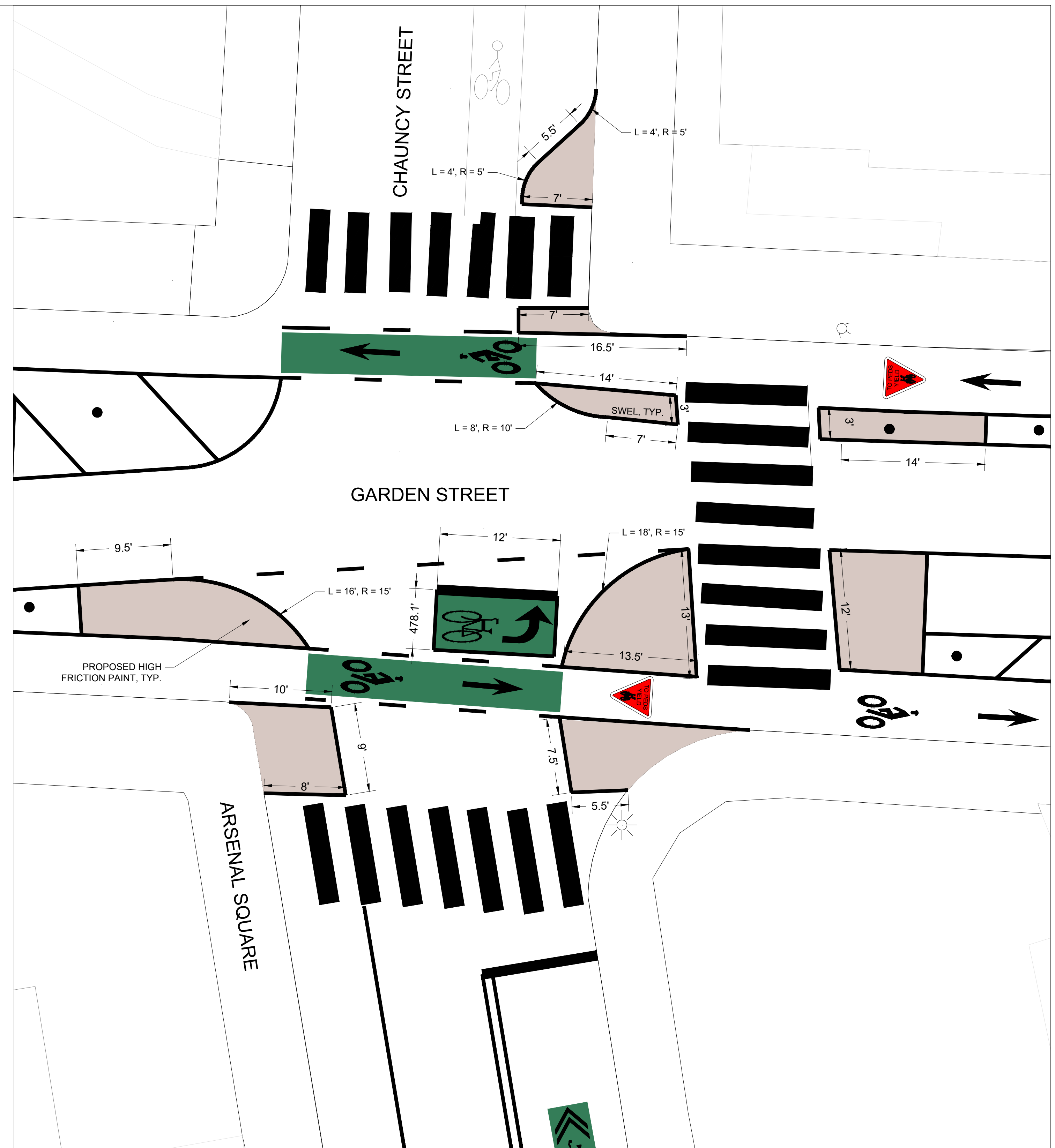

CURB EXTENSION DETAIL AT CHAUNCY STREET/ARSENAL SQUARE  
NOT TO SCALE

PROFESSIONAL CERTIFICATION

I HEREBY CERTIFY THAT THESE PLANS WERE PREPARED OR APPROVED BY ME, AND THAT I AM A DULY LICENSED PROFESSIONAL ENGINEER UNDER THE LAWS OF THE STATE OF [STATE].  
LICENSE NO. \_\_\_\_\_  
EXPIRATION DATE: \_\_\_\_\_



REUSE OF DOCUMENTS

ALL DRAWINGS ARE INSTRUMENTS OF PROFESSIONAL SERVICE FOR THIS PROJECT. REUSE OR ALTERATION IS AT THE USER'S SOLE RISK.

NO.	DATE	REVISION	BY	APVD



2 OLIVER STREET, SUITE 305  
BOSTON, MA 02109  
PHONE: 617.619.9910  
www.tooledesign.com

GARDEN STREET FROM HURON AVENUE TO MASON STREET - SEPARATED BICYCLE LANES

COMMONWEALTH OF MASSACHUSETTS

CONSTRUCTION DETAILS

SHEET 3 OF 3

PROJECT NO.	6085.07
DATE	10/21/2022
DRAWING NO.	G-05
SHEET NO.	5 OF 30



H:\60000\6085.07\_Engineering Services for SBL Projects\8 - Garden Street (Huron Ave to Mason St)\CAD\PLANS\6085.07\_5-Pavement Markings.dwg  
Friday, October 21, 2022 3:15:31 PM

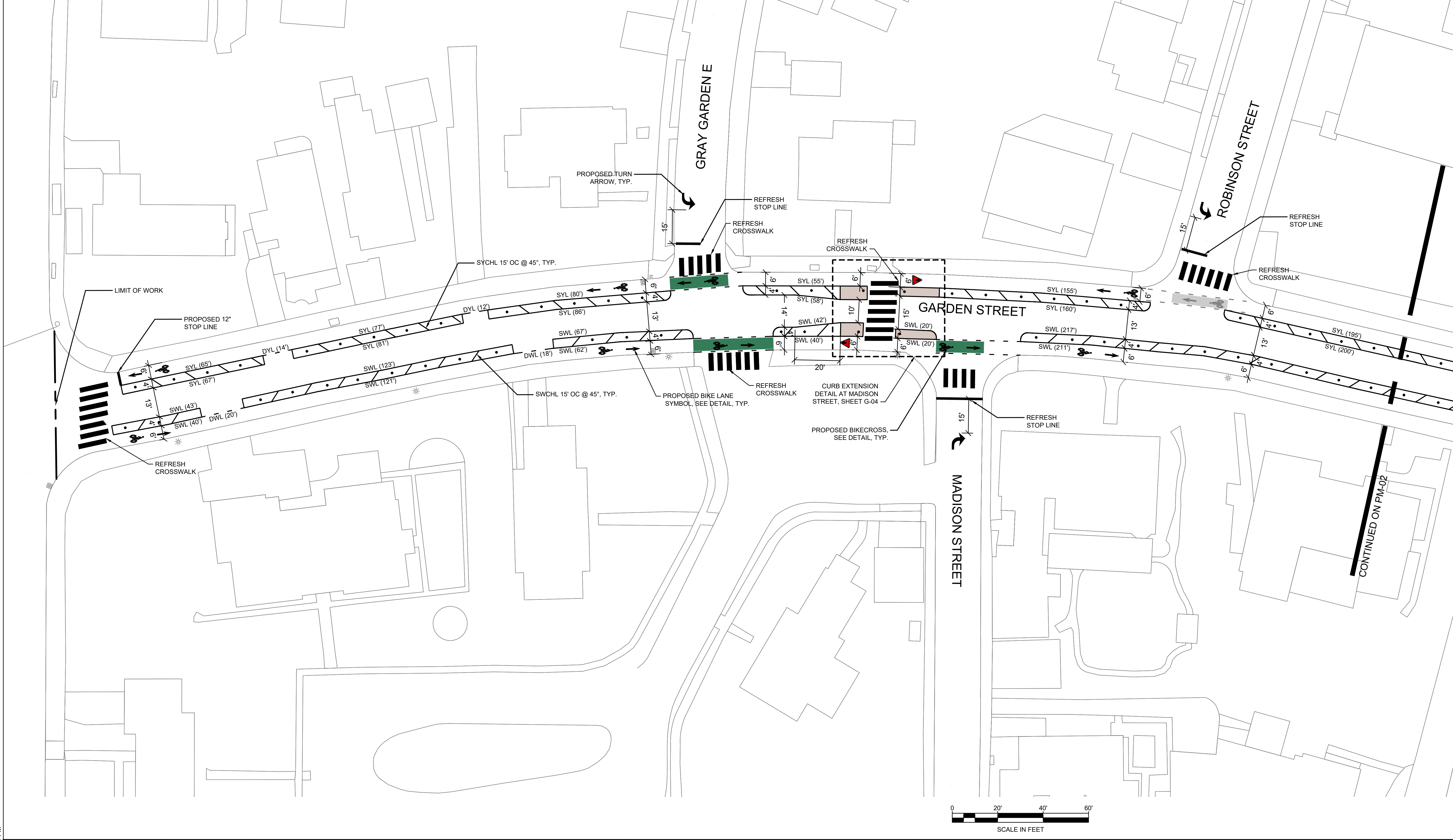

**PROFESSIONAL CERTIFICATION**

I HEREBY CERTIFY THAT THESE PLANS WERE PREPARED OR APPROVED BY ME, AND THAT I AM A DULY LICENSED PROFESSIONAL ENGINEER UNDER THE LAWS OF THE STATE OF [STATE].  
LICENSE NO. \_\_\_\_\_  
EXPIRATION DATE: \_\_\_\_\_



**REUSE OF DOCUMENTS**  
ALL DRAWINGS ARE INSTRUMENTS OF PROFESSIONAL SERVICE FOR THIS PROJECT. REUSE OR ALTERATION IS AT THE USER'S SOLE RISK.

NO.	DATE	REVISION	BY	APVD

TOOLE  
DESIGN

2 OLIVER STREET, SUITE 305  
BOSTON, MA 02109  
PHONE: 617.619.9910  
www.tooledesign.com

GARDEN STREET FROM HURON AVENUE TO MASON STREET - SEPARATED BICYCLE LANES  
CITY OF CAMBRIDGE  
COMMONWEALTH OF MASSACHUSETTS

PAVEMENT MARKING  
PLAN

SHEET 1 OF 6

PROJECT NO.	6085.07
DATE	10/21/2022
DRAWING NO.	PM-01
SHEET NO.	12 OF 30



H:\60000\6085.07\_Engineering Services for SBL Projects\8 - Garden Street (Huron Ave to Mason St)\CAD\PLANS\6085.07\_5-Pavement Markings.dwg  
Friday, October 21, 2022 3:15:42 PM

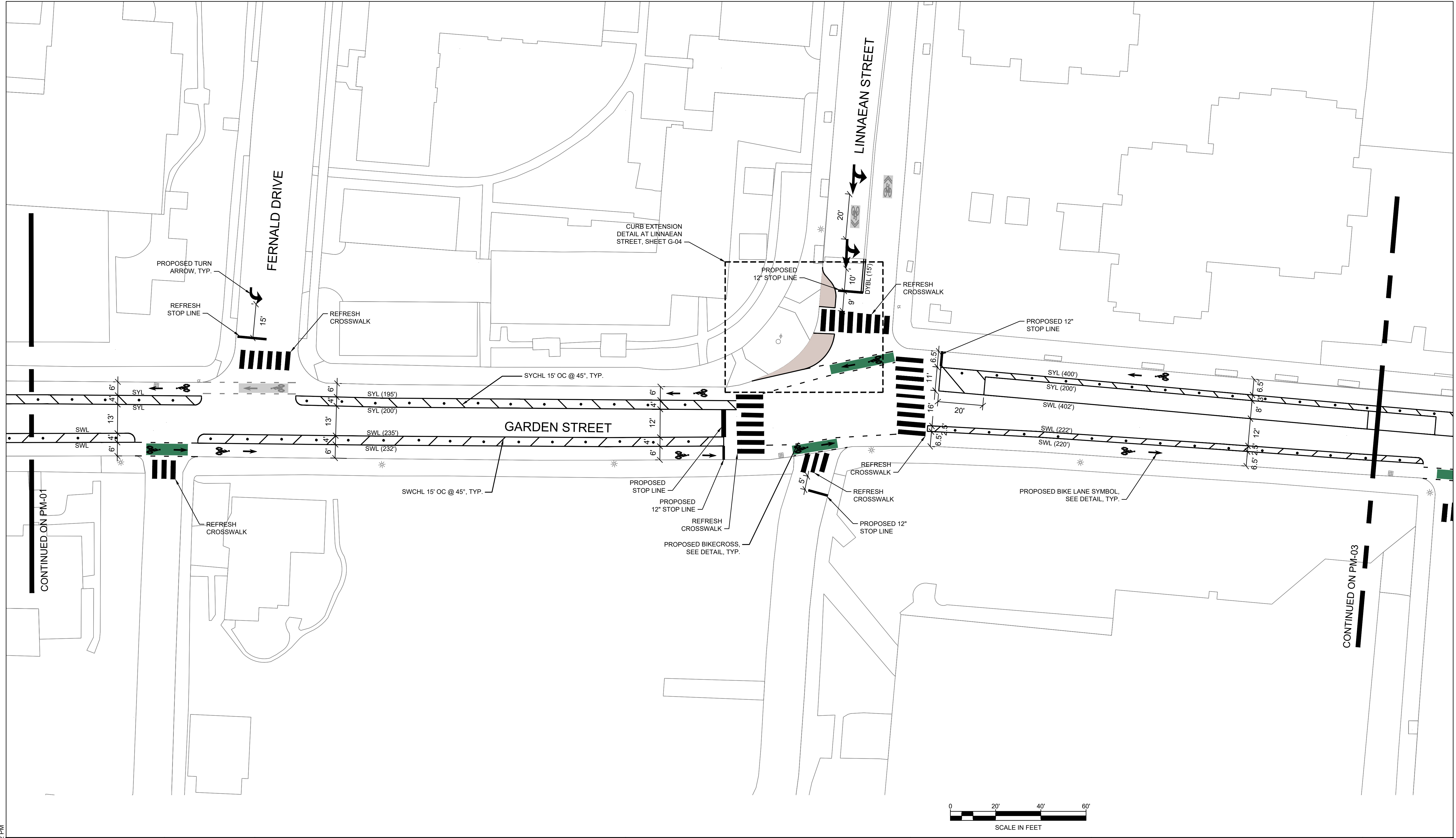

CONTINUED ON PM-01

CONTINUED ON PM-03

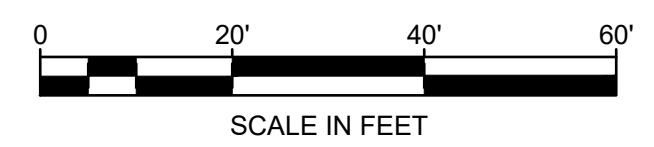

**PROFESSIONAL CERTIFICATION**

I HEREBY CERTIFY THAT THESE PLANS WERE PREPARED OR APPROVED BY ME, AND THAT I AM A DULY LICENSED PROFESSIONAL ENGINEER UNDER THE LAWS OF THE STATE OF [STATE].  
LICENSE NO. \_\_\_\_\_  
EXPIRATION DATE: \_\_\_\_\_



**REUSE OF DOCUMENTS**

ALL DRAWINGS ARE INSTRUMENTS OF PROFESSIONAL SERVICE FOR THIS PROJECT. REUSE OR ALTERATION IS AT THE USER'S SOLE RISK.

NO.	DATE	REVISION	BY	APVD

TOOLE  
DESIGN

2 OLIVER STREET, SUITE 305  
BOSTON, MA 02109  
PHONE: 617.619.9910  
www.tooledesign.com

GARDEN STREET FROM HURON AVENUE TO MASON STREET - SEPARATED BICYCLE LANES  
CITY OF CAMBRIDGE  
COMMONWEALTH OF MASSACHUSETTS

PAVEMENT MARKING PLAN

SHEET 2 OF 6

PROJECT NO.	6085.07
DATE	10/21/2022
DRAWING NO.	PM-02
SHEET NO.	13 OF 30

H:\60000\6085.07 - Engineering Services for SBL Projects\8 - Garden Street (Huron Ave to Mason St)\CAD\PLANS\6085.07\_5-Pavement Markings.dwg  
Friday, October 21, 2022 3:15:54 PM

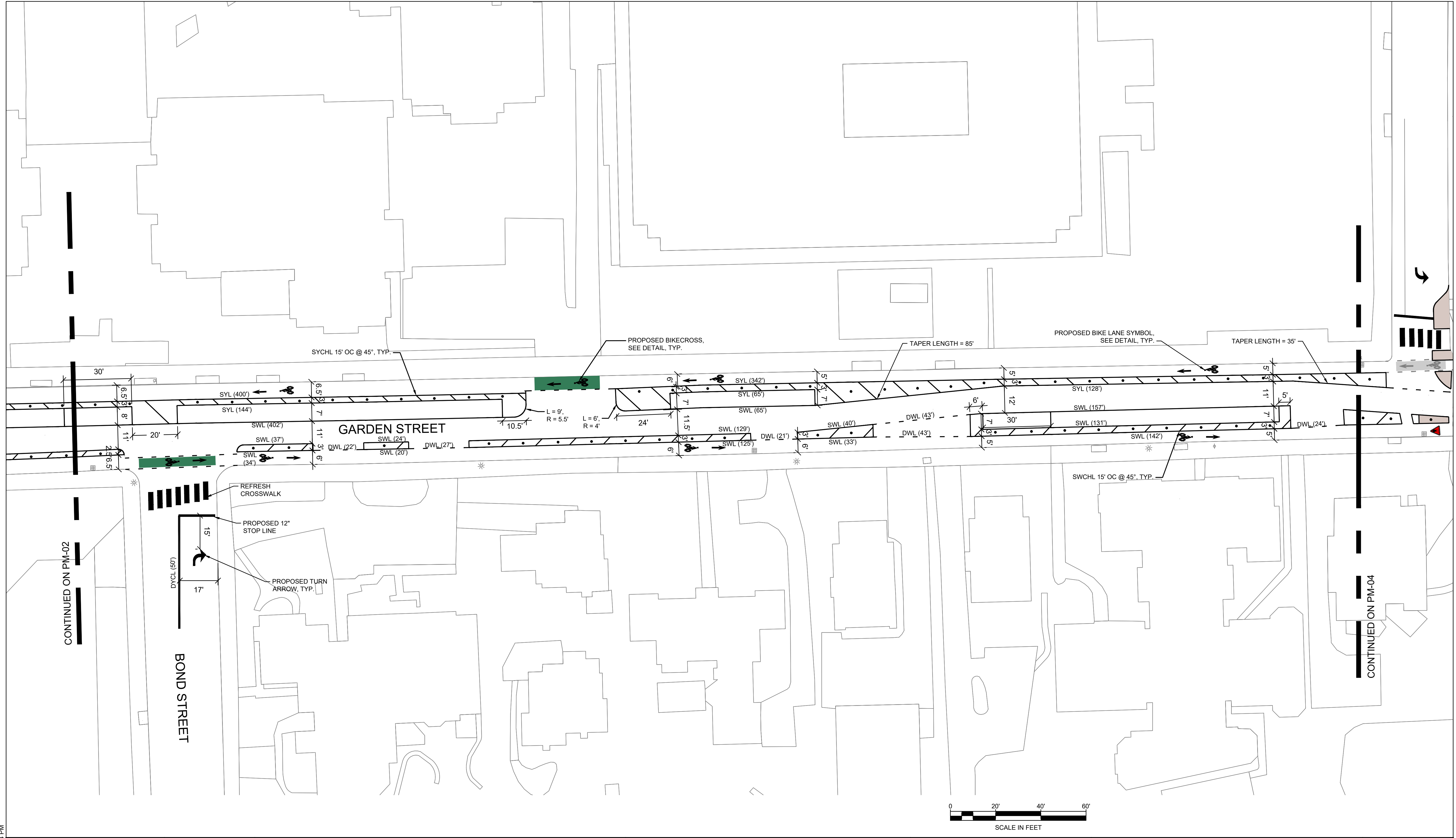

CONTINUED ON PM-02

BOND STREET

CONTINUED ON PM-04

**PROFESSIONAL CERTIFICATION**

I HEREBY CERTIFY THAT THESE PLANS WERE PREPARED OR APPROVED BY ME, AND THAT I AM A DULY LICENSED PROFESSIONAL ENGINEER UNDER THE LAWS OF THE STATE OF [STATE].  
LICENSE NO. \_\_\_\_\_  
EXPIRATION DATE: \_\_\_\_\_



**REUSE OF DOCUMENTS**

ALL DRAWINGS ARE INSTRUMENTS OF PROFESSIONAL SERVICE FOR THIS PROJECT. REUSE OR ALTERATION IS AT THE USER'S SOLE RISK.

NO.	DATE	REVISION	BY	APVD

TOOLE  
DESIGN

2 OLIVER STREET, SUITE 305  
BOSTON, MA 02109  
PHONE: 617.619.9910  
www.tooledesign.com

GARDEN STREET FROM HURON AVENUE TO MASON STREET - SEPARATED BICYCLE LANES

CITY OF CAMBRIDGE  
COMMONWEALTH OF MASSACHUSETTS

PAVEMENT MARKING PLAN

SHEET 3 OF 6

PROJECT NO.	6085.07
DATE	10/21/2022
DRAWING NO.	PM-03
SHEET NO.	14 OF 30



H:\60000\6085.07\_Engineering Services for SBL Projects\8 - Garden Street (Huron Ave to Mason St)\CAD\PLANS\6085.07\_5-Pavement Markings.dwg  
Friday, October 21, 2022 3:16:05 PM

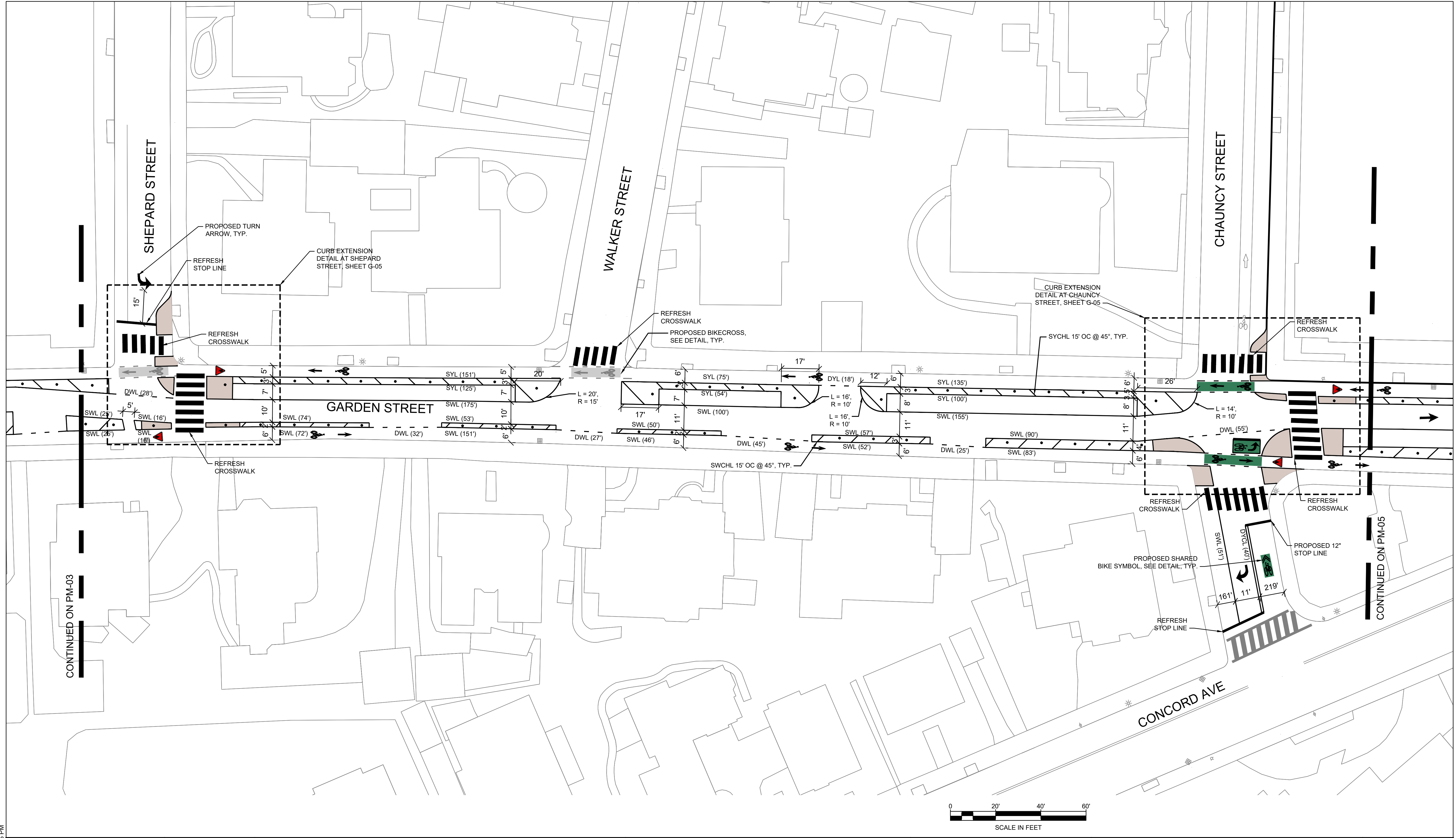

**PROFESSIONAL CERTIFICATION**

I HEREBY CERTIFY THAT THESE PLANS WERE PREPARED OR APPROVED BY ME, AND THAT I AM A DULY LICENSED PROFESSIONAL ENGINEER UNDER THE LAWS OF THE STATE OF [STATE].  
LICENSE NO. \_\_\_\_\_  
EXPIRATION DATE: \_\_\_\_\_



**REUSE OF DOCUMENTS**

ALL DRAWINGS ARE INSTRUMENTS OF PROFESSIONAL SERVICE FOR THIS PROJECT. REUSE OR ALTERATION IS AT THE USER'S SOLE RISK.

DSGN	HS				
DR	HS				
CHK	MLD				
APVD	MLD	NO.	DATE	REVISION	BY
					APVD

TOOLE  
DESIGN

2 OLIVER STREET, SUITE 305  
BOSTON, MA 02109  
PHONE: 617.619.9910  
www.tooledesign.com

GARDEN STREET FROM HURON AVENUE TO MASON STREET - SEPARATED BICYCLE LANES

CITY OF CAMBRIDGE  
COMMONWEALTH OF MASSACHUSETTS

PAVEMENT MARKING PLAN

SHEET 4 OF 6

PROJECT NO.	6085.07
DATE	10/21/2022
DRAWING NO.	PM-04
SHEET NO.	15 OF 30



H:\60000\6085.07\_Engineering Services for SBL Projects\8 - Garden Street (Huron Ave to Mason St)\CAD\PLANS\6085.07\_5-Pavement Markings.dwg  
Friday, October 21, 2022 3:16:17 PM

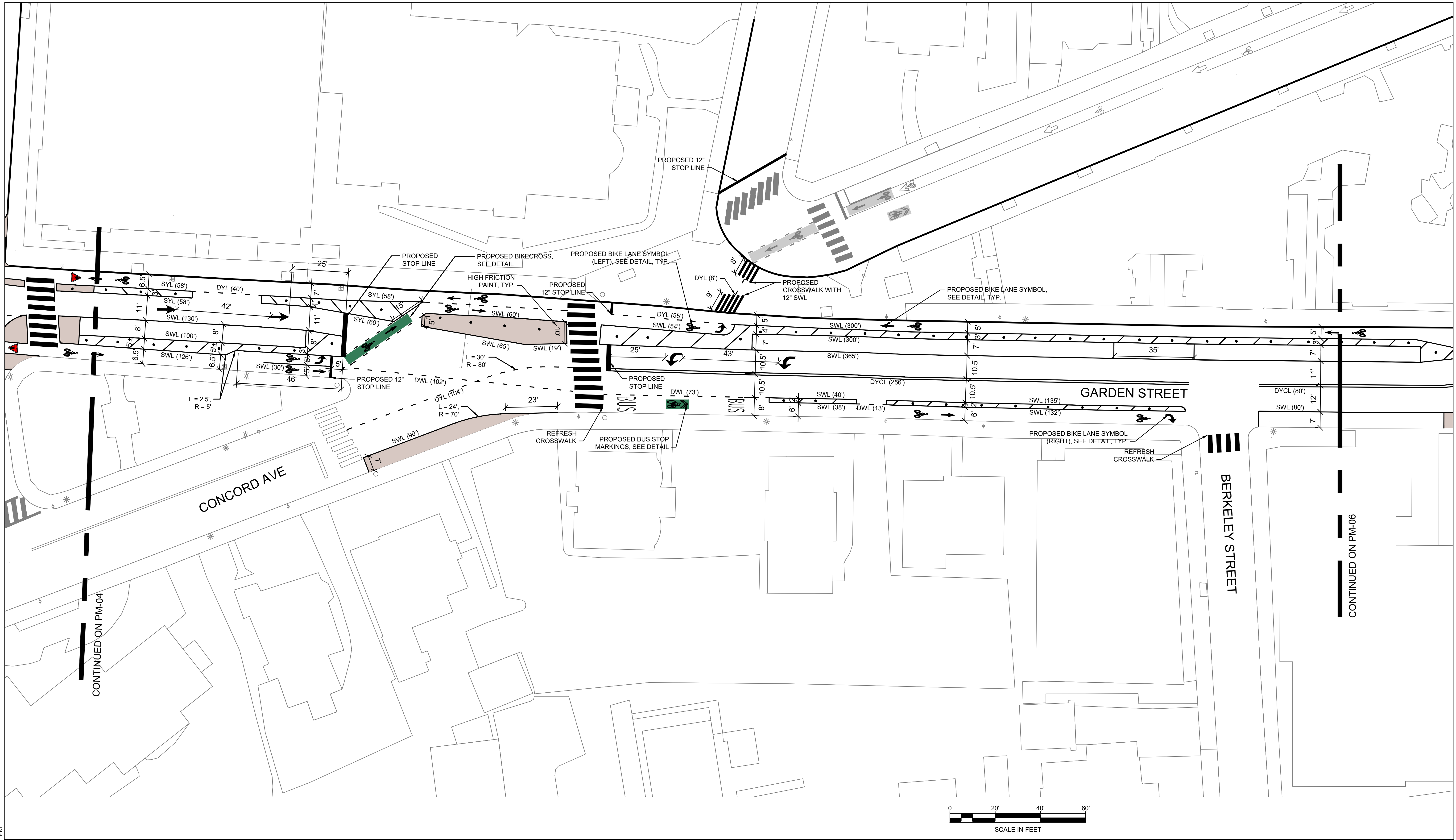

CONTINUED ON PM-06

**PROFESSIONAL CERTIFICATION**

I HEREBY CERTIFY THAT THESE PLANS WERE PREPARED OR APPROVED BY ME, AND THAT I AM A DULY LICENSED PROFESSIONAL ENGINEER UNDER THE LAWS OF THE STATE OF [STATE].  
LICENSE NO. \_\_\_\_\_  
EXPIRATION DATE: \_\_\_\_\_



REUSE OF DOCUMENTS		ALL DRAWINGS ARE INSTRUMENTS OF PROFESSIONAL SERVICE FOR THIS PROJECT. REUSE OR ALTERATION IS AT THE USER'S SOLE RISK.	
DSGN	HS	NO.	DATE
DR	HS		
CHK	MLD		
APVD	MLD		
		REVISION	BY
			APVD

**TOOLE DESIGN**

2 OLIVER STREET, SUITE 305  
BOSTON, MA 02109  
PHONE: 617.619.9910  
www.tooledesign.com

GARDEN STREET FROM HURON AVENUE TO MASON STREET - SEPARATED BICYCLE LANES

CITY OF CAMBRIDGE  
COMMONWEALTH OF MASSACHUSETTS

**PAVEMENT MARKING PLAN**

SHEET 5 OF 6

PROJECT NO.	6085.07
DATE	10/21/2022
DRAWING NO.	PM-05
SHEET NO.	16 OF 30



H:\60000\6085.07\_Engineering Services for SBL Projects\8 - Garden Street (Huron Ave to Mason St)\CAD\PLANS\6085.07\_5-Pavement Markings.dwg  
Friday, October 21, 2022 3:16:29 PM

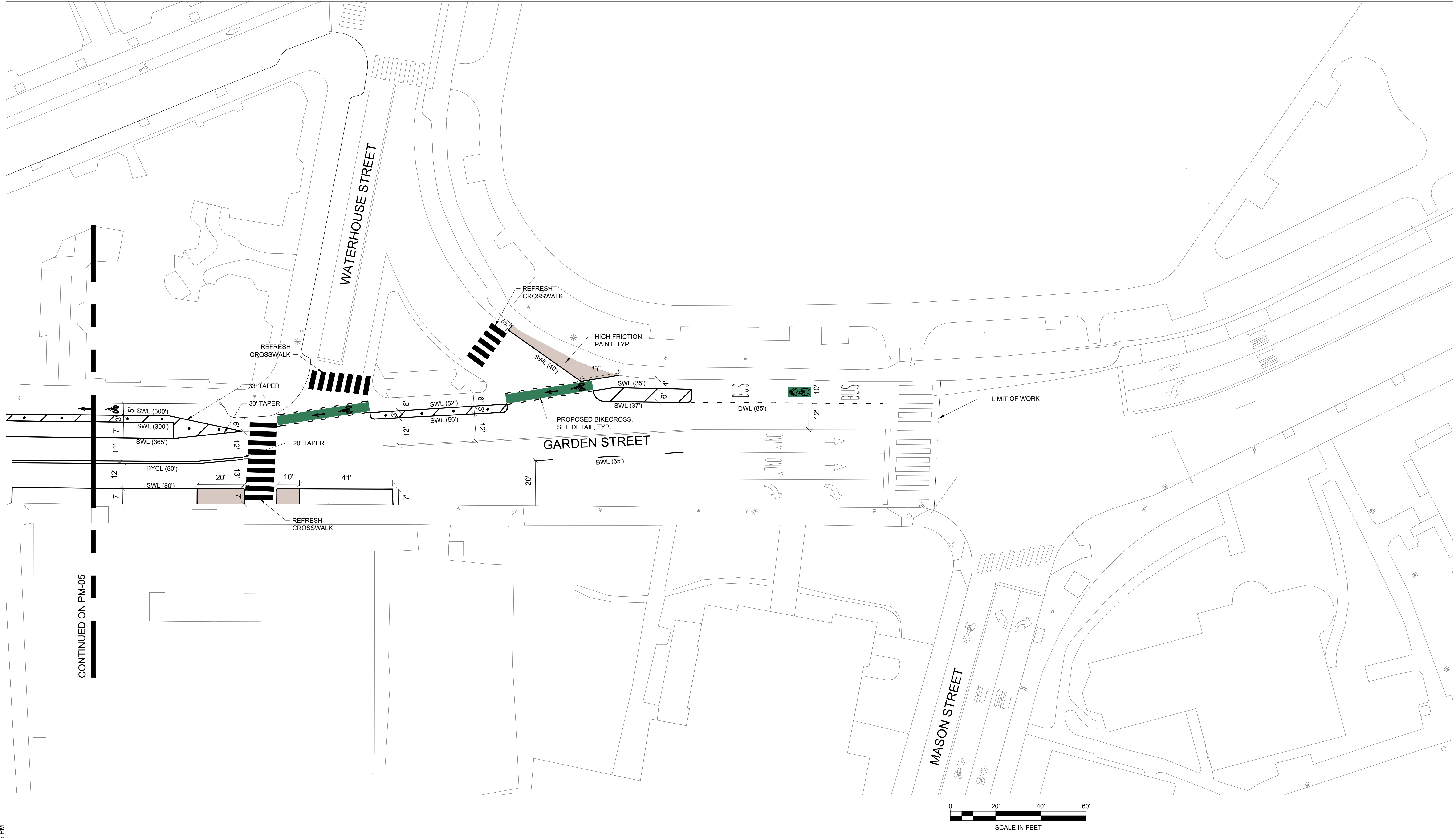

CONTINUED ON PM-05

**PROFESSIONAL CERTIFICATION**

I HEREBY CERTIFY THAT THESE PLANS WERE PREPARED OR APPROVED BY ME, AND THAT I AM A DULY LICENSED PROFESSIONAL ENGINEER UNDER THE LAWS OF THE STATE OF [STATE].  
LICENSE NO. \_\_\_\_\_  
EXPIRATION DATE: \_\_\_\_\_



**REUSE OF DOCUMENTS**  
ALL DRAWINGS ARE INSTRUMENTS OF PROFESSIONAL SERVICE FOR THIS PROJECT. REUSE OR ALTERATION IS AT THE USER'S SOLE RISK.

DSGN	HS						
DR	HS						
CHK	MLD						
APVD	MLD	NO.	DATE	REVISION	BY	APVD	

TOOLE  
DESIGN

2 OLIVER STREET, SUITE 305  
BOSTON, MA 02109  
PHONE: 617.619.9910  
www.tooledesign.com

GARDEN STREET FROM HURON AVENUE TO MASON STREET - SEPARATED BICYCLE LANES  
CITY OF CAMBRIDGE  
COMMONWEALTH OF MASSACHUSETTS

PAVEMENT MARKING PLAN

SHEET 6 OF 6

PROJECT NO.	6085.07
DATE	10/21/2022
DRAWING NO.	PM-06
SHEET NO.	17 OF 30