

STA. 601+00 TO STA. 620+00  
SCALE: NTS

- NOTES:**
- CONTRACTOR SHALL MAINTAIN EXISTING UTILITY COVERS AND CASTINGS TO ALL INTERMEDIATE AND FINAL GRADES. CONTRACTOR TO COORDINATE WITH RESPECTIVE UTILITY COMPANIES FOR GAS/TELECOMMUNICATIONS/ELECTRIC.
  - ALL VERTICAL GRANITE CURBING WITHIN WORK LIMITS SHALL BE REMOVED AND RESET UNLESS OTHERWISE NOTED. DAMAGES OR DISLOCATING OF FEATURES AT BACK OF SIDEWALK SHALL BE REPAIRED/REPLACED AT NO ADDITIONAL COST TO THE PRIVATE PROPERTY OWNER OR CITY OF CAMBRIDGE.
  - AT LOCATIONS WITH EXISTING TREES TO REMAIN, CONTRACTOR SHALL MAINTAIN 8'-0" MINIMUM WIDE SIDEWALK BETWEEN TREE PIT DEPRESSIONS UNLESS SHOWN OTHERWISE ON THE PLANS. AT LOCATIONS WITH PROPOSED OR REPLACED TREES, 4'-0" MINIMUM WIDE SIDEWALK SHALL BE PROVIDED BETWEEN TREE PIT AND BACK OF SIDEWALK.
  - CONTRACTOR TO ADJUST TREE PIT OPENINGS AS NECESSARY TO MAINTAIN A MINIMUM AREA OF 20 SF.
  - ALL EXISTING TREES AND SHRUBS SHALL BE RETAINED UNLESS OTHERWISE NOTED.
  - ALL EXISTING FEATURES AT BACK OF SIDEWALK SHALL REMAIN IN PLACE UNLESS OTHERWISE NOTED. DAMAGES OR DISLOCATING OF FEATURES AT BACK OF SIDEWALK SHALL BE REPAIRED/REPLACED AT NO ADDITIONAL COST TO THE PRIVATE PROPERTY OWNER OR CITY OF CAMBRIDGE.
  - CONTRACTOR SHALL MATCH THE EXISTING ROADWAY PAVEMENT GRADE AT THE LIMIT OF PROPOSED PAVEMENT MILLING AND OVERLAY. THE JOINT BETWEEN EXISTING AND PROPOSED PAVEMENT SHALL BE TREATED WITH PAVEMENT SEALANT AND NOT POURED RUBBERIZED ASPHALT SEALER.
  - ALL EXISTING SIGN POSTS SHALL BE REMOVED AND REPLACED UNLESS OTHERWISE NOTED. ALL PROPOSED SIGNS SHALL BE LOCATED A LATERAL CLEARANCE OF 1' FROM THE BACK OF THE CURB BUT NOT LESS THAN 4' FROM THE BACK OF SIDEWALK.
  - AT EXISTING TREE LOCATIONS WITH LARGE, MATURE TREES, APPROXIMATE LIMITS OF FLEXPAYE ARE INDICATED ON THE PLANS. CONTRACTOR SHALL MAINTAIN THE EXISTING SIDEWALK AND REVIEW OF ROOT LOCATIONS IN CAMBRIDGE UPON THE REMOVAL OF THE EXISTING SIDEWALK AND REVIEW OF ROOT LOCATIONS.
  - CONTRACTOR SHALL NOT PERFORM ANY WORK ON PRIVATE PROPERTY UNTIL A SIGNED RIGHT OF ENTRY (ROE) IS RECEIVED FROM THE PROPERTY OWNER. THE CONTRACTOR IS RESPONSIBLE FOR COORDINATING ROE WITH THE PROPERTY OWNER.
  - CONTRACTOR SHALL MATCH EXISTING GRADE AT BACK OF SIDEWALK LIMITS. REVIEW OF ALL SIDEWALK FORMS SHALL BE COORDINATED WITH THE ENGINEER PRIOR TO PLACEMENT FOR LOCATIONS WHERE PRIVATE PROPERTY RESTORATION IS REQUIRED TO MEET DRAINAGE REQUIREMENTS AND BACK OF SIDEWALK GRADE. ALL PRIVATE PROPERTY RESTORATION WORK SHALL BE COORDINATED WITH THE PRIVATE PROPERTY OWNER AND ENGINEER PRIOR TO THE START OF WORK.

ISSUED FOR BID

City of Cambridge, Massachusetts		Sheet	R-15
Chapter 90 Contract 25		Project	11393
Roadway Improvement Project		Drawing	
Sciarappa Street - Construction Plan		File No.	
Sta 600+00 to 606+00			
AS NOTED	AS NOTED	Date	
JANUARY 2024	JANUARY 2024	Job No.	2023106.020A
Designed by	JPP/FG	Drawn by	ALG/GLD
Checked by	PFB	No.	
Approved by	BMS	Description	REVISIONS





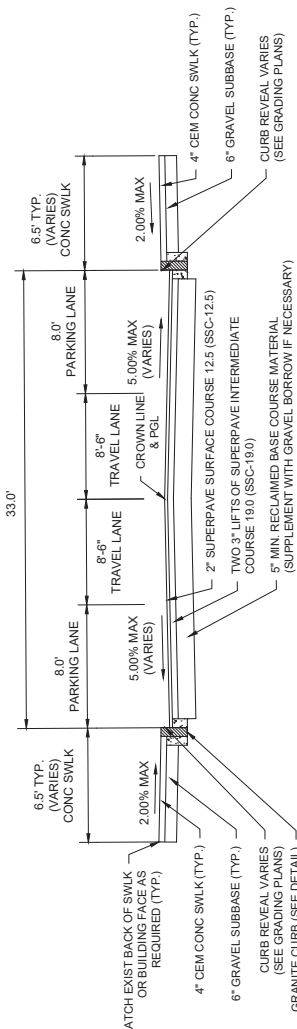
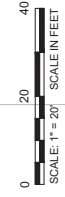
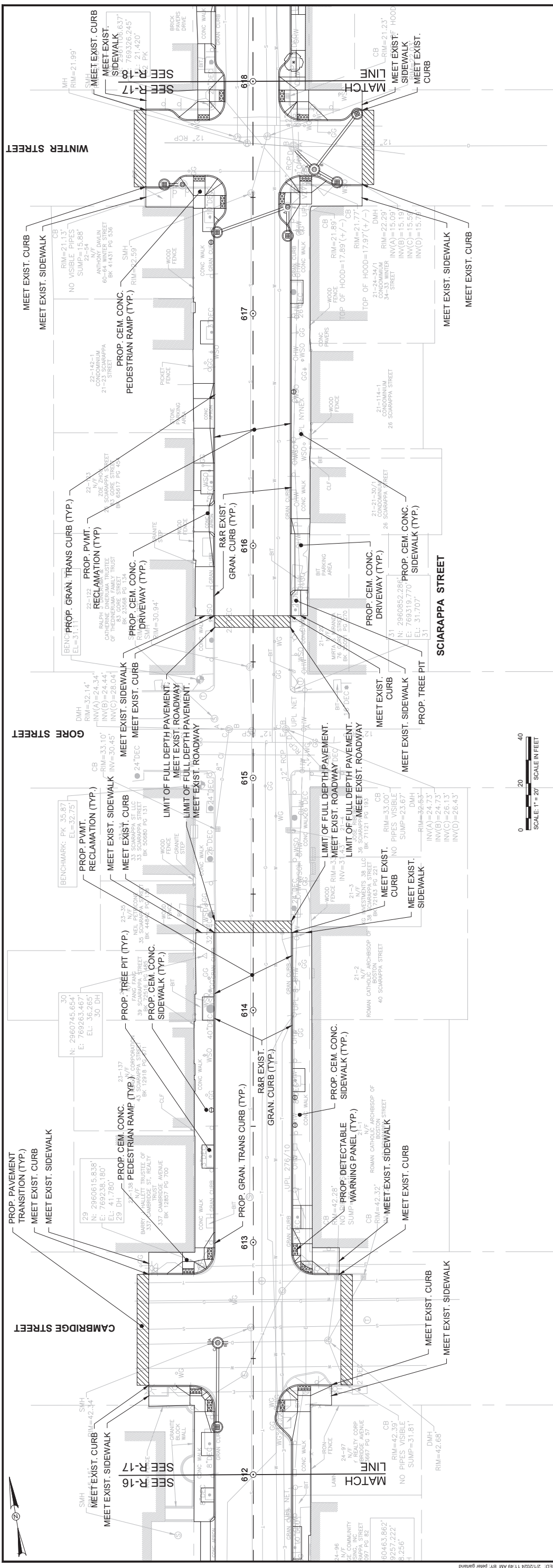

SCIARAPPA STREET  
STA. 601+00 TO STA. 620+00  
SCALE: NTS

- NOTES:**
- CONTRACTOR SHALL MAINTAIN EXISTING UTILITY COVERS AND CASTINGS TO ALL INTERMEDIATE AND FINAL GRADES. CONTRACTOR TO COORDINATE WITH RESPECTIVE UTILITY COMPANIES FOR GAS/TELECOMMUNICATIONS/ELECTRIC.
  - ALL VERTICAL GRANITE CURBING WITHIN WORK LIMITS SHALL BE REMOVED AND RESET UNLESS OTHERWISE NOTED. DAMAGES OR DISLOCATING OF FEATURES AT BACK OF SIDEWALK SHALL BE REPAIRED/REPLACED AT NO ADDITIONAL COST TO THE PRIVATE PROPERTY OWNER OR CITY OF CAMBRIDGE.
  - AT LOCATIONS WITH EXISTING TREES TO REMAIN, CONTRACTOR SHALL MAINTAIN 8" MINIMUM WIDE SIDEWALK BETWEEN TREE PIT OR DETECTABLE PANEL UNLESS SHOWN OTHERWISE ON THE PLANS. AT LOCATIONS WITH PROPOSED OR REPLACED TREES, 4'-0" MINIMUM WIDE SIDEWALK SHALL BE PROVIDED BETWEEN TREE PIT AND BACK OF SIDEWALK.
  - CONTRACTOR TO ADJUST TREE PIT OPENINGS AS NECESSARY TO MAINTAIN A MINIMUM AREA OF 20 SF.
  - ALL EXISTING TREES AND SHRUBS SHALL BE RETAINED UNLESS OTHERWISE NOTED.
  - ALL EXISTING FEATURES AT BACK OF SIDEWALK SHALL REMAIN IN PLACE UNLESS OTHERWISE NOTED. DAMAGES OR DISLOCATING OF FEATURES AT BACK OF SIDEWALK SHALL BE REPAIRED/REPLACED AT NO ADDITIONAL COST TO THE PRIVATE PROPERTY OWNER OR CITY OF CAMBRIDGE.
  - CONTRACTOR SHALL MATCH THE EXISTING ROADWAY PAVEMENT GRADE AT THE LIMIT OF PROPOSED PAVEMENT MILLING AND OVERLAY. THE JOINT BETWEEN EXISTING AND PROPOSED PAVEMENT SHALL BE TREATED WITH PAVEMENT SEALANT AND NOT POURED RUBBERIZED ASPHALT SEALER.
  - ALL EXISTING SIGN POSTS SHALL BE REMOVED AND REPLACED UNLESS OTHERWISE NOTED. ALL PROPOSED SIGNS SHALL BE LOCATED A LATERAL CLEARANCE OF 1' FROM THE BACK OF THE CURB BUT NOT LESS THAN 4' FROM THE BACK OF SIDEWALK.
  - AT EXISTING TREE LOCATIONS WITH LARGE, MATURE TREES, APPROXIMATE LIMITS OF FLEXURE ARE INDICATED ON THE PLANS. CONTRACTOR SHALL MAINTAIN THESE LIMITS THROUGHOUT THE PROJECT. THE OWNER AND CITY OF CAMBRIDGE UPON THE REMOVAL OF THE EXISTING SIDEWALK AND REVIEW OF ROOT LOCATIONS.
  - CONTRACTOR SHALL NOT PERFORM ANY WORK ON PRIVATE PROPERTY UNTIL A SIGNED RIGHT OF ENTRY (ROE) IS RECEIVED FROM THE PROPERTY OWNER. THE CONTRACTOR IS RESPONSIBLE FOR COORDINATING ROE WITH THE PROPERTY OWNER.
  - CONTRACTOR SHALL MATCH EXISTING GRADE AT BACK OF SIDEWALK LIMITS. REVIEW OF ALL SIDEWALK FORMS SHALL BE COORDINATED WITH THE ENGINEER PRIOR TO PLACEMENT OF CONCRETE FOR LOCATIONS WHERE PRIVATE PROPERTY RESTORATION IS REQUIRED TO MEET DRAINAGE REQUIREMENTS AND BACK OF SIDEWALK GRADE. ALL PRIVATE PROPERTY RESTORATION WORK SHALL BE COORDINATED WITH THE PRIVATE PROPERTY OWNER AND ENGINEER PRIOR TO THE START OF WORK.

ISSUED FOR BID

City of Cambridge, Massachusetts		Sheet	R-17
Chapter 90 Contract 25		Project	11393
Roadway Improvement Project		File No.	
Sciarrappa Street - Construction Plan		Drawing	
Sta 612+00 to 618+00			
AS NOTED	DATE	DESCRIPTION	DATE
	JANUARY 2024		
	2023108.020A		
	JPP/PG		
	ALG/GLD		
	PFB		
	BMS		



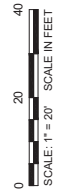
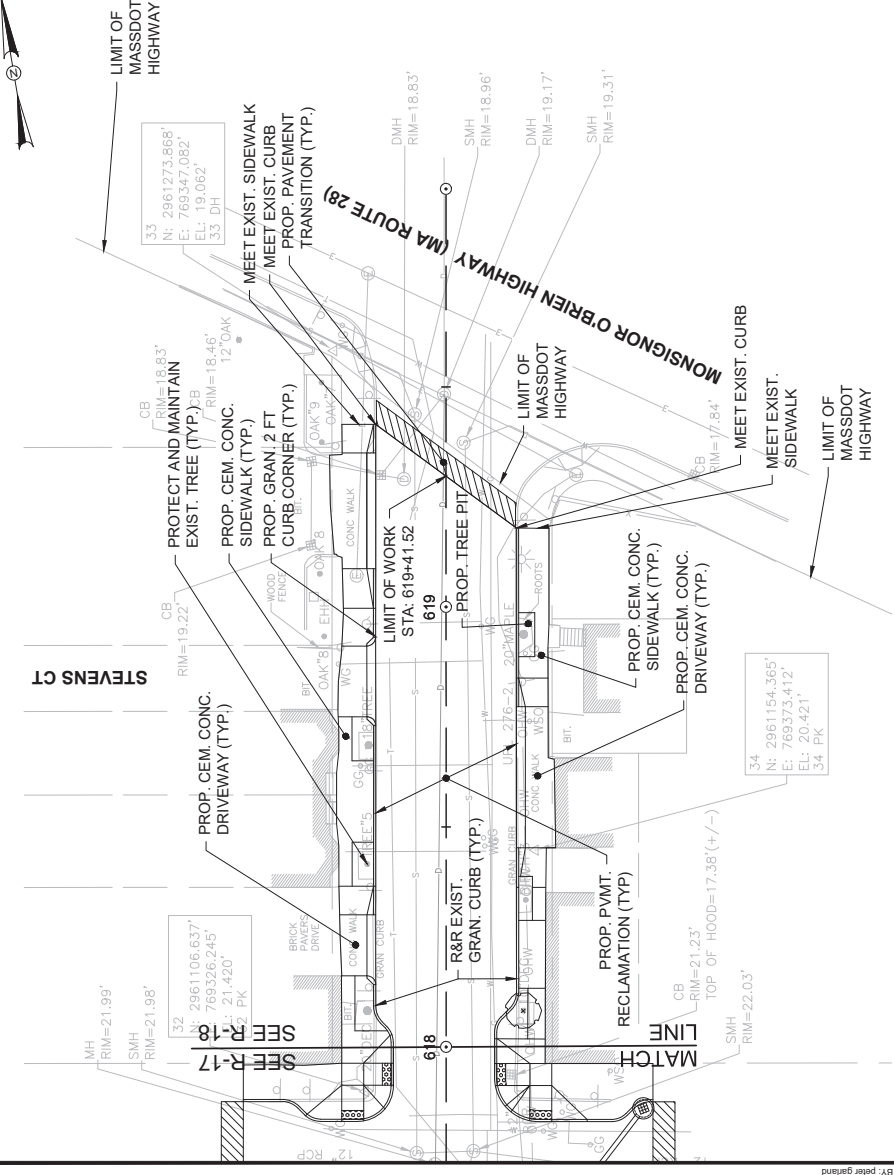

**NOTES:**

- CONTRACTOR SHALL ADJUST EXISTING UTILITY COVERS AND CASTINGS TO ALL INTERM AND FINAL GRADES. CONTRACTOR TO COORDINATE WITH RESPECTIVE UTILITY COMPANIES FOR GAS/TELECOMM/ABLEELECTRIC.
- ALL VERTICAL GRANITE CURBING WITHIN WORK LIMITS SHALL BE REMOVED AND RESET UNLESS OTHERWISE NOTED. GRANITE CURBING TO BE REINSTALLED TO ORIGINAL GRADE UNLESS OTHERWISE NOTED.
- AT LOCATIONS WITH EXISTING TREES TO REMAIN, CONTRACTOR SHALL MAINTAIN 8" MINIMUM WIDE SIDEWALK BETWEEN TREE PIT AND CURB UNLESS SHOWN OTHERWISE ON THE PLANS. AT LOCATIONS WITH PROPOSED OR REPLACED TREES, 4'-0" MINIMUM WIDE SIDEWALK SHALL BE PROVIDED BETWEEN TREE PIT AND BACK OF SIDEWALK.
- CONTRACTOR TO ADJUST TREE PIT OPENINGS AS NECESSARY TO MAINTAIN A MINIMUM AREA OF 20 SF.
- ALL EXISTING TREES AND SHRUBS SHALL BE RETAINED UNLESS OTHERWISE NOTED.
- ALL EXISTING FEATURES AT BACK OF SIDEWALK SHALL REMAIN IN PLACE UNLESS OTHERWISE NOTED. DAMAGES OR DISLOCATING FEATURES AT BACK OF SIDEWALK SHALL BE REPAIRED/REPLACED AT NO ADDITIONAL COST TO THE PRIVATE PROPERTY OWNER OR CITY OF CAMBRIDGE.
- CONTRACTOR SHALL MATCH THE EXISTING ROADWAY PAVEMENT GRADE AT THE LIMIT OF PROPOSED PAVEMENT MILLING AND OVERLAY. THE JOINT BETWEEN EXISTING AND PROPOSED PAVEMENT SHALL BE TREATED WITH PAVEMENT SEALANT AND NOT POURED RUBBERIZED ASPHALT SEALER.
- ALL EXISTING SIGN POSTS SHALL BE REMOVED AND REPLACED UNLESS OTHERWISE NOTED. ALL PROPOSED SIGNS SHALL BE LOCATED A LATERAL CLEARANCE OF 1' FROM THE BACK OF THE CURB BUT NOT LESS THAN 4' FROM THE BACK OF SIDEWALK.
- AT EXISTING TREE LOCATIONS WITH LARGE, MATURE ROOTS, APPROXIMATE LIMITS OF FLEW PAVEMENT ARE INDICATED ON THE PLANS. CONTRACTOR SHALL MAINTAIN THESE LIMITS THROUGHOUT THE PROJECT. THE OWNER AND CITY OF CAMBRIDGE UPON THE REMOVAL OF THE EXISTING SIDEWALK AND REVIEW OF ROOT LOCATIONS.
- CONTRACTOR SHALL NOT PERFORM ANY WORK ON PRIVATE PROPERTY UNTIL A SIGNED RIGHT OF ENTRY (ROE) IS RECEIVED FROM THE PROPERTY OWNER. THE CONTRACTOR IS RESPONSIBLE FOR COORDINATING ROE WITH THE PROPERTY OWNER.
- CONTRACTOR SHALL MATCH EXISTING GRADE AT BACK OF SIDEWALK LIMITS. REVIEW OF ALL SIDEWALK FORMS SHALL BE COORDINATED WITH THE ENGINEER PRIOR TO PLACEMENT OF CONCRETE FOR LOCATIONS WHERE PRIVATE PROPERTY RESTORATION IS REQUIRED TO MEET DRAINAGE REQUIREMENTS AND BACK OF SIDEWALK GRADE. ALL PRIVATE PROPERTY RESTORATION WORK SHALL BE COORDINATED WITH THE PRIVATE PROPERTY OWNER AND ENGINEER PRIOR TO THE START OF WORK.

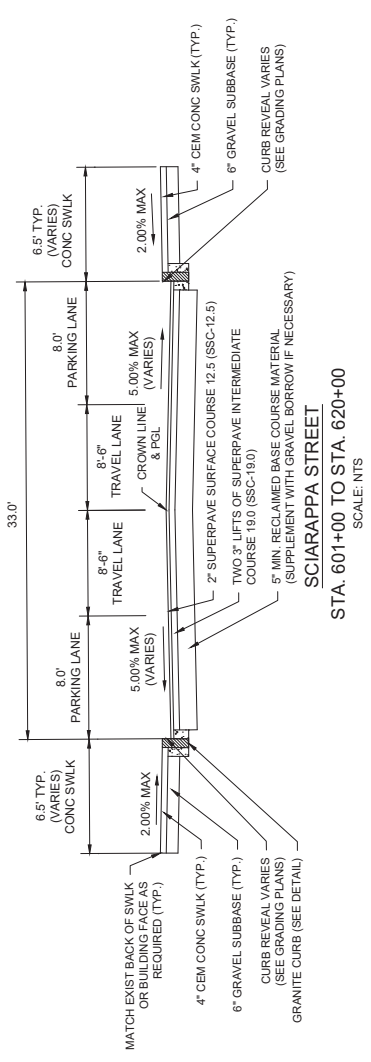

STA. 601+00 TO STA. 620+00  
SCALE: NTS

ISSUED FOR BID

		Client <b>CITY OF CAMBRIDGE, MASSACHUSETTS</b>	Sheet <b>R-18</b>
Project <b>CHAPTER 90 CONTRACT 25 ROADWAY IMPROVEMENT PROJECT</b>		File No. <b>11393</b>	
Drawing <b>SCIARAPPA STREET - CONSTRUCTION PLAN STA 618+00 TO 620+00</b>			
AS NOTED Date <b>JANUARY 2024</b>	Job No. <b>2023108.020A</b>	Designed by <b>JPP/FG</b>	
Drawn by <b>AJZ/GLD</b>	Checked by <b>PFB</b>	No. <b>BMS</b>	Date 
Approved by 		Description <b>REVISIONS</b>	

