



Lesley
UNIVERSITY



Town Gown
Planning Board
February 4, 2020

2019 Town Gown

- Campus Overview
- Projects by Campus
- Sustainability
- Cambridge Partnerships



Campus Overview

- 3 Cambridge campuses
- 10 minutes apart by foot
- Shuttles run between each campus

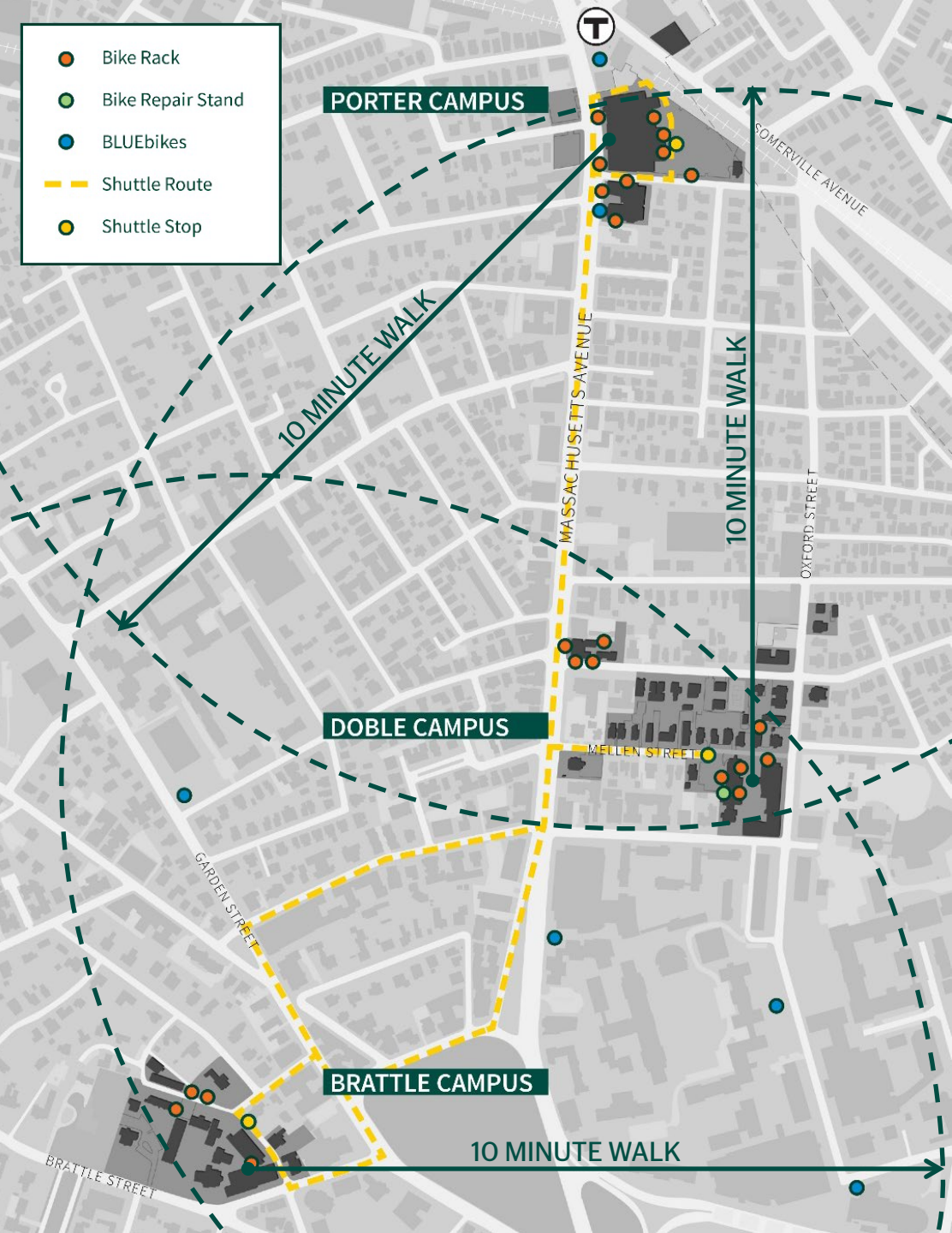

Campus Overview

Lesley Profile – 2019

- 60 buildings
- 14 offsite locations
 - 6 within MA
 - 8 outside MA



Campus Overview

Lesley Profile – 2019

Students	
Undergraduate	1,927
Graduate	1,980
Non-degree	2,472
Dormitory Beds	864

Faculty & Staff	
Faculty	171
Staff	363



Campus Overview

Equity & Inclusion

- Expanding need-based, as opposed to merely merit based, scholarship system
- Installation of all gender restrooms and signs
- Food Pantry
- 34% of UG students POC (increasing, 40% freshmen POC)
- 45% of freshmen 1st generation to college



Campus Overview

Strategic Plan

Five Pillars:

- Everything we do is about our students and their success
- Educating new audiences in new fields in new ways
- Diversity, equity and inclusion are core university values
- Sustained impact on our students and the world through innovation and interdisciplinary work
- Enabling connectedness internally and externally



Campus Overview

Planning Efforts

- Campus Plan
 - Develop & refine strategies to realize 2030 vision
 - Facilities/campus strategy
 - Align real estate strategies with institutional goals
- Athletics & Recreation Space
- Brattle Campus Development
- Investment in Infrastructure & Maintenance
 - Elevator and mechanical system replacements
 - Exterior envelope improvements (new roofs, windows, etc.)



Projects By Campus

PORTER CAMPUS

DOBLE CAMPUS

BRATTLE CAMPUS

#

Completed

1. 4 Berkeley Street
2. 5 Phillips Heating
3. ADA Repairs/Ramps
4. Amphitheater Steps
5. Burnham Hall
6. Roof Replacements
7. Security Desk
8. Washburn Dining

#

In Construction

9. 6 St. John's Kitchen
10. Brattle Shuttle Shelter
11. Sherrill Hall, Library Phase 1

#

In Planning

12. Brattle Campus Development
13. Doble Hall Elevator & Interior Renovations
14. Roof Replacements
15. Sherrill Hall, Phase 2
16. Wolfard Hall Bathrooms

PORTER CAMPUS

DOBLE CAMPUS

BRATTLE CAMPUS

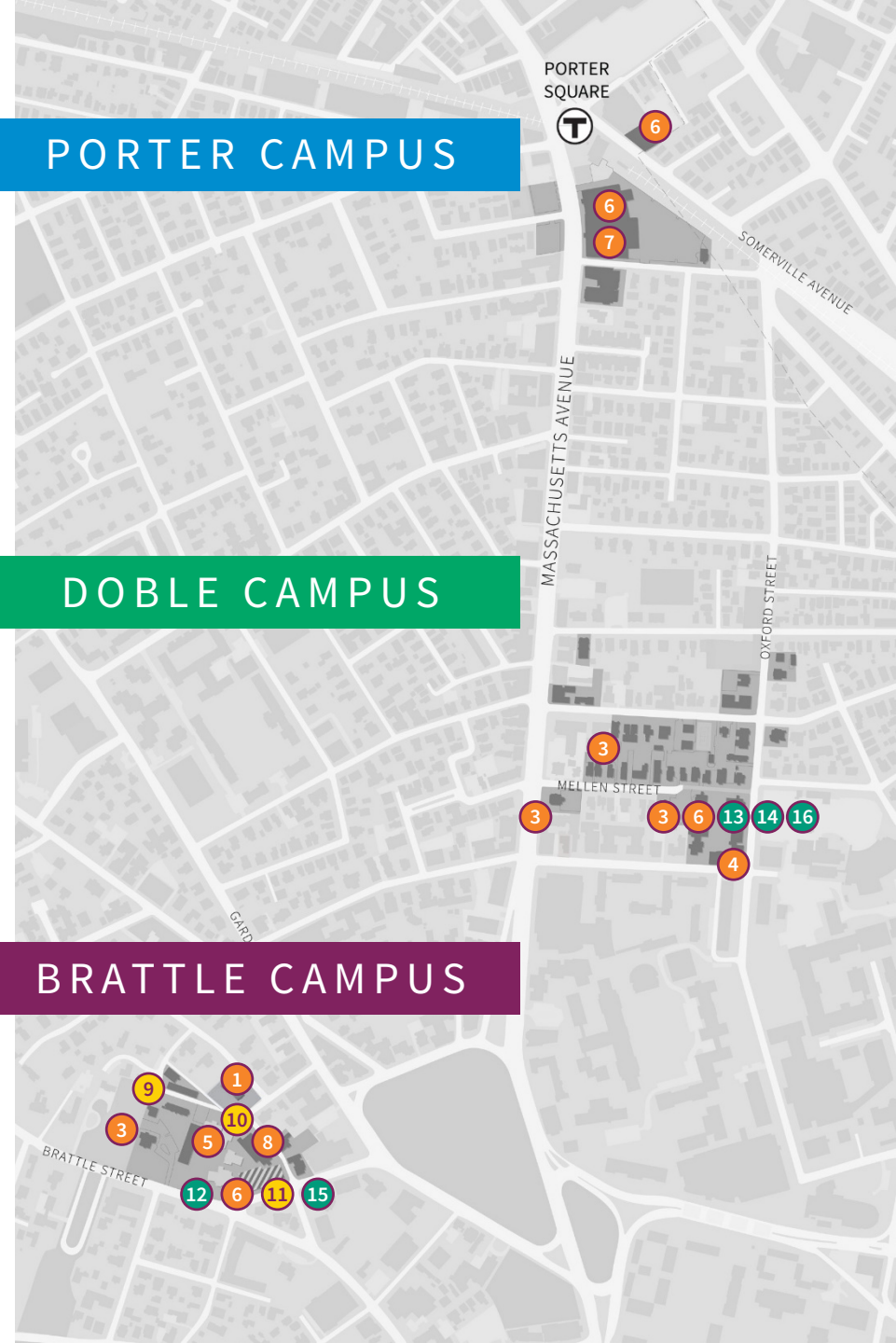

Porter Campus



- COMPLETED
- 6. Roof Replacements
- 7. Security Desk

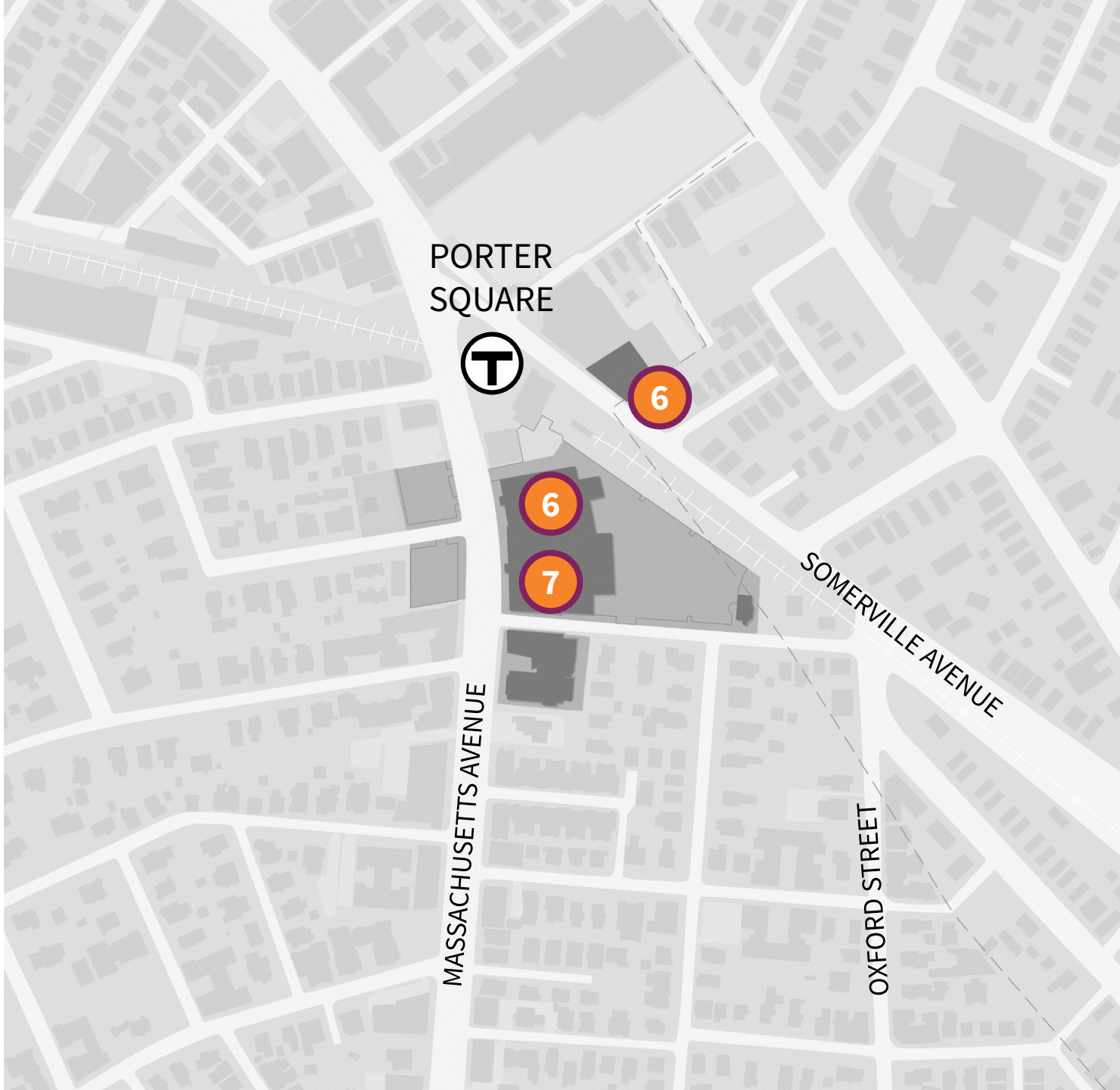

Doble Campus

COMPLETED

- 3. ADA Repairs
- 4. Amphitheater Steps
- 6. Roof Replacements

IN PLANNING

- 13. Doble Hall Elevator and Interior Renovations
- 14. Roof Replacements
- 16. East/West Public Bathrooms

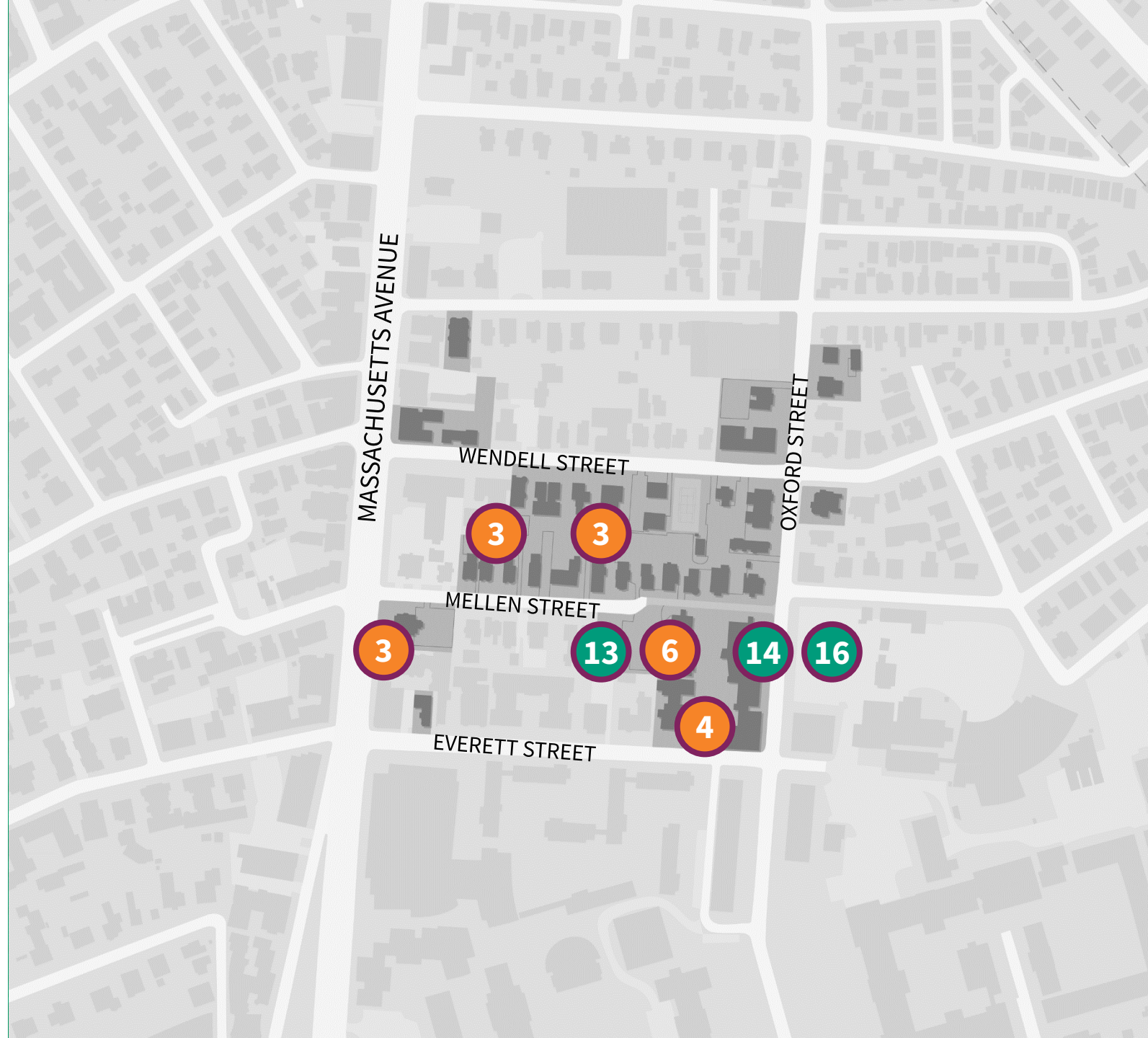

Brattle Projects

COMPLETED

1. 4 Berkeley Street
2. 5 Phillips Heating System
3. ADA Repairs/Ramps
5. Burnham Hall
6. Roof Replacements
8. Washburn Dining

IN CONSTRUCTION

9. 6 St. John's Kitchen
10. Brattle Shuttle Shelter
11. Sherrill Hall, Phase 1

IN PLANNING

12. Brattle Campus Development
15. Sherrill Hall, Phase 2

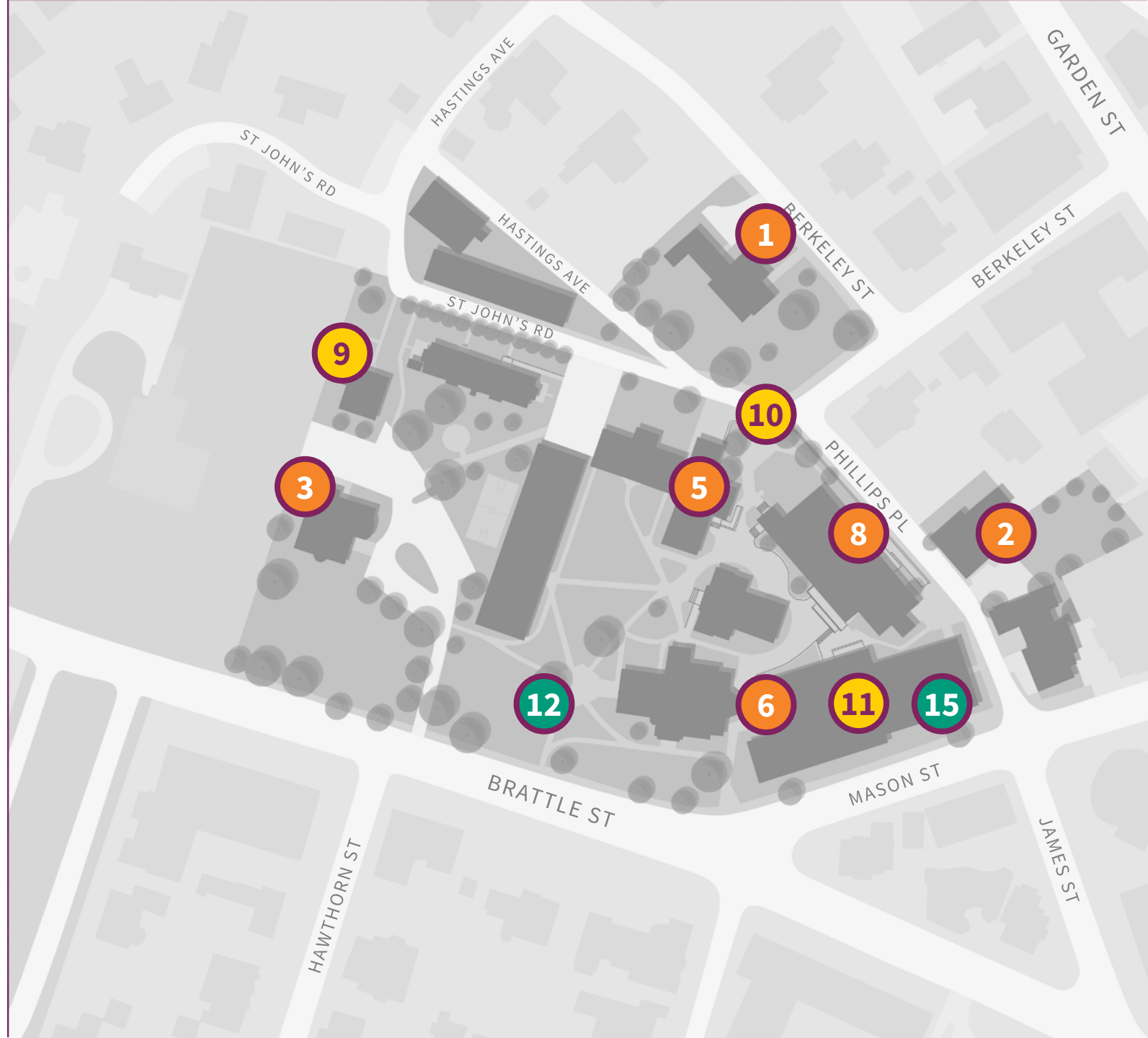

Brattle Campus



Brattle Campus

Building	Area (GSF)	Year Built
4 Berkeley	9,758	1852
St. John's Chapel	11,344	1868
Reed Hall	8,715	1875
Burnham Hall	9,652	1879, 1889
Wright Hall	6,380	1911
Sherrill Hall	51,938	1965



4 Berkeley President's House

- Roof and HVAC replacement
- Accessible entrance & restroom
- Interior finishes



Sherrill Hall Renovation

- Year-long planning and construction project
- Learning commons
- Divided into two phases
- Library renovation in first phase



Sherrill Hall Café

- Café replaced former circulation desk
- As books consolidated, reimagine library space as student meeting



Sherrill Hall Library Renovation



Sherrill Hall Library Renovation



Sherrill Hall Classrooms

- New furniture and finishes
- 2 models:
 - Adaptable
 - Fixed seating



Washburn Dining Hall



Washburn Dining Hall

- Expanded servery
- New lighting, finishes, furniture



Burnham Hall Tyler Room



- New ceiling
- Chandeliers
- Finishes



St. John's Chapel In Planning

- 11,344 SF
- Planning & Feasibility Study
- MCFF award
- Address restrooms, sprinklers, circulation with new use plan

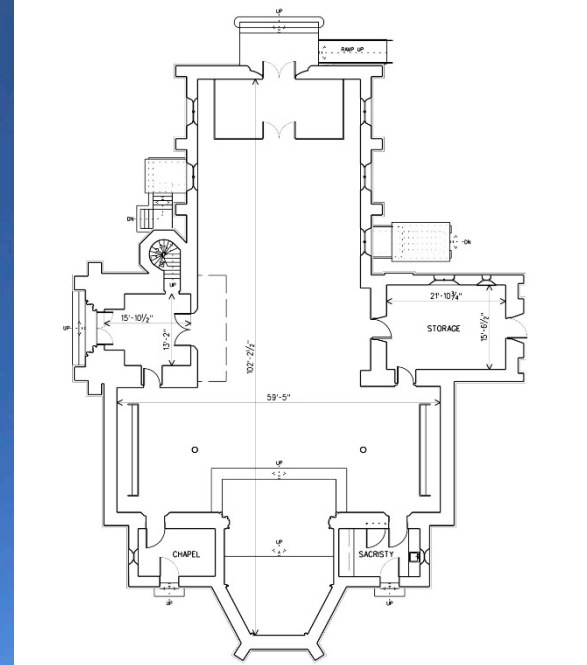

Sustainability

Greenhouse Gas Emissions

- Reduced GHG emissions by 72% despite 34% increase in campus square footage since 2006
- Signed new electric contract containing 100% Renewable Energy Certificates, effective fall 2018

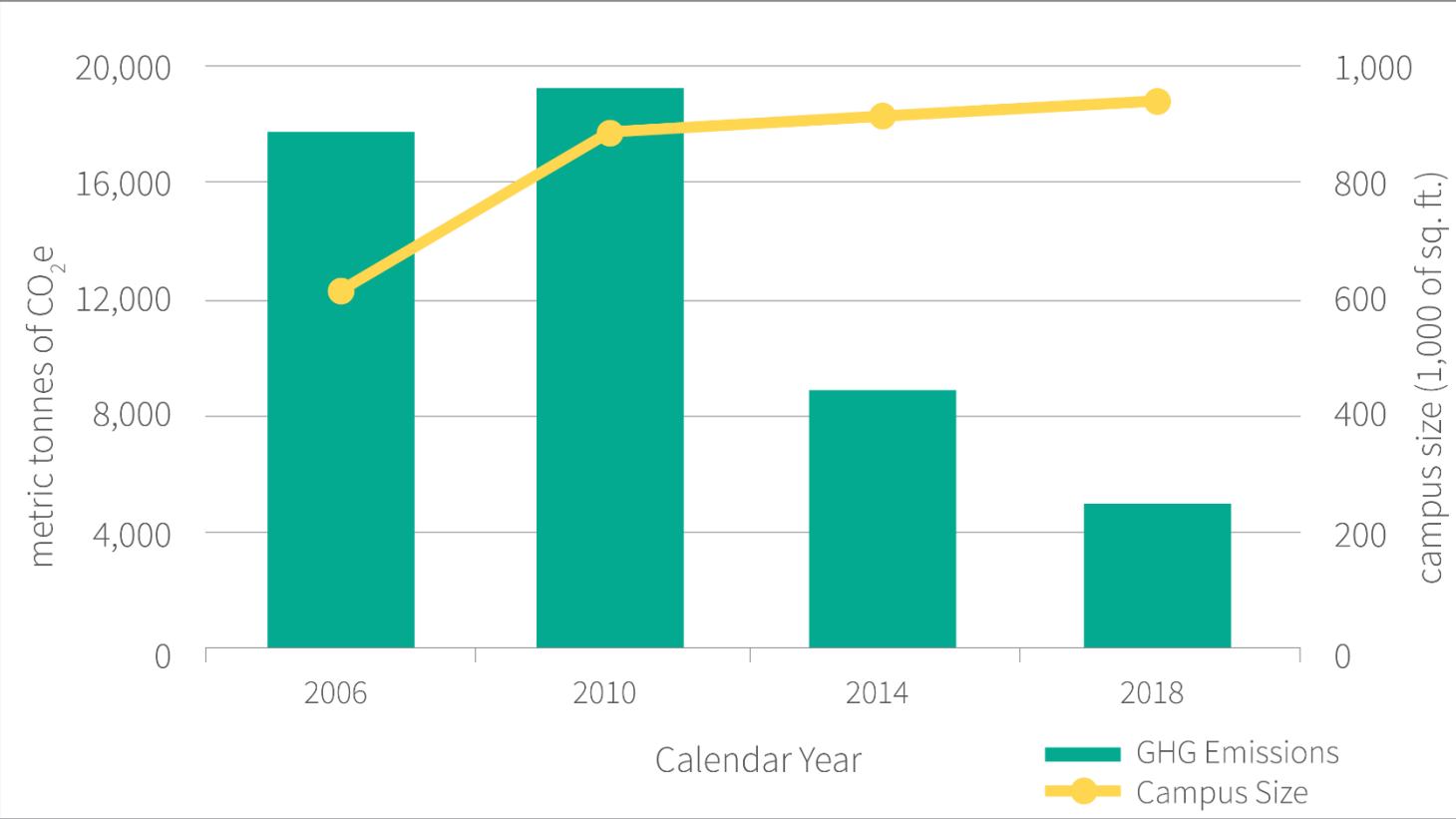

Sustainability

Waste Diversion

Goals

- 50% recycling rate
- Reduction in overall waste

Challenges

- Contaminated recycling
- Changes to acceptable materials

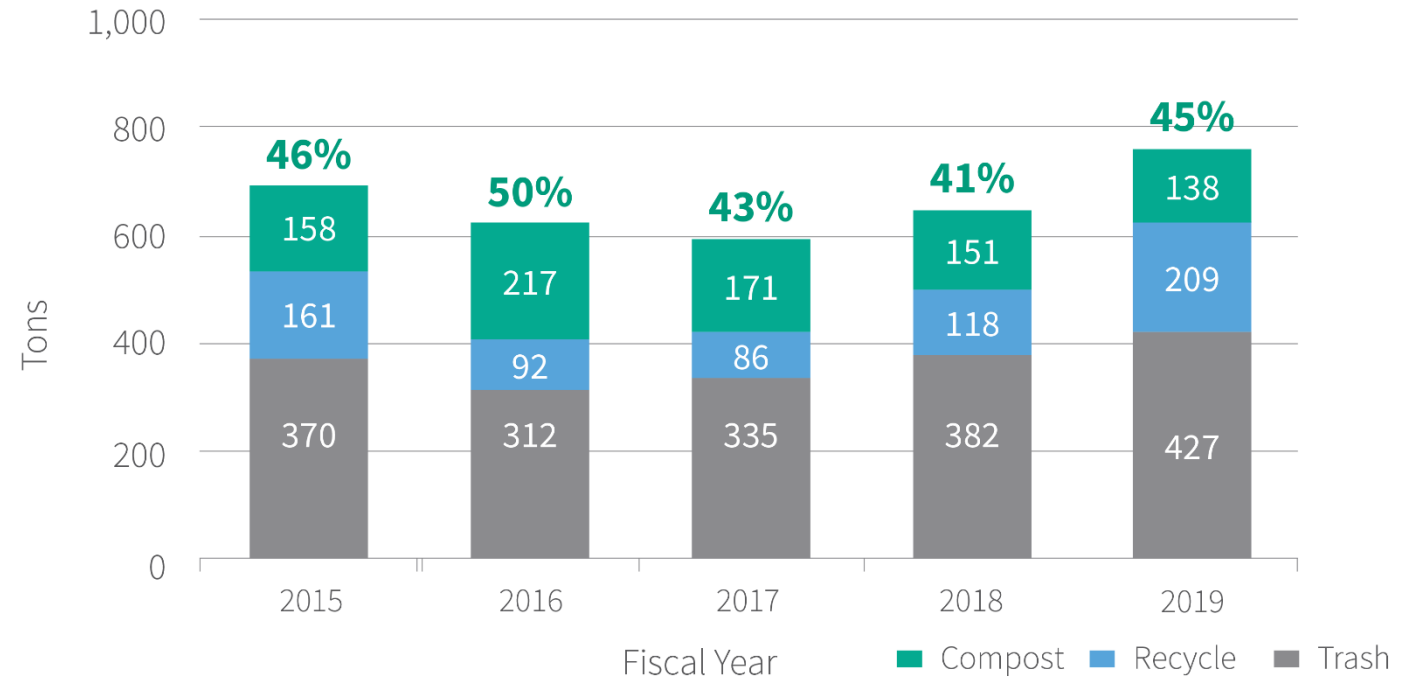

Sustainability

Transportation

- Bicycle amenities
 - 358 bicycle spaces
 - Bicycle repair station on Doble Campus
 - Blue Bikes Station at Lunder Arts Center
- 29% SOV (goal \leq 38%)
- 19% increase in shuttle use



Cambridge Partnerships

Lesley STEAM Learning Lab
play • make • create

- Professional development on “Making” & student-level experiences for CPSD/Lesley Summer Compass Program
- Participation in STEAM Community Events organized the City’s STEAM Coordinator, Sharlene Yang
- Participation in Cambridge Science Festival
- Appointment to STEAM Advisory Committee by City Manager & CPS Superintendent



Cambridge Partnerships

Lesley STEAM Learning Lab
play • make • create

- Biogen Foundation STAR Initiative Grantee: to provide STEM professional learning opportunities to Cambridge Public School District & Out-of-School Time Middle / High school educators
- Monthly Open Hours for Educators
- Foundry Consortium Member
- Chamber of Commerce Visionary Award



Cambridge Partnerships Cambridge Schools

- Partnership with CPSP, CAC and CCF to support Cambridge Creativity Commons
- Professional Development for CPSP Teachers in schools & at the university
- CPSP (administrators and educators) held 66 meetings in 113 classrooms, utilizing nearly 300 hours



Cambridge Partnerships

Urban Scholars Initiative

- Partnering with about 20 feeder organizations in Cambridge and Greater Boston area
- Addressing education gap and empowering disadvantaged students
- Intrusive & Holistic Coaching
- Students excel
 - Avg. GPA 3.0
 - 91.3% retention rate



Cambridge Partnerships Lesley Art + Design

- 50+ community partnerships
- Community Advisory Council meets quarterly with Dean and Dir. of Community Engagement
- Collaborative Workshops – free & low-cost art and design workshops to high schools & the general public
- Socially Engaged Art – public art & college course in partnership with local organizations and institutions
- College Pathways Scholarships – dual enrollment courses & college credit for talented, low-income high school students
- Open Lecture Series & Events – this year Massachusetts Independent Comics Expo (MICE) was in excess of 4,200 fans and visitors



thank you



Images Courtesy of Bruner/Cott,
Photo by Robert Benson

Town Gown
Planning Board
February 4, 2020