

City of Cambridge
Community Development Department

Joint Meeting of Bicycle and Pedestrian Committees

July 14, 2021

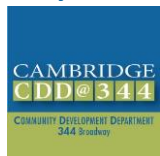

Meeting Agenda

1. Zoom meeting protocols
2. MXD Substation Bike Valet
3. Public Comment
4. City Updates
5. Grand Junction Path
6. Development Projects
7. Public Comment
8. Other Updates and Announcements

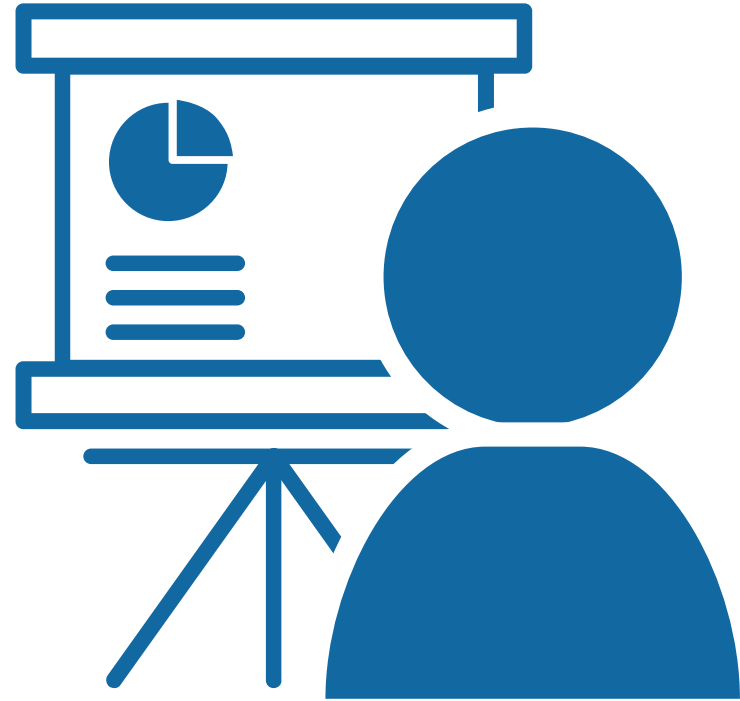

Committee Member Instructions

- Committee members may speak and show webcam video
- Use "Raise Hand" button to help manage discussion
 - Located at the bottom of the Participants panel (See A1-2 below) OR at the bottom of the screen (see B below)
 - *9 to Raise Hand by phone
- Please stay muted unless speaking
 - *6 to mute/unmute by phone

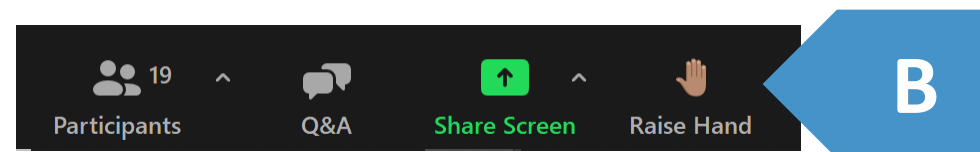
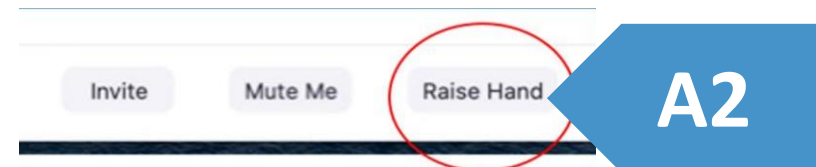
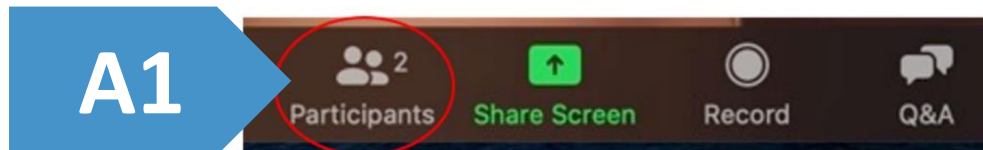

Public Comment Instructions

- Members of the public are muted and cannot show webcam video
- Public can write questions or ask for assistance in Q&A window at any time
 - Questions may be submitted at any time and will be addressed as time allows, during discussion/comment periods
- During the Public Comment period, use the "Raise Hand" button to signal you have a question/comment. A staff member will then enable you to unmute yourself and you will have 3 minutes to speak.
 - *9 to Raise Hand by phone
 - *6 to Mute/Unmute by phone
- Please be respectful! Participants will be removed for inappropriate behavior

Bottom Panel of
Zoom Screen

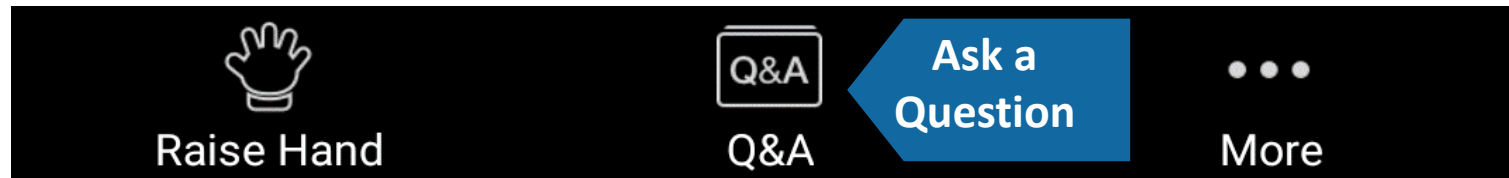



Joint Committee Minutes



Pedestrian Committee Minutes



Public comment

Public Comment Instructions

- Use the "Raise Hand" button to signal you have a question/comment. A staff member will then enable you to unmute yourself.
 - *9 to Raise Hand by phone
 - *6 to Mute/Unmute by phone
- Questions can also be submitted using the Q&A button.

Bottom Panel of
Zoom Screen

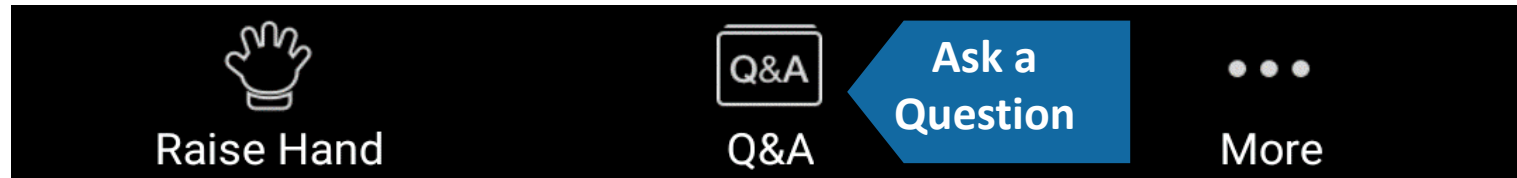



MXD Substation Bike Valet Proposal

MXD Substation Proposal

Bicycle & Pedestrian Committee Meeting

2021 07 14

Outline



[1] Project background

[2] Introductions + proposed bicycle parking plan

[3] Discussion



LINDEN PARK
NEIGHBORHOOD

EAST CAMBRIDGE
NEIGHBORHOOD

KENNEDY-
LONGFELLOW SCHOOL

FULKERSON STREET

BINNEY STREET

NORTH PARCEL

VOLPE
DEVELOPMENT

PORTLAND STREET

GALILEO GALILEI WAY

BROADWAY

THIRD STREET

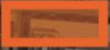

EVERSOURCE FULKERSON

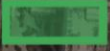

BINNEY STREET PARK



NORTH PARCEL BLUE GARAGE SITE

bxp Boston
Properties

PICKARD CHILTON

Project background

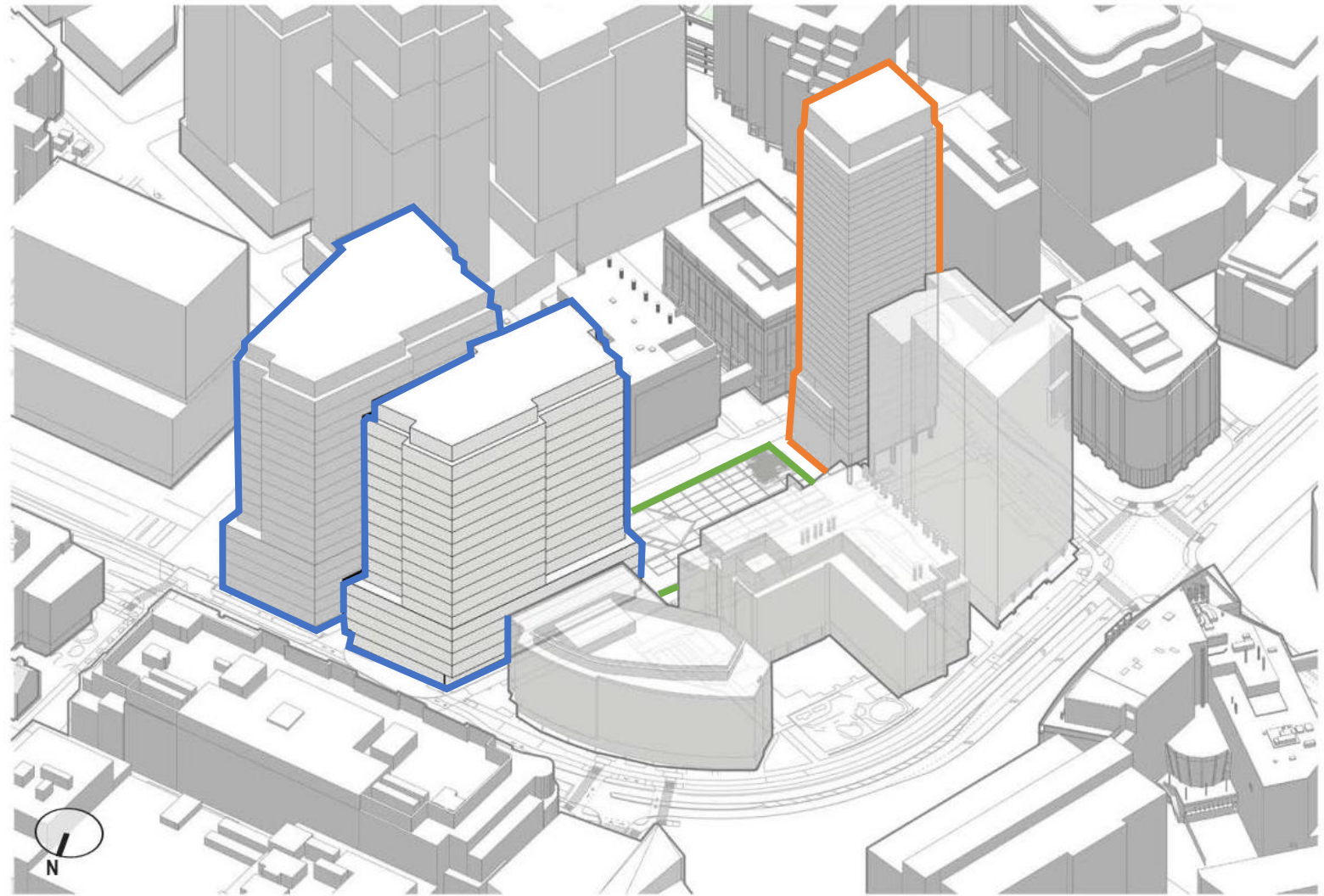

— Commercial — Residential — Plaza/Substation

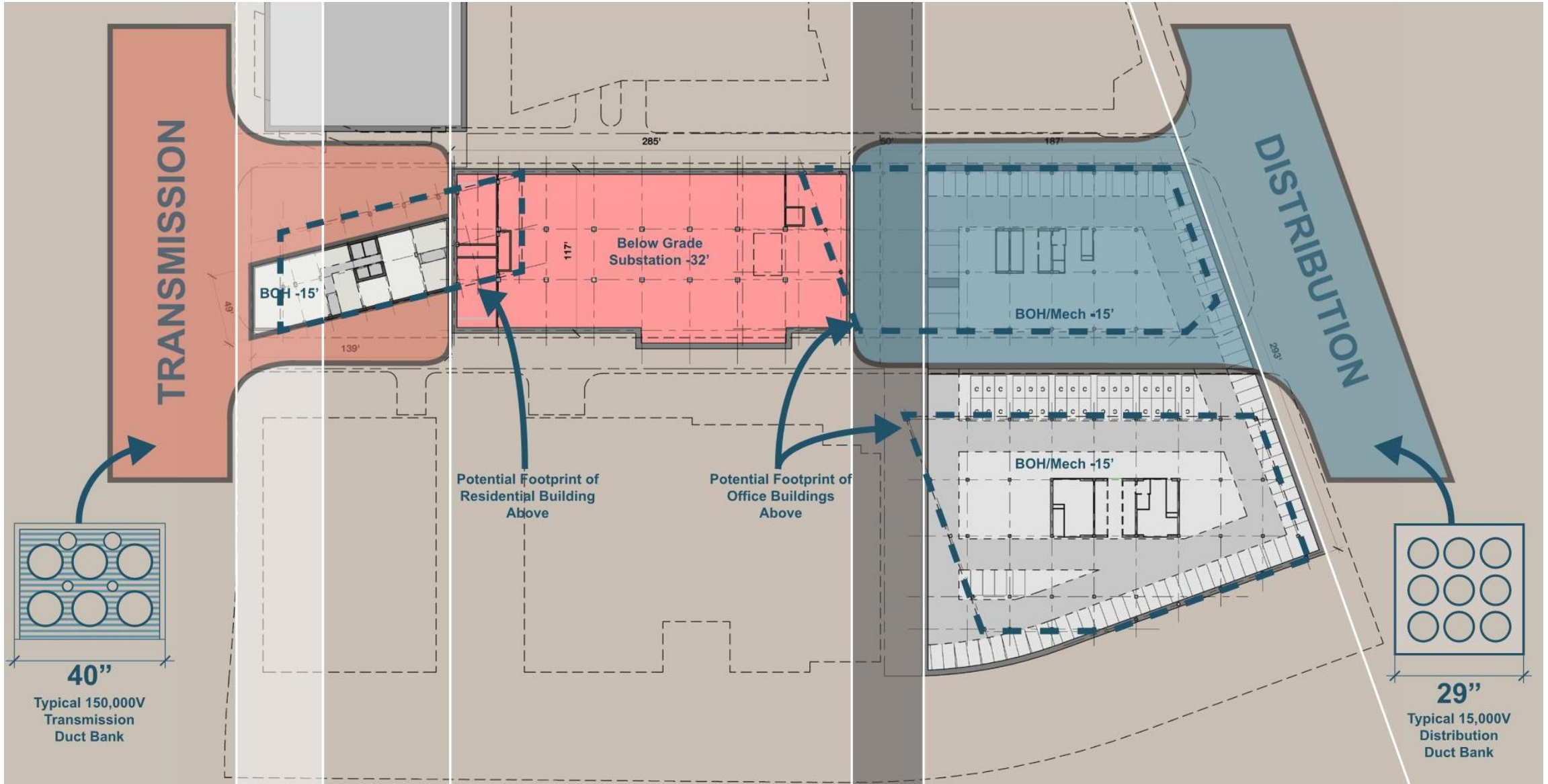

TRANSMISSION

DISTRIBUTION

Below Grade Substation -32'

BOH -15'

BOH/Mech -15'

BOH/Mech -15'

Potential Footprint of Residential Building Above

Potential Footprint of Office Buildings Above

40"

Typical 150,000V Transmission Duct Bank

29"

Typical 15,000V Distribution Duct Bank

Project background

- Commercial buildings not fully developed at this stage
- Nonetheless, scarcity of ground floor space evident in concept
- Retail/bicycle parking competing for same space
- Phased delivery between west and east buildings

*zoning required: approximately 688 LT / 101 ST

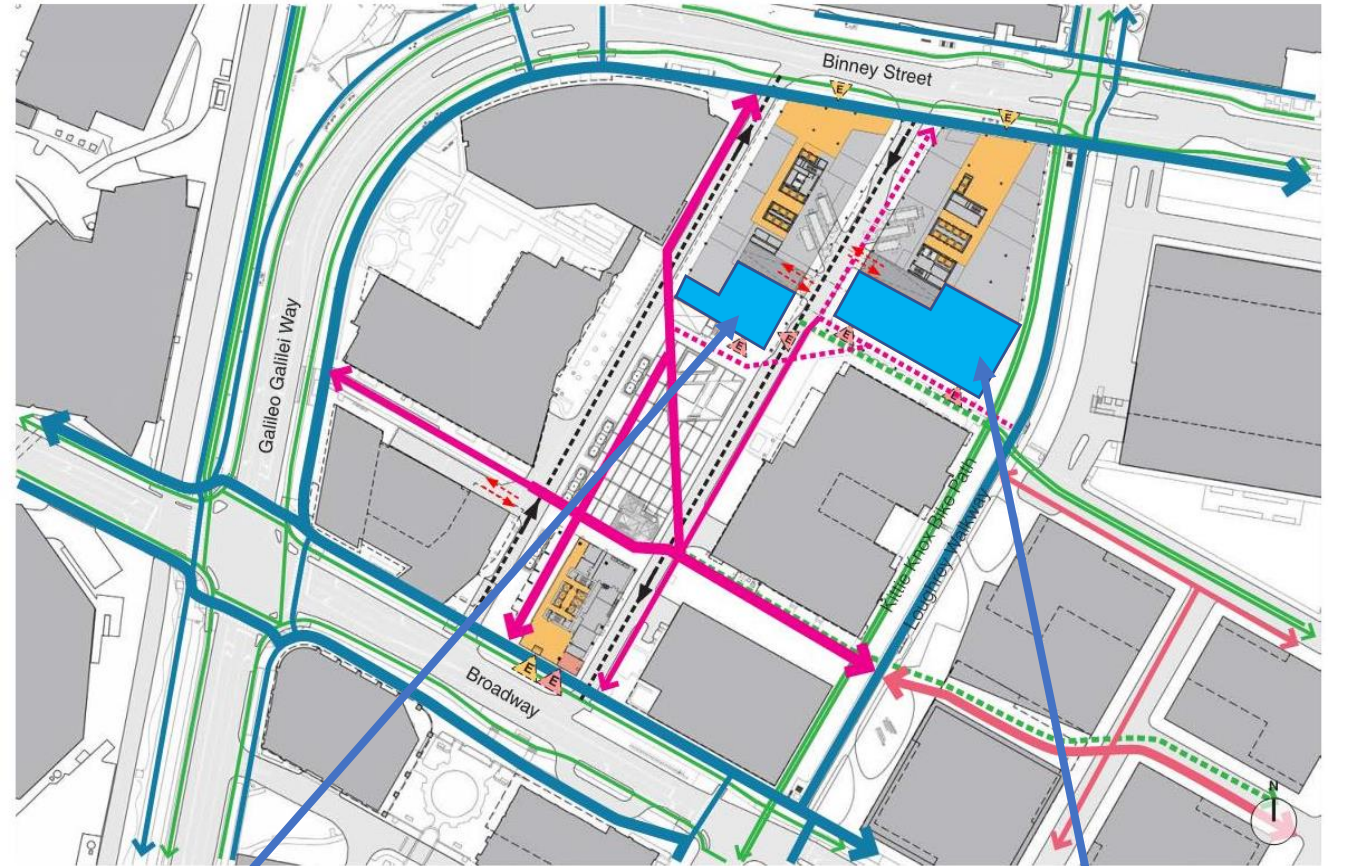

Commercial West Bike Parking
or Retail (~250 traditional)

Commercial East Bike Parking or
Retail (~400 traditional)

— Bicycle

— Pedestrian

— Proposed Pedestrian

Project background

- Automobile parking similarly constrained on this site
- Mode shift away from SOVs expected over medium to long term
- Consonance with City bicycle plan goals sought

GOALS

- ① **Make a significant shift towards bicycling as a sustainable transportation mode**
- ② **Create a transportation system that is safe for users of all ages and abilities**
- ③ **Innovate and be an early adopter of best practices in bicycle infrastructure**



Team introduction: Go By Bike

- Operator of largest bike valet in North America (9 years)
- 500,000 bicycles parked and returned
- Portland, OR location includes bike shop, bike share, and valet

Team introduction: Bikes Not Bombs

- Bikes Not Bombs reclaims thousands of bicycles each year, creates local and global programs that provide skill development, jobs, and sustainable transportation.
- Youth Pathways: As youth progress through our Bike School to paid Apprenticeships they build critical thinking skills, engage in hands-on vocational training, cultivate leadership skills, and grow a commitment to environmental and social justice.
- International Programs: Youth, staff, and volunteers help ship thousands donated bikes to locally owned organizations in Latin America, Africa, and the Caribbean, each of whom addresses the core social justice and environmental issues unique to their communities.
- Bike Shop and Vocational Training Center: Adult and youth mechanics refurbish bikes for sale at our Bike Shop, providing critical vocation training for youth and sustainable, affordable transportation to local community members.



Proposed bicycle parking plan

- Build out a centralized bicycle valet facility (expected to be largest in North America at completion with approximately 600 spaces)
- Offer valet services from **0600 – 2200, seven days per week** while leveraging higher density parking solutions
- Complement with ~20 traditional LT spaces within residential building, ST spaces outside each building (x12 each)

*All parking quantity estimates subject to change



Proposed bicycle parking plan

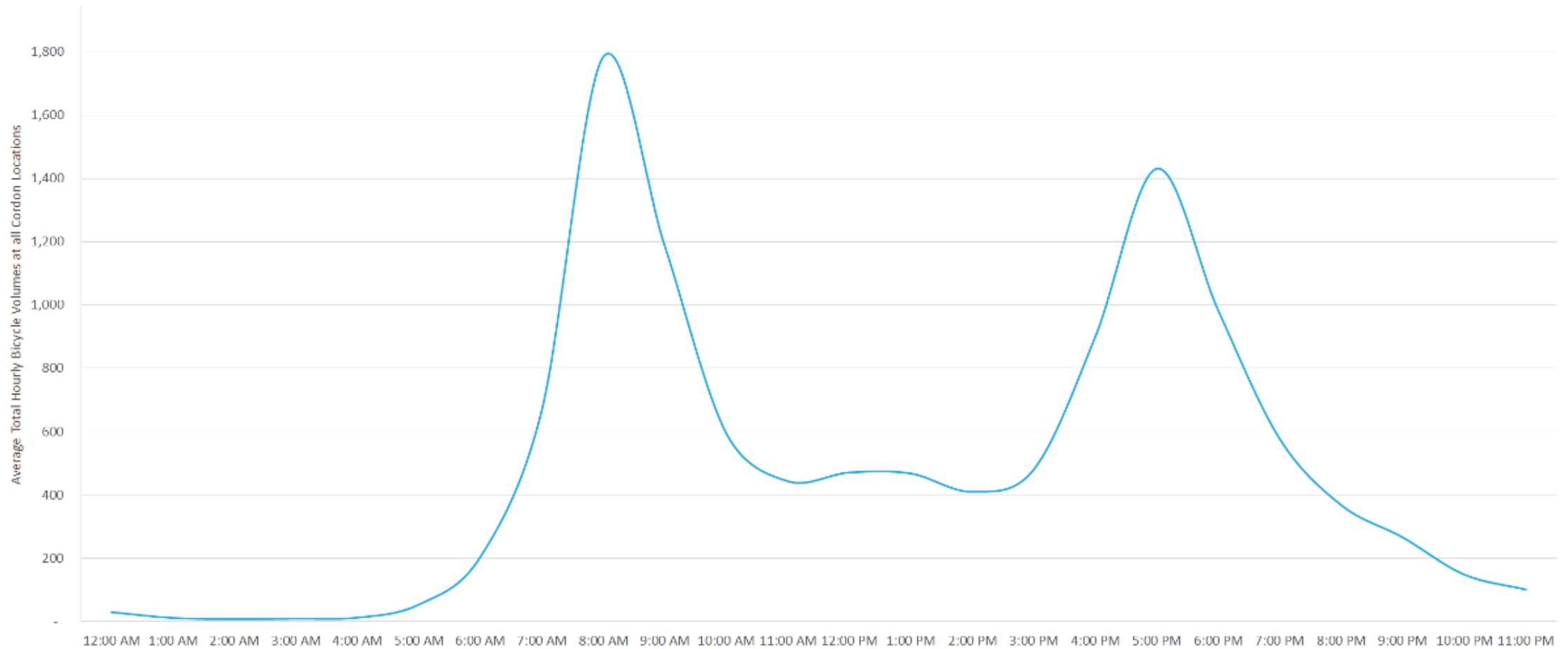

*Data from CRA Kendall Square Mobility Report (2019)

Proposed bicycle parking plan

[1] Boosts parking capacity by between 50%-60% relative to “traditional” racks

[2] Superior service and security for cyclists

[3] Centralized facilities and pooled capacity

[4] Potential for complementary bike shop retail use

[5] Operational flexibility/capacity for experimentation highly valued and sought here



Discussion

Appendix

Project overview

07 April 2020 – ECPT Meeting [Project Introduction]

15 April 2020 – CRA Board Meeting [Project Introduction]

21 April 2020 – Linden Park Neighbors [Project Overview]

20 May 2020 – CRA Board Meeting [Preliminary Zoning Changes]

17 June 2020 – CRA Board Meeting [Draft MXD Zoning Petition]

25 June 2020 – Virtual Open House [Masterplan Development]

01 July 2020 – Zoom Open office Hours [Q&A]

15 July 2020 – CRA Board Meeting [Draft KSURP Amendment]

22 July 2020 – ECPT Meeting [Eversource Update]

04 August 2020 – ECBA Meeting [Project Overview]

19 August 2020 – Linden Park Neighbors [Project Update]

02 September 2020 – Kendall Square Association [Project Update]

03 September 2020 – Kendall Residents Association [Project Update]

16 September 2020 – CRA Board Meeting [Vote on Zoning Petition]

11 November 2020 – CRA/CDD Design Review Committee [Project Update]

12 November 2020 – Cambridge Planning Board Meeting [Zoning Petition Review]

19 November 2020 – Cambridge Ordinance Committee [Zoning Petition Review]

05 January 2021 – Cambridge City Council [Review & Q&A]

27 January 2021 – Cambridge Ordinance Committee [Financial Review]

03 February 2021 – Cambridge City Council [Zoning Petition Approved]

30 March 2021 – Design Review Committee Meeting [Review & Q&A]

31 March 2021 – Virtual Open House Community Meeting [Review & Q&A]

04 April 2021 – Open Office Hours [Review & Q&A]

14 April 2021 – ECPT Meeting [Review & Q&A]

13 May 2021 – Virtual Open House Community Meeting [Review & Q&A]

18 May 2021 – Cambridge Planning Board/CRA Board Meeting [Pre-Filing Discussion] (expected)

09 July 2021 – Cambridge Bicycle Committee Meeting [Review & Q&A] (expected)

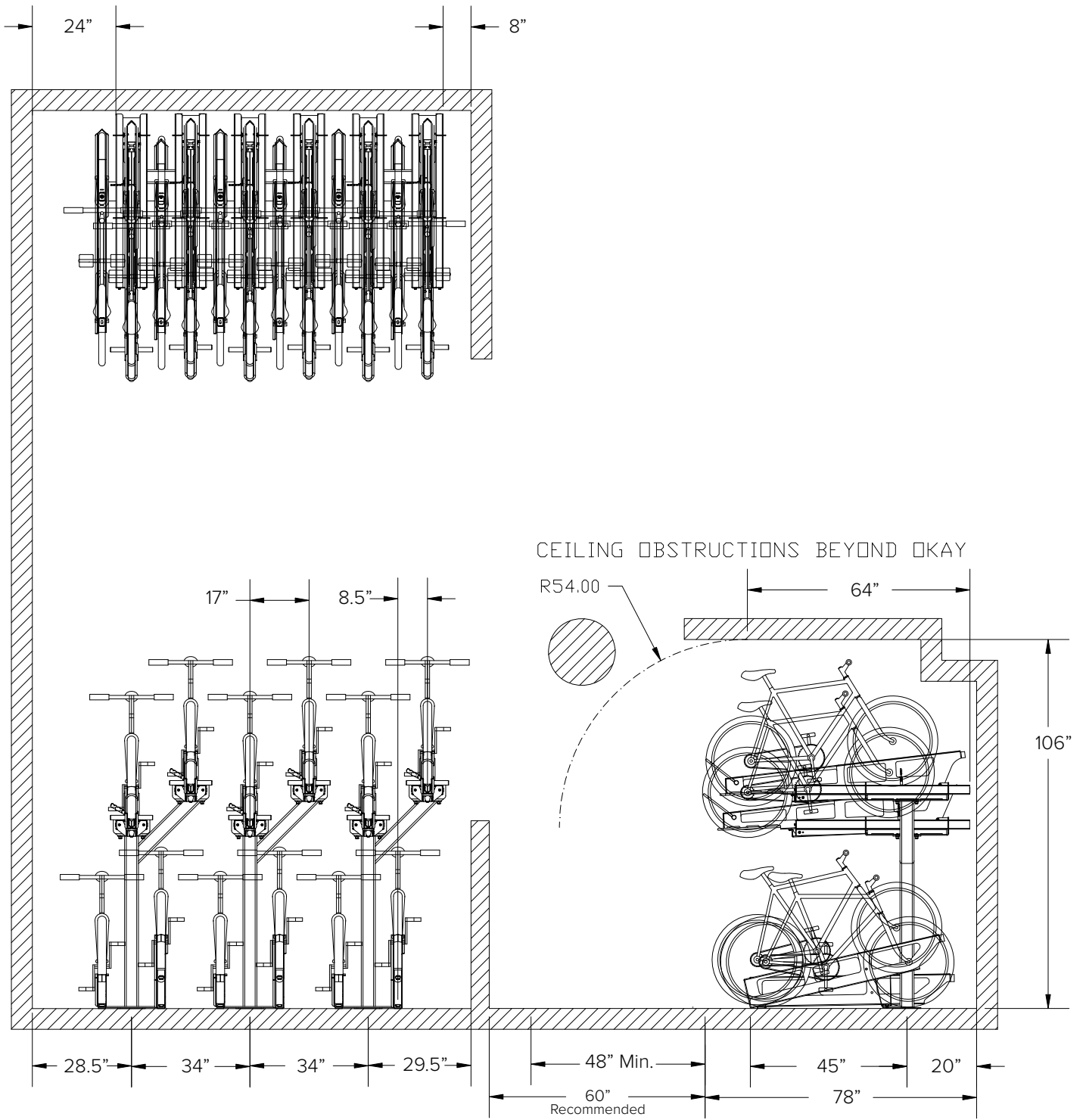

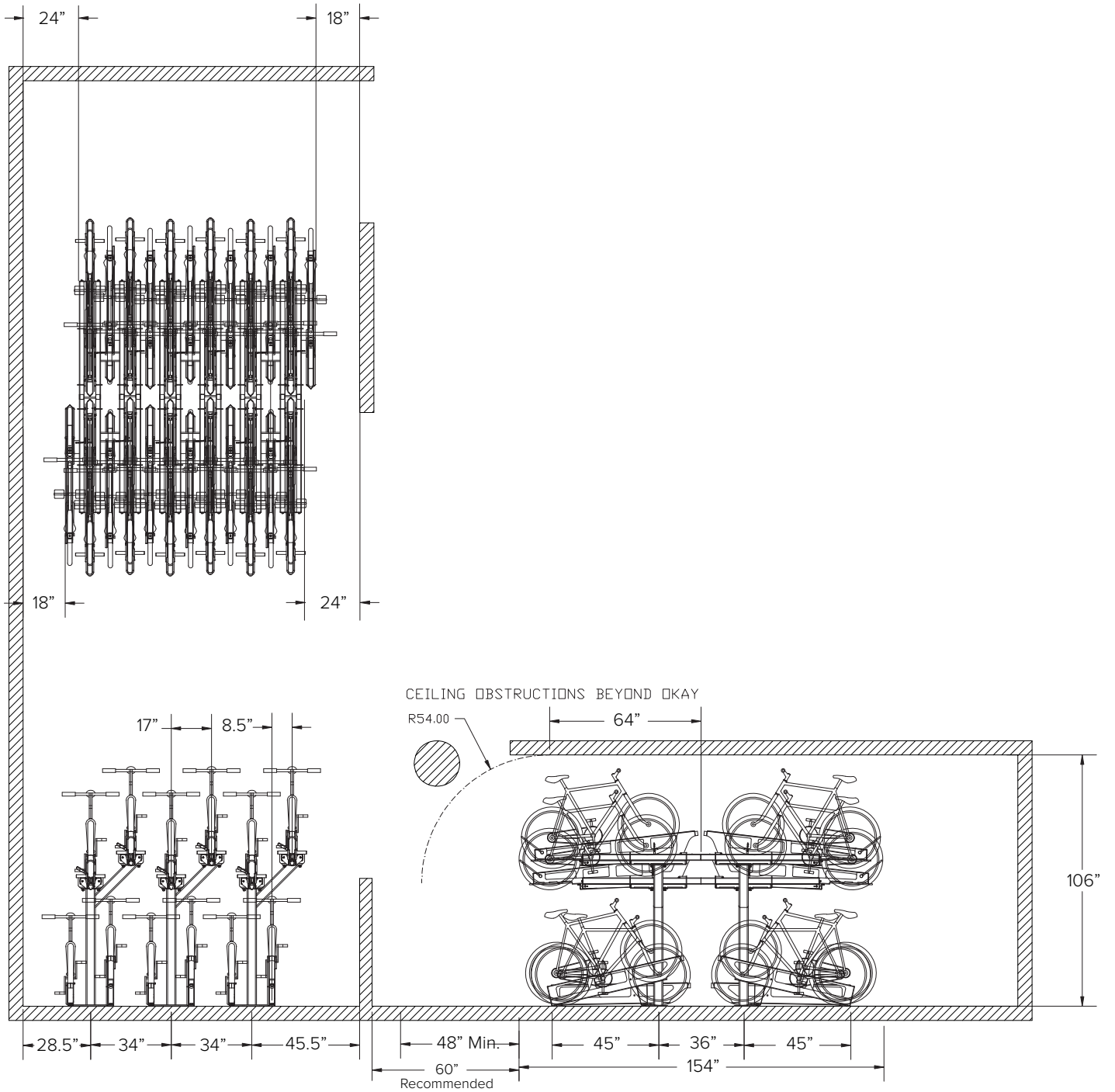



TOOLS NEEDED

Hammer drill
 Masonry bit, 3/8", 1/2"
 Hammer
 Socket wrench
 Sockets, 9/16", 3/4"
 Socket extension, 4-6"

Hex wrench, 3/16"
 Tape measure
 Chalk line
 Marker
 Level

RECOMMENDED BASE MATERIAL

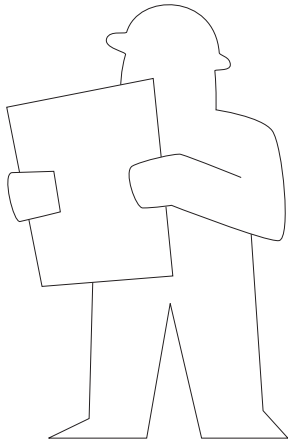
Solid concrete is the best base material for installation. To ensure the proper anchors are shipped with your racks, ask your Dero representative which anchor is appropriate for your application. Be sure nothing is underneath the base material that could be damaged by drilling.

1

Refer to setback diagrams before installation to ensure sufficient space. Installation surface must be concrete of suitable strength. If surface is not level, contact Dero representative for workable solution.

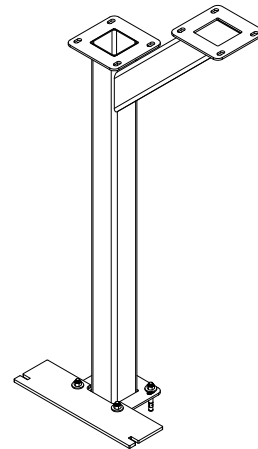
2

Place the Uprights in position and secure with (4) 1/2" x 3.75" wedge anchors. At least 1.25" of wedge anchor threads should remain above the concrete. The Lower Tray Mount should be placed on the front side of the Upright and secured with the existing wedge anchors.

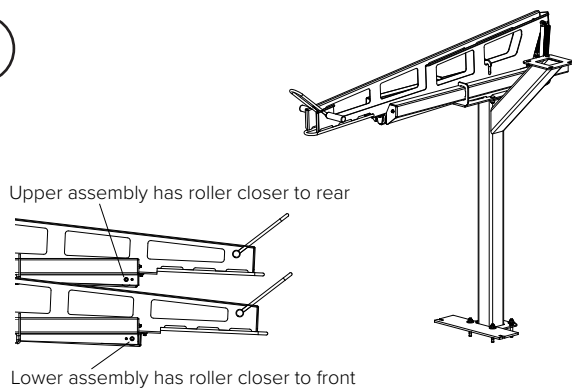
3

Place the lower Cantilever Assembly on the lower Upright position and secure with (4) 1/2" x 1.25" carriage bolts, 1/2" washers, and 1/2" nylock nuts.

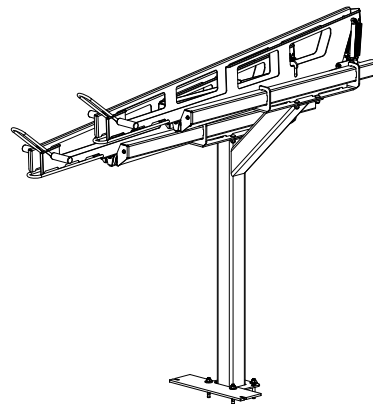
4

Do the same for the upper Cantilever Assembly.

5

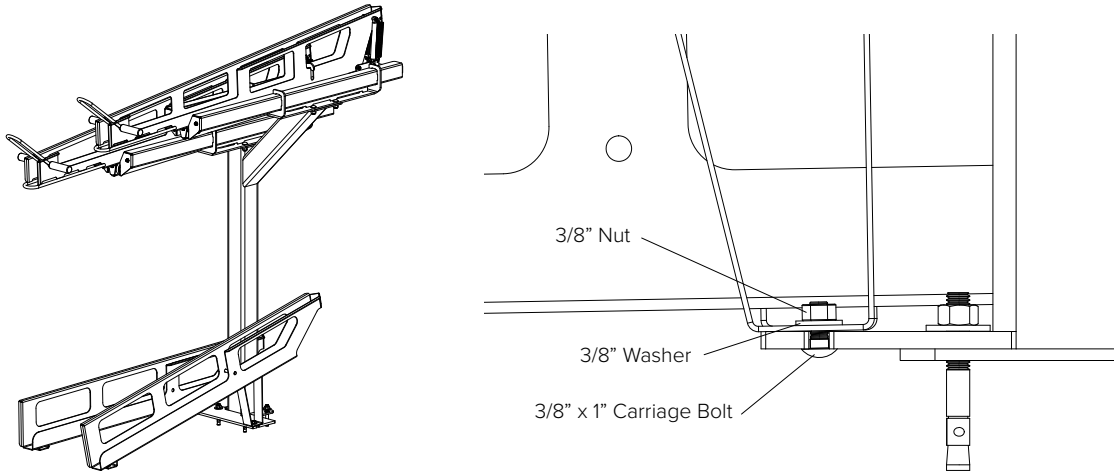

Place the bottom Lower and Upper Trays in position and secure at the rear with (1) 3/8" x 1" carriage bolt, 3/8" washer, and 3/8" nut each. Secure at the front with (1) 3/8" x 3" wedge anchor each.

6

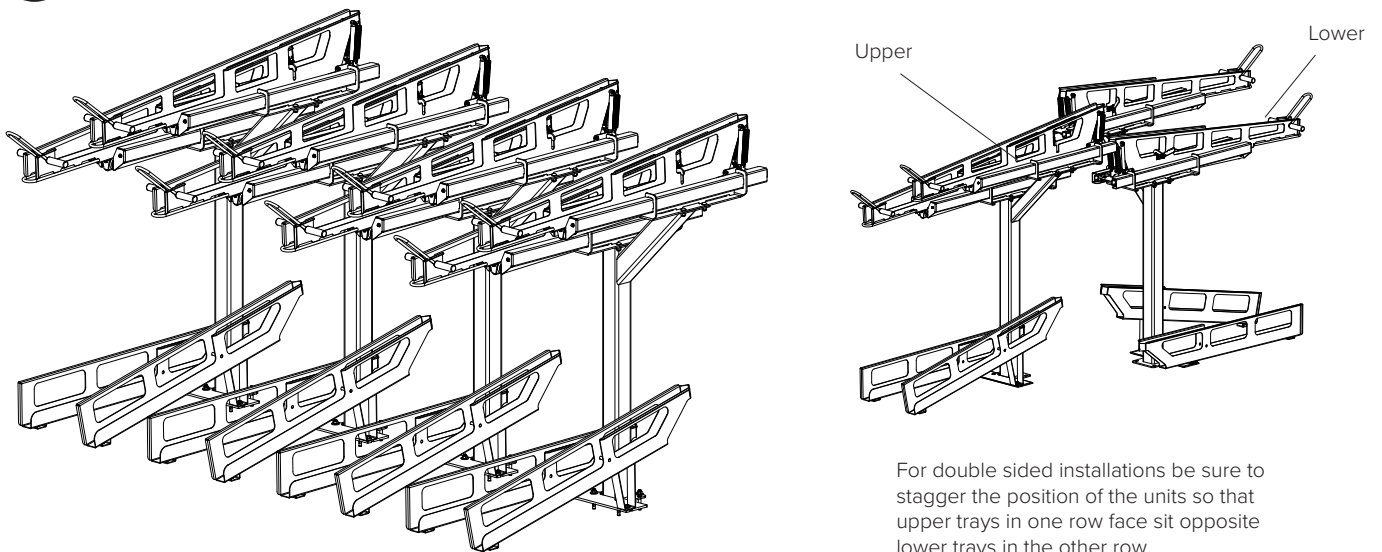

For double sided installations be sure to stagger the position of the units so that upper trays in one row face sit opposite lower trays in the other row.

Continue to the next section and repeat the previous steps.



DPW Updates



TP&T Updates



Grand Junction Path Update



MIT/Volpe

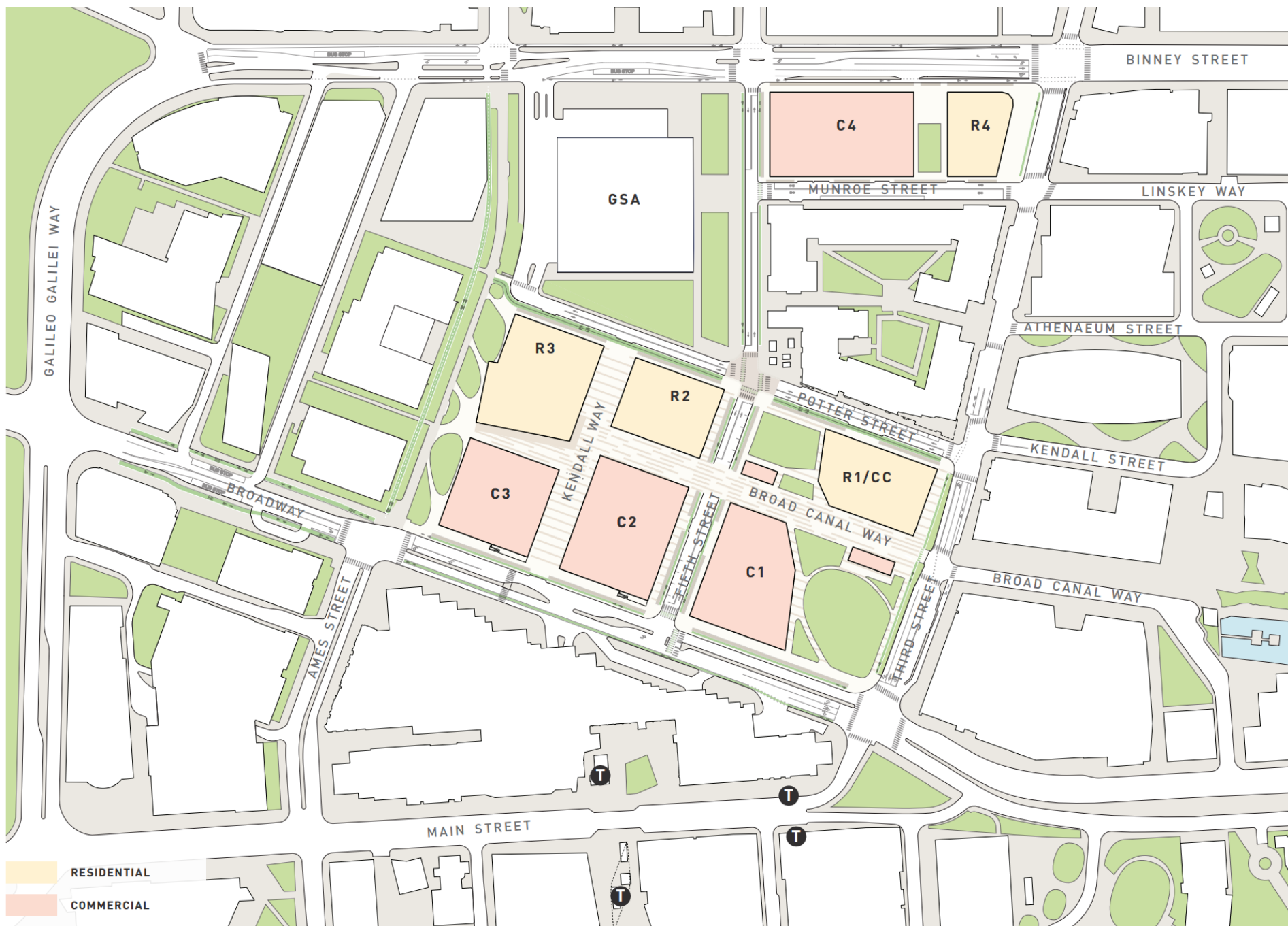
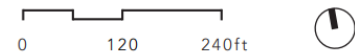

Figure A9: Site Development Plan - Uses



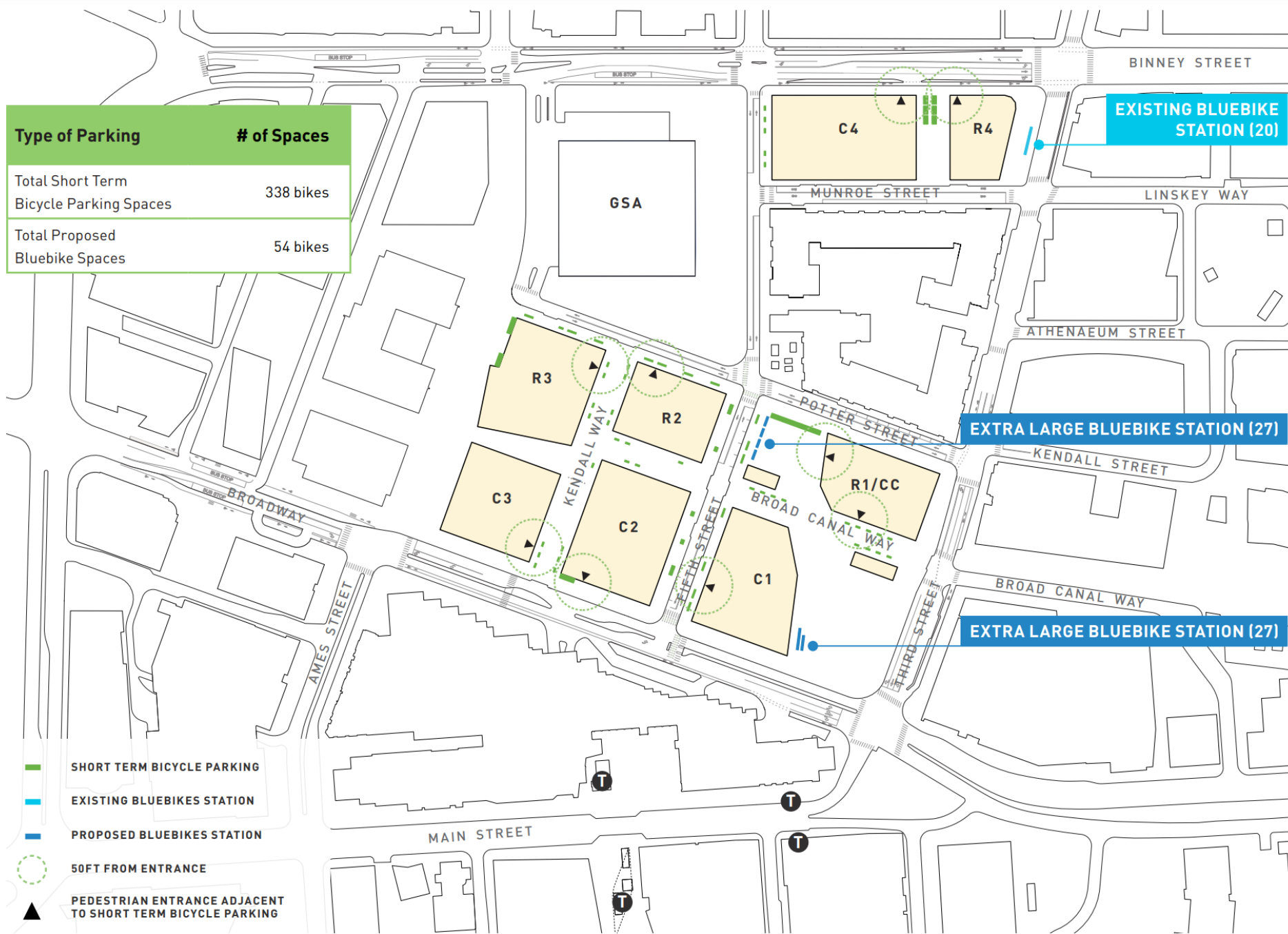
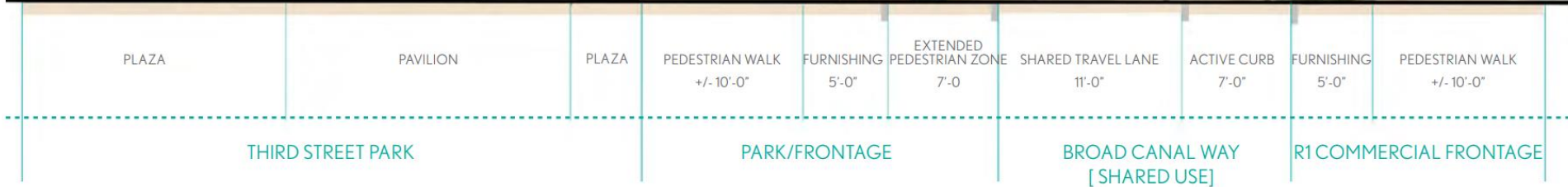
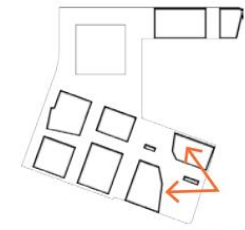

Figure C2: Bluebike Stations and Short Term Bike Parking Plan





*DIMENSIONS ARE APPROXIMATE

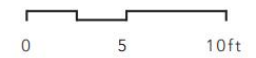
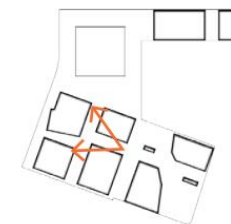

Figure D15: Street Section - Broad Canal Way East



*DIMENSIONS ARE APPROXIMATE

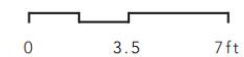
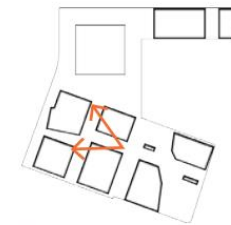

Figure D16: Street Section - Broad Canal Way West



*DIMENSIONS ARE APPROXIMATE

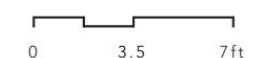
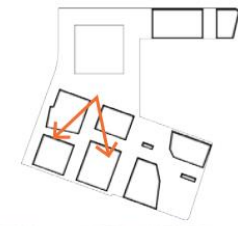

Figure D17: Street Section - Broad Canal Way West Alternative Layout



PEDESTRIAN WALK
+/- 10'-0"

FURNISHING
5'-0"

SHARED USE WAY
30'-0"

FURNISHING
5'-0"

PEDESTRIAN WALK
+/- 10'-0"

R2 PEDESTRIAN WALK

KENDALL WAY [FACING SOUTH]

R3 PEDESTRIAN WALK

*DIMENSIONS ARE APPROXIMATE

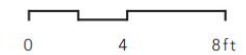

Figure D18: Street Section - Kendall Way

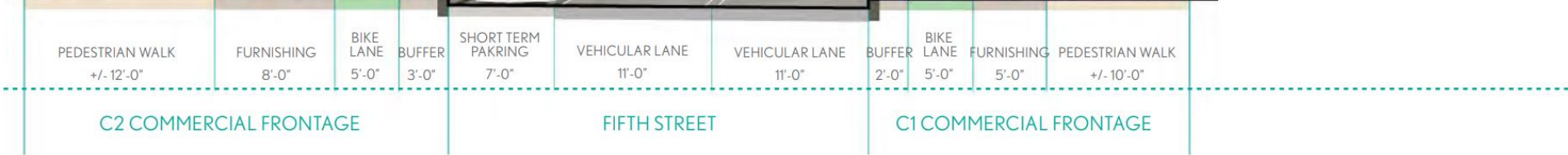
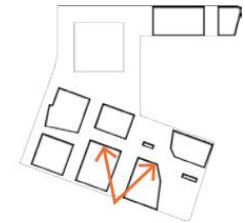
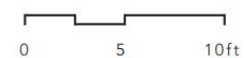
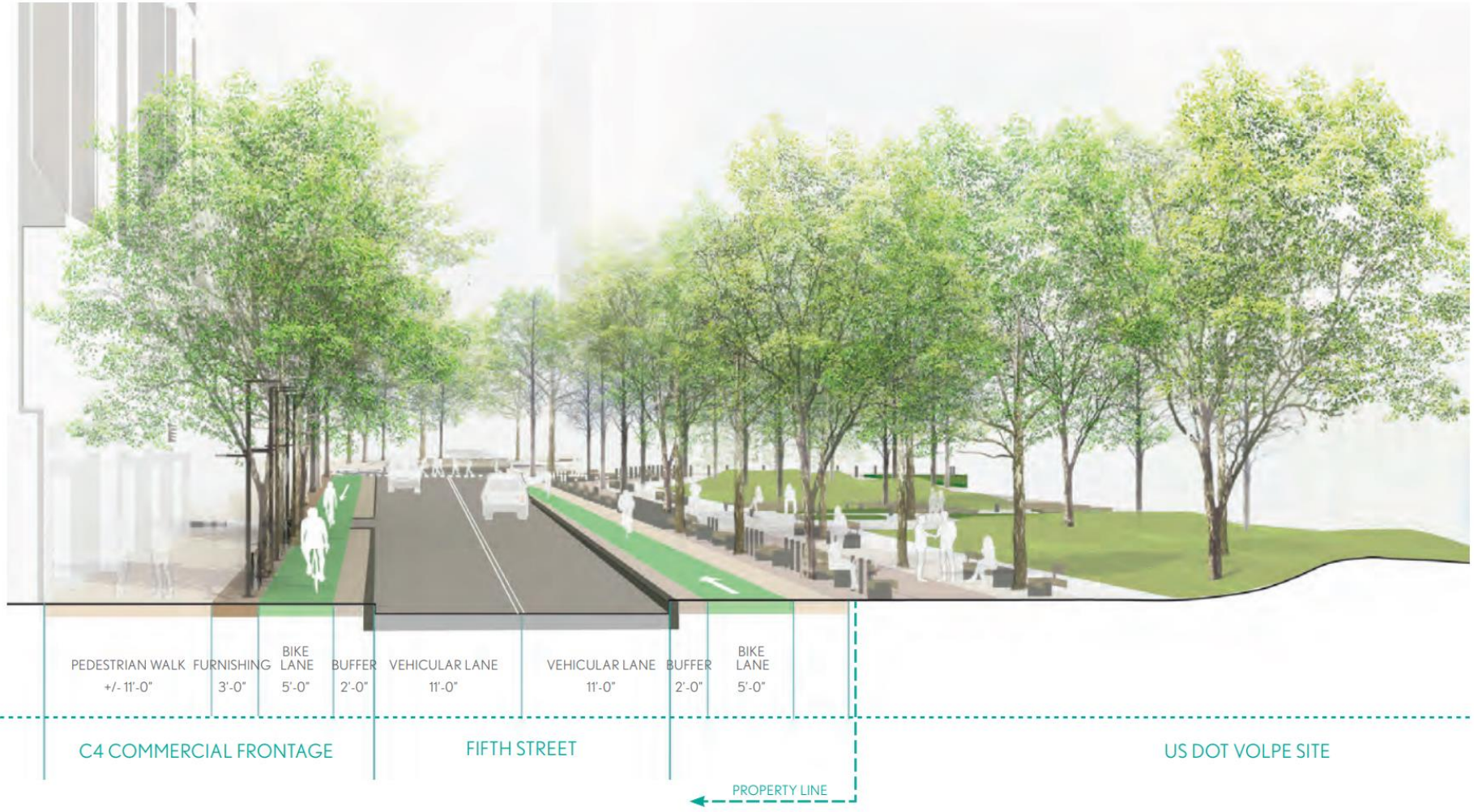
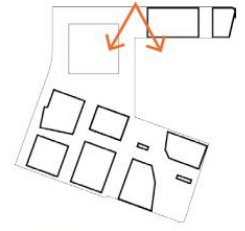

Figure D14: Street Section - Fifth Street South of Potter

*DIMENSIONS ARE APPROXIMATE





*DIMENSIONS ARE APPROXIMATE

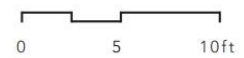
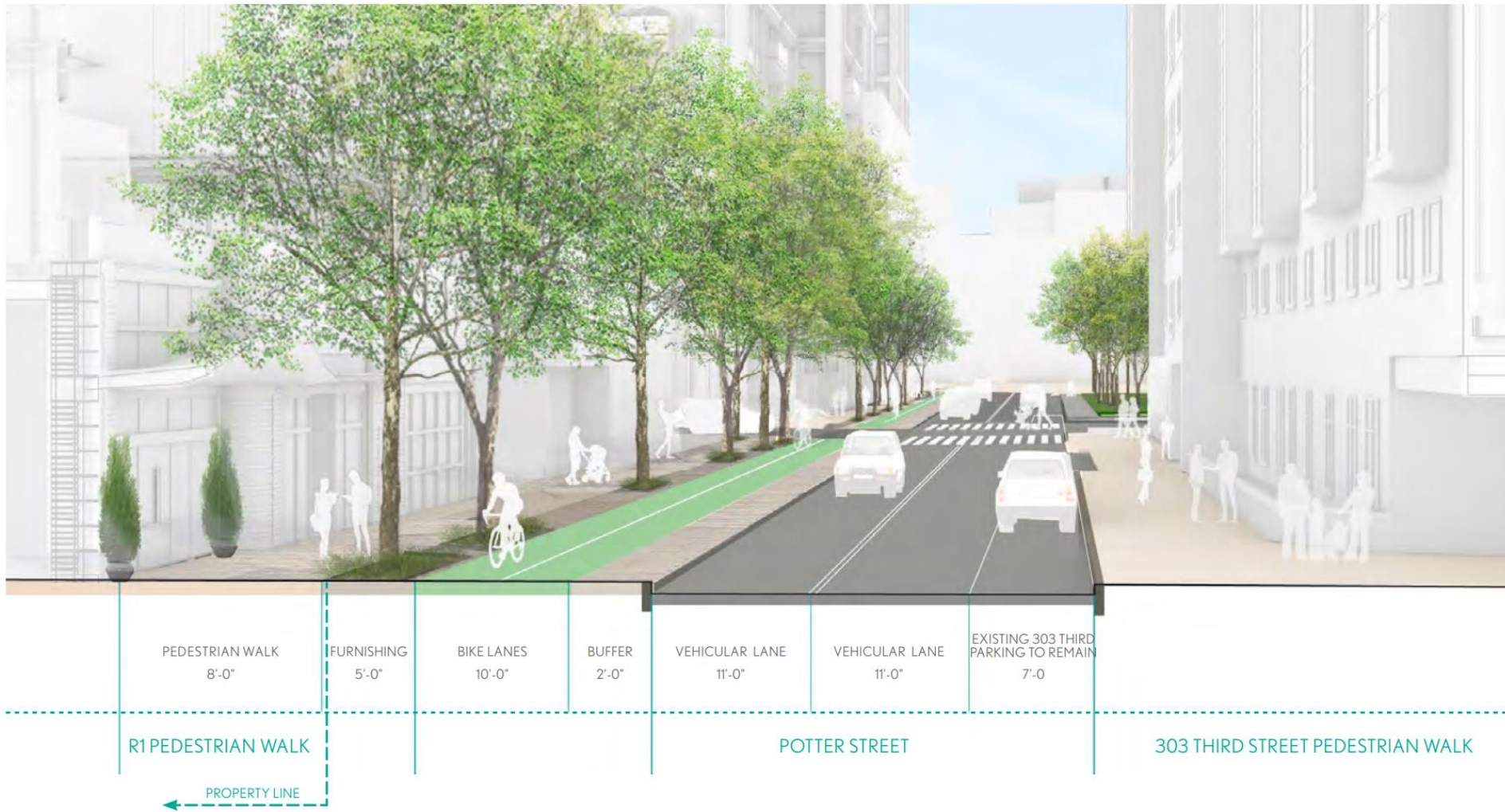
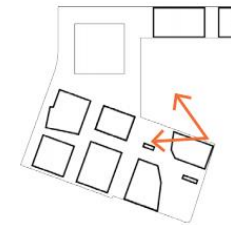

Figure D13: Street Section - Fifth Street at Binney



*DIMENSIONS ARE APPROXIMATE

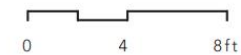
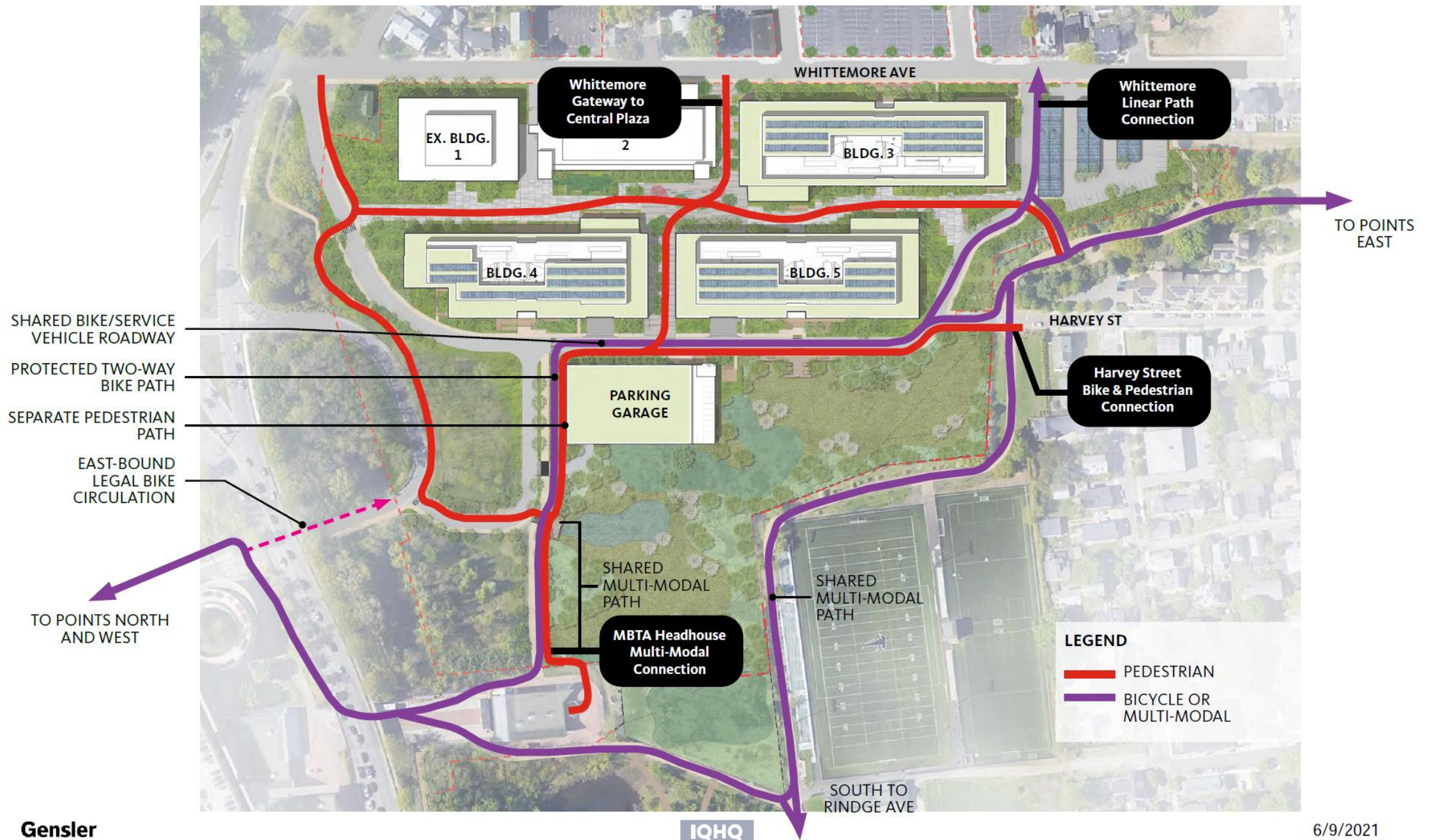

Figure D19: Street Section - Potter Street



IQHQ/Alewife Park

UPDATED SITE PLAN | CONNECTIONS & PATHS



TRANSPORTATION SITE PLANNING + MITIGATION MEASURES

Community Concern	Site Planning Mitigation Measure
Garage location + neighborhood cut-through vehicle trips	Site access and garage location to take advantage of road network to the west (Proximity to Rte 2)
	Gates located to prevent convenience cut-throughs
	Maintaining police detail
Net-new vehicle trip increase	Transit oriented site location helps reduce vehicle mode share
	Transportation Demand Management measures to reduce single-occupancy vehicle trips

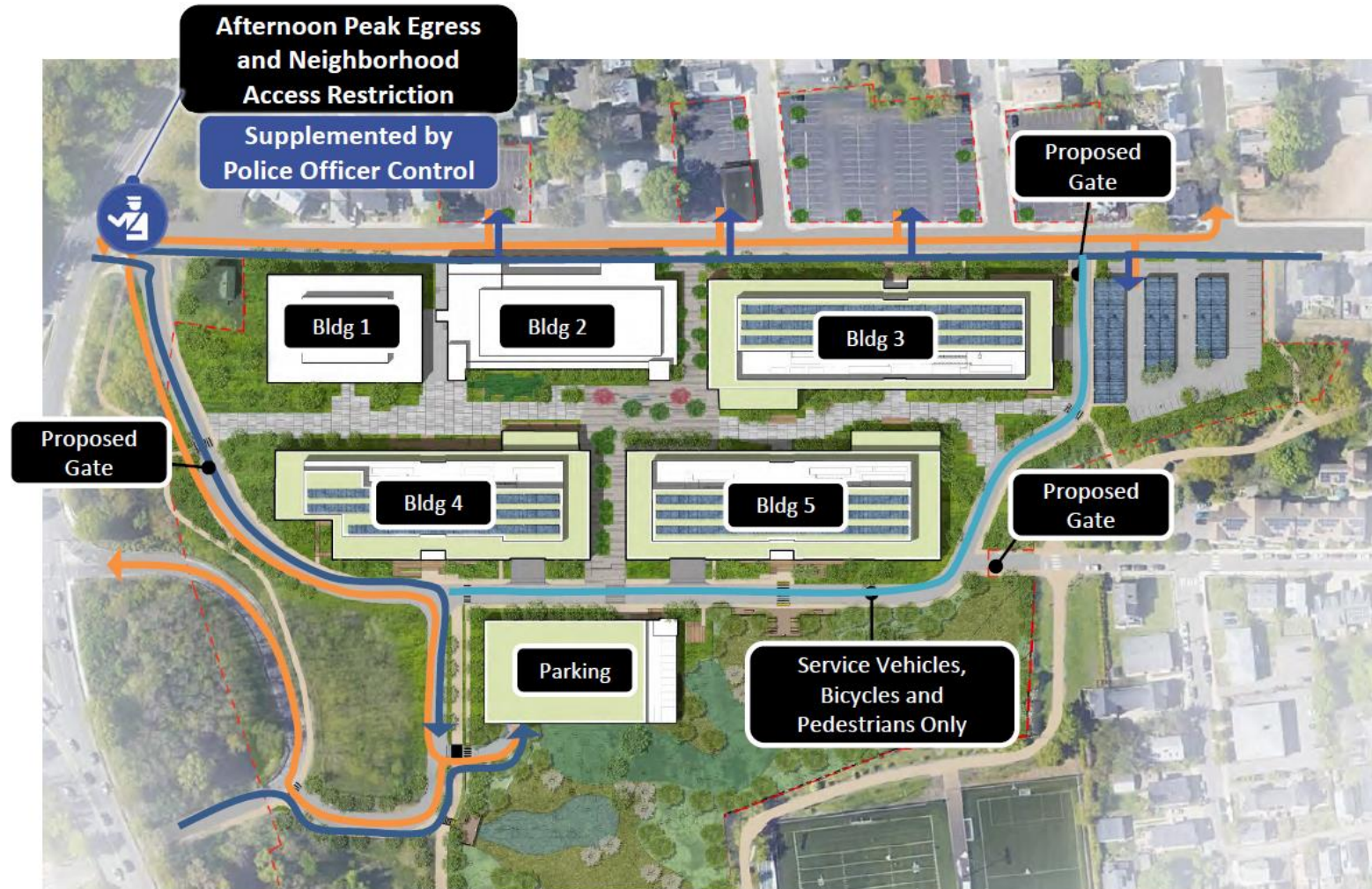

- Vehicular Access
- Vehicle Egress
- Service Vehicles

JERRY'S POND - PEDESTRIAN PATH



Jerry's Pond Public Access Plan will provide:

- Overall Seating Capacity of **114**
- Pedestrian Only Boardwalk Connection from Rindge Avenue north to the MBTA Headhouse
- Expanded Paths along Rindge Avenue
- Improved Signalized Crosswalks Across Rindge Avenue
- Improved Path Along Rte 16

JERRY'S POND - RINDGE AVENUE SIDEWALK & BOARDWALK





Walden Square II

Illustrative Site Plan

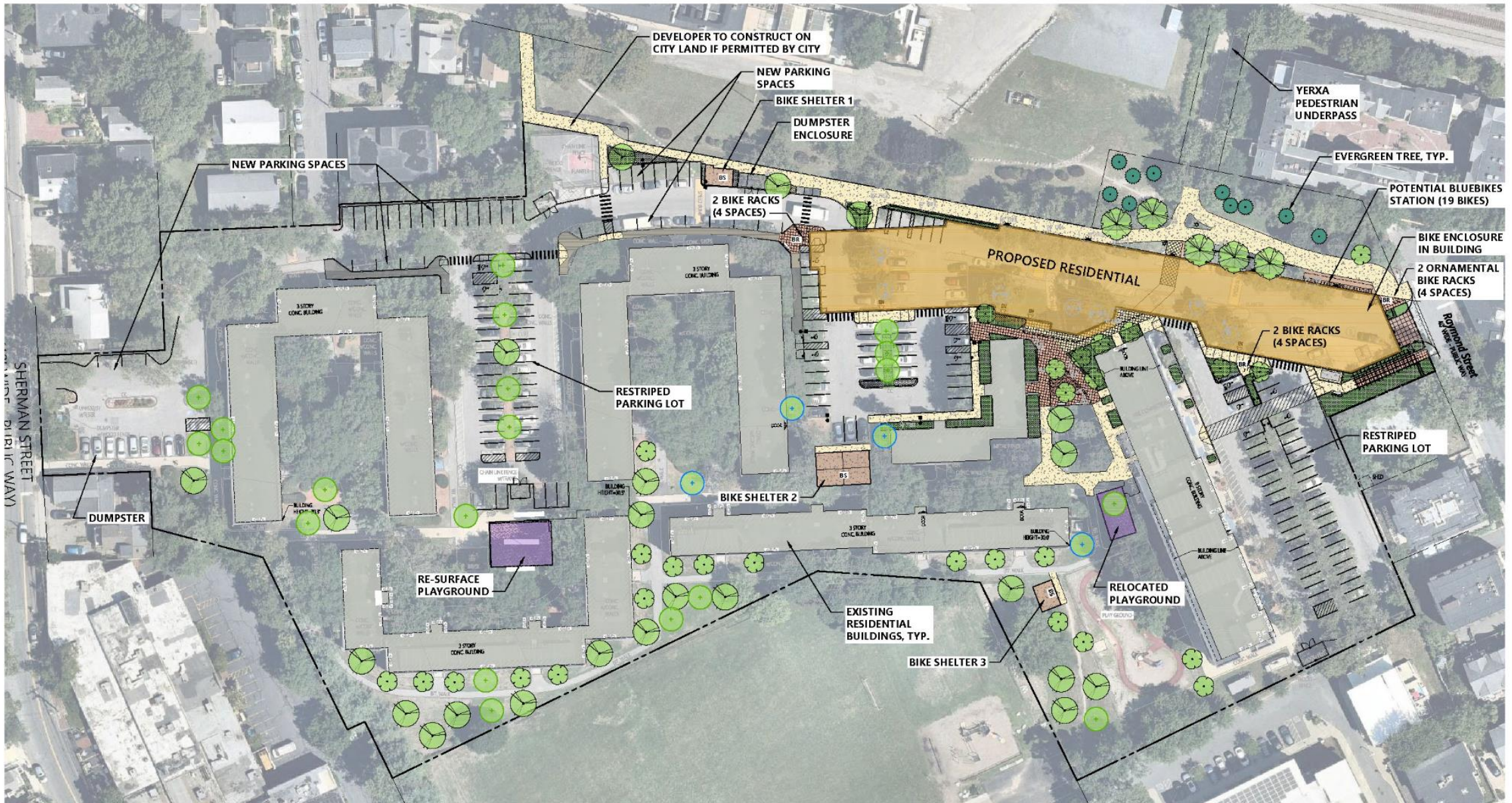

Proposed Circulation

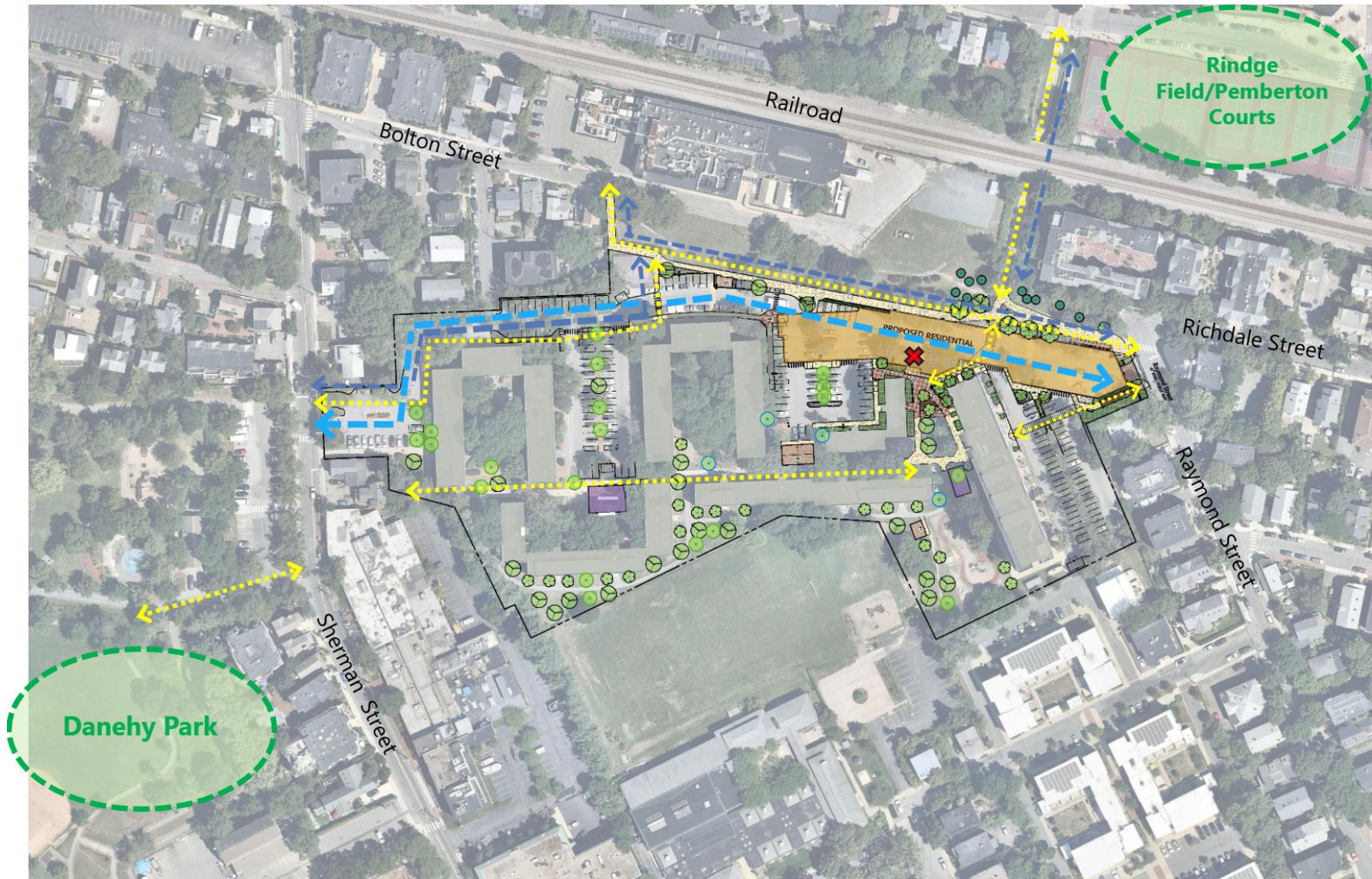

- PEDESTRIAN
- - - - BICYCLE
- . - . VEHICLE

View After Yerxa Underpass



Ground Floor Plan

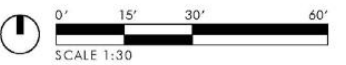
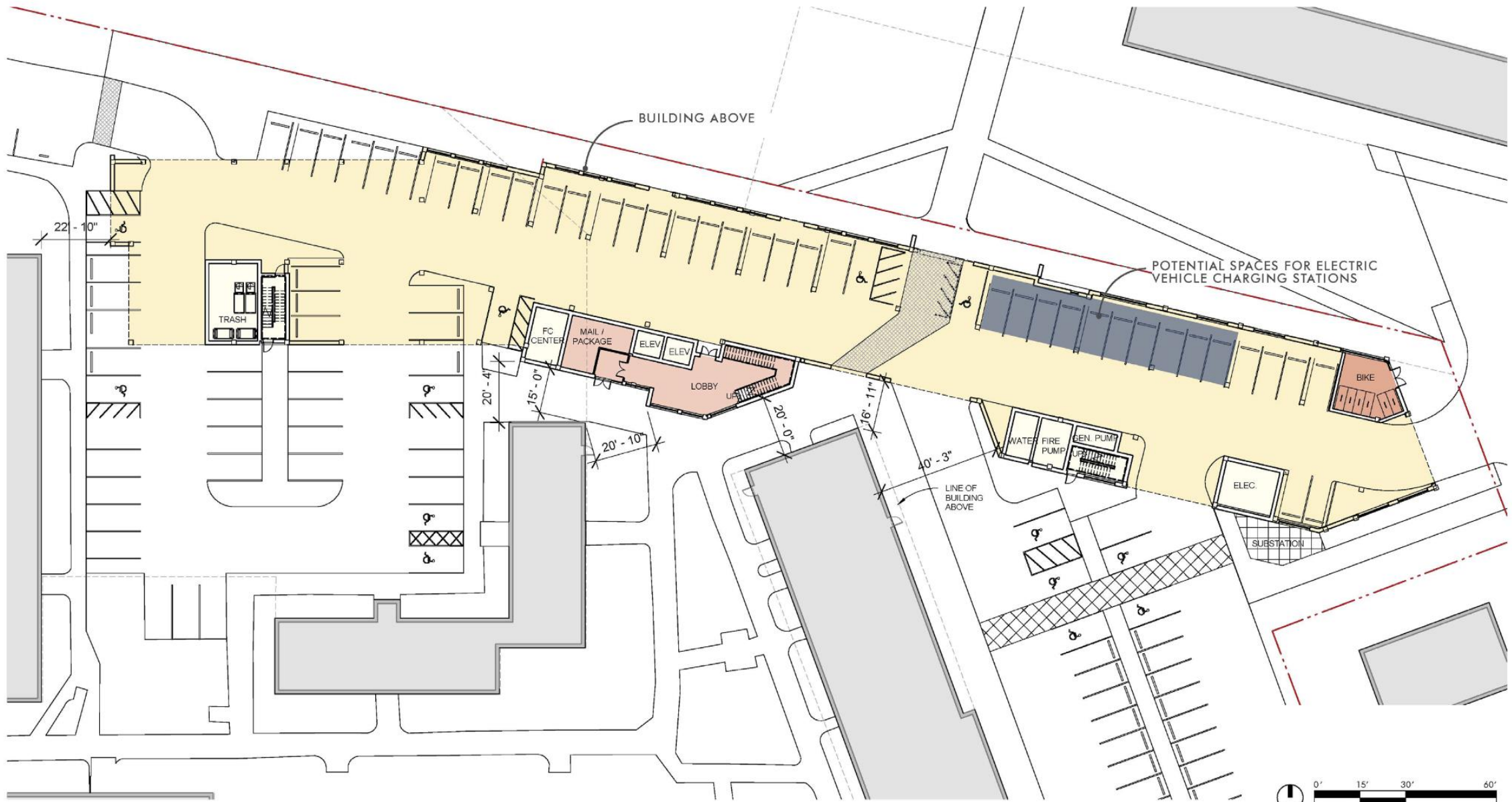



Public comment

Public Comment Instructions

- Use the "Raise Hand" button to signal you have a question/comment. A staff member will then enable you to unmute yourself.
 - *9 to Raise Hand by phone
 - *6 to Mute/Unmute by phone
- Questions can also be submitted using the Q&A button.

Bottom Panel of
Zoom Screen

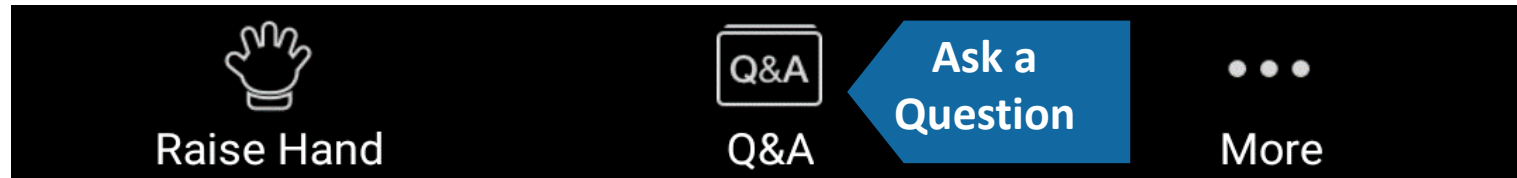



Other Announcements



Upcoming Meetings

- Pedestrian Committee walk of Cambridge Crossing/North Point area
 - Thursday, June 24, 6:00 PM – 8:00 PM
 - Meet at entrance to Lechmere pedestrian at the intersection of First St and Cambridge St (next to the Bluebikes station)
- Bicycle Committee August meeting
 - Wednesday, August 11, 5:30 PM
 - Ride?
- Pedestrian Committee August meeting (August 26)
 - Thursday, August 26, 5:30 PM or 6:00 PM
 - Walk?



Thank You