

CITY OF CAMBRIDGE, MASSACHUSETTS

MOUNT AUBURN STREET BUS PRIORITY PILOT

MIDDLESEX COUNTY

| INDEX | |
|--------------|----------------------------------|
| SHEET NO. | DESCRIPTION |
| 1 | TITLE SHEET & INDEX |
| 2 | NOTES & LEGEND |
| 3 | KEY PLAN |
| 4-10 | TRAFFIC SIGN & PAVEMENT MARKINGS |
| 11 | TRAFFIC SIGN SUMMARY SHEET |

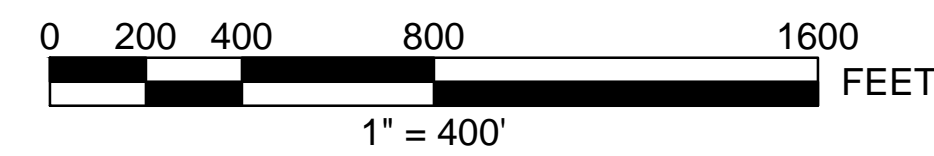
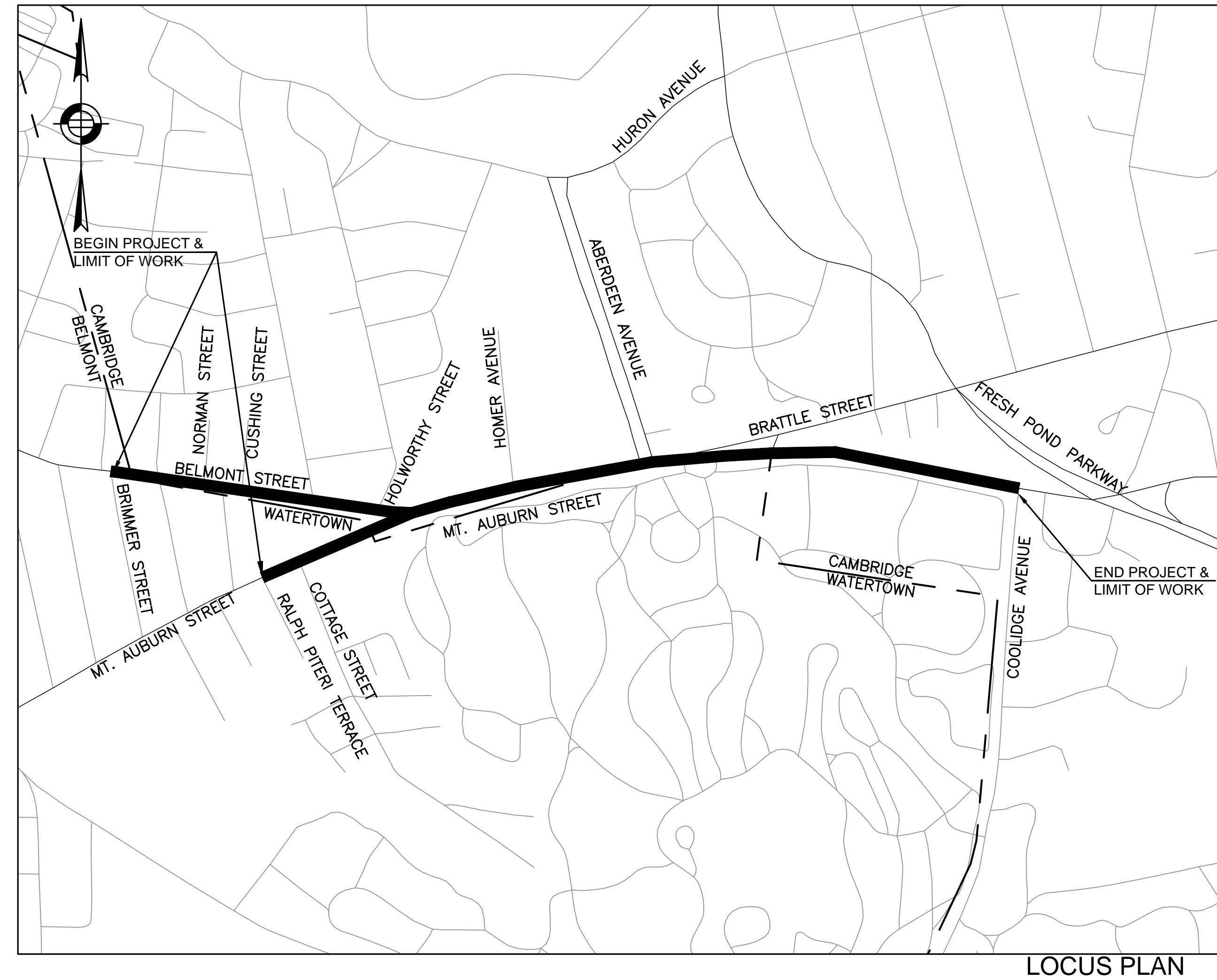

| | | | | | | |
|---|---------|----------|----------|------------|-----------|--------------|
| CITY OF CAMBRIDGE | | | | | | |
| TRAFFIC, PARKING, & TRANSPORTATION DEPARTMENT | | | | | | |
| MT. AUBURN STREET | | | | | | |
| BUS PRIORITY PILOT | | | | | | |
| TRAFFIC SIGN & PAVEMENT MARKINGS | | | | | | |
| | DATE | DRAWN BY | CHKD. BY | APPRVD. BY | SHEET NO. | TOTAL SHEETS |
| | 8/10/18 | SM | PB | . | 1 | 11 |

GENERAL NOTES

TRAFFIC SIGNAL LEGEND

| EXISTING (TO REMAIN) | REMOVE/ABANDON | DESCRIPTION |
|----------------------|----------------|------------------------|
| | | CONTROLLER CABINET |
| | | SIGNAL POST |
| | | MAST ARM |
| | | VEHICULAR SIGNAL |
| | | BICYCLE SIGNAL |
| | | PEDESTRIAN SIGNAL |
| | | PEDESTRIAN PUSH BUTTON |

TRAFFIC FURNITURE LEGEND

| PROPOSED | EXISTING (TO REMAIN) | DESCRIPTION |
|------------------|----------------------|-------------|
| | | SIGN |
| ABBREVIATION R&S | DESCRIPTION SIGN | |

PAVEMENT MARKING LEGEND

| | |
|--|--|
| | 6" SOLID WHITE EDGE LINE |
| | 12" SOLID WHITE EDGE LINE |
| | 6" SOLID YELLOW EDGE LINE |
| | 12" SOLID YELLOW EDGE LINE |
| | 6" SOLID WHITE LANE LINE |
| | 6" BROKEN WHITE LANE LINE 10' MARK - 30' SKIP |
| | 6" DOTTED WHITE LANE LINE 2" MARK - 4" SKIP |
| | 8" DOTTED WHITE LANE LINE 2" MARK - 4" SKIP |
| | 12" SOLID WHITE CHANNELIZATION LINE |
| | 12" SOLID YELLOW CHANNELIZATION LINE |
| | 2-4" YELLOW CENTER LINES, 4" GAP |
| | WHITE STOP LINE (12" UNLESS OTHERWISE SPECIFIED) |
| | WHITE - CONTINENTAL CROSSWALK (2" LONGITUDINAL LINES, 4" O.C.) (UNLESS OTHERWISE SHOWN) |
| | 12" SOLID WHITE CHANNELIZATION (15' O.C. @45°, UNLESS OTHERWISE NOTED). |
| | 12" SOLID YELLOW CHANNELIZATION (15' O.C. @45°, UNLESS OTHERWISE NOTED). |
| | 4" DOTTED YELLOW CENTER LINES, 4" GAP 2" MARK - 4" SKIP |
| | BIKE LANE SYMBOL |
| | SHARED LANE MARKING |
| | YIELD LINE |
| | BIKE LANE CROSSING 6" WHITE LANE LINES 2" MARK - 4" SKIP (WHITE LANE LINE ONLY) HIGH FRICTION SURFACE TREATMENT (GREEN) (WIDTH EQUALS BICYCLE LANE WIDTH) 2" MARK - 4" SKIP (WHITE LANE LINE ONLY) INCLUDE BIKE LANE SYMBOL CENTERED IN CROSSING WHEN SHOWN ON PLANS |
| | SHARED BUS AND BICYCLE LANE AND RIGHT-TURN ONLY LANE (FOR CARS ONLY) 6" BROKEN WHITE LANE LINE (SHARED BUS AND BIKE LANE CROSSING) SEE PLANS FOR MARK AND SKIP LENGTHS HIGH FRICTION SURFACE TREATMENT (RED) (WIDTH AS SHOWN ON PLANS) 6" BROKEN WHITE LANE LINE (SHARED BUS AND BIKE LANE CROSSING) SEE PLANS FOR MARK AND SKIP LENGTHS |
| | SHARED BUS AND BICYCLE LANE CROSSING 6" BROKEN WHITE LANE LINE (SHARED BUS AND BIKE LANE CROSSING) 10' MARK - 10' SKIP HIGH FRICTION SURFACE TREATMENT (RED) (WIDTH AS SHOWN ON PLANS) 6" BROKEN WHITE LANE LINE (SHARED BUS AND BIKE LANE CROSSING) 10' MARK - 10' SKIP |

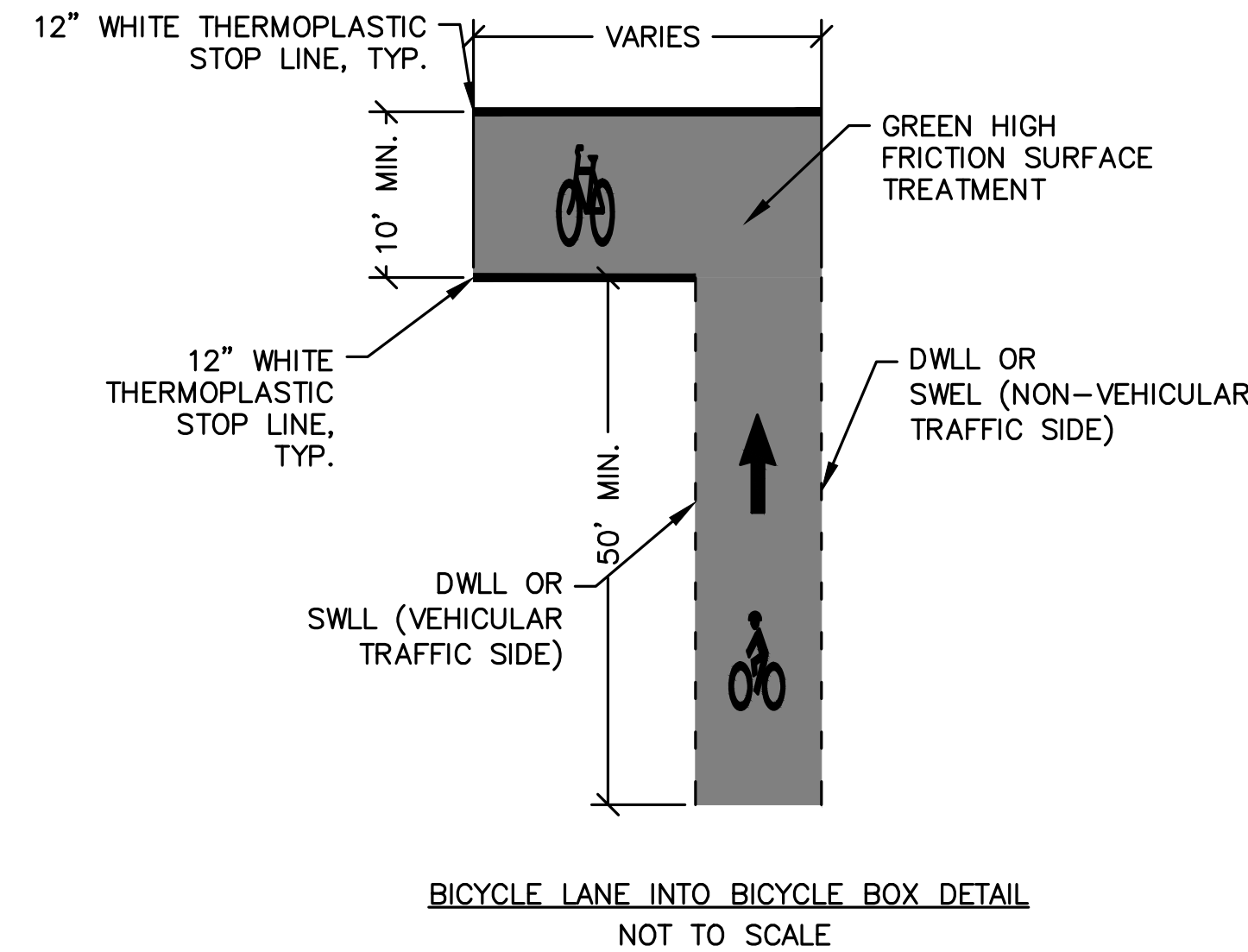

NOTES:

1. THE DWLL SHALL BE USED WHEN THERE IS A POTENTIAL CONFLICT WITH A VEHICLE (I.E. TURNING VEHICLES INTO DRIVEWAYS OR SIDE STREET VEHICLES CROSSING THE BICYCLE LANE). OTHERWISE AN SWLL AND/OR SWEL SHALL BE USED.
2. A BIKE SYMBOL MARKING SHALL BE PLACED IN THE CENTER OF THE EXTENSION OF EACH VEHICULAR TRAVEL LANE.

1. ALL WORK SHALL CONFORM TO THESE PLANS, THE CITY OF CAMBRIDGE TRAFFIC, PARKING, & TRANSPORTATION DEPARTMENT STANDARDS AND SPECIFICATIONS, THE CITY OF CAMBRIDGE STANDARDS AND SPECIFICATIONS, AND THE MASSACHUSETTS HIGHWAY DEPARTMENT STANDARD SPECIFICATIONS FOR HIGHWAYS AND BRIDGES DATED 1988, AS AMENDED, THE SUPPLEMENTAL SPECIFICATIONS DATED JULY 1, 2015, THE 2016 CONSTRUCTION STANDARD DETAILS, THE 2015 OVERHEAD SIGNAL STRUCTURE AND FOUNDATION STANDARD DRAWINGS, MASSDOT TRAFFIC MANAGEMENT PLANS AND DETAIL DRAWINGS, THE LATEST MANUAL ON UNIFORM TRAFFIC CONTROL DEVICES FOR STREETS AND HIGHWAYS WITH MASSACHUSETTS AMENDMENTS, THE 1990 STANDARD DRAWINGS FOR SIGNS AND SUPPORTS, THE 1968 STANDARD DRAWINGS FOR TRAFFIC SIGNALS AND HIGHWAY LIGHTING, AND THE LATEST MASSACHUSETTS BAY TRANSPORTATION AUTHORITY (MBTA) STANDARDS, WILL GOVERN. WHERE CONFLICTS EXIST, THE CITY OF CAMBRIDGE STANDARDS AND SPECIFICATIONS SHALL GOVERN.
2. THE CONTRACTOR WILL BE REQUIRED TO OBTAIN PERMITS FROM THE CITY OF CAMBRIDGE FOR EACH STREET LOCATION WHERE WORK IS REQUIRED AND SHALL ADHERE TO ALL PERMIT RESTRICTIONS, INCLUDING ORDER OF WORK AND HOURS OF OPERATIONS AT NO ADDITIONAL COST TO THE CONTRACT.
3. AREAS OUTSIDE THE LIMITS OF PROPOSED WORK DISTURBED BY THE CONTRACTOR'S OPERATIONS, INCLUDING STAGING AREAS, SHALL BE RESTORED BY THE CONTRACTOR TO THEIR ORIGINAL CONDITION AT THE CONTRACTOR'S EXPENSE.
4. THE CONTRACTOR SHALL FIELD VERIFY CONDITIONS AND DIMENSIONS PRIOR TO THE START OF CONSTRUCTION.
5. THE CONTRACTOR SHALL MAINTAIN PEDESTRIAN ACCESS AT ALL SURROUNDING ROADWAYS AT ALL TIMES DURING CONSTRUCTION. ACCESS SHALL BE MAINTAINED SUCH THAT ALL TEMPORARY ROUTES ARE ACCESSIBLE TO DISABLED PERSONS AROUND BLOCKAGES TO AN EXISTING PEDESTRIAN ROUTE (E.G. SIDEWALKS, CROSSWALKS, PEDESTRIAN CURB RAMPS, ETC.) BLOCKAGES INCLUDE, BUT ARE NOT LIMITED TO, CONSTRUCTION WORK, EXCAVATIONS, EQUIPMENT AND VEHICLES, TEMPORARY WATER AND UTILITY LINES.
6. SIDEWALK AREAS SHALL REMAIN OPEN AND FREE FROM SAFETY CONTROL DEVICES AND CONSTRUCTION DEBRIS THROUGHOUT THE DURATION OF CONSTRUCTION. PEDESTRIAN DETOURING SHALL NOT OCCUR UNLESS APPROVED BY THE CITY.
7. WHERE THE NEW CONSTRUCTION IS WITHIN THE EXISTING TRAVELED WAY, THE CONTRACTOR SHALL PERFORM WORK IN A MANNER ACCEPTABLE TO THE ENGINEER SO THAT INTERFERENCE TO BUSINESS CONCERNS AND ABUTTERS, DUE TO THE CONSTRUCTION WORK, IS KEPT TO A MINIMUM. THE CONTRACTOR WILL NOT BE ALLOWED TO PARK EQUIPMENT, OR STOCKPILE MATERIAL ON THE TRAVELED WAYS OVERNIGHT OR WHEN NOT IN USE. THE CONTRACTOR SHALL MAINTAIN SAFE AND REASONABLE ACCESS TO AND FROM ABUTTING PROPERTIES AT ALL TIMES AT NO ADDITIONAL COST.
8. CONTRACTOR SHALL BE RESPONSIBLE FOR INVESTIGATING AND CONFIRMING THAT ALL ITEMS TO BE REUSED ARE IN SERVICEABLE CONDITION. IF IT IS DEEMED THAT ANY ITEM IS NOT ABLE TO BE REUSED, THE CONTRACTOR SHALL NOTIFY THE ENGINEER IN WRITING AND INCLUDE ESTIMATED COSTS TO INSTALL NEW.
9. THE CONTRACTOR SHALL DISPOSE OF ALL WASTE MATERIAL IN ACCORDANCE WITH ALL FEDERAL, STATE, AND LOCAL REGULATIONS AT HIS OWN EXPENSE, OUTSIDE OF THE PROJECT LIMITS.
10. THE CONTRACTOR SHALL ERADICATE EXISTING PAVEMENT MARKINGS THAT CONFLICT WITH PROPOSED PAVEMENT MARKINGS, USING CITY APPROVED METHODS.
11. THE MINIMUM MOUNTING HEIGHT OF POST-MOUNTED SIGNS, MEASURED VERTICALLY FROM THE BOTTOM OF THE SIGN TO THE TOP OF THE CURB OR SIDEWALK, OR TO THE TOP ELEVATION OF THE NEAR EDGE OF THE TRAVELED WAY, SHALL BE 7 FEET UNLESS OTHERWISE SPECIFIED ON THE PLANS.
12. UNLESS OTHERWISE NOTED, RETAIN ALL EXISTING SIGNS.

| | | | | | | |
|--|---------|----------|----------|------------|-----------|--------------|
| CITY OF CAMBRIDGE TRAFFIC, PARKING, & TRANSPORTATION DEPARTMENT MT. AUBURN STREET BUS PRIORITY PILOT TRAFFIC SIGN & PAVEMENT MARKINGS | | | | | | |
| | DATE | DRAWN BY | CHKD. BY | APPRVD. BY | SHEET NO. | TOTAL SHEETS |
| | 8/10/18 | SM | PB | . | 2 | 11 |

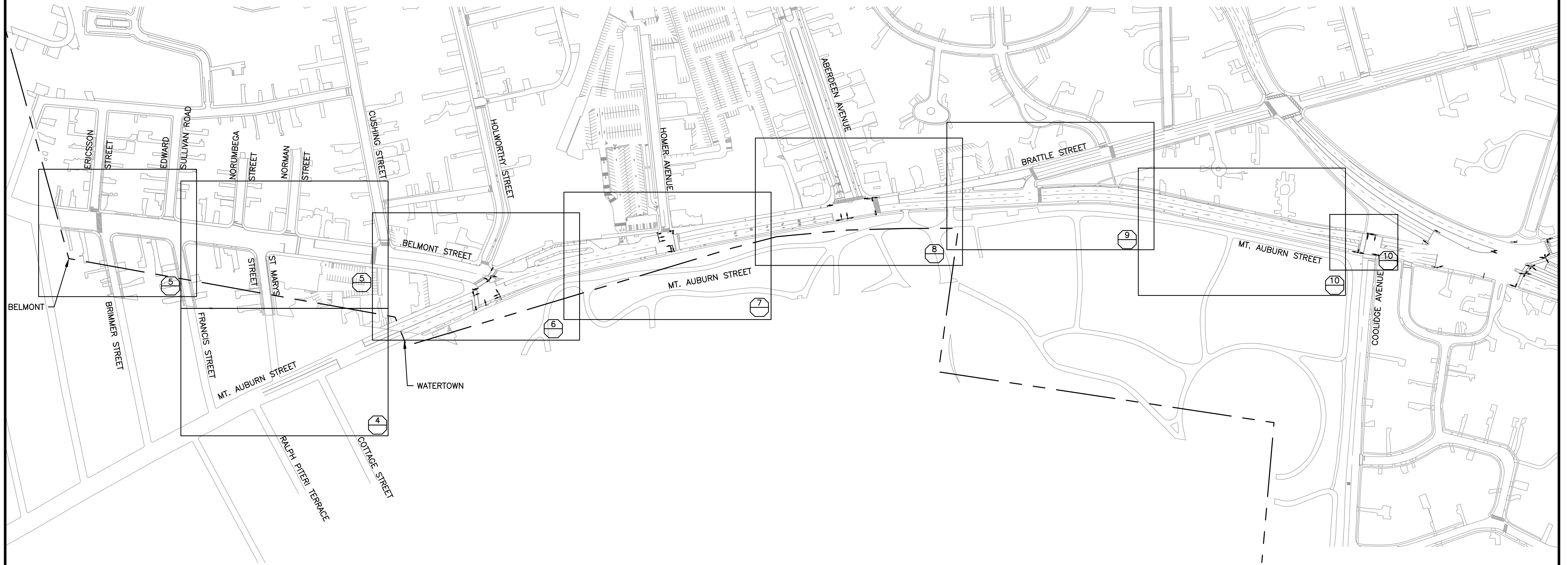
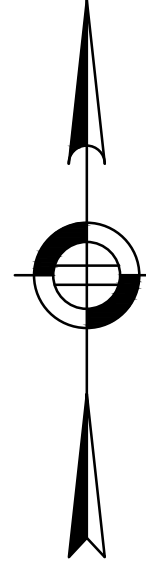

LEGEND

 TRAFFIC SIGN AND PAVEMENT MARKINGS SHEET NO.

| | | | | | | |
|---|----------|----------|------------|-----------|--------------|--|
| CITY OF CAMBRIDGE TRAFFIC, PARKING, & TRANSPORTATION DEPARTMENT | | | | | | |
| MT. AUBURN STREET BUS PRIORITY PILOT TRAFFIC SIGN & PAVEMENT MARKINGS | | | | | | |
| DATE | DRAWN BY | CHKD. BY | APPRVD. BY | SHEET NO. | TOTAL SHEETS | |
| 8/10/18 | SM | PB | . | 3 | 11 | |



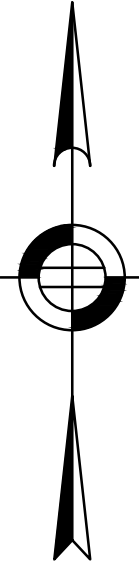

NOTES:

- 1. ALL EXISTING PAVEMENT MARKINGS TO REMAIN UNLESS DIRECTED BY ENGINEER.

R&S R7-107b
R&S R7-107c



| | | | | | | |
|---|----------|----------|------------|-----------|--------------|--|
| CITY OF CAMBRIDGE TRAFFIC, PARKING, & TRANSPORTATION DEPARTMENT | | | | | | |
| MT. AUBURN STREET BUS PRIORITY PILOT TRAFFIC SIGN & PAVEMENT MARKINGS | | | | | | |
| DATE | DRAWN BY | CHKD. BY | APPRVD. BY | SHEET NO. | TOTAL SHEETS | |
| 8/10/18 | SM | PB | . | 4 | 11 | |

9/17/2018 5:Engineering\Ink Folder - Stephen\Projects\Plan Review\MT Auburn Street\CAD Plan\1011 PAVEMENT MARKINGS_20180501.dwg
 Meese, Stephen

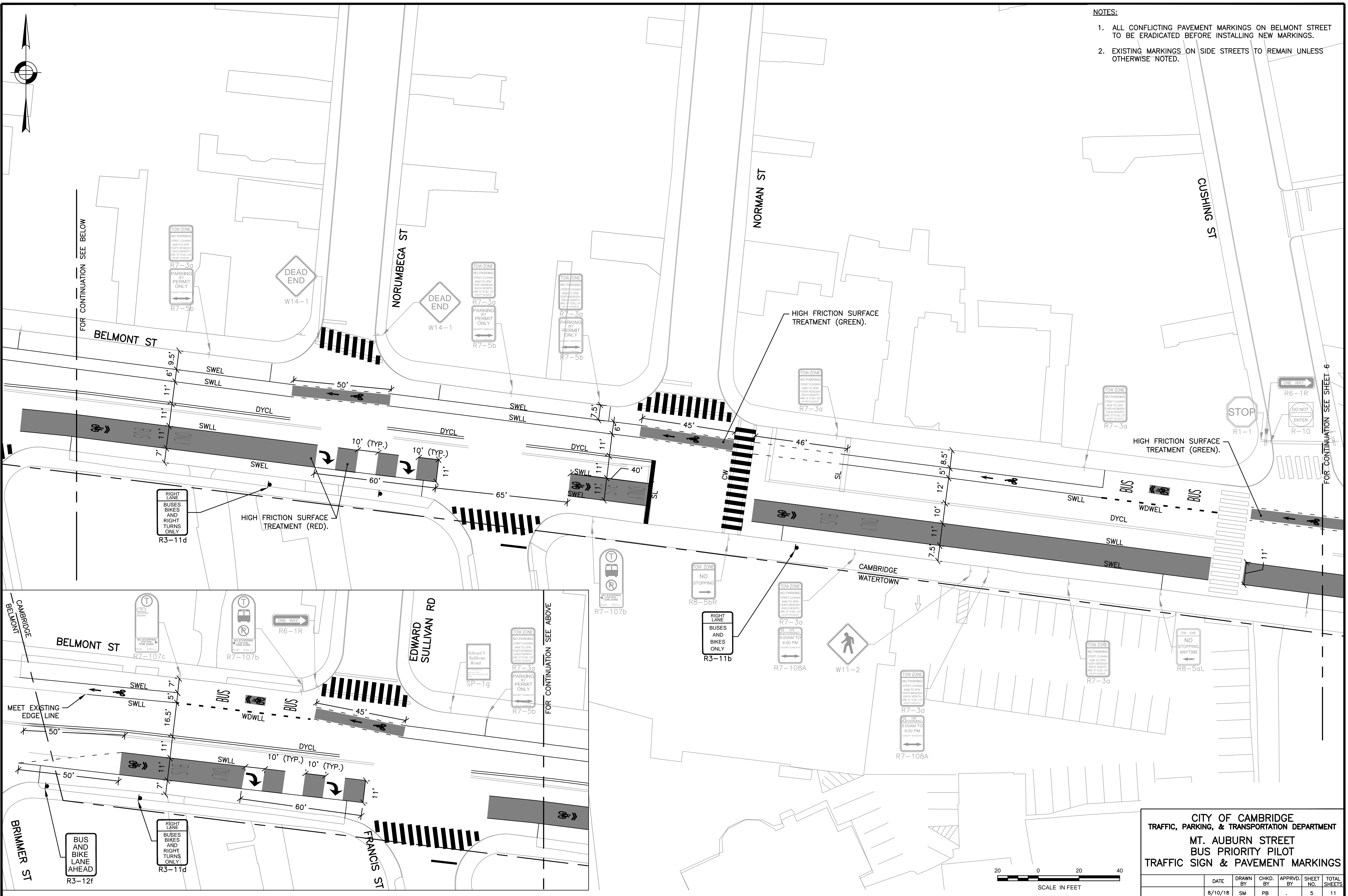

- NOTES:**
1. ALL CONFLICTING PAVEMENT MARKINGS ON BELMONT STREET TO BE ERADICATED BEFORE INSTALLING NEW MARKINGS.
 2. EXISTING MARKINGS ON SIDE STREETS TO REMAIN UNLESS OTHERWISE NOTED.

CITY OF CAMBRIDGE
 TRAFFIC, PARKING, & TRANSPORTATION DEPARTMENT
MT. AUBURN STREET
BUS PRIORITY PILOT
 TRAFFIC SIGN & PAVEMENT MARKINGS

| DATE | DRAWN BY | CHKD. BY | APPRVD. BY | SHEET NO. | TOTAL SHEETS |
|---------|----------|----------|------------|-----------|--------------|
| 8/10/18 | SM | PB | | 5 | 11 |

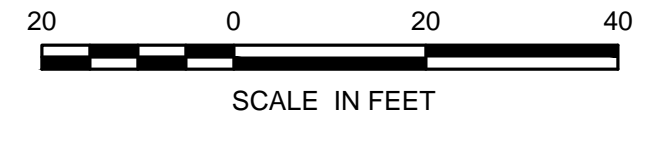

FOR CONTINUATION SEE BELOW

FOR CONTINUATION SEE ABOVE

FOR CONTINUATION SEE SHEET 6

9/17/2018 5:Engineering\Ink Folder - Stephen\Projects\Plan Review\MT Auburn SWA\CAD Plans\16011 PAVEMENT MARKINGS_20180501.dwg
 Meese, Stephen

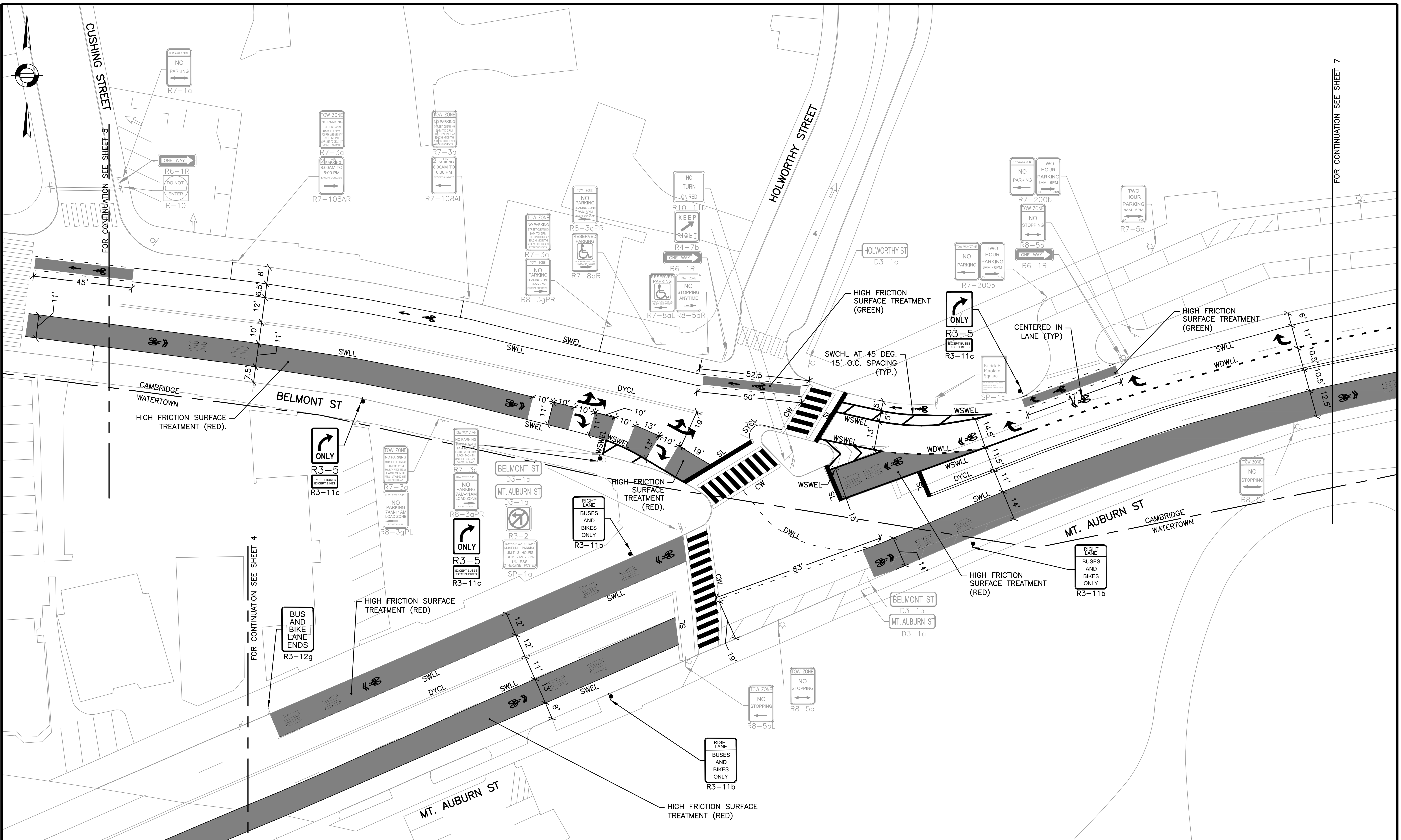

- NOTES:**
1. ALL CONFLICTING PAVEMENT MARKINGS ON MOUNT AUBURN STREET AND BELMONT STREET TO BE ERADICATED BEFORE INSTALLING NEW MARKINGS.
 2. EXISTING MARKINGS ON SIDE STREETS TO REMAIN UNLESS OTHERWISE NOTED.

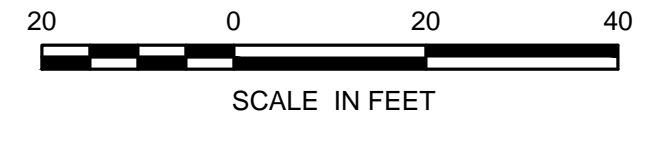

**CITY OF CAMBRIDGE
 TRAFFIC, PARKING, & TRANSPORTATION DEPARTMENT
 MT. AUBURN STREET
 BUS PRIORITY PILOT
 TRAFFIC SIGN & PAVEMENT MARKINGS**

| DATE | DRAWN BY | CHKD. BY | APPRVD. BY | SHEET NO. | TOTAL SHEETS |
|---------|----------|----------|------------|-----------|--------------|
| 8/10/18 | SM | PB | | 6 | 11 |

FOR CONTINUATION SEE SHEET 5

FOR CONTINUATION SEE SHEET 4

FOR CONTINUATION SEE SHEET 7

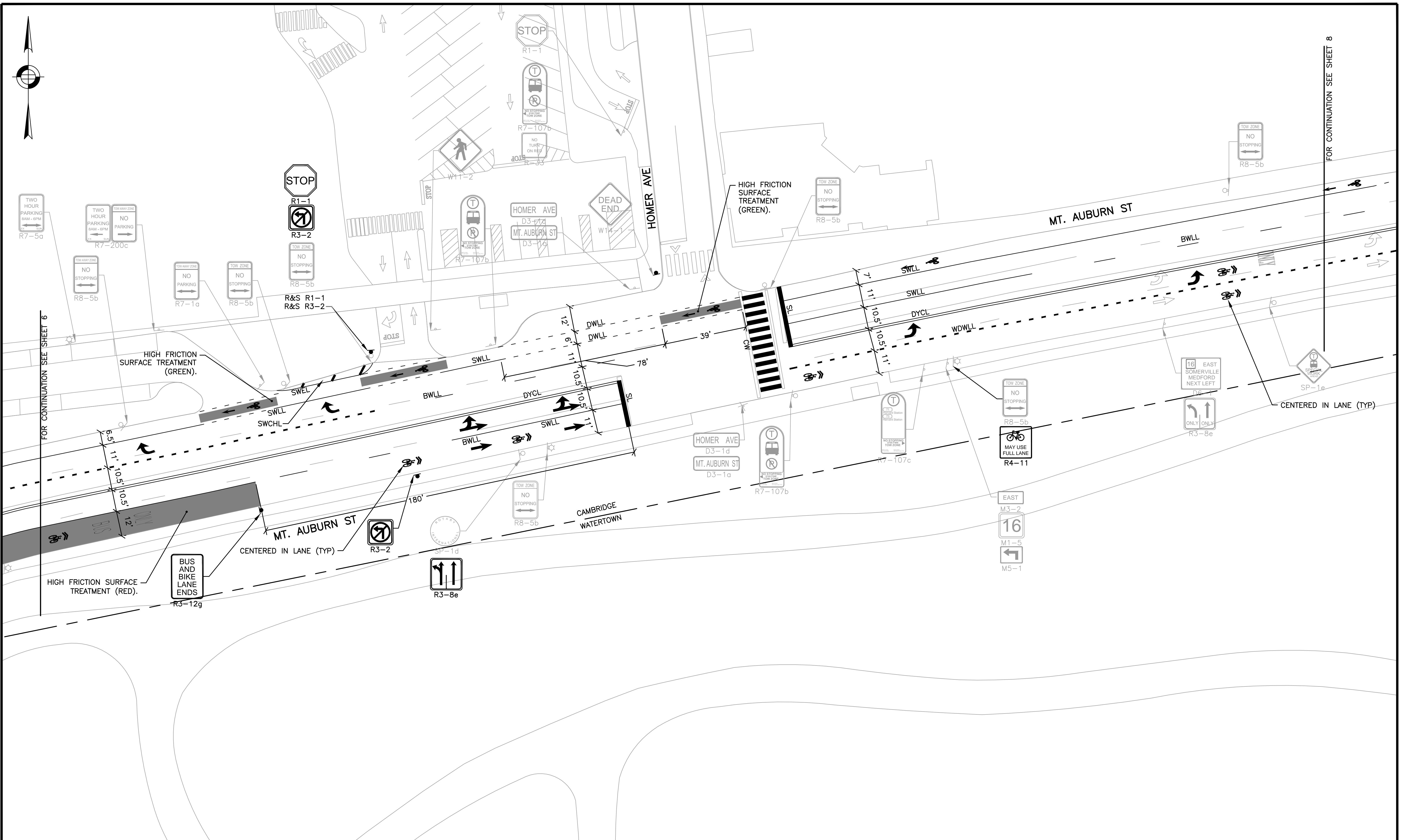
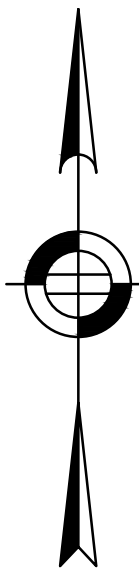

FOR CONTINUATION SEE SHEET 6

FOR CONTINUATION SEE SHEET 8

NOTES:

1. ALL CONFLICTING PAVEMENT MARKINGS ON MOUNT AUBURN STREET TO BE ERADICATED BEFORE INSTALLING NEW MARKINGS.
2. EXISTING MARKINGS ON SIDE STREETS TO REMAIN UNLESS OTHERWISE NOTED.



| | | | | | | |
|---|----------|----------|------------|-----------|--------------|--|
| CITY OF CAMBRIDGE TRAFFIC, PARKING, & TRANSPORTATION DEPARTMENT | | | | | | |
| MT. AUBURN STREET BUS PRIORITY PILOT TRAFFIC SIGN & PAVEMENT MARKINGS | | | | | | |
| DATE | DRAWN BY | CHKD. BY | APPRVD. BY | SHEET NO. | TOTAL SHEETS | |
| 8/10/18 | SM | PB | . | 7 | 11 | |

9/17/2018 5:Engineering\Inch Folder - Stephen\Projects\Plan Review\MT Auburn\SubCAD\Plan\16011 PAVEMENT MARKINGS_20180501.dwg
Messe, Stephen

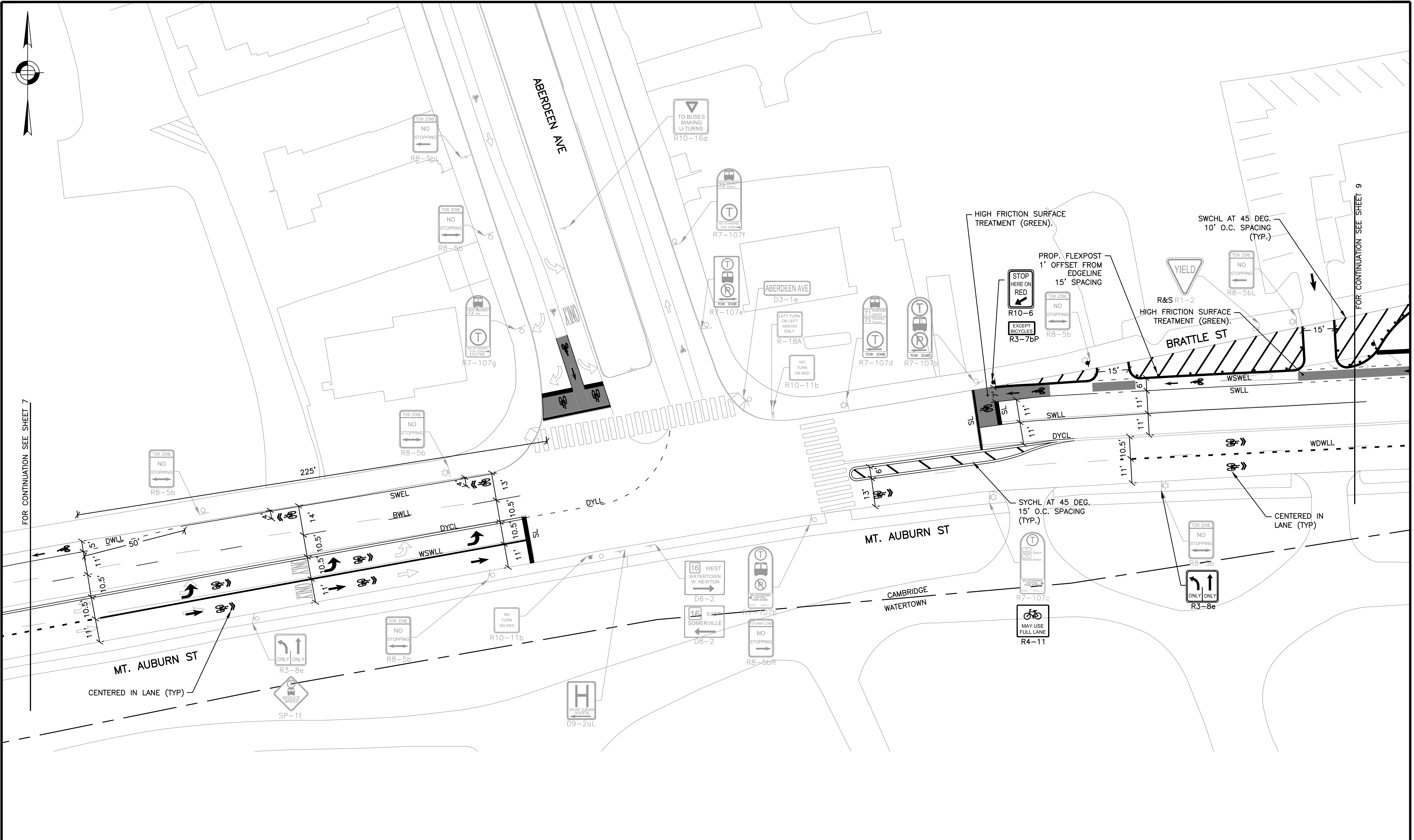

- NOTES:
- ALL CONFLICTING PAVEMENT MARKINGS ON MOUNT AUBURN STREET TO BE ERADICATED BEFORE INSTALLING NEW MARKINGS.
 - EXISTING MARKINGS ON SIDE STREETS TO REMAIN UNLESS OTHERWISE NOTED.

CITY OF CAMBRIDGE
TRAFFIC, PARKING, & TRANSPORTATION DEPARTMENT
MT. AUBURN STREET
BUS PRIORITY PILOT
TRAFFIC SIGN & PAVEMENT MARKINGS

| DATE | DRAWN BY | CHKD. BY | APPRVD. BY | SHEET NO. | TOTAL SHEETS |
|---------|----------|----------|------------|-----------|--------------|
| 8/10/18 | SM | PB | . | 8 | 11 |

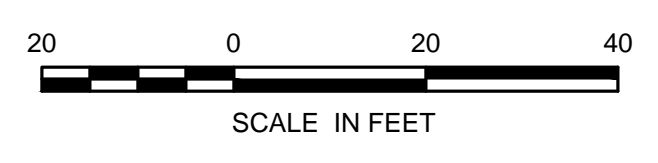

FOR CONTINUATION SEE SHEET 7

FOR CONTINUATION SEE SHEET 9

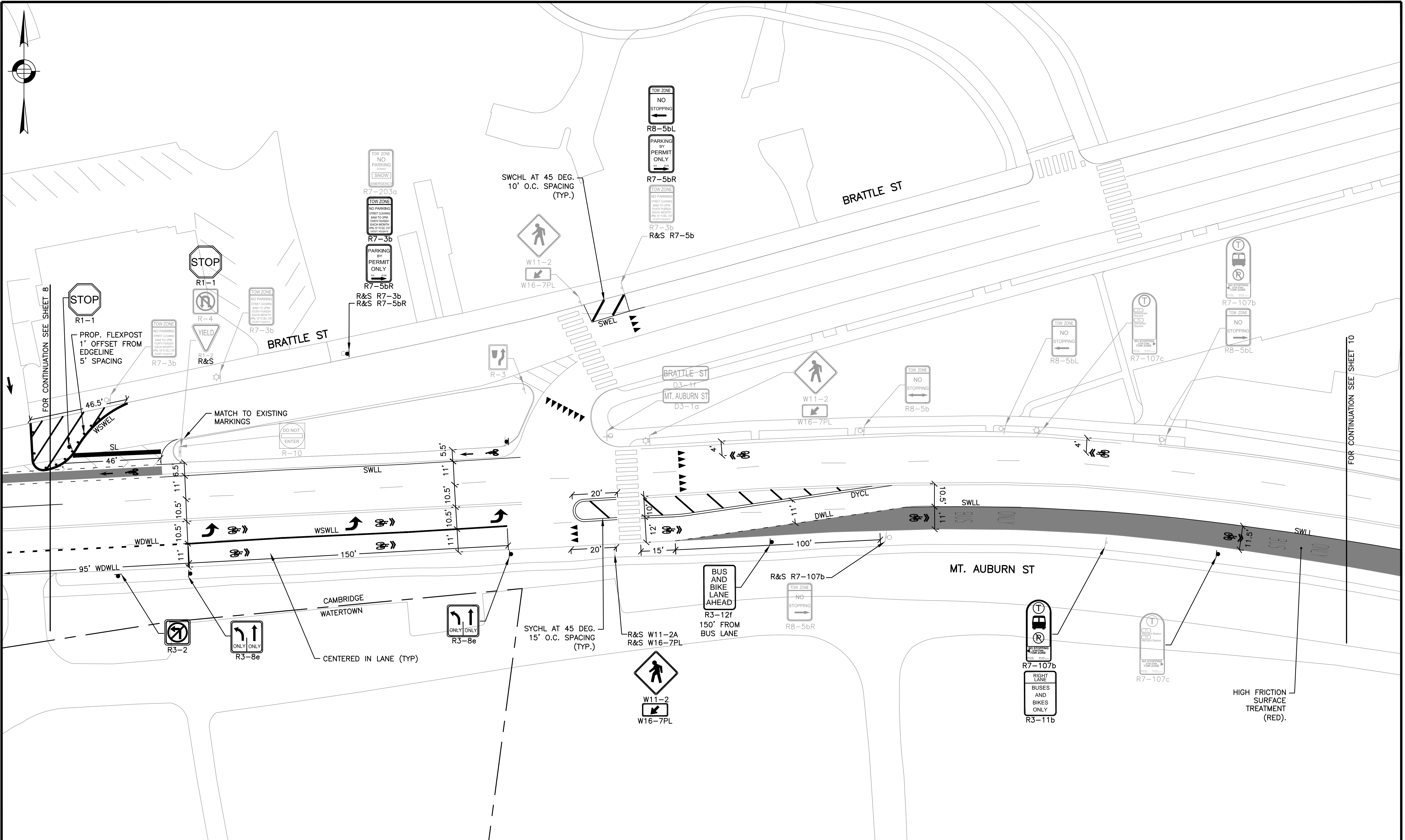

- NOTES:
1. ALL CONFLICTING PAVEMENT MARKINGS ON MOUNT AUBURN STREET TO BE ERADICATED BEFORE INSTALLING NEW MARKINGS.
 2. EXISTING MARKINGS ON SIDE STREETS TO REMAIN UNLESS OTHERWISE NOTED.

CITY OF CAMBRIDGE
 TRAFFIC, PARKING, & TRANSPORTATION DEPARTMENT
 MT. AUBURN STREET
 BUS PRIORITY PILOT
 TRAFFIC SIGN & PAVEMENT MARKINGS

| DATE | DRAWN BY | CHKD. BY | APPRVD. BY | SHEET NO. | TOTAL SHEETS |
|---------|----------|----------|------------|-----------|--------------|
| 8/10/18 | SM | PB | | 9 | 11 |

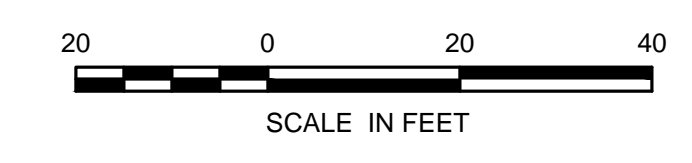

- NOTE:**
1. ALL CONFLICTING PAVEMENT MARKINGS ON MOUNT AUBURN STREET TO BE ERADICATED BEFORE INSTALLING NEW MARKINGS.
 2. LANDING PAD CONSTRUCTED BY OTHERS. NEEDED TO PROVIDE ADA ACCESS FOR NEW BUS STOP LOCATION.
 3. SIGNALS SHOWN ARE PROPOSED TO BE MODIFIED UNDER THE DCR PROJECT (DCR #681).
 4. EXISTING MARKINGS ON SIDE STREETS TO REMAIN UNLESS OTHERWISE NOTED.

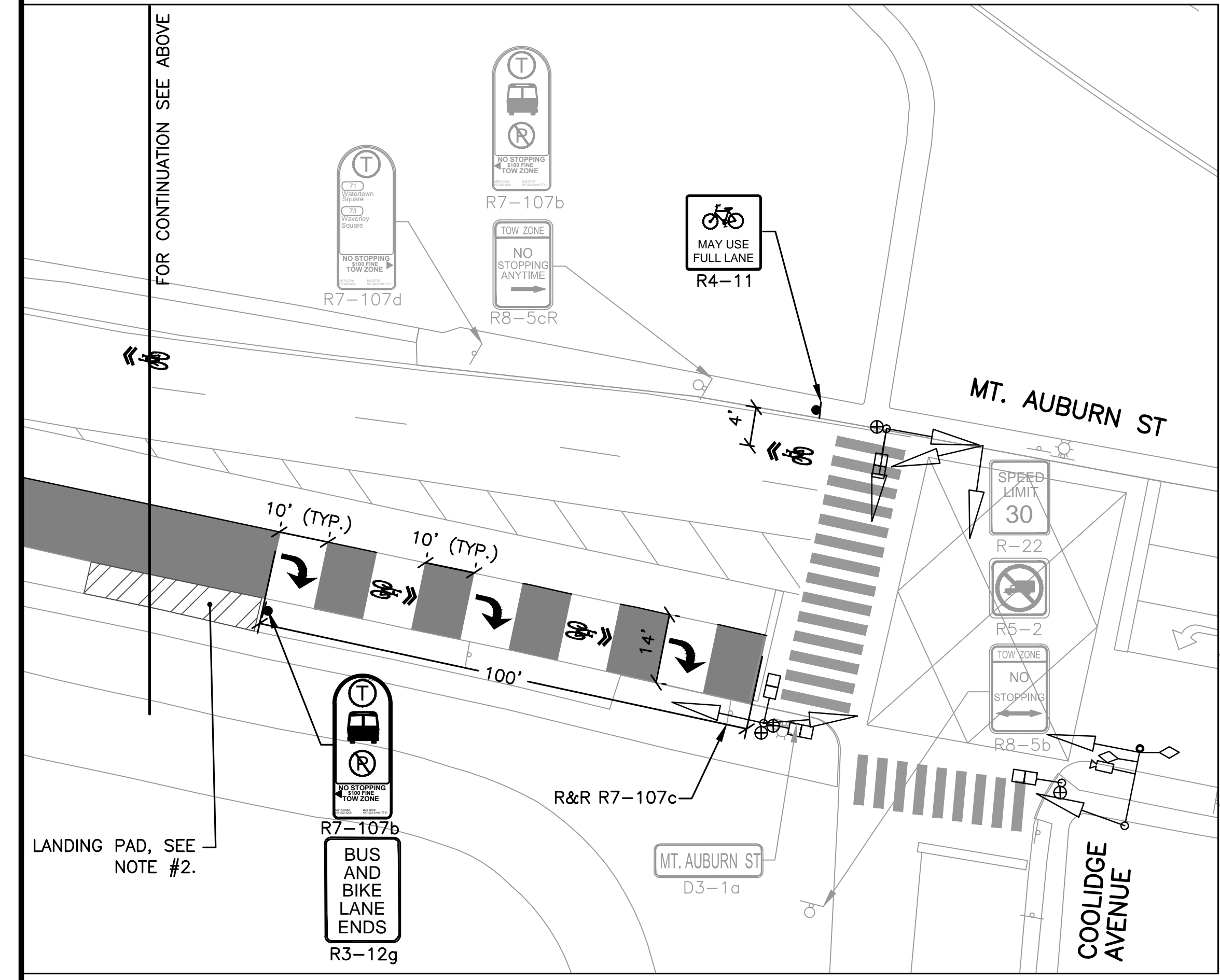
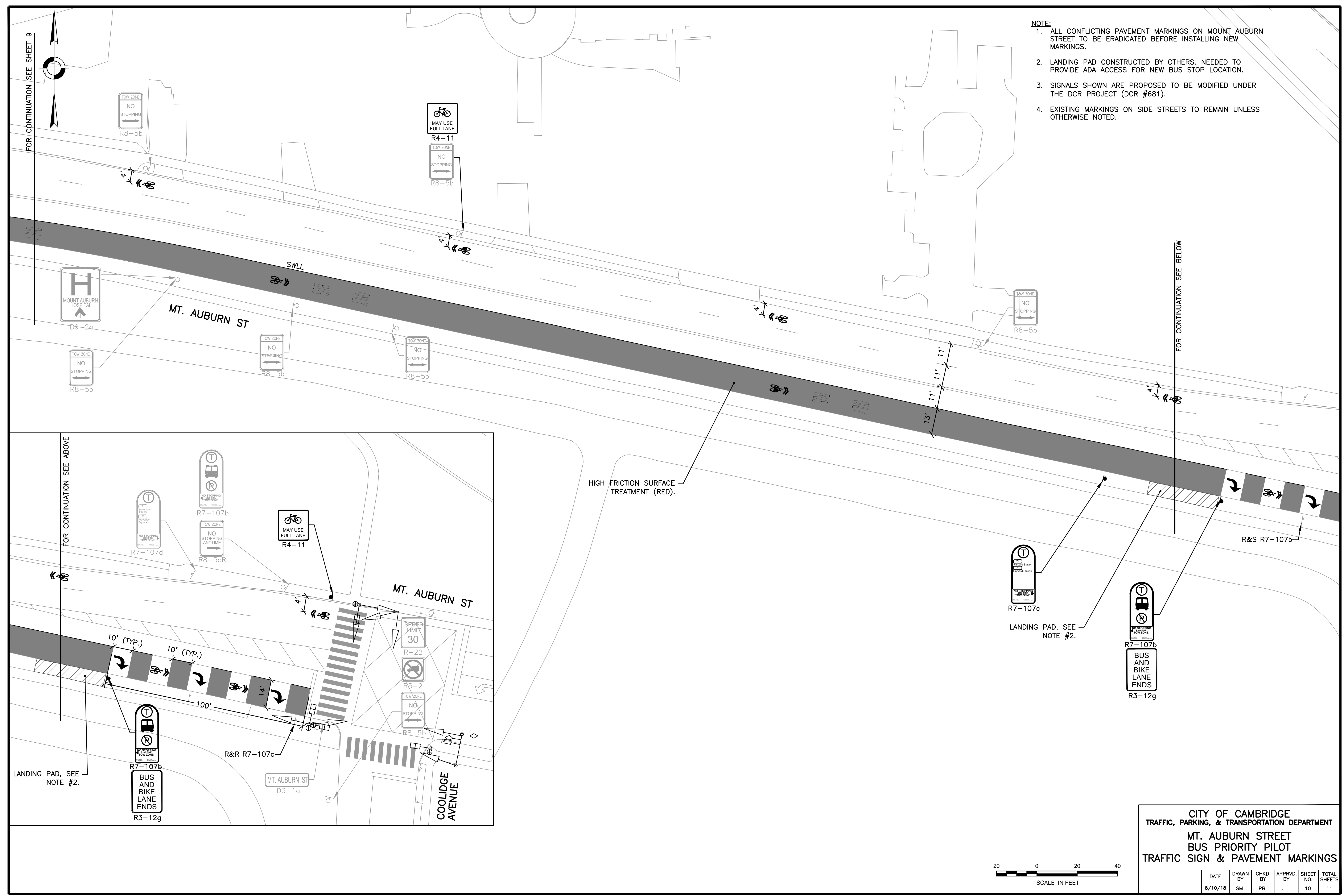

CITY OF CAMBRIDGE
TRAFFIC, PARKING, & TRANSPORTATION DEPARTMENT
MT. AUBURN STREET
BUS PRIORITY PILOT
TRAFFIC SIGN & PAVEMENT MARKINGS

| DATE | DRAWN BY | CHKD. BY | APPRVD. BY | SHEET NO. | TOTAL SHEETS |
|---------|----------|----------|------------|-----------|--------------|
| 8/10/18 | SM | PB | . | 10 | 11 |

