



CAMBRIDGE
REDEVELOPMENT
AUTHORITY



Kendall Square Urban Redevelopment Plan

2020 Kendall Square Urban Redevelopment Area
Streetscape Redesign Main, Broadway, and Third
Transit Committee Presentation 4/7/21



AGENDA

1. STREETScape PROJECT SCOPE, GOALS & OBJECTIVES
2. KSTEP BUS PRIORITY STUDY
3. DEFINING THE STREETS – THIRD ST, BROADWAY, MAIN ST
4. BUS STUDY

IN THE WORKS

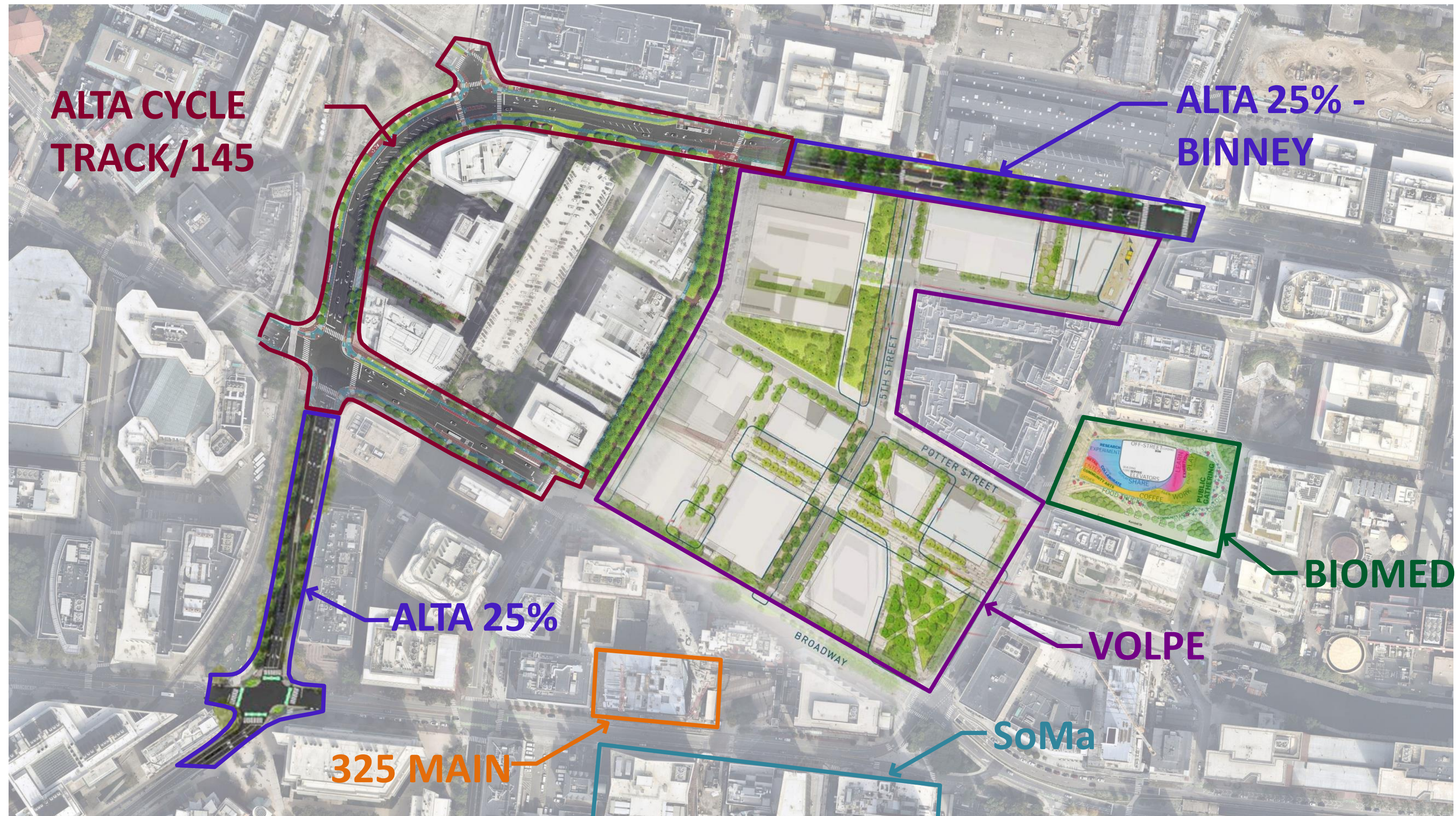

DEFINING THE STREETS

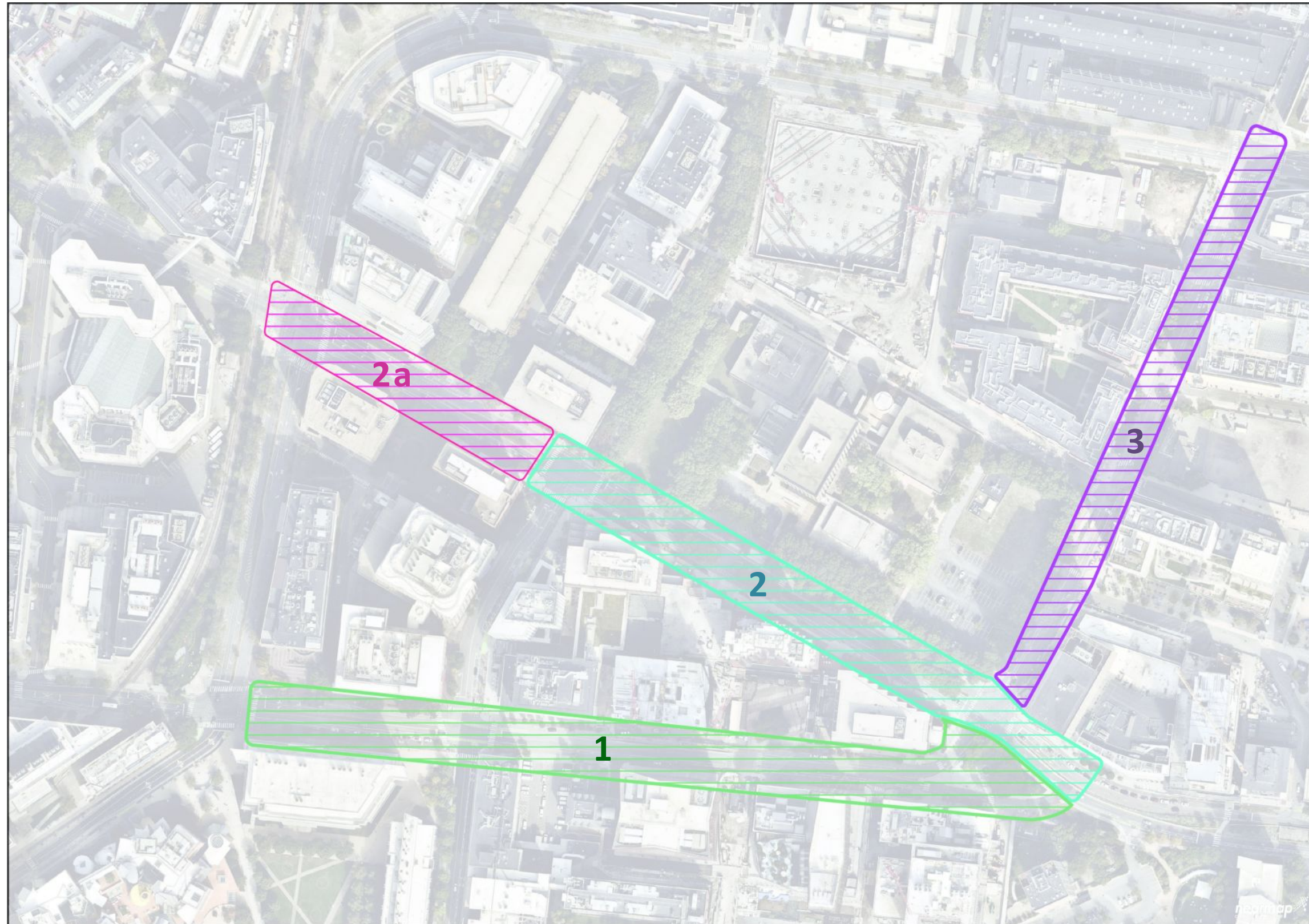

1. Main Street - Pedestrian-Focused Transit Hub (considering an interim & long-term vision)
2. Broadway - Multi-Modal Corridor
- 2a. Broadway Bus Priority Study Only*
3. Third Street - Res/Mixed-Use Mecca

GOALS

- Design streets as high-quality public spaces that maximize the human experience through the provision of public art, street furniture, plantings, hardscape materials, and interpretive elements.
- Reflect Cambridge's environmental sustainability goals
- Design streets to be safe for all users regardless of age, ability, or mode of transportation.
- Design streets to meet all City policies and standards.

OBJECTIVES

- Implement separated bicycle facilities
- Accommodate access to new and existing developments
- Plan around existing and future utilities
- Preserve and enhance the tree canopy
- Improve pedestrian, transit, and bike infrastructure at intersections
- Design for bus/shuttle priority and access to Kendall MIT Station.
- Design for pick-up/drop-off and commercial loading zones
- Activate with retail.

Kendall Bus Priority Study

2018 Bus Delay & Unreliability Study – Areas of Concern

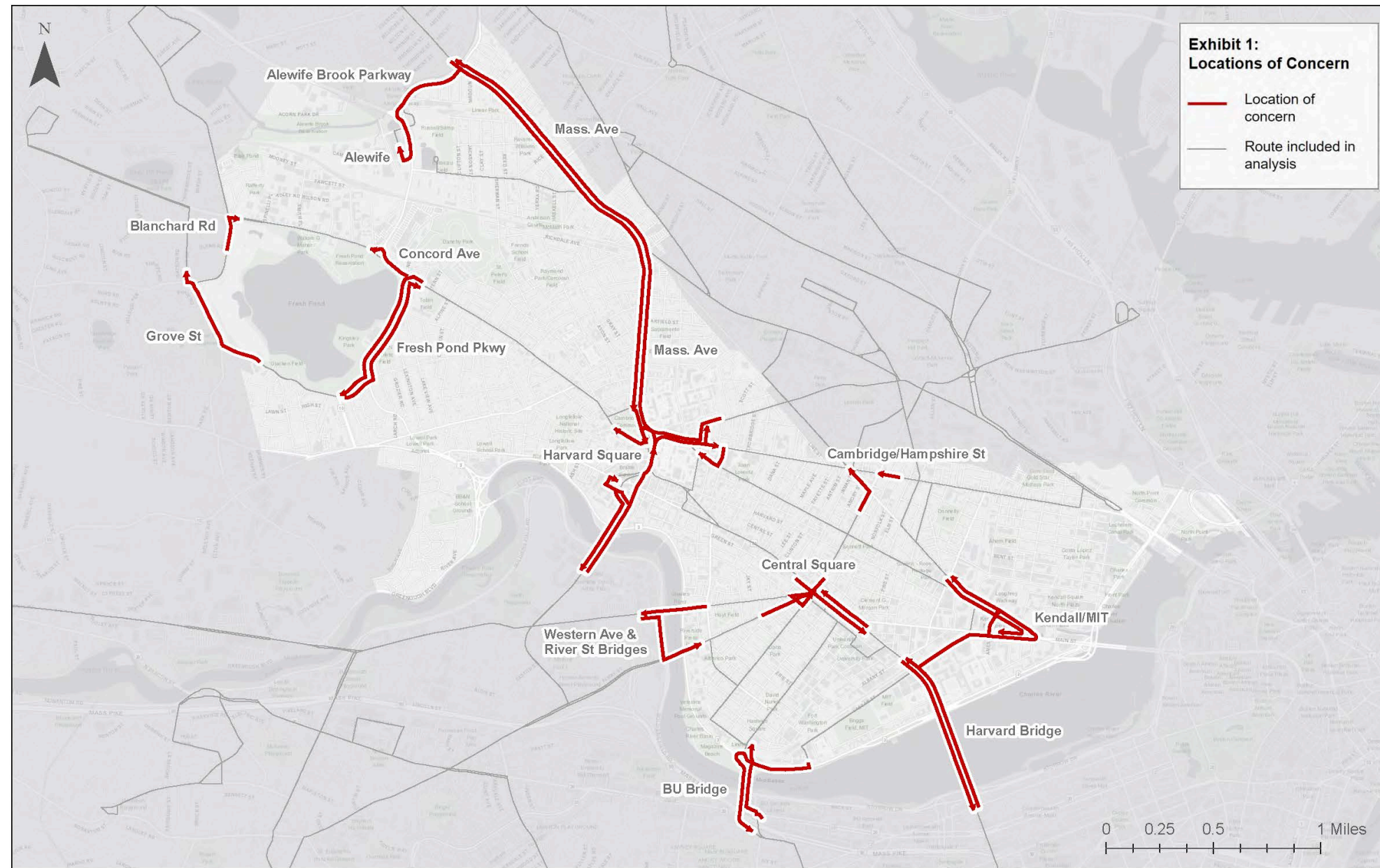

Bus Priority Treatments

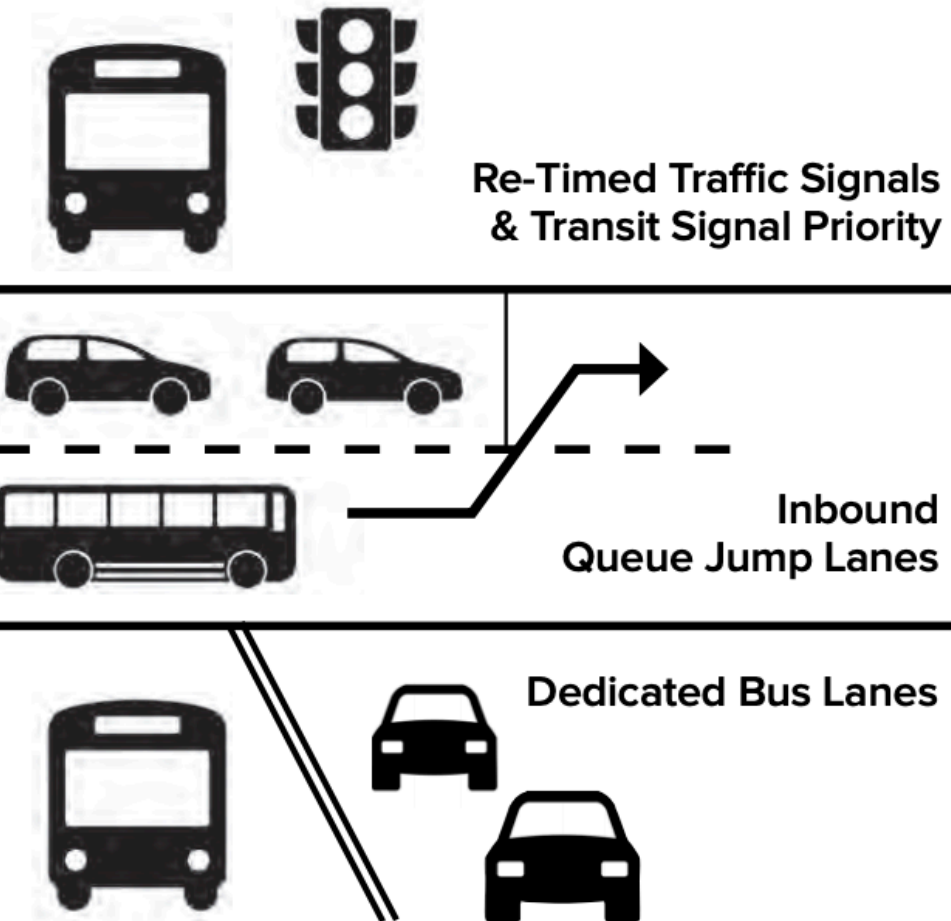

KSTEP

KENDALL SQUARE TRANSIT ENHANCEMENT PROGRAM



- Working group of the City of Cambridge, MassDOT, MBTA, BXP & CRA
- Program to fund programs that improve transit capacity to and from Kendall Square.

Funded Bus Service Improvement Study

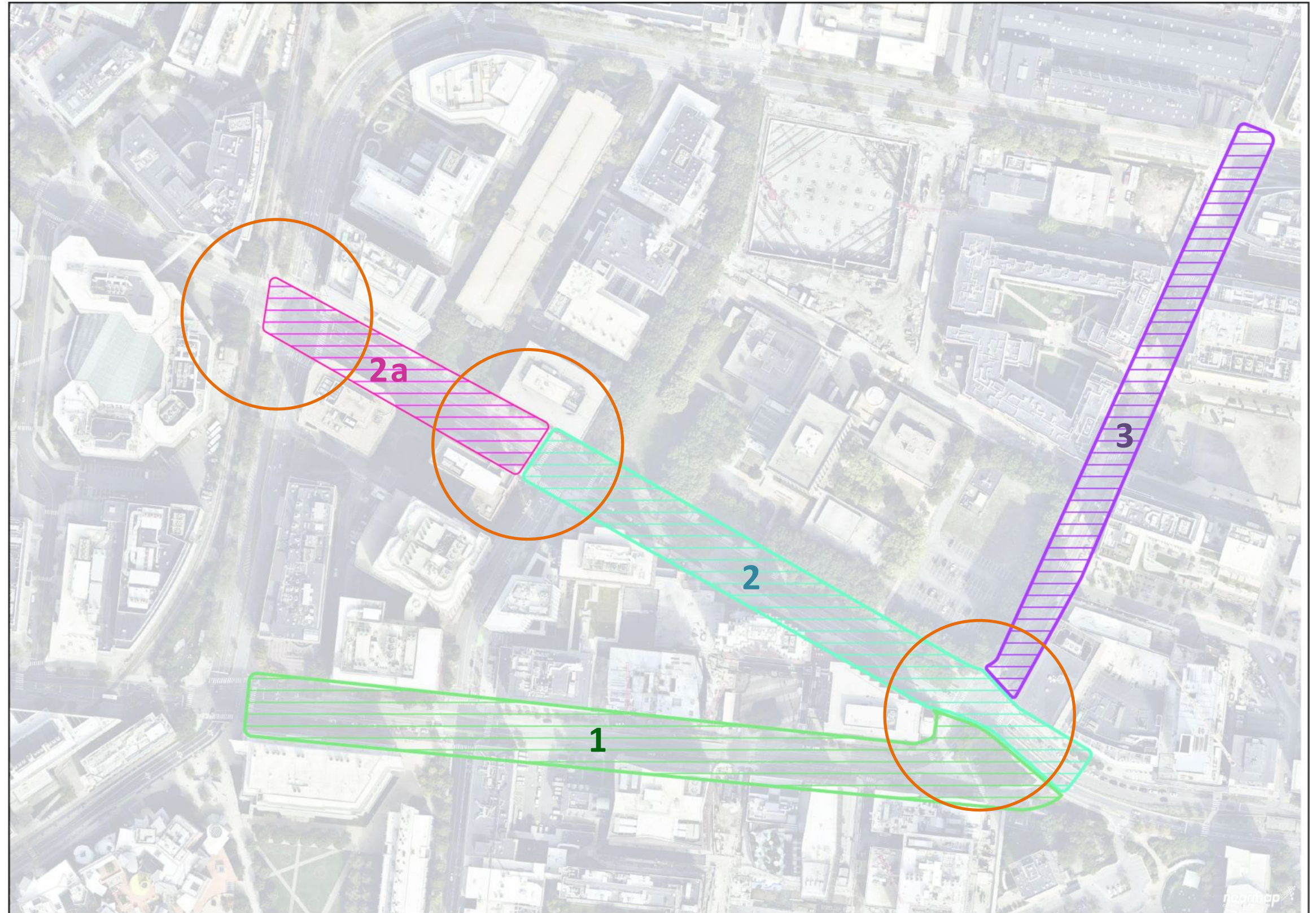

EXISTING CONDITIONS

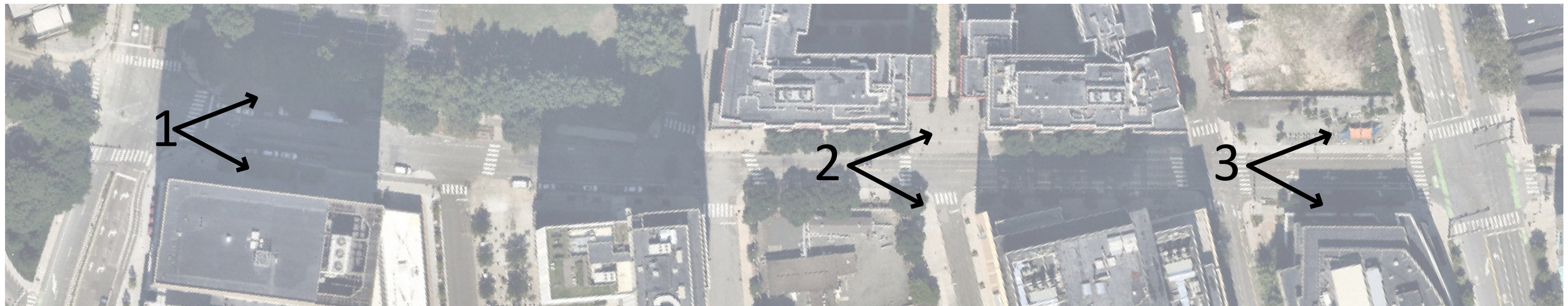
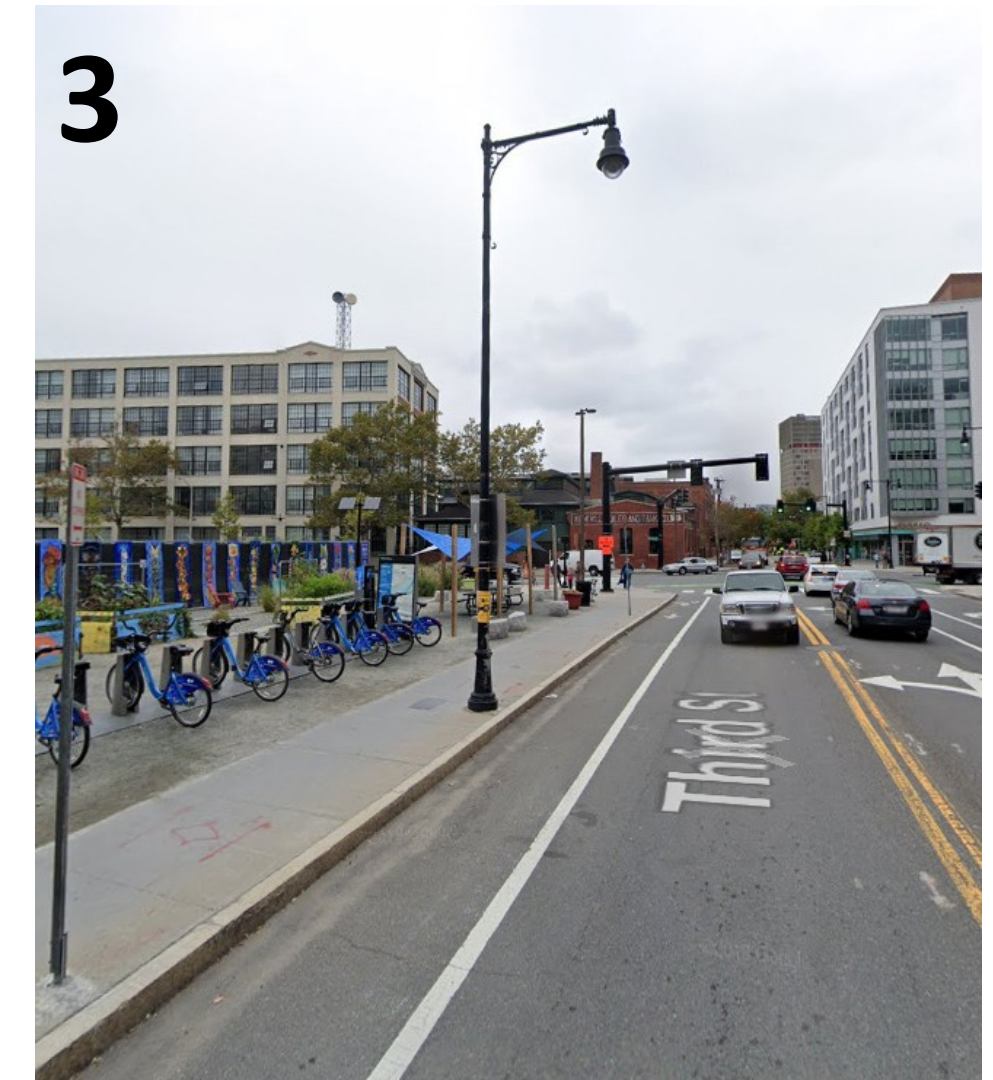

GOALS

1. Integrate intersections of adjacent streets including major connections at Binney, Biomed, and Broad Canal Way (emphasize canal's history)
2. Create placemaking elements that tie the street together and facilitate both safety (pandemic) and interaction (future)
3. Expand on the canopy cover existing today
4. Emphasize and increase the raised cycle track extents (integrate into west side of Volpe property)

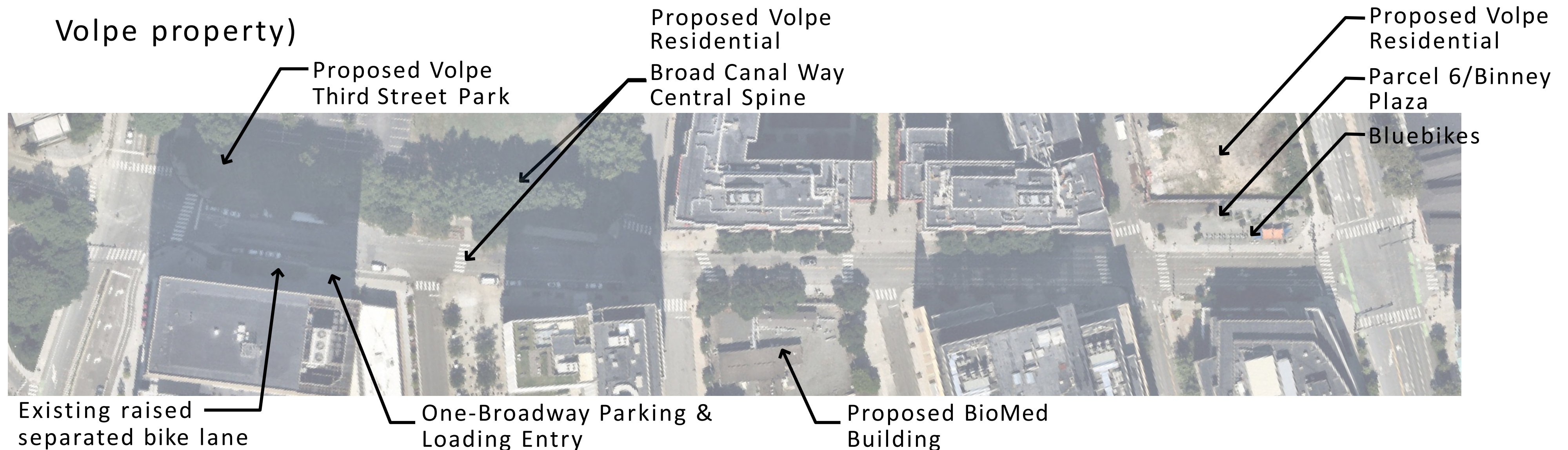

PRECEDENTS



P STREET - LINCOLN, NE



CONGRESS AVE - AUSTIN, TX



THE MEADOW - UK

EXISTING CONDITIONS

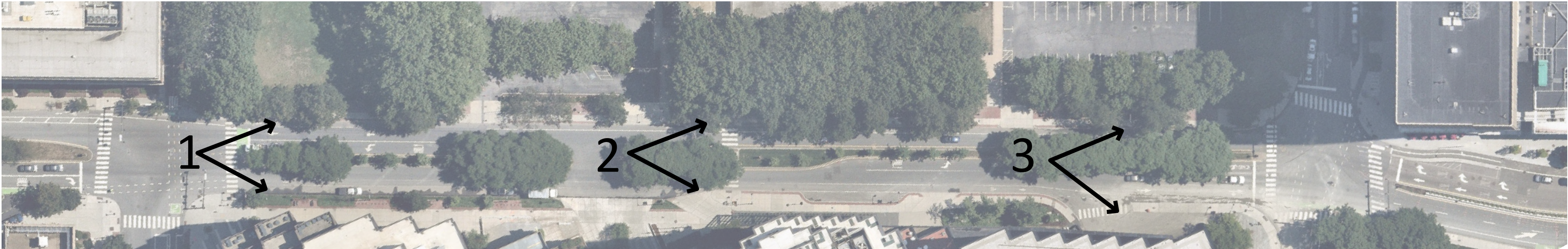
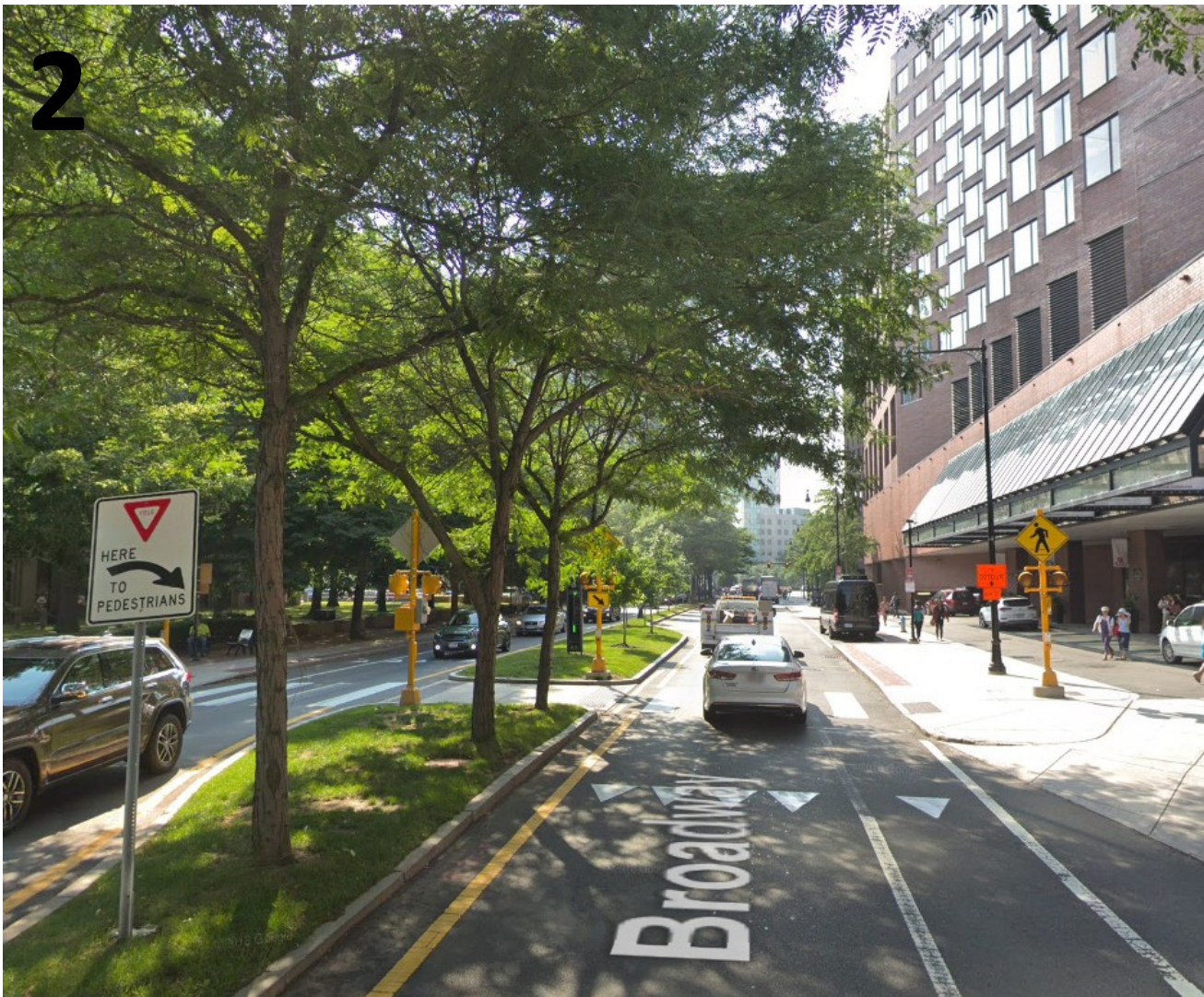

GOALS

- Expand the raised cycle track beyond 6th street
- Connect into Volpe plans
- Preserve existing tree canopy and expand on the "forested edge"
- Reconcile loading zones with pedestrian and cyclist experience.
- Continue placemaking elements begun on 145 Broadway

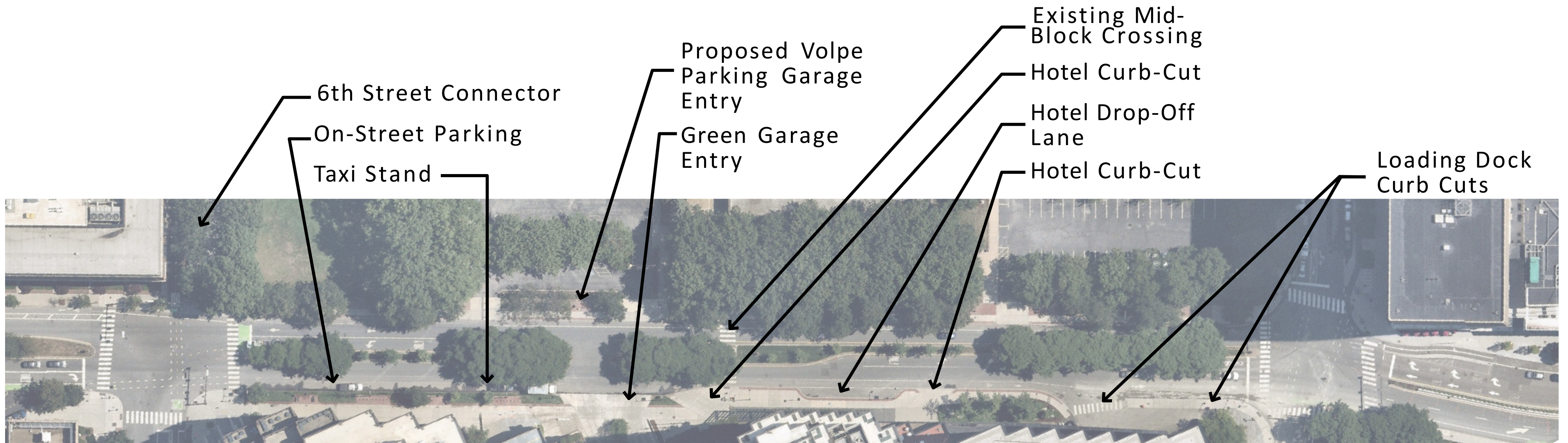

PRECEDENTS



**AUSTIN ACTIVITY
NODES**



**INDIANAPOLIS CULTURAL
TRAIL**



**WALK OF THE TOWN -
BANGKOK**

MAIN STREET

EXISTING CONDITIONS



GOALS

- Provide a transformative public transit gateway into Kendall Square
- Facilitate highest and best mix of pedestrian and transit use
- Reconcile need for loading with public realm improvements
- Connect to the greater system

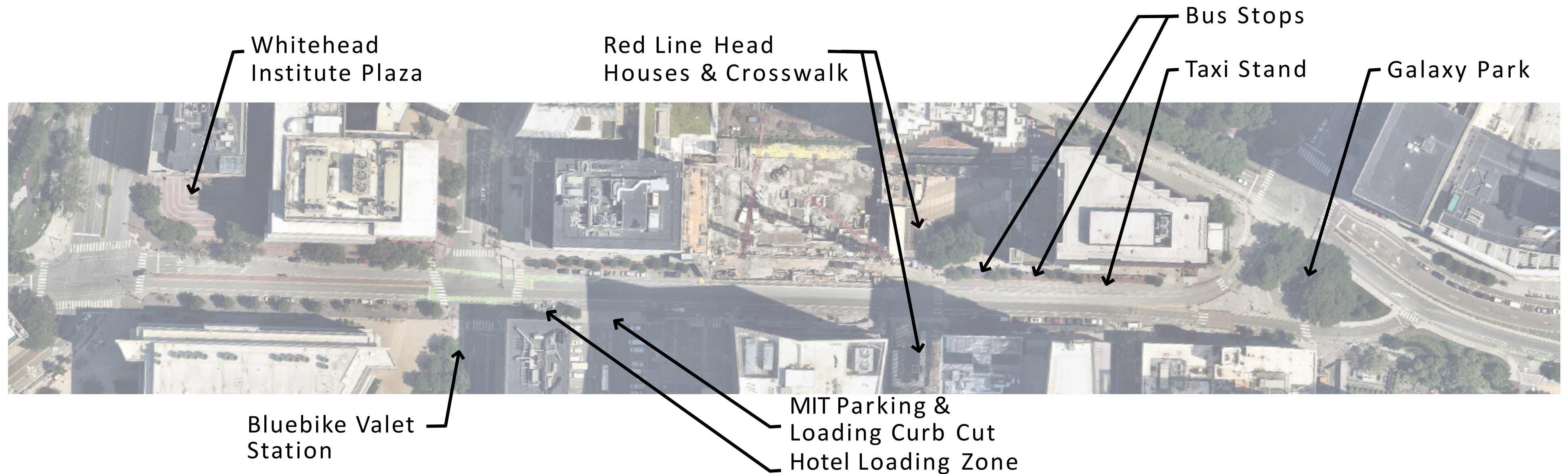

PRECEDENTS – Interim Term



GALILEO WAY TEMP BIKE PATH – Cambridge, MA



MEDIAN BIKE LANE – Sevilla, Spain



QWICK KURB



CENTER LANE PROTECTED BIKE LANES – Athens, GA



MODULAR BUS PLATFORM – Oakland, CA



FLOATING BUS PLATFORM – Portland, OR

PRECEDENTS – Longer Term Vision



NICOLLET MALL - MINNEAPOLIS, MN



DISTRICT WHARF - D.C.



BELL STREET - SEATTLE, WA



Existing Transit Network

Figure is amended from the October 22, 2020 Volpe Exchange Parcel TIS prepared by VHB

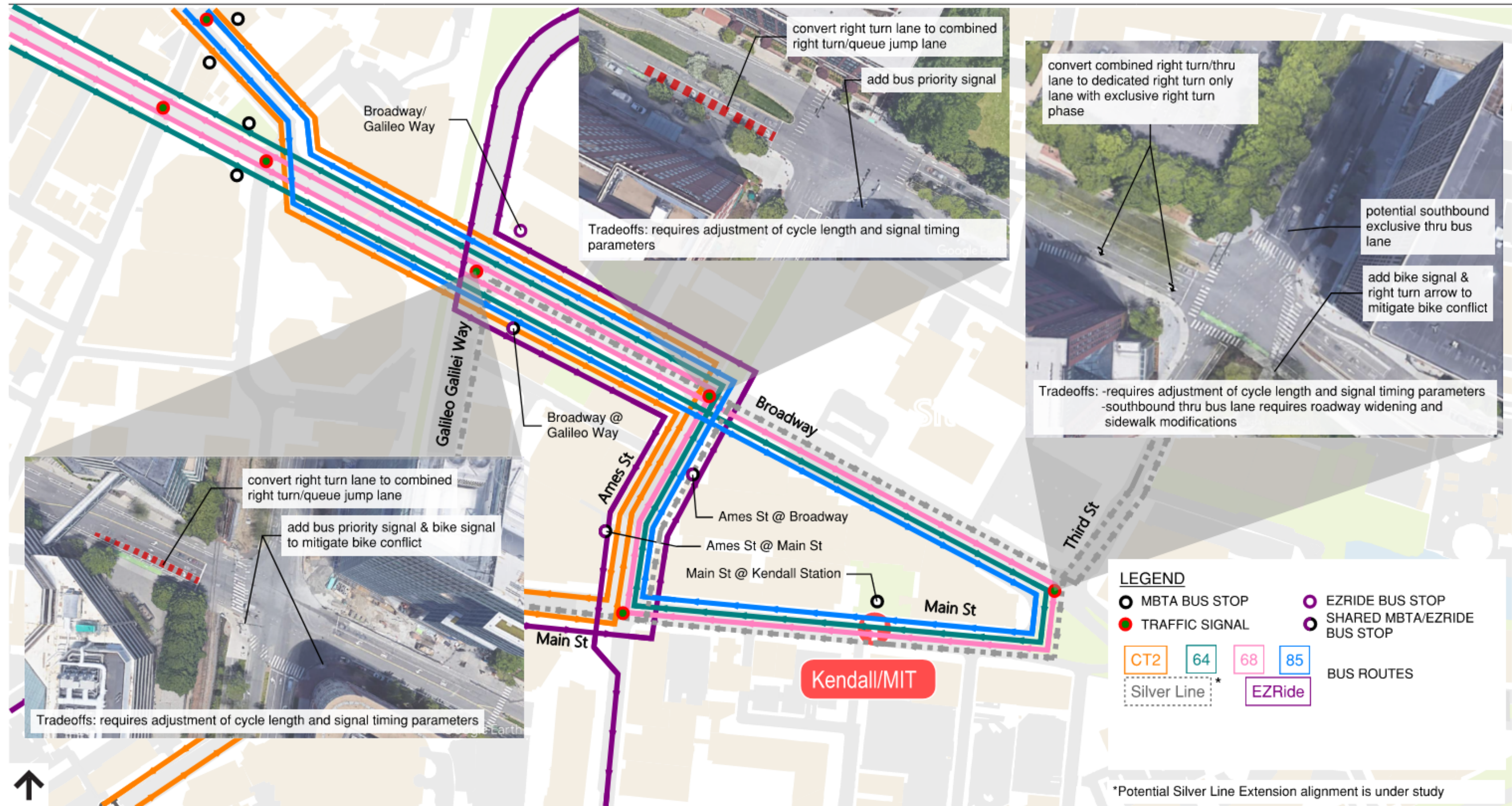

Proposed Broadway Transit Corridor Improvements

Figure is amended from the October 22, 2020 Volpe Exchange Parcel TIS prepared by VHB

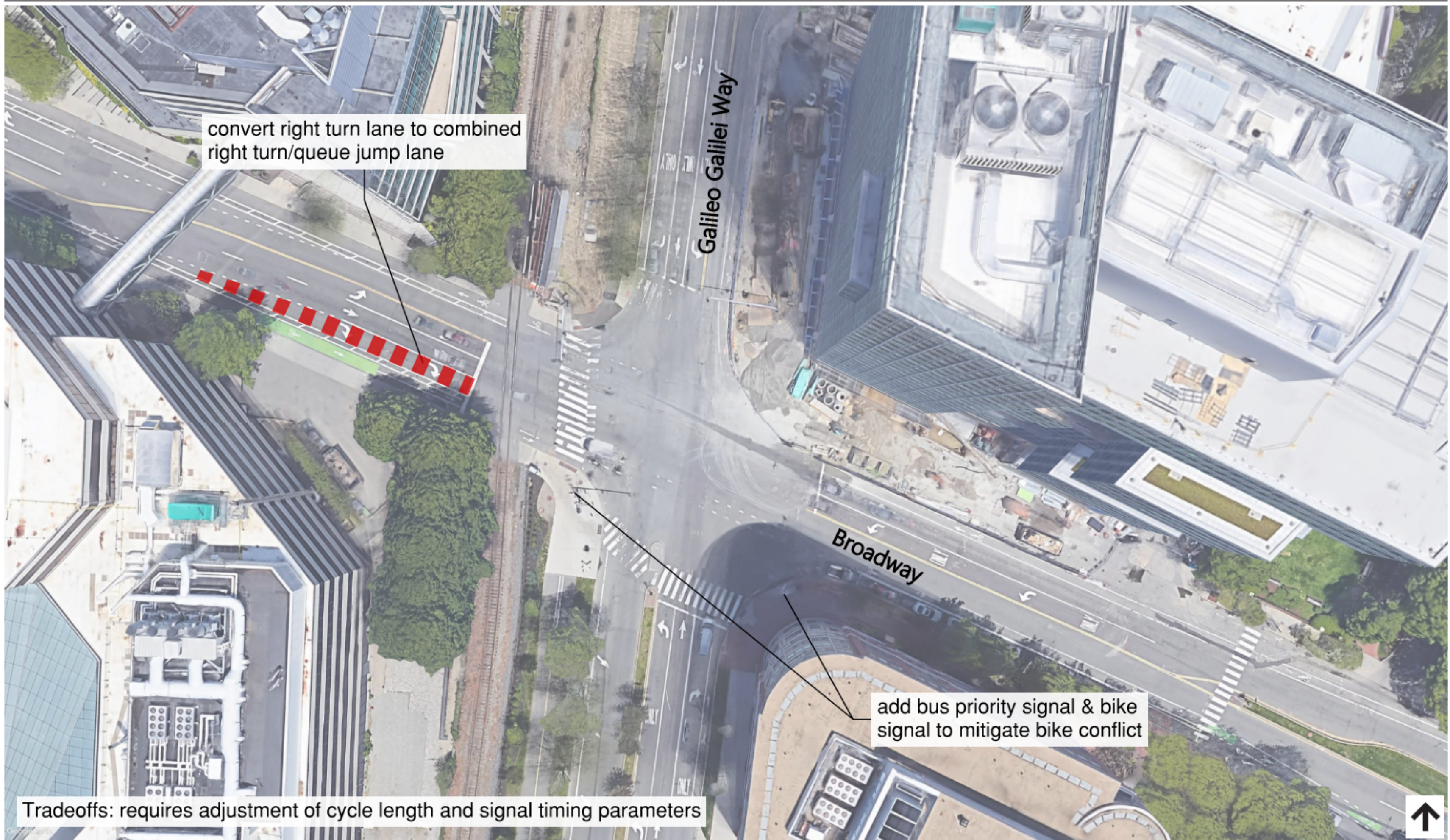

convert right turn lane to combined right turn/queue jump lane

Galileo Galilei Way

Broadway

add bus priority signal & bike signal to mitigate bike conflict

Tradeoffs: requires adjustment of cycle length and signal timing parameters



Broadway @ Galileo Way

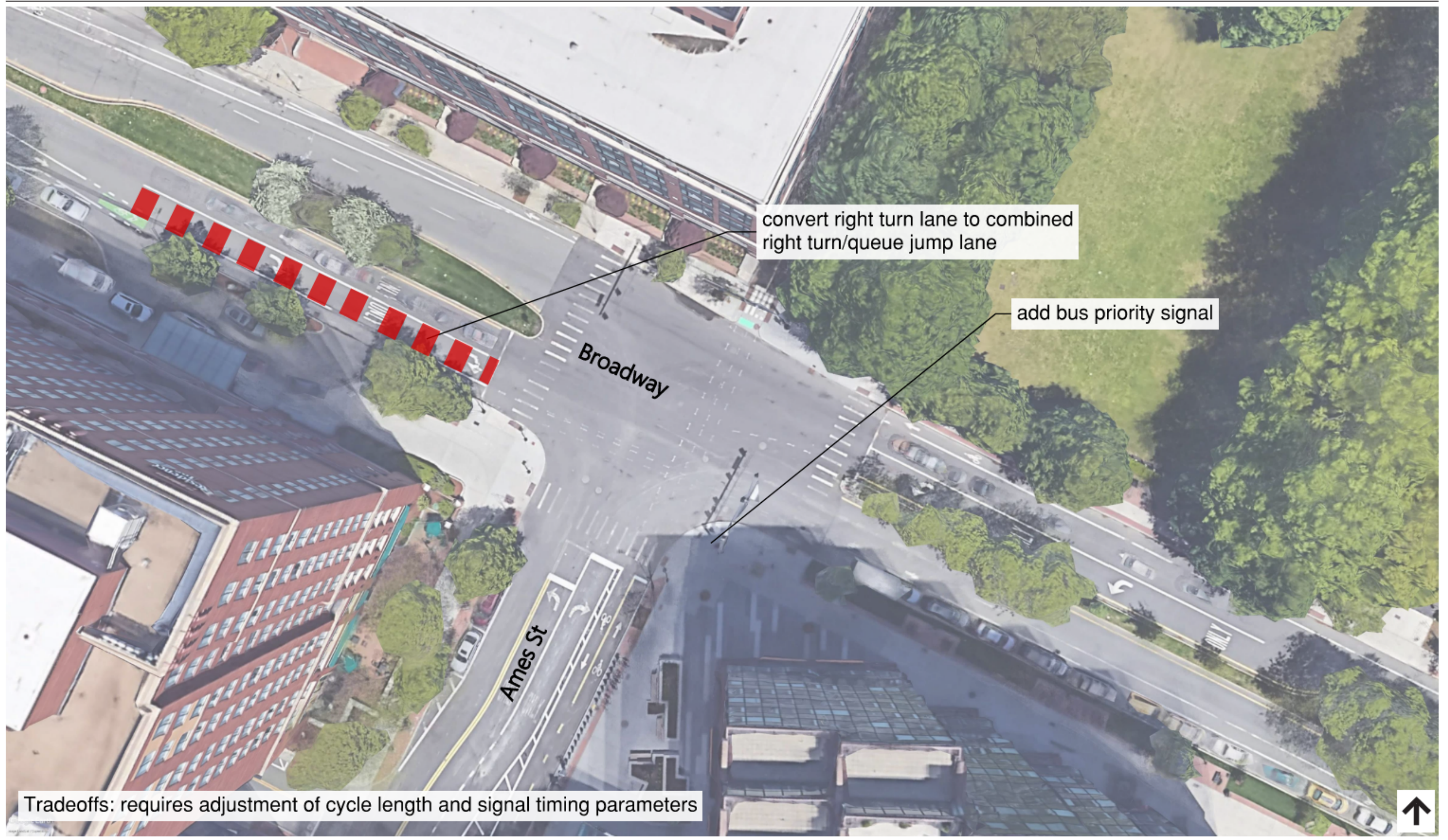

convert right turn lane to combined right turn/queue jump lane

add bus priority signal

Tradeoffs: requires adjustment of cycle length and signal timing parameters

Broadway @ Ames St



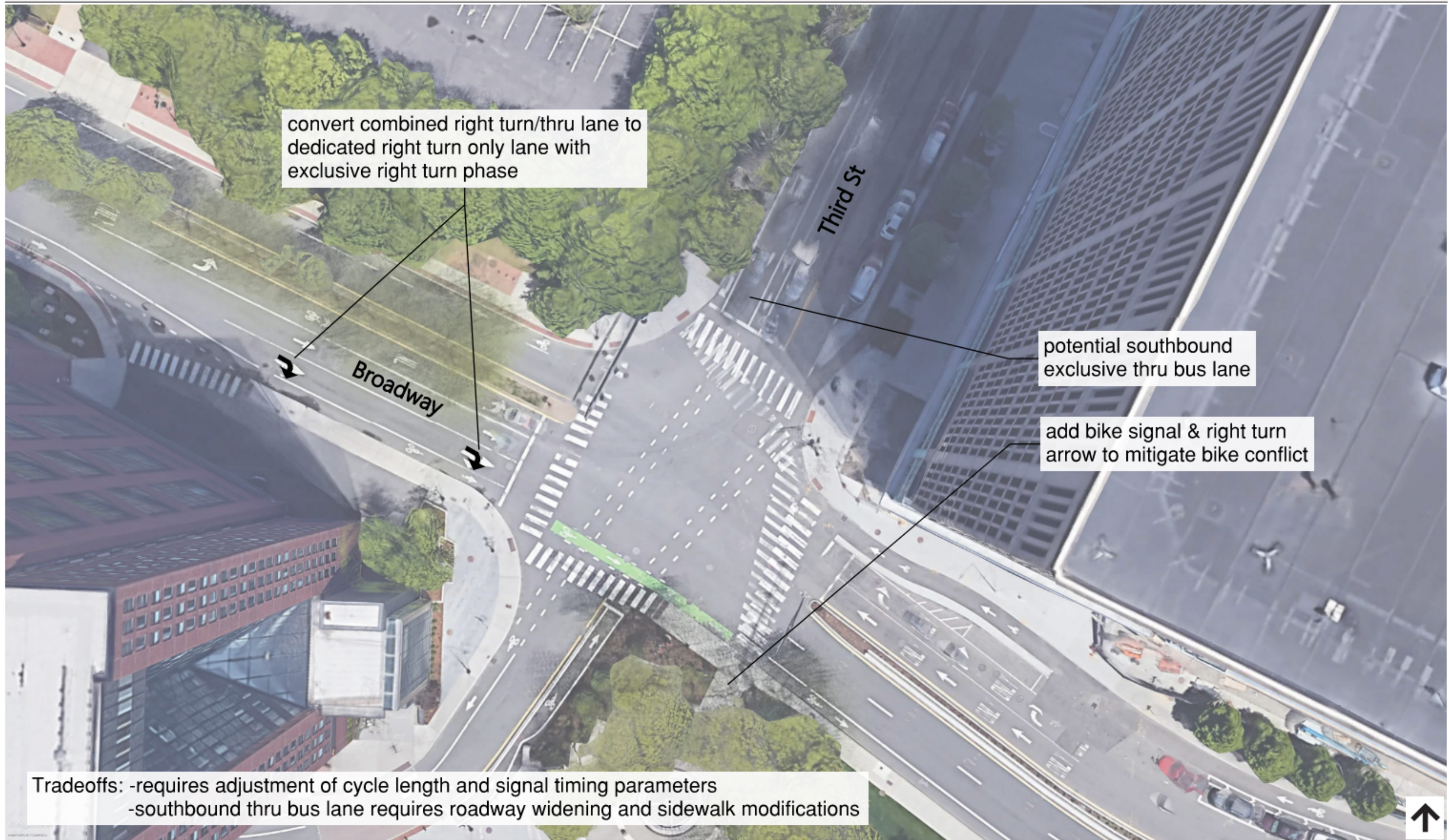

convert combined right turn/thru lane to dedicated right turn only lane with exclusive right turn phase

potential southbound exclusive thru bus lane

add bike signal & right turn arrow to mitigate bike conflict

Tradeoffs: -requires adjustment of cycle length and signal timing parameters
-southbound thru bus lane requires roadway widening and sidewalk modifications

Broadway @ Third St



COMMUNITY MEETING

When: April 28, 2021 @ 5:30 PM

Location: Zoom Webinar

Registration Link - <https://bit.ly/3fQ1njj>