



EF Education First

EF EDUCATION FIRST  
SP/PUD Application



**SPECIAL PERMIT APPLICATION  
APPENDIX**

08.16.2011













## 7.0 APPENDIX OF GRAPHIC MATERIALS

- 7.10 Locus Map
- 7.11 Intermediate Scale Map
  
- 7.20 Development Parcel
  
- 7.30 Existing Site Context and Land Use Plan
- 7.31 Site Photo Key
- 7.32 Existing Site Photos
- 7.33 Existing Site Photos
  
- 7.40 Proposed Site Context and Land Use Plan
- 7.41 Pedestrian and Bicycle Network Plan
- 7.42 Landscape Plan
- 7.43 Utility Site Plan
  
- 7.50 Building Area Summary
  
- 7.60 Ground Floor Plan
- 7.61 Typical Parking Level Floor Plan (Levels P1-P4)
- 7.62 Typical Office Level Floor Plan (Levels 4-10)
  
- 7.70 West Elevation
- 7.71 South Elevation
- 7.72 East Elevation
- 7.73 North Elevation
- 7.74 Building Section A
- 7.75 Building Section B
- 7.76 Building Section C
- 7.77 Building Section D
  
- 7.80 Rendered View From Charles River
- 7.81 Rendered View From North Point Boulevard
- 7.82 Rendered View From Education Street
- 7.83 Rendered View From Highway Ramp



# East Cambridge

Cambridge, Massachusetts

-  City Boundary
-  MBTA Subway Station
-  Neighborhood Boundaries
-  City Park or Playground
-  DCR-Owned Park
-  DCR-Owned Parkway
-  Public Plaza
-  Privately-Owned, Publicly-Accessible Park
-  Privately-Owned, Publicly-Accessible Plaza
-  Public Rooftop Garden
-  Public School Grounds
-  Park Under Development

Publicly-Accessible Park

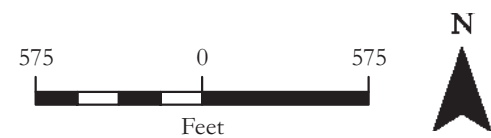

Planimetric information displayed on this map was prepared through the use of photogrammetric methods from aerial photographs taken April 17, 2003. Certain features have been updated through other methods. This map is intended for planning purposes only.

Cambridge Community Development Department  
Cambridge GIS

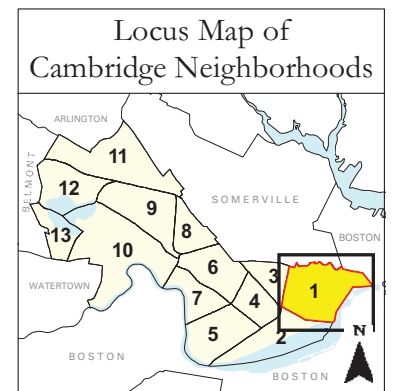
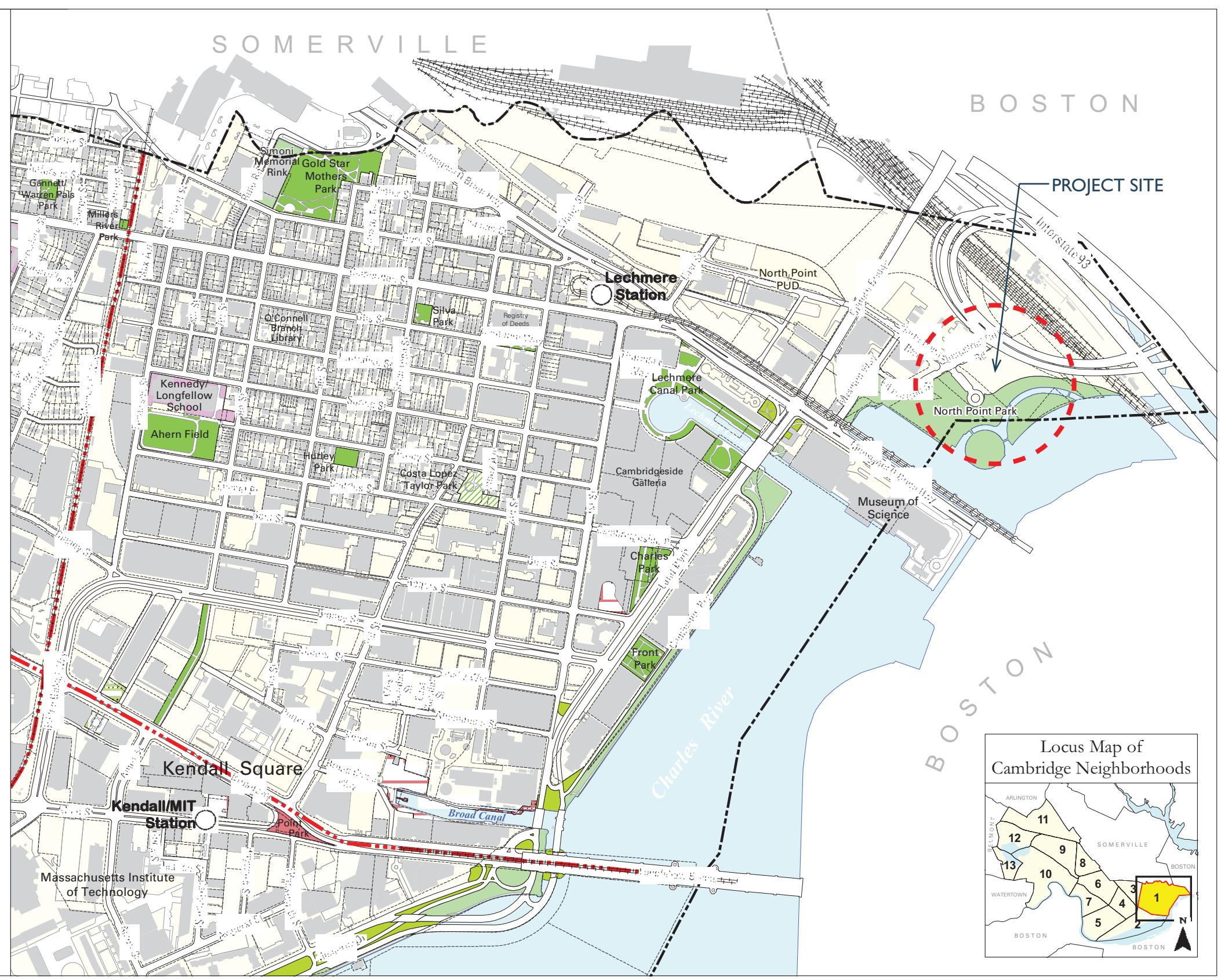



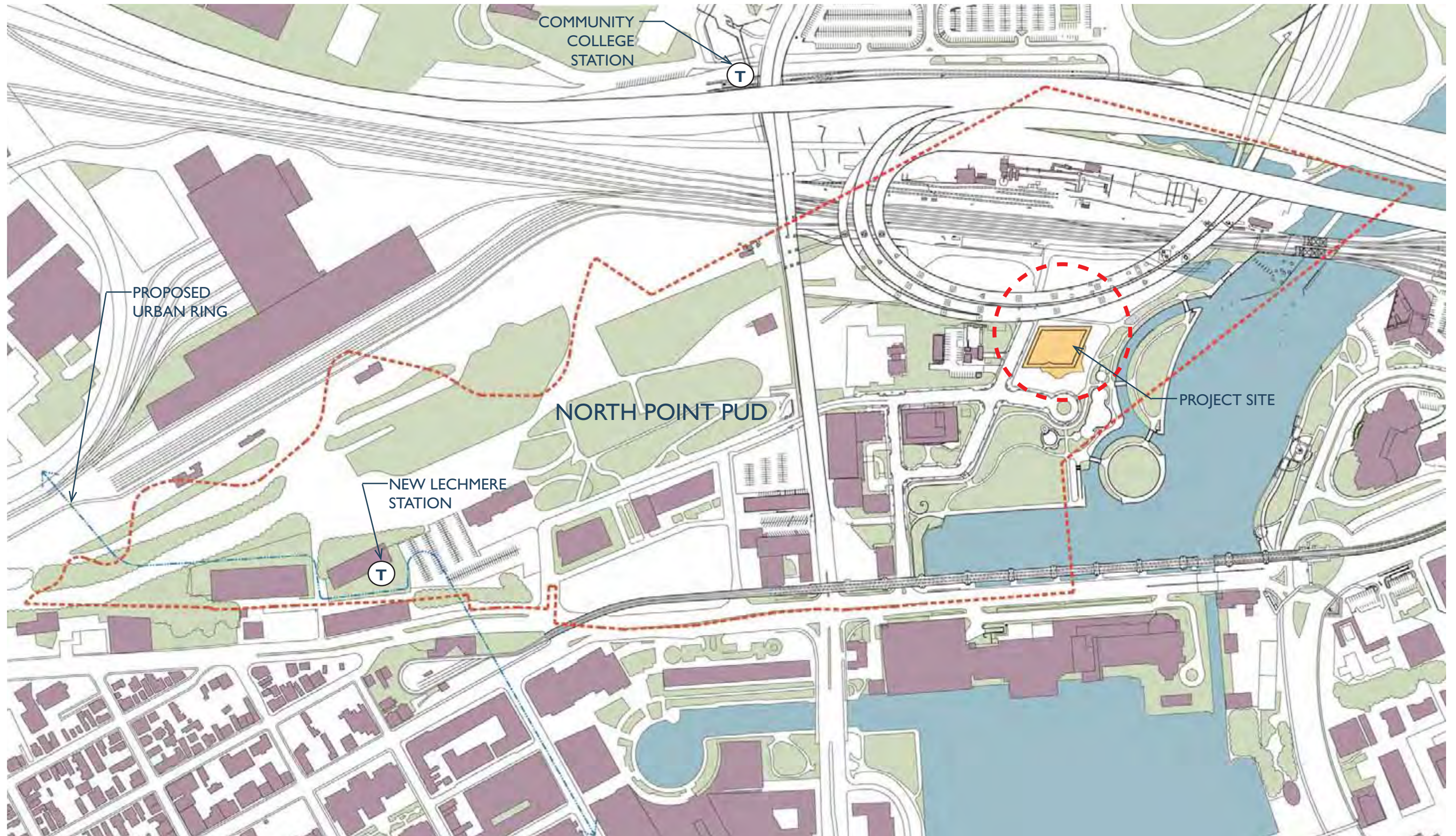











7.31 Site Photo Key





7.32 Existing Site Photos



A



B



C



D



E



F



G



7.33 Existing Site Photos



H



I



J



K



L



M







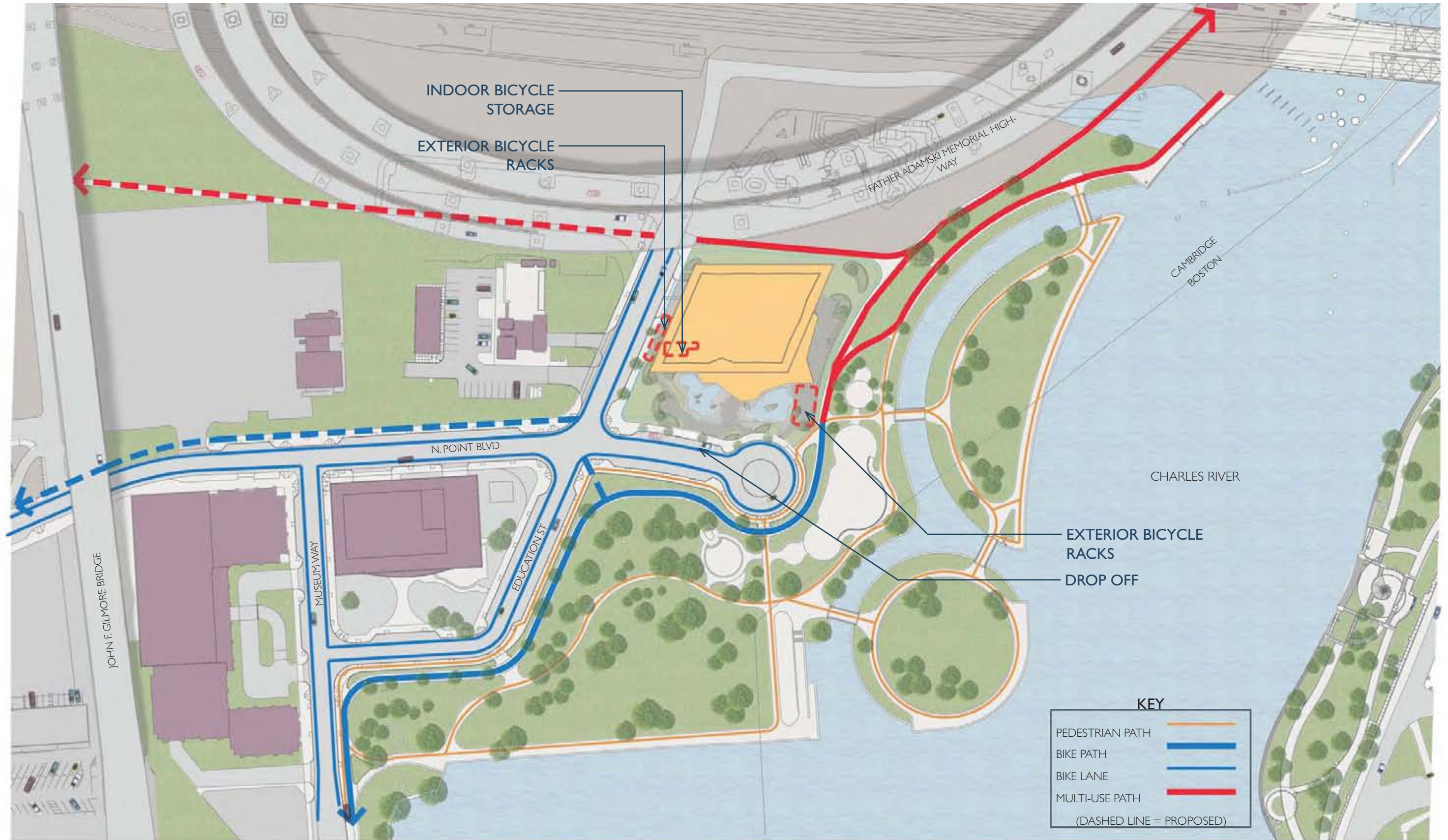



# EF NORTH POINT

Cambridge, Massachusetts

## Landscape Plan

Scale: 1" = 30'

Date: August 10, 2011



NOTE:  
Ponds 'A' and 'B' to be gunite shell with riverstone finishes.





\\MABOS\PROJECTS\11489.00\CAD\LD\PLANSET\SD\11489.UIT

Saved: Monday, July 25, 2011 11:37:49 AM MACJESON Plotted: Monday, July 25, 2011 11:45:56 AM Jackson, Mark

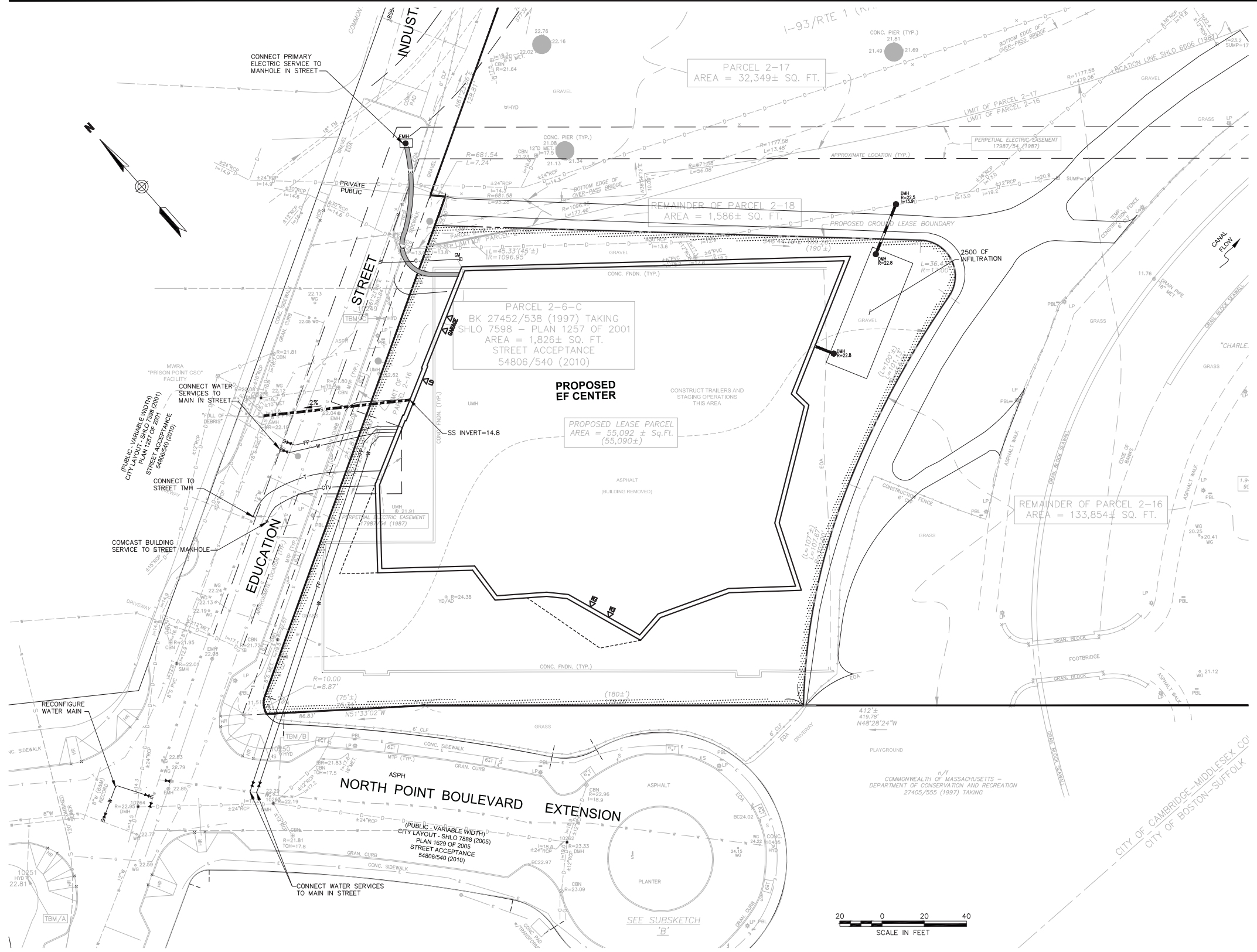

**Vannose Hangen Brustin, Inc.**  
 Transportation  
 Land Development  
 Environmental Services  
 99 High Street  
 Boston, Massachusetts 02110  
 617.728.7777 • FAX 617.728.7782

No.	Revision	Date	Appr.

Designed by	Drawn by	Checked by
CAD checked by	Approved by	
Scale 1"=20'	Date July 14, 2011	

Project Title  
**EF Center**

Education Way  
 Cambridge, Massachusetts

Not Approved for Construction  
 Drawing Title  
**Utility Plan**

Drawing Number  
**C-4**  
 Sheet of  
 Project Number  
 11489.00

11489.UIT.DWG



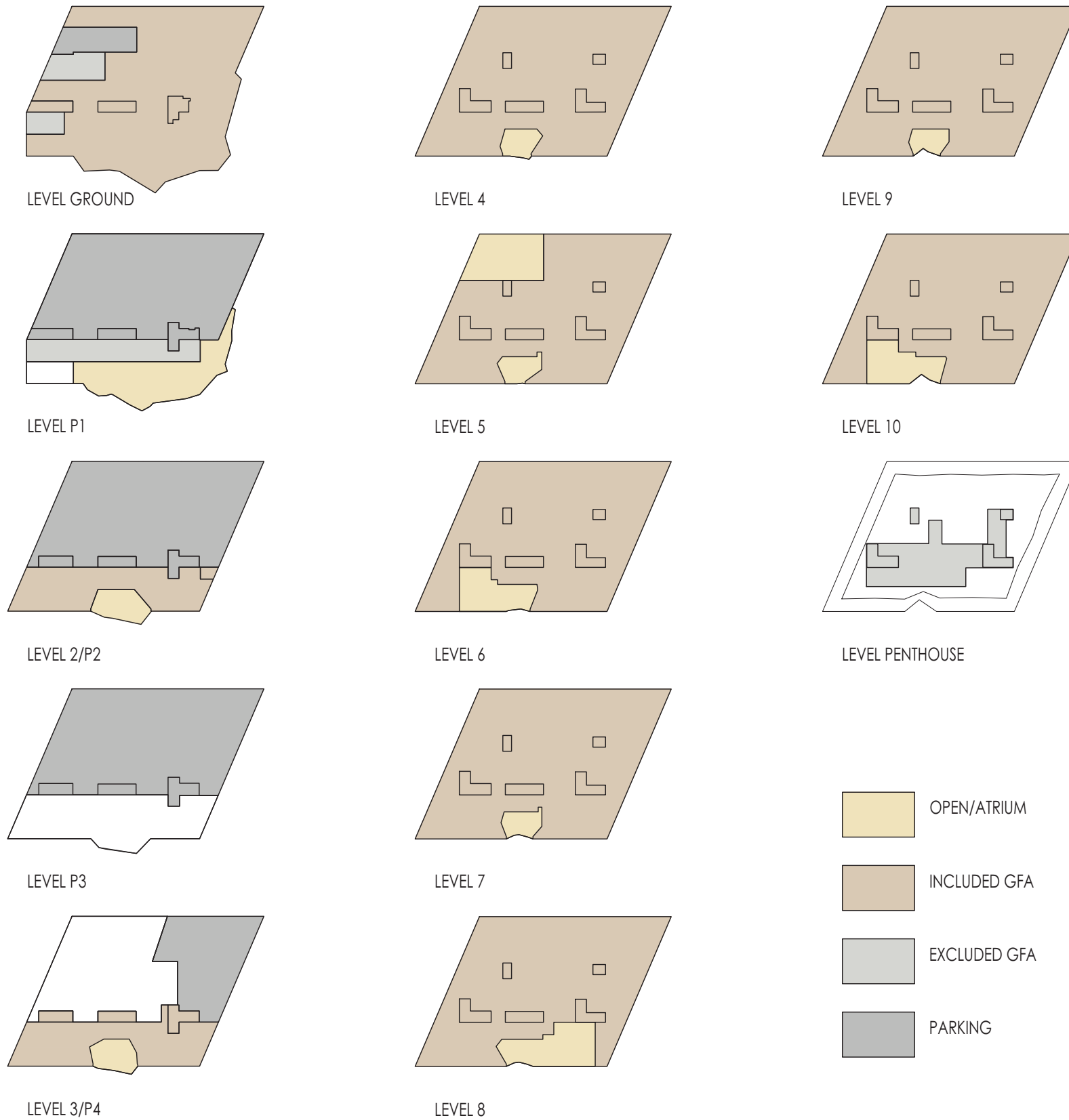

Building Area Summary (SF)

Level	Office	Parking	Total
Roof	0	0	0
10	25,000		25,000
9	26,500		26,500
8	25,000		25,000
7	26,500		26,500
6	25,500		25,500
5	24,500		24,500
4	26,500		26,500
P4	8,000	7,500	15,500
3/P3	500	18,500	19,000
2/P2	8,000	18,500	26,500
P1	6,000	18,500	24,500
G	28,000	2,000	30,000
<b>Totals</b>	<b>230,000</b>	<b>65,000</b>	<b>295,000</b>

SF indicated are approximate. Total will not exceed 295,000 SF

Office total includes proposed Restaurant function





BIKE RACK TYPES AND LAYOUT DIMENSIONS TO COMPLY WITH ARTICLE 6.37 AND 6.49



7.61 Typical Parking Level Floor Plan (Levels P1-P4)

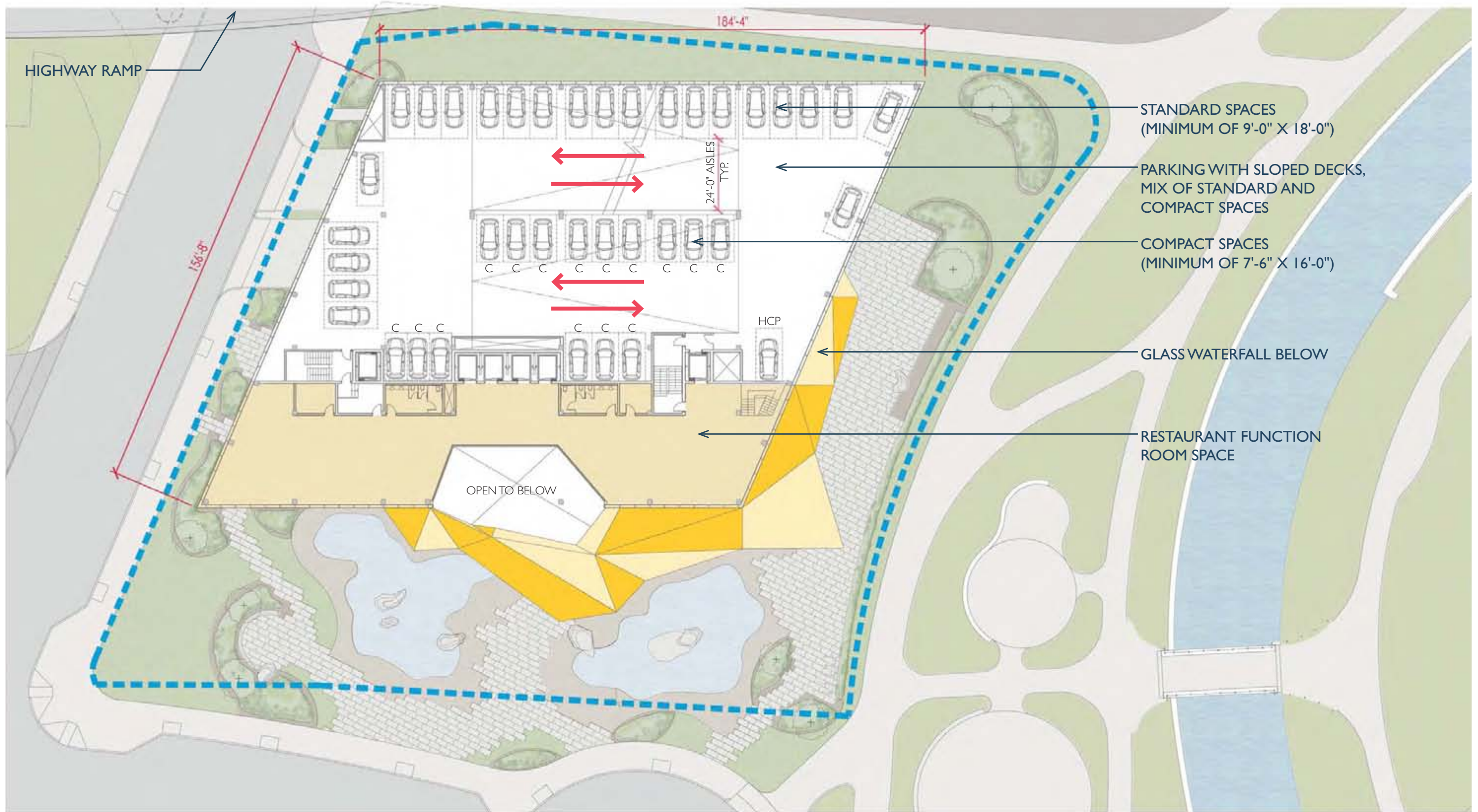



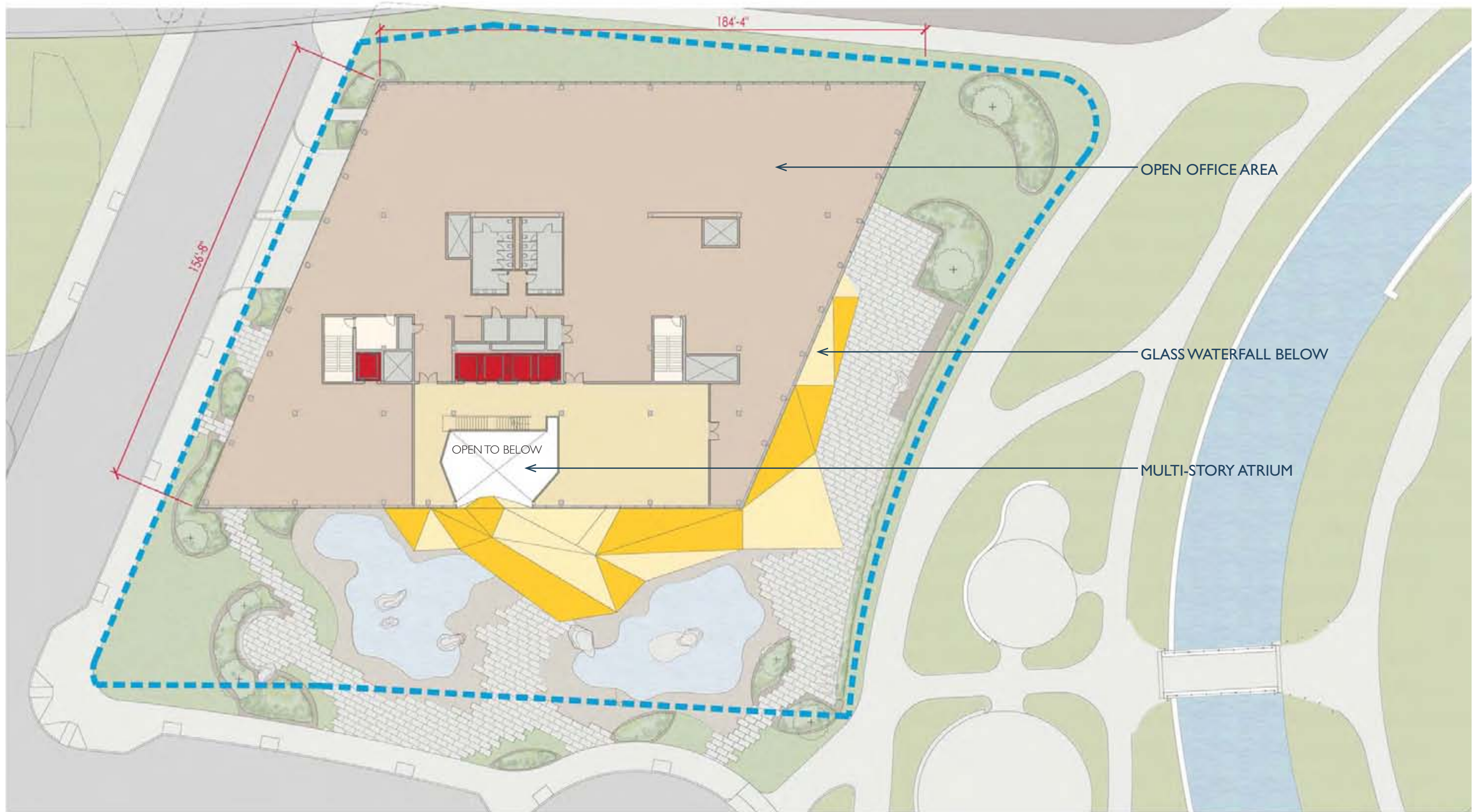



7.70 West Elevation

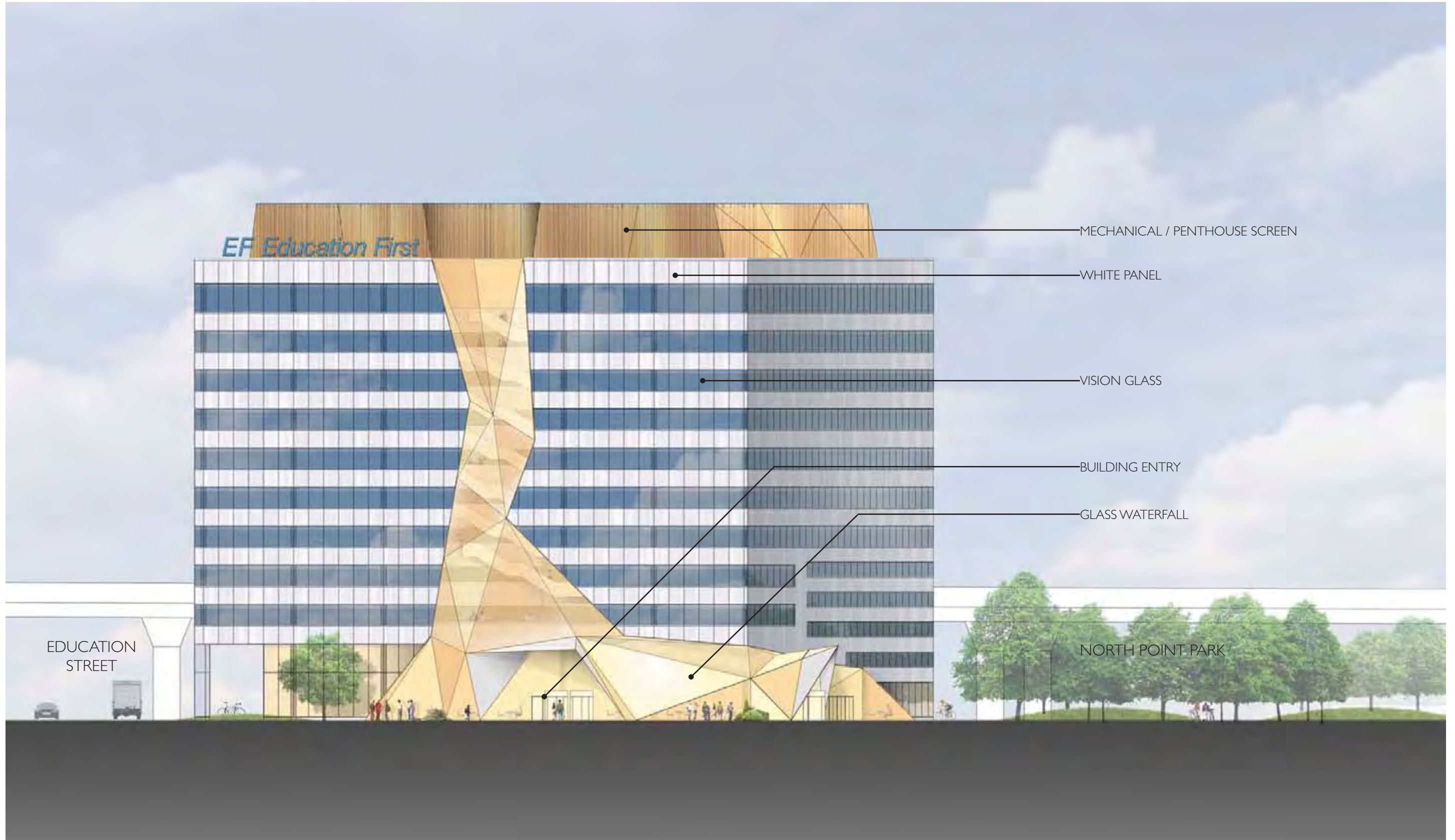









MECHANICAL / PENTHOUSE SCREEN

WHITE PANEL

VISION GLASS

DOUBLE HEIGHT GLAZING AT  
AUDITORIUM

LOUVERS WITH INTEGRATED DOORS,  
FOR TRANSFORMER AND  
SWITCHGEAR ROOMS

NORTH POINT PARK

EDUCATION STREET



7.73 North Elevation





