

\*Updated to show current Landscape design.

Source: FXFWLE  
**Vanasse Hangen Brustlin, Inc.**

Figure 14  
Pedestrian Circulation

Ames Street Residences  
Cambridge, MA

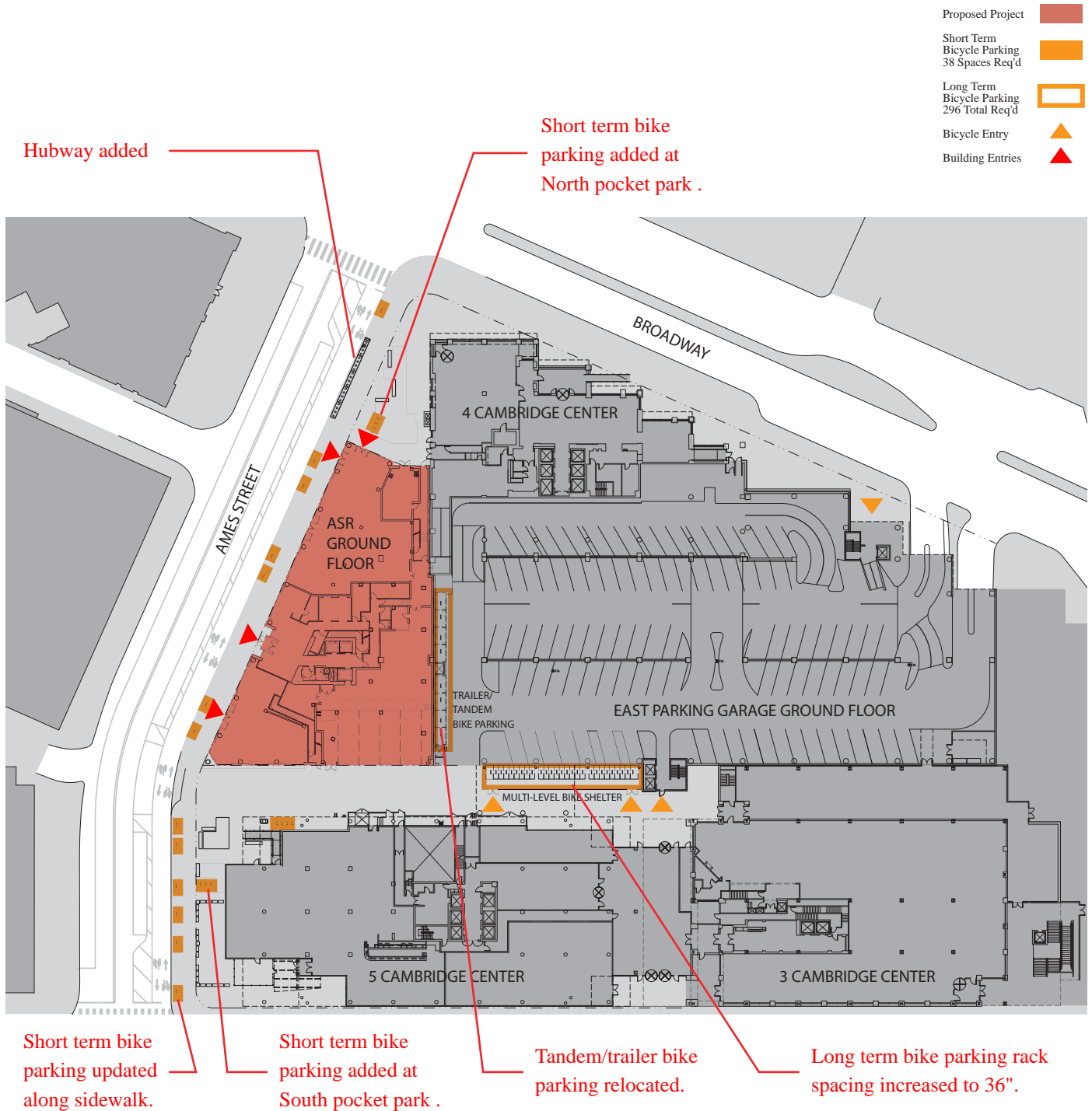

Source: FXFOWLE

**Vanasse Hangen Brustlin, Inc.**

Proposed Bicycle Parking Layout  
(Garage Ground Floor)

Figure 15a

Ames Street Residences  
Cambridge, MA

- Proposed Project ■
- Short Term Bicycle Parking 38 Spaces Req'd ■
- Long Term Bicycle Parking 296 Total Req'd
- Bicycle Entry ▲
- Building Entries ▲



Long term bike parking rack spacing increased to 36".

Source: FXFOWLE

Vanasse Hangen Brustlin, Inc.

Proposed Bicycle Parking Layout  
(Garage 2nd Floor)

Figure 15b

Ames Street Residences  
Cambridge, MA

- Proposed Project ■
- Short Term Bicycle Parking 38 Spaces Req'd ■
- Long Term Bicycle Parking 296 Total Req'd
- Bicycle Entry ▲
- Building Entries ▲



Third floor added to multi-level bike shelter.

Long term bike parking rack spacing increased to 36".

Source: FXFOWLE

**Vanasse Hangen Brustlin, Inc.**

Proposed Bicycle Parking Layout  
(Garage 3rd Floor)

Figure 15c

Ames Street Residences  
Cambridge, MA

- Proposed Project ■
- Short Term Bicycle Parking 38 Spaces Req'd ■
- Long Term Bicycle Parking 296 Total Req'd
- Bicycle Entry ▲
- Building Entries ▲



Source: FXFOWLE

**Vanasse Hangen Brustlin, Inc.**

Proposed Bicycle Parking Layout  
(Garage 5th Floor)

Figure 15d

Ames Street Residences  
Cambridge, MA

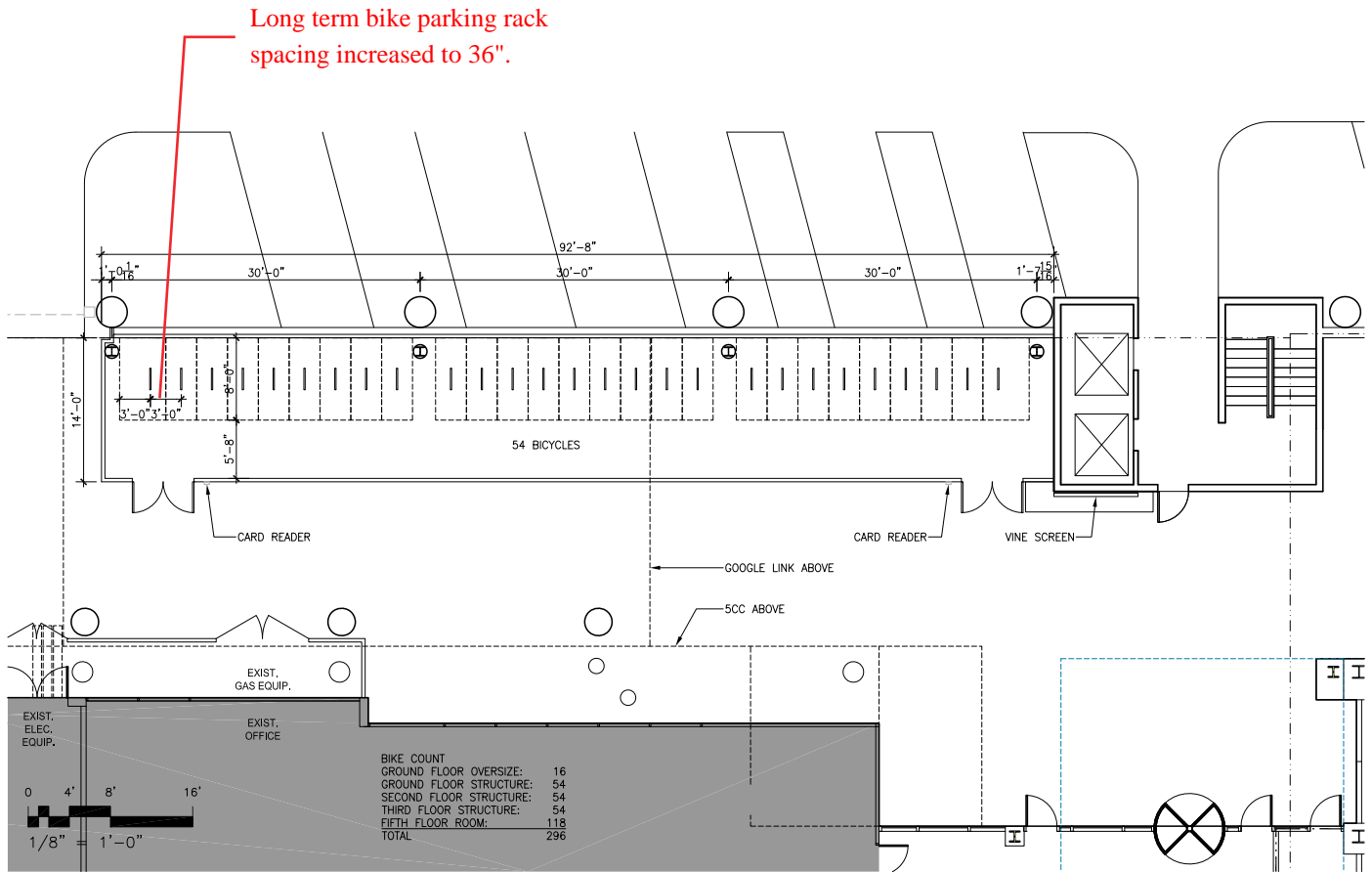

Source: FXFOWLE

**Vanasse Hangen Brustlin, Inc.**

Garage Bicycle Parking Structure  
(Ground Floor)

Figure 16a

Ames Street Residences  
Cambridge, MA

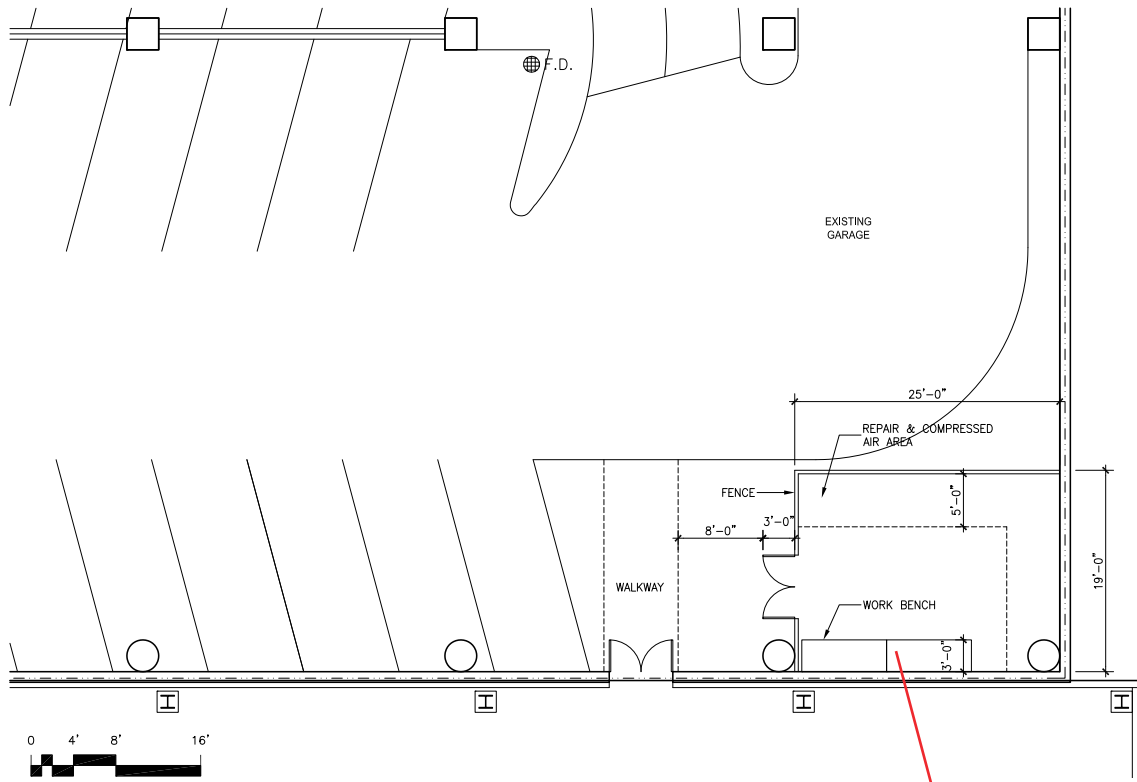

Bike repair area redesigned.

\*Tandem/trailer bike parking relocated.

Source: FXFOWLE

Vanasse Hangen Brustlin, Inc.

Garage Bicycle Parking Structure  
(Ground Floor)  
Repair Area

Figure 16b

Ames Street Residences  
Cambridge, MA

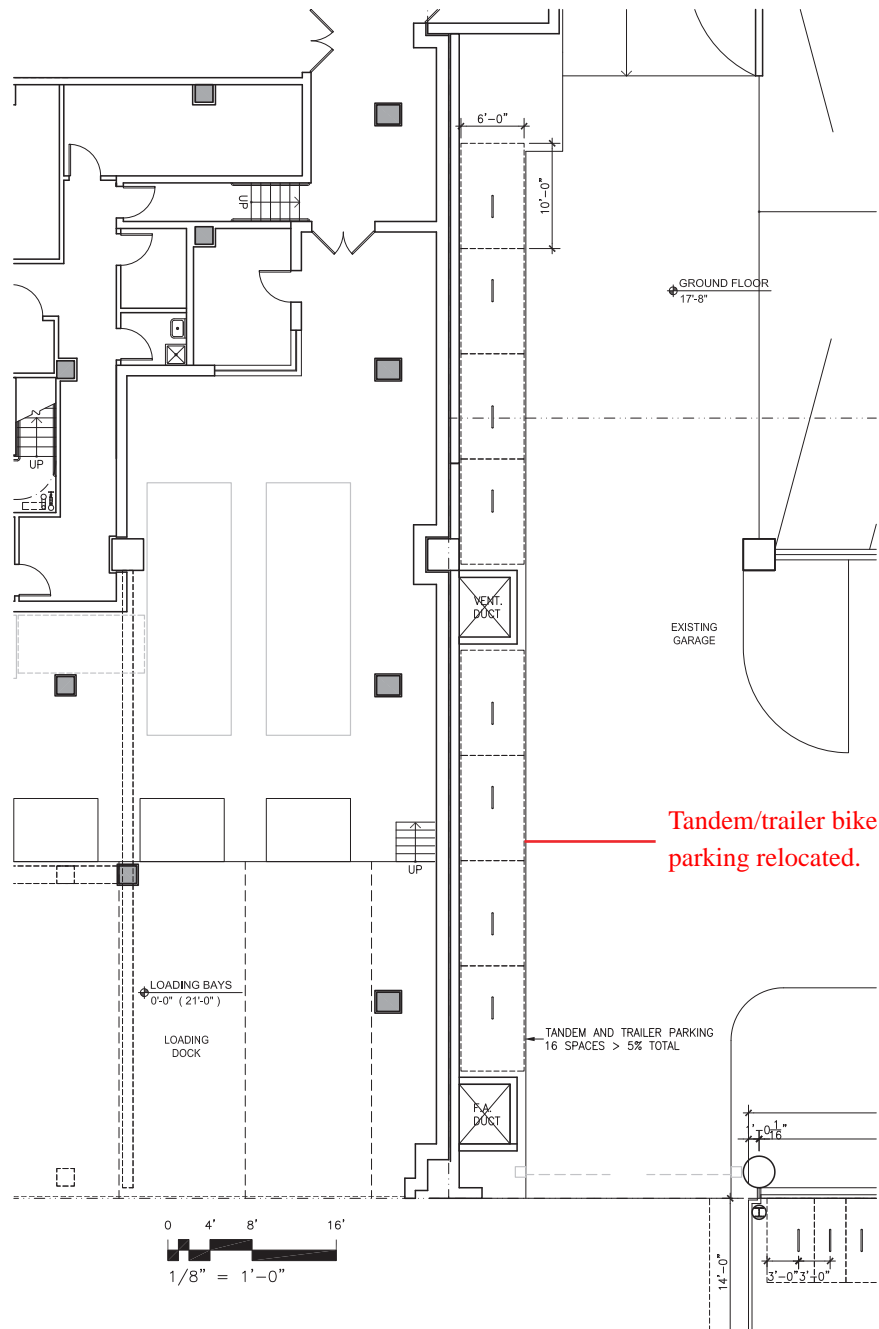

Source: FXFWLE

Vanasse Hangen Brustlin, Inc.

Garage Bicycle Parking Structure  
(Ground Floor)  
Tandem and Trailer Area

Figure 16c

Ames Street Residences  
Cambridge, MA



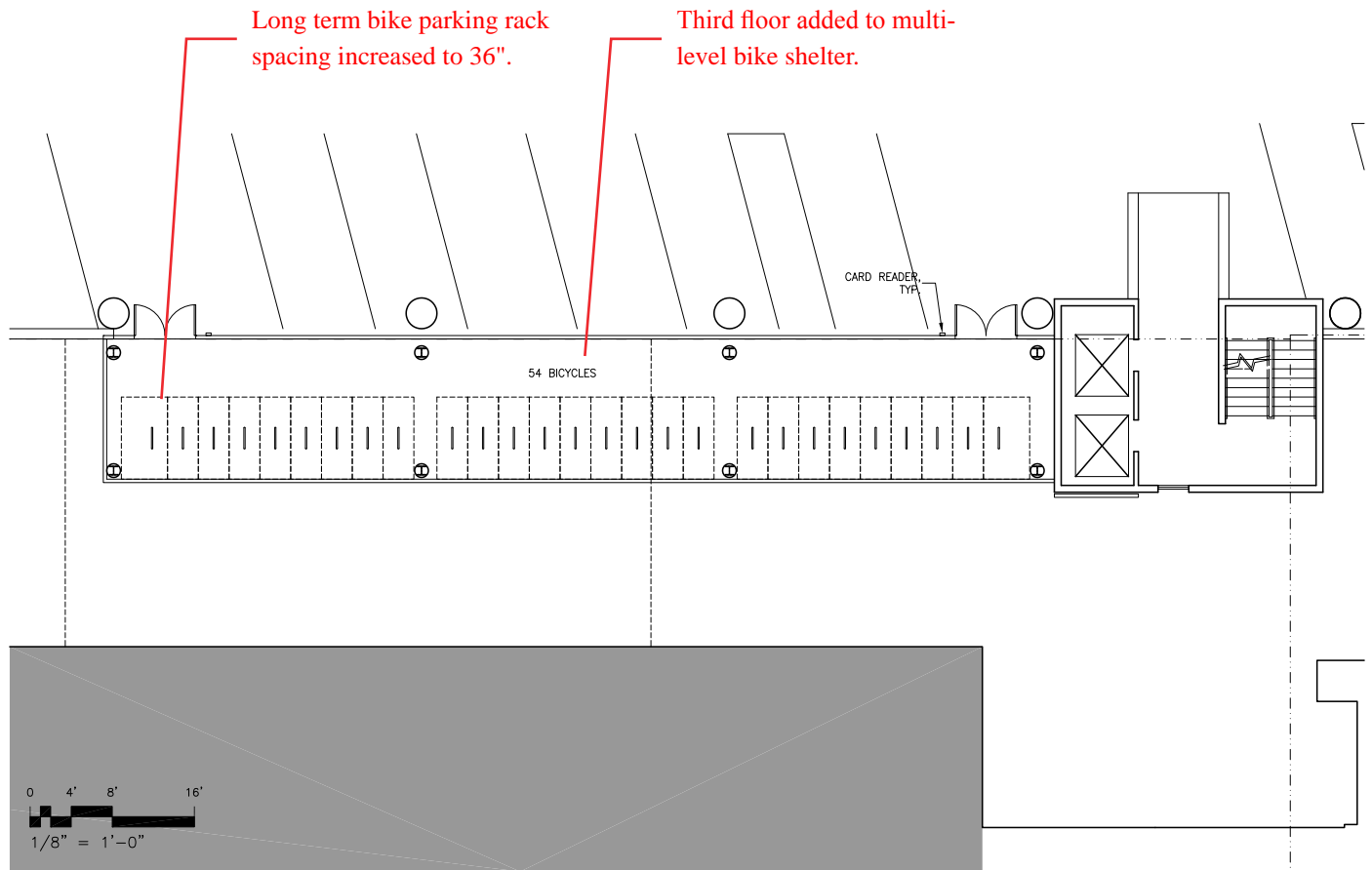

Source: FXFOWLE

**Vanasse Hangen Brustlin, Inc.**

Garage Bicycle Parking Structure  
(2nd & 3rd Floor)

Figure 16d

Ames Street Residences  
Cambridge, MA

Fifth floor long term bike parking room updated.

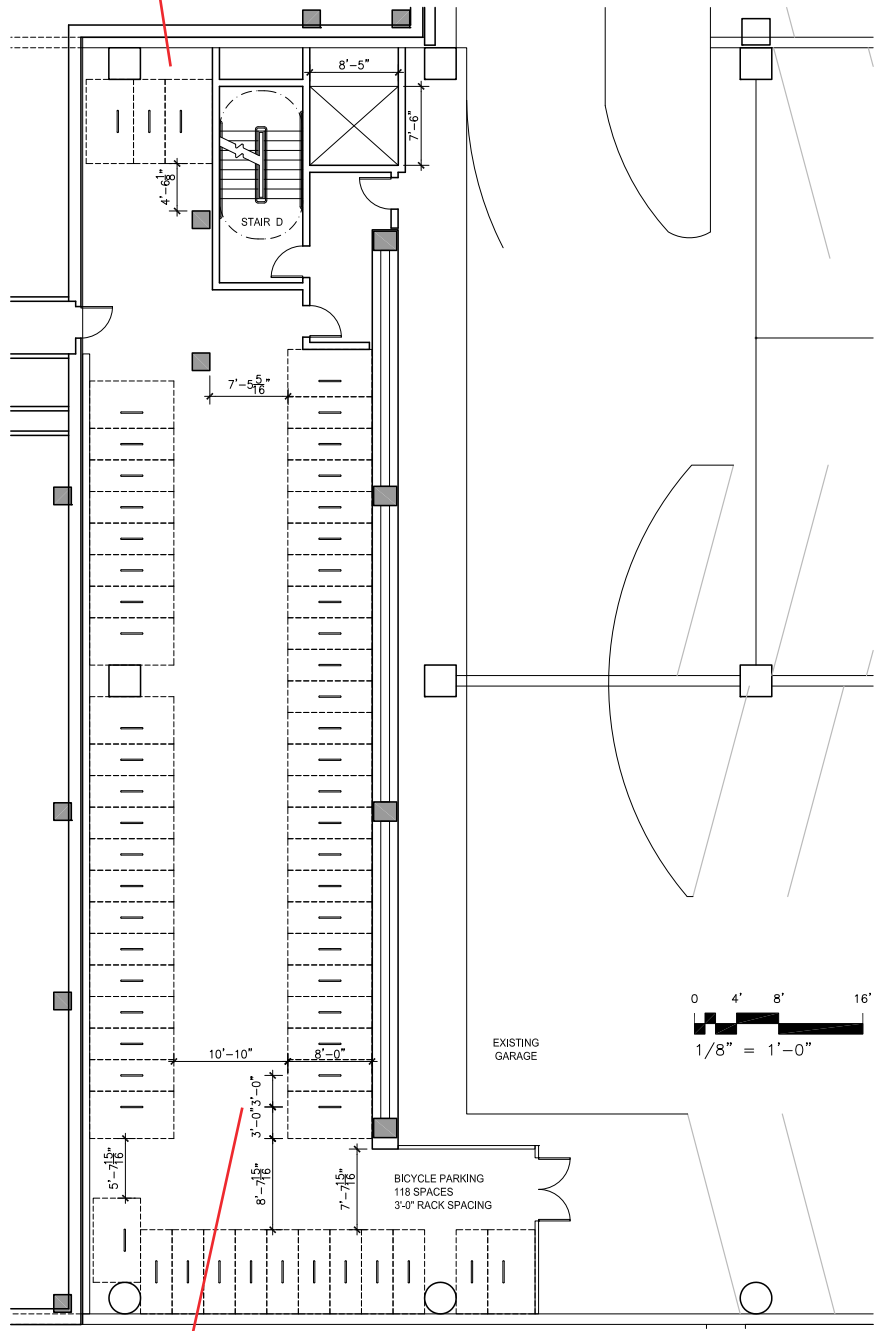

Long term bike parking rack spacing increased to 36".

Source: FXFOWLE

**Vanasse Hangen Brustlin, Inc.**

Garage Bicycle Parking Structure  
(5th Floor)

Figure 16e

Ames Street Residences  
Cambridge, MA

Third floor added to multi-level bike shelter.

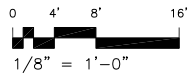
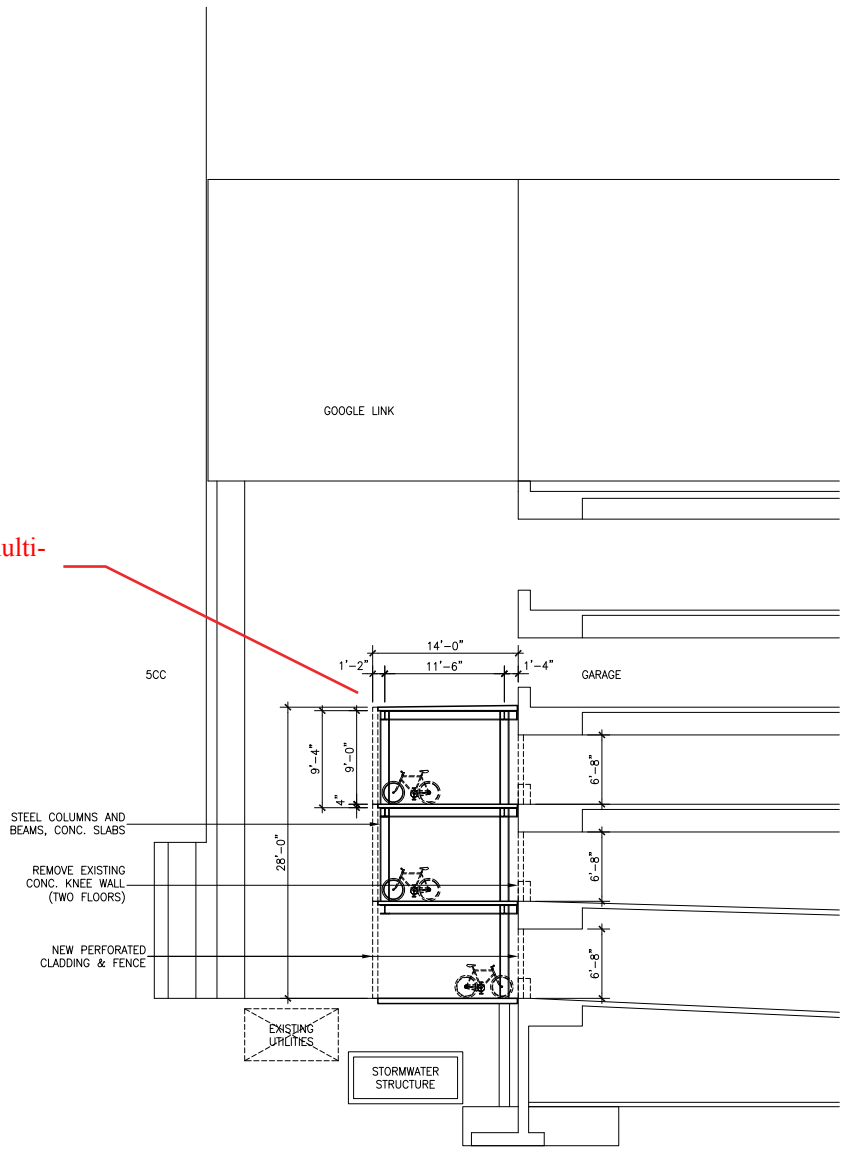

Source: FXFWLE

**Vanasse Hangen Brustlin, Inc.**

Garage Bicycle Parking Structure - Section

Figure 16f

Ames Street Residences  
Cambridge, MA

- Proposed Project 
- Parking Access 
- Parking Egress 

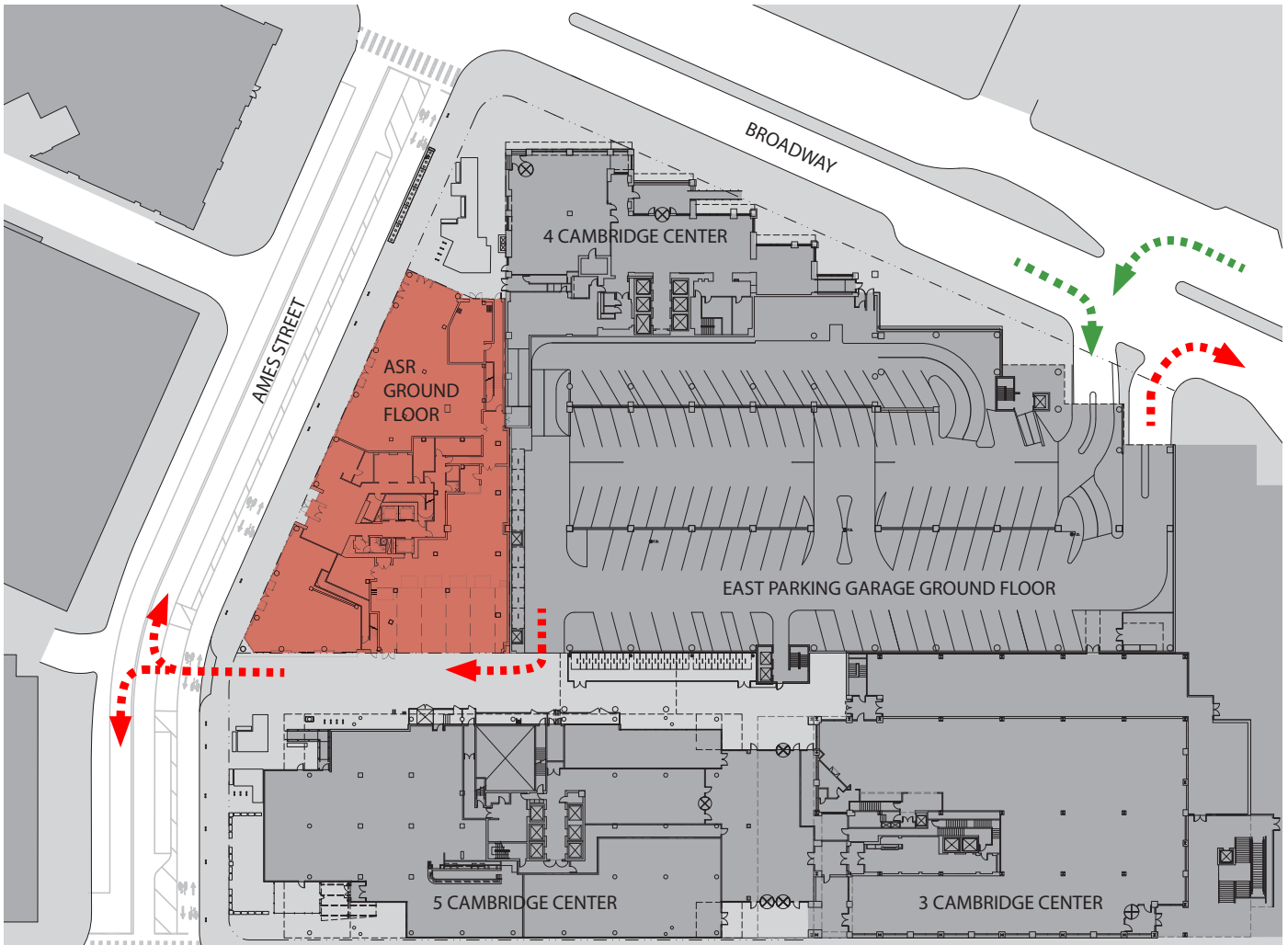

\*Updated to show current  
Landscape design.

Source: FXFWLE

**Vanasse Hangen Brustlin, Inc.**

Proposed Vehicular Parking Access/Egress

Figure 17

Ames Street Residences  
Cambridge, MA

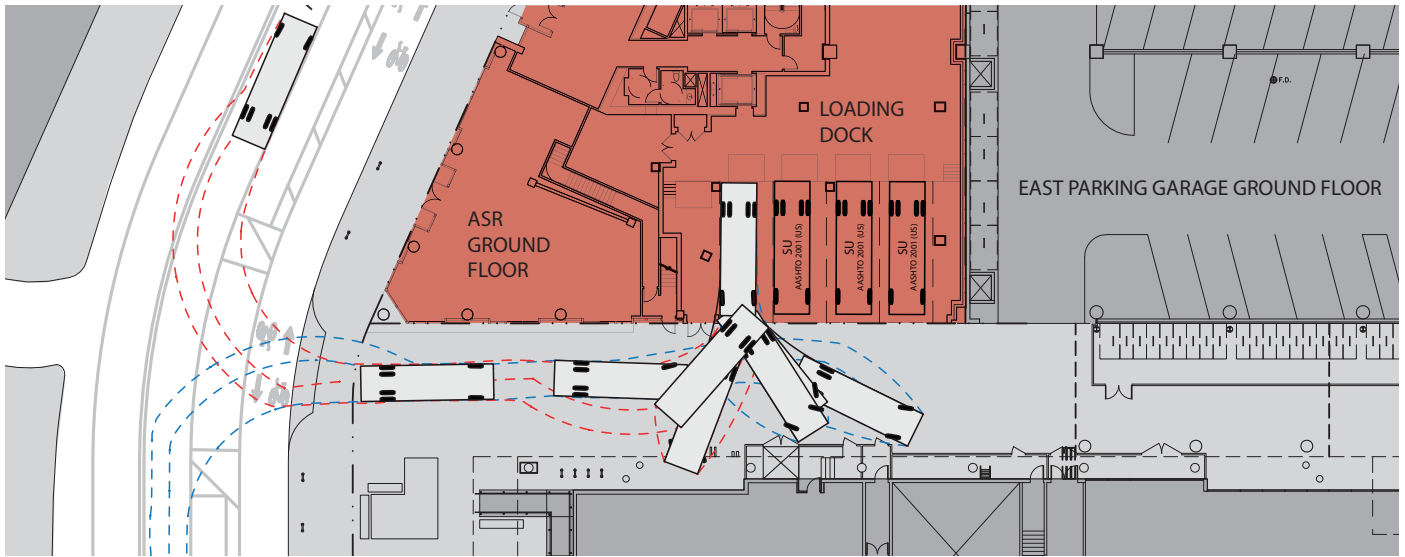

LOADING BAY 1

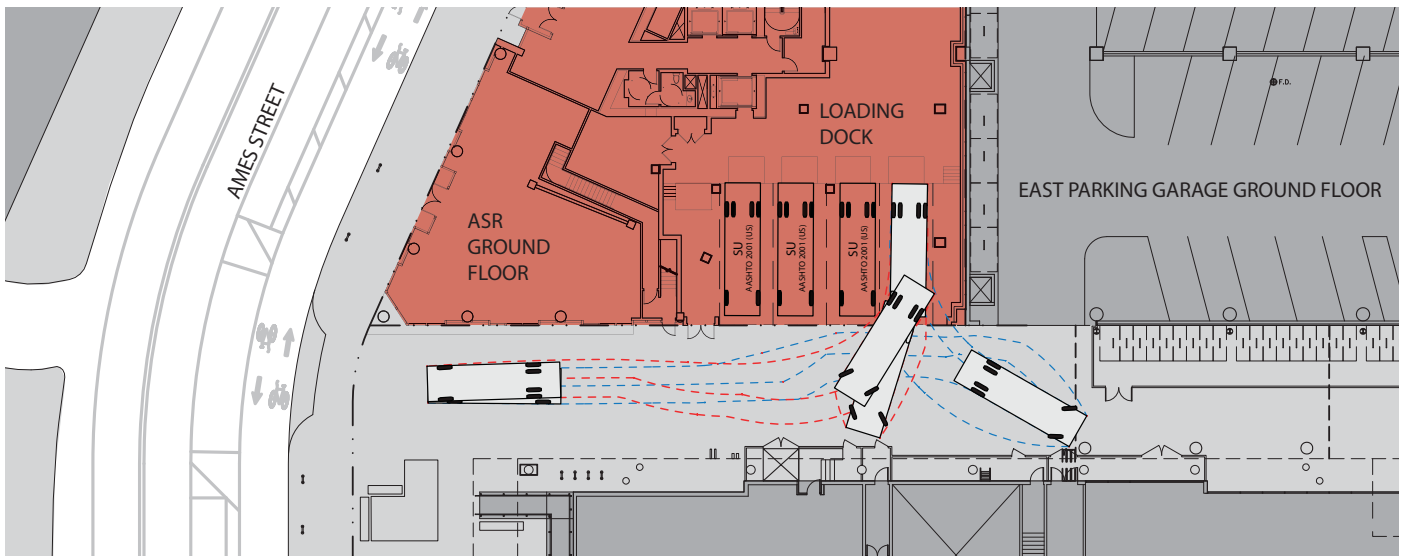

LOADING BAY 4

\*Updated to show current  
Landscape design & truck-  
turning updates.

Source: FXFOWLE / VHB

Vanasse Hangen Brustlin, Inc.

Truck Turning Movements

Figure 18

Ames Street Residences  
Cambridge, MA

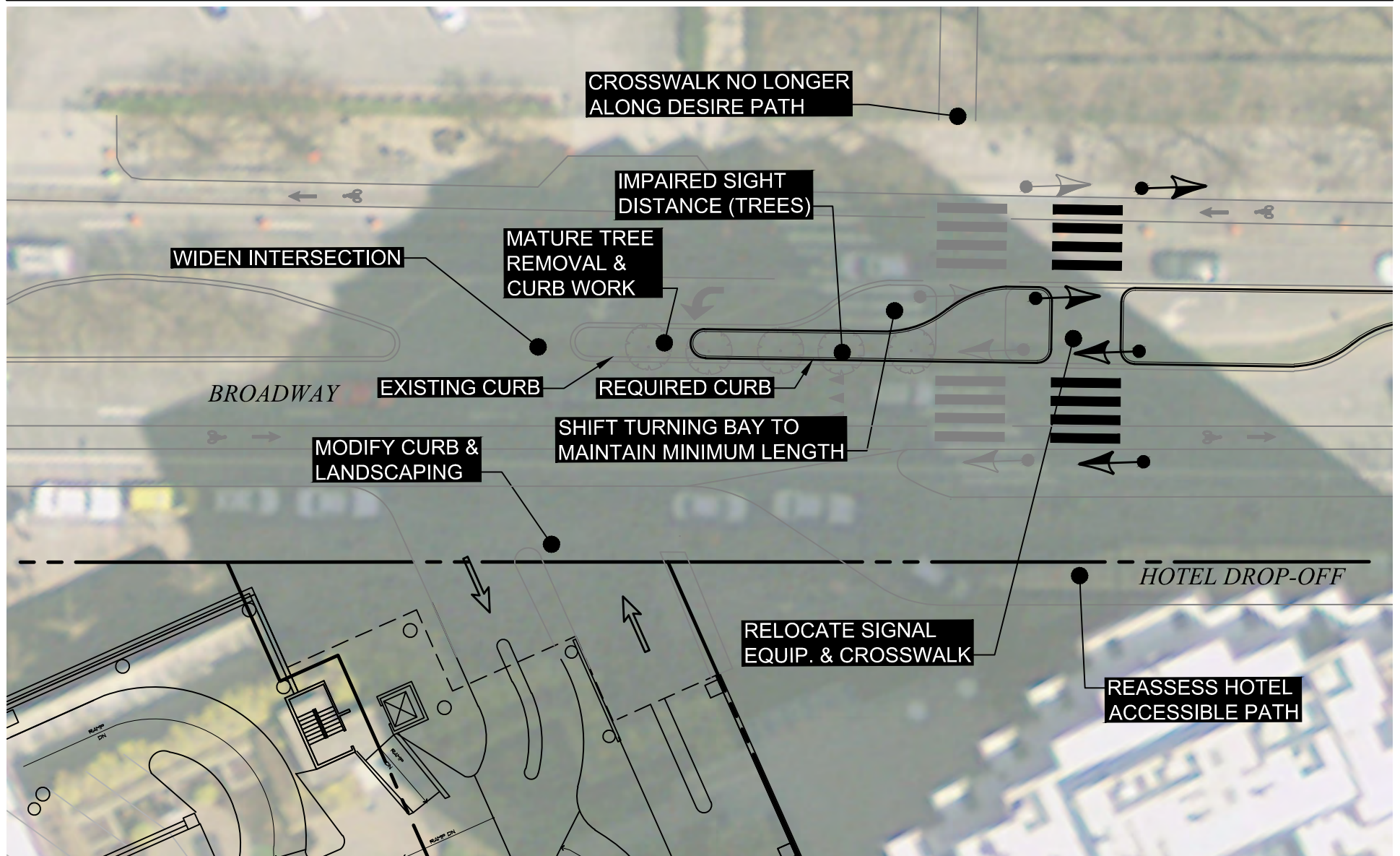

**Vanasse Hangen Brustlin, Inc.**

Figure 19 January 2015

East Garage Egress  
Left-Turn Modification Challenges  
Ames Street Residences  
Cambridge, MA

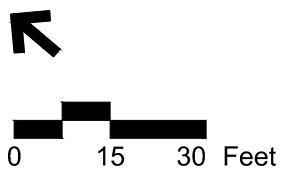



↑  
Not to Scale

Vanasse Hangen Brustlin, Inc.

2014 Build Condition  
Traffic Volumes  
Pioneer Way Closed to Exiting Vehicles  
AM Peak Hour (8:15 - 9:15 AM)  
Ames Street Residences  
Kendall Square, Cambridge MA

Figure 20



↑  
Not to Scale

Project Generated Trips  
Traffic Volumes  
Pioneer Way Closed to Exiting Vehicles  
AM Peak Hour (8:15 - 9:15 AM)  
Ames Street Residences  
Kendall Square, Cambridge MA

Figure 21



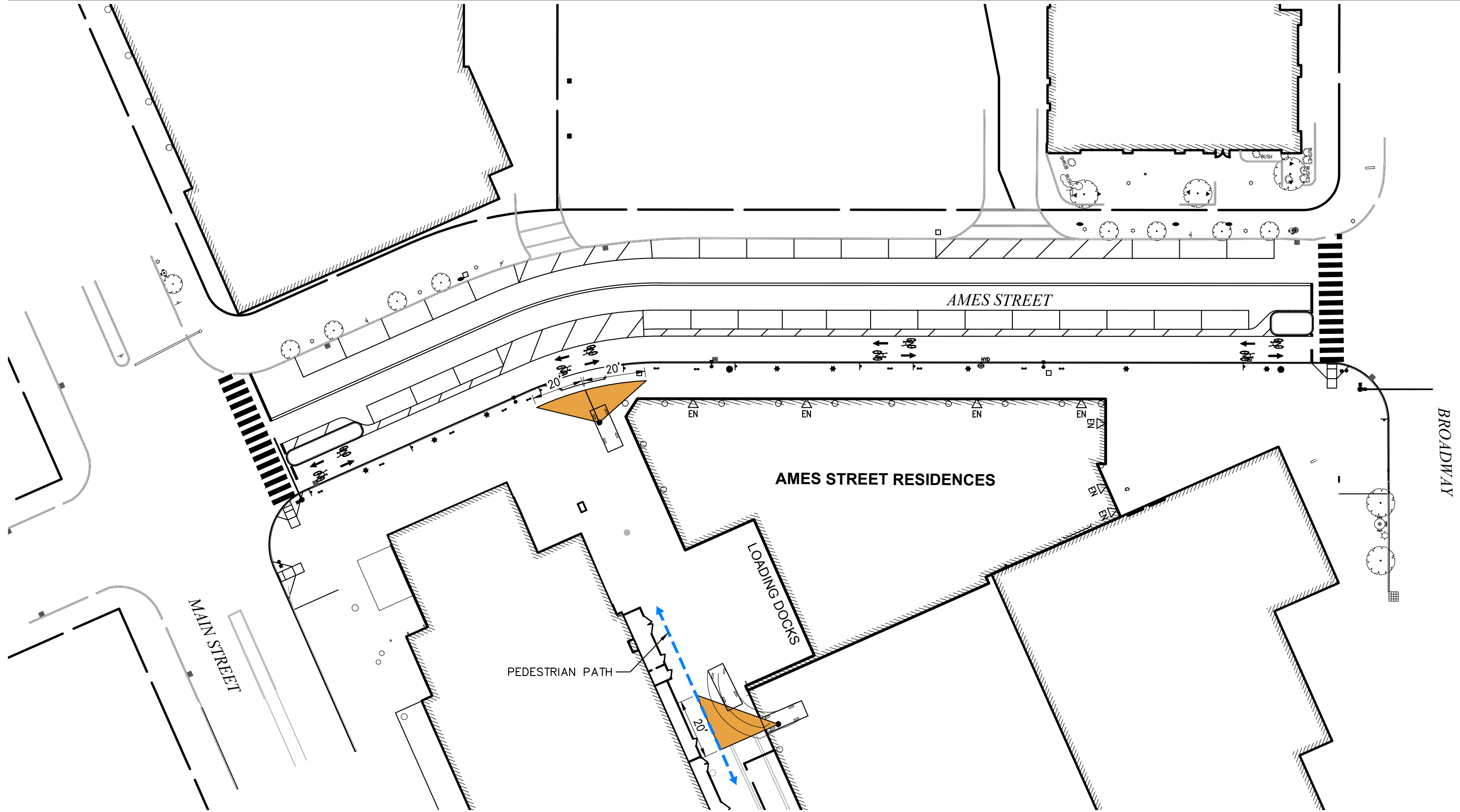

NOTES:

1. SIGHT LINES BASED ON PEDESTRIAN 20 FEET FROM EDGE OF DRIVEWAY.
2. FRONT OF THE VEHICLE IS ON BACK OF SIDEWALK AND DRIVER' EYE IS ASSUMED TO BE SIX FEET BEHIND FRONT OF VEHICLE.

**Vanasse Hangen Brustlin, Inc.**

Figure 22

January 2015

Pedestrian Sight Lines

Ames Street Residences  
Cambridge, MA

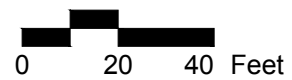



Source: FXFOWLE

**Vanasse Hangen Brustlin, Inc.**

**Figure 23**

Vehicular Sightline at Pioneer Way Exit

Ames Street Residences  
Cambridge, MA

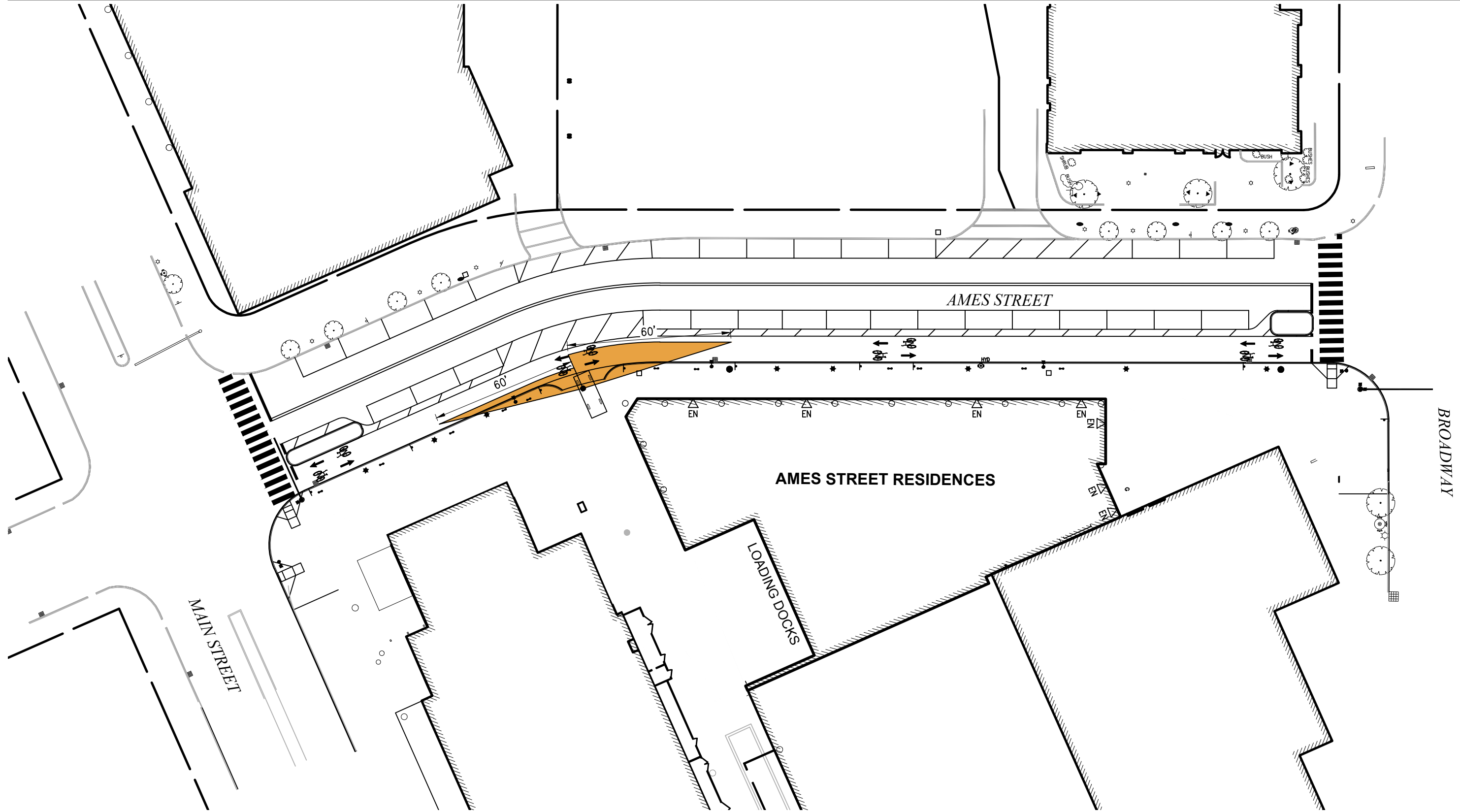

NOTES:

1. ACCORDING TO MASSACHUSETTS LAW, A BICYCLE TRAVELING 15 MILES PER HOUR SHALL BE ABLE TO STOP WITHIN 30 FEET.
2. FOR A MORE CONSERVATIVE ANALYSIS, THAT ACCOUNTS FOR VARIABILITY IN CONDITIONS AND REACTION, A SIGHT DISTANCE OF 60 FEET WAS USED.
3. FRONT OF THE VEHICLE IS ON THE CURBLINE AND DRIVER' EYE IS ASSUMED TO BE SIX FEET BEHIND FRONT OF VEHICLE.



0 20 40 Feet

Vanasse Hangen Brustlin, Inc.

Figure 24

January 2015

Bicycle Sight Lines

Ames Street Residences  
Cambridge, MA

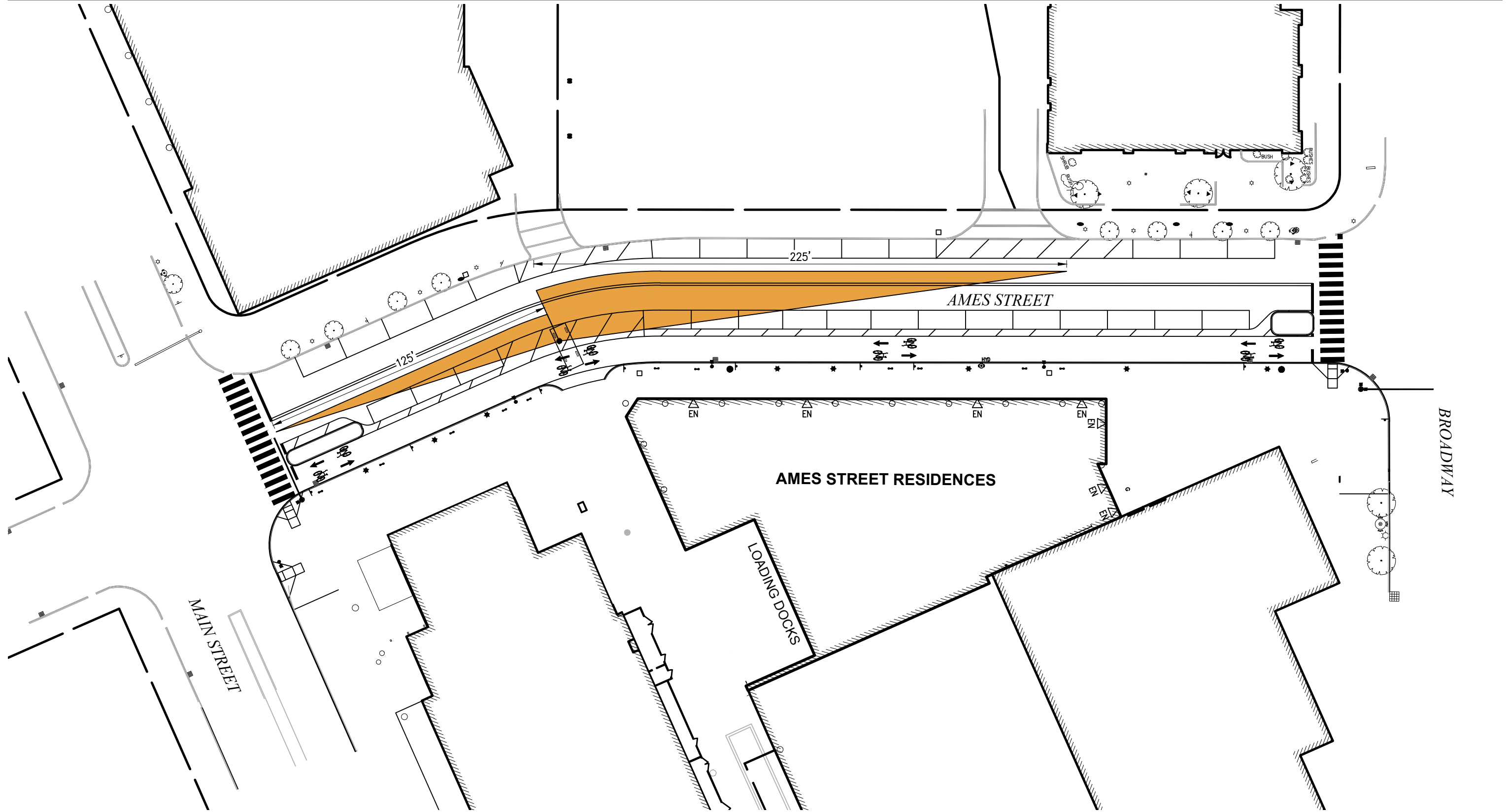

NOTES:

1. DESIGN SPEED ASSUMED TO BE 20 MPH.
2. THIS REQUIRES A 115 FOOT STOPPING SIGHT DISTANCE (SSD) AND 225 FOOT INTERSECTION SIGHT DISTANCE (ISD) ACCORDING TO ASSHTO.
3. DUE TO THE DRIVEWAY PROXIMITY TO AMES ST/MAIN ST INTERSECTION, ISD CAN NOT BE ACHIEVED IN NORTHBOUND DIRECTION.

Vanasse Hangen Brustlin, Inc.

Figure 25  
Vehicular Sight Lines

January 2015

Ames Street Residences  
Cambridge, MA



Figure 26 – Cadys Alley, Washington DC



Figure 28 – Covent Garden, London UK



Figure 27 – Cadys Alley, Washington DC



Figure 29 – Covent Garden, London UK



Figure 30 – Downtown Crossing, Boston MA

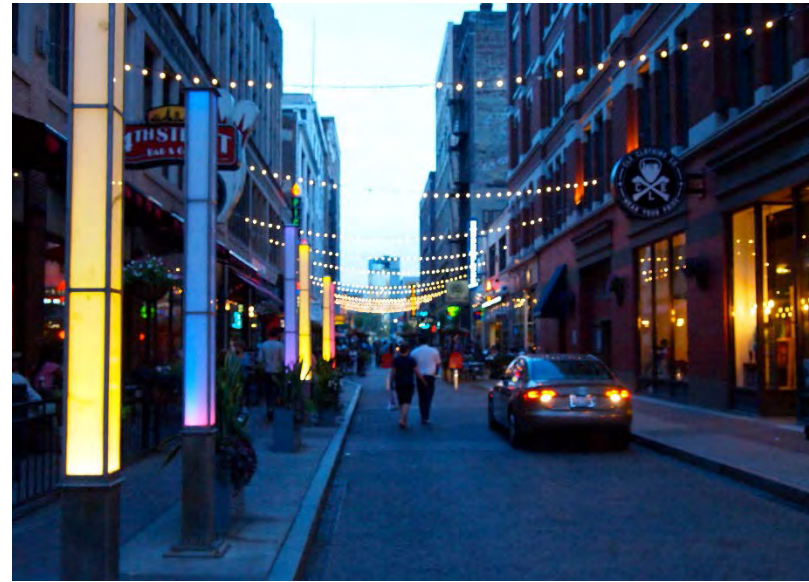

Figure 32 – East 4th Street, Cleveland OH



Figure 31 – East 4th Street, Cleveland OH



Figure 33 – Pearl Alley, Columbus OH



Figure 34 – Winter Street, Boston MA



Figure 36 – Winthrop Steet, Cambridge MA



Figure 35 – Winthrop Steet, Cambridge MA



Figure 37 – Winthrop Steet, Cambridge MA