

**SIGN PLAN**

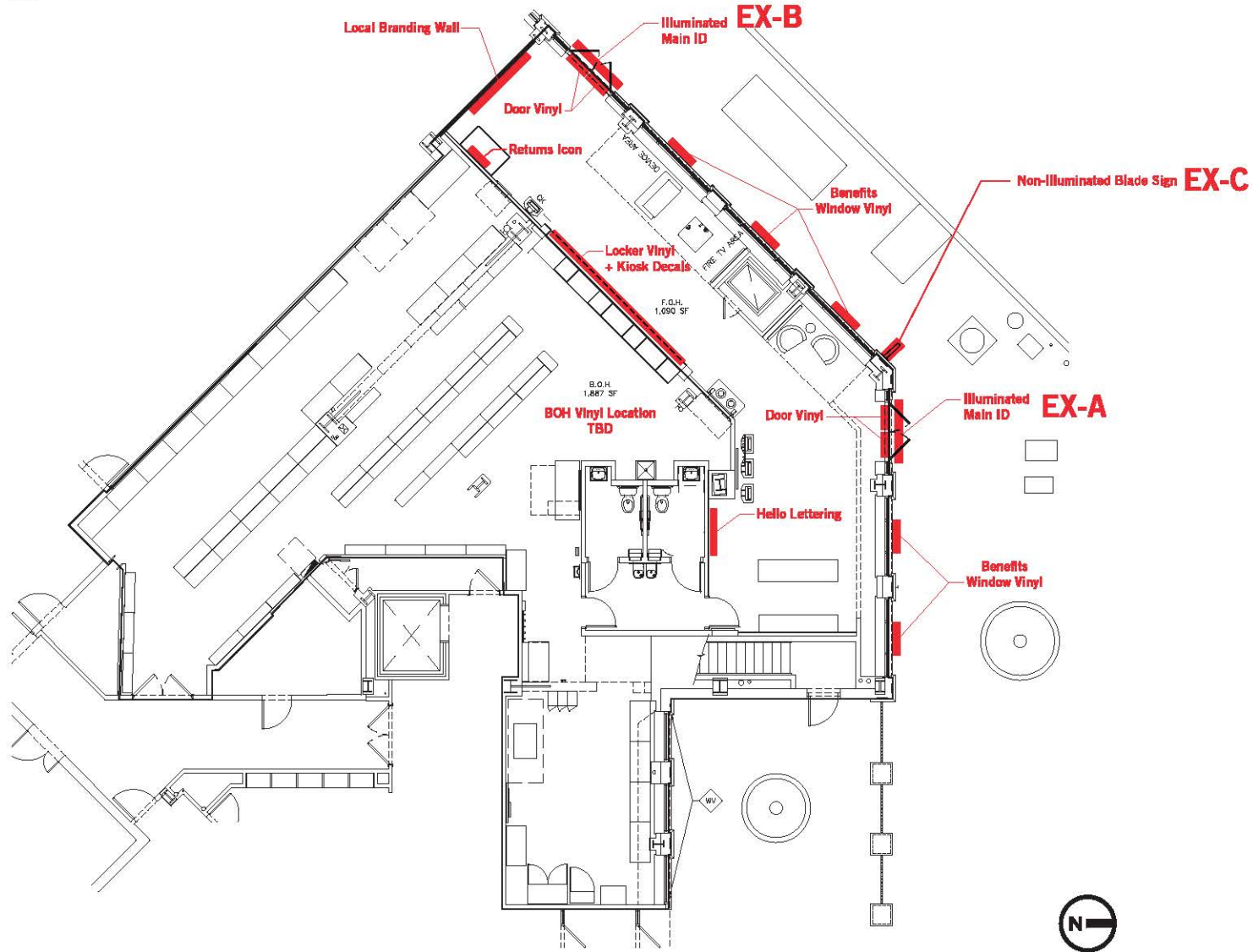

SIGN PLAN

Scale: 3/32" = 1'- 0"



SEATTLE | NEW YORK

JOB #  
**101652**

PROJECT NAME  
**AMAZON CAMPUS  
- MIT Boston - Central Square**

LOCATION  
**624 Massachusetts Ave.  
Cambridge, MA 02139  
Parcel ID#: TBD**

CONTACTS  
**Sharon Lefkowitz**

PROJECT MANAGER  
**Greg Griffin**

DESIGN  
**Hank Bearberg**

SCALE  
**Noted**

ORIGINAL DATE  
**09.27.2017**

REVISION DATES/NOTES

FILE LOCATION  
**M:\Amazon\101652 - Amazon -  
Boston Central Square\_Design**

**APPROVED**

BY:

DATE:

- AS SHOWN
- WITH NOTED CHANGES

M3 | MESSENGER  
37 South Hudson Street  
Seattle, Washington 98134  
206.678.4525  
messengercorp.com

© Messenger Corp 2017  
All artwork contained herein is the copyrighted property of Messenger Corporation and may not be used or displayed in any medium without prior written or oral consent of \$5000 per proposed page or \$25000 per project including, but not limited to Messenger Corporation artwork. Messenger Corporation will retain title and all usage rights to Logo, Design, and Artwork. Usage rights Limited to Campaign may be purchased from Messenger Corporation for additional charge.

PAGE

**EXTERIOR A - ILLUMINATED MAIN ID ( NORTHWEST WALL )**

FOR EXTERIOR USE

VOLTS: \_\_\_\_\_ AMPS: \_\_\_\_\_ CIRCUITS: \_\_\_\_\_  
REQUIRES DEDICATED 20 AMP CIRCUIT

THIS SIGN IS INTENDED TO BE INSTALLED IN ACCORDANCE WITH THE REQUIREMENTS OF ARTICLE 600 OF THE NATIONAL ELECTRICAL CODE AND/OR OTHER APPLICABLE CODES. THIS INCLUDES PROPER GROUNDING AND BONDING OF THE SIGN.

SQ FT. = 15.95



ILLUMINATED LETTERING AND LOGO - FRONT VIEW

Scale: 3/4" = 1'- 0"

**NEED TO SURVEY SOFFIT TO VERIFY DEPTH TO BUILD WIREWAY SO BOTH TOP AND BOTTOM LETTER LINES ARE FLUSH TO ONE ANOTHER**

**A. ILLUMINATED CHANNEL LETTERING Qty: 1**

3" Deep channel letter with aluminum returns painted matte black.  
Interior of channels painted reflective white.  
.177" Translucent white acrylic faces.

White LEDs populate interior of channels for face illumination.  
Low voltage wiring connected to external power supply to 120V 20A circuit.  
Drain holes to be at base of letters and to be baffled.

**MOUNT**  
Letters mounted flush to wall with mechanical fasteners.

**B. ILLUMINATED CHANNEL SMILE LOGO Qty: 1**

3" Deep channel letter logo with aluminum returns painted matte black.  
Interior of channels painted reflective white.  
.177" Translucent white acrylic faces.

White LEDs populate interior of channels for face illumination.  
Low voltage wiring connected to external power supply to 120V 20A circuit.  
Drain holes to be at base of letters and to be baffled.

Wireway to be used as a standoff for the arrow since the soffit is uneven.  
Access to interior of wireway to be from the base with drain holes drilled every 48". Box painted green to match building( CALL OUT TBD ).

**MOUNT**  
Wireway mounted to designated wall with mechanical fasteners.  
Smile mounted to wireway with mechanical fasteners.

**DETAILS ON PAGE 6**

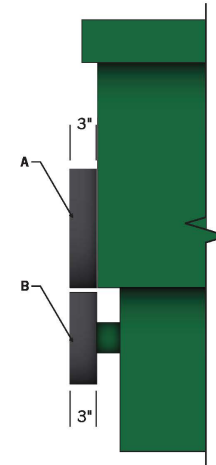

SIDE VIEW

Scale: 1/2" = 1'- 0"



ELEVATION - EXTERIOR PARTIAL NORTH WALL

Scale: 1/4" = 1'- 0"



SEATTLE | NEW YORK

JOB #  
**101652**

PROJECT NAME  
AMAZON CAMPUS  
- MIT Boston - Central Square

LOCATION  
624 Massachusetts Ave.  
Cambridge, MA 02139  
Parcel ID#: TBD

CONTACTS  
Sharon Lefkowitz

PROJECT MANAGER  
Greg Griffin

DESIGN  
Hank Baarslag

SCALE  
Noted

ORIGINAL DATE  
09.27.2017

REVISION DATES/NOTES  
10.12.2017

FILE LOCATION  
M:\Amazon\101652 - Amazon -  
Boston Central Square\_Design

**APPROVED**

BY:

DATE:

AS SHOWN  
 WITH NOTED CHANGES

M3 | MESSENGER  
37 South Hudson Street  
Seattle, Washington 98134  
206.673.4525  
messengercorp.com

© Messenger Corp 2017  
All artwork contained herein is the copyrighted property of Messenger Corporation and may not be used or displayed in any medium without prior consent or paid compensation of \$5000 per proposed sign or \$2000 per product containing unaffiliated original Messenger Corporation artwork. Messenger Corporation will retain any and all usage rights to logos, designs, and artwork. Usage rights (limited at Company) may be purchased from Messenger Corporation for an additional charge.

PAGE

**EXTERIOR B - ILLUMINATED MAIN ID ( NORTH WALL )**

VOLTS: \_\_\_\_\_ AMPS: \_\_\_\_\_ CIRCUITS: \_\_\_\_\_  
 FOR EXTERIOR USE  
 REQUIRES DEDICATED 20 AMP CIRCUIT

THIS SIGN IS INTENDED TO BE INSTALLED IN ACCORDANCE WITH THE REQUIREMENTS OF ARTICLE 600 OF THE NATIONAL ELECTRICAL CODE AND/OR OTHER APPLICABLE CODES. THIS INCLUDES PROPER GROUNDING AND BONDING OF THE SIGN.

SQ FT. = 15.95



ILLUMINATED LETTERING AND LOGO - FRONT VIEW

Scale: 3/4" = 1'- 0"

**NEED TO SURVEY SOFFIT TO VERIFY DEPTH TO BUILD WIREWAY SO BOTH TOP AND BOTTOM LETTER LINES ARE FLUSH TO ONE ANOTHER**

**A. ILLUMINATED CHANNEL LETTERING Qty: 1**

3" Deep channel letter with aluminum returns painted matte black.  
 Interior of channels painted reflective white.  
 .177" Translucent white acrylic faces.

White LEDs populate interior of channels for face illumination.  
 Low voltage wiring connected to external power supply to 120V 20A circuit.  
 Drain holes to be at base of letters and to be baffled.

**MOUNT**  
 Letters mounted flush to wall with mechanical fasteners.

**B. ILLUMINATED CHANNEL SMILE LOGO Qty: 1**

3" Deep channel letter logo with aluminum returns painted matte black.  
 Interior of channels painted reflective white.  
 .177" Translucent white acrylic faces.

White LEDs populate interior of channels for face illumination.  
 Low voltage wiring connected to external power supply to 120V 20A circuit.  
 Drain holes to be at base of letters and to be baffled.

Wireway to be used as a standoff for the arrow since the soffit is uneven.  
 Access to interior of wireway to be from the base with drain holes drilled every 48". Box painted green to match building( CALL OUT TBD ).

**MOUNT**  
 Wireway mounted to designated wall with mechanical fasteners.  
 Smile mounted to wireway with mechanical fasteners.

DETAILS ON PAGE 6

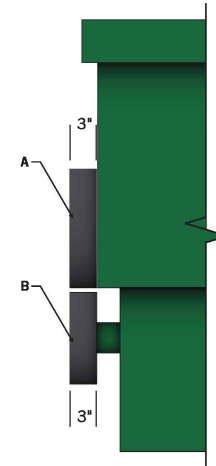

SIDE VIEW

Scale: 1/2" = 1'- 0"



ELEVATION - EXTERIOR PARTIAL NORTH WALL

Scale: 1/4" = 1'- 0"



SEATTLE | NEW YORK

JOB #  
**101652**

PROJECT NAME  
 AMAZON CAMPUS  
 - MIT Boston - Central Square

LOCATION  
 624 Massachusetts Ave.  
 Cambridge, MA 02139  
 Parcel ID#: TBD

CONTACTS  
 Sharon Lefkowitz

PROJECT MANAGER  
 Greg Griffin

DESIGN  
 Hank Baarslag

SCALE  
 Noted

ORIGINAL DATE  
 09.27.2017

REVISION DATES/NOTES  
 10.12.2017

FILE LOCATION  
 M:\Amazon\101652 - Amazon -  
 Boston Central Square\_Design

**APPROVED**

BY:

DATE:

- AS SHOWN
- WITH NOTED CHANGES

M3 | MESSENGER  
 37 South Hudson Street  
 Seattle, Washington 98134  
 206.673.4525  
 messengercorp.com

© Messenger Corp 2017  
 All artwork contained herein is the copyrighted property of Messenger Corporation and may not be used or displayed in any medium without prior consent or paid compensation of \$5000 per proposed sign or \$2000 per product containing unaffiliated original Messenger Corporation artwork. Messenger Corporation will retain any and all usage rights to logos, designs, and artwork. Usage rights (limited or complete) may be purchased from Messenger Corporation for an additional charge.

PAGE

**WINDOW DECALS - BENEFITS MESSAGING ( NORTHWEST WALL )**

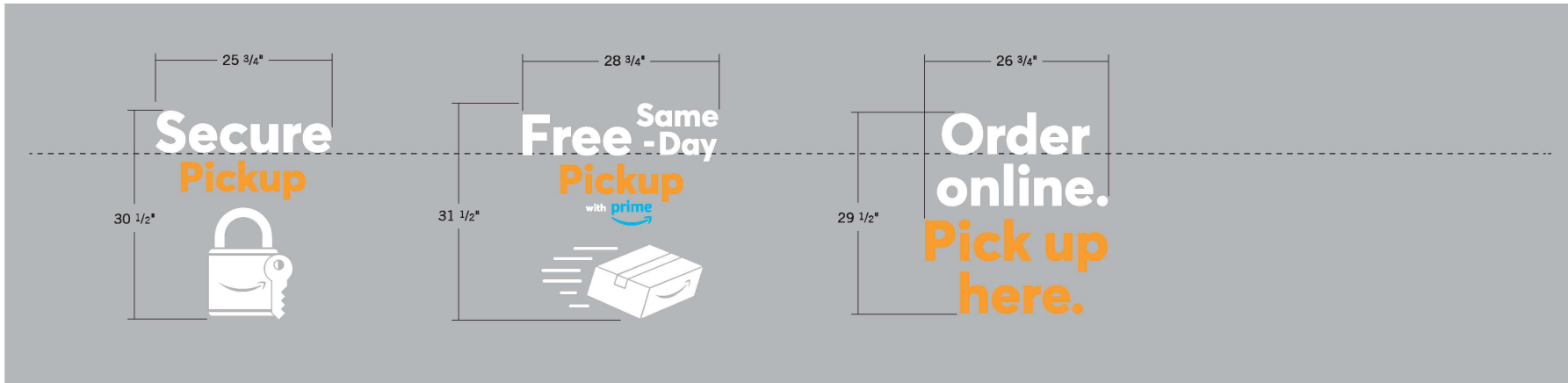

GREY REPRESENTS WINDOW AREA

**BENEFITS MESSAGING DECALS**

Scale: 3/4" = 1'- 0"

**A. VINYL WINDOW DECALS**

Qty: 1 of Each ( 3 )

- Second surface vinyl cut decals.
- White vinyl lettering.
- Orange vinyl to match PMS 1375C.
- Blue vinyl to match PMS 2995C.

**INSTALL**

- 2ND SURFACE direct application to windows.
- Center decals horizontally and measure 40" to baseline of first line of text to base of glass.

**TOTAL SQ. FT. = TBD**

	PMS 1375C / 3M Kumquat Orange Stock Vinyl Coated Finish
	PMS 2995C Coated Finish

Measure to baseline of first line of text to base of glass. 40"



ELEVATION - EXTERIOR PARTIAL NORTHWEST WALL

Scale: 1/4" = 1'- 0"



SEATTLE | NEW YORK

JOB #  
**101652**

PROJECT NAME  
AMAZON CAMPUS  
- MIT Boston - Central Square

LOCATION  
624 Massachusetts Ave.  
Cambridge, MA 02139  
Parcel ID#: TBD

CONTACTS  
Sharon Lefkowitz

PROJECT MANAGER  
Greg Griffen

DESIGN  
Hank Baarslag

SCALE  
Noted

ORIGINAL DATE  
09.27.2017

REVISION DATES/NOTES

FILE LOCATION  
M:\Amazon\101652 - Amazon - Boston Central Square\_Design

**APPROVED**

BY:

DATE:

- AS SHOWN
- WITH NOTED CHANGES

M3 | MESSENGER  
37 South Hudson Street  
Seattle, Washington 98134  
206.623.4525  
messengercorp.com

© Messenger Corp 2017  
All artwork contained herein is the copyrighted property of Messenger Corporation and may not be used or displayed in any medium without prior consent or paid compensation of \$5000 per proposal or \$2000 per product containing unlawfully acquired Messenger Corporation artwork. Messenger Corporation will retain any and all usage rights to Logo, Design, and Artwork. Usage rights (limited or complete) may be purchased from Messenger Corporation for an additional charge.

PAGE

**WINDOW DECALS - BENEFITS MESSAGING ( NORTH WALL )**



GREY REPRESENTS WINDOW AREA

**BENEFITS MESSAGING DECALS**

Scale: 3/4" = 1'- 0"

**A. VINYL WINDOW DECALS**

Qty: 1 of Each ( 2 )

- Second surface vinyl cut decals.
- White vinyl lettering.
- Orange vinyl to match PMS 1375C.

**INSTALL**

- 2ND SURFACE direct application to windows.
- Center decals horizontally and measure 40" to baseline of first line of text to base of glass.

TOTAL SQ. FT. = TBD

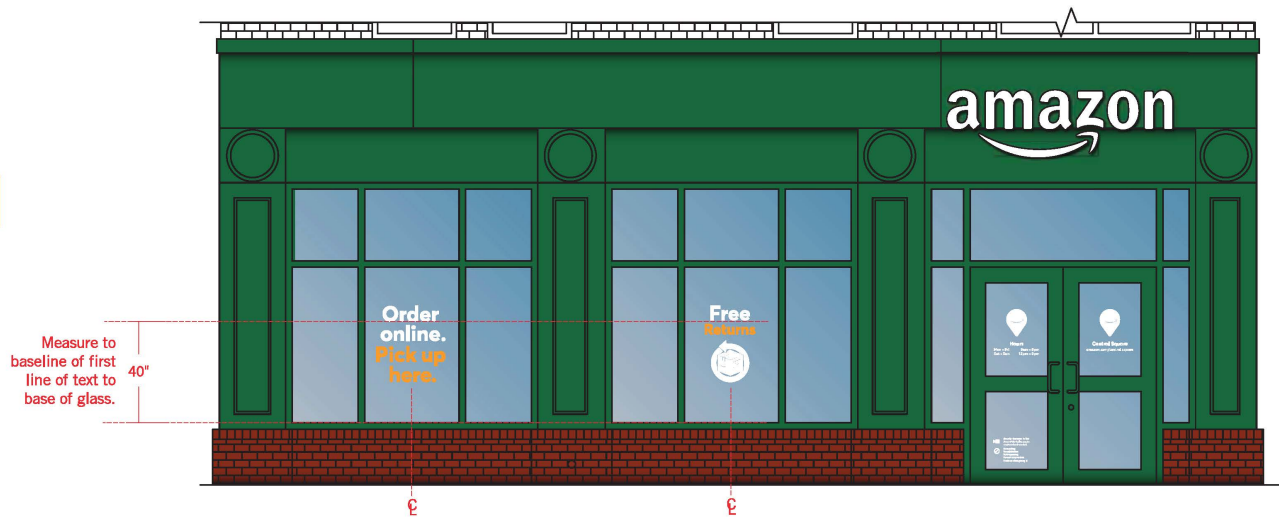
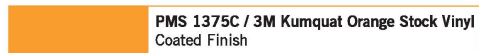

ELEVATION - EXTERIOR PARTIAL NORTH WALL

Scale: 1/4" = 1'- 0"



SEATTLE | NEW YORK

JOB #  
**101652**

PROJECT NAME  
**AMAZON CAMPUS**  
- MIT Boston - Central Square

LOCATION  
**624 Massachusetts Ave.**  
Cambridge, MA 02139  
Parcel ID#: TBD

CONTACTS  
Sharon Lefkowitz

PROJECT MANAGER  
Greg Griffin

DESIGN  
Hank Baarslag

SCALE  
Noted

ORIGINAL DATE  
09.27.2017

REVISION DATES/NOTES

FILE LOCATION  
M:\Amazon\101652 - Amazon - Boston Central Square\_Design

**APPROVED**

BY: \_\_\_\_\_

DATE: \_\_\_\_\_

- AS SHOWN
- WITH NOTED CHANGES

M3 | MESSENGER  
27 South Hudson Street  
Seattle, Washington 98134  
206.623.4525  
messengercorp.com

© Messenger Corp 2017  
All artwork contained herein is the copyrighted property of Messenger Corporation and may not be used or displayed in any medium without prior consent or paid compensation of \$5000 per proposal or \$1000 per product, including unilaterally assigned Messenger Corporation artwork. Messenger Corporation will retain any and all usage rights to Logo, Design, and Artwork. Usage rights (Limited at Completion) may be purchased from Messenger Corporation for an additional charge.

PAGE

## WINDOW DECALS - STORE URL / HOURS / RULES

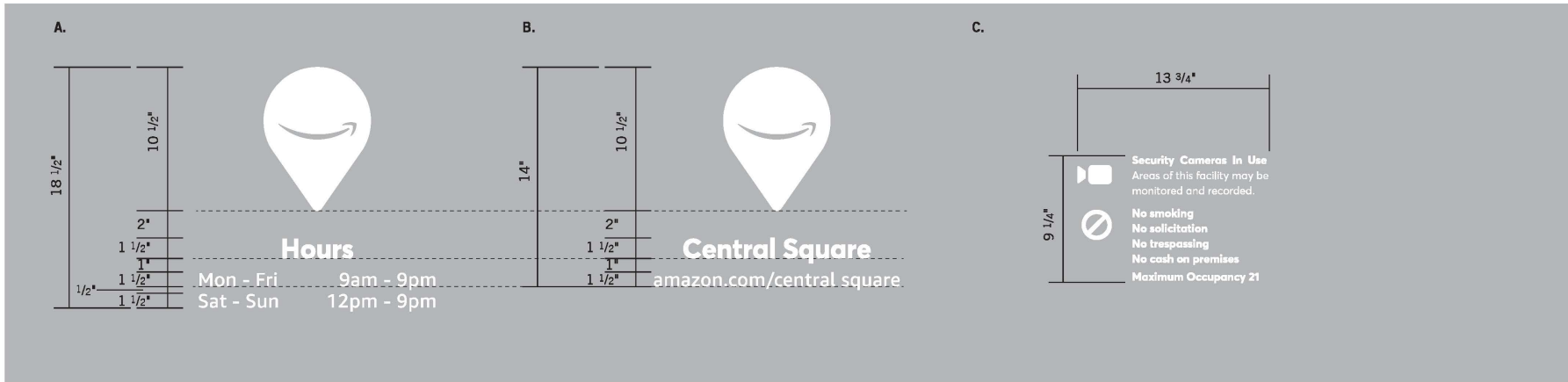

## DOOR DECALS - ( STORE HOURS / STORE URL / STORE RULES )

Scale: 1 1/2" = 1'- 0"

- A. VINYL WINDOW DECALS "STORE HOURS"** Qty: 2  
Second surface vinyl cut decals.  
White vinyl lettering.  
FONTS: Averta Extra Bold / Amazon Ember Regular
- B. VINYL WINDOW DECALS "STORE URL"** Qty: 2  
Second surface vinyl cut decals.  
White vinyl lettering.  
FONTS: Averta Extra Bold / Amazon Ember Regular
- C. VINYL WINDOW DECALS "STORE RULES"** Qty: 2  
Second surface white vinyl cut decals.

**INSTALL**  
2ND SURFACE direct application to each entry door window locations.  
Center decals horizontally and measure 54" to baseline of top line text to floor.

**TOTAL SQ. FT. = TBD**

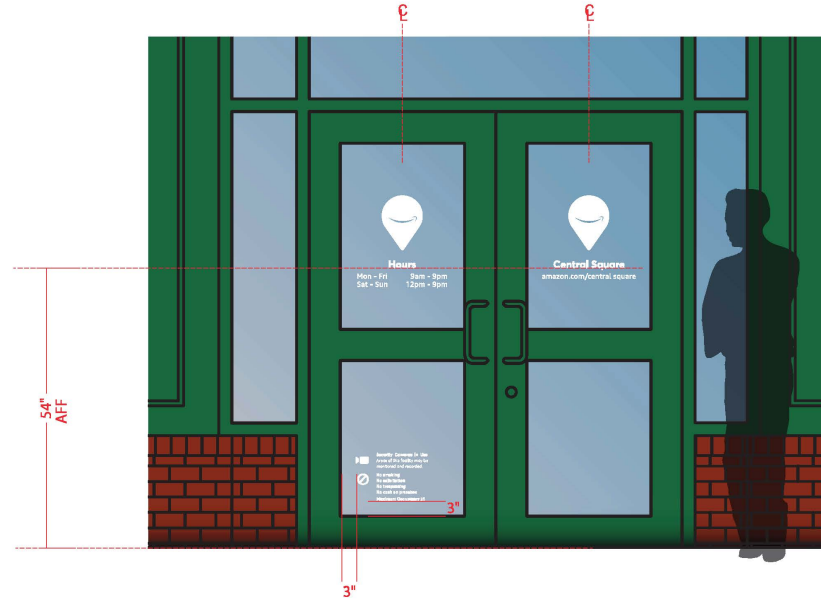

ELEVATION - EXTERIOR DOOR

Scale: 1/2" = 1'- 0"



SEATTLE | NEW YORK

JOB #  
**101652**

PROJECT NAME  
AMAZON CAMPUS  
- MIT Boston - Central Square

LOCATION  
624 Massachusetts Ave.  
Cambridge, MA 02139  
Parcel ID#: TBD

CONTACTS  
Sharon Lefkowitz

PROJECT MANAGER  
Greg Griffen

DESIGN  
Hank Baarlag

SCALE  
Noted

ORIGINAL DATE  
09.27.2017

REVISION DATES/NOTES

FILE LOCATION  
M:\Amazon\101652 - Amazon -  
Boston Central Square\_Design

**APPROVED**

BY:

DATE:

- AS SHOWN
- WITH NOTED CHANGES

M3 | MESSENGER  
37 South Hudson Street  
Seattle, Washington 98134  
206.673.4525  
messengercorp.com

© Messenger Corp 2017  
All artwork contained herein is the copyrighted property of Messenger Corporation and may not be used or displayed in any medium without prior consent or paid compensation of \$5000 per proposal page or \$2000 per product containing unlawfully acquired Messenger Corporation artwork. Messenger Corporation will retain any and all usage rights to Logo, Design, and Artwork. Usage rights (limited or complete) may be purchased from Messenger Corporation for an additional charge.

PAGE

**EXTERIOR - BLOCK OUT WINDOW VINYL**



**A. VINYL BLOCK OUT MATERIAL** Qty: 1  
 3M Medium Gray 180C-31 Vinyl applied 2ND SURFACE as  
 blockout vinyl covering all window areas around door.

**MOUNT**  
 2ND SURFACE application with vertical seams if  
 necessary on lower windows.



ELEVATION - EXTERIOR PARTIAL NORTH WALL

Scale: 3/8" = 1'- 0"



SEATTLE | NEW YORK

JOB #  
**101652**

PROJECT NAME  
 AMAZON CAMPUS  
 - MIT Boston - Central Square

LOCATION  
 624 Massachusetts Ave.  
 Cambridge, MA 02139  
 Parcel ID#: TBD

CONTACTS  
 Sharon Lefkowitz

PROJECT MANAGER  
 Greg Griffin

DESIGN  
 Hank Baarslag

SCALE  
 Noted

ORIGINAL DATE  
 09.27.2017

REVISION DATES/NOTES

FILE LOCATION  
 M:\Amazon\101652 - Amazon -  
 Boston Central Square\_Design

**APPROVED**

BY:

DATE:

- AS SHOWN
- WITH NOTED CHANGES

M3 | MESSENGER  
 27 South Hudson Street  
 Seattle, Washington 98134  
 206.673.4525  
 messengercorp.com

© Messenger Corp 2017  
 All artwork contained herein is the copyrighted  
 property of Messenger Corporation and may not be  
 used or displayed in any medium without prior  
 consent or paid compensation of \$5000 per  
 proposed page or \$2000 per product, including  
 unaffiliated original Messenger Corporation artwork.  
 Messenger Corporation will retain any and all usage  
 rights to Logo, Design, and Artwork. Usage rights  
 (Limited or Complete) may be purchased from  
 Messenger Corporation for an additional charge.

PAGE

**INTERIOR - HELLO WALL**

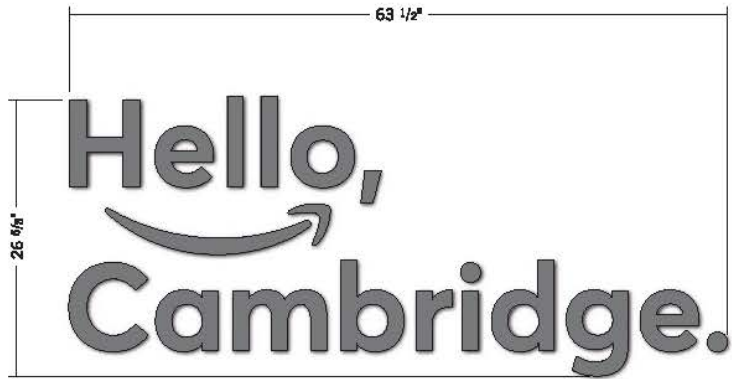

**DIMENSIONAL WALL LETTERING**

Scale: 1" = 1'- 0"

**A. DIMENSIONAL WALL LETTERING**

Qty: 1

1/2" Laser cut acrylic face and sides painted PMS Cool Gray 9 with a matte finish.

FONT: Averta Bold

**INSTALL**

Pin mount lettering and smile so it is 1/4" offset to the wall.

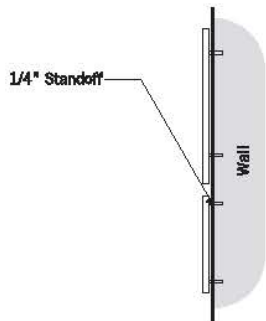

**SIDE DETAIL**

Scale: 1" = 1'- 0"

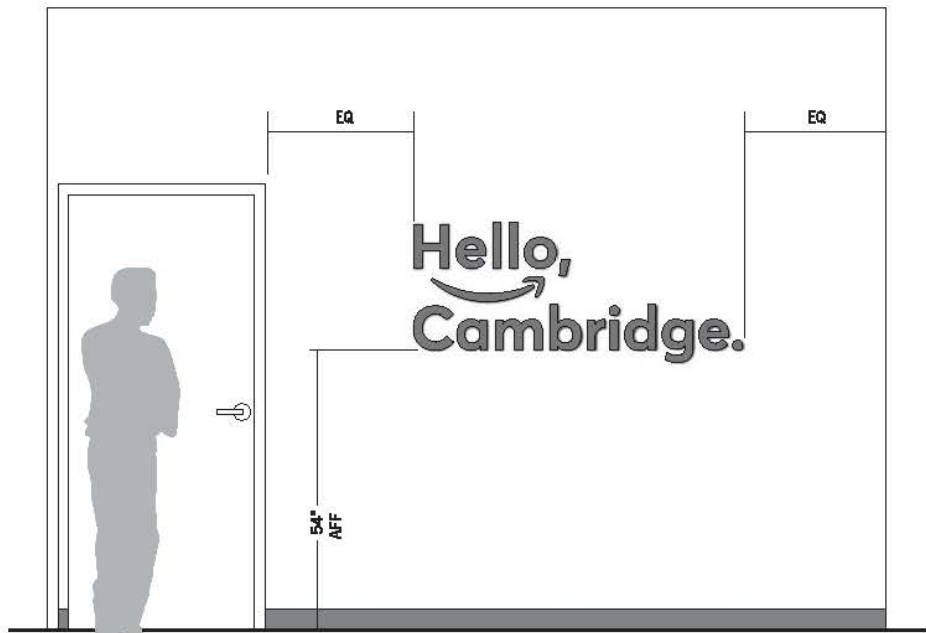

**ELEVATION**

Scale: 1/2" = 1'- 0"



SEATTLE | NEW YORK

JOB #  
**101652**

PROJECT NAME  
AMAZON CAMPUS  
- MIT Boston - Central Square

LOCATION  
624 Massachusetts Ave.  
Cambridge, MA 02139  
Parcel ID# 13D

CONTACTS  
Sharon Lefkowitz

PROJECT MANAGER  
Greg Griffin

DESIGN  
Mark Berman

SCALE  
Noted

ORIGINAL DATE  
09.27.2017

REVISION DATES/NOTES

FILE LOCATION  
M:\Amazon\101652 - Amazon -  
Boston - Central Square\_Design

**APPROVED**

BY

DATE

- AS SHOWN
- WITH NOTED CHANGES

M3 | MESSENGER  
337 South Hudson Street  
Seattle, Washington 98134  
206.633.4525  
messengercorp.com

© Messenger Corp 2017  
All other material herein is the copyrighted property of Messenger Corporation and may not be used or displayed in any medium without prior consent or prior compensation of \$5000 per copy and up to \$2000 per picture containing substantially copied Messenger Corporation content. Messenger Corporation will enforce all its copyright, trademark, design, and artwork. Design rights in this document may be purchased from Messenger Corporation for an additional charge.

PAGE



**INTERIOR - LOCKER DECALS**



LOCKER SOFFIT DECAL - "CTA"

Scale: 3/4" = 1'- 0"

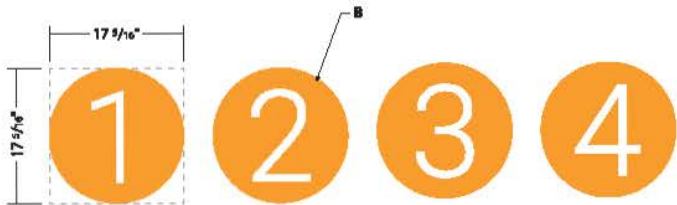

LOCKER NUMBERS

Scale: 3/4" = 1'- 0"

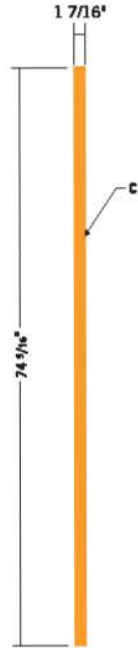

LOCKER DIVIDERS

Scale: 3/4" = 1'- 0"

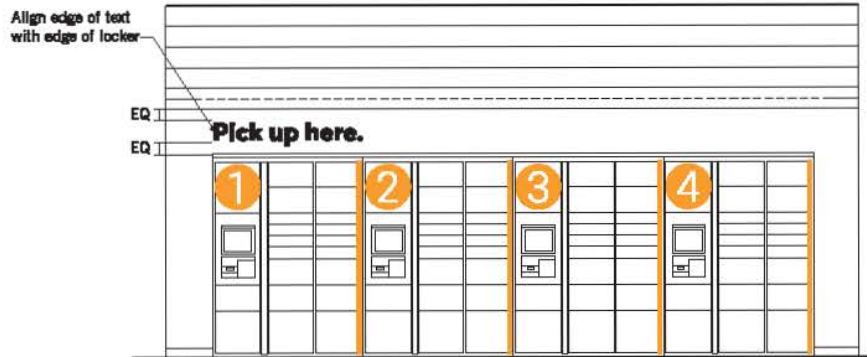

ELEVATION - INTERIOR LOCKER WALL

Scale: 1/4" = 1'- 0"

**A. LOCKER SOFFIT DECAL "CTA"**

Matta black vinyl.  
Font: Averta - Extra Bold / Size: 716pt (at full size)  
Standard size CTA.

Qty: 1

**INSTALL:**

First surface direct application to soffit above lockers.  
See drawing for exact placement.

**B. LOCKER DECAL "NUMBERS"**

First surface vinyl decals plot to shape with a reverse weed for the numbers to expose locker surface.  
Orange vinyl to match PMS 1375C.  
Font: Roboto - Light / Size: 1186pt (at full size)

Qty: 4

**C. LOCKER DECAL "DIVIDERS"**

First surface vinyl decals plot to shape.  
Orange vinyl to match PMS 1375C.

Qty: 4

**INSTALL:**

First surface direct application to lockers.  
Numbers to be installed in sequence with corresponding kiosks.  
Vertical dividers to be install flush with the last locker set within each locker grouping. See drawing for exact placement.

PMS 1375C / 3M Kumquat Orange Stock Vinyl  
Coated Finish



PREVIOUS INSTALL PHOTO FOR REFERENCE.

Scale: NTS



SEATTLE | NEW YORK

JOB #  
**101652**

PROJECT NAME  
AMAZON CAMPUS  
- MIT Station - Central Square

LOCATION  
624 Massachusetts Ave.  
Cambridge, MA 02139  
Parcel ID#: T8D

CONTACTS  
Sharon Lefkowitz

PROJECT MANAGER  
Greg Griffin

DESIGN  
Mark Manning

SCALE  
Noted

ORIGINAL DATE  
09.27.2017

REVISION DATES/NOTES

FILE LOCATION  
M:\Amazon\101652 - Amazon -  
Station: Central Square\Design

**APPROVED**

BY:

DATE:

AS SHOWN  
 WITH NOTED CHANGES

M3 | MESSENGER  
33 South Foulton Street  
Seattle, Washington 98194  
206.623.4525  
messengercorp.com

© Messenger Corp 2017  
All artwork contained herein is the copyrighted property of Messenger Corporation and may not be used or adapted in any medium without prior consent or prior authorization of \$5000 per approved page or \$2500 per printed rendering. Messenger Corporation will not be held liable for any reproduction, distribution, or use of this artwork without the prior written consent of Messenger Corporation. All rights reserved. Messenger Corporation is not responsible for any reproduction, distribution, or use of this artwork without the prior written consent of Messenger Corporation.

PAGE

# INTERIOR - LOCKER KIOSK DECALS



KIOSK VINYL CUT DECAL

Scale: 6" = 1'- 0"

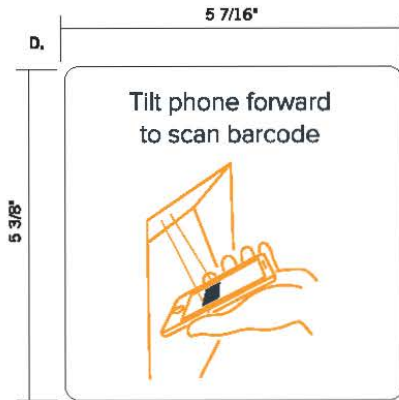
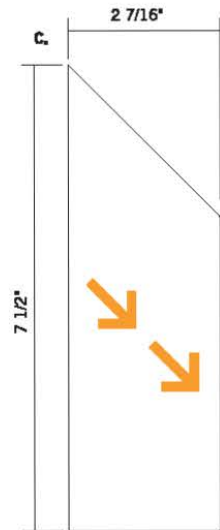
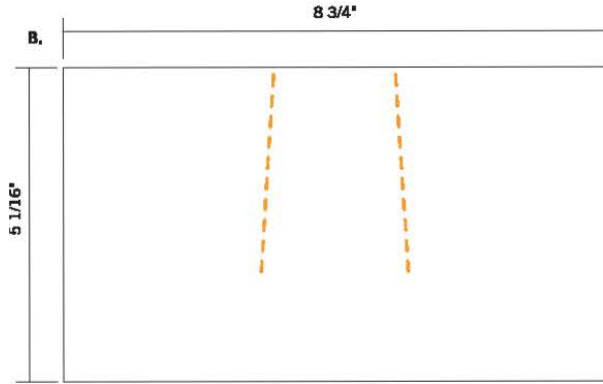

KIOSK DECALS

Scale: 6" = 1'- 0"

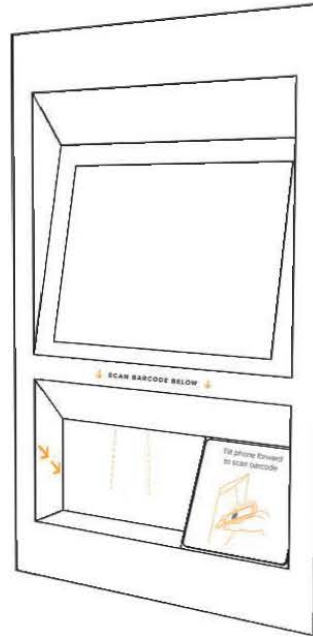

KIOSK FACE DETAIL

Scale: NTS

**A. VINYL LOCKER KIOSK DECALS "Scan Barcode Below / Arrows"** Qty: 4  
First surface vinyl cut decal with text to be cut out of Matte Black vinyl and arrows cut from Orange vinyl to match PMS 1375C.

**B. VINYL LOCKER KIOSK DECALS "Alignment Lines"** Qty: 4  
First surface white control tac with digital graphic printed to surface with a matte laminate.  
Orange vinyl to match PMS 1375C.

**C. VINYL LOCKER KIOSK DECALS "Alignment Arrows"** Qty: 4  
First surface white control tac with digital graphic printed to surface with a matte laminate.  
Orange vinyl to match PMS 1375C.

**D. VINYL LOCKER KIOSK DECALS "Tilt Phone Visual"** Qty: 4  
First surface white control tac with digital graphic printed to surface with a matte laminate.  
Orange vinyl to match PMS 1375C.

**MOUNT**

First surface direct application to kiosk.

**PMS 1375C / 3M Kumquat Orange Stock Vinyl**  
Coated Finish



REFERENCE PHOTO

Scale: NTS



SEATTLE | NEW YORK

JOB #  
**101652**

PROJECT NAME  
AMAZON CAMPUS  
- MIT Boston - Central Square

LOCATION  
624 Massachusetts Ave.  
Cambridge, MA 02189  
Parcel ID#: TBD

CONTACTS  
Sharon Lefkowitz

PROJECT MANAGER  
Greg Girton

DESIGN  
Hank Bearling

SCALE  
Noted

ORIGINAL DATE  
09.27.2017

REVISION DATES/NOTES

FILE LOCATION  
M:\Amazon\101652 - Amazon -  
Boston Central Square\_Design

**APPROVED**

BY:

DATE:

- AS SHOWN
- WITH NOTED CHANGES

M3 | MESSENGER  
37 South Hudson Street  
Seattle, Washington 98134  
206.523.4525  
messengercorp.com

© Messenger Corp 2017  
All artwork contained herein is the copyrighted property of Messenger Corporation and may not be used or changed in any medium without prior written consent of Messenger Corporation. Messenger Corporation is not responsible for any damage or loss of data resulting from the use of Messenger Corporation artwork. Messenger Corporation will not be liable for any and all copyright infringement, design, and artwork. Usage rights (limited or complete) may be purchased from Messenger Corporation for an additional charge.

PAGE

**INTERIOR - RETURNS WALL ICON**

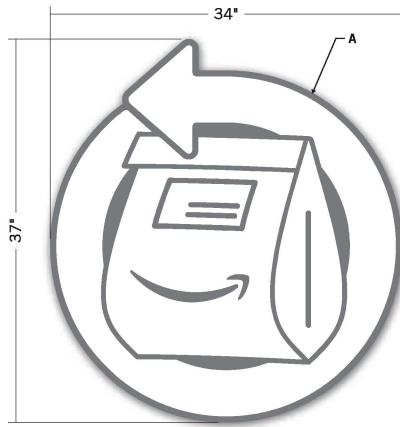

**DIMENSIONAL WALL ICON**

Scale: 1" = 1'- 0"

**A. DIMENSIONAL WALL ICON** Qty: 1  
1/2" Sintra with direct print graphics ( black 65% ).

**INSTALL**

Sintra icon is mounted to wall using french cleats.  
Center icon horizontally over returns cabinet and vertically align so base is 42" AFF.

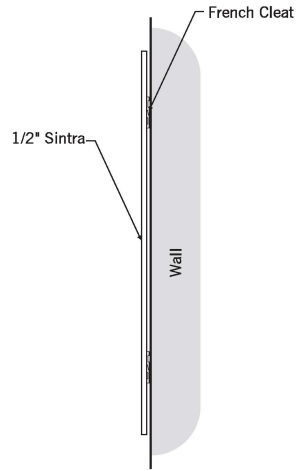

**SIDE DETAIL**

Scale: 1" = 1'- 0"

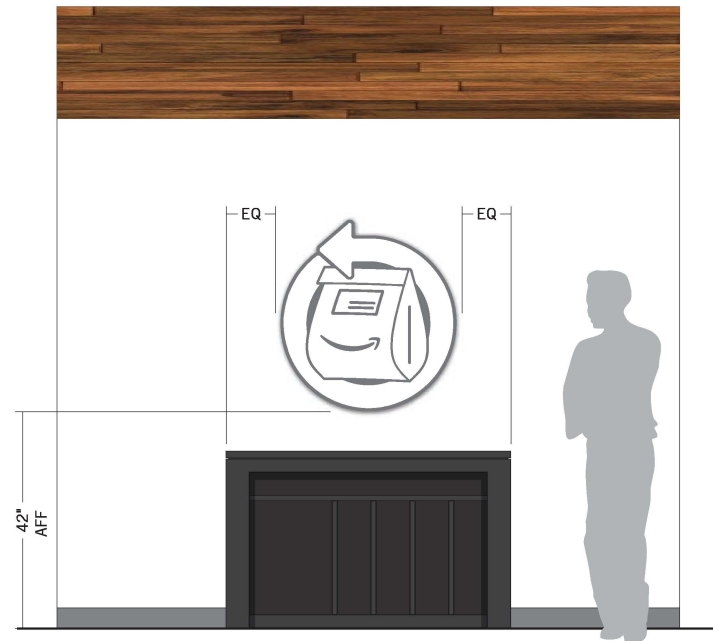

**ELEVATION**

Scale: 1/2" = 1'- 0"



SEATTLE | NEW YORK

JOB #  
**101652**

PROJECT NAME  
AMAZON CAMPUS  
- MIT Boston - Central Square

LOCATION  
624 Massachusetts Ave.  
Cambridge, MA 02139  
Parcel ID#: TBD

CONTACTS  
Sharon Lefkowitz

PROJECT MANAGER  
Greg Griffen

DESIGN  
Hank Baarslag

SCALE  
Noted

ORIGINAL DATE  
09.27.2017

REVISION DATES/NOTES

FILE LOCATION  
M:\Amazon\101652 - Amazon -  
Boston Central Square\_Design

**APPROVED**

BY: \_\_\_\_\_

DATE: \_\_\_\_\_

- AS SHOWN
- WITH NOTED CHANGES

M3 | MESSENGER  
37 South Hudson Street  
Seattle, Washington 98134  
206.673.4525  
messengercorp.com

© Messenger Corp 2017  
All artwork contained herein is the copyrighted property of Messenger Corporation and may not be used or displayed in any medium without prior consent or paid compensation of \$5000 per proposed page or \$1000 per product containing unlawfully acquired Messenger Corporation artwork. Messenger Corporation will retain any and all usage rights to Logo, Design, and Artwork. Usage rights (Limited or Complete) may be purchased from Messenger Corporation for an additional charge.

PAGE

**INTERIOR - BACK OF THE HOUSE EMPLOYEE MESSAGING**

**A. EMPLOYEE ACTION STATEMENT** Qty: 1  
 6' Tall matte black vinyl cut lettering cut and premasked.

**B. EMPLOYEE PRINCIPLES** Qty: 1 of each statement ( 14 total )  
 4' Tall matte black vinyl cut lettering cut and premasked.

**INSTALL PLAN:**  
 All premasked statement decals to be installed in the back of the house employee only area. On site installer will work with the store manager to finalize placement locations of the decals and apply each to its designated wall.



**EMPLOYEE ACTION STATEMENT**  
 Scale: 3/4" = 1'- 0"

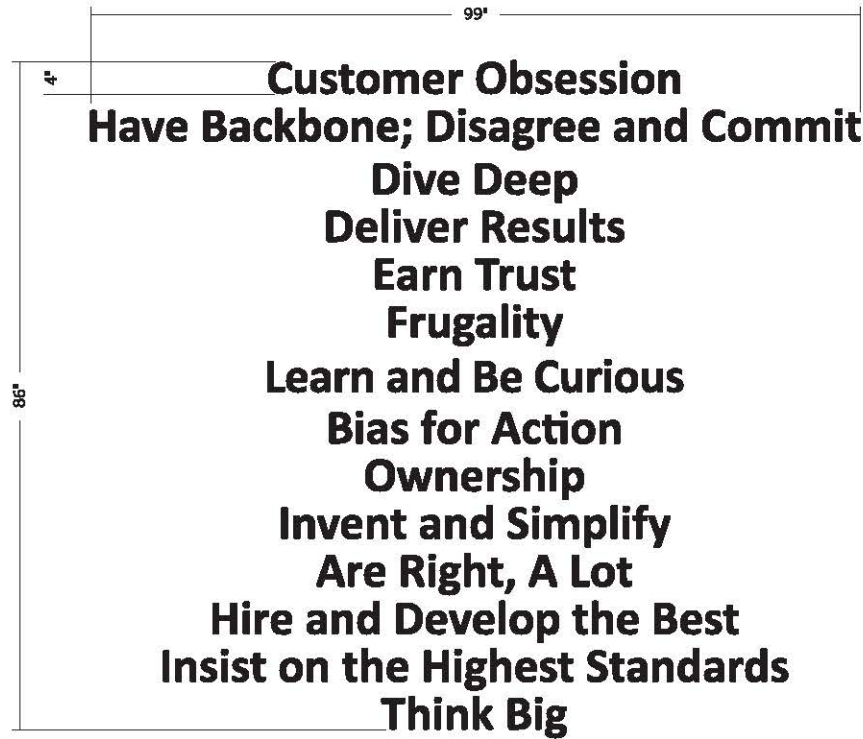

**EMPLOYEE PRINCIPLES**  
 Scale: 3/4" = 1'- 0"



SEATTLE | NEW YORK

JOB #  
**101652**

PROJECT NAME  
**AMAZON CAMPUS  
 - MIT Boston - Central Square**

LOCATION  
**624 Massachusetts Ave.  
 Cambridge, MA 02139  
 Parcel ID#: TBD**

CONTACTS  
**Sharon Lefkowitz**

PROJECT MANAGER  
**Greg Griffin**

DESIGN  
**Hank Beareing**

SCALE  
**Noted**

ORIGINAL DATE  
**09.27.2017**

REVISION DATES/NOTES

FILE LOCATION  
**M:\Amazon\101652 - Amazon -  
 Boston Central Square\_Design**

**APPROVED**

BY:

DATE:

- AS SHOWN
- WITH NOTED CHANGES

M3 | MESSENGER  
 37 South Hudson Street  
 Seattle, Washington 98134  
 206.678.4525  
 messengercorp.com

© Messenger Corp 2017  
 All artwork contained herein is the copyrighted property of Messenger Corporation and may not be used or displayed in any medium without prior written or oral consent of \$5000 per proposed page or \$2000 per printed rendering. Unlawfully copied Messenger Corporation artwork. Messenger Corporation will retain title and all usage rights to Logo, Design, and Artwork. Usage rights Limited to Company may be purchased from Messenger Corporation for an additional charge.

PAGE

**INTERIOR - COMMUNITY WALL**

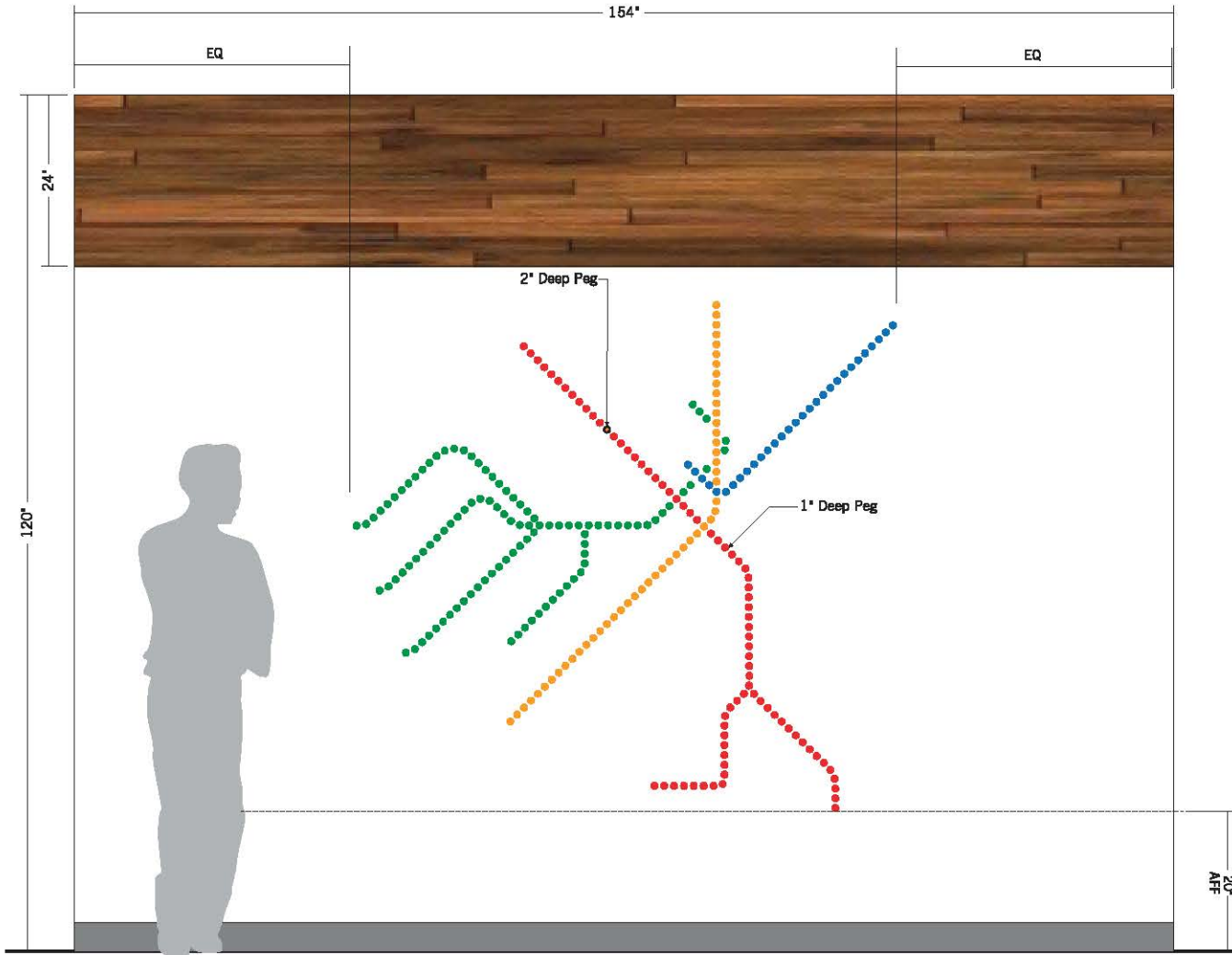

**ELEVATION**  
Scale: 3/4" = 1'-0"

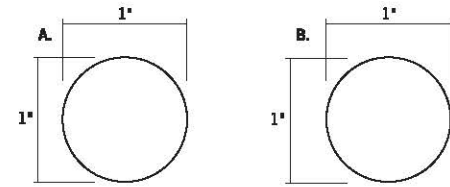

**PEGS PLAN VIEW**  
Scale: 1 : 1

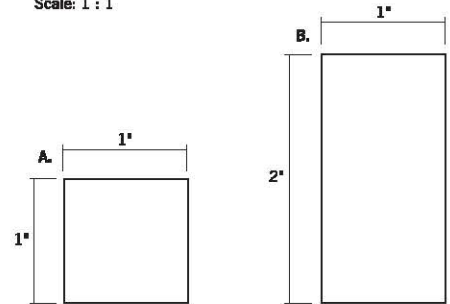

**PEGS PROFILE VIEW**  
Scale: 1 : 1

**A. 1" DEEP WALL PEGS** Qty: 261  
1" Deep acrylic pegs with a 1" diameter to be laser cut and painted to match corresponding transit line.

- 261 TOTAL PEGS**  
 77 = Red { Paint to match PMS 485 }  
 30 = Blue { Paint to match PMS 285 }  
 103 = Green { Paint to match PMS 355 }  
 51 = Orange { Paint to match PMS 1375 }

**MOUNT**  
Pegs mounted to finished wall using a paper pattern and with VHB adhesive.

**B. 2" DEEP WALL PEG** Qty: 1  
2" Deep acrylic pegs with a 1" diameter to be laser cut and painted to highlight the Amazon Campus location. Entire peg painted black with an inner circle painted orange to match PMS 1375C.

**MOUNT**  
Peg will be pin mounted to finished wall using a paper pattern.

	PMS 485
	PMS 285
	PMS 355
	PMS 1375



SEATTLE | NEW YORK

JOB #  
**101652**

PROJECT NAME  
**AMAZON CAMPUS**  
- MIT Boston - Central Square

LOCATION  
824 Massachusetts Ave.  
Cambridge, MA 02139  
Parcel ID#: TBD

CONTACTS  
Sharon Larkowitz

PROJECT MANAGER  
Greg Griffin

DESIGN  
Hank Bearberg

SCALE  
Noted

ORIGINAL DATE  
09.27.2017

REVISION DATES/NOTES

FILE LOCATION  
M:\Amazon\101652 - Amazon -  
Boston Central Square\_Design

**APPROVED**

BY: \_\_\_\_\_  
DATE: \_\_\_\_\_  
 AS SHOWN  
 WITH NOTED CHANGES

M3 | MESSENGER  
37 South Hudson Street  
Seattle, Washington 98134  
206.628.4525  
messengercorp.com

© Messenger Corp 2017  
All artwork contained herein is the copyrighted property of Messenger Corporation and may not be used or displayed in any medium without prior written or print authorization of \$5000 per proposed page or \$2000 per printed rendering. Unlawfully copied Messenger Corporation artwork. Messenger Corporation will retain title and all usage rights to Layout, Design, and Artwork. Usage Rights Limited or Copied may be purchased from Messenger Corporation for an additional charge.

PAGE