

HARVARD SQUARE KIOSK AND PLAZA

Project Background

In conjunction with the Harvard Square Kiosk and Plaza Working Group process, the City of Cambridge has been developing design concepts for renovating the historic Harvard Square Kiosk. The project involves carefully restoring architectural details, adapting for future use, and redesigning the Plaza to improve accessibility and enhance the flexibility of the space.

Public Process

In 2017, the City established a Harvard Square Kiosk and Plaza Working Group to create a vision for the future use, operation, and governance of the Harvard Square Kiosk and Plaza.

The Working Group process has involved broad public input, including surveys, community meetings, pop-up workshops, and a Call for Ideas.

Based on this community feedback and regular meetings, the Working Group developed a set of recommendations for the future of this space in the heart of Harvard Square.

Summary of Vision and Recommendations for the Kiosk and Plaza

The Working Group envisions the Harvard Square Kiosk and Plaza to be flexible, dynamic, and welcoming community assets that enhance the everyday life of Harvard Square, act as platforms for community gatherings, including civic, artistic, and social activities, and attract and serve a broad range of people, including residents, students, visitors, etc.

The interior of the Kiosk would function as a flexible space accommodating permanent and temporary community uses:

- Permanent uses would feature a Visitor Information Center with displays focused on Cambridge history and happenings and the provision of news, brochures, and other materials.
- Temporary programming would occur inside the Kiosk and around the Plaza intermittently throughout the span of a typical week, which could include functions such as: small performances, historical exhibits, interactive installations, family oriented activities, voter registration, sampling of goods or services, and other entertaining, educational, festive, civic, and community-oriented activities.

More detail on the Working Group process and recommendations is featured in a report available at www.cambridgema.gov/harvardsquarekiosk.

Project Timeline

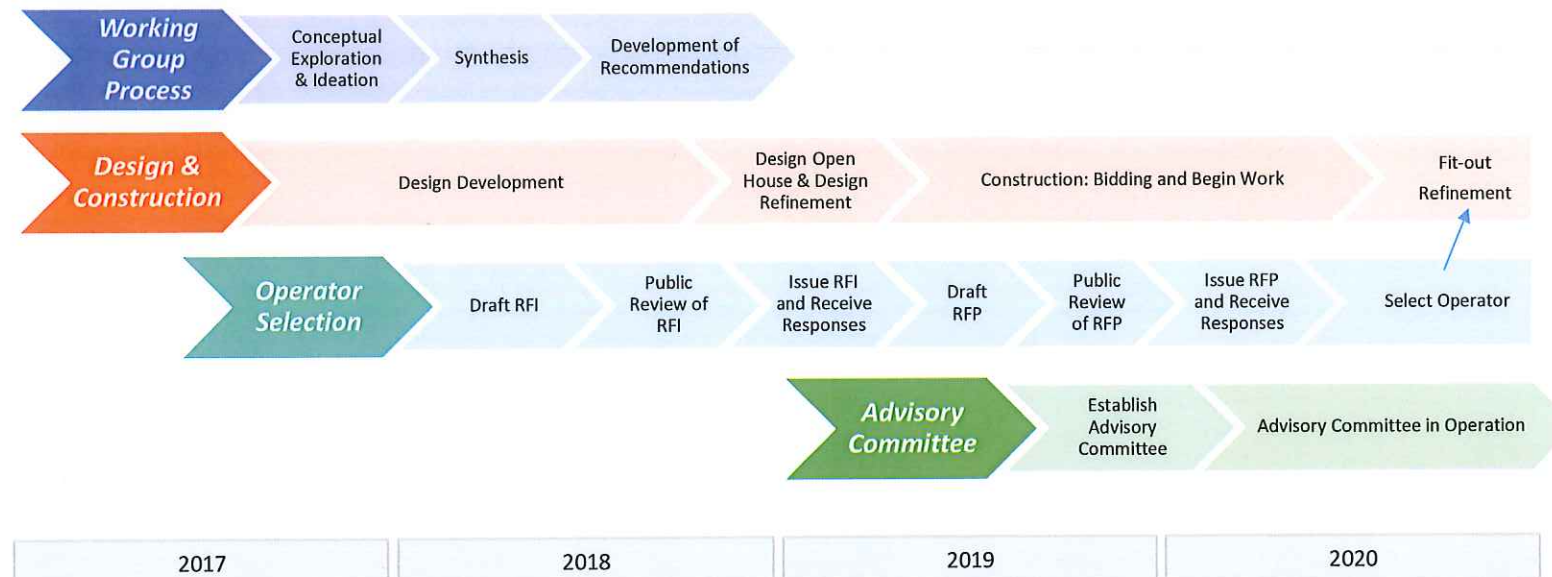

DESIGN CONSIDERATIONS

CONTEXT

- ENHANCE CONNECTIONS TO SURROUNDING USES

CIRCULATION

- PRESERVE PRIMARY CIRCULATION ROUTES
- MAKE BETTER USE OF REMAINING SPACE ON THE PLAZA

FLEXIBLE SPACE

- DECLUTTER - REMOVE WALLS/STEPS/PLANTERS/INFO BOOTH
- LEVEL/FLAT PLAZA - UNIVERSAL ACCESS
- MINIMIZE PERMANENT FURNISHINGS - MOVABLE FURNITURE

SENSE OF ENCLOSURE / SAFETY / COMFORT

- PROTECTION FROM VEHICLES
- SHADE - TREES OR UMBRELLAS

PLANTING

- TREES
- PLANTERS

PROGRAMMING

- ACCOMODATE VARIETY OF USES: EVENTS, PASSIVE, ART, MUSIC, FOOD, ETC
- NIGHT/DAY
- SEASONALITY

EXISTING CONDITIONS



EXISTING CONDITIONS



BUFFERING THE SPACE FROM MASS AVE WOULD RESULT IN SAFER & MORE COMFORTABLE GATHERING



EXISTING CONDITIONS



EXISTING CONDITIONS



REMOVING A TAXI SPACE COULD AMELIORATE THE CIRCULATION PINCH POINT ADJACENT TO THE KIOSK



EXISTING CONDITIONS



LOWERING THE FINISH FLOOR ELEVATION OF THE KIOSK WILL IMPROVE ADA ACCESSIBILITY



EXISTING ACCESSIBILITY DIAGRAM

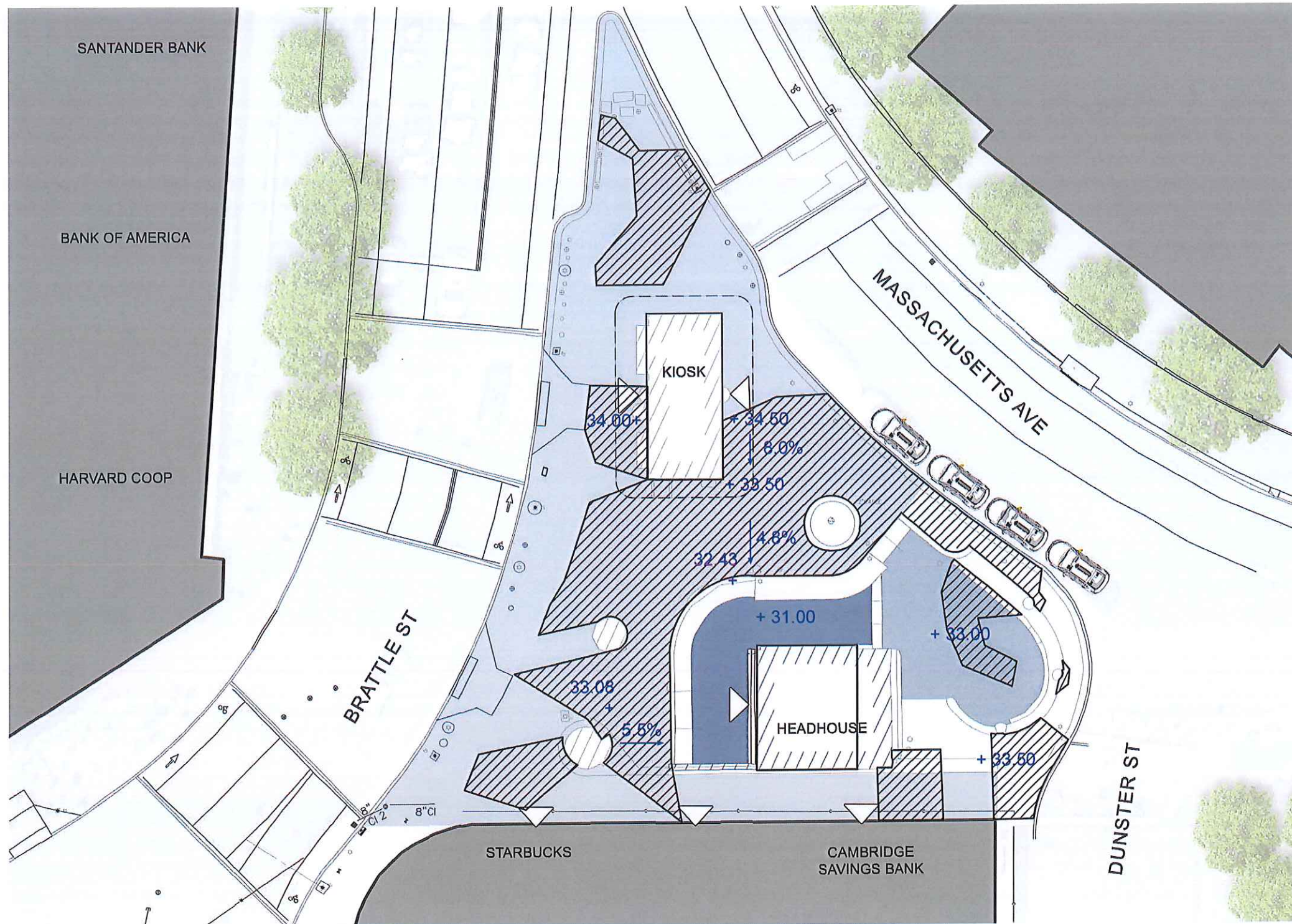

EXISTING ELEVATION

- UPPER
- INTERMEDIATE
- LOWER
- NON-COMPLIANT ADA ACCESSIBILITY
 > 2% PLAZA SLOPES
 > 2% CROSS SLOPES
 > 5% RUNNING SLOPES

PLAZA IS SUBDIVIDED INTO THREE LEVELS LIMITING CIRCULATION AND USAGE

WEST SIDE OF KIOSK IS 6" HIGHER THAN EAST SIDE RESULTING IN A STEP DOWN OUT OF KIOSK

EXISTING PLAZA SLOPES ARE NOT COMPLIANT WITH CURRENT ADA/MAAB REGULATIONS

PROPOSED ACCESSIBILITY DIAGRAM

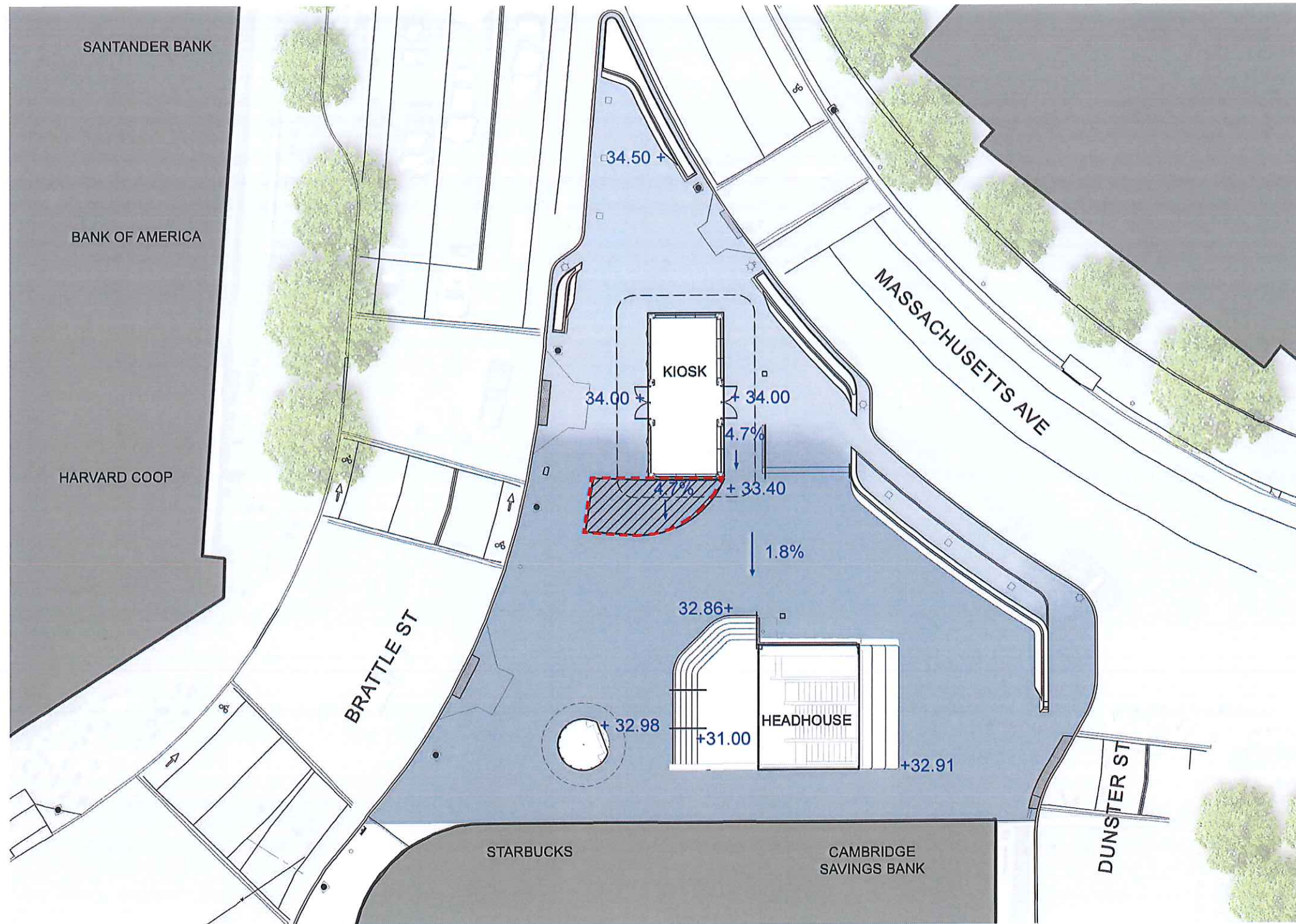

PROPOSED ELEVATION

- UPPER
- INTERMEDIATE
- LOWER
- NON-COMPLIANT ADA ACCESSIBILITY
> 2% PLAZA SLOPES
> 2% CROSS SLOPES
> 5% RUNNING SLOPES
- AREA REQUIRING VARIANCE

RECONFIGURED STEPS AND WALLS
CREATE ONE LARGER GATHERING
SPACE AT INTERMEDIATE LEVEL

KIOSK ELEVATION IS LOWERED 6" PRO-
VIDING UNIVERSAL ACCESS TO BOTH
EAST AND WEST ENTRANCES

PLAZA SLOPES ARE COMPLIANT WITH
CURRENT ADAMAAB REGULATIONS



PROPOSED SITE PLAN



FEATURES AND ACCESSIBLE ROUTES

- ① TREES IN PERMEABLE PAVERS
- ② PLANTERS AND SEAT WALLS TO ENHANCE SPACE
- ③ ADJUST FINISH GRADE OF KIOSK FOR ACCESSIBILITY
- ④ LEVEL FLEXIBLE PLAZA SPACE
- ⑤ WIDENED SIDEWALK
- ⑥ TERRACED SEATING FEATURE
- ⑦ RECONFIGURED STAIRS
- ⑧ NEW GLASS MBTA ELEVATOR
- ⑨ RETAINING SEAT WALL
- ⑩ REMOVE ONE TAXI SPACE TO AMELIORATE PINCH POINT
- ⑪ REMOVE INFO BOOTH TO IMPROVE CIRCULATION

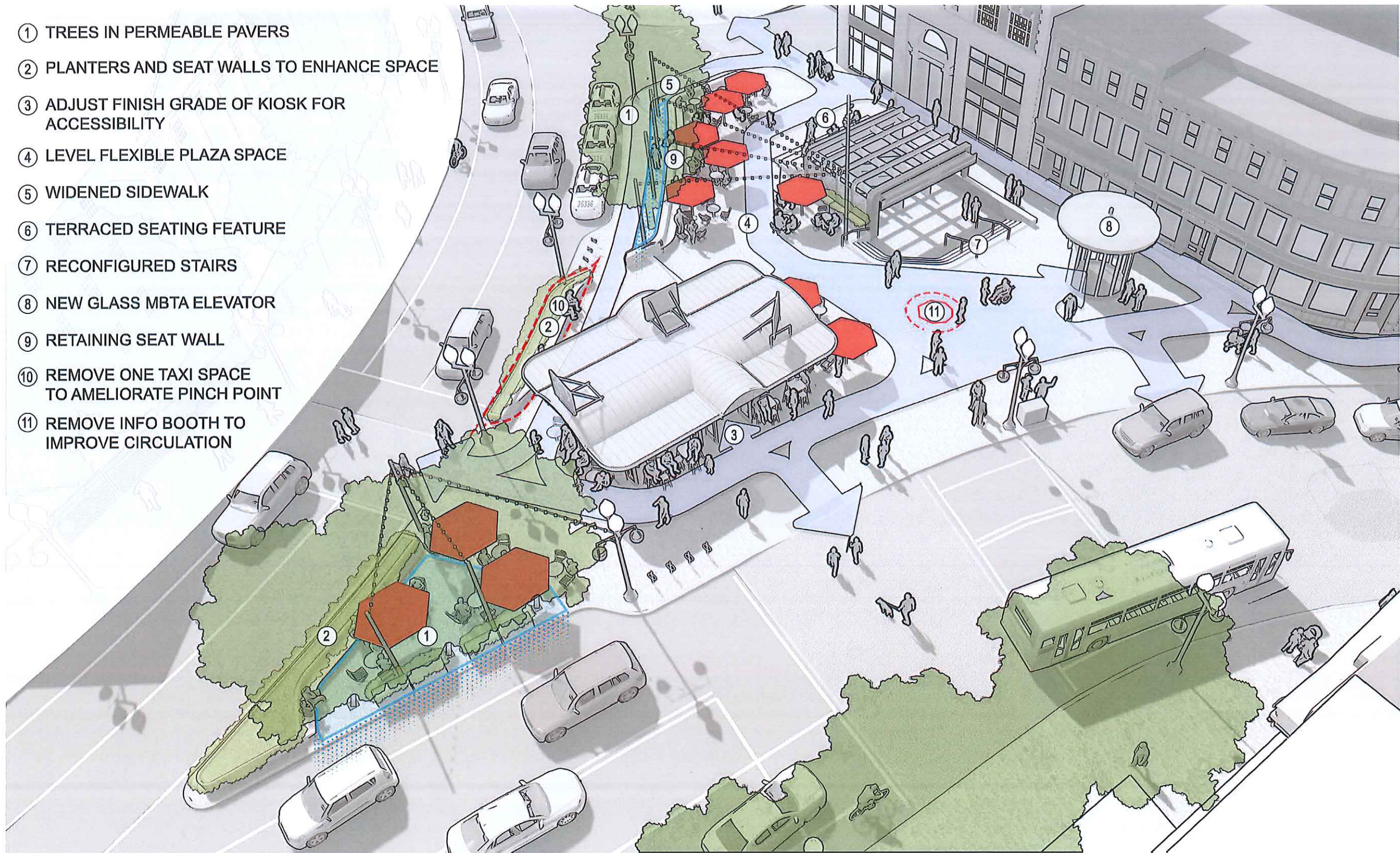

KEY DESIGN CONSIDERATIONS

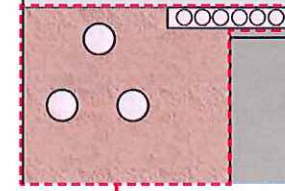
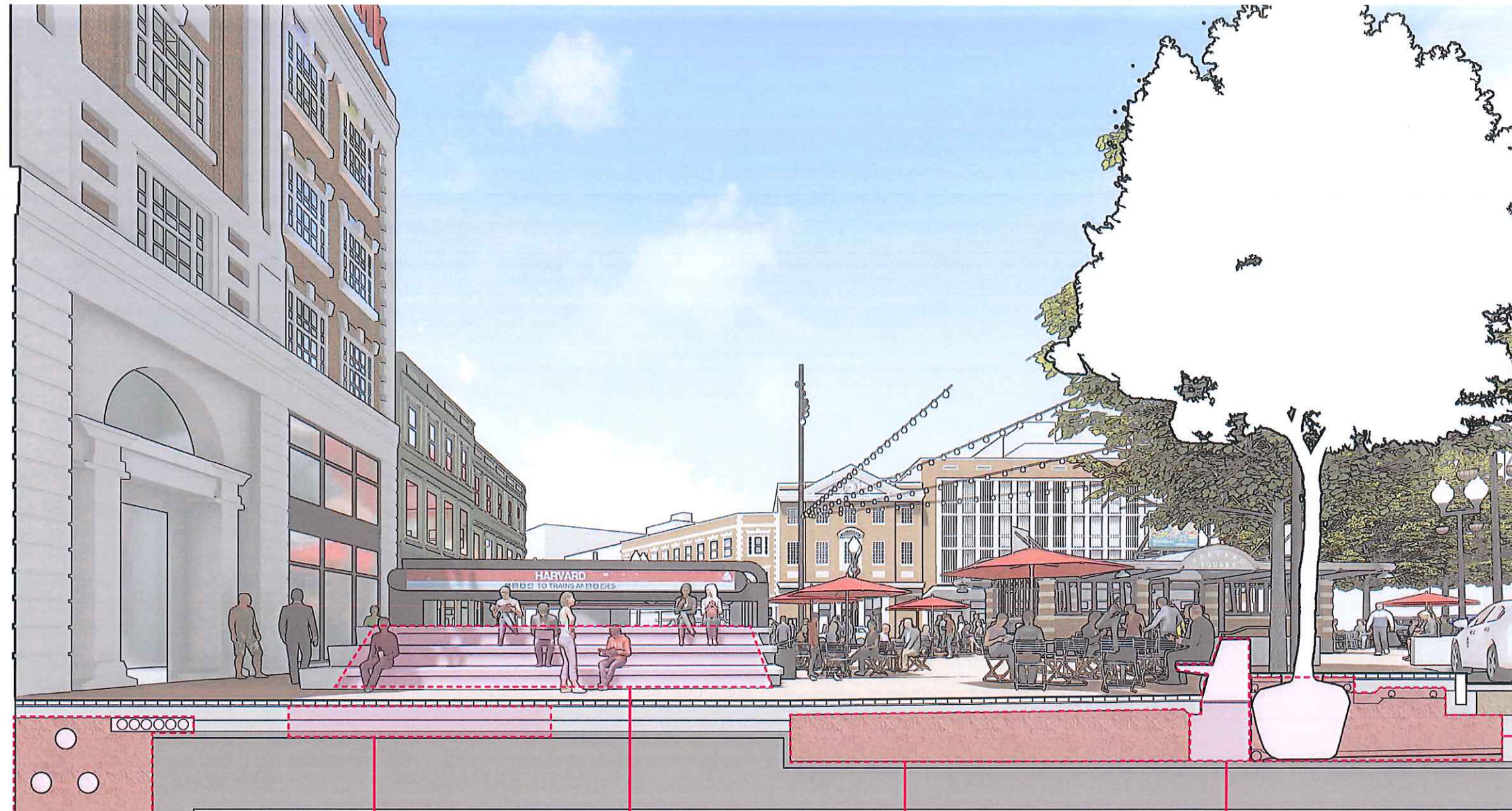

UTILITY CORRIDOR



MINIMAL CLEARANCE OVER TUNNEL ROOF

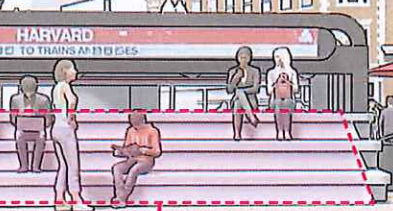

MBTA STATION SLOPED ROOF TO REMAIN



INADEQUATE SOIL DEPTH FOR TREE PLANTING

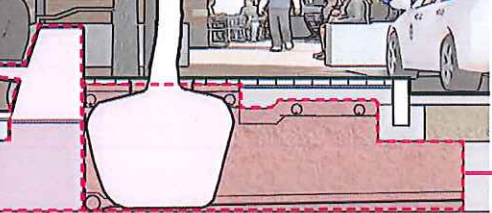

RETAINING WALL REQUIRED TO NEGOTIATE TRANSITION FROM MASS AVE. TO PLAZA



WATERPROOFED TREEWAY ON TUNNEL ROOF



PERSPECTIVE VIEW FROM DUNSTER STREET - PLAZA AT NIGHT



PERSPECTIVE VIEW FROM DUNSTER STREET - PLAZA



PERSPECTIVE VIEW OF NORTHERN PLAZA SPACE



MATERIAL PALETTE



BRONZE HANDRAILS

KITLEDGE GREY GRANITE
SUPPLIED BY FLETCHER GRANITE

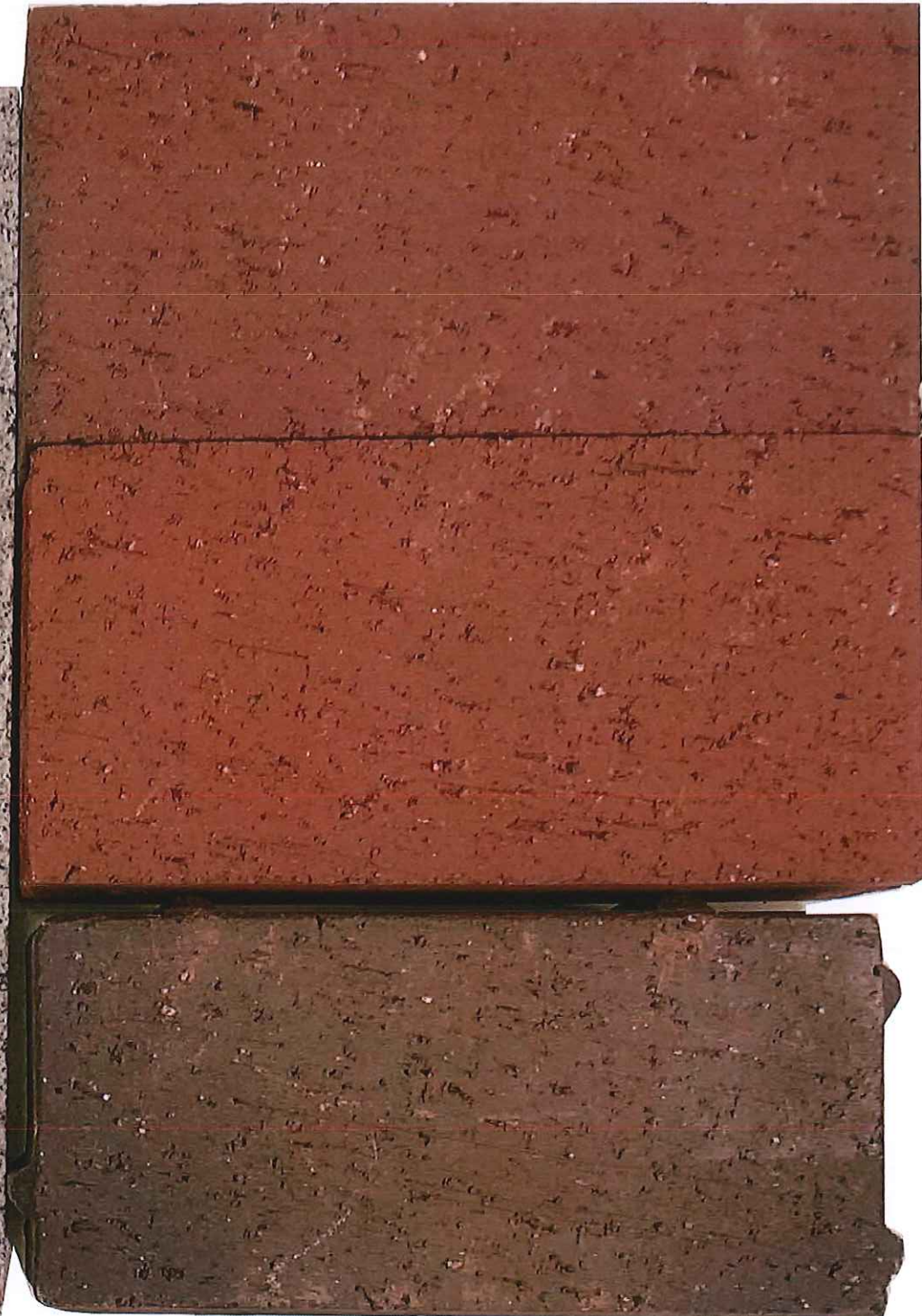

CITY OF CAMBRIDGE STANDARD -
PATHWAY HD FULL RANGE
SUPPLIED BY PINE HALL BRICK

